



# CRUSADER



CRUSADER | FIFTH WHEELS  
[WWW.PRIMETIMERV.COM](http://WWW.PRIMETIMERV.COM)

A HIGHER STANDARD





# CRUSADER

Within us all, there's a calling to achieve ever-greater things; a search for a higher standard. In creating Crusader, we asked our engineers and design team to throw caution to the wind and engage in serious "outside the box" thinking. We challenged them to think beyond the status quo and reach for product innovations not currently offered. We said, "Make Crusader a new icon for the 21st century." Needless to say, they took the challenge to heart.

**The result of their efforts represents a new standard in fifth wheels — A HIGHER STANDARD — Crusader.**



351 REQ Living Room in Truffle Décor



## A HIGHER STANDARD





294 RLT Living Room In Autumn Mocha Décor

Crusader is unlike any fifth wheel in its class. On the outside, our fifth wheel experts have combined advanced engineering and design with best-in-class features to create a fifth wheel that looks great, tows easily, and maximizes convenience. On the inside, Cherry hardwood cabinetry and solid surface kitchen countertops carefully work together to make a lasting first impression. Your comfort and relaxation will be guaranteed with an abundance of upgrades such as

a home theater system, residentially inspired Lane® Furniture, and Crusader's Ever Rest® select foam mattress. Everywhere you look, there are numerous upgrades that will maximize your convenience while making your Crusader the envy of every campground. Finally, your long-term peace of mind is assured with Crusader's durable ETERNABOND® Construction, 50 AMP service, and Leak Guard Assurance process.





**A**

- A. The Crusader 351 REQ bathroom is amazing! It features a slide-out vanity and loads of storage.
- B. Full extension drawer guides allow complete access to Crusader's extra large storage areas.

351 REQ Bathroom



**C**

## A HIGHER STANDARD THAT WILL IMPRESS AT EVERY TURN

Within seconds of entering, experienced RV'ers will recognize Crusader's subtle details of excellence, best-in-class features, and residential appointments.

- C. The large pantry area in the 294 RLT features "Best in Class" storage. This pantry area is also featured in the 325 RES, 350 REQ and 351 REQ.
- D. The Large LED television is perfectly positioned in the 294 RLT. The huge lower cabinet maximizes storage and is complimented by the large buffet countertop.

- E. "Suite Slide" offers premium storage and livability not found on most mid-profile fifth wheels.
- F. The king shower, Skyview® skylight, 6'8" of headroom, and STOR MOR® shower caddy deliver on Crusader's promise of "A Higher Standard".





D



E



F



Many models offer the innovative  
*Blanket Bin* headboard storage.

Shown here is the queen bed  
slide-out in the Crusader 351 REQ.





Crusader shown with Champagne Fiberglass exterior.



Residentially Inspired Lane® Furniture



Universal Docking Center



Easy-To-Clean Saddlebags Offer Convenient Storage



Lane® Furniture Residential Hide-A-Bed Sofa



Deluxe Skyview® Skylight and STOR MOR® Shower Caddy



Best-In-Class Pass Thru Storage with Strut



Bus Style Slam Latch Baggage Doors



Designer Aluminum Wheels with Rubberized Suspension



50 AMP Power with Convenient Detachable Marine Cord



Extended Drip Spouts



LED Interior Lighting



Optional Bumper Mounted Swing Arm Grill



QUIET COOL® Air Conditioner is 75% Quieter, 25% More Efficient



SUPER TURN® Front Cap Has 88 Degree Turning Radius



Outside Kitchen Featured in Three Models (Sink N/A in 360 BHS)

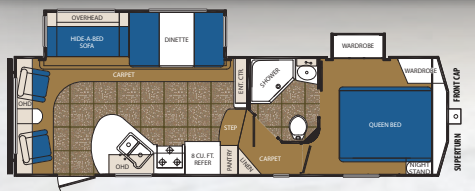

260 RLD

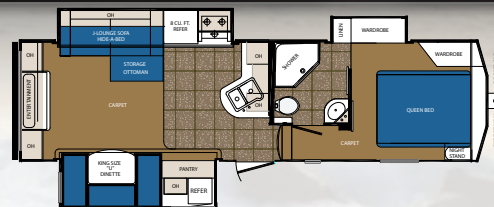

285 RET

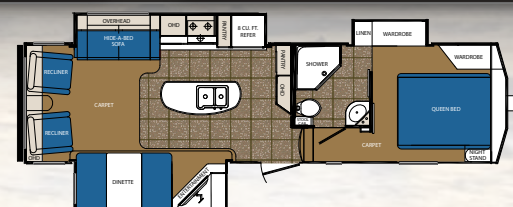

294 RL

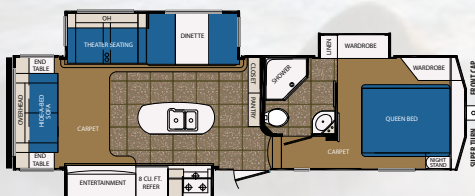

295 RST

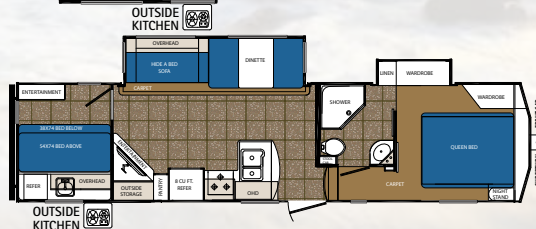

296 BHS

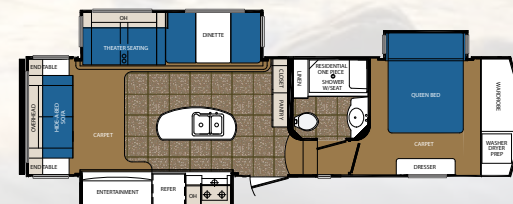

315 RST



# STANDARDS & OPTIONS

## CONSTRUCTION

- Gel Coated Fiberglass Exterior
- 5" Truss Rafters on 16" Centers with 3/8" WALK ON Decking
- Fiberglass Roof Insulation (R-14)
- One Piece Rubber Roof with 12 Year Warranty
- Upgraded Water Line Fittings with 25 Year Warranty
- Easy Access Low Point Drain Switches
- Easy Access Fresh Water Drain Switches
- **Fresh Water Capacity – 60 Gallons**
- **Waste Water Capacity – 35 Gallons**
- **Gray Water Capacity – 70 Gallons**

## EXTERIOR STANDARDS

- SUPER TURN® Aerodynamic Front Cap
- "E-Z LUBE" Greasable Axle Hubs
- Oversized Pass Thru Baggage Doors
- Extended Drip Spouts
- Black, Dark Tinted, Radius Safety Glass Windows
- 30# LP Bottles - Weight Distribution Design
- Quick Connect® Exterior LP Connection
- Outside Speakers
- Folding Grab Handle
- 30" Radius Entry Door
- Outside Shower with Detachable Hose
- Digital Compatible Roof Mounted Antenna
- Hi-Rise Triple Entry Step
- Outside Television Hook-Up
- ABS Hitch Cover
- 15" Wheels and Tires (260,285,294,295,296)
- 16" Wheels and Tires (315,325,334,335,350,351,360)

## APPLIANCES/EQUIPMENT

- 15,000 BTU "Quiet Cool" Air Conditioner
- 35,000 BTU Hi Capacity Gas Furnace
- 3-Burner Range with Large Oven

- Range Hood with Light and Exhaust
- 8 Cubic Foot Double Door Refrigerator
- 6 Gal. Gas/Electric W/H with DSI
- 18 Gal./Hr. Quick Recovery Mode for Water Heater
- Simple Water Heater Bypass
- Hi Capacity Water Pump
- 12V Electrical System
- EZ Winterization Hook-Up
- Washer/Dryer Prep (Bed Slide Models)

## INTERIOR STANDARDS

- Solid Cherry Hardwood Cabinet Doors
- Solid Cherry Hardwood Drawer Fronts
- Solid Wood Core Cabinets
- Predrilled and Screwed Cabinetry
- Ball Bearing Extended Drawer Glides
- "Video Pro" Separate Cable / Satellite Prep
- Upgraded Residential Carpet
- Deep Overhead Cabinets in Slide Out (where applicable)
- Swivel Chairs (where applicable)
- Decorative Wall Light in Slide Out
- Large Panoramic Slide Room Windows
- Premium Vinyl Flooring
- Pleated Shades

## KITCHEN

- LG Solid Surface Countertops
- Polished Nickel Fixtures & Hardware
- Deep, Double Bowl Kitchen Sink
- Hi Rise Metal Kitchen Faucet
- Residential Style Microwave
- Large Size Trash Can In Dedicated Area
- Oversized Pots N Pans Drawer
- Slide Out Pantry (most models)

## BATHROOM

- King Size Shower (most models)

- Glass Shower Enclosure (most models)
- ABS Tub Surround
- Deluxe Skyview® Skylight Over Tub
- Power Vent Fan
- Porcelain Toilet with Foot Flush
- STOR MOR® Shower Caddy
- Large Bathroom Sink
- Medicine Cabinet with Mirror

## BEDROOM

- Dual Wardrobes (most models)
- Underbed Storage with Struts
- Residential Bedsprad
- Bedroom Heat and A/C Vents
- Wired & Framed for 2nd Air Conditioner

## SAFETY EQUIPMENT

- CO Detector
- LP Detector
- Fire Extinguisher
- Propane Alarm
- Smoke Alarm

## "ADVANTAGE PACKAGE" \*\* (MANDATORY)

- ETERNABOND CONSTRUCTION Featuring:
  - Laminated Aluminum Framed Side Walls (R-11)
  - Laminated Aluminum Framed End Walls (R-11)
  - Laminated Aluminum Framed Main Floor (R-14)
  - Laminated Aluminum Framed (R-14) Slide Out Walls and Roof

- Hartford Cherry Cabinetry
- LG Solid Surface Countertops
- LG Solid Surface Sink Covers
- Universal Docking Center (UDC)
  - Cable & Satellite Hook-ups
  - Black Tank Flush
  - Battery Disconnect Switch
  - Spray Port with Hot & Cold Water
  - Coil Hose
  - Simple Water Heater By-Pass Switch
  - Simple Winterization Switch
  - Simple Winterization Draw Line
  - City Water Connection and Fresh Tank Gravity Fill
- Thermal Package Plus Featuring:
  - Enclosed and Heated Underbelly
  - Heated Holding Tanks
  - Enclosed Dump Valves
  - Heated Dump Valves
  - Zero Degree Extended Season Enjoyment
- Roof Ladder
- Spare Tire
- Lane® Residential Hide-a-Bed Sofa
- Lane® Residential Recliners (294,325,334,350,351)
- Detachable Power Cord
- Ever Rest Select Foam Mattress
- Dexter "E-Z Flex" Rubberized Suspension
- 1 Year Emergency Roadside Assistance Plan

- Leak Guard Assurance Process
- DVD and Surround Sound System
- AM/FM *Blue Tooth* Stereo System with Interior/Exterior Speakers
- Large LED TV
- One Touch Electric Awning
- 15K BTU "Quiet Cool" Premium Air Conditioning System
- 50 AMP Electrical System
- Prepped For Bedroom Air Conditioner

## OPTIONS

- 16" Aluminum Wheels and "E" Rated Tires IPO 15"
- Free Standing Table with 4 Chairs
- Bumper Mounted Swing Arm Grill (N/A 260)
- 12 Cubic Foot Refrigerator (325,334,350 Only)
- Champagne High Gloss Gel Coat Exterior
- Dual Pane Windows
- Lane® Theater Seating IPO Recliners (334 Only)
- Colored Front Cap
- 2nd 13.5K "Quiet Cool" Air Conditioner w/Dual Zone Control (315,325,334,350,351,360)

\*\*Mandatory Effective 1/1/14

SPECIFICATIONS	260RLD	285RET	294RLT	295RST	296BHS	315RST	325RES	334CKT	335BHS	350REQ	351REQ	360BHS
Length	29' 11"	31' 8"	32' 11"	31' 11"	35' 3"	33' 11"	36' 0"	37' 9"	37' 9"	39' 6"	39' 6"	40' 5"
Height	11' 8"	11' 8"	11' 8"	11' 8"	11' 8"	12' 7"	12' 7"	12' 7"	12' 7"	12' 7"	12' 7"	13' 2"
Hitch	1,321	1,497	1,290	1,278	1,350	1,953	1,715	1,741	1,657	2,270	2,270	1,852
Ship Weight	7,669	8,821	9,061	8,777	8,934	9,926	10,632	10,606	9,751	11,875	11,875	12,120
Carrying Capacity	2,393	3,159	2,351	3,117	2,538	2,389	3,045	3,097	2,268	2,357	2,357	1,694

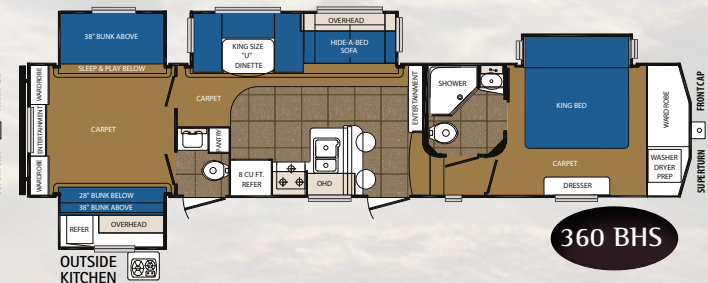
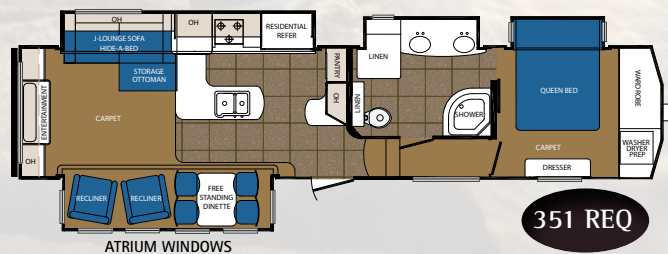
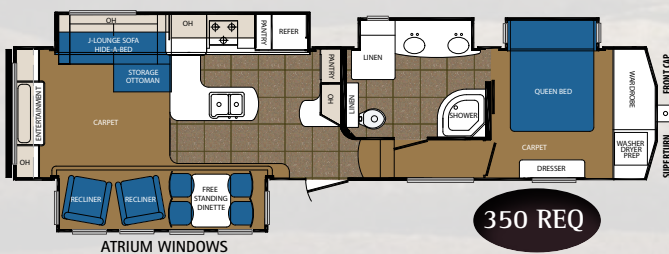
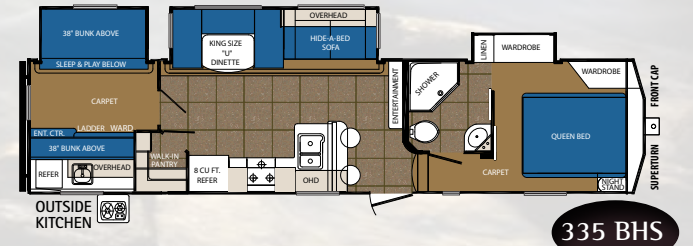
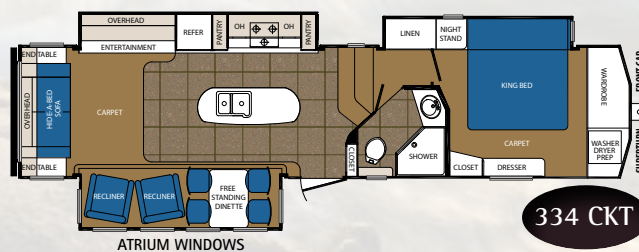
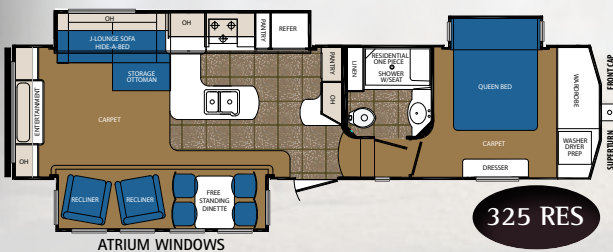

# DSI QUALITY CIRCLE AWARD WINNER - 2010, 2011, 2012, 2013

Prime Time Manufacturing is proud to be recognized as an industry leader in value, reliability, and overall quality by the Recreational Vehicle Dealers Association. This was accomplished by committing ourselves to "A Higher Standard" in design, construction, testing, and customer service. Check us out - we know you'll be impressed!



Seal Tech Air Pressure Test



ETERNABOND Construction



Rain Bay



Seek-A-Leak Pressure Test



65 Point Secondary PDI



Web Based  
Customer Service



Executive Quality Audits



Advanced Engineering



www.primetimerv.com



## HERE'S JUST A SAMPLE OF THE BENEFITS\*

- ✓ Mobile Mechanic
- ✓ Free Jump Starts
- ✓ Tire Changes
- ✓ \$2000 Trip Interruption
- ✓ Appointment Assistance
- ✓ Lock Out Service
- ✓ Fuel Delivery
- ✓ Service Assistance
- ✓ Custom Trip Routing and Maps
- ✓ 24 Hour Emergency Messaging

\*Exclusions and restrictions apply. See member guide for details.



Forest River, Inc. encourages our customers to purchase their Forest River products from a local dealership whenever possible for the following reasons:

- 1) Forest River, Inc. dealers are independently owned and operated businesses so priority service and scheduling is at their discretion and is often provided to customers that purchased their unit at that dealership.
- 2) Purchasing locally allows customers to establish meaningful relationships with a dealer, enhancing the RV experience through assistance with product questions, user tips or RV regulations for your state or country, and much more!
- 3) Canadian customers must meet requirements to bring an RV purchased out of the country to their home. These requirements may involve additional inspections and certifications, taxes and fees. Your local Canadian Dealer is a professional at meeting these requirements.
- 4) Scheduling timely warranty repairs and adjustments through a local dealership provides far greater flexibility and convenience to you, the customer!

It is the goal of Forest River, Inc. that all of our RV owners fully enjoy the RV experience and that customer satisfaction meets or exceeds their expectations!

All illustrations and specifications contained in this literature are based on the latest product information at time of publication. Prime Time Manufacturing reserves the right to make changes in prices, colors, materials, equipment and specifications at anytime, without notice, and assumes no responsibility for any error in this literature. All units are shipped F.O.B. point of manufacture.

F-66-367 © 2013  
Forest River Litho U.S.A.



**Learn More**  
Scan this barcode using a QR Reader on your smart phone to learn more about Forest River.



Colton RV  
North Tonawanda, NY 14120  
(716) 694-0188  
(800) 628-4889  
www.ColtonRV.com

Colton RV  
Orchard Park, NY 14117  
(716) 957-3250  
(800) 628-4889  
www.Coltonrv.com

DEALER