

OPEN RANGE 3X

2025 FIFTH WHEELS

40.6411° N, 110.1102° W
Vernal, Utah



Freedom to Explore





2025 Open Range 3X 390TBS FW

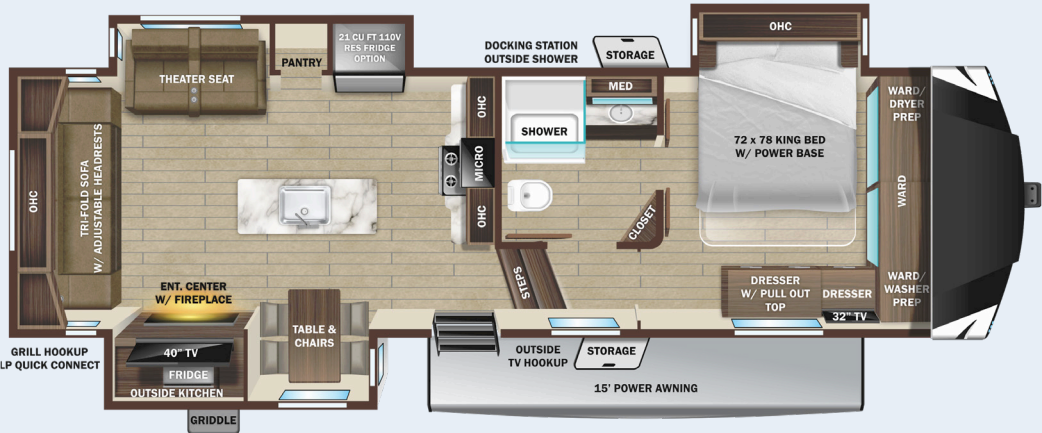

ROAMER FW

FLOORPLAN
OPTION

20 Cu. Ft. 12V Refrigerator
(Available on All Floorplans Shown)

287RLS

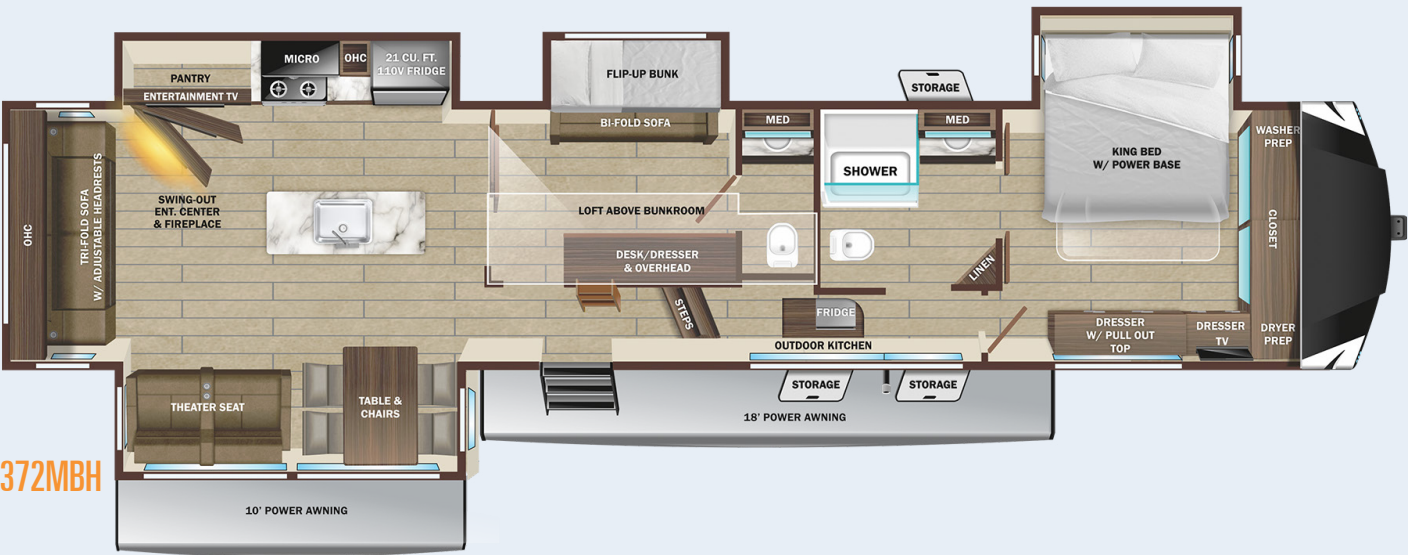

372MBH



390TBS

STANDARD INTERIOR EQUIPMENT

- » 60" x 80" residential queen bed with storage below
- » 72" x 78" residential king bed with power base
- » 9" 3 layer firm/soft option residential mattress
- » Cable and satellite prep
- » Ceramic subway tile backsplash
- » Fiberglass shower base
- » Flexible reading lights with USB chargers
- » Flush floor slides with residential vinyl flooring
- » GE 21 cu. ft. residential refrigerator
- » GE 3.75 cu. ft. freestanding oven and 4-burner range
- » GE 30" OTR residential microwave
- » Glass shower door
- » Hardwood ceiling soffit
- » Hardwood slideout fascia
- » Large hidden pantry
- » LED interior lighting
- » Main bedroom TV - 32"
- » Pet/Child Screen Guard on Screen Door
- » Porcelain lavatory bowl with single lever faucet
- » Rainfall kitchen sink with Produce and Glass Rinser
- » Raised panel hardwood cabinet doors
- » Solid surface lavatory top
- » Solid surface waterfall island
- » Square windows with intergraded blinds
- » Table and 4 chairs
- » Theater seating with power recline
- » VoiceLINK™ voice command system- controls lighting, heating and cooling along with TravelINK®
- » Wall controlled power vent (kitchen/living room area)
- » Washer/dryer prep

STANDARD EXTERIOR EQUIPMENT

- » 102" wide body frame
- » 16 gal. gas/electric water heater
- » 2" receiver hitch
- » 3-40 lb. LP bottles
- » 4000 MORyde® Suspension

- » 50 amp service
- » ACCU-SLIDE™ slide system (42" deep 4-corner compression)
- » Battery disconnect switch
- » Brass hanger bushings with wet bolts
- » Equa-Flex® axle suspension
- » Exterior grill/griddle quick connect port
- » H-rated steel belted radial tires
- » Intergraded aluminum hub rims
- » Laminated block foam floor
- » LevelLoc™ - 4 or 6 point automatic leveling with JT's Strong Arms®
- » PVC roofing membrane (limited lifetime warranty)
- » Rear roof access ladder
- » Self-adjusting electric brakes
- » Spare tire
- » TuffShell™ -vacuum bonded laminated construction, reinforced with heavy-duty fiberglass and welded aluminum frames
- » Xtend Solar I Package (1-200 watt solar panel with 30 amp controller)

EXECUTIVE PACKAGE (MANDATORY)

- » 3-15,000 BTU A/C with quiet residential return air
- » Cutting board and sink strainer
- » Dome style digital TV antenna with Wi-Fi prep
- » Interior convenience center light
- » Keyed-Alike® entry and baggage doors
- » Main bedroom TV - 32"
- » Motion sensor lighting in bedroom and hallway
- » Painted fiberglass front cap with LED lighting
- » Power awning with LED lighting
- » Quick recovery gas/electric water heater
- » Quick release fresh water drain
- » Residential high-rise faucet with pull-down sprayer
- » Security camera prep above entrance door
- » Single basin stainless steel under-mount kitchen sink
- » Smart Entertainment HDTV with Bluetooth®, Soundbar and Built in Stereo
- » Solid swing-down entry steps

- » Solid-surface kitchen countertops
- » Stainless steel appliances
- » TravelINK® - Smart RV system that allows for Bluetooth® control of awnings, lighting, slideouts, heating, cooling and more
- » USB/12V charging port

FOUR SEASON PACKAGE (MANDATORY)

- » 2.625" sidewall, 50% thicker wall with 3/4" vapor barrier between the interior and the aluminum tubes
- » 40K BTU high performance furnace
- » 5K BTU electric fireplace
- » Double insulated baggage doors
- » Ducted heat to underbelly with cold air return
- » Enclosed cable operated gate valves
- » Enclosed exterior docking station with black tank flush
- » Heated and enclosed underbelly
- » R-17 block foam insulation in sidewalls with 3/4" vapor barrier
- » R-38 reflective foil insulation in ceiling and underbelly

OPTIONS

- » 20 cu. ft. 12V Refrigerator with ice maker
- » Dual pane windows
- » GE 18" Residential Dishwasher
- » Generator prep - LP
- » Heat pump (main A/C)
- » MORyde® Pinbox
- » Observation camera
- » On demand water heater
- » Rear table ipo standard sofa (372MBH)
- » Slideout awning covers
- » Wall controlled power vent - bathroom
- » Wi-Fi router
- » Xtend Solar II Package (2-200 watt solar panels with 30 amp solar controller and 1800 watt inverter) (Replaces standard Xtend Solar I Package)

SPECIFICATIONS

May Include Estimated Values

	287RLS	372MBH	390TBS
Unloaded Vehicle Weight (lbs.)	11,830	14,030	14,565
Dry Hitch Weight (lbs.)	2,155	2,930	2,970
Gross Vehicle Weight Rating (GVWR)	13,900	16,300	11,595
Cargo (Gross)	2,070	2,270	2,430
Exterior Length (Pin to Rear)	33' 10"	42' 3"	42' 5"
Exterior Length (Overall)	35' 4"	43' 9"	43' 7"
Exterior Height	12' 6"	16' 6"	12' 3"
Exterior Width	8' 5"	8' 6"	8' 6"
Exterior Width (Slides Out)	14' 4"	14' 9"	14' 10"
Interior Height (Upper Deck)	6' 4"	6' 4"	6' 3"
Interior Height (Lower Deck)	7' 6"	8' 2"	8'
Fresh Water Capacity (Gal.)*	85	91	91
Gray Waste Water Capacity (Gal.)	80	97	97
Black Waste Water Capacity (Gal.)	57	40	80
LP Capacity (lbs.)	80	80	80
Tire Size	16"	16"	16"
Awning Size	19'	18', 10'	18', 11'

*Includes Water Heater

LOCAL DEALER INFO

Colton RV & Marine
3122 Niagara Falls Blvd.
North Tonawanda, NY 14120
(716) 694-0188
www.ColtonRV.com

Colton RV
489 Bushkill Plaza LN #9665
Wind Gap, PA 18091
(610) 863-5239
www.ColtonRV.com

TO LEARN MORE VISIT
openrangerv.com

Highland Ridge RV – Part of the Jayco Family of Companies



Highland
RIDGE RV

Own the Outdoors

Due to continual research and advances, manufacturer reserves the right to change specifications, design, price, and equipment without notice, and assumes no responsibility for any error in the literature. Some items shown are not included as standard or optional equipment.