



# XLR NITRO



TRAVEL TRAILER & FIFTH WHEEL  
TOY HAULERS





42DS5

## CLEAN, CONTEMPORARY STYLING

*This convenient island kitchen puts the cook in the center of the action! Contemporary kitchen appointments include a 50/50 stainless steel sink and appliances, cabinets with hidden hinges for a sleek look, loads of counter space, plus plenty of storage. Solid wood slide out fascia surrounds Nitro's plush four seat Zero wall recliner sofa with integrated lumbar support. Blue LED lighting accents the heat/massage control cup holders and sofa base. An above garage loft is a great sleeping place for kids, or serves as additional storage. The access ladder stows away in the garage.*





# XLR NITRO

## TRAVEL TRAILER & FIFTH WHEEL TOY HAULERS

At the end of the day, the right Toy Hauler delivers the best of both worlds – a relaxing retreat after an exciting day's adventure, and a safe, secure shelter for your toys, dogs, gear, equipment – anything! Nitro is known in the industry for a distinctive style with premium kitchen appointments, versatile, well-planned living spaces and garage essentials to fit your growing family and ever changing interests. All Nitros come with an XLR king bed for a better night's sleep.



**42DS5**

*A sliding glass door leads to the side patio with a protective rail fence for extended living and entertaining. Access the second bathroom and garage area via the patio deck. Shown with an optional 32" LED TV.*

*Nitro impresses with styling that amps up the WOW factor! Blue LED accent lighting, contrasting Birchwood plank style flooring, rich Espresso cabinets and wainscoting add pop. An AM/FM Bluetooth Sound Bar with three zone programming in the living room, garage and outside, lets you enjoy premium entertainment. The living area has a 40" LED flatscreen TV and DVD player. Blu-ray is an available option.*



*This plush master bedroom is complete with an XLR king bed, nightstands, an electronics charging outlet, overhead cabinets, and a large wardrobe slide out with drawer storage. The bathroom includes a contemporary radius shower with glass doors and a porcelain toilet. (Chestnut décor)*







**29KW**

*This open floorplan is the ultimate in versatility. Birchwood plank style flooring in the living area transitions to durable oil and gas resistant industrial flooring in the garage. 5000# D-rings attached to the frame secure your cargo. Optional carpeting can be rolled out into the garage to increase the living area. The 29KW comes with two Eurostyle reclining chairs and a table, plus a large 50" LED flatscreen TV, and a Happijac bed lift system. (Raven décor)*

*All Nitro models have a spacious XLR king bed with stylish pillow shams and a bedspread!*



*Go off grid! Keep the kitchen stocked and the crew happy with tons of storage in the galley. It's equipped with a 50/50 stainless steel sink, a gooseneck faucet, and stainless steel appliances. A sink cover increases counter space and doubles as a cutting board.*







## CONSTRUCTION

1. Gel coat fiberglass radius cap
2. Radiant foil barrier
3. 7,000 lb. E-Z Lube® Dexter® Axles (FW)
4. 16" E-rated tires
5. Nitro filled radial tires
6. 5/8" Plywood floor decking
7. Fully enclosed underbelly
8. Holding tanks secured by frame cradle
9. 3" Wood floor joists with fiberglass insulation (Most models)
10. Slam latch compartment doors
11. High gloss fiberglass exterior
12. Laminated and insulated slide out end walls/roof
13. 1" Garage floor decking with rubberized flooring (FW)
14. 8 Ft. easy lift, 3,000 lb. ramp door
15. One piece rubber roof
16. 13,500 BTU air conditioner
17. Rear electric stabilizer jacks
18. Steel anchor plates for 5,000 lb. tie downs
19. High efficiency A/C duct system
20. Vacuum bonded sidewall with block foam insulation
21. 3/8" Roof decking
22. Fiberglass insulation plus radiant foil barrier
23. Attic vents
24. 102" Widebody construction
25. Full walk on roof
26. 2" Aluminum framed sidewalls

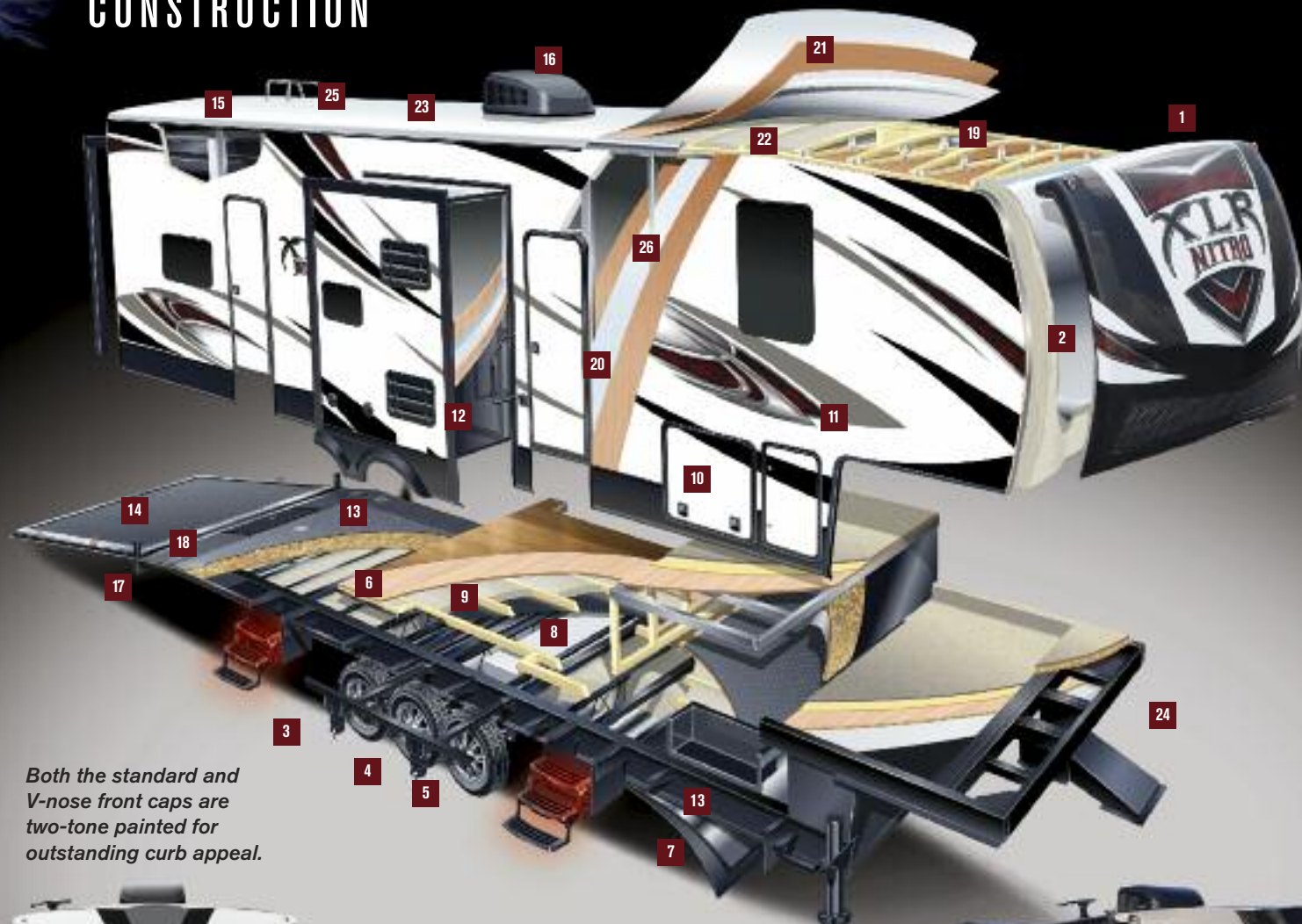

*Both the standard and V-nose front caps are two-tone painted for outstanding curb appeal.*



*Standard Fifth Wheel*



*V-Nose Fifth Wheel*

### PERFECT FOR SHORT BED TRUCKS

*XLR offers three V-Nose models that are unique to the Toy Hauler industry. The aerodynamic V-nose front end provides a better turning radius and allows towing without a slider hitch on short bed trucks, plus improves fuel economy. Insects bounce right off the V-nose resulting in quicker clean up. (35VL5, 36VL5 and 38VL5)*



*Full Body Paint Option*



# FIFTH WHEELS

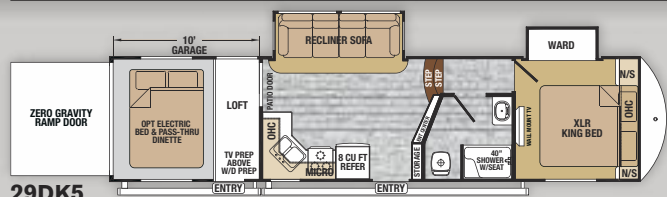

29DK5

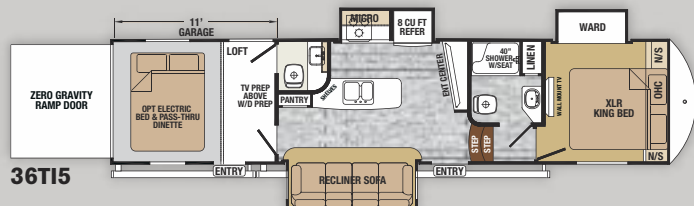

36TI5

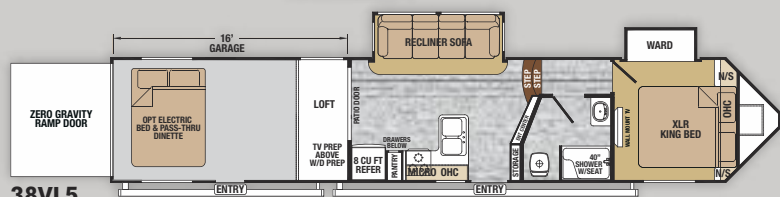

38VL5

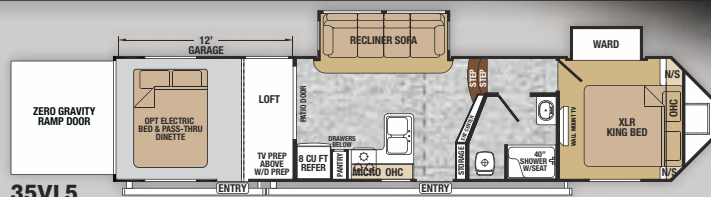

35VL5

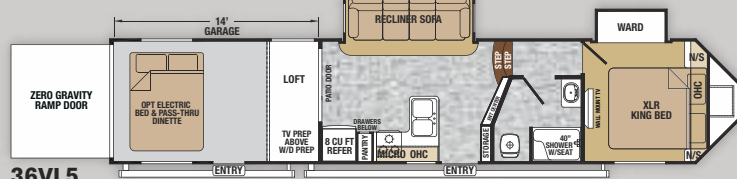

36VL5

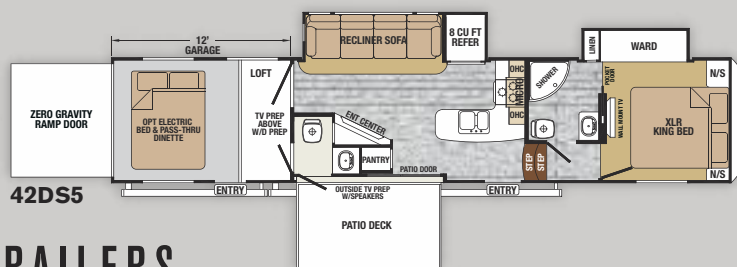

42DS5

# TRAVEL TRAILERS

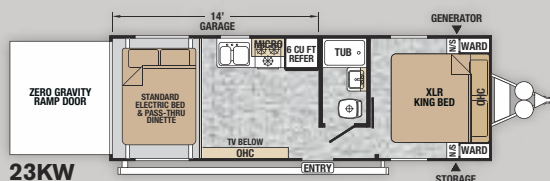

23KW

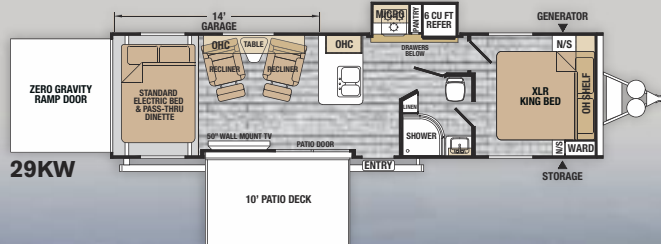

29KW

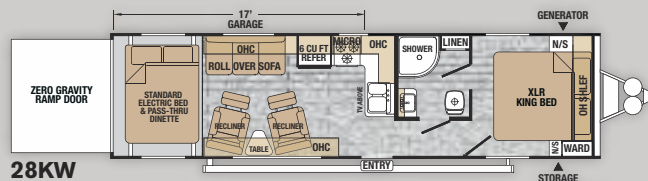

28KW

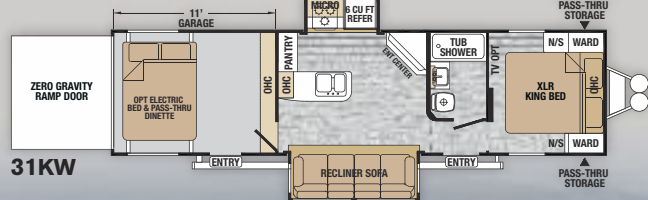

31KW

## FIFTH WHEELS

## TRAVEL TRAILERS

Model	29DK5	35VL5	36TI5	36VL5	38VL5	42DS5	23KW	28KW	29KW	31KW
Hitch Weight	2545	2579	3217	2850	3125	2669	730	995	1515	1387
UVW	11553	12678	13598	12210	13979	15404	6865	8428	9256	9944
Cargo Capacity	4992	3901	3619	4640	4021	2596	2665	4567	4259	3571
Exterior Length	37' 10"	38' 5"	39' 11"	43' 11"	45' 11"	43' 11"	30' 2"	36' 9"	36' 9"	37' 5"
Exterior Height	12' 10"	12' 10"	13' 4"	13' 4"	13' 4"	13' 4"	12' 10"	12' 10"	12' 10"	12' 10"
Exterior Width	102"	102"	102"	102"	102"	102"	102"	102"	102"	102"
Fresh Water	94	94	94	94	94	94	92	85	94	94
Grey Water	80	80	80	80	80	110	50	50	60	62
Black Water	50	50	80	50	50	80	30	30	30	30

GVWR (Gross Vehicle Weight Rating) - is the maximum permissible weight of the unit when fully loaded. It includes all weights, inclusive of all fluids, cargo, optional equipment and accessories. For safety and product performance do NOT exceed the GVWR.

GAWR (Gross Axle Weight Rating) - is the maximum permissible weight, including cargo, fluids, optional equipment and accessories that can be safely supported by a combination of all axles.

UVW (Unloaded Vehicle Weight) - is the typical weight of the unit as manufactured at the factory. It includes all weight at the unit's axle(s) and tongue or pin and LP Gas. The UVW does not include cargo, fresh potable water, additional optional equipment or dealer installed accessories.

CCC (Cargo Carrying Capacity)\*\* - is the amount of weight available for fresh potable water, cargo, additional optional equipment and accessories. CCC is equal to GVWR minus UVW. Available CCC should accommodate fresh potable water (8.3 lbs. per gallon). Before filling the fresh water tank, empty the black and grey tanks to provide for more cargo capacity.

\*Estimated Average based on standard build optional equipment.

\*\*Estimated average based on standard build optional equipment.

Each Forest River RV is weighed at the manufacturing facility prior to shipping. A label identifying the unloaded vehicle weight of the actual unit and the cargo carrying capacity is applied to every Forest River RV prior to leaving our facilities. The load capacity of your unit is designated by weight, not by volume; so you cannot necessarily use all available space when loading your unit.



## TRAVEL TRAILER & FIFTH WHEEL TOY HAULERS

GO BIG. GO BOLD. GO XLR!

Nitro offers six fifth wheel and four travel trailer floor plans to accommodate your lifestyle.

Outdoor enthusiasts, family vacations, sporting events or off-road expeditions... the possibilities are endless. Even better, Nitro's versatile floorplans will grow with you for years.

## DÉCOR

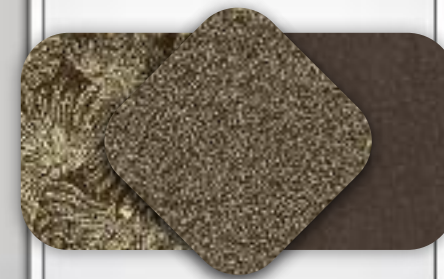

CHESTNUT

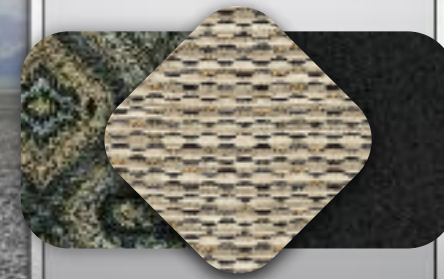

RAVEN

# STANDARDS AND OPTIONS

## EXTERIOR STANDARDS

- Aluminum Framed Laminated Sidewalls
- 102" Wide Body Construction
- Powder Coated Steel I-Beam Chassis
- One Piece Rubber Roof
- Two Tone Partial Painted Front Cap (FW)
- Large Entry Assist Grab Handle
- EZ-Lube® Dexter® Axles
- Marine Grade Speakers
- Huge Tinted Safety Glass Windows
- 18K Hitch Pin (FW)
- Collapsible Exterior Ladder (FW)
- Black Tank Flush
- Full Walk-on Roof
- Rain Gutter Drip Spouts
- LED Exterior Lighting
- Nitro Filled Radial Tires
- Satellite Prep
- Hot and Cold Spray Port

## INTERIOR STANDARDS

- LED Interior Lighting
- Full Height Ceilings
- Plywood Decking
- Beauflor® Birchwood Plank Flooring

- Shaker Style Cabinetry
- Full Extension Ball-Bearing Drawer Guides
- Brushed Nickel Hardware
- Stainless Steel Galley Sink
- Large LCD Living Room TV
- 35K BTU Furnace
- 12V Battery Disconnect
- Ducted A/C and Heat Throughout
- Gas/Electric Water Heater
- AM/FM/Bluetooth Soundbar (FW)
- 5,000# Steel Reinforced Tie Downs

## 2017 BIG AIR PACKAGE

- 13.5K Ducted A/C
- Spare Tire
- Blackout Features
- Aluminum Wheels
- Premium Graphics
- Aztec Grey Front and Rear Fiberglass
- Recliner Sofa with Heat Massage and LED Lighting (FW, 31KW)
- Upgraded Furniture (TT)
- Stainless Steel Appliances
- Electric Awning with LED Lighting
- Enclosed Underbelly
- Friction Hinge Doors

- Solar Charger Input
- Night Shades
- Hid-N-Screen
- Wainscoting in Garage
- Hidden Hinges on Cabinetry
- Shaker Style Passage Doors
- Radiant Roof/Floor/Slide out Floor/ Garage Floor/Front Insulation (R-38 @ 80°F)

## 2017 N.O.S. PACKAGE

- LG Solid Surface Kitchen Countertop
- Electric Stabilizer Jacks
- N.O.S. Red Light Under Entry Steps
- Key Alike - Single Key Lock System
- MORryde Zero G Ramp Door
- MORryde CRE Suspension Enhancement System
- MaxxAir Power Roof Vent Bathroom
- 50AMP Service and Generator Storage Box
- Red LED Exterior Marine Grade Speakers

## OPTIONAL EQUIPMENT

- Extreme Weather Package (Dual Pane Windows, 12V Heated Tanks)

- Off The Grid Prep (Gen Prep, Mobile Fuel Station)
- Off The Grid Pkg (5.5 Onan Gen, Gen Prep, Mobile Fuel Station)
- Power Tongue Jack
- Second Electric Awning (FW)
- Sway Command™ Sway Control
- Ground Control 3.0 Electric Leveling System (TT)
- Ground Control 3.0 Electric Leveling System (FW)
- Euro Chair - Single
- 32" Flat Screen TV
- Satellite Wiring Package
- Convection Microwave
- 11 Cu. Ft. 110V Residential Refrigerator with Inverter IPO Gas/Electric (FW)
- 15K A/C IPO 13.5K
- Second 13.5K A/C Bedroom
- Three 13.5K A/Cs with Energy Management System
- MaxxAir Power Roof Vent
- Electric Bed with Max Clearance Pass Thru Dinette (Std. 23KW, 28KW, 29KW)
- Plush Removable Cargo Carpet
- VIP Party Deck and Electric Awning
- VIP Patio Steps (FW)
- Full Body Paint Upgrade



Keyed Alike – Single Key Lock System



50 AMP Service



MORryde Zero G Ramp Door



LG Solid Surface Kitchen Countertop



MORryde CRE Suspension Enhancement System



Electric Stabilizer Jacks



MaxxAir Power Roof Vent Bathroom



RED LED Exterior Marine Grade Speakers



Large Generator Box (Generator not included)



N.O.S. Red Light Under Entry Steps



Rear Vision Camera Pre-wire







# XLR NITRO

## TRAVEL TRAILER & FIFTH WHEEL TOY HAULERS



**GARAGE**



**DINING ROOM**



**BEDROOM**



### RAMPED UP VERSATILITY

Designed to hold today's most popular side-by-sides, 4-wheelers, motorcycles, grills, kayaks, bicycles, pets and kids, this multi-use garage/living space grows with you and converts to fit your lifestyle. The max clearance dinette with an electric bed allows for a full 8' of space when loading your toys. For plenty of fresh air, the garage becomes the perfect bug-free outdoor dining area with the optional roll up Hid-n-screen. Whether you're off for an extended adventure or you're a weekend warrior, XLR Nitro has the comfort, convenience and the right floorplan configurations to hold all your gear in major style.

### XLR Nitro by Forest River

2421 Century Drive ■ Goshen, IN 46528

E-mail: [XLRinfo@forestriverinc.com](mailto:XLRinfo@forestriverinc.com) ■ Phone: 574-642-0438

[www.forestriverinc.com/XLR](http://www.forestriverinc.com/XLR) ■ [www.forestriveraccessories.com](http://www.forestriveraccessories.com) ■ #XLRtoyhaulers

Actual towing capacity is dependent on your particular loading and towing circumstances, which includes GVWR, GAWR and GCWR, as well as adequate trailer brakes. Please refer to the Owners Manual of your vehicle for further information. All information contained in this brochure is believed to be accurate at the time of publication. However, during the model year, it may be necessary to make revisions and Forest River, Inc., reserves the right to make all such changes without notice, including prices, colors, materials, equipment and specifications as well as the addition of new models and the discontinuance of models shown in this brochure. Therefore, please consult with your Forest River dealer and confirm the existence of any materials, design or specifications that are material to your purchase decision. ©2016 XLR, a Division of Forest River, Inc., a Berkshire Hathaway company. All Rights Reserved. 12/16



### XLR Nitro Owner "Digital Kit" App

Now you can have your Owner's Manual with you wherever you are. Download our FREE App from the App Store or Google Play and you'll have the information right at your fingertips.



**FREE MEMBERSHIP**  
to Forest River Owners' Group

[www.forestriverfrog.com](http://www.forestriverfrog.com)



### PRE-DELIVERY INSPECTION FACILITY

20,000 square feet of quality assurance. The bare essentials for a premium product. This state-of-the-art facility gives immediate daily feedback to production for quality assurance in every unit built.

### 24/7 EMERGENCY ROADSIDE ASSISTANCE

For a worry-free ownership experience Forest River includes one

**Coach-Net®**

RV Technical & Roadside Assistance

year of Coach-Net RV Technical & Roadside Assistance with each RV purchase. Whether new to the RV lifestyle or an experienced RV enthusiast, Forest River owners have 24/7 access to technical, operational and emergency road service coverage throughout the US & Canada. Coach-Net's fast, dependable service is just a phone call away.



### Learn More

Scan this barcode using a QR Reader on your smart phone to learn more about Forest River.



A Berkshire Hathaway company.

### CUSTOMER SATISFACTION



[www.ForestRiverBuyLocal.com](http://www.ForestRiverBuyLocal.com)

### Your XLR Nitro Dealer

Colton RV & Marine  
3122 Niagara Falls Blvd  
North Tonawanda, NY 14120  
(716) 694-0188  
[www.ColtonRV.com](http://www.ColtonRV.com)

Colton RV & Marine  
3443 Southwestern Blvd.  
Orchard Park, NY 14127  
(716) 957-3250  
[www.Coltonrv.com](http://www.Coltonrv.com)