

North Trail



Visit HEARTLAND on:



North Trail

CURVILINEAR ROOF



32 BUDS



27 BHDS

Spacious Living Rooms *Relax, Entertain and Unwind.*

You will appreciate the open design of North Trail's layouts that give your whole family room to relax and enjoy your stay away from home. Oversized windows let in lots of natural light and offer spectacular views of the outdoors.



27 BHDS

North Trail

Chef's Kitchen

For the chef in the family

While large kitchens like this are typically reserved for luxury coaches in a much higher price range, this NORTH TRAIL model provides an efficient wide-open prep area, as well as large base cabinet and overhead storage for that extended vacation. Our three burner range with oven and microwave make meals a snap and the huge residential double sink makes cleanup a breeze.



Dinette

Dinner for Four or More.

Enjoy our freestanding table and chairs or the traditional booth style dinette with a table that you can take outside to your patio. For parties of six choose one of our models that feature the Mega-Booth dinette.



Bedroom Suite

Comfort and Convenience

Comfortable sleep is half the point of taking a vacation and North Trail delivers. Our bedrooms feature queen size beds with room to walk around, night stands and reading lights. Get a good nights rest in a North Trail for the exciting day ahead.



Curvilinear Roof

Inside, the arched ceiling increases headroom for a roomy, more open feel. Outside, the curved roof sheds water and debris easily eliminating puddling

LED Lighting

Brighter, more efficient and longer lasting than traditional incandescent lighting. Awning LED light strip illuminates your patio long into the night.



Power Awning

Quick and easy setup and adjusting.

Covered LP Tanks

Protect your tanks and have easy access to the valves without removing the cover.

Large Grab Handle

Assists you going in or out - Safety first.

Camp Kitchen

Everything you need to entertain family and friends on the patio.

Strong Safety Glass

Tinted safety glass protects against harmful UV rays and stray baseballs.

Innovative Rain Gutters

Channel rain water away helping to reduce unsightly stains on sidewalls.



Large Pass Through Storage with Thick Insulated Doors

Easily store larger items such as this cooler or long fishing poles. Thick, insulated compartment doors and rubber seals protect your cargo.

Wide Trax

Virtually glide over bumps and holes in the road with Wide Trax suspension.



Strength, Durability and Comfort BEYOND COMPARE!

These three laminated systems bring you the Strongest and Lightest construction available. Combined they also provide unparalleled thermal insulation, noise reduction and long term durability. Protecting your investment is important to HEARTLAND. Laminated construction provides that protection.

YOUR LAMINATED WORLD...



Laminated ROOF System

- **Seamless Rubber Roof Skin**
- **Wood Decking**
- **Block Foam Insulation**
- **Aluminum Ribs and Perimeter**
- **Decorative, Textured Ceiling Vinyl**

- **Lightweight Aluminum Structure**
- **Double Welded**
- **1½" Thick Block Foam Insulation**
- **Two Inches Thick Overall**
- **High Gloss Fiberglass Skin**



Laminated SIDEWALL System

A 1/8" thin coffee cup can protect your hand from scalding hot coffee - consider the protection Heartland's sidewalls offer featuring 1.5" block foam insulation



Laminated FLOOR System

- **Sturdy Aluminum Framing**
- **Thick Block Foam Insulation**
- **Seamless Decking on Top**
- **Thermo-Board Luan Underneath.**



Heartland's laminated floor construction easily supported over 1,800 lbs. of water jugs in one spot - resulting in less flex!!

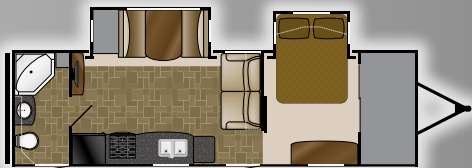

Length: 32' 6" Dry: 6,695 NT 26BRSS
Height: 11' 4" Hitch: 678 GVWR: 8,600

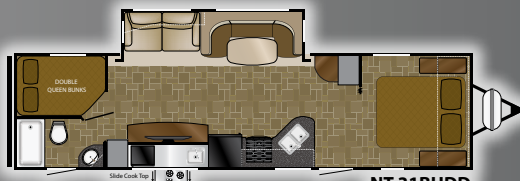

Length: 35' 11" Dry: 6,399 NT 31BHDD
Height: 11' 4" Hitch: 652 GVWR: 8,600

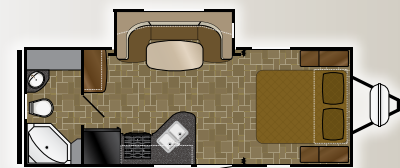

Length: 26' 6" Dry: 4,450 NT 21FBS
Height: 11' 2" Hitch: 390 GVWR: 6,900

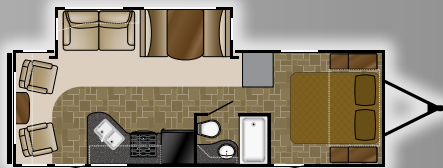

Length: 30' 2" Dry: 5,695 NT 26 LRSS
Height: 11' 4" Hitch: 572 GVWR: 8,600

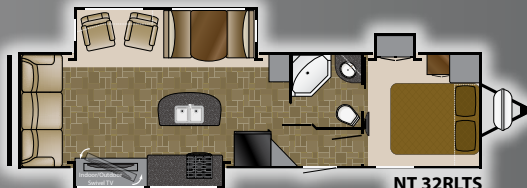

Length: 36' 8" Dry: 6,950 NT 32RLTS
Height: 11' 4" Hitch: 780 GVWR: 8,600

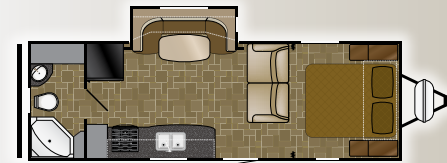

Length: 29' 7" Dry: 4,695 NT 22FBS
Height: 11' 2" Hitch: 325 GVWR: 6,900

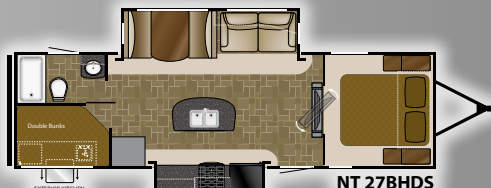

Length: 32' 8" Dry: 6,674 NT 27BHDS
Height: 11' 4" Hitch: 780 GVWR: 8,600

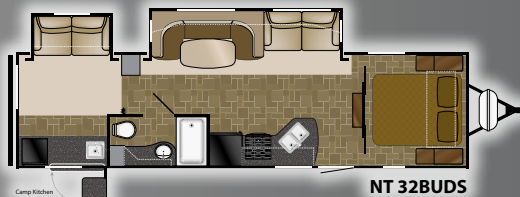

Length: 35' 10" Dry: 6,795 NT 32BUDS
Height: 11' 4" Hitch: 655 GVWR: 8,600

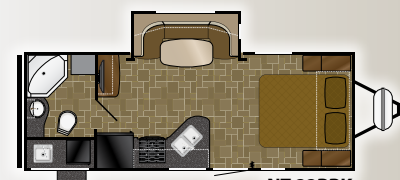

Length: 26' 4" Dry: 4,774 NT 22RBK
Height: 11' 2" Hitch: 440 GVWR: 6,900

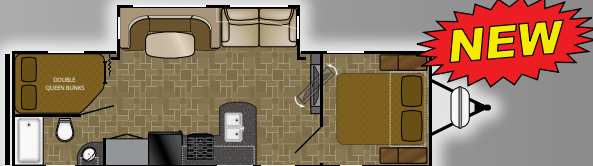

Length: 33' 6" Dry: 6,432 NT 28DBSS
Height: 11' 4" Hitch: 644 GVWR: 8,600

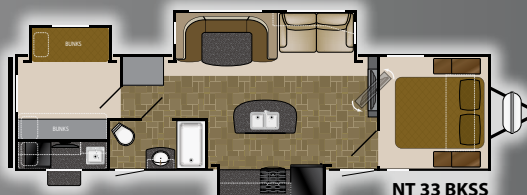

Length: 36' 10" Dry: 7,595 NT 33 BKSS
Height: 11' 4" Hitch: 695 GVWR: 9,600

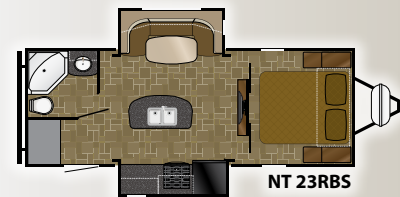

Length: 26' 11" Dry: 5,310 NT 23RBS
Height: 11' 2" Hitch: 625 GVWR: 6,900

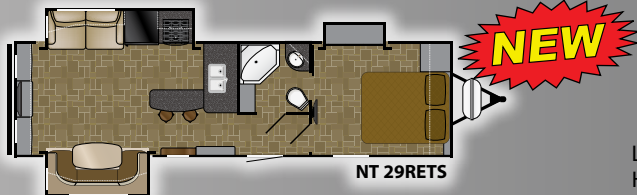

Length: 34' 9" Dry: 6,905 NT 29RETS
Height: 11' 4" Hitch: 725 GVWR: 8,600

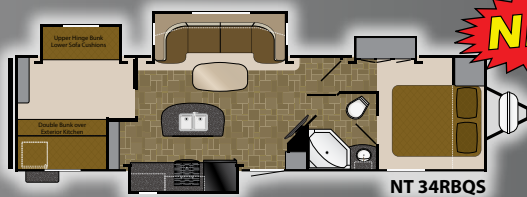

Length: 36' 9" Dry: 7,905 NT 34RBQS
Height: 11' 4" Hitch: 820 GVWR: 9,600

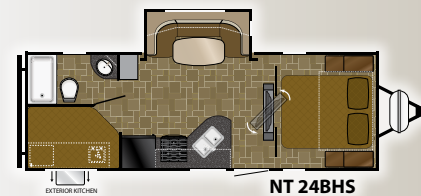

Length: 27' 11" Dry: 5,585 NT 24BHS
Height: 11' 2" Hitch: 550 GVWR: 6,900

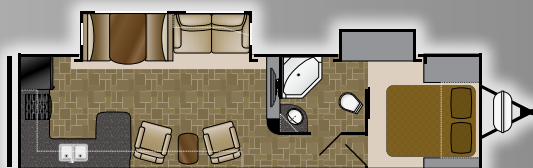

Length: 36' 9" Dry: 6,795 NT 30RKDD
Height: 11' 4" Hitch: 788 GVWR: 8,600

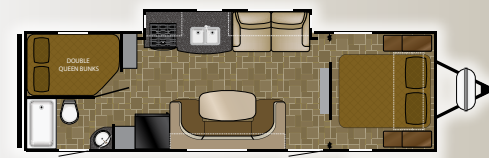

Length: 32' 0" Dry: 5,180 NT 28BRS
Height: 11' 2" Hitch: 482 GVWR: 6,900

STANDARDS & OPTIONS

INTERIOR

- Radius counter tops
- Smoke detector
- LP detector
- Fire extinguisher
- 8 ft. wide-body design
- Curvilinear roof
- Monitor panel in bathroom
- Cable TV prep
- Dual ducted 13.5 A/C
- AM/FM CD/DVD player
- Raised panel overhead cabinet doors
- TV antenna with booster
- Designer accent walls

KITCHEN

- Steel ball-bearing, full extension drawer guides
- Pull-out kitchen faucet
- Conventional oven
- Three-burner range
- Beauflor flooring
- Power range hood with light
- Double door refer
- Acrylic sink with covers

BATH AREA

- Shower skylight
- Tub surround with built-in shelves
- Hardwood medicine cabinet
- Bathroom power vent with wall switch

BEDROOM

- RV queen bed, foam
- Bedroom night stands
- Reading lights
- 120 Volt outlets on both night stands

EXTERIOR

- Slam latch baggage doors
- Heated and enclosed underbelly
- E-Z Lube hubs
- Four stab jacks
- 14" tires on lightweight trailers
- 15" on king slides
- Outside speakers
- Outside shower
- Exterior 120 Volt outlet
- Large assist entry handle
- One piece rubber roofing material
- Radial tires

FEATURES

- Diamond plate front rock guard

- 30,000 BTU furnace
- 6 DSI gas/electric water heater
- Fresh water 36 Gal
- Gray/Black 37 Gal
- Electric slide outs
- Black tank flush system

OPTIONS

- RVQ grill
- Aluminum wheels
- Power stability jacks
- 78" pillow-top mattress (most models)
- Free standing dinette (King slides)
- 15K BTU A/C
- ToyLok
- Power awning
- Black refrigerator door insert
- Painted front cap with stone guard
- LED HDTV
- Spare tire
- 50 Amp & 2nd A/C (some models)
- **Pearl package**
- **Caliber package**

NT KITCHEN PACKAGE

- Upgraded brushed nickel hardware
- Upgraded decorative glass inserts
- Removable dinette table (inside/outside) (most models)
- Large viewing window in kitchen
- Full extension ball bearing drawer guides
- Deep pantry with removable shelves (most models)

LIGHTWEIGHT STRENGTH PACKAGE

- Laminated crowned roof system
- Laminated floor
- Block foam brick insulation
- Aluminum construction (front, back, side walls, floor and roof)
- Enclosed and heated underbelly
- Radius double entry step
- Tinted safety glass windows
- 2" thick (R-7) sidewall construction
- Four stabilizer jacks with sand pads
- WIDE-TRAX axle placement
- HD leaf spring suspension
- Dual 20 lb. LP tanks
- Thermal tested

CALIBER Edition

Includes Everything on Standard North Trails Plus:

- Solid surface countertops
- Stainless steel deep 50/50 sink
- Porcelain foot flush toilet
- Hidden hinges
- LED HDTV
- Bumper pull-out bike rack
- Power awning
- Power jacks
- Spare tire

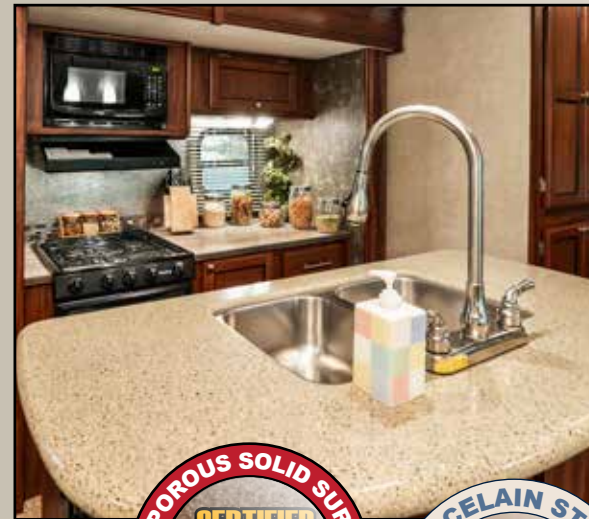



Heartland Recreational Vehicles
2831 Dexter Drive • Elkhart, IN 46514 • 574-262-5992

Community. Convenience. Close-to-home.

Where you purchase your recreational vehicle is ultimately your decision but Heartland urges you to consider buying at your local dealer. Dealers are part of your community, providing jobs and contributing to your local economy. These dealers are under obligation to provide warranty service for products they sell, but are not legally required to service products purchased from other dealers. At some point, you may need to return to the dealer you buy from - why not stay close to home? After all, home is where your Heartland is!

BENEFITS OF PURCHASING YOUR RV LOCALLY:

- You enjoy valuable relationship building with Dealer Representatives, close to your home, who will explain the features and benefits of the product.
- You receive a full product orientation prior to delivery, which includes hands-on directions for many of the coach's systems and functions. You are also introduced to the Dealership's Service/Parts/Warranty personnel who are at the ready to help you with any issues you may encounter, now and in the future.
- You enjoy customer PRIORITY. Dealerships generally service their purchasing customers first - others may experience long delays and miss opportunities to use their RV. What is it worth for you to have a dealership's full attention and motivation to satisfy you when you need service - in a timely manner?
- Valuable TAX dollars and jobs stay in YOUR community which pays for your roads, schools, police and fire departments.

DON'T UNDERESTIMATE CUSTOMER SERVICE AND PERSONAL CARE!

For Canadian Residents: If you purchase an RV out-of-country, there are additional fees, taxes and inspections that must be met before bringing your product home. Your local Canadian dealers are experts in these provisions.

Visit HEARTLAND on:



Your Authorized Heartland Dealer:

Colton RV
3122 Niagara Falls Blvd
North Tonawanda, NY 14120
(716) 694-0188
www.ColtonRV.com

Colton RV
3443 Southwestern Blvd.
Orchard Park, NY 14127
(716) 957-3250
www.Coltonrv.com

HEARTLAND PROUDLY PARTNERS WITH THE HIGHEST QUALITY VENDORS
in manufacturing our recreational vehicles:



North Trail

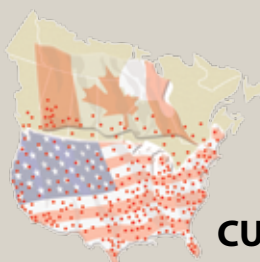

HEARTLAND CUSTOMER SERVICE WE'VE GOT YOUR BACK!

Over 40 men and women located in a dedicated facility servicing our customers every day. With a dealer network of over 400 locations across the U.S. and Canada, you're never far from an authorized Heartland dealer.

Product information is as accurate as possible as of the date of publication of this brochure. Due to Heartland's commitment to continuous product improvement - floorplans, materials, components, features, measurements, specifications, options, etc. are subject to change at any time without notice or obligation. In certain conditions some additional equipment may be needed. Photos may show optional equipment or props used for photography purposes only.

Heartland has listed the approximate base weight of the trailer without the option equipment included. Option equipment will impact the weight of the trailer. Please locate the weight sticker attached to the trailer you are considering for the most accurate trailer weight.

Tow Vehicle Caution: Owners of Heartland recreational vehicles are solely responsible for the selection and proper use of tow vehicles. All customers should consult with a motor vehicle manufacturer or their dealer concerning the purchase and use of suitable tow vehicles for Heartland products. Heartland disclaims any liability or damages suffered as a result of the selection, operation, use or misuse of a tow vehicle. Heartland's limited warranty does not cover damage to the recreational vehicle or the tow vehicle as a result of the selection of the tow vehicle.

Product information and specifications apply to coaches beginning with serial number 292025

www.HEARTLANDRVs.com



Experience:
Product Walk-Through Videos
Side By Side Comparisons
Feature Videos • Photo Galleries
Virtual 360° Tours
Detailed Floor Plans
News • Testimonials
Dealer Locator • Owners Club
Customer Service • Service Locator
and More at our Informative Web Site



FOR ADDITIONAL INFORMATION