

Class A Motorhomes | 2018

Precept • Alante



HANDS DOWN, THE BEST RIDE.

**2**  
**YEAR**  
WARRANTY



## Our Wings Get You There

Family fun happens when you spread your wings. Thanks to Jayco's amenity-packed floorplans, rock-solid construction and two full camping seasons, or 24,000 miles, of warranty coverage, you can. Greater peace of mind and added comfort mean better memories and lasting bonds. So go ahead. Hit the road—and let the good times fly.

## Generations of Family Fun



# PRECEPT

# *Alante*

## CLASS A MOTORHOMES

The lineup delivers an unmatched combination of performance and value. With industry-exclusive technology, premium ride and handling features, and oh-so-comfortable spaces, these coaches have something for every traveler.

### THE JAYCO DIFFERENCE

1. **120-inch panoramic windshield** equipped with oversized wiper blades allows for maximum visibility
2. **Exterior entertainment center** comes standard with an LED TV mounted on a swivel bracket
3. **One-piece fiberglass roof** offers unmatched durability
4. **Lockable pass-through storage** with easy-to-use Slam-latch™ doors
5. **Seatbelts in every seating position** secure the most precious cargo



## WE CARE ABOUT GETTING THERE AS MUCH AS BEING THERE

JRide® is a powerful blend of precise handling and renowned stability. Hands down, it's the best ride. **Experience JRide for yourself—visit your local dealer and take a test drive.**



### A PRECEPT STANDARD

J+

Precept:  
<https://www.jayco.com/products/class-a-motorhomes/2018-precept/jride-plus/>



### AN ALANTE STANDARD

J

Alante:  
<https://www.jayco.com/products/class-a-motorhomes/2018-alante/jride/>

\*Each model contains different JRide components. Visit Jayco.com for details.

J J+

#### COMPUTER-BALANCED DRIVESHAFT

Ensures smooth and efficient power transfer from the engine to the wheels

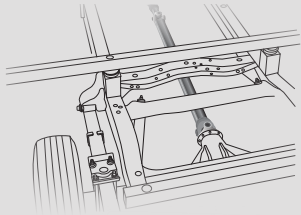

J J+

#### BOUNCE BUMPERS

Assist during extreme road occurrences to absorb impact and dampen excess road noise

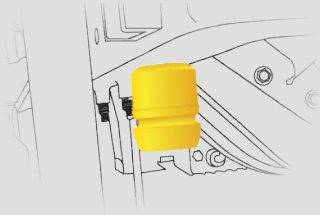

J J+

#### STABILIZER BAR(S)

Reduces the body roll of a vehicle during fast cornering or over road irregularities

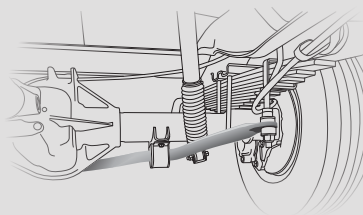

J J+

#### SACHS SHOCK ABSORBERS

Large-diameter tube design pairs gas and hydraulics to resist heat and pressure while independently adjusting to changing road conditions

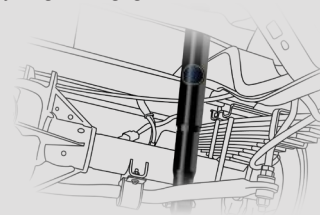

J+

#### HEAVY-DUTY FRONT STABILIZER BAR

A larger bar and polyurethane bushings, instead of rubber, transfer power faster for extra support, more stability and easier handling

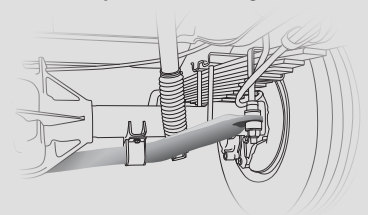

**GARMIN®**  
powered by **FUSION**



#### JAYCO-EXCLUSIVE GARMIN® INFOTAINMENT SYSTEM POWERED BY FUSION®

New for 2018 and exclusive to Jayco motorhomes, this easy-to-use, detachable touchscreen system delivers the convenience of connectivity, doubling as a custom RV navigation and four-zone AM/FM/Bluetooth®/USB entertainment system.





## PRECEPT FLOORPLANS

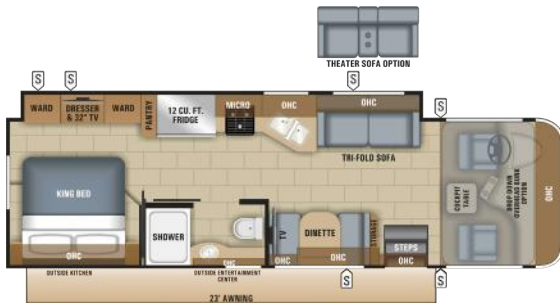

PRECEPT | 29V



PRECEPT | 31UL



PRECEPT | 33U

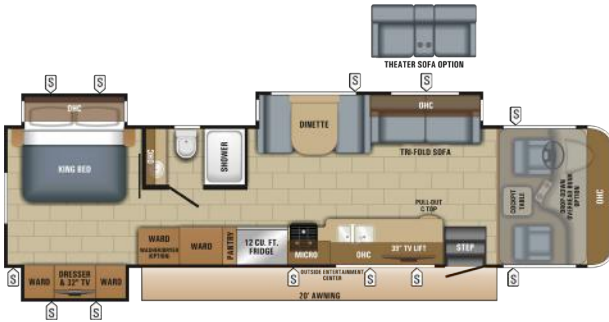

PRECEPT | 35S



PRECEPT | 36T

## PRECEPT EXTERIOR SELECTIONS



Graphics  
Sahara Dream



Premium Paint Option  
Desert Sky



Premium Paint Option  
Moon Bay



Premium Paint Option  
Summer Wood

## PRECEPT INTERIOR DÉCOR

### CHATEAU

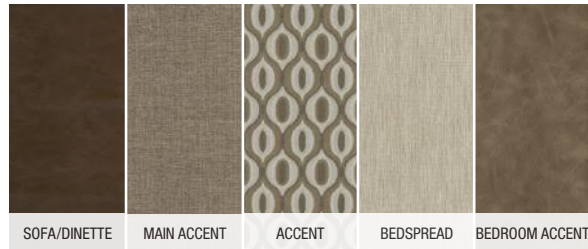

### MINERAL



## PRECEPT SPECS

MODELS	DIMENSIONS					TANKS (GALS.)		
FLOORPLAN	EXTERIOR LENGTH	EXTERIOR WIDTH	EXTERIOR HEIGHT (WITH A/C)	INTERIOR HEIGHT	WHEEL BASE	FRESH WATER CAPACITY (INCLUDES WATER HEATER)	GREY WASTE WATER CAPACITY	BLACK WASTE WATER CAPACITY
29V	32' 2"	101"	12' 7"	84"	190"	72	40 / 8.5	50
31UL	32' 11"	101"	12' 7"	84"	228"	72	40	50
33U	36' 3"	101"	12' 7"	84"	228"	72	40 / 31	51 / 31
35S	36' 7"	101"	12' 7"	84"	228"	72	40	50
36T	38' 2"	101"	12' 7"	84"	242"	72	40 / 40	51 / 51





FEATURED FLOORPLAN: 31R

## ALANTE

**FEATURE KEY:** 1. Hardwood cabinet doors 2. Roller shades 3. LED living room TV  
4. 3-burner range and oven with 9,000-BTU SuperBurner™ and piezo igniter



OPTIONAL DROP-DOWN BUNK WITH 750-POUND RATING



31V BEDROOM



26X COCKPIT



## ALANTE FLOORPLANS



ALANTE | 26X

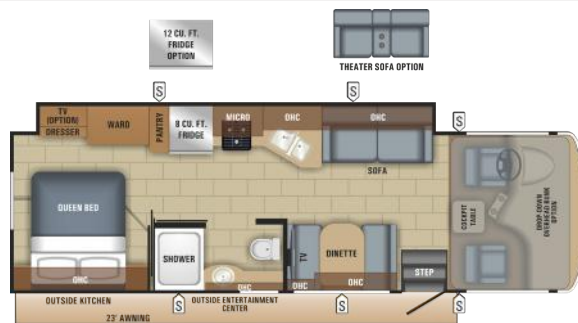

ALANTE | 29S



ALANTE | 31P



ALANTE | 31R



ALANTE | 31V

## ALANTE EXTERIOR



Sparkling Sand Graphics

## ALANTE INTERIOR DÉCOR

### ALBANY

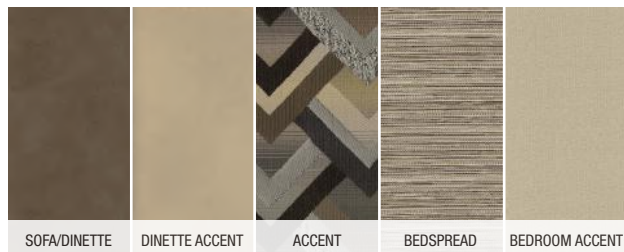

### CHAMBRAY



### NANTUCKET

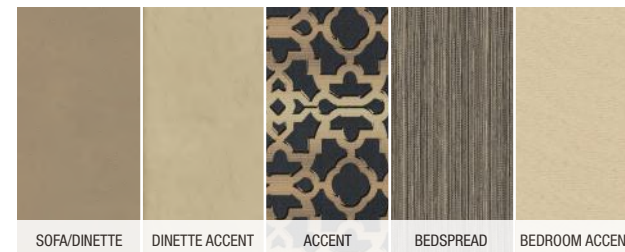

## ALANTE SPECS

MODELS		DIMENSIONS				TANKS (GALS.)		
FLOORPLAN	EXTERIOR LENGTH	EXTERIOR WIDTH	EXTERIOR HEIGHT (WITH A/C)	INTERIOR HEIGHT	WHEEL BASE	FRESH WATER CAPACITY (INCLUDES WATER HEATER)	GREY WASTE WATER CAPACITY	BLACK WASTE WATER CAPACITY
26X	27' 5"	101"	12' 5"	84"	158"	59	40	32
29S	31' 4"	101"	12' 5"	84"	190"	79	40 / 9	50
31P	31' 6"	101"	12' 5"	84"	191"	79	41	51
31R	34' 10"	101"	12' 5"	84"	228"	79	40	50
31V	31' 11"	101"	12' 5"	84"	190"	78	40	50

**Gross Vehicle Weight Rating (GVWR):** The maximum permissible weight of the motorhome, including the Unloaded Vehicle Weight (UUV) plus passengers, personal items, all cargo, fluids, options and dealer-installed accessories. The GVWR is equal to or greater than the sum of the UUV and the Cargo Carrying Capacity.

**Gross Combined Weight Rating (GCWR):** The maximum allowable combined weight of the motorhome used as a tow vehicle and the attached towed vehicle. It is important for your safety and enjoyment that you are aware of the weights and tow ratings of the RV you select. Consult a competent advisor for questions or advice.

Whether you are new to RVing or a veteran, get a feel for the performance of your RV before heading out on the roadways. When you tow a vehicle with your RV, you must drive differently than when you drive a single vehicle. Practice hooking up, driving, backing up and braking in a safe environment or seek out professional instruction. Jayco affixes a weight label to each RV which lists weight information for that vehicle. Refer to that label to verify the vehicle will meet your requirements.

## STANDARDS AND OPTIONS

### PRECEPT

#### CUSTOMER VALUE PACKAGE

JRide® Plus Package: Computer-balanced driveshaft, heavy-duty front stabilizer bar, standard rear stabilizer bar, jounce bumpers, SACHS shock absorbers
Automatic hydraulic leveling jacks
Jayco-exclusive Garmin® infotainment system powered by Fusion®
Backup and sideview cameras
Frameless windows
Electric patio awning with LED lights
Slideout cover awnings
Exterior entertainment center with LED TV mounted on swivel bracket and CD/DVD/AM/FM radio and speakers
Onan® Marquis Gold Genset 5,500-watt generator with auto-gen start
1000-watt inverter
50-amp electrical service
15,000-BTU A/C unit with heat pumps (2)
Truma AquaGo® on-demand water heater
Solid-surface kitchen countertops with integrated stainless steel sink
LED living room TV
Day/night roller shades
Driver/passenger cockpit table
<b>STANDARD EXTERIOR EQUIPMENT</b>
High-gloss fiberglass walls
One-piece fiberglass roof
Entrance door with industry's largest travel-view window
One-piece fiberglass front and rear cap
Bead-foam insulation (R-24 max roof, R-9 max floor, R-8 max walls)

Electric-powered entrance steps
Lockable pass-through storage compartments with easy-to-use Slam-latch™ doors
12V house battery
12V demand water pump
Theftford® Sani-Con® Turbo macerator system
120-inch panoramic windshield

#### STANDARD INTERIOR EQUIPMENT

Soft-touch vinyl ceiling
High-intensity, recessed LED ceiling lights
Ball-bearing drawer guides
3-burner range with 9,000-BTU SuperBurner™ and piezo igniter
Convection microwave oven
12-cubic-foot gas/electric refrigerator
Water filtration system
Dream Dinette™ mechanism, easily raises/lowers tabletop
Seatbelts in all seating positions
Soft-touch vinyl dash
31,000-BTU auto-ignition ducted furnace (31UL)
30,000-BTU auto-ignition ducted furnaces (2) (36T)
35,000-BTU auto-ignition ducted furnace (33U, 35S)
Prep for satellite dish
Cable TV hookup with RG-6 coax and video selector switch
Digital antenna with signal booster
Shower with surround, glass door, skylight and light
Stainless steel lavatory sink
One-piece fiberglass front and rear cap
Porcelain toilet with foot flush
Powered roof vent in bathroom with wall switch

Queen-size bed with under-bed storage (33U, 36T)
King-size bed with under-bed storage (29V, 31UL, 35S)
32-inch LED TV in bedroom
Bunk beds (300-pound rating) (36T)
Decorative kitchen backsplash
Entrance door with large frameless window and keyless entry

#### STANDARD DRIVING EQUIPMENT

Ford® F53 chassis:
6.8L Triton® V-10 320HP gas engine with electronic fuel injection and 460 lb.-ft. torque
6-speed automatic TorqShift® transmission with overdrive and tow-haul mode
130-amp alternator
56-pound, 16.5-gallon propane tank
12V chassis battery
Front and rear disc, 4-wheel anti-lock brakes
5,000-pound-rated rear hitch receiver with dual connector
7-pin plug
6-way power, swivel driver and passenger seats
Flush-mount LED marker lights
Third brake light

#### OPTIONS

Canadian standards
Premium Paint Options: Desert Sky, Moon Bay, Summer Wood
Drop-down overhead bunk in cab area with 750-pound capacity
Washer/dryer combination (33U, 35S, 36T)
Power theater seats (n/a in 33U)

### ALANTE

#### CUSTOMER VALUE PACKAGE

JRide Package: Computer-balanced driveshaft, jounce bumpers, standard front and rear stabilizer bars, SACHS shock absorbers
Jayco-exclusive Garmin infotainment system powered by Fusion
Backup and sideview cameras
Electric patio awning with LED lights
Slideout cover awnings
LED living room TV
Roller shades
One-piece fiberglass roof
Exterior entertainment center with LED TV mounted on swivel bracket and CD/DVD/AM/FM radio and speakers
1,000-watt inverter
Driver/passenger cockpit table

#### STANDARD EXTERIOR EQUIPMENT

Automatic hydraulic leveling jacks
White, high-gloss fiberglass walls
One-piece fiberglass front cap
Frameless windows
Entrance door with industry's largest travel-view window
Bead-foam insulation (R-24 max roof, R-9 max floor, R-8 max walls)
Electric-powered double entry step
Lockable pass-through storage compartments with easy-to-use Slam-latch doors
12V house battery
12V demand water pump
30-amp electrical service cord
4-inch tube bumper with sewer hose storage

Onan Marquis Gold Genset 4,000-watt generator
11,000-BTU A/Cs (2) (n/a on 26X)
15,000-BTU A/C (26X)
Energy Management System
Outside shower

#### STANDARD INTERIOR EQUIPMENT

Stainless steel sinks in kitchen and bathroom
High-intensity, recessed LED ceiling lights
Hardwood cabinet doors throughout
Ball-bearing drawer guides
3-burner range with oven, 9,000-BTU SuperBurner and piezo igniter
1.6-cubic-foot microwave
8-cubic-foot gas/electric refrigerator
Water filtration system
Seatbelts in all seating positions
31,000-BTU auto-ignition ducted furnace
Prep for satellite dish
Cable TV hookup with RG-6 coax and video selector switch
Digital antenna with signal booster
Shower with glass door, skylight and light
Toilet with foot flush
Bathroom powered roof vent with wall switch
Bedroom power vent (26X)
Full two-toned dash with grey burl accents
6-gallon gas/electric water heater
Linoleum flooring
Queen-size bed with bedspread
Decorative window valance
Bunk beds (300-pound rating) (31R)

#### STANDARD DRIVING EQUIPMENT

Ford F53 chassis:
16,000-pound GVWR (26X)
18,000-pound GVWR (29S, 31P, 31V)
20,500-pound GVWR (31R)
6.8L Triton V-10 320HP gas engine with electronic fuel injection and 460 lb.-ft. torque
6-speed automatic TorqShift transmission with overdrive and tow-haul mode
175-amp alternator
56-pound, 16.5-gallon propane tank
12V chassis battery
19.5-inch Goodyear® radial tires
Front and rear disc, 4-wheel anti-lock brakes
5,000-pound-rated rear hitch receiver with dual connector
7-pin plug
6-way power driver seat
LED marker lights
Third brake light
Power front shade

#### OPTIONS

Canadian standards
LED TV in bedroom
Drop-down overhead bunk in cab area with 750-pound capacity
12-cubic-foot gas/electric refrigerator (29S, 31P, 31R)
Theater seats (n/a in 26X, 31R)



Generations of family fun.

Meet your Jayco Dealer

Colton RV  
North Tonawanda, NY 14120  
(716) 694-0188  
(800) 628-4889  
www.ColtonRV.com

Colton RV  
Orchard Park, NY 14127  
(716) 957-3250  
(800) 628-4889  
www.Coltonrv.com

We work hard—so you can play hard. From finding the perfect Jayco for your family to providing flexible financing options and full-service support, we're here to help.

Follow Jayco



Jayco, Inc. | P.O. Box 460 | Middlebury, IN 46540



See dealer for further information and prices. All information in this brochure and on www.jayco.com is the latest available at the time of publication approval. Jayco reserves the right to make changes and to discontinue models without notice or obligation. Photography may show optional equipment or props used for decoration purposes only. RVs built for sale in Canada may differ to conform to Canadian codes. JAYCO and the JAYCO BIRD IN FLIGHT are registered trademarks of Jayco, Inc. Printed in USA 50K 11/17 ©2017 Jayco, Inc. 274785

### Travel with Confidence



At Jayco, we build our RVs to handle every adventure, then back them with our industry-leading 2-year limited warranty. We, with support from our select partners, have you covered for **2 camping seasons or twenty-four thousand (24,000) miles** (mileage limitation applies to motorized products only), whichever occurs first, from the original date of purchase. You won't find a better warranty in the business, because the only strings we attach are those that deliver the ultimate in reliability. That's the Jayco difference. So go explore. We have the warranty that will follow you. For a copy of our 2-year limited warranty with complete terms and conditions, please contact your local Jayco dealer.



A year's access to Coach-Net™—the country's largest RV emergency road service.



Jayco's long-term commitment to generations of family fun

After six years of increased efforts to eliminate waste, conserve energy and increase recycling, we've come a long way in building RVs that are not only better for your family—but also better for the planet.

Learn more at [Jayco.com/EcoAdvantage](http://Jayco.com/EcoAdvantage)