

RANGE LITE

2025 TRAVEL TRAILERS



43.8901° N, 102.2548° W
Pennington County, South Dakota



Travel Freely





2025 Range Lite 225CK

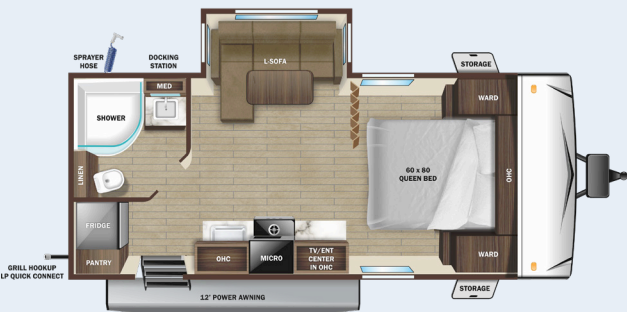

212FB A
OPTION

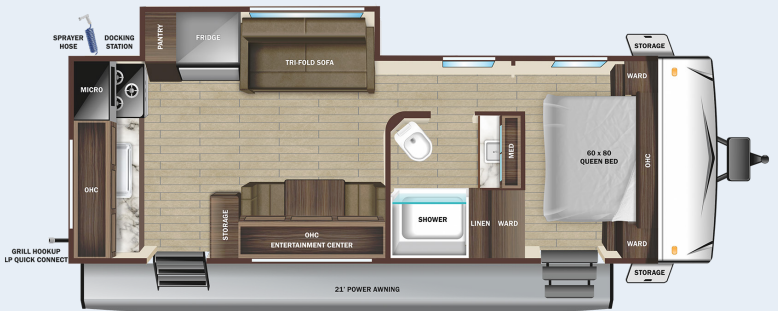

233ML A, B & C
OPTIONS



189RG A
OPTION

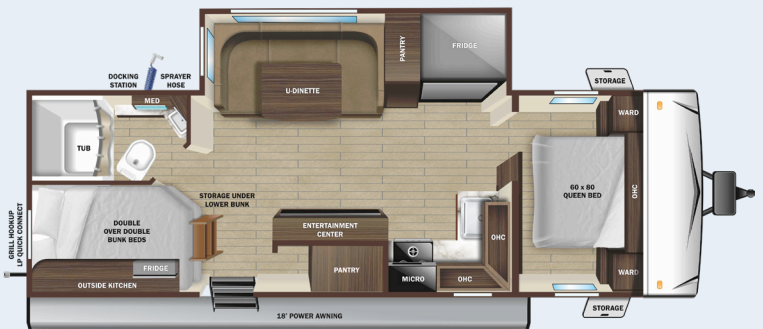

241BH B & C
OPTIONS



225CK A
OPTIONS



261BH A, B & C
OPTIONS



252RB A, B & C
OPTIONS

RANGE LITE

FLOORPLAN OPTIONS

A

Theater Seat

B

Table & Chairs

C

Table & Chairs/Bench

STANDARD INTERIOR EQUIPMENT

- » 10 cu. ft. 12V refrigerator
- » 5G antenna
- » 60" x 80" residential queen bed with storage below
- » 75 lb. ball bearing drawer guides
- » 81" interior height
- » Cable and satellite prep
- » Electrical outlets and USB ports in master bedroom
- » Flush floor slides with residential vinyl flooring
- » Hardwood cabinet doors
- » Hidden hinge cabinet door hinges
- » Kitchen sink covers
- » LED interior lighting
- » Magnetic cabinet door catches
- » Medicine cabinet
- » Powered 12V bathroom vent
- » Range hood
- » Residential high-rise faucet
- » Roller blackout night shades
- » Soft closing foot flush toilet
- » Stainless steel single basin under-mount kitchen sink
- » Tri-fold sofa (select models)

STANDARD EXTERIOR EQUIPMENT

- » 5/8" main floor decking
- » Door side spray port
- » Exterior grill/griddle quick connect port
- » Flexible LP lines
- » Foldable grab handle
- » Fully-walkable roof
- » In-frame battery rack
- » Magnetic baggage door catches
- » Oversized pass-through storage with motion lighting
- » PVC roofing membrane (limited lifetime warranty)
- » Rain guttering with molded drip spouts
- » Rear observation camera prep
- » Safety bumper with drain hose carrier and end caps
- » Self-adjusting electric brakes

- » Side camera prep marker lights
- » Solid swing-down entry steps
- » Thermal Seal- enclosed, insulated and heated underbelly with fully insulated roof with a PVC roofing membrane
- » Tinted safety-glass windows throughout
- » TuffShell™ - vacuum bonded laminated construction, reinforced with heavy-duty fiberglass and welded aluminum frames
- » Xtend Solar I Package (200 watt solar panel with 30 amp solar controller)

CUSTOMER CONVENIENCE PACKAGE (MANDATORY)

- » 15,000 BTU roof mounted A/C
- » 2-30 lb. LP bottles
- » 3-burner range with 17" oven and flush mount glass cover
- » Dome style digital TV antenna with Wi-Fi prep
- » Enclosed exterior docking station with black tank flush
- » EZ-store detachable cord
- » Friction hinge entrance door with window and shade prep
- » Gas/electric water heater
- » Microwave
- » Nitrogen filled radial tires with aluminum rims
- » Pop up wireless and USB charger in bedroom
- » Power awning with LED lighting
- » Power tongue jack
- » Pressed membrane countertops
- » Rear roof access ladder
- » Smart entertainment HDTV with Bluetooth®, soundbar and built in stereo

OPTIONS

- » 17" Griddle with bumper bracket
- » 50 amp service with 2nd A/C
- » Electric stabilizer jacks
- » Free standing table with 2 chairs and bench (N/A 189RG, 212FB, 233ML, 225CK)
- » Free standing table with 4 chairs (N/A 189RG, 212FB, 233ML, 225CK)
- » Theater seating ipo L-sofa (189RG, 212FB)
- » Theater seating ipo tri-fold sofa (N/A 241BH)
- » Wi-Fi router
- » Xtend Solar II Package (2-200 watt solar panels with 30 amp solar controller and 1800 watt inverter) (Replaces standard Xtend Solar I Package)

SPECIFICATIONS

May Include Estimated Values

	212FB	189RG	225CK	233ML	241BH	261BH	252RB**
Unloaded Vehicle Weight (lbs.)	4,840	5,035	5,120	5,880	5,930	6,050	6,215
Dry Hitch Weight (lbs.)	480	6,400	485	570	625	800	705
Gross Vehicle Weight Rating (GVWR)	6,400	6,500	6,600	7,250	7,500	7,600	7,600
Cargo (Gross)	1,560	1,465	1,480	1,370	1,670	1,550	1,385
Exterior Length (Overall)	23' 3"	25' 2"	27' 4"	29' 7"	29' 8"	30' 5"	30' 9"
Exterior Height	10' 4"	10' 5"	10' 5"	10' 5"	10' 4"	10' 4"	10' 5"
Exterior Width	8' 1"	8' 1"	8' 1"	8' 3/4"	8'	8' 1"	8' 3/4"
Exterior Width (Slides Out)	11' 3"	11' 4"	9' 11"	11' 3"	11' 2"	11' 3"	11' 3"
Interior Height	6' 9"	6' 9"	6' 10"	6' 10"	6' 5"	6' 9"	6' 10"
Fresh Water Capacity (Gal.)*	51	51	51	51	51	51	51
Gray Waste Water Capacity (Gal.)	29	29	29	58	58	29	58
Black Waste Water Capacity (Gal.)	29	29	29	29	29	29	29
LP Capacity (lbs.)	60	60	60	60	60	60	60
Tire Size	14"	14"	14"	14"	14"	14"	14"
Awning Size	12'	16'	19'	21'	18'	20' 6"	20'

*Includes Water Heater

LOCAL DEALER INFO

Colton RV & Marine
3122 Niagara Falls Blvd.
North Tonawanda, NY 14120
(716) 694-0188
www.ColtonRV.com

Colton RV
489 Bushkill Plaza LN #9665
Wind Gap, PA 18091
(610) 863-5239
www.ColtonRV.com

TO LEARN MORE VISIT
openrangerv.com

Highland Ridge RV – Part of the Jayco Family of Companies



Highland
RIDGE RV

Own the Outdoors

Due to continual research and advances, manufacturer reserves the right to change specifications, design, price, and equipment without notice, and assumes no responsibility for any error in the literature. Some items shown are not included as standard or optional equipment.