

# Pursuit

## Precision

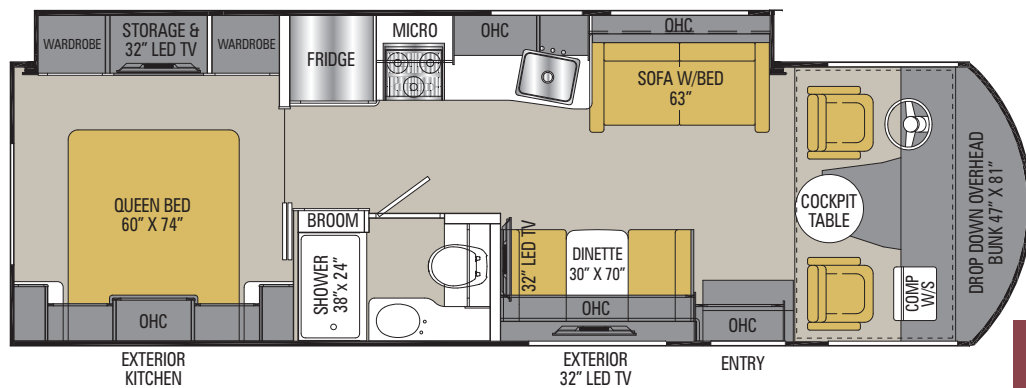

**29SS**

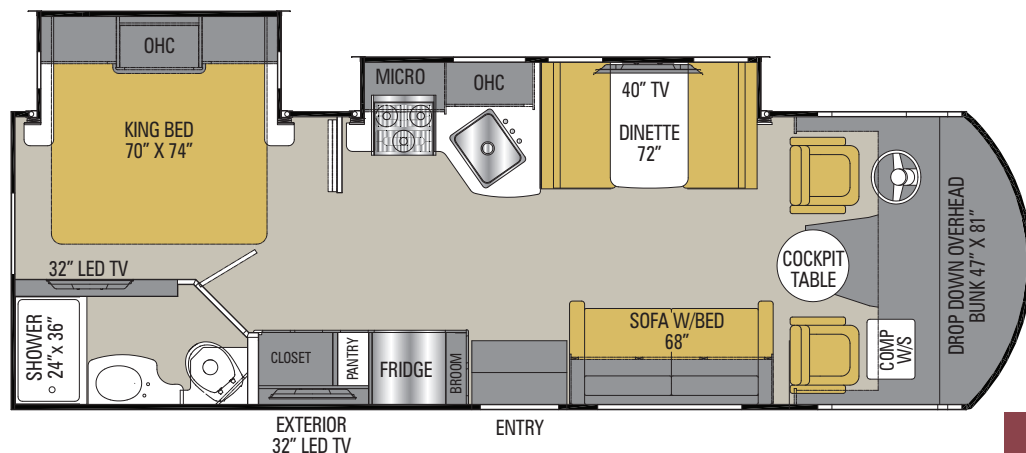

**27DS**



**Coachmen®**  
Recreational Vehicles

Colton RV  
North Tonawanda, NY 14120  
(716) 694-0188  
(800) 628-4889  
[www.ColtonRV.com](http://www.ColtonRV.com)

Colton RV  
Orchard Park, NY 14127  
(716) 957-3250  
(800) 628-4889  
[www.ColtonRV.com](http://www.ColtonRV.com)

# STANDARD FEATURES

## INTERIOR APPOINTMENTS

Power Drop-Down Front Bunk  
Self Closing Ball Bearing Drawer Guides Throughout  
Thermofoil countertops throughout  
Beau Flor  
High Gloss wood Grain  
Brushed Nickel Hardware  
Hardwood Cab Doors / flat panel  
Frameless Tinted Windows w/ Safety Glass  
Lower Floor & Upper Entrance Door Safety Windows  
Reclining / Swivel Pilot Seats  
Soft Touch Jackknife Sofa  
Privacy Roller Shades Coach  
Dream Booth Dinette  
Round Cockpit Pedestal Table  
Easy Clean Cockpit floor

## INTERIOR EQUIPMENT

Radio AM/FM/Blue Tooth  
Satellite Prep wire to roof  
Exterior Cable TV Jack  
LP Leak Alarm and Smoke Detector  
Carbon Monoxide Detector  
Fire Extinguisher  
King Jack TV Antenna  
32" LED TV Coach  
DVD Player in Living room  
Broom Closet  
Mud Room at Stepwell  
Charging Station for Electronic Devices  
Bedroom Radio AM/FM/Blue Tooth w/ Outside Speakers  
Fantastic Vent W/ Shroud in Bedroom & Coach (27SD)  
Fantastic Vent W/ Shroud in Coach (29SS)

## GALLEY

Range Hood W/ Light  
Flush Mount, Double Door Refer  
High Rise Kitchen Faucet  
Stainless Steel Kitchen Sink  
3-Burner Range  
Microwave Oven  
Tile Backsplash  
Range Cover  
Trash Can

## SLEEPING

Queen Bed 60W X 75L (29SS)  
King Bed 72W X 76L (27DS)  
Serta Mattress (29SS)  
Denver Mattress (27DS)  
Designer Headboard  
32" LED TV Bedroom

## BATH AND WATER

Porcelain Toilet w/Foot Flush  
One Piece ABS shower Surround  
Upgrade Shower Curtain  
Power Bath Vent  
6-Gallon (Gas/ELEC) D.S.I. Water Heater  
Demand Water Pump  
Skylight Over the Shower  
Stainless Lav Sink  
Outside Shower  
Black Tank Flush

## ELECTRICAL//HEATING/AC

### 29SS

50 Amp Package (includes)  
50 Amp Power Cord  
5.5 KW Onan Generator  
Two 13,500 BTU Air Conditioner Ducted

### 27DS

30Amp Package (includes)  
30' -30amp Power Cord  
4.0 Generator Onan Generator  
One 15,000 BTU Air Conditioner Ducted

Automatic Transfer Switch  
55 amp Converter w/ Distribution Panel  
GFI Circuit  
Outside Receipt  
Emergency Start Switch  
30,000 BTU E.I. Furnace  
Duel 12V Coach Batteries  
Coach Command Center  
Heated Holding Tank Compartment  
LED Interior Lights  
**Exterior Kitchen Includes: (29SS)**  
Refrigerator, Sink & Portable Gas Grill, Gas Grill  
Stand & Propane Hose & Hook-Up

## AUTOMOTIVE/EXTERIOR

Travel Easy Roadside Assistance (Coach-Net)  
18,000# Ford Chassis (29SS)  
16,000# Ford Chassis (27DS)  
Computer Work Station W/USB,12V,120V  
Tilt Steering Wheel  
Cruise Control  
Intermittent Wipers  
Dash Air Conditioning  
Cab Privacy Shades  
Back Up Monitor w/Side Cameras  
Radial Tires  
Rear Mud Flaps Only  
Power Entrance Step-Single  
Crowned, Laminated TPO Roof  
Radius Trunk Doors  
Fiberglass Front Cap  
Exterior LED Strip Light  
Dead Bolt Lock-Entrance Door  
26" Radius Entry Door  
Power Patio Awning  
8,000 Towing Hitch w/ 7 Way Plug  
Rear Mounted Roof Ladder  
Chrome Power Heated Mirrors  
Rear Bumper  
Stainless Steel Wheel Liners  
Slide-out room awning(s)  
20 Gallon LP Tank  
Valve stem extenders  
Noble Select Gelcoat High Gloss Sidewalls  
(with AZDEL SUPERLITE COMPOSITE)  
Outside Entertainment Center w/ 32" TV & DVD  
Automatic Leveling Jacks  
Exterior Kitchen (29SS Only)

## Interior Decor Color Selections

Desert Spice  
Scenic Swirl  
Copper Penny

## Interior Wood Color Selections

Estate Cherry  
Cappuccino Cherry

## Exterior Color Selections

Oyster Fiberglass W/ Mocha Frost Vinyl Graphics  
Oyster Fiberglass W/ Logan Berry Vinyl Graphics

# SECIFICATIONS

## 27DS

## 29SS

FORD GAS ENGINE V-10 6.8L 3-Valve

320 HP/46

TRQ 320 HP/460 TRQ

WHEEL BASE

178"

190"

GVWR

16,000 lbs.

18,000 lbs.

GCWR

23,000 lbs

23,000 lbs

FUEL CAPACITY

80 gal

80 gal

LP GAS CAPACITY (gallons)

20 gal

20 gal

FURNACE (BTUs)

30,000

30,000

EXTERIOR LENGTH (w/o ladder)

28' 9"

30' 3"

EXTERIOR HEIGHT (with AC)

12'

12'

EXTERIOR WIDTH

102"

102"

FRESH WATER

50 gal

50 gal

GREY WATER

76 gal

35 gal

BLACK WATER

38 gal

35 gal

WATER HEATER

6 gal

6 gal

AWNING SIZE

19'

20'