



DURANGO



Travel Trailers
Fifth Wheels



355BH



Beautiful cabinetry throughout, there is plenty of storage to accommodate everything you need to prepare your favorite meals.



Not only is there a private bunk room for the kids and their friends, its located at the opposite end of the master suite offering you plenty of privacy, and maybe a little quiet time too.

DURANGO

Reach New Heights

This year's Durango reaches new heights of excellence in comfort and design.

Explore a road you never dreamed of taking before and see where it leads you.



Dual entry bath and hallway, another KZ innovation that gives a residential feel to your Durango. The standard 26" LCD flat screen TV and optional fireplace enhance this interior.



The master suite is both plush and thoughtfully laid out, not compromising on any storage area, there's plenty.





305KS

The biggest decision you may be faced with is not wanting to leave. Durango offers enough room and comfort to stay a little, or maybe a lot longer.

This dining room features large windows and an elegant table, shown with designer chair option.



This great kitchen layout features plenty of cabinet storage, a standard 26" LCD TV and wood panel refrigerator doors. You'll appreciate the efficient use of space every time you step into your Durango.



The master suite is beautifully decorated. The color coordinated bedding, combined with the warm trim and cabinetry, invites you in even if it's not bedtime.





3557PX3

DURANGO LX

Answer the call of the wild
in your new Durango.



Standard 26" flat screen LCD TV on swivel arm is perfect for viewing from anywhere.



This kitchen offers a standard eight cubic foot refrigerator with adjacent pull out pantry.



The standard air bed hide-a-bed offers a comfortable place to rest as well as plenty of storage.



3557PX3



Stainless steel appliances, pull out pantry and island make food preparation and clean up a breeze. Shown with optional solid surface countertop.



Sometimes getting away really means getting away. Those times are perfect for the master suite, complete with mirror closet doors and wardrobe, or optional wood cabinet.



Spacious side bath with shower surround features the look of marble and a glass shower door.



DURANGO and DURANGO LX Features

Interior Features



Mirrored cabinet conceals unit's electronics control panel.



LP/CO/Smoke Detectors in all units.



Standard baskets to take goodies out to the campfire.



Easy access to central vac connection (optional) and electrical fuse panel.

Three Distinctive Interior Selections

Regal Décor



DURANGO Interior Décor Package

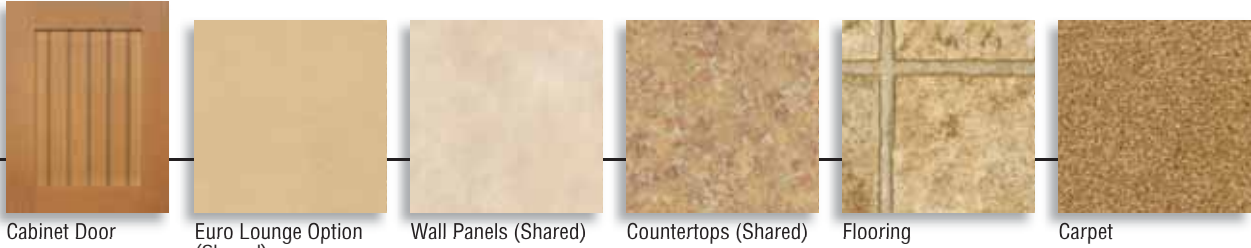

DURANGO LX Interior Décor Package



Cut-Away Features

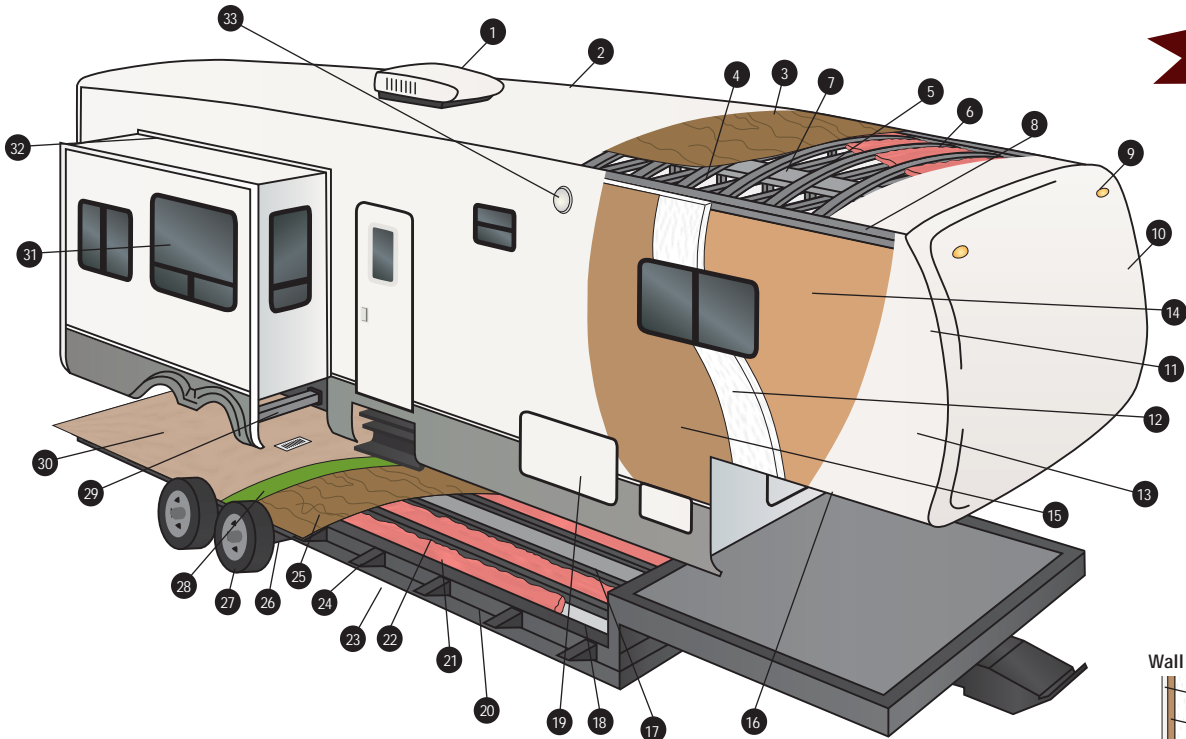

Total Aluminum Frame

- 1 13,500 BTU A/C (15,000 on LX)
- 2 TPO Vinyl Roof
- 3 3/8" Decking (fully walk on)
- 4 Vinyl Interior Ceiling Panel
- 5 4 1/2" Aluminum Truss Rafters, 16" O.C.
- 6 R-14 Batten Insulation (R21 with Flex Foil)
- 7 Insulated Ductwork
- 8 Heavy Duty Aluminum Headers
- 9 Exterior Clearance and Brake Lights
- 10 One-Piece Fiberglass Front Cap
- 11 Aluminum Frame Front and End Walls
- 12 Expanded Polystyrene - R11
- 13 Fiberglass Exterior with Integrated Luan Backing
- 14 1/8" Luan Decorative Wall Board
- 15 1/8" Luan Wall Board
- 16 3" Aluminum Stringer
- 17 Residential Style Ducted Heat Run in Floor
- 18 Darco® Moisture Barrier
- 19 Large Capacity Pass-Thru Exterior Storage with Radius Doors Front and Side for Easy Access
- 20 Heavy Duty I-Beam Frame Construction
- 21 R-7 Batten Insulation (R12 with Flex Foil)
- 22 2x3 Double Welded Aluminum Floor Joists, 16" O.C.
- 23 Heated & Enclosed Underbelly
- 24 Fully Welded Outriggers
- 25 5/8" Tongue and Groove Plywood
- 26 Heavy Duty Leaf Springs
- 27 Heavy Duty Steel Wheels with Trim Rings and Center Caps
- 28 Residential Style Carpet Pad
- 29 Rack and Pinion Electric Slide with Manual Override with 2x3 Box Tube Slide Out Ram
- 30 28 oz. Residential Carpet or Linoleum
- 31 Tinted Safety Glass Windows
- 32 Triple Sealed Slide Outs
- 33 Exterior Security/Scare Lights

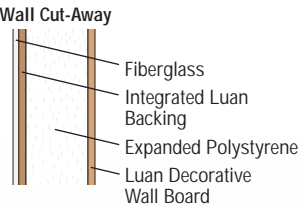

Exterior Features



Lots of storage



Enclosed utility center



Combo porch light and security light



Another KZ standard – newly designed drip rails and spouts keep the water flowing away from the sidewalls.



Because it Rains!
Here at KZ we know a little bit about camping, actually we know a lot about camping. One thing you can count on, it will rain. We randomly test our KZ campers from every product line in our state of the art rain booth. The rain may spoil your fun outside, but it won't inside.

DURANGO Floor Plans

Travel Trailers

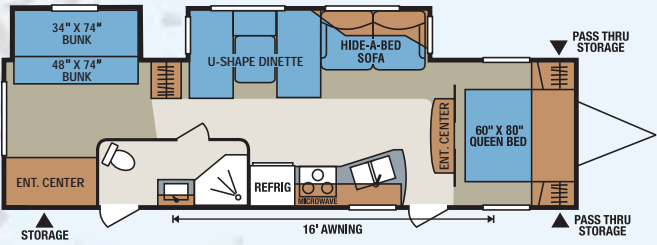

D320BH • UVW 7820 • Dry Hitch Wt. 787 • NCC 2180 • Length 35'6"

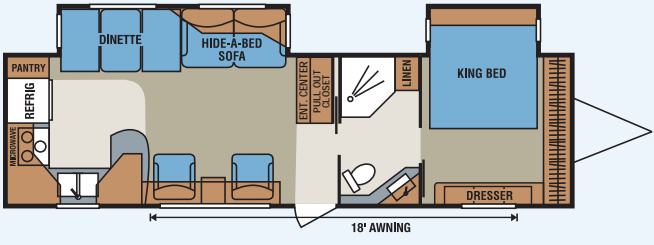

D321RK • UVW 8259 • Dry Hitch Wt. 1046 • NCC 1741 • Length 36'

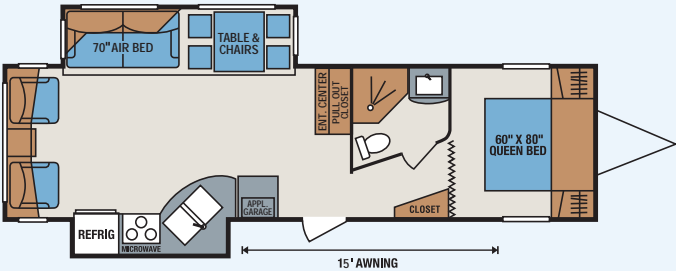

D326RL • UVW 7693 • Dry Hitch Wt. 690 • NCC 2307 • Length 34'4"

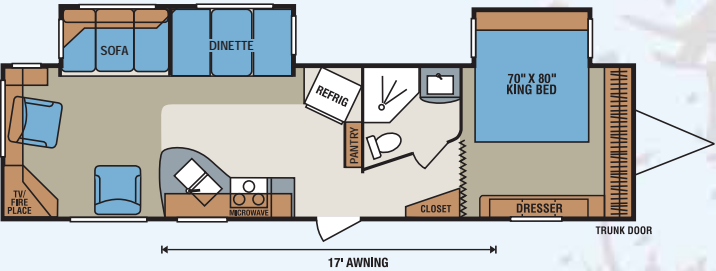

D330RE • UVW 8136 • Dry Hitch Wt. 1160 • NCC 2064 • Length 37'6"

Fifth Wheels

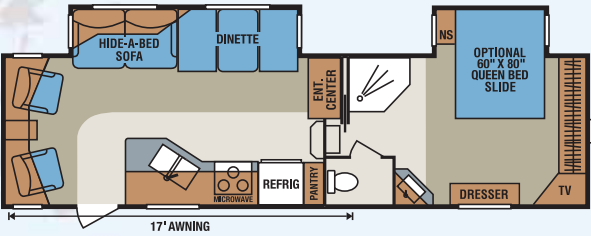

D285RL • UVW 8053 • Dry Hitch Wt. 1572 • NCC 2747 • Length 30'9"

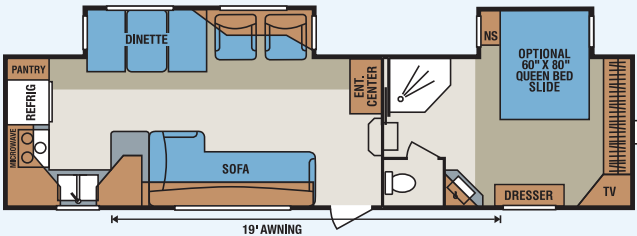

D315RK • UVW 8348 • Dry Hitch Wt. 1637 • NCC 2652 • Length 33'

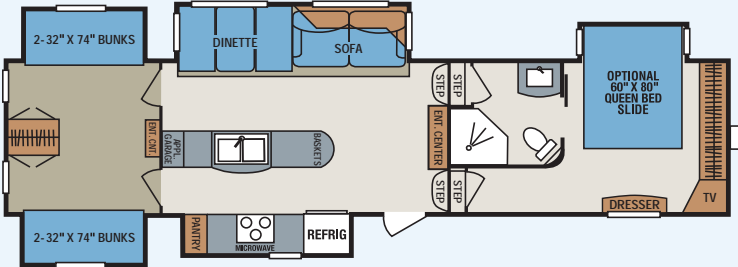

D355BH • UVW 11431 • Dry Hitch Wt. 1586 • NCC 1569 • Length 39'

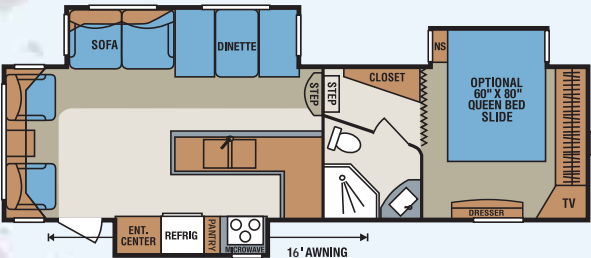

D305KS • UVW 9084 • Dry Hitch Wt. 1803 • NCC 1716 • Length 32'

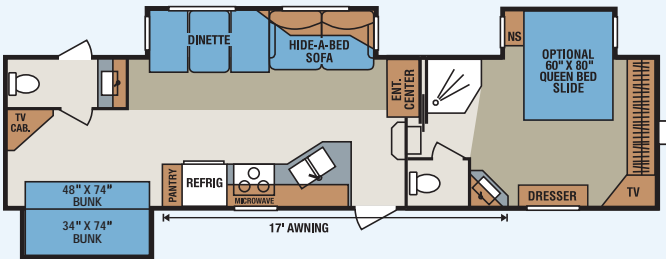

D325BH • UVW 9830 • Dry Hitch Wt. 1986 • NCC 3170 • Length 34'2"

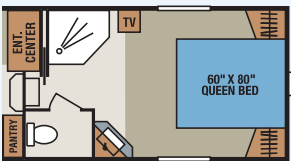

D285RL • Queen Bed Standard

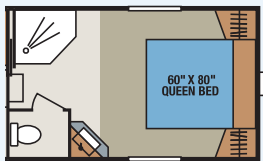

D315RK • Queen Bed Standard

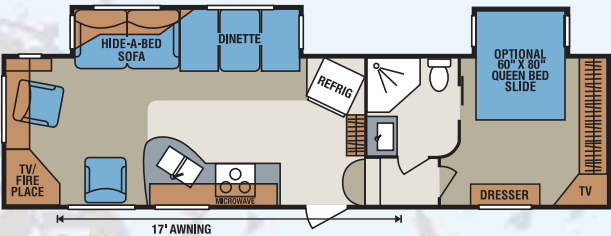

D305SB • UVW 8628 • Dry Hitch Wt. 1975 • NCC 2172 • Length 32'9"

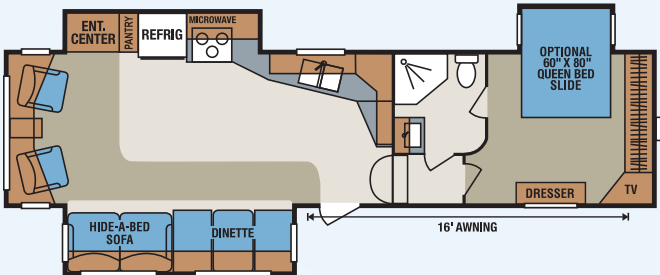

D325SB • UVW 9427 • Dry Hitch Wt. 1773 • NCC 3573 • Length 34'5"

Color Key:

- Carpet
- Cabinets
- Comfort Areas
- Countertops
- Linoleum



Adventure Awaits...
Answer the Call.

DURANGO

| | Fifth Wheels | | | | | | | Travel Trailers | | | |
|----------------------------------|--------------|--------|--------|--------|--------|--------|--------|-----------------|--------|--------|--------|
| | D285RL | D305KS | D305SB | D315RK | D325BH | D325SB | D355BH | D320BH | D321RK | D326RL | D330RE |
| UVW (Unloaded Vehicle Wt.) | 8053 | 9084 | 8628 | 8348 | 9830 | 9427 | 11431 | 7820 | 8259 | 7693 | 8136 |
| Dry Hitch Wt. | 1572 | 1803 | 1975 | 1637 | 1986 | 1773 | 1586 | 787 | 1046 | 690 | 1160 |
| Dry Axle Wt. | 6481 | 7281 | 6653 | 6711 | 7844 | 7654 | 9845 | 7033 | 7193 | 7003 | 6976 |
| NCC (Net Carrier Capacity) | 2747 | 1716 | 2172 | 2652 | 3170 | 3573 | 1569 | 2180 | 1741 | 2307 | 2064 |
| GVWR | 10800 | 10800 | 10800 | 11000 | 13000 | 13000 | 13000 | 10000 | 10000 | 10000 | 10200 |
| Exterior Height | 154" | 154" | 154" | 154" | 154" | 154" | 156" | 136" | 136" | 136" | 136" |
| Exterior Width | 96" | 96" | 96" | 96" | 96" | 96" | 96" | 96" | 96" | 96" | 96" |
| Exterior Length | 30'9" | 32' | 32'9" | 33' | 34'2" | 34'5" | 39' | 35'6" | 36' | 34'4" | 37'6" |
| Refrigerator (cu. feet) | 8 | 8 | 8 | 8 | 8 | 8 | 8 | 8 | 8 | 8 | 8 |
| Water Htr Cap. (gal. G/E w/ DSI) | 10 | 10 | 10 | 10 | 10 | 10 | 10 | 10 | 10 | 10 | 10 |
| Fresh Water Cap. (gal.) | 55 | 55 | 55 | 55 | 55 | 55 | 55 | 55 | 55 | 55 | 55 |
| Waste Water Cap. (gal.) | 50 | 50 | 40 | 50 | 50 | 40 | 40 | 40 | 40 | 40 | 40 |
| Gray Water Cap. (gal.) | 50 | 50 | 40 | 50 | 82 | 40 | 40 | 40 | 72 | 40 | 40 |
| LP Gas Cap. (lbs.) | 60 | 60 | 60 | 60 | 60 | 60 | 60 | 60 | 60 | 60 | 60 |
| Furnace BTUs (1,000's) | 30 | 30 | 30 | 30 | 30 | 30 | 30 | 30 | 30 | 30 | 30 |
| Tire Size | 15" | 15" | 15" | 15" | 15" | 16" | 16" | 15" | 15" | 15" | 15" |
| Awning | 17' | 17' | 17' | 19' | 17' | 16' | 17' | 16' | 18' | 14' | 17' |

Comfort Pack (FORCED OPTION)

- Equa-Flex Suspension
- Stabilizer Jacks
- Front Cap
- Awning
- Spare Tire & Hoist (FW)/Carrier (TT)
- Enclosed Pin Box (FW)
- Security Light on Door Side
- Skylight Over Tub
- Pillows for Sofa
- Wired for Satellite
- 6 Sided Aluminum Frame
- Heated Tanks and Enclosed Underbelly
- Tinted Safety Windows
- Black Tank Flush System
- Power Jacks (FW)

- 8 Cu. Refer w/Raised Panel Insert
- LCD TV
- Assist Grab Handle
- Night Shades
- AM/FM/CD/DVD Player with Surround Sound
- Air Bed Hide-A-Bed
- Stand Up Profile (FW)
- Porcelain Toilet
- Ceiling Fan (FW)
- 10 Gallon Gas/Electric DSI Water Heater
- Outside Speakers
- Riser Kit

Additional Options

- Bedroom Slide (Forced on 305KS, 305SB, 325BH, 325SB & 355BH)
- Central Vac
- Fireplace
- King Size Bed (N/A on 305SB, 325SB & 355 BH)
- Outside Grill
- Recliner 1 or 2
- One Piece Sectional Sofa
- Table & 4 Chairs
- Shur-Flo Fan w/ Remote
- Thermal Pane Windows */*

- 16" Tires w/12,000 lb. Axles (Forced on 325SB, 325BH & 355BH)
- Aluminum Wheels 4
- 50 Amp Service
- 2nd A/C 13,500 BTU in Bedroom
- Solid Wall w/Swing Door (325BH only)
- (Extra large)Countertop Extension
- Side Winder Hitch
- Flex Foil Insulation (R21 roof, R12 floor & R13 front and rear) */*
- Power Awning
- Ladder
- 15,000 BTU A/C

DURANGO LX

| | Fifth Wheels | | | | |
|----------------------------------|--------------|----------|----------|----------|----------|
| | D3255PX3 | D3354PX3 | D3551PX4 | D3556PX4 | D3557PX3 |
| UVW (Unloaded Vehicle Wt.) | 9644 | 9977 | 10110 | 10703 | 11712 |
| Dry Hitch Wt. | 1967 | 2023 | 1928 | 2022 | 2514 |
| Dry Axle Wt. | 7677 | 7954 | 8182 | 8681 | 9198 |
| NCC (Net Carrier Capacity) | 4156 | 3823 | 3690 | 3097 | 2088 |
| GVWR | 13800 | 13800 | 13800 | 13800 | 13800 |
| Exterior Height | 154" | 154" | 154" | 154" | 156" |
| Exterior Width | 96" | 96" | 96" | 96" | 96" |
| Exterior Length | 34'9" | 34'11" | 37' | 38'10" | 39' |
| Refrigerator (cu. feet) | 8 | 8 | 8 | 8 | 8 |
| Water Htr Cap. (gal. G/E w/ DSI) | 10 | 10 | 10 | 10 | 10 |
| Fresh Water Cap. (gal.) | 55 | 55 | 55 | 55 | 55 |
| Waste Water Cap. (gal.) | 40 | 40 | 50 | 80 | 50 |
| Gray Water Cap. (gal.) | 40 | 40 | 50 | 40 | 50 |
| LP Gas Cap. (lbs.) | 60 | 60 | 60 | 60 | 60 |
| Furnace BTUs (1,000's) | 30 | 30 | 30 | 30 | 30 |
| Tire Size | 16" | 16" | 16" | 16" | 16" |
| Awning | 16' | 19' | 17' | 19' | 17' |

Comfort Pack (FORCED OPTION)

- Equa-Flex Suspension
- Stabilizer Jacks
- Ladder
- Front Cap
- Awning
- Spare Tire & Hoist
- Enclosed Pin Box
- Security Light on Door Side
- Skylight Over Tub
- Pillows for Sofa
- Wired for Satellite
- Aluminum Wheels
- 6 Sided Aluminum Frame
- Heated Tanks & Enclosed Underbelly
- Tinted Safety Windows
- Black Tank Flush System
- Power Jacks
- 8 Cu. Refer
- Posterest Mattress
- LCD TV
- Assist Grab Handle

Additional Options

- Central Vac
- Fireplace
- King Size Bed (3551PX4)
- Outside Grill
- Thermal Pane Windows */*
- Shur-Flo Fan w/ Remote
- Plumb for Washer/Dryer (3354 PX3 & 3551PX3 w/o King Option)
- Side Winder Hitch
- Flex Foil Insulation (R21roof, R12 floor & R13 front and rear) */*
- Power Awning
- Solid Surface Countertops
- Rear Power Stabilizer Jacks
- Exterior Paint Package
- Exterior Folding Table

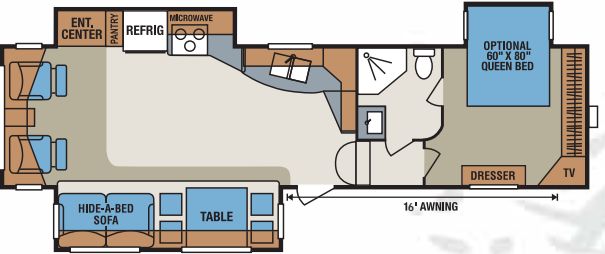

D3255PX3 • UVW 9644 • Dry Hitch Wt. 1967 • NCC 4156 • Length 34'9"

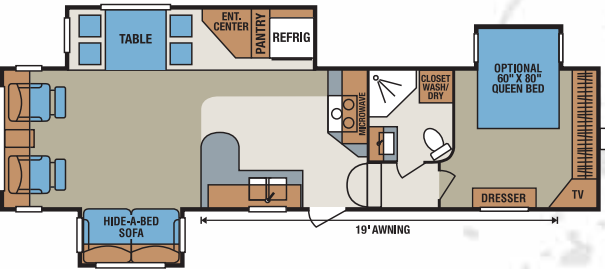

D3354PX3 • UVW 9977 • Dry Hitch Wt. 2023 • NCC 3823 • Length 34'11"

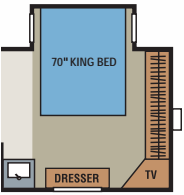

D3551PX4
King Bed Option

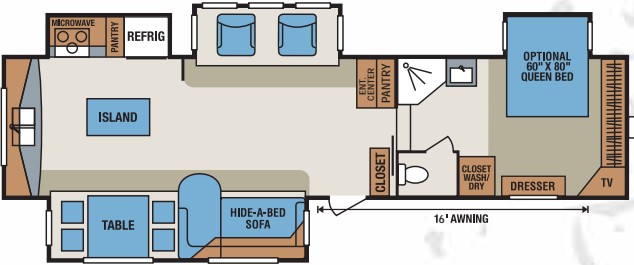

D3551PX4 • UVW 10110 • Dry Hitch Wt. 1928 • NCC 3690 • Length 37'

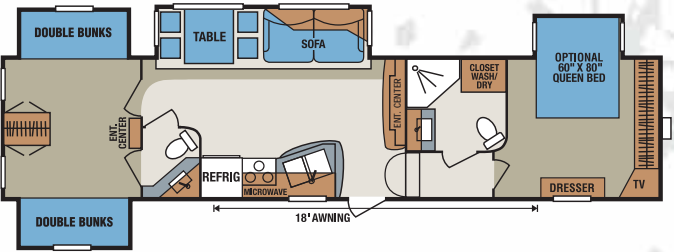

D3556PX4 • UVW 10703 • Dry Hitch Wt. 2022 • NCC 3097 • Length 38'10"

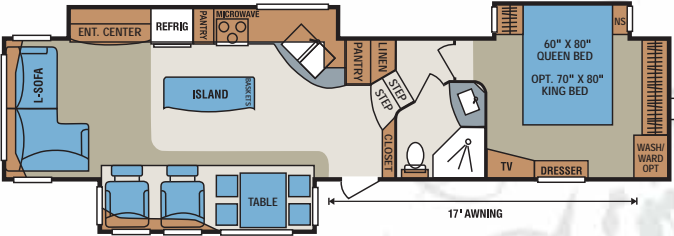

D3557PX3 • UVW 11712 • Dry Hitch Wt. 2514 • NCC 2088 • Length 39'

Color Key:

- Carpet
- Cabinets
- Comfort Areas
- Countertops
- Linoleum

/ We at KZ realize that you may travel within the northern and southern climates and added R value is not just a luxury but a necessary option for your comfort. So we decided to option the flex foil and thermal panel windows on the Durango.

2X2 WARRANTY – The KZ Recreational Vehicles 2x2 Warranty is a manufacturer's warranty. Each KZ product is warrantied to the original purchaser for twenty-four (24) months from the original date of purchase. Coverage includes appliances, components, construction and FULL structure. The appliances and other amenities are warranted by the individual manufacturers of those components, not KZ. Our warranty is also transferable within the first two (2) years for a small processing fee. For a copy of the warranty with full terms and conditions, ask your local KZ Dealer or visit our web site at <http://www.kz-rv.com>.

VEHICLE LOADING – Every effort has been made to provide the greatest number of options for the recreation vehicle owner. Each owner is responsible to select loads allowing the recreational vehicle to remain within the manufacturer's specified chassis weight limits. Do not overload the recreational vehicle.

UNLOADED VEHICLE WEIGHT (UVW) – The typical weight of this trailer as built at the factory. The UVW does not include cargo, LP gas, fresh water, options or dealer-installed accessories.

GROSS VEHICLE WEIGHT RATING (GVWR) – The maximum permissible weight of the trailer, including the UVW plus passengers, all cargo, personal items, fluids, options and dealer-installed accessories. The GVRW is equal to or greater than the sum of the UVW and the NCC.

NET CARRYING CAPACITY (NCC) – The maximum weight of all passengers, personal items, fresh water, food, tools, LP gas, other cargo and dealer-installed accessories* that can be carried by the trailer. NCC is equal to or less than GVWR minus UVW.

* The addition of options will decrease the NCC.

It is important for your safety and enjoyment that your tow vehicle be adequately sized and equipped to tow and handle the GVWR of the RV you select. Review weights and rating of your tow vehicle and consult a competent advisor for questions or advice. Whether you are new to RVing or a seasoned veteran, get a feel for the performance of your tow vehicle and the RV together before heading out on the roadways. When you tow an RV, you must drive differently than you do when driving a single vehicle. Practice hooking up, driving, backing up and braking in a safe environment or seek out professional instruction.

See specification chart. KZ affixes a weight label to each new RV which lists weight information for that vehicle.

NOTE: This information is intended as a guide only. Weights of individual vehicles are approximate. Consult your Owner's Manual for complete loading, weighing and towing instructions. All weights may vary.



Due to continual research and advances, manufacturer reserves the right to change specifications, design, price and equipment without notice, and assumes no responsibility for any error in this literature. Some items shown are not included as standard or optional equipment.
©2008KZ

9/1/08 50M



Dealer:

Colton RV & Marine
3122 Niagara Falls Blvd
North Tonawanda, NY 14120
(716) 694-0188
www.ColtonRV.com

Colton RV & Marine
3443 Southwestern Blvd.
Orchard Park, NY 14127
(716) 957-3250
www.Coltonrv.com