

Jayco | Jay Flight Travel Trailer

# JAY FLIGHT

#1 SELLING TRAVEL TRAILER FOR 15 YEARS



**2+3**  
YEAR | YEAR  
WARRANTY



# INTERIOR DESIGN



## CLASSIC COTTAGE



Wood



Floor



Countertop

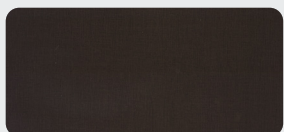

Main Fabric



Accent Fabrics

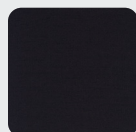

## MODERN FARMHOUSE

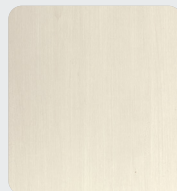

Wood



Floor

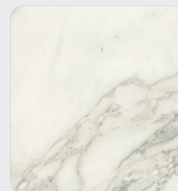

Countertop

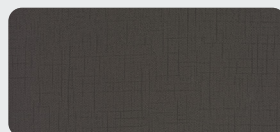

Main Fabric



Accent Fabrics

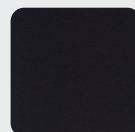

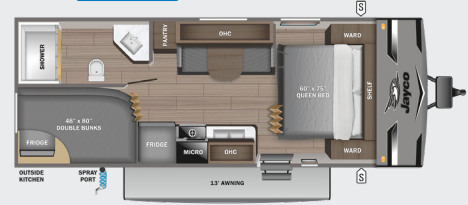
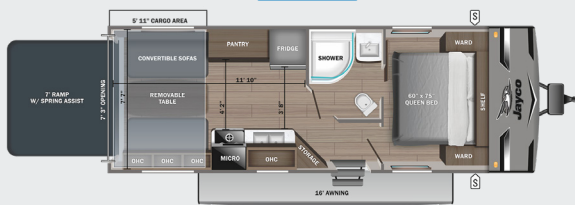

**212QB**

**224BH**

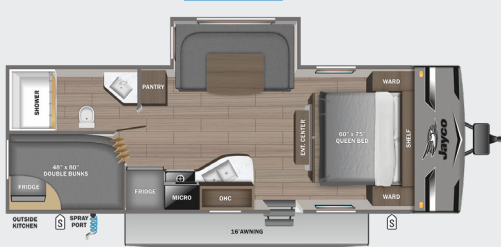
**236TH**

**240RBS**
**OPTION: A**

**242BHS**

**247RBS**

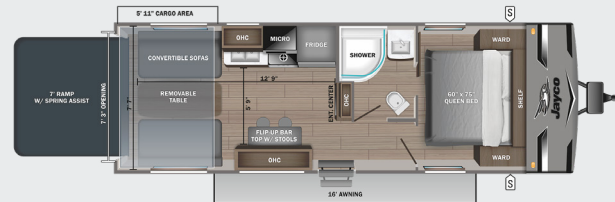
**263RBS**
**OPTION: A**

**264BH**
**OPTION: B**

**265RLS**
**OPTIONS: A, C**

**265TH**

## OPTIONS

-  **STORAGE**
- MICRO** MICROWAVE
- OHC** OVERHEAD CABINETS
- FRIDGE** REFRIGERATOR
- WARD** WARDROBE

**A**

**Tri-fold Sofa**
**B**

**Chil N' Stor**
**C**

**Theater Seat**

**267BHS**

OPTIONS: A, C

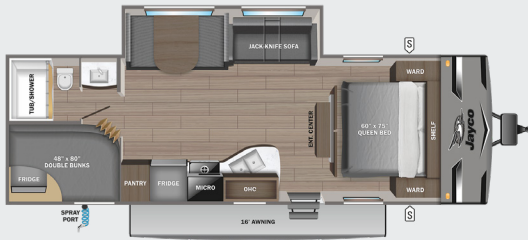

**274BH**

**280BHK**

OPTIONS: A, C

**280RKS**

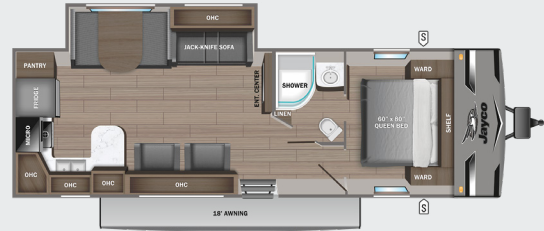
OPTIONS: A, C

**284BHS**

OPTIONS: A, C

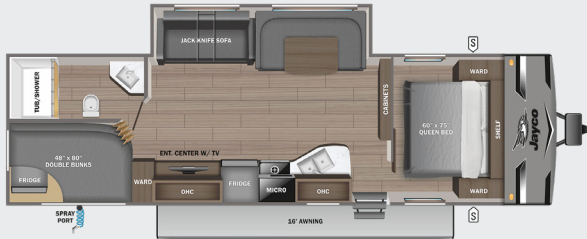
**285BHS**

OPTIONS: A, C

**2940BS**

OPTIONS: A, C

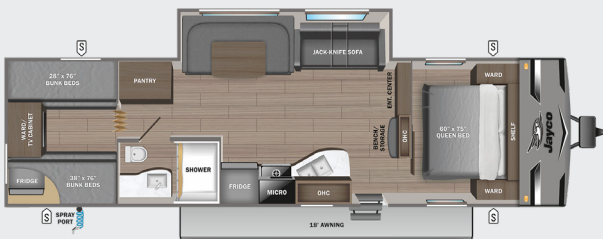
**295BHS**

OPTIONS: A, C

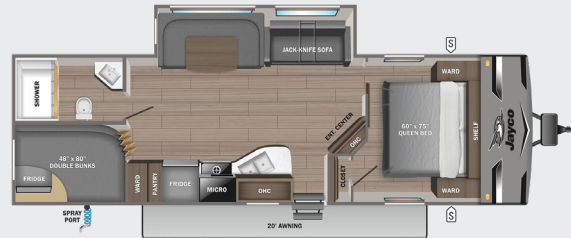
**324BDS**

OPTIONS: A, C

**OPTIONS**

**MICRO**
**OHC**
**FRIDGE**
**WARD**
**STORAGE**
**MICROWAVE**
**OVERHEAD CABINETS**
**REFRIGERATOR**
**WARDROBE**
**A**

Tri-fold Sofa

**B**



Chil N' Stor

**C**

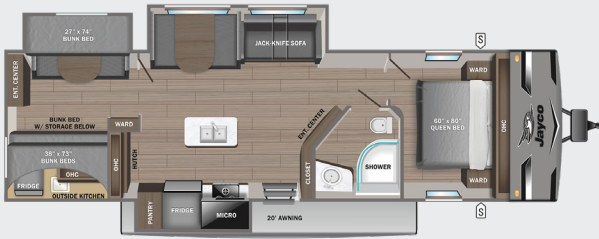

Theater Seat

**331BTS**

OPTIONS: A, C, D, F

**334RTS**

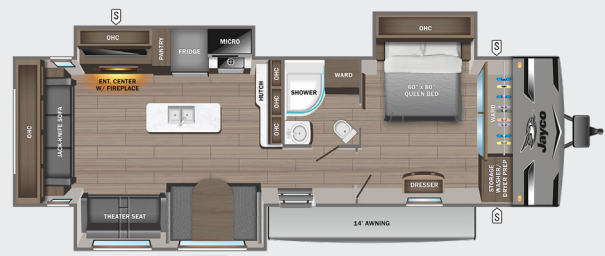
OPTIONS: A, E, F

**340RLK**

OPTIONS: A, E

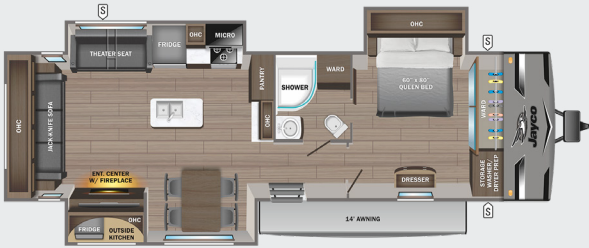
**380DQS**

OPTIONS: A, C, E

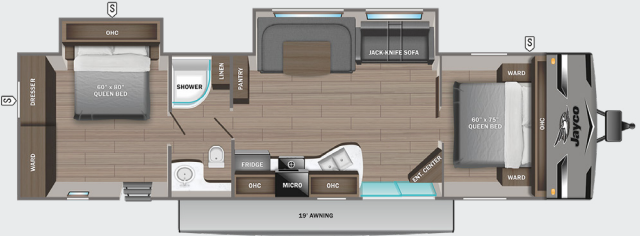
**OPTIONS**
**A**

Tri-fold Sofa

**B**

Chil N' Stor

**C**

Theater Seat

**D**

Jack-knife Sofa

**E**

King Bed

**F**

Table &amp; Chairs

\*Indicates split tanks

FLOORPLAN	EXTERIOR TRAVEL LENGTH	EXTERIOR WIDTH	EXTERIOR HEIGHT (WITH A/C)	INTERIOR HEIGHT	UNLOADED VEHICLE WEIGHT	DRY HITCH WEIGHT	GVWR	CARGO CARRYING CAPACITY	FRESH WATER CAPACITY (INCLUDING WATER HEATER)	GRAY WASTE WATER CAPACITY	BLACK WASTE WATER CAPACITY	SLEEPING CAPACITY
212QB	25' 8"	8' 0"	10' 7"	6' 9"	4,290	490	5,500	1,210	42	33	39	4-5
224BH	27' 1"	8' 0"	10' 7"	6' 9"	4,490	510	5,600	1,110	42	39	39	7-8
236TH	28' 4"	8' 0"	10' 6"	6' 9"	5,020	845	7,500	2,480	42	39	39	4
240RBS	27' 4"	8' 0"	10' 11"	6' 9"	5,465	620	6,750	1,285	38	78*	39	2-4
242BHS	29' 4"	8' 0"	11' 2"	6' 9"	5,490	770	7,000	1,510	38	39	39	6-8
247RBS	28' 10"	8' 0"	11' 1"	6' 9"	5,340	645	6,750	1,410	38	39	39	4-6
263RBS	30' 1"	8' 0"	11' 0"	6' 9"	6,075	720	7,500	1,425	38	78*	39	4-6
264BH	29' 5"	8' 0"	10' 6"	6' 9"	4,730	500	6,000	1,270	42	39	39	8-9
265RLS	31' 1"	8' 0"	11' 1"	6' 9"	6,010	735	7,150	1,140	38	39	39	4-6
265TH	30' 5"	8' 0"	10' 7"	6' 9"	5,240	845	7,500	2,260	42	39	39	4-6
267BHS	30' 4"	8' 0"	11' 2"	6' 9"	5,880	775	7,100	1,220	38	39	39	8-10
274BH	30' 7"	8' 0"	10' 6"	6' 9"	5,265	645	6,500	1,235	42	39	39	6-8
280BHK	34' 7"	8' 0"	11' 2"	6' 9"	6,650	735	8,250	1,600	38	78*	39	8-10
280RKS	33' 10"	8' 0"	11' 3"	6' 9"	6,495	810	8,150	1,655	38	78*	39	4-6
284BHS	33' 7"	8' 0"	11' 1"	6' 9"	6,265	815	7,600	1,335	38	39	39	8-10
285BHS	33' 4"	8' 0"	11' 2"	6' 9"	6,450	760	8,150	1,700	38	78*	39	8-10
294QBS	35' 7"	8' 0"	11' 3"	6' 9"	6,640	910	8,250	1,610	38	47.5*	39	8-14
295BHS	34' 4"	8' 0"	11' 3"	6' 9"	6,450	815	7,750	1,300	38	39	39	8-10
324BDS	35' 4"	8' 0"	11' 2"	6' 9"	7,665	970	9,000	1,335	40	41*	39	9-10
331BTS	37' 10"	8' 0"	11' 3"	6' 9"	TBD	1,215	11,350	2,380	40	78*	39	6-7
334RTS	37' 10"	8' 0"	11' 2"	6' 9"	8,590	1,130	10,250	2,860	40	71.5*	39	4-5
340RLK	37' 8"	8' 0"	11' 2"	6' 9"	TBD	1,325	11,250	2,470	40	71.5*	39	4-5
380DQS	40' 6"	8' 0"	11' 2"	6' 9"	TBD	1,045	10,750	2,600	40	80	39	4-6

Some specs at the time of print may include estimates. For the most updated information, please visit Jayco.com

# STANDARDS & OPTIONS

## EXTERIOR

20 lb. LP bottles with cover (2)  
 Enclosed underbelly  
 Axles with electric, self-adjusting brakes and easy-lube hubs  
 I-Class™ cambered structural steel I-beams  
 Fully integrated A-frame  
 5/8 in. tongue-and-groove plywood floor decking  
 Magnum Truss™ Roof system with plywood decking  
 Seamless one piece roof material  
 Large exterior downspouts  
 Galvanized steel, impact-resistant wheel wells  
 30-amp service  
 Front diamond plate  
 Rock Solid Stabilizer System  
 Exterior TV mount and bracket  
 LED exterior lighting  
 Friction hinge entry door with shade-prep window  
 G20 dark tinted safety-glass privacy windows  
 LP quick connect (outside gas grill prep)  
 Detachable power cord  
 Backup and side marker camera prep

## INTERIOR

81 in. ceiling height  
 8 cu. ft. 12V refrigerator  
 Shower/tub surround  
 Solid hardwood cabinet doors  
 LED interior lighting  
 J-Steel™ jack-knife sofa with armrest and cup holders (most models)  
 Vinyl flooring throughout (including slide floors)  
 Window shades  
 Smoked-glass cabinet door inserts (select models)

Residential-style kitchen countertops  
 3-burner range with glass cover  
 Oven with glass door and interior light  
 Heavy-duty, 75 lb., full-extension, steel ball-bearing drawer guides  
 Range hood  
 USB charging station  
 Queen mattress  
 Plywood bed platforms  
 Main bed struts  
 300 lb. rated bunk beds (select models)  
 600 lb. rated bunk beds (double bunks)  
 Privacy curtains in bunk areas (select models)  
 Vented bunk windows (select models)  
 4 in. thick bunk mats (select models)  
 Wooden bedroom doors (select models)  
 Shower curtain with curved shower track (select models)

## CUSTOMER VALUE PACKAGE (MANDATORY)

Black tank flush  
 Roof mounted solar prep  
 Large main entry door grab handle  
 Solid Step® entry steps (N/A 380DQS)  
 Tankless water heater  
 Cable/satellite TV hookup  
 Digital TV antenna  
 Goodyear® Endurance® tires (made in the USA)  
 Outside shower  
 Power tongue jack  
 Spare tire with cover  
 Water heater bypass  
 Power awning with LED lights  
 Marine grade exterior speakers  
 Keyed-Alike™ entry and baggage doors

Bathroom power vent  
 Bathroom skylight  
 Tub surround

## OPTIONS

15,000 BTU A/C  
 50-amp service  
 7 cu. ft. gas/electric refrigerator  
 Chil N' Stor (264BH)  
 Roof ladder (N/A 236TH, 265TH)  
 Wall-hugger theater seating (select models)  
 Overlander 1 Solar Package: (1) 200W solar panel and 30-amp digital controller  
 LED Smart TV (standard on 284BHS, 334RTS, 340RLK)  
 Hide-a-bed with tri-fold mattress (select models)  
 Outside griddle with bumper mount (select models)  
 Cargo accessory receiver (340RLK, 334RTS, 380DQS, 331BTS)  
 Fiberglass sidewalls (select models)  
 Rear sofa with folding bunk (331BTS)  
 2nd A/C in bedroom (340RLK, 334RTS, 380DQS, 331BTS)  
 Front bunks with dinette (380DQS)  
 King bed (340RLK, 334RTS, 380DQS)

## Meet your Jayco Dealer

Colton RV & Marine  
 3122 Niagara Falls Blvd.  
 North Tonawanda, NY 14120  
 (716) 694-0188  
[www.ColtonRV.com](http://www.ColtonRV.com)

Colton RV  
 489 Bushkill Plaza LN #9665  
 Wind Gap, PA 18091  
 (610) 863-5239  
[www.ColtonRV.com](http://www.ColtonRV.com)



Scan QR  
 code for  
 specification  
 definitions



Some specs at the time of print may include estimates.  
 For the most updated information, please visit  
[Jayco.com](http://Jayco.com)

**Jayco, Inc. | P.O. Box 460 | Middlebury, IN 46540**  
 See dealer for further information and prices. All information in this brochure and on [www.jayco.com](http://www.jayco.com) is the latest available at the time of publication approval. Jayco reserves the right to make changes and to discontinue models without notice or obligation. Photography may show optional equipment or props used for decoration purposes only. RVs built for sale in Canada may differ to conform to Canadian codes. JAYCO and the JAYCO BIRD IN FLIGHT are registered trademarks of Jayco, Inc. Printed in USA 1/23 ©2023 Jayco, Inc. 2032594.2023

**Jayco - Part of Jayco Family of Companies**