

Hummingbird 2018



Jayco®

Generations of family fun.



BAJA EDITION

2
YEAR
WARRANTY



17RK



AMERICAN-MADE NITRO-FILLED GOODYEAR® TIRES WITH ALUMINUM RIMS AND SELF-ADJUSTING BRAKES



A-FRAME-MOUNTED 2-BIKE CARRIER (OPTIONAL)



LOW-PROFILE 13,500-BTU A/C



JAYCO-EXCLUSIVE SIMMONS® MATTRESS



17RK REAR WINDOW (ALSO ON 16FD, 17BH AND 17FD)



17RK KITCHEN

FLOORPLANS

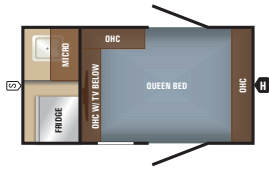

HUMMINGBIRD | 10RK

Ext. Length: **13' 0"** Travel Ht: **92"**
Unloaded Wt. (lbs): **1,510** Sleeps: **2**

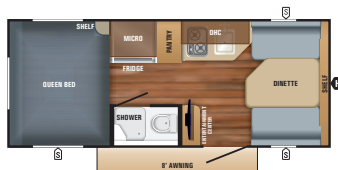

HUMMINGBIRD | 16FD

Ext. Length: **18' 10"** Travel Ht: **111"**
Unloaded Wt. (lbs): **2,535** Sleeps: **3-4**

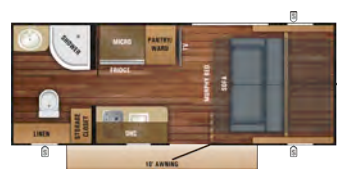

HUMMINGBIRD | 16MRB

Ext. Length: **19' 9"** Travel Ht: **110"**
Unloaded Wt. (lbs): **2,670** Sleeps: **2**

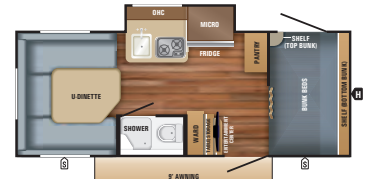

HUMMINGBIRD | 17BH

Ext. Length: **19' 9"** Travel Ht: **110"**
Unloaded Wt. (lbs): **2,940** Sleeps: **4**

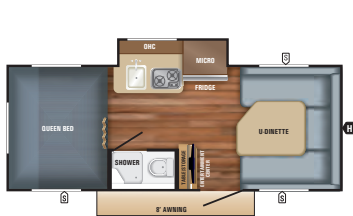

HUMMINGBIRD | 17FD

Ext. Length: **19' 9"** Travel Ht: **109"**
Unloaded Wt. (lbs): **2,800** Sleeps: **3-4**



HUMMINGBIRD | 17MBS

Ext. Length: **TBD** Travel Ht: **TBD**
Unloaded Wt. (lbs): **TBD** Sleeps: **TBD**

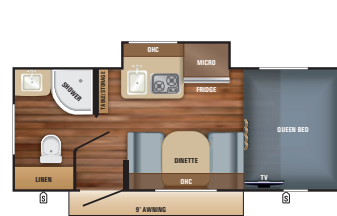

HUMMINGBIRD | 17RB

Ext. Length: **19' 9"** Travel Ht: **109"**
Unloaded Wt. (lbs): **2,865** Sleeps: **3**

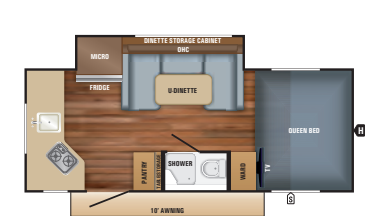

HUMMINGBIRD | 17RK

Ext. Length: **19' 9"** Travel Ht: **110"**
Unloaded Wt. (lbs): **2,985** Sleeps: **3-4**

SPECS

MODELS					DIMENSIONS				WEIGHT (LBS.)				TANKS (GALS.)		
FLOORPLAN	EXTERIOR TRAVEL LENGTH	EXTERIOR WIDTH	EXTERIOR HEIGHT (WITH A/C)	INTERIOR HEIGHT	UNLOADED VEHICLE WEIGHT	DRY HITCH WEIGHT	GROSS VEHICLE WEIGHT RATING	CARGO CARRYING CAPACITY	FRESH WATER CAPACITY (INCLUDES WATER HEATER)	GREY WASTE WATER CAPACITY	BLACK WASTE WATER CAPACITY				
10RK	13' 0"	97"	92"	78"	1,510	165	2,000	490	25.6	N/A	N/A				
16FD	18' 10"	97"	111"	78"	2,535	270	3,500	965	31.6	25.4	25.4				
16MRB	19' 9"	97"	110"	78"	2,670	340	3,750	1,080	31.6	25.4	25.4				
17BH	19' 9"	97"	110"	78"	2,940	345	3,950	1,010	31.6	25.4	25.4				
17FD	19' 9"	97"	109"	78"	2,800	320	3,750	950	31.6	25.4	25.4				
17MBS	TBD	97"	TBD	78"	TBD	TBD	TBD	TBD	31.6	25.4	25.4				
17RB	19' 9"	97"	109"	78"	2,865	300	3,750	885	31.6	25.4	25.4				
17RK	19' 9"	97"	110"	78"	2,985	335	3,950	965	31.6	25.4	25.4				

Unloaded Vehicle Weight (UVW): Sometimes referred to as "Dry Weight," UVW means the typical weight of this trailer as built at the factory. The UVW, as used in product literature and other promotional materials, does not include cargo, fresh water, propane, options or dealer-installed accessories.

Gross Vehicle Weight Rating (GVWR): GVWR means the maximum permissible weight of the trailer, including the UVW plus personal items, all cargo, fluids, options and dealer-installed accessories. The GVWR is equal to or greater than the sum of the UVW and the CCC.

Cargo Carrying Capacity (CCC): CCC means the maximum weight of personal items, food, fresh water, propane, tools, other cargo and dealer-installed accessories that can be carried by the trailer. CCC is equal to or less than GVWR minus UVW. The addition of options will decrease the CCC.

Hitch Weight (HW): The hitch weight, as used in product literature and other promotional materials, does not include cargo, fresh water, propane gas, options or dealer-installed accessories. The addition of these types of items will either add to or subtract from the stated hitch weight.

It is important for your safety and enjoyment that your tow vehicle be adequately sized and equipped to tow and handle the GVWR of the RV you select. Review weights and rating of your tow vehicle and consult a competent advisor for questions or advice. Whether you are new to RVing or a veteran, get a feel for the performance of your tow vehicle before heading out on the roadways. When you tow an RV, you must drive differently than when you drive a single vehicle. Practice hooking up, driving, backing up and braking in a safe environment or seek out professional instruction. Jayco affixes a weight label to each RV which lists weight information for that vehicle. See specifications chart above.

STANDARDS AND OPTIONS

STANDARD EXTERIOR EQUIPMENT

- Aerodynamic, rounded profile with front and rear black diamond plating
- Graphics package with 2-colored sidewall
- Tuff-Shell™, vacuum-bonded laminated floor, roof and sidewalls
- Norco® frame with integrated A-frame
- Single axle with rubber-torsion suspension
- G20 tinted safety-glass windows
- Marine-grade exterior speakers (2)
- Impact-resistant, powder-coated, black aluminum fenders
- U-channel drip rail over slideout
- 30-amp service with detachable power cord
- 20-pound propane bottle with auto-regulator and cover
- Outside grill propane quick-disconnect port
- Exterior TV bracket with cable and satellite hookups
- Rear camera backup prep
- 26-inch-wide entry doors with gas-strut and frosted window
- Exterior LED lighting
- 25.5-gallon fresh water, black and grey tanks
- Aluminum entry step(s)
- One-piece fiberglass roof

STANDARD INTERIOR EQUIPMENT

- Folding 2-foot x 4-foot picnic table with storage compartment
- Screwed-and-glued cabinetry
- Smoked-glass decorative inserts (select overhead cabinets)
- Ball-bearing drawer glides with 75-pound capacity
- LED lighting throughout
- 2-burner cooktop
- Plywood dinette and bed bases
- High-density dinette cushions with vinyl backing
- Jayco-exclusive Simmons mattress with bedspread and pillows
- 2.1-amp USB port in all models
- Decorative window treatments with pleated nightshades
- Wall-to-wall residential vinyl flooring with cold-cracking resistance

CUSTOMER VALUE PACKAGE

- American-made, nitro-filled Goodyear radial tires
- Aluminum wheels
- Solar ready
- Self-adjusting electric brakes
- Stabilizer jacks with pads (4)

- 6-gallon gas/electric DSI water heater
- Folding assist handle at entry door
- Black tank flush
- Outside shower
- 3-cubic-foot 2-way Norcold® refrigerator
- 18,000-BTU Atwood® furnace
- AM/FM/CD/DVD/Bluetooth® stereo with speakers
- Convection microwave
- Power awning with multi-colored LED light with remote

OPTIONS

- 24-inch LED TV
- Low-profile 13,500-BTU A/C (mandatory)
- Baja Package: 15-inch off-road mud tires, additional 5-inch ground clearance and double entry step (std. on 10RK)
- Enclosed underbelly with Astro-Foil™ insulation (std. on 16MRB)
- Electric tongue jack
- Spare tire
- A-frame-mounted 2-bike carrier
- Exterior grill
- Spare tire (Baja Package)

FAST FUN

Hit the road, set up camp and dial up the fun in a flash with the comfy, cozy and lightweight Hummingbird. The 2018 lineup offers all new interiors, two additional floorplans and world-class Goodyear® tires that make towing even easier and more safe.



Scan the QR code for complete towing guide resources



- **American-made, nitro-filled Goodyear radial tires** with self-adjusting electric brakes and rubber torsion axles
- **Vacuum-bonded floor, sidewalls and roof** for better protection from the elements
- **Norco® frame** with integrated A-frame prevents the hitch from buckling
- **Power awning with remote-controlled, multi-function and multi-color LED lights**
- **Optional A-frame-mounted 2-bike carrier** visible during transport
- **Optional enclosed underbelly with Astro-Foil™ insulation**
- **Unloaded vehicle weights range from 1,510 to 2,985 pounds** for comfortable towing
- **Low-profile 13,500-BTU A/C standard**
- **Jayco-exclusive Simmons® mattress** with residential bedspread
- **Exterior TV bracket** with cable and satellite hookups
- **Solar prep** makes efficient, environmentally friendly camping a breeze
- **Folding 2-foot x 4-foot picnic table** in each model



Generations of family fun.

Meet your Jayco Dealer

Colton RV & Marine
3122 Niagara Falls Blvd.
North Tonawanda, NY 14120
(716) 694-0188
www.ColtonRV.com

Colton RV
489 Bushkill Plaza LN #9665
Wind Gap, PA 18091
(610) 863-5239
www.ColtonRV.com

We work hard—so you can play hard. From finding the perfect Jayco for your family to providing flexible financing options and full-service support, we're here to help.

Travel with Confidence



At Jayco, we build our RVs to handle every adventure, then back them with our industry-leading 2-year limited warranty. We, with support from our select partners, have you covered for **2 camping seasons**. That's **730 days**. You won't find a better warranty in the business, because the only strings we attach are those that deliver the ultimate in reliability. That's the Jayco difference. So go explore. For a copy of our 2-year limited warranty with complete terms and conditions, please contact your local Jayco dealer.



Featuring Durawall® Technology—ENGINEERED to help you tow with confidence

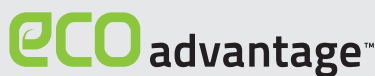

Jayco's long-term commitment to generations of family fun

After six years of increased efforts to eliminate waste, conserve energy and increase recycling, we've come a long way in building RVs that are not only better for your family—but also better for the planet.

Learn more at Jayco.com/EcoAdvantage

Follow Jayco



Jayco, Inc. | P.O. Box 460 | Middlebury, IN 46540



See dealer for further information and prices. All information in this brochure and on www.jayco.com is the latest available at the time of publication approval. Jayco reserves the right to make changes and to discontinue models without notice or obligation. Photography may show optional equipment or props used for decoration purposes only. RVs built for sale in Canada may differ to conform to Canadian codes. JAYCO and the JAYCO BIRD IN FLIGHT are registered trademarks of Jayco, Inc. Printed in USA 15K 1/18 ©2018 Jayco, Inc. 274773-2