

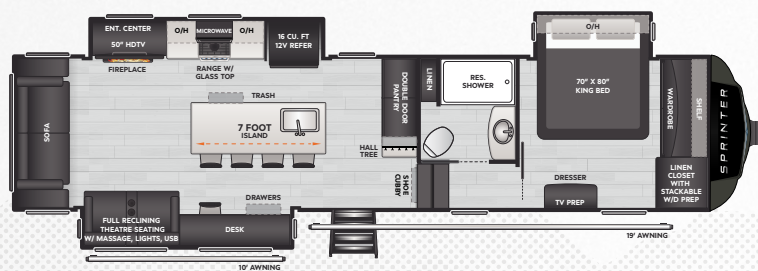

KEYSTONE
RV COMPANY

SPRINTER

2025 | FIFTH WHEELS



3210RLS | WEIGHT TBD | LENGTH 37' 4"

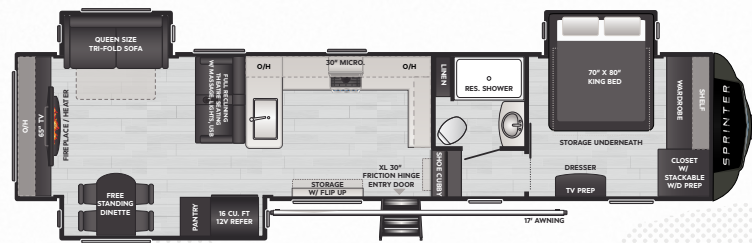

3520RDS | WEIGHT TBD | LENGTH 39' 5"

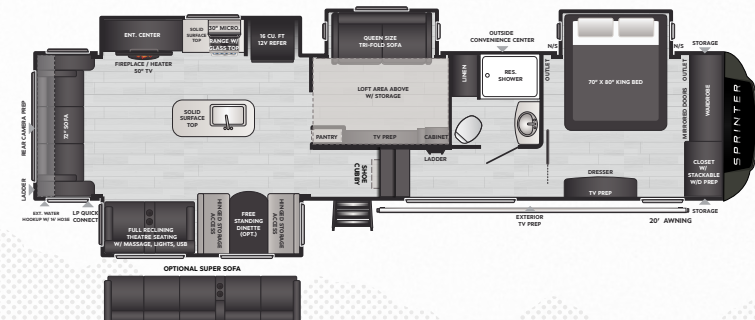

3590LFT | WEIGHT 12020 | LENGTH 39' 4"

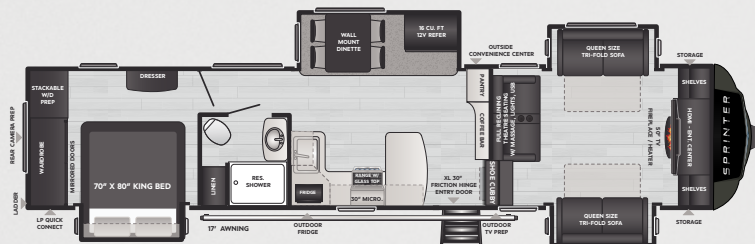

3670FLS | WEIGHT 11485 | LENGTH 40' 4"

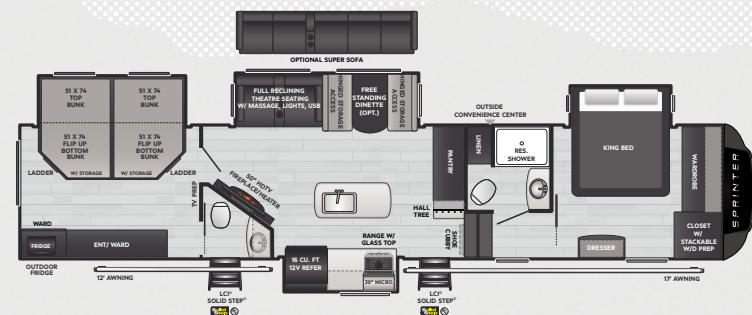

3810QBS | WEIGHT 13350 | LENGTH 42' 11"

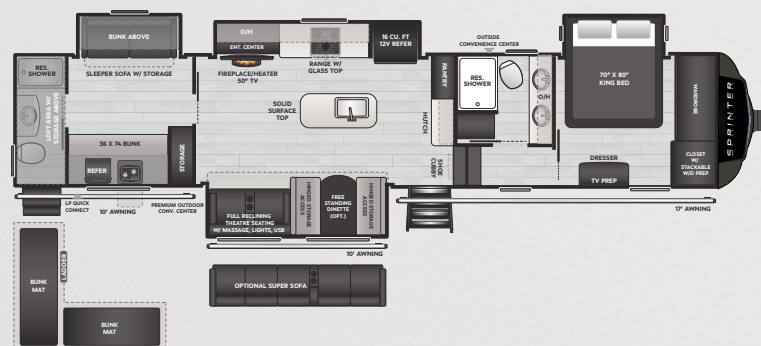

3900DBL | WEIGHT 13969 | LENGTH 43' 6"

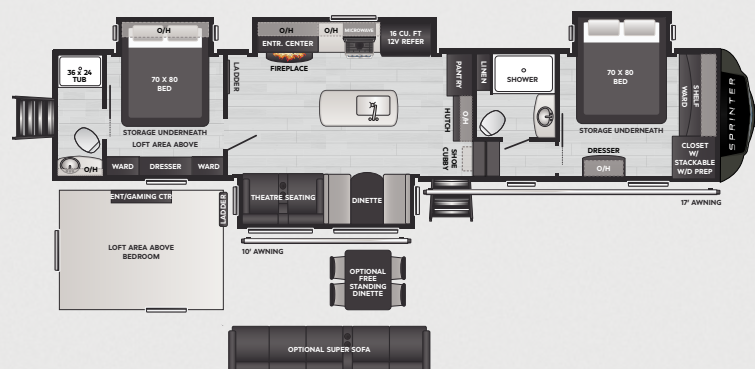

3920DSL | WEIGHT 13450 | LENGTH 42' 9"

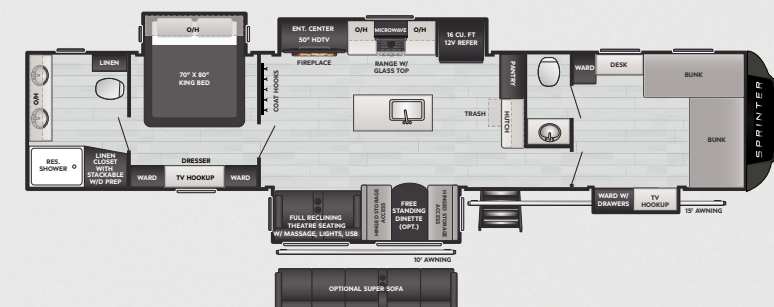

3980FBS | WEIGHT 12760 | LENGTH 43' 1"

DISCLAIMER: Product information is as accurate as possible as of the date of this publication. All features, floor plans, and specifications are subject to change without notice. Pre-production estimated weights & lengths may be listed; visit Keystonerv.com for the most current product information and specifications.

CAMP BETTER
KINDNESS · COMMUNITY · PLANET





KEYSTONE
RV COMPANY

SPRINTER

2025 | FIFTH WHEELS

INTERIOR

- » Black Out Night Shades
- » Floating Style Made Deck Steps With Shoe Storage
- » Designer Upholstered Window Valances
- » Residential Style Screwed & Glued Cabinetry
- » Theater Seating W/ USB Charging
- » Thomas Payne® Collection Luxury Furniture
- » 5.5K BTU Electric Fireplace W/ Thermostat Control & Remote
- » Maxxair Power Vent Fan(s) W/ Rain Sensor
- » 22" Deep Drawers W/ Full Extension Heavy-Duty Guides
- » Residential Style Seamless Marbled Countertops
- » Deep Single-Basin Stainless Steel Industrial Sink
- » High-Rise Pull Out Faucet & Sprayer
- » 70" X 80" King Bed W/ Gas Strut Storage
- » 30K BTU Furnace
- » Girard® Tankless On-Demand Water Heater
- » Premium Entertainment Center W/ HD LED TV, Multi Zone Stereo, Exterior TV Hook-Up & Speakers
- » 16 Cu. Ft. 12V Refrigerator
- » Stainless Steel Microwave W/Carousel
- » Oversized 30" Over The Range Microwave
- » 3-Burner Gas Range W/ 21" Stainless Steel Oven, Glass Top, & Piezo Electronic Ignite
- » Stackable Washer/Dryer Prep

EXTERIOR

- » Floorplan Specific 100" Wide-Body Frame W/ Full W/ Outriggers
- » Maxturn™ Technology W/ Lippert® Road Armor™
- » HitchVision
- » 2" Aluminum Framed And Laminated Sidewalls
- » Tinted Safety Glass Windows
- » Automotive-Grade Painted Fiberglass Front Cap W/ KeyShield™ Protection
- » Dual Layer Insulation
- » Rear Ladder Prep
- » Equal Torsion Cable Slides W/ Manual Override
- » Thermal Package
- » Heated & Enclosed Underbelly W/ Astro-Foil Insulation
- » Dexter® E-Z Lube Axles With Never-Adjust Brakes
- » Aluminum Wheels W/ Lifetime Warranty
- » One Touch 4-Point Leveling System W/ Return Hookup Memory
- » 30" Friction Hinge Entry Doors
- » Suburban Stow Away Step With 33% Larger First Step
- » High Performance Maxxis Radial Tires W/ Balancing Beads
- » 2" Receiver Hitch W/ 4 Way Hook Up - 3K LBS. Limit
- » Heated Pass-Through Storage W/ Lockable Slam Latch Baggage Doors
- » Locking Slam Latch Baggage Doors
- » Outside Shower W/ Hot & Cold Water
- » Over-Sized Roto Cast Holding Tanks W/ Best In Class Capacities
- » Electric Awning With Friction Hinge Adjustment, LED Light Strip, & Manual Override
- » Congoleum® Vinyl Flooring W/ One-Piece Dyna Span Marine Grade Decking

STANDARD FEATURES & OPTIONS



Colton RV & Marine
3122 Niagara Falls Blvd.
North Tonawanda, NY 14120
(716) 694-0188
www.ColtonRV.com

Colton RV
489 Bushkill Plaza LN #9665
Wind Gap, PA 18091
(610) 863-5239
www.ColtonRV.com

DISCLAIMER: Product information is as accurate as possible as of the date of this publication. All features, floor plans, and specifications are subject to change without notice. Pre-production estimated weights & lengths may be listed; visit Keystonerv.com for the most current product information and specifications.

CAMP BETTER
KINDNESS · COMMUNITY · PLANET

