

SALEM GRAND VILLA FOREST RIVER

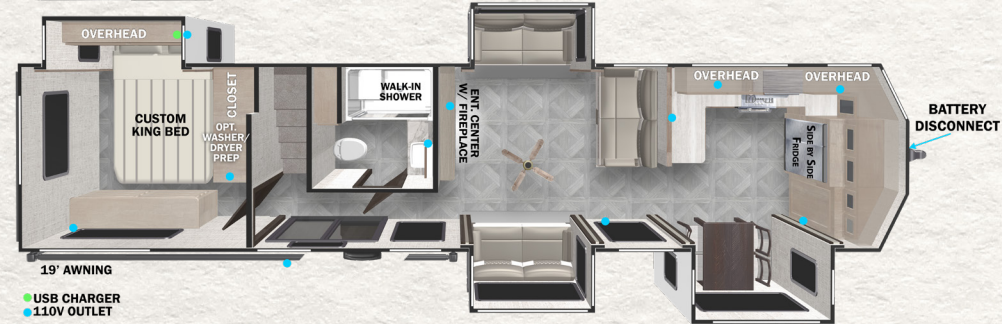
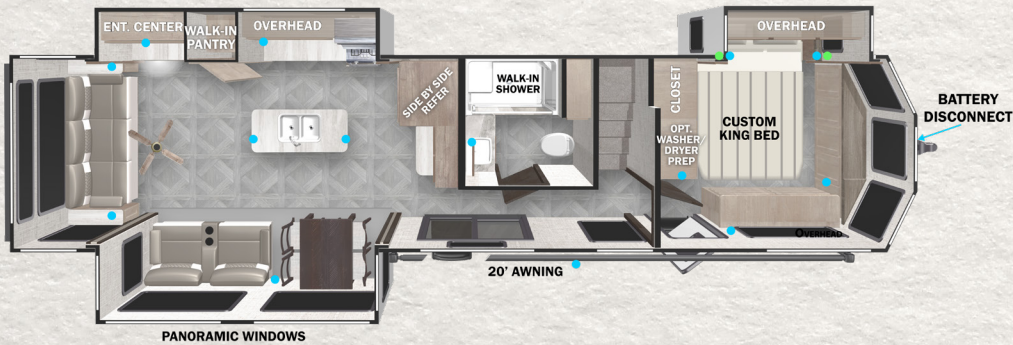
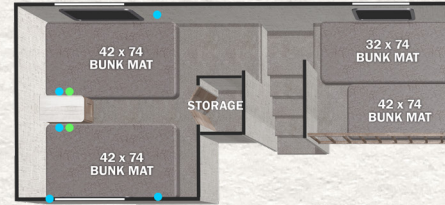
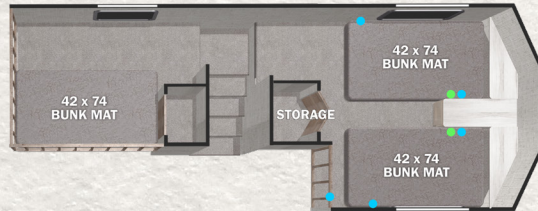

● USB CHARGER
● 110V OUTLET

MODEL #: 42DL
HITCH: 1,855 LBS UVW: 12,179 LBS LENGTH: 41'10"

MODEL #: 42FK
HITCH: 1,780 LBS UVW: 12,469 LBS LENGTH: 42'11"

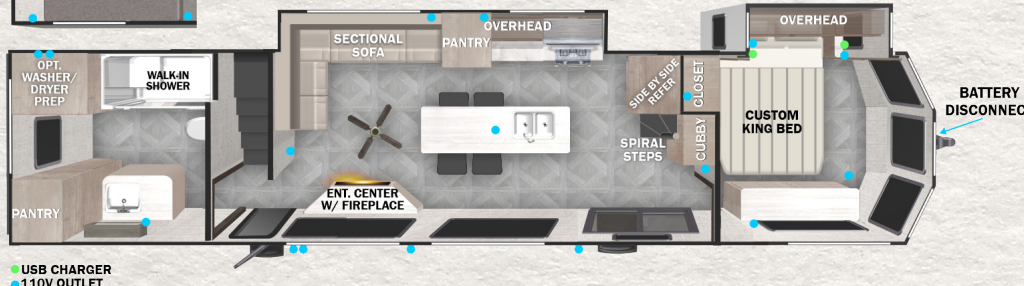
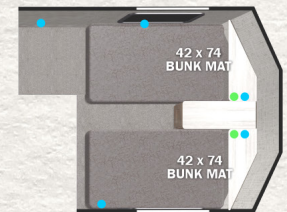
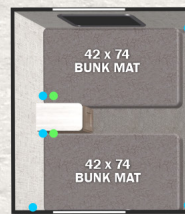
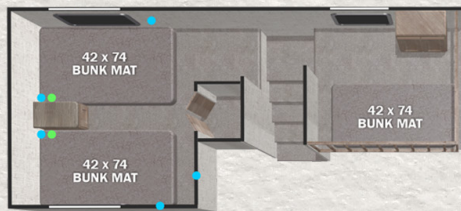

MODEL #: 42FLDL
HITCH: 1,720 LBS UVW: 12,209 LBS LENGTH: 41'7"

MODEL #: 42VIEW
HITCH: TBD UVW: TBD LENGTH: TBD

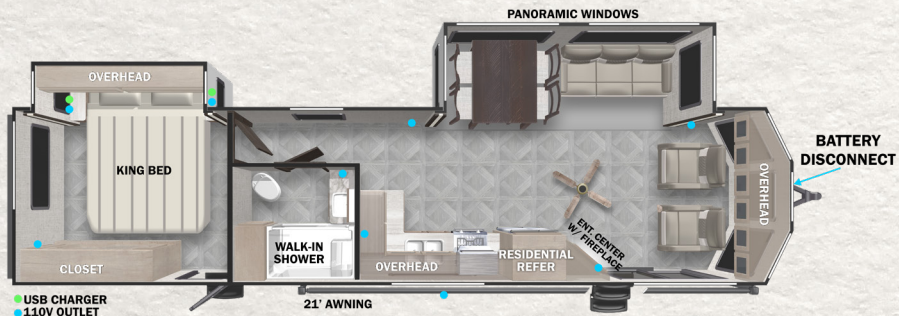

MODEL #: 353FLFB

HITCH: 1,335 LBS UYW: 9,234 LBS LENGTH: 37'9"

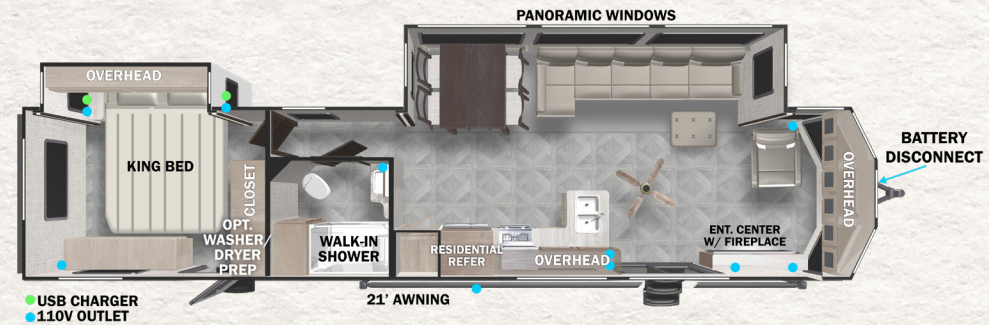

MODEL #: 40FDEN

HITCH: 1,260 LBS UYW: 10,574 LBS LENGTH: 42'5"

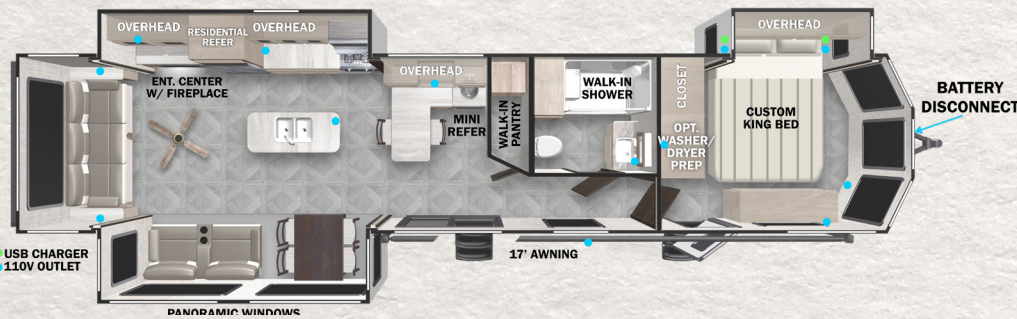

MODEL #: 40RLB

HITCH: 1,445 LBS UYW: 11,604 LBS LENGTH: 43'

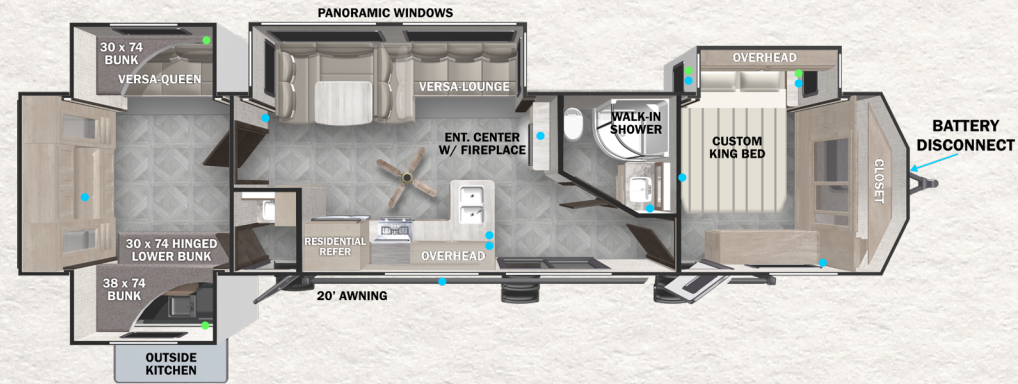

MODEL #: 42QBQ

HITCH: 1,365 LBS UYW: 12,029 LBS LENGTH: 42'4"



For detailed specifications, pictures & 360 Tours, visit www.forestriverinc.com/Salem OR Scan the QR code!



MEET YOUR VILLA/GRAND VILLA DEALER

Colton RV & Marine
3122 Niagara Falls Blvd
North Tonawanda, NY 14120
(716) 694-0188
www.ColtonRV.com

Colton RV & Marine
3443 Southwestern Blvd.
Orchard Park, NY 14127
(716) 957-325
www.Coltonrv.com

All information contained in this brochure is believed to be accurate at the time of publication. However, during the model year, it may be necessary to make revisions and Forest River, Inc., reserves the right to make all such changes without notice, including prices, colors, materials, equipment and specifications as well as the addition of new models and the discontinuance of models shown in this brochure. Therefore, please consult with your Forest River dealer and confirm the existence of any materials, design or specifications that are material to your purchase decision. © 2022 Salem, a Division of Forest River, Inc., a Berkshire Hathaway company. All Rights Reserved.

