



Colton RV & Marine  
3122 Niagara Falls Blvd  
North Tonawanda, NY 14120  
(716) 694-0188  
[www.ColtonRV.com](http://www.ColtonRV.com)

Colton RV & Marine  
3443 Southwestern Blvd.  
Orchard Park, NY 14127  
(716) 957-3250  
[www.Coltonrv.com](http://www.Coltonrv.com)

**NORTHSTAR<sup>®</sup>**

**QUALITY  
SINCE 1961**





## About Us

### Our History of Excellence

Northstar Campers has been calling Waterloo, Iowa home since 1955 when the Willett family began manufacturing truck campers. The company was founded by Ralph (Tex) Willett who along with his son Robert (Chuck), ran the company under the name of Texson Campers. The father/son duo helped launch the company, building a reputation unmatched in the industry and creating a strong foundation for Chuck's son, Rex. Rex took over the company in the 1980s, operating under the Northstar Campers name, which continues to this day.

We've been selling our campers to dealers since 1961, and Northstar's campers are sold across the world to help families enjoy the outdoors and camping. From our facility at the corner of Leverage Road and Airline Highway in Cedar Falls, we've remained committed to improving our truck campers using proven construction techniques while integrating modern materials. This allows our product to continue to stay ahead of the industry, both in quality and longevity.

## Quality that Lasts

Northstar Campers manufactures truck campers that you can depend on for a long time. Our dedication to quality has allowed us to continue "Shining Above the Rest" and many of our campers are still out on the road decades later. We believe our truck campers are the perfect thing for active travelers and campers, and we're here to help you for every mile on the road. Our customers are the most important thing to us, and we take great pride in not only manufacturing the best truck campers you can find, but in helping you maintain it for years while we build a relationship with you based on trust and quality.



# Vista

Our newest addition to the Northstar family is the cab-less VISTA. Great storage and expandable dinette bed without the resistance of a cabover.

## Specifications

Based on standard features only without water, LP, battery or personal gear

Base Dry Weight (pounds)	1,260
Interior Height	6' 1"
Entrance Door Width	26"
Exterior Width	7' 6"
Overall Length	6' 10"
Floor Length	6' 8"
Dinette Slide Out Bed	48" X 80"
Fold Down Bunk/Cabinet (Option #26)	30" X 80"
Fresh Water Tank (Gallons)	20
Gray Water Holding Tank (Gallons) (Option #4)	7.5
Center of Gravity (front of truck bed back)	23"
Single 20lb Exchangeable LP Tank	

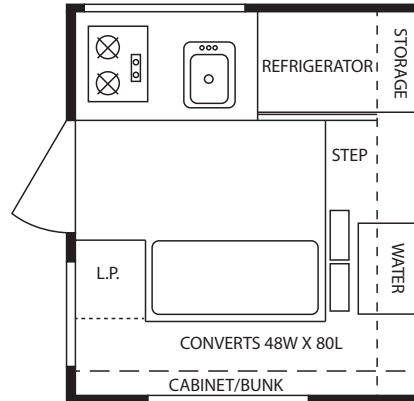

# Quality Since 1961



Vista Exterior

# 8.5 Adventurer

Great open floorplan in a compact 7' width. Northstar's 8.5 Adventurer is ready for the open road!

## Specifications

Based on standard equipment only without water, LP or personal gear

Base Dry Weight (pounds)	1,940
Floor Length	8'9"
Overall Length	16'2"
Exterior Width	7'
Interior Height	6'4"
Center of Gravity (front of truck bed back)	32"
Cabover Bed Size	60x80
Dinette Bed Size	38x72
Fresh Water Tank Capacity (gallons)	20
Gray Water Holding Tank Capacity (gallons)	13
20Lb Exchangeable LP Tank Optional Second Bottle	

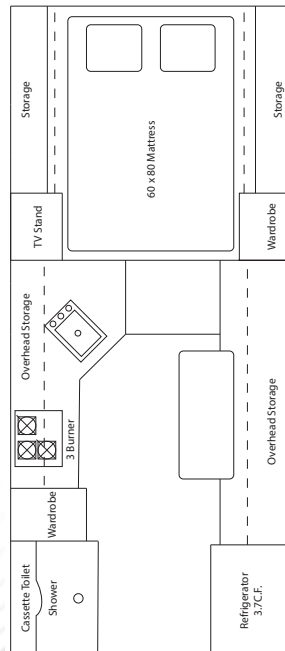

Vista Interior

Check Our Website For More Photos [www.northstarcampers.com](http://www.northstarcampers.com)





# Laredo SC

The Laredo SC has no boundaries. An agile narrow 7' body width, but major storage and equipment. New features include dual 20# exchangeable LP bottles, room for two large AGM batteries stored inside, and a whopping 40 gallon fresh water tank! Plus the extra wide screened entrance door for ease of entry and loading or unloading your gear. Larger kitchen and cabover windows available for great visibility and unobstructed views, and True four season capabilities in extreme heat or cold. Long distance travel, Off-road or prolonged off-grid camping, ease of parking along Main Street to check out a festival or the local area, the Laredo SC is truly in a class by itself!

## Specifications

Based on standard equipment only without water, LP or personal gear

Base Dry Weight (pounds)	2090
Floor Length	8'6"
Overall Length	15'11"
Exterior Width	7'
Entrance Door Width	26"
Interior Height	6'4"
Center of Gravity (from front bed of truck back)	32"
Cabover Bed Size	60x80
Dinette Bed Size	37x73
Fresh Water Tank (gallons)	40
Gray Water Holding Tank (gallons)	13
Cassette Fresh Water Tank (gallons)	4
Cassette Black Water Tank (gallons)	5
20lb Exchangeable LP Tank	Optional Second Bottle

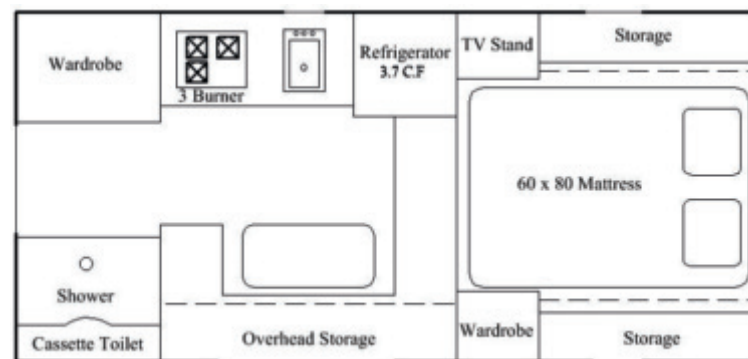

**NORTHSTAR®**

"Shining Above the Rest"

Photography includes options.



# Liberty

Northstar's Liberty for today's short bed and ultra short bed trucks.

## Specifications

Based on standard equipment without water, LP or personal gear

Base Dry Weight (pounds)	1775
Interior Height	6'4"
Entrance Door Width	22"
Exterior Width	7'
Overall Length	14'5"
Floor Length	7'
Cabover Bed Size	60x80
Dinette Seating Area	55"
Fresh Water Tank (gallons)	20
Gray Water Holding Tank (gallons)	13
Cassette Fresh Water Tank (gallons)	4
Cassette Black Water Tank (gallons)	5
Center of gravity (front of bed back)	24"
20lb exchangeable LP tank, optional second bottle	

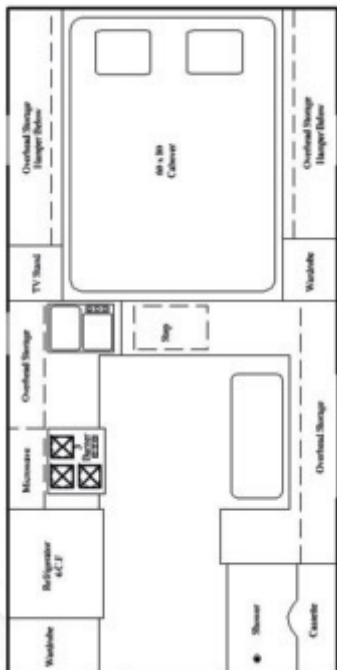

## 8.5 Arrow U

Today's 3/4 ton short bed trucks.

## Specifications

Based on standard equipment without water, LP or personal gear

Base Dry Weight (pounds)	2,480
Floor Length	8'9"
Overall Length	16'
Exterior Width	7'6"
Entrance Door Width	26"
Interior Height	6'8"
Center of Gravity (front of bed back)	32"
Cabover Bed Size	60x80
Dinette Bed Size	37x72
Fresh Water Tank (gallons)	40
Gray Water Holding Tank (gallons)	13
Cassette Fresh Water Tank (gallons)	4
Cassette Black Water Tank (gallons)	5
Dual 20lb exchangeable LP Tanks	





## 9.5 Igloo

### Specifications

Based on standard equipment without water, LP or personal gear

Base Dry Weight (pounds)	2,670
Floor Length	9'9"
Overall Length	16'10"
Exterior Width	7'6"
Entrance Door Width	26"
Interior Height	6'8"
Center of Gravity (front of truck bed back)	40"
Cabover Bed Size	60x80
Dinette Bed Size	38x78
Fresh Water Tank (gallons)	40
Gray Water Holding Tank (gallons)	13
Cassette Fresh Water Tank (gallons)	4
Cassette Black Water Tank (gallons)	5
Dual 20lb exchangeable LP tanks	

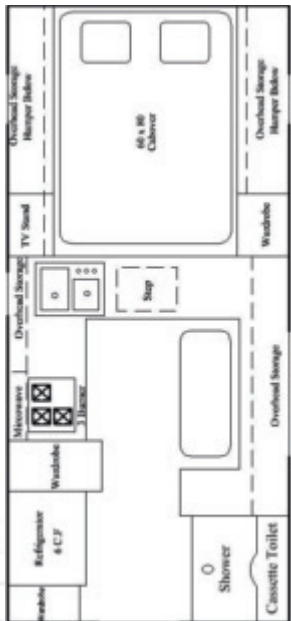

## American Hero

### Side Door Flatbed

### Specifications

Base Dry Weight (pounds)	2650
Floor Length	9'
Overall Length	14'3"
Exterior Width	7'10"
Entrance Door Width	26"
Interior Height	6'8"
Cabover Bed Size	60x80
Dinette Bed Size	36x72
Fresh Water Tank (gallons)	40
Gray Water Holding Tank (gallons)	13
Cassette Fresh Water Tank (gallons)	4
Cassette Black Water Tank (gallons)	5
Dual 20lb exchangeable LP tanks	

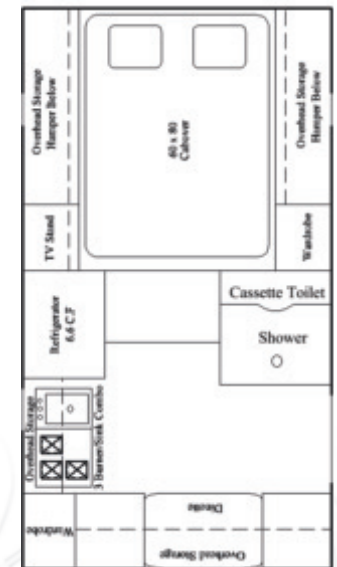



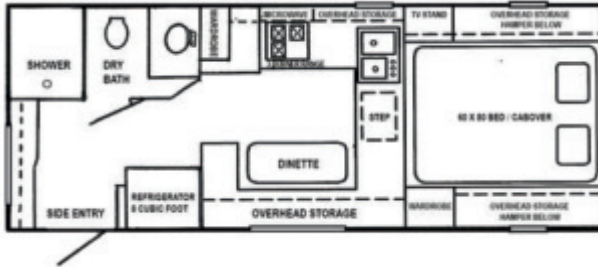

# 12 STC

Northstar's 12 sTc is a low profile, non basement, side door with a dry spacious bathroom. Fantastic storage and standard with almost everything the sTc weighs in at 3176 lbs. dry making it one of the lightest campers in its class. Experience the ride and control without sacrificing room and comfort.

## Specifications

Based on standard equipment without water, LP or personal gear

Base Dry Weight (pounds)	3176
Floor Length	12'
Overall Length	19'
Exterior Width	7'9"
Entrance Door Width	24"
Interior Height	6'8"
Center of Gravity (from front of truck bed back)	54"
Cabover Bed Size	60x80
Dinette Bed Size	36x73
Fresh Water Tank (gallons)	40
Gray Water Holding Tank (gallons)	20
Cassette Fresh Water Tank (gallons)	2.9
Cassette Black Water Tank (gallons)	3.5
Dual 20lb exchangeable LP tanks	

Available with regular marine toilet and 13 gallon black tank



All the Features  
All the Quality



# NORTHSTAR®

Simply the World's Finest | Quality Since 1961

**R.C. Willett Co. Inc.**

3040 Leverssee Rd. | Cedar Falls, IA 50613

[www.northstarcampers.com](http://www.northstarcampers.com)



Also check out Northstar's complete line of pop-up campers.



## Cassette Toilets Are Truck Camper Perfect!

So...you like to get off the grid?

The cassette is a built in toilet system with it's own water tank supply and water-pump. It has a waste capacity of 5 gallons and easily just slides out to dump just about anywhere. You can fill the 4 gallon fresh tank with antifreeze or windshield washer fluid for cold weather camping and never worry about freezing! No wrestling with a sewer hose or paying to dump. When camping with the camper off the truck you can use the toilet as much as you want with no worry of reloading the camper to dump your waste-tank.

Totally off Grid!