

STANDARD GRAPHICS

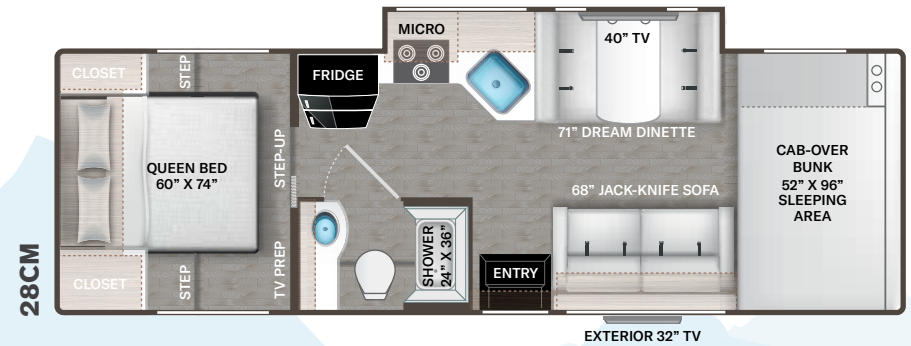
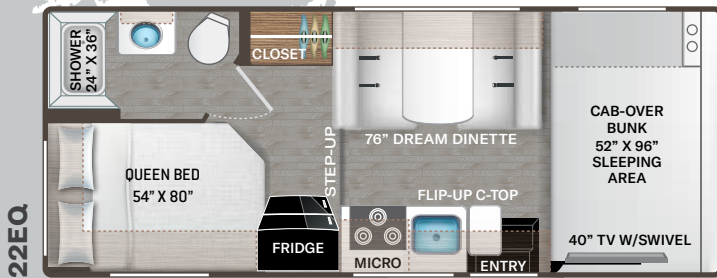
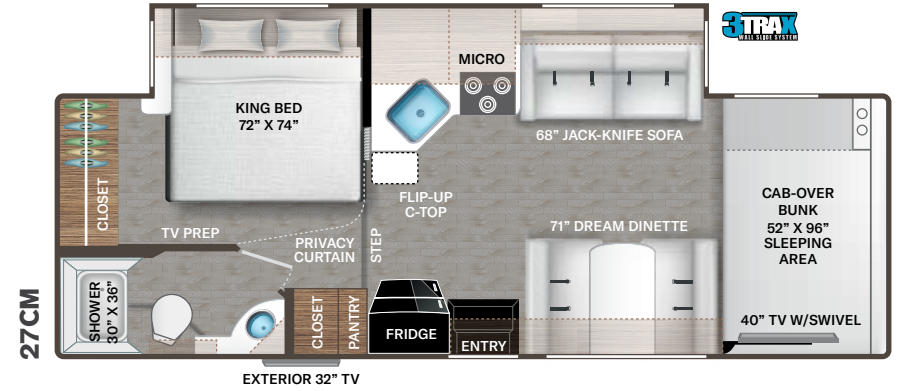
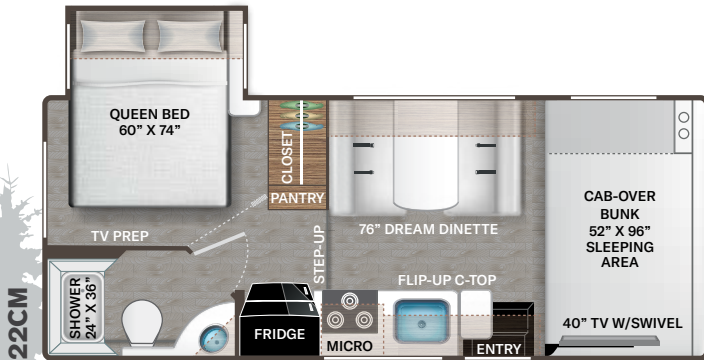
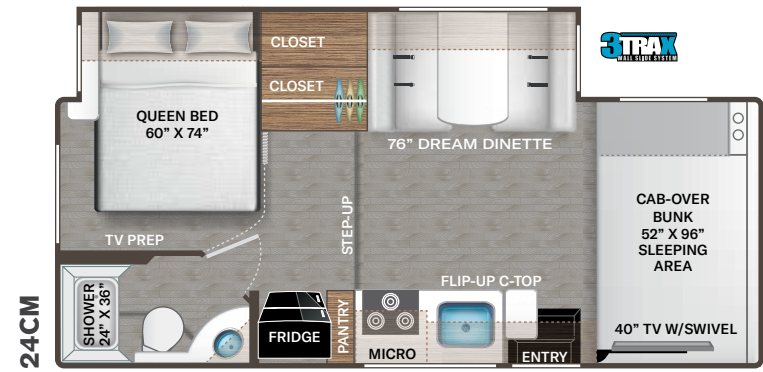

WEATHERED
CHERRY

FLOORING

Featured Highlights

CONSTRUCTION & EXTERIOR

- Ford® E-Series Chassis - 7.3L V8, 325HP & 450 lb-ft Torque - w/TPM's
- 8,000-lb Trailer Hitch
- Premium One-Piece Crossflex™ Roofing
- Welded Tubular Aluminum Roof & Sidewall Cage Construction
- One-Piece Fiberglass Front Cap
- Slick Fiberglass Exterior with Graphics Package
- Electric Stabilizing System (24CM & 27CM)
- Drop Down Stairwell Entrance Step with Accent Light Under Step on Separate Switch
- Flush Mount Radius Compartment Doors
- Lighted Rotocast Storage Compartments with Single ON/OFF Interior Switch
- MEGA-Storage™ Compartment
- Portable Folding Table (28CM)
- Power Patio Awning with Integrated LED Lighting
- Slideout Room Topper Awnings (22CM, 24CM, 27CM & 28CM)
- Black Framed Windows

CONSTRUCTION & EXTERIOR OPTION

- Chevrolet® Dually Chassis with 6.6L V8, 401HP & 464 lb-ft Torque (22CM & 22EQ)

AUTOMOTIVE & COCKPIT

- 7" Touchscreen Dash Radio, Apple CarPlay™, Android Audio® with Back-Up Monitor
- SiriusXM® Tuner & Antenna
- Steering Wheel Audio & Camera Controls on Ford® E-Series Chassis Only
- Tilt Steering Wheel
- Deluxe Exterior Mirrors

Colton RV & Marine
3122 Niagara Falls Blvd
North Tonawanda, NY 14120
(716) 694-0188
www.ColtonRV.com

KITCHEN

- Double Door Refrigerator
- Recessed 3-Burner Gas Cooktop/Oven with Glass Cover
- Range Hood with Task Lighting Above Cooktop
- Metal Pan Drawer Front(s) Matching Cooktop Below Cooktop
- Microwave Oven
- Flip-Up Countertop Extension (22EQ, 22CM, 24CM & 27CM)
- Pop-Up Countertop Outlet & Charging Center for Electronics (27CM & 28CM)
- Pantry (24CM & 27CM)
- Kitchen Waste Basket
- Large Single Bowl Stainless Steel Sink and Single Handle Faucet with Pull-Down Sprayer
- Kitchen Countertop LED Accent Lighting
- Decorative Kitchen Tile Backsplash (27CM)
- Pressed Laminate Kitchen Countertops with Under Mounted Sink with Sink Cover(s)
- 12-volt Ceiling Vent with Under Cabinet Switch

BEDROOM & BATHROOM

- King Size Bed (27CM)
- Queen Size Bed (22EQ, 22CM, 24CM & 28CM)
- Bedspread & Pillow Shams
- Bedroom USB Power Charging Center for Electronics
- Bedroom 12-volt Outlet for CPAP Machine
- Foot Flush Porcelain Toilet
- Stainless Steel Bathroom Sink
- Robe/Towel Hooks in Bathroom
- Shower with Curtain (22CM & 22EQ)

Colton RV & Marine
3443 Southwestern Blvd.
Orchard Park, NY 14127
(716) 957-3250
www.Coltonrv.com

ENTERTAINMENT

- Shower with Anti-Microbial Curtain (24CM & 28CM)
- Shower with Glass Door (27CM)
- Skylight in Shower
- Showermi\$er Hot Water Recycling System
- 12-volt Ceiling Vent in Bath with Under Cabinet Switch
- 40" TV on Manual Swivel in Cab-Over (22EQ, 22CM, 24CM & 27CM)
- 40" TV in Living Area (28CM)
- Bedroom TV Prep with HDMI Cable (22CM, 24CM, 27CM & 28CM)
- HDMI Video Distribution Box (22CM, 24CM, 27CM & 28CM)
- Cable TV Ready
- Satellite Mounting Backer in Roof
- Digital TV Antenna
- Wall Cubby with Net & USB Charging Port
- Exterior 32" TV on Manual Swivel Bracket with Bluetooth® Sound Bar (27CM & 28CM)

ELECTRICAL & PLUMBING

- Gas Generator
- 30-amp Shoreline Power Cord
- Automatic Transfer Switch with Power Protection
- Automatic Shoreline-to-Generator Transfer Switch
- Single Roof Air Conditioner
- 12-volt Auxiliary House Battery
- Battery Disconnect Switch
- Battery Tray for Four (4) Batteries
- Solar Prep - Includes Solar Controller

- Exterior LP Connection (27CM & 28CM)
- Exterior Water Spray Port (28CM)
- 6-gallon DSI Gas/Electric Water Heater
- Water Heater Bypass System
- 1" Fresh Water Tank Drain
- 360° Siphon® RV Holding Tank Vent Cap
- Black Tank Flush System
- Systems Control Center

For a complete listing of available features, visit freedom-motorhomes.com/coleman.

Use your phone's camera to find out more information.

Just scan the code!



	22CM	22EQ	24CM	27CM	28CM
Chassis	Ford / Chevy	Ford / Chevy	Ford / Chevy	Ford	Ford
Gross Vehicle (GVWR)	12,500 / 12,300	12,500 / 12,300	12,500 / 14,500	14,500	14,500
Gross Combined (GCWR)	18,500 / 16,000	18,500 / 16,000	18,500 / 22,000	22,000	22,000
Wheel Base	158" / 159"	158" / 159"	168" / 169"	209"	212"
Exterior Length (w/o ladder)	24'-1" / 24'-7"	24'-1" / 24'-7"	25'-2" / 25'-8"	29'-1"	30'-0"
Exterior Height (w/AC)	11'	11'	11'-2"	11'-2"	11'
Exterior Width (w/o mirrors)	99"	99"	99"	99"	99"
Interior Height (living area)	84"	84"	84"	84"	84"
Awning Size	15'	15'	16'	20'	14'
Fuel (gal)	55 / 57	55 / 57	55 / 57	55	55
LPG (lbs)	40.9	40.9	40.9	40.9	40.9
Fresh/Waste/Gray Water (gal)	40 / 29 / 25	40 / 24.5 / 37	40 / 34.5 / 37	40 / 34.5 / 37	40 / 26 / 32
Water Heater (gal)	6	6	6	6	6
Furnace (BTUs)	19,000	19,000	30,000	30,000	30,000
Exterior Storage Capacity (cu. ft.)	30.9	50.3	39	55.5	99.9
Hitch Weight Rating (lbs)	8,000	8,000	8,000	8,000	8,000

IMPORTANT-PLEASE READ: This brochure reflects product design, fabrication, material, components and specifications at the date of printing, which date is disclosed below. Please visit us online at daybreakmotorhomes.com or consult with your selling dealership for the latest in standards, options, specification and technical information. Photographs in the brochure may depict optional equipment or may only be available in certain floor plans. Components, appliances and the chassis may have been manufactured in a calendar year before the vehicle's designated model year. All capacities are approximate. The actual length of the vehicle may differ from that indicated in the brochure due to variances in the manufacturing processes and/or installed components. All dry weights are based on standard model features and do not include optional features or equipment. Component part and appliance manufacturers issue limited warranties covering portions of the vehicle not covered under the limited warranty we issue. Copyright Thor Motor Coach, Inc. © MY 04/01/2022