

# QUANTUM™

IN A QUANTUM™, THE DRIVE IS WHEN YOUR  
VACATION STARTS. WHERE IT ENDS,  
THAT'S UP TO YOU. EXPLORE MORE  
WITH THOR MOTOR COACH.



Made to fit.



# QUANTUM™

Remember when you were younger and every year you traveled to that one magical, unforgettable spot?

To this day you can still remember the sounds and the smell of summer.

It's time to go there again in a 2020 Quantum™ from Thor Motor Coach.



# EXTERIOR OPTIONS



HOT STREAK **HD-MAX**



LET IT RIDE **HD-MAX**



JOKERS WILD II PARTIAL PAINT



DOUBLE DOWN II PARTIAL PAINT

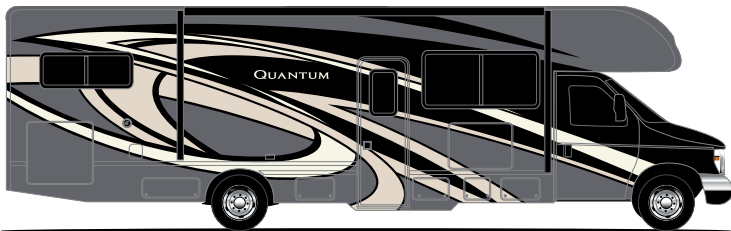

BLACK ONYX FULL-BODY PAINT  
(KW29, JM31, LF31, & WS31)



TOPAZ BLUE FULL-BODY PAINT  
(KW29, JM31, LF31, & WS31)

# S P R I N T E R S



HOT STREAK **HD-MAX**



LET IT RIDE **HD-MAX**

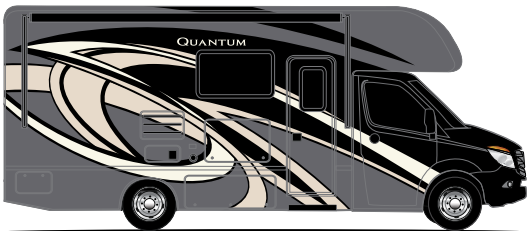

BLACK ONYX FULL-BODY PAINT

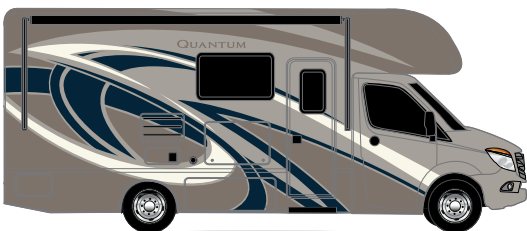

TOPAZ BLUE FULL-BODY PAINT







# FLOOR PLANS

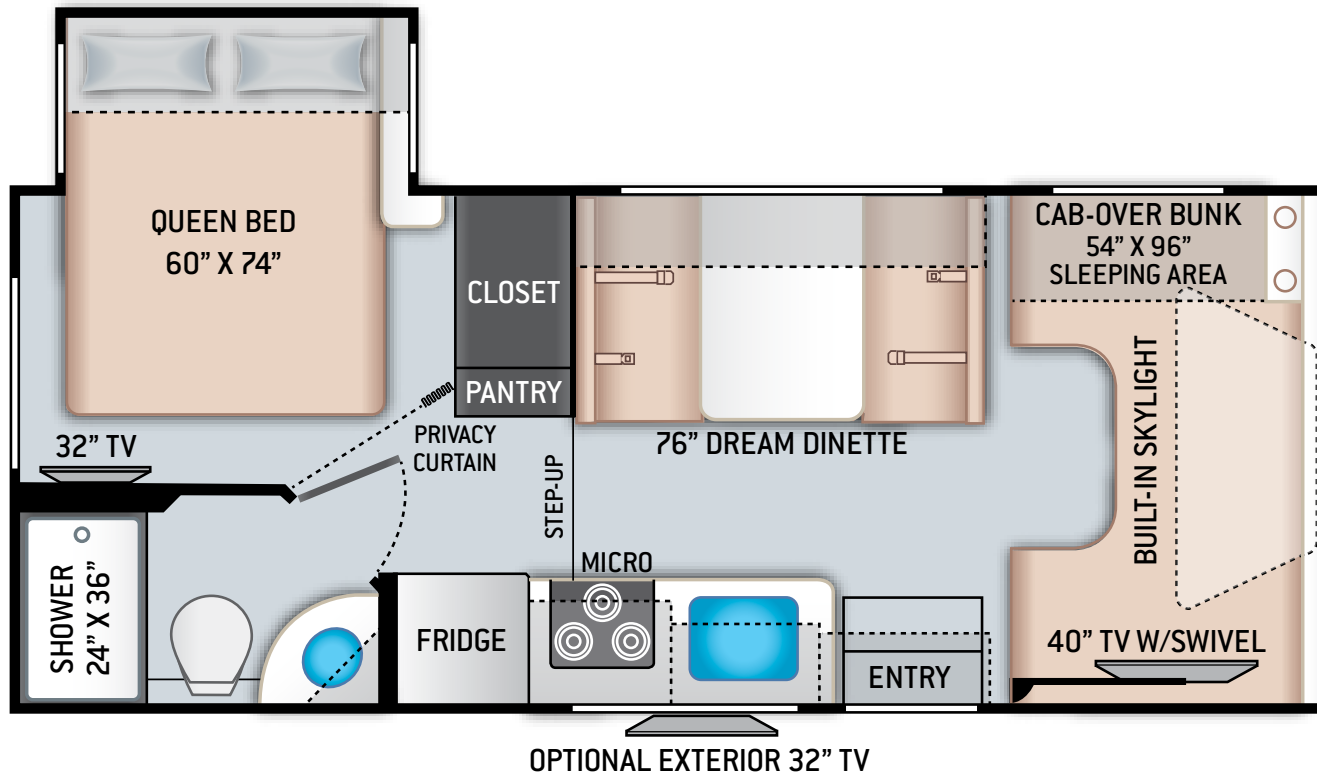

## GR22



# SPECIFICATIONS

GR22

<b>CHASSIS</b>	Ford / Chevy
<b>GROSS VEHICLE (GVWR)</b>	12,500 / 12,300
<b>GROSS COMBINED (GCWR)</b>	18,500 / 16,000
<b>WHEEL BASE</b>	158" / 159"
<b>EXTERIOR LENGTH (W/O LADDER)</b>	24' / 24'-6"
<b>EXTERIOR HEIGHT (W/AC)</b>	11'
<b>EXTERIOR WIDTH (W/O MIRRORS)</b>	99"
<b>INTERIOR HEIGHT (LIVING AREA)</b>	84"
<b>AWNING SIZE</b>	15'
<b>FUEL (GAL)</b>	55 / 57
<b>LPG (LBS)</b>	40.9
<b>FRESH/WASTE/GRAY WATER (GAL)</b>	40 / 29 / 25
<b>WATER HEATER (GAL)</b>	Tankless
<b>FURNACE (BTUS)</b>	19,000
<b>EXTERIOR STORAGE CAPACITY (CU. FT.)</b>	30.9
<b>HITCH WEIGHT RATING (LBS)</b>	8,000

# FLOOR PLANS

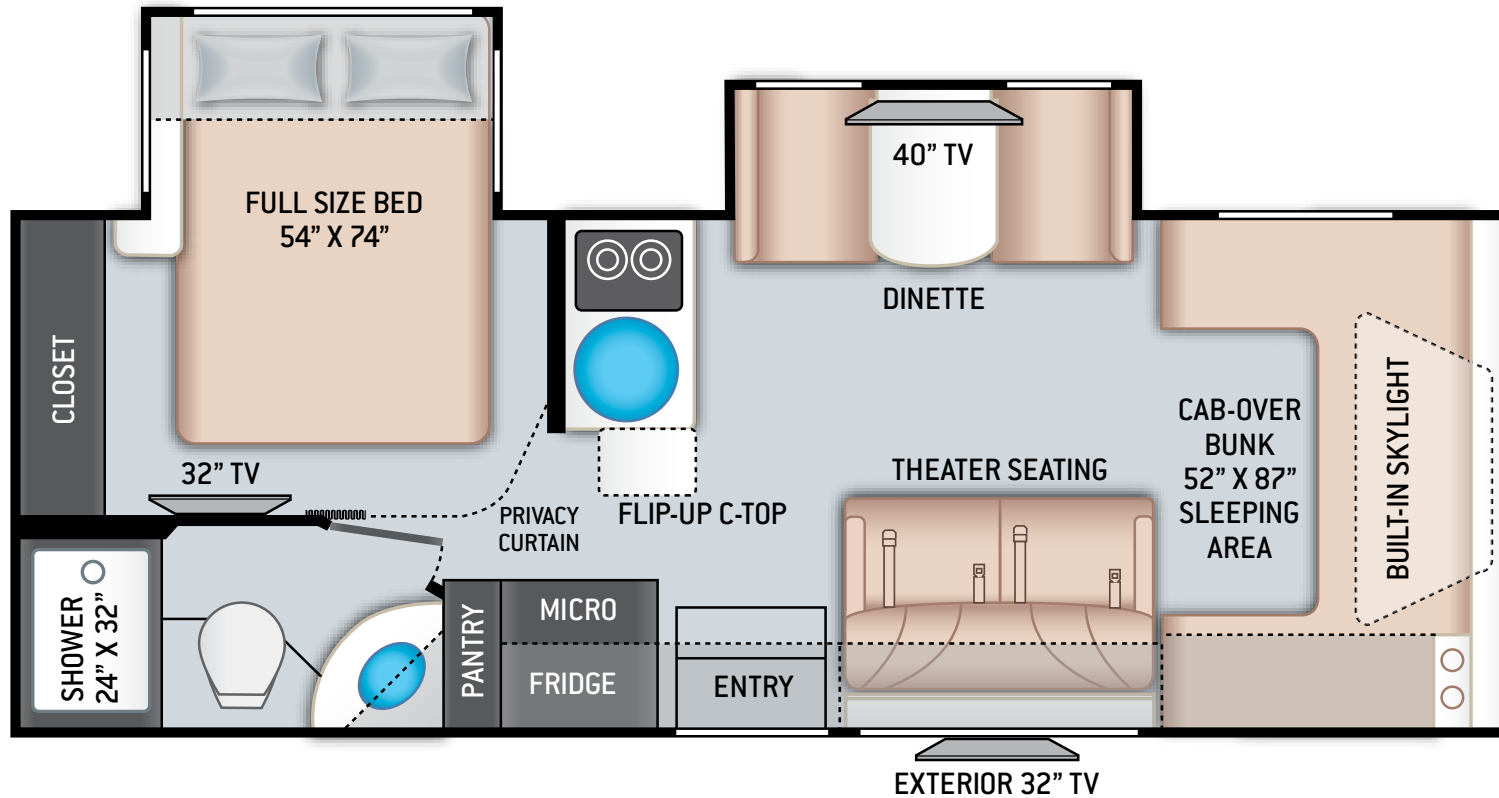

CR24 

# SPECIFICATIONS

CR24

CHASSIS	Mercedes-Benz
GROSS VEHICLE (GVWR)	11,030
GROSS COMBINED (GCWR)	15,250
WHEEL BASE	170.3"
EXTERIOR LENGTH (W/O LADDER)	25'-8"
EXTERIOR HEIGHT (W/AC)	12'-1"
EXTERIOR WIDTH (W/O MIRRORS)	90"
INTERIOR HEIGHT (LIVING AREA)	84"
AWNING SIZE	16'
FUEL (GAL)	26.4
LPG (LBS)	68.2
FRESH/WASTE/GRAY WATER (GAL)	30 / 34.5 / 37
WATER HEATER (GAL)	Tankless
FURNACE (BTUS)	30,000
EXTERIOR STORAGE CAPACITY (CU. FT.)	47
HITCH WEIGHT RATING (LBS)	5,000

# FLOOR PLANS

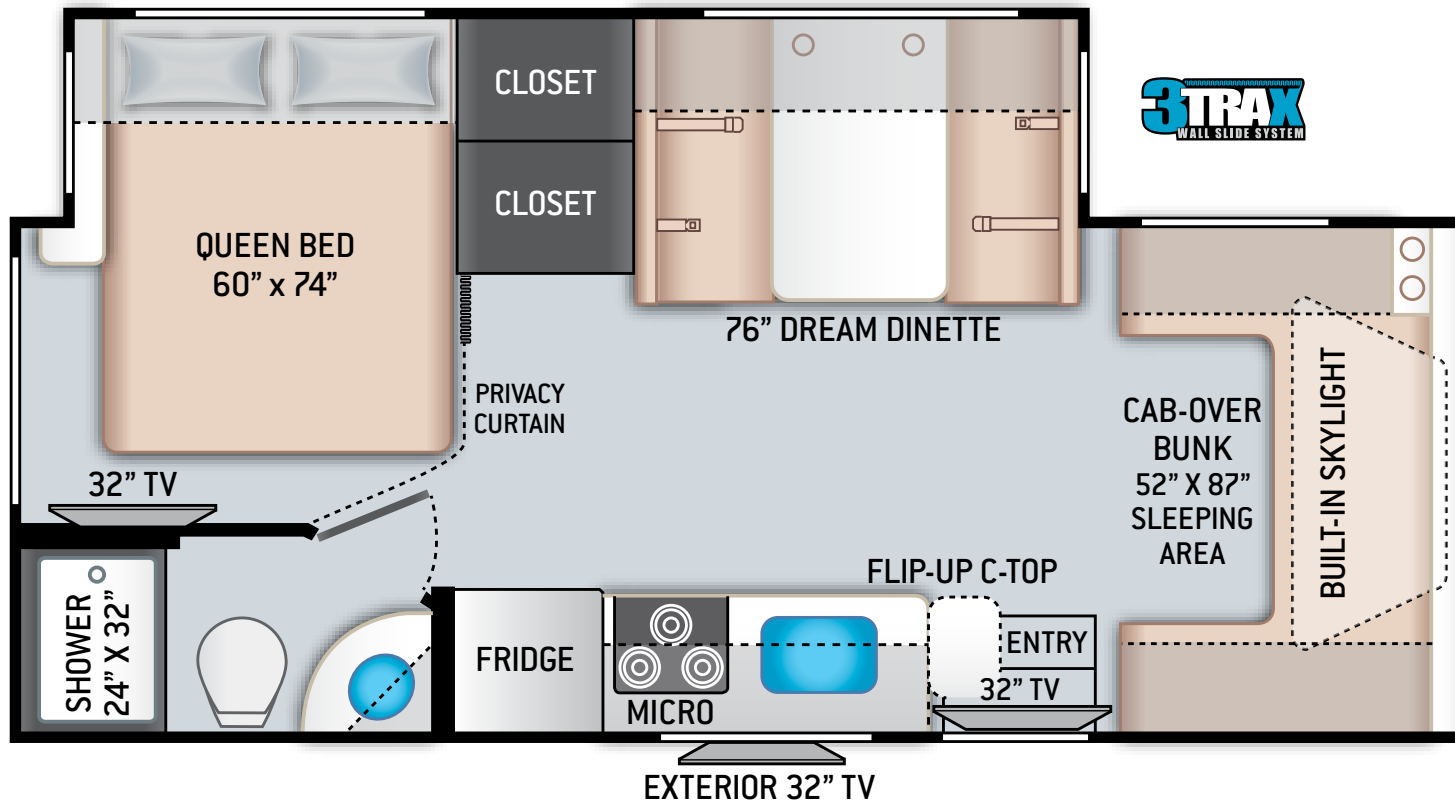

KM24 

# SPECIFICATIONS

KM24

CHASSIS	Mercedes-Benz
GROSS VEHICLE (GVWR)	11,030
GROSS COMBINED (GCWR)	15,250
WHEEL BASE	170.3"
EXTERIOR LENGTH (W/O LADDER)	24'-8"
EXTERIOR HEIGHT (W/AC)	12'-1"
EXTERIOR WIDTH (W/O MIRRORS)	90"
INTERIOR HEIGHT (LIVING AREA)	84"
AWNING SIZE	15'
FUEL (GAL)	26.4
LPG (LBS)	68.2
FRESH/WASTE/GRAY WATER (GAL)	30 / 24.5 / 38
WATER HEATER (GAL)	Tankless
FURNACE (BTUS)	30,000
EXTERIOR STORAGE CAPACITY (CU. FT.)	48.5
HITCH WEIGHT RATING (LBS)	5,000

# FLOOR PLANS

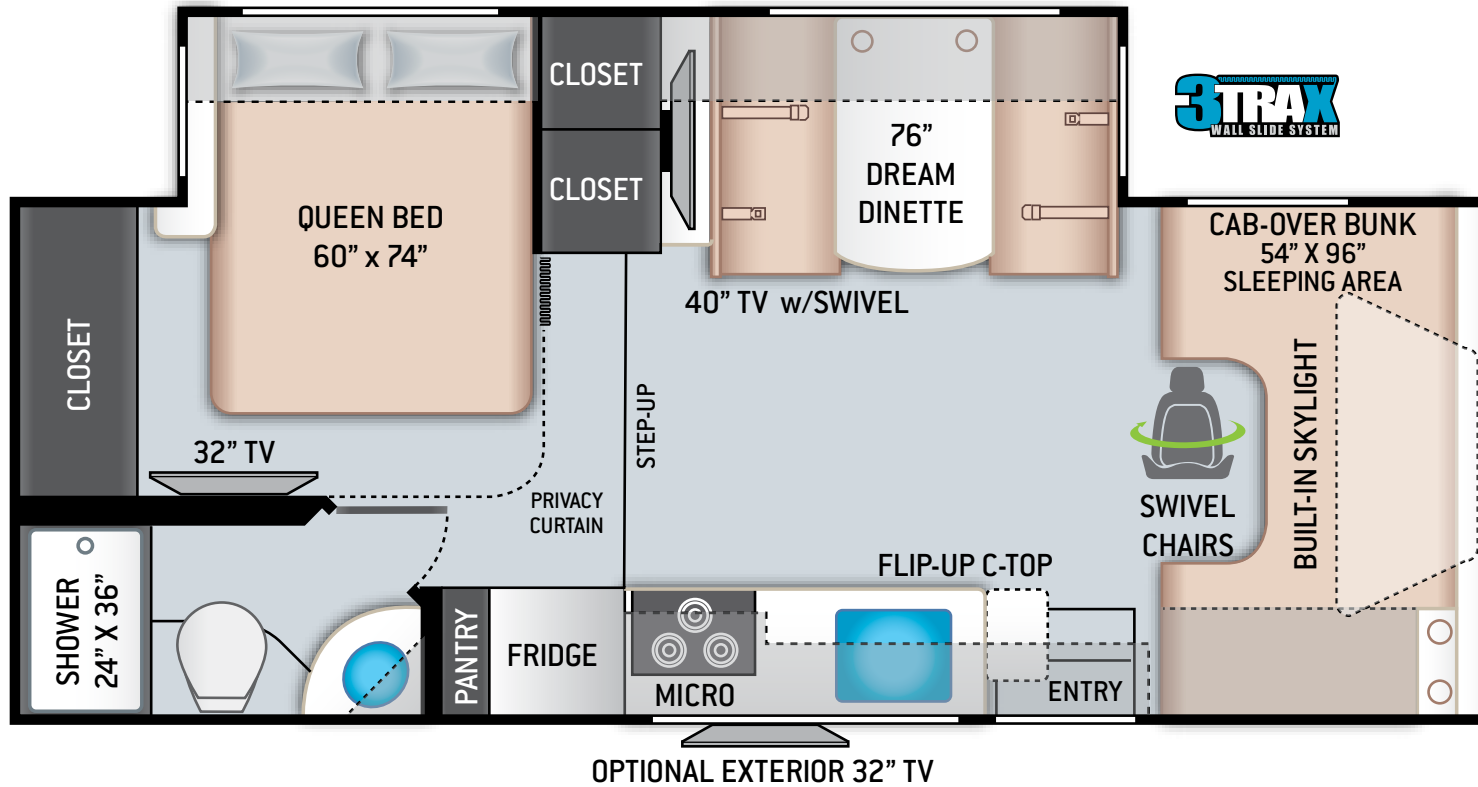

## RC25

# SPECIFICATIONS

RC25

<b>CHASSIS</b>	Ford
<b>GROSS VEHICLE (GVWR)</b>	14,500
<b>GROSS COMBINED (GCWR)</b>	22,000
<b>WHEEL BASE</b>	178"
<b>EXTERIOR LENGTH (W/O LADDER)</b>	26'-3"
<b>EXTERIOR HEIGHT (W/AC)</b>	11'-2"
<b>EXTERIOR WIDTH (W/O MIRRORS)</b>	99"
<b>INTERIOR HEIGHT (LIVING AREA)</b>	84"
<b>AWNING SIZE</b>	16'
<b>FUEL (GAL)</b>	55
<b>LPG (LBS)</b>	40.9
<b>FRESH/WASTE/GRAY WATER (GAL)</b>	40 / 34.5 / 37
<b>WATER HEATER (GAL)</b>	Tankless
<b>FURNACE (BTUS)</b>	30,000
<b>EXTERIOR STORAGE CAPACITY (CU. FT.)</b>	45.1
<b>HITCH WEIGHT RATING (LBS)</b>	8,000

# FLOOR PLANS

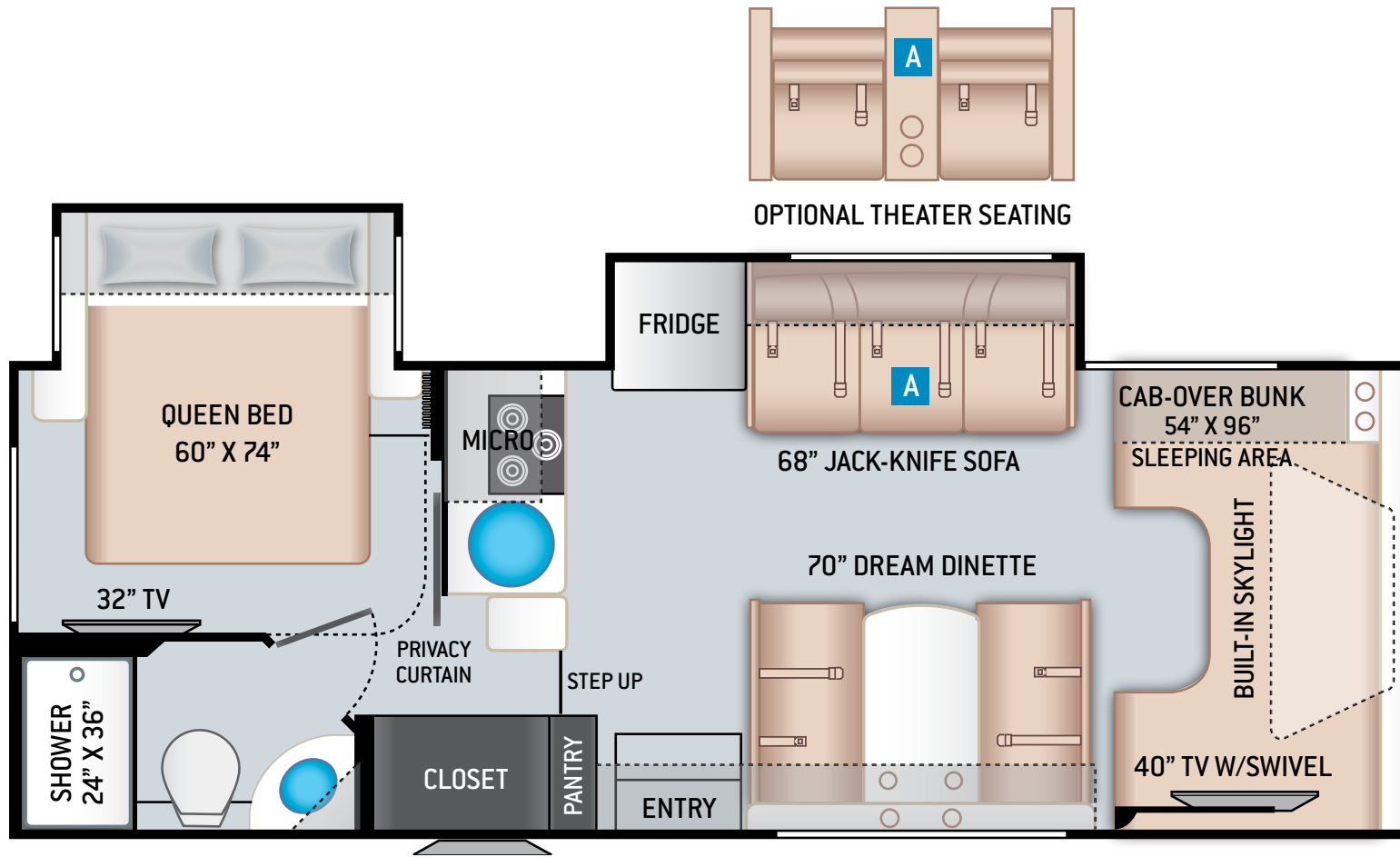

## LH26



# SPECIFICATIONS

LH26

<b>CHASSIS</b>	Ford / Chevy
<b>GROSS VEHICLE (GVWR)</b>	14,500 / 14,200
<b>GROSS COMBINED (GCWR)</b>	22,000 / 20,000
<b>WHEEL BASE</b>	190" / 191"
<b>EXTERIOR LENGTH (W/O LADDER)</b>	27'-6" / 28"
<b>EXTERIOR HEIGHT (W/AC)</b>	11'-2"
<b>EXTERIOR WIDTH (W/O MIRRORS)</b>	99"
<b>INTERIOR HEIGHT (LIVING AREA)</b>	84"
<b>AWNING SIZE</b>	18'
<b>FUEL (GAL)</b>	55 / 57
<b>LPG (LBS)</b>	40.9
<b>FRESH/WASTE/GRAY WATER (GAL)</b>	40 / 29 / 25
<b>WATER HEATER (GAL)</b>	Tankless
<b>FURNACE (BTUS)</b>	30,000
<b>EXTERIOR STORAGE CAPACITY (CU. FT.)</b>	25.1
<b>HITCH WEIGHT RATING (LBS)</b>	8,000

# FLOOR PLANS

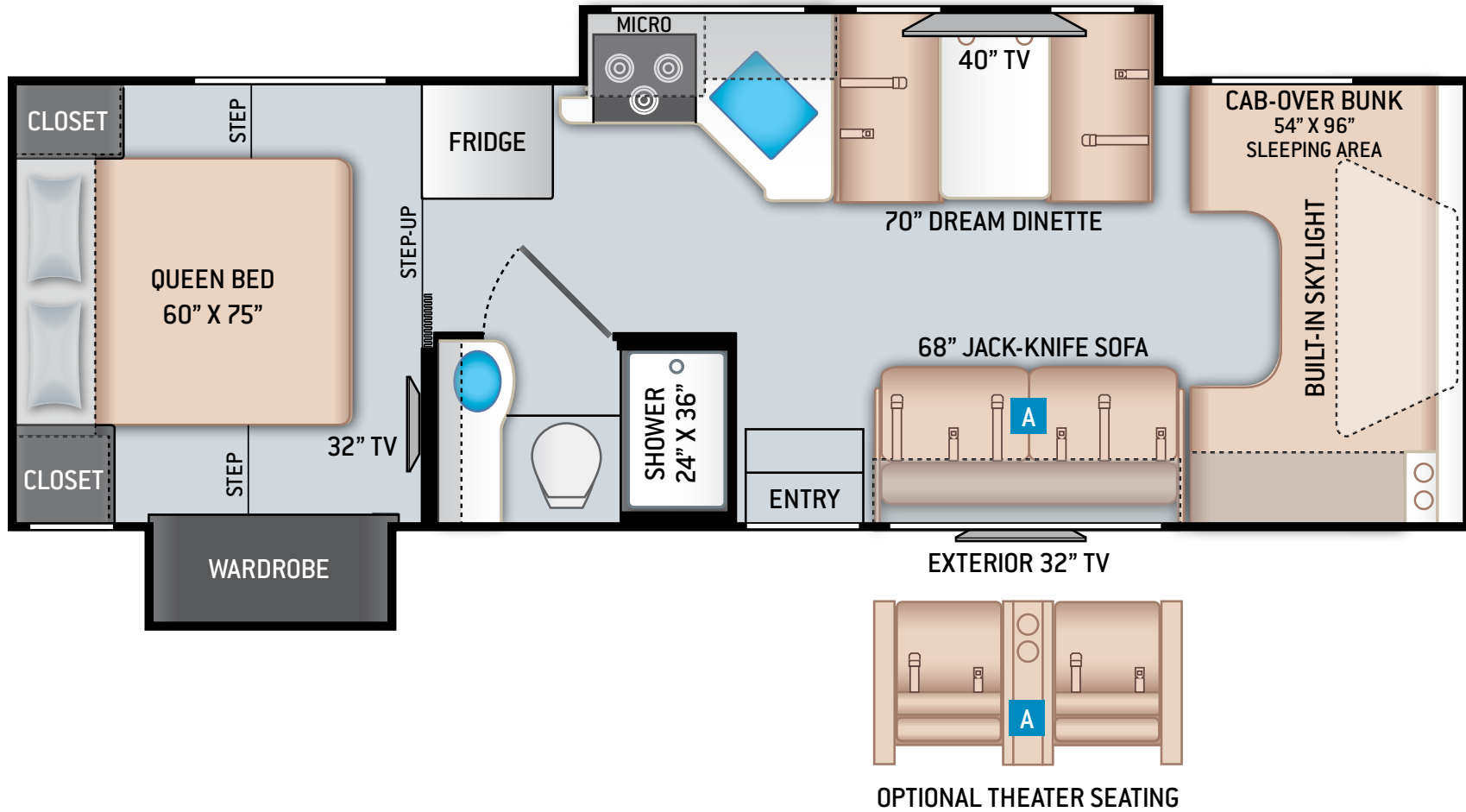

## RW28

# SPECIFICATIONS

RW28

<b>CHASSIS</b>	Ford
<b>GROSS VEHICLE (GVWR)</b>	14,500
<b>GROSS COMBINED (GCWR)</b>	22,000
<b>WHEEL BASE</b>	212"
<b>EXTERIOR LENGTH (W/O LADDER)</b>	30'-2"
<b>EXTERIOR HEIGHT (W/AC)</b>	11'-2"
<b>EXTERIOR WIDTH (W/O MIRRORS)</b>	99"
<b>INTERIOR HEIGHT (LIVING AREA)</b>	84"
<b>AWNING SIZE</b>	14'
<b>FUEL (GAL)</b>	55
<b>LPG (LBS)</b>	40.9
<b>FRESH/WASTE/GRAY WATER (GAL)</b>	40 / 26 / 32
<b>WATER HEATER (GAL)</b>	Tankless
<b>FURNACE (BTUS)</b>	30,000
<b>EXTERIOR STORAGE CAPACITY (CU. FT.)</b>	99.9
<b>HITCH WEIGHT RATING (LBS)</b>	8,000

# FLOOR PLANS

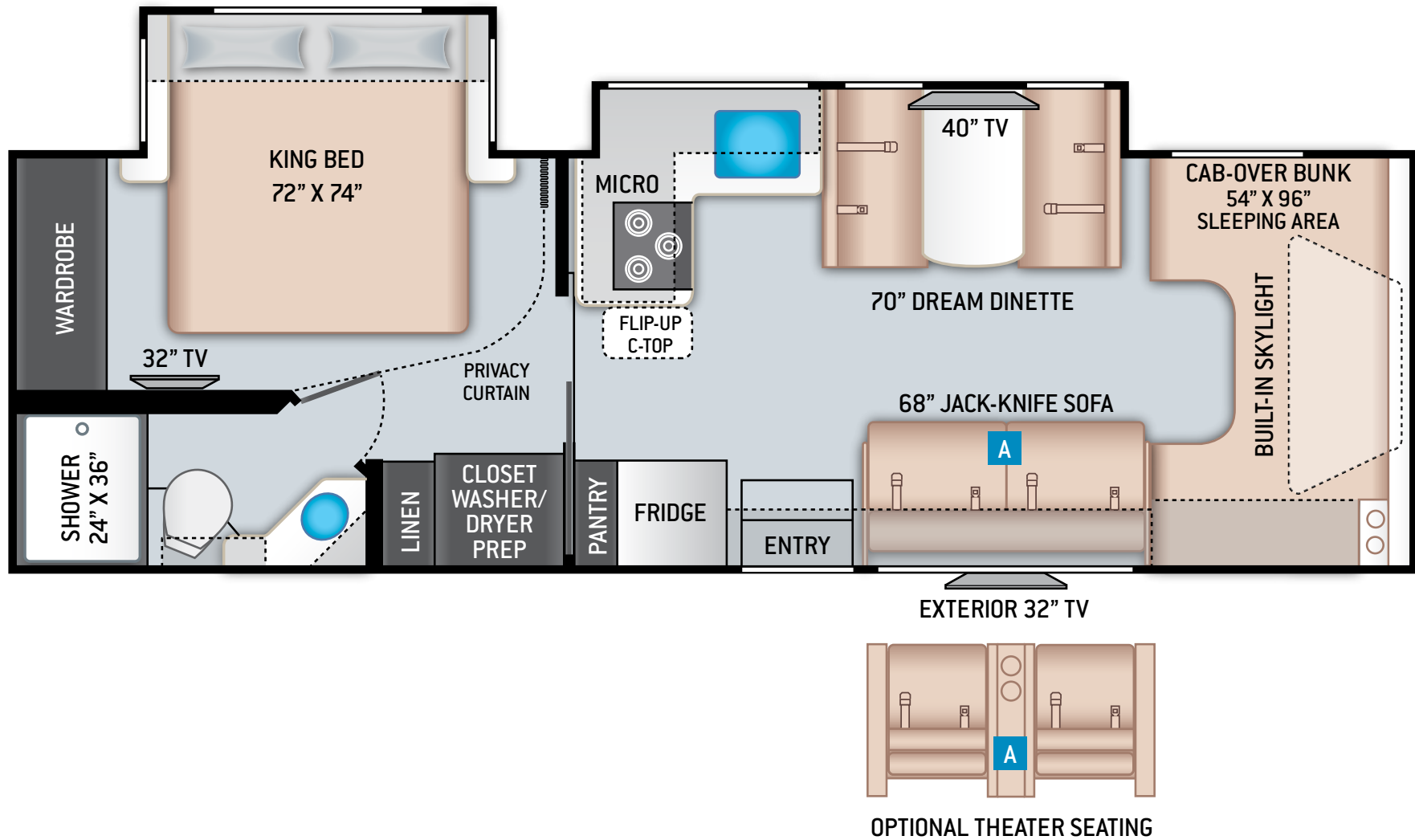

## KW29

# SPECIFICATIONS

KW29

<b>CHASSIS</b>	Ford
<b>GROSS VEHICLE (GVWR)</b>	14,500
<b>GROSS COMBINED (GCWR)</b>	22,000
<b>WHEEL BASE</b>	212"
<b>EXTERIOR LENGTH (W/O LADDER)</b>	30'-11"
<b>EXTERIOR HEIGHT (W/AC)</b>	11'-2"
<b>EXTERIOR WIDTH (W/O MIRRORS)</b>	99"
<b>INTERIOR HEIGHT (LIVING AREA)</b>	84"
<b>AWNING SIZE</b>	18'
<b>FUEL (GAL)</b>	55
<b>LPG (LBS)</b>	40.9
<b>FRESH/WASTE/GRAY WATER (GAL)</b>	40 / 34.5 / 37
<b>WATER HEATER (GAL)</b>	Tankless
<b>FURNACE (BTUS)</b>	30,000
<b>EXTERIOR STORAGE CAPACITY (CU. FT.)</b>	50.4
<b>HITCH WEIGHT RATING (LBS)</b>	8,000

# FLOOR PLANS

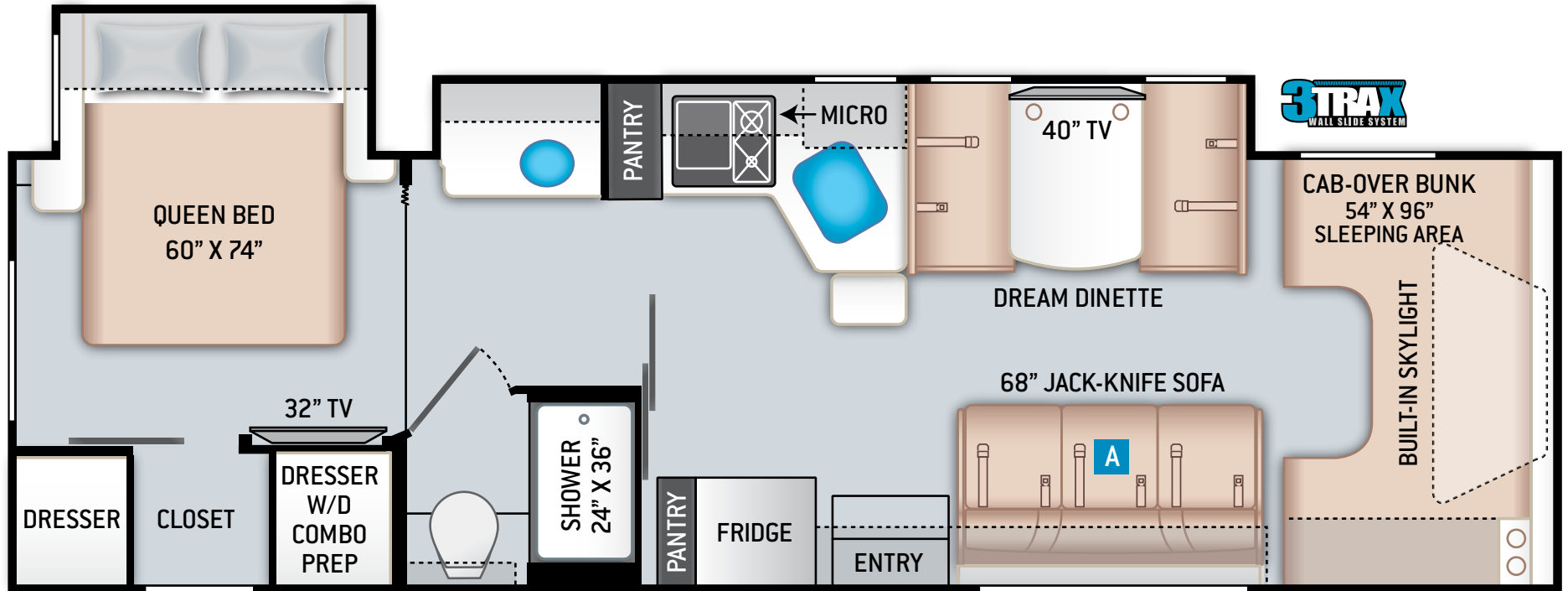

EXTERIOR 32" TV

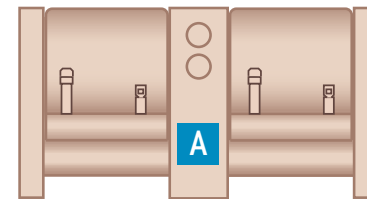

OPTIONAL THEATER SEATING

# JM31

# SPECIFICATIONS

JM31

<b>CHASSIS</b>	Ford
<b>GROSS VEHICLE (GVWR)</b>	14,500
<b>GROSS COMBINED (GCWR)</b>	22,000
<b>WHEEL BASE</b>	219"
<b>EXTERIOR LENGTH (W/O LADDER)</b>	32'-2"
<b>EXTERIOR HEIGHT (W/AC)</b>	11'-2"
<b>EXTERIOR WIDTH (W/O MIRRORS)</b>	99"
<b>INTERIOR HEIGHT (LIVING AREA)</b>	84"
<b>AWNING SIZE</b>	18'
<b>FUEL (GAL)</b>	55
<b>LPG (LBS)</b>	40.9
<b>FRESH/WASTE/GRAY WATER (GAL)</b>	40 / 31 / 35
<b>WATER HEATER (GAL)</b>	Tankless
<b>FURNACE (BTUS)</b>	30,000
<b>EXTERIOR STORAGE CAPACITY (CU. FT.)</b>	44.5
<b>HITCH WEIGHT RATING (LBS)</b>	8,000

# FLOOR PLANS

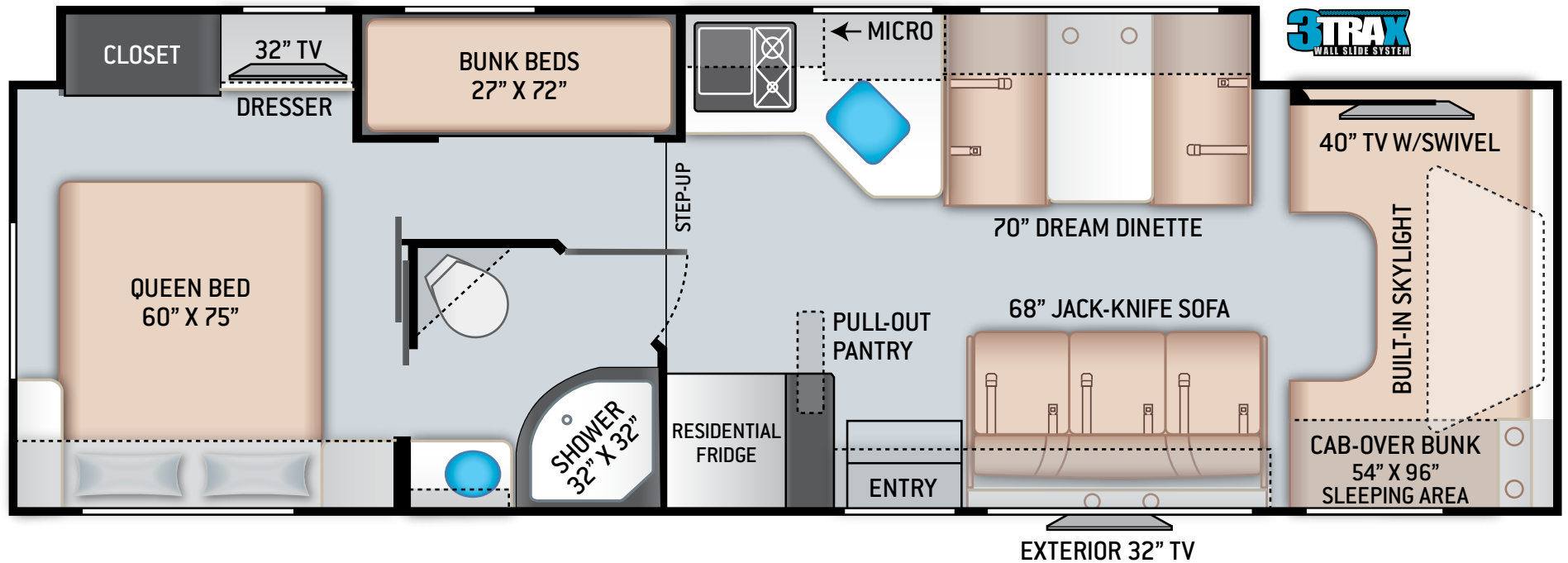

LF31



# SPECIFICATIONS

LF31

<b>CHASSIS</b>	Ford
<b>GROSS VEHICLE (GVWR)</b>	14,500
<b>GROSS COMBINED (GCWR)</b>	22,000
<b>WHEEL BASE</b>	223"
<b>EXTERIOR LENGTH (W/O LADDER)</b>	32'-7"
<b>EXTERIOR HEIGHT (W/AC)</b>	11'-2"
<b>EXTERIOR WIDTH (W/O MIRRORS)</b>	99"
<b>INTERIOR HEIGHT (LIVING AREA)</b>	84"
<b>AWNING SIZE</b>	16'
<b>FUEL (GAL)</b>	55
<b>LPG (LBS)</b>	40.9
<b>FRESH/WASTE/GRAY WATER (GAL)</b>	40 / 28 / 28
<b>WATER HEATER (GAL)</b>	Tankless
<b>FURNACE (BTUS)</b>	30,000
<b>EXTERIOR STORAGE CAPACITY (CU. FT.)</b>	55.7
<b>HITCH WEIGHT RATING (LBS)</b>	8,000

# FLOOR PLANS

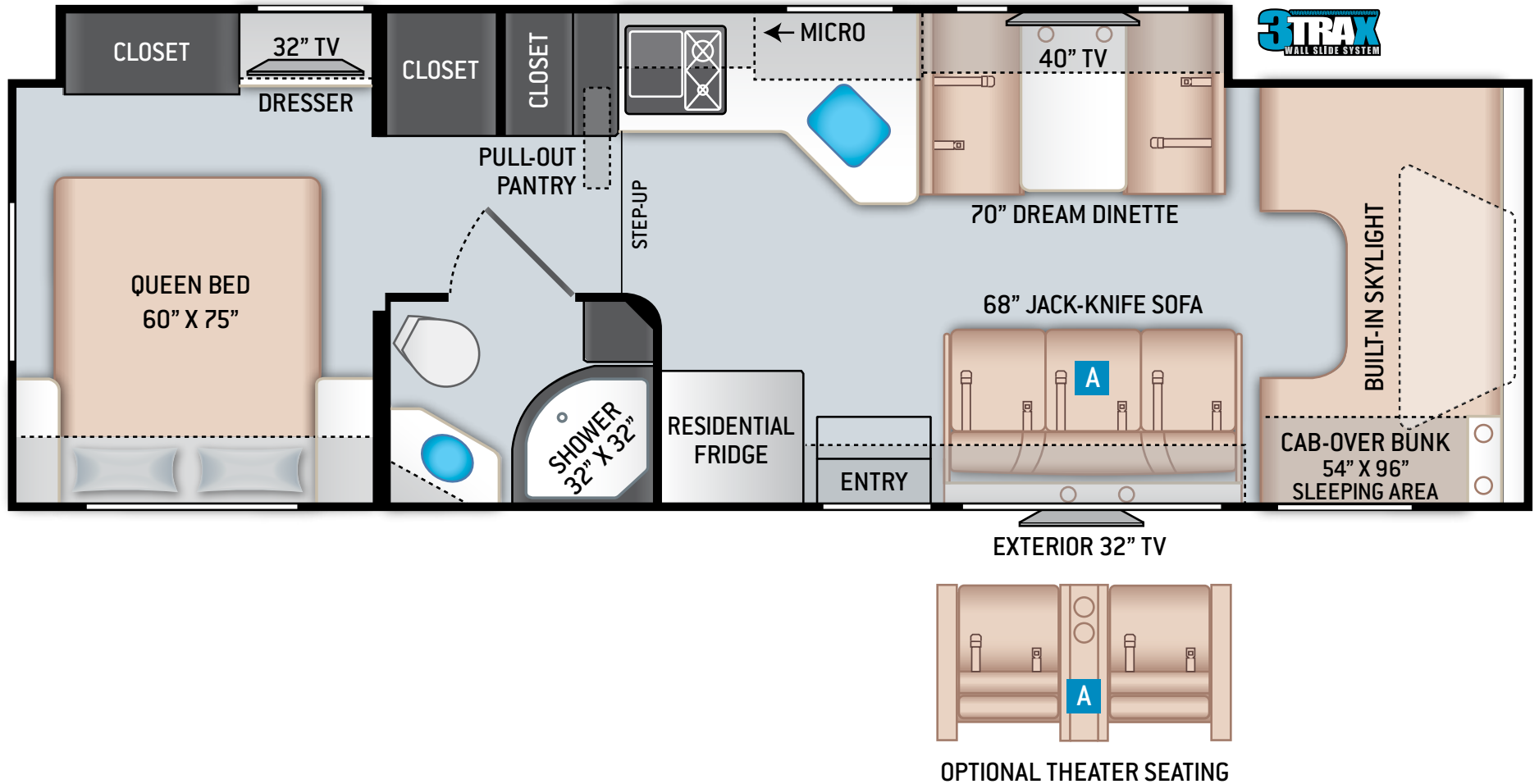

## WS31

# SPECIFICATIONS

WS31

<b>CHASSIS</b>	Ford
<b>GROSS VEHICLE (GVWR)</b>	14,500
<b>GROSS COMBINED (GCWR)</b>	22,000
<b>WHEEL BASE</b>	223"
<b>EXTERIOR LENGTH (W/O LADDER)</b>	32'-2"
<b>EXTERIOR HEIGHT (W/AC)</b>	11'-2"
<b>EXTERIOR WIDTH (W/O MIRRORS)</b>	99"
<b>INTERIOR HEIGHT (LIVING AREA)</b>	84"
<b>AWNING SIZE</b>	16'
<b>FUEL (GAL)</b>	55
<b>LPG (LBS)</b>	40.9
<b>FRESH/WASTE/GRAY WATER (GAL)</b>	40 / 28 / 28
<b>WATER HEATER (GAL)</b>	Tankless
<b>FURNACE (BTUS)</b>	30,000
<b>EXTERIOR STORAGE CAPACITY (CU. FT.)</b>	55.7
<b>HITCH WEIGHT RATING (LBS)</b>	8,000





# INTERIOR OPTIONS



ARCTIC FROST II

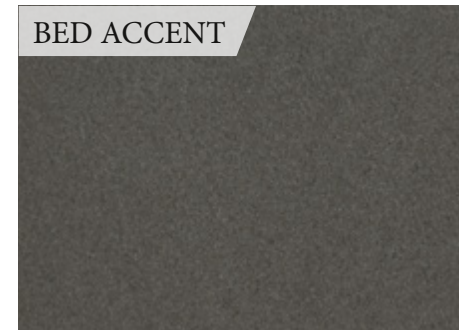

CLOUD NINE II



MIDTOWN TAUPE II

ARTISAN CHERRY



PRESTIGE MAPLE



KITCHEN COUNTERTOP



LEATHERETTE  
FURNITURE



DINETTE COUNTERTOP



LEATHERETTE  
ACCENT



BED & BATH COUNTERTOP



FLOORING



# SPECIAL FEATURES CLASS C



Winegard® Connect™ 2.0 4G LTE Router and WiFi Extender



Bedroom Charging Station with Dedicated CPAP Outlet and Storage Location



HDMI Video Distribution



Solar Prep - Includes Solar Controller



Tankless Water Heater



Black Tank Flush System



Back-up Monitor with Integrated Rear Wall Camera



SiriusXM® Radio





# SPECIAL FEATURES SPRINTER



Winegard® Connect™ 2.0  
WiFi / 4G / TV Antenna



Bedroom Charging Station with  
Dedicated CPAP Outlet and  
Storage Location



Exterior TV on Manual  
Swivel with Sound Bar



Solar Prep -  
Includes Solar Controller



Tankless Water Heater



Black Tank Flush System



Back-up Monitor with  
Integrated Rear Wall Camera



SiriusXM® Radio



# FEATURED HIGHLIGHTS CLASS C

## CONSTRUCTION & EXTERIOR

- ♦ Automatic Leveling Jacks (JM31, LF31 & WS31)
- ♦ HD-MAX® Exterior with Graphics Package (GR22, RC25, LH26, RW28 & KW29)
- ♦ MEGA-Storage™ Compartment (GR22, RC25, LH26, & RW28)
- ♦ Portable Table (RW28)
- ♦ Framed Slider Windows (GR22, RC25, LH26, RW28 & KW29)
- ♦ Frameless Slider Windows (JM31, LF31 & WS31)

## CONSTRUCTION & EXTERIOR OPTIONS

- ♦ Electric Stabilizing System (OPT GR22, & RW28 / STD RC25, LH26 & KW29)
- ♦ Partial Paint on HD-MAX® Exterior with Graphics Package (STD JM31, LF31, & WS31)
- ♦ Full Body Paint Package with Gel-Coat Sidewalls & Invisible Front Mask Paint Protection (KW29, JM31, LF31 & WS31)

## AUTOMOTIVE & COCKPIT

- ♦ Touchscreen Dash Radio with Navigation & Back-Up Monitor
- ♦ SiriusXM® Radio Tuner & Antenna
- ♦ Leatherette Captain's Chairs (GR22, RW28, KW29, JM31, LF31 & WS31)
- ♦ Leatherette Swivel Captain's Chairs with Filler Cushions (RC25)
- ♦ Deluxe Exterior Mirrors (GR22, RC25 & LH26)
- ♦ Emergency Engine Start Switch
- ♦ Aluminum Running Boards
- ♦ Stainless Steel Wheel Liners
- ♦ Valve Stem Extenders

## AUTOMOTIVE & COCKPIT OPTIONS

- ♦ Heated/Remote Exterior Mirrors with Integrated Side View Camera (STD RW28, KW29, JM31, LF31 & WS31)
- ♦ Power Driver's Seat - Ford® Chassis Only (OPT RW28, KW29, JM31, LF31 & WS31)
- ♦ Cockpit Carpet Mat

## INTERIOR

- ♦ Leatherette Jack-Knife Sofa (LH26, RW28, KW29, JM31, LF31 & WS31)
- ♦ Leatherette Dream Dinette® Booth
- ♦ 40" TV in Living Area
- ♦ 32" TV in Bedroom
- ♦ Two (2) 15" TVs w/DVD Player in Bunk Bed Area (LF31)
- ♦ HDMI Video Distribution Box
- ♦ Winegard® ConnetT™ 2.0 4G LTE Router & WiFi Extender
- ♦ Wall Cubby with Net & USB Charging Port
- ♦ USB Charging Port at Dinette
- ♦ Double Door Gas/Electric RV Refrigerator with Smoked Acrylic Panel Inserts (GR22, RC25, LH26, RW28 & KW29)
- ♦ Residential Refrigerator with Ice Maker (JM31, LF31 & WS31)
- ♦ Recessed 3-Burner Gas Cooktop with Glass Cover (GR22, RC25, LH26, RW28 & KW29)
- ♦ 2-Burner Gas with Single Induction Cooktop (JM31, LF31 & WS31)
- ♦ Microwave Oven (GR22, RC25, LH26, RW28 & KW29)

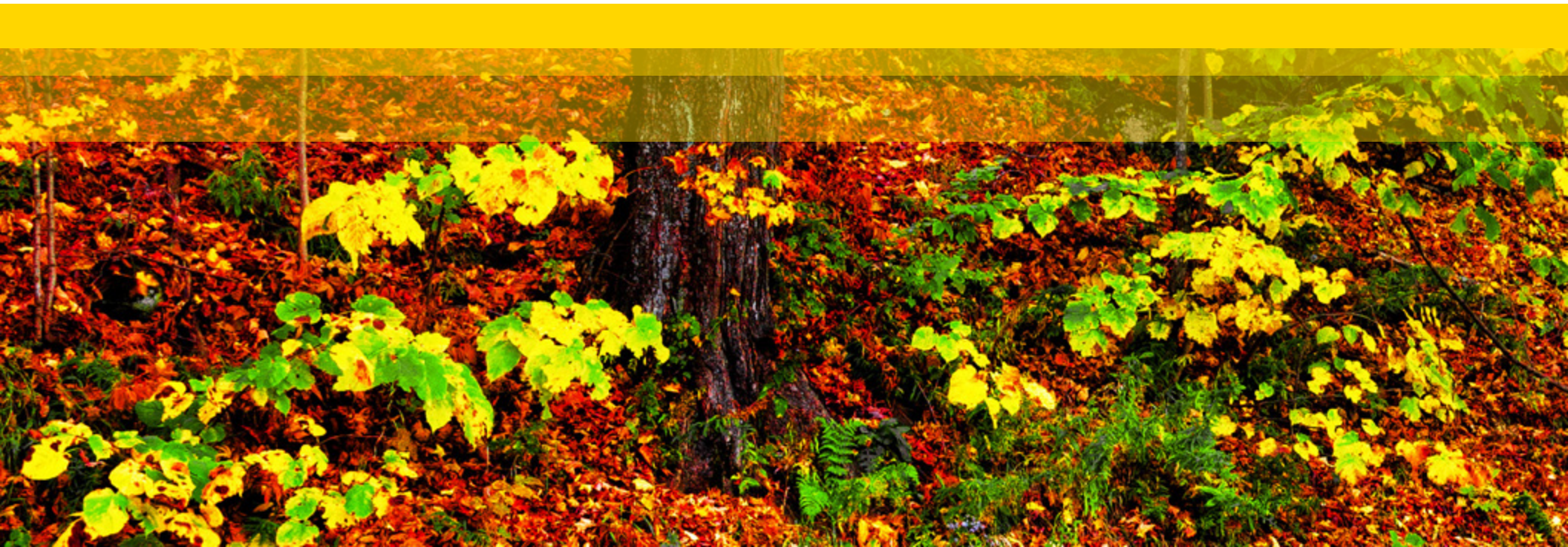

- ◆ 30" Over-the-Range Convection Microwave Oven (JM31, LF31 & WS31)
- ◆ Flip-Up Countertop Extension (RC25, LH26, KW29 & JM31)
- ◆ Pop-Up Countertop Outlet & Charging Center (JM31, LF31 & WS31)
- ◆ Solid Surface Kitchen Countertops
- ◆ Queen Size Bed (N/A KW29)
- ◆ King Size Bed (KW29)
- ◆ Bedroom 12-volt Outlet for CPAP Machine
- ◆ 12-volt Attic Fan with Cover in Bedroom

#### **INTERIOR OPTIONS**

- ◆ Leatherette Theater Seat IPO Jack-Knife Sofa (LH26, RW28, KW29, JM31 & WS31)
- ◆ Cab-Over Child Safety Net
- ◆ 12-volt Attic Fan with Cover in Cab-Over Bunk
- ◆ Single Child Safety Tether in Dinette
- ◆ Recessed 3-Burner Gas Cooktop/Oven with Glass Cover (GR22, RC25, LH26, RW28 & KW29)
- ◆ Convection Microwave Oven (GR22, RC25, LH26, RW28 & KW29)

- ◆ 32" Exterior TV on Manual Swivel with Bluetooth® Sound Bar (STD - RW28, KW29, JM31, LF31 & WS31)

#### **ELECTRICAL & PLUMBING**

- ◆ Onan® RV QG 4000 Gas Generator
- ◆ Automatic Generator Start (JM31, LF31 & WS31)
- ◆ 30-amp Shoreline Power Cord
- ◆ 1800-watt Inverter (JM31, LF31 & WS31)
- ◆ Second Auxiliary House Battery
- ◆ Battery Tray for Four (4) Batteries (JM31, LF31 & WS31)
- ◆ Solar Prep - Includes Solar Controller
- ◆ Tankless Water Heater
- ◆ 13,500 BTU Roof Front Air Conditioner (GR22, RC25 & LH26)
- ◆ 15,000 BTU Roof Front Air Conditioner (RW28, KW29, JM31, LF31 & WS31)
- ◆ Exterior LP Connection
- ◆ Whole Coach Water Filtration System (JM31, LF31 & WS31)
- ◆ Outside Shower
- ◆ 360° Siphon® RV Holding Tank Vent Cap

- ◆ Black Tank Flush System
- ◆ Enclosed Sewer Area for Sewer Tank Valves (JM31, LF31 & WS31)
- ◆ Holding Tanks with Heat Pads
- ◆ Stackable Washer/Dryer Prep (KW29)
- ◆ Combo Washer/Dryer Prep (JM31)
- ◆ Rapid Camp® Wireless Control System (JM31, LF31 & WS31)

#### **ELECTRICAL & PLUMBING OPTIONS**

- ◆ 15,000 (IPO 13,500) BTU Roof Front Air Conditioner (GR22, RC25 & LH26)
- ◆ Dual 11,000 BTU Roof Air Conditioners IPO 15,000 BTU Roof Air Conditioner (KW29, JM31, LF31, & WS31)

**For a complete listing of available features visit [thormotorcoach.com/quantum](http://thormotorcoach.com/quantum).**

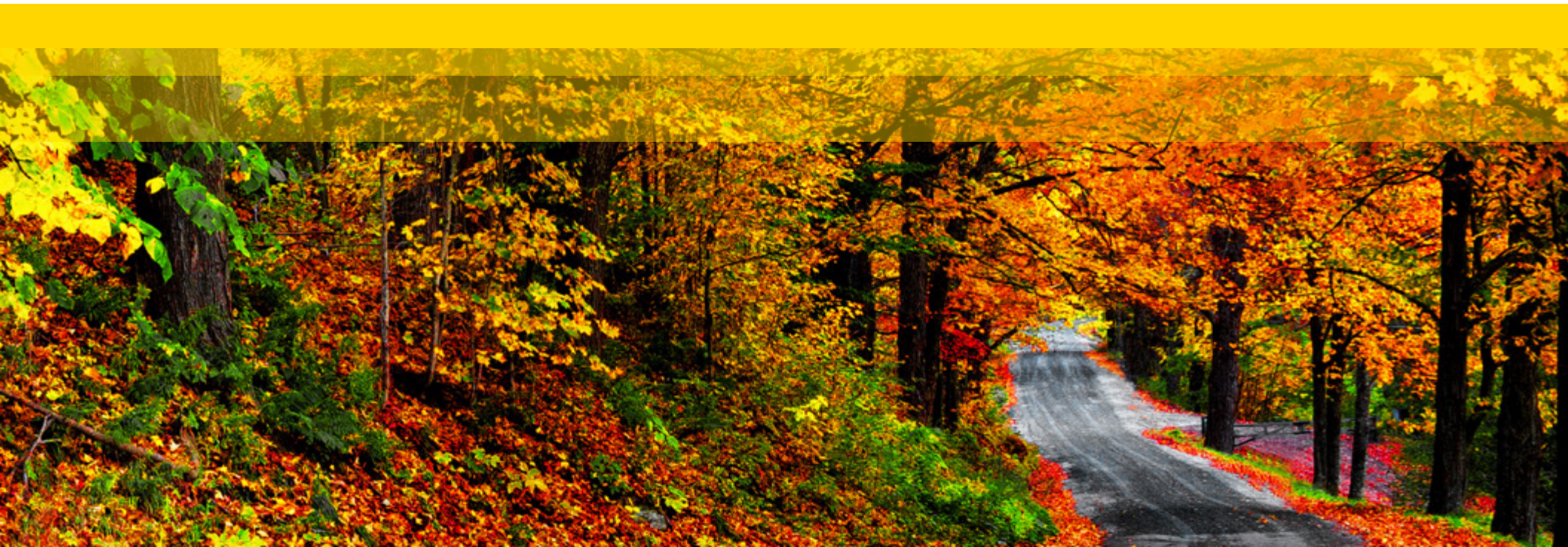

# FEATURED HIGHLIGHTS SPRINTER

---

## CONSTRUCTION & EXTERIOR

- ◆ Electric Stabilizing System
- ◆ Fiberglass Front Cap with Skylight & Power Shade
- ◆ HD-MAX® Exterior with Graphics Package
- ◆ Lighted Rotocast Storage Compartments
- ◆ Flush Mount Radius Compartment Doors
- ◆ Power Patio Awning with Integrated LED Lighting

## CONSTRUCTIVE & EXTERIOR OPTIONS

- ◆ Full-Body Paint Package with Invisible Front Mask Paint Protection

## AUTOMOTIVE & COCKPIT

- ◆ Touchscreen Dash Radio with Back-Up Monitor & Integrated Camera
- ◆ SiriusXM® Radio Tuner & Antenna
- ◆ Heated/Remote Exterior Mirrors
- ◆ Leatherette Swivel Captain's Chairs with Two (2) Filler Cushions
- ◆ Cockpit Carpet Mat
- ◆ Stainless Steel Wheel Liners
- ◆ Keyless Entry System
- ◆ Valve Stem Extenders

## INTERIOR

- ◆ 40" TV in Living Area (CR 24)
- ◆ 32" TV on Manual Swivel in Living Area (KM24)
- ◆ 32" TV in Bedroom
- ◆ 32" Exterior TV on Manual Swivel with Bluetooth® Sound Bar
- ◆ HDMI Video Distribution Box
- ◆ Winegard® ConneCT™ 2.0 4G LTE Router & WiFi Extender
- ◆ Cab-Over Bunk Ladder
- ◆ Wall Cubby with Net & USB Charging Port
- ◆ Leatherette Theater Seating with Footrests (CR24)
- ◆ Leatherette Dream Dinette® Booth (KM24)
- ◆ Leatherette Dinette Booth with Two (2) Storage Drawers (CR24)



- ◆ Double Door Gas/Electric RV Refrigerator with Smoked Acrylic Panel Inserts
- ◆ 3-Burner Gas Cooktop with Glass Cover (KM24)
- ◆ 2-Burner Gas Cooktop with Glass Cover & Electric Start (CR24)
- ◆ Convection Microwave Oven
- ◆ Solid Surface Kitchen Countertop
- ◆ 12-volt Fan in Kitchen
- ◆ Queen Size Bed (KM24)
- ◆ Full Size Bed (CR24)
- ◆ Bedroom 12-volt Outlet for CPAP Machine
- ◆ 12-volt Attic Fan with Cover in Bathroom & Bedroom

#### **INTERIOR OPTIONS**

- ◆ Cab-Over Child Safety Net
- ◆ 12-volt Attic Fan with Cover in Cab-Over Bunk
- ◆ Single Child Safety Tether in Dinette (KM24)

#### **ELECTRICAL & PLUMBING**

- ◆ Onan® RV QG 3600 LP Generator
- ◆ 30-amp Shoreline Power Cord
- ◆ Automatic Shoreline-to-Generator Transfer Switch
- ◆ Battery Disconnect Switch
- ◆ Second Auxiliary House Battery
- ◆ 13,500 BTU Roof Front Air Conditioner
- ◆ Systems Control Center

- ◆ Exterior LP Connection
- ◆ Solar Prep - Includes Solar Controller
- ◆ Tankless Water Heater
- ◆ 1" Fresh Water Tank Drain
- ◆ 360° Siphon® RV Holding Tank Vent Cap
- ◆ Holding Tanks with Heat Pads
- ◆ Black Tank Flush System
- ◆ Outside Shower

#### **ELECTRICAL & PLUMBING OPTIONS**

- ◆ 15,000 (IPO 13,500) BTU Roof Front Air Conditioner

**For a complete listing of available features, visit [thormotorcoach.com/quantum-sprinter](http://thormotorcoach.com/quantum-sprinter).**





**Made to fit.**

Colton RV  
North Tonawanda, NY 14120  
(716) 694-0188  
(800) 628-4889  
[www.ColtonRV.com](http://www.ColtonRV.com)

Colton RV  
Orchard Park, NY 14127  
(716) 957-3250  
(800) 628-4889  
[www.Coltonrv.com](http://www.Coltonrv.com)

**IMPORTANT—PLEASE READ:** This brochure reflects product design, fabrication, material, components and specifications at the date of printing, which date is disclosed below. **Please visit us online at [ThorMotorCoach.com](http://ThorMotorCoach.com) or consult with your selling dealership for the latest in standards, options, specification and technical information.** Photographs in the brochure may depict optional equipment or may only be available in certain floor plans. Components, appliances and the chassis may have been manufactured in a calendar year before the vehicle's designated model year. All capacities are approximate. The actual length of the vehicle may differ from that indicated in the brochure due to variances in the manufacturing processes and/or installed components. All dry weights are based on standard model features and do not include optional features or equipment. Component part and appliance manufacturers issue limited warranties covering portions of the vehicle not covered under the limited warranty we issue. Copyright Thor Motor Coach, Inc. © OH 11/01/19



[thormotorcoach.com/quantum](http://thormotorcoach.com/quantum)

P.O. Box 1486, Elkhart, IN 46515 Sales Department: 800.860.5658 Customer Service: 877.855.2867