

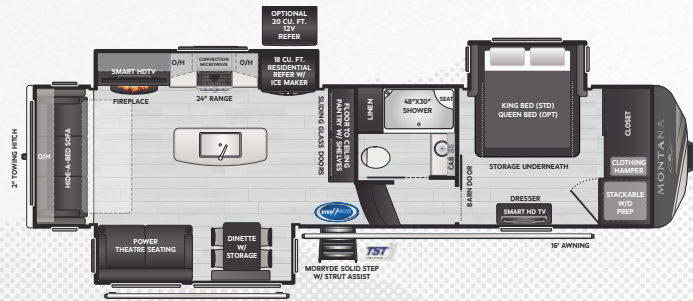

KEYSTONE
RV COMPANY

MONTANA

2025 | FIFTH WHEELS



3123RL | WEIGHT 12530 | LENGTH 35' 1"

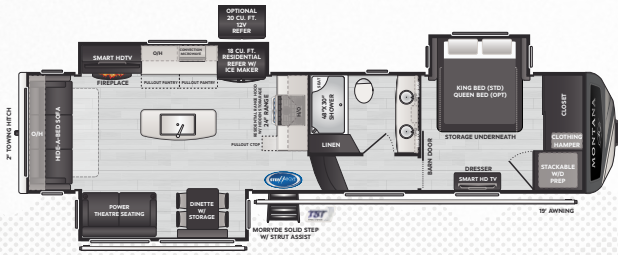

3231CK | WEIGHT 12903 | LENGTH 37' 5"

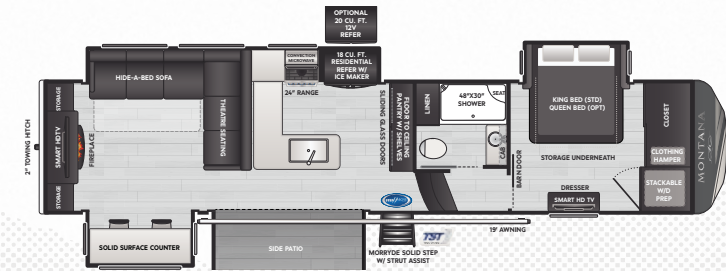

3531RE | WEIGHT 13116 | LENGTH 38' 7"

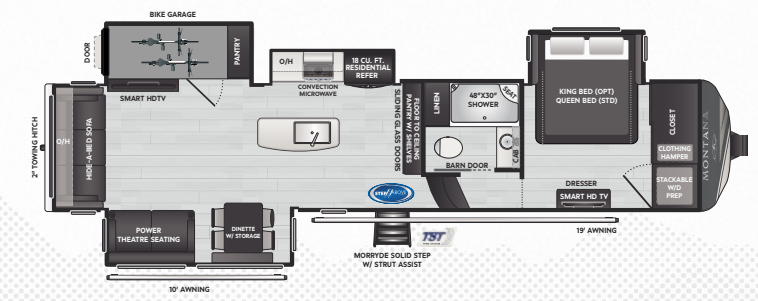

3623EB | WEIGHT 13835 | LENGTH 40' 2"

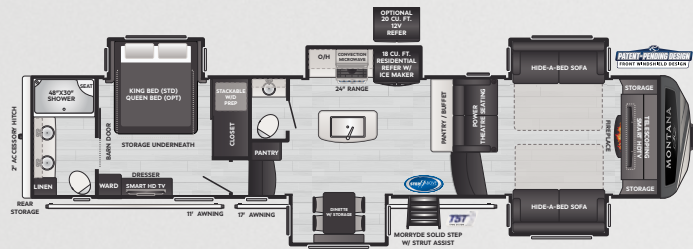

3761FL | WEIGHT 14641 | LENGTH 41' 0"

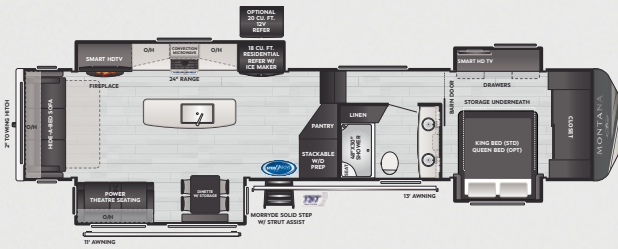

3781RL | WEIGHT 13790 | LENGTH 41' 0"

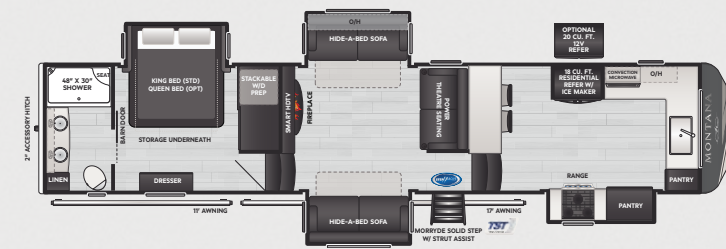

3795FK | WEIGHT 13870 | LENGTH 39' 11"

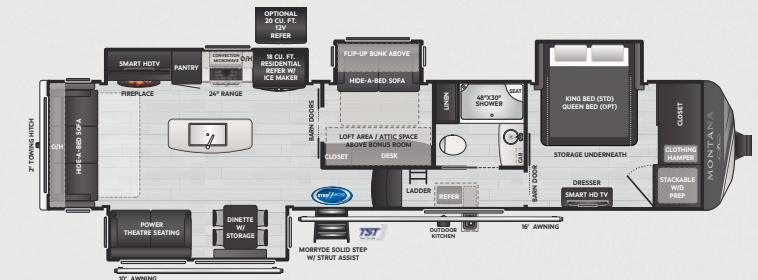

3857BR | WEIGHT 14369 | LENGTH 40' 11"

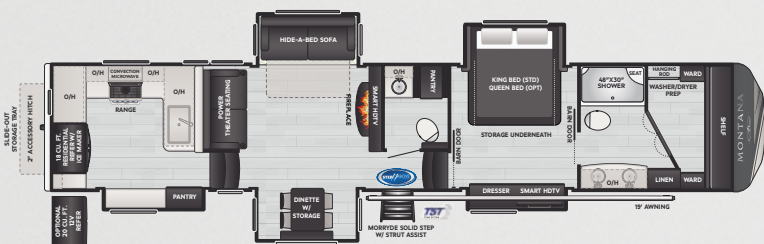

3901RK | WEIGHT 14755 | LENGTH 42' 4"

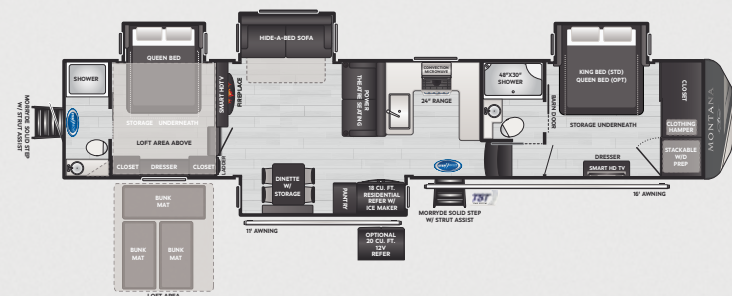

3915TB | WEIGHT 15130 | LENGTH 43' 0"

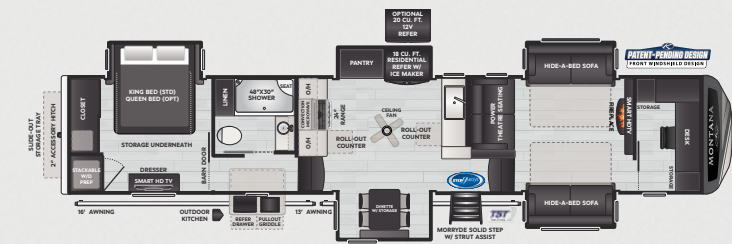

3941FO | WEIGHT 15267 | LENGTH 42' 7"

DISCLAIMER: Product information is as accurate as possible as of the date of this publication. All features, floor plans, and specifications are subject to change without notice. Pre-production estimated weights & lengths may be listed; visit Keystonerv.com for the most current product information and specifications.

CAMP BETTER
KINDNESS · COMMUNITY · PLANET





KEYSTONE
RV COMPANY

MONTANA

2025 | FIFTH WHEELS

INTERIOR

- » La-Z-Boy® Furniture Package
- » Manhattan Maple Interiors w/ Birch & Glazed White Accents
- » Hardwood Cabinet Drawers, Doors, Stiles and Window Treatments
- » Soft Close Cabinet Drawers and Doors
- » Solid Surface Countertops
- » Belair Vinyl Flooring by Shaw® w/ 7-Year Cold Cracking Warranty
- » Island Design w/ built in Dog Dishes (select floorplans)
- » Waterfall Sink with Added Attachments
- » Dishwasher Prep (select floorplans)
- » Larger, 24" Furrion Stove w/ Matching Stainless Steel Drawer
- » Stainless Steel Convection Microwave
- » 50" Smart TV in the Living Room
- » JBL® Stereo with Mizone Control & Subwoofer
- » 32" Smart TV in the Bedroom
- » Central Vacuum with Toe Kick
- » Adjustable Shelving in Pantry
- » Flip Up Jewelry Box Storage Built into Bedroom Dresser Top
- » Sliding Silverware Storage Built into Free Standing Dinette Table
- » Dual Suite Front Closet with Trifold Doors giving 6' of Unobstructed Opening
- » Bathroom Storage W/ Built-In spot for Hair Dryer & Curling Iron

EXTERIOR

- » NEW Dynamic Exterior Graphics
- » Square Frameless Windows with built in reflective shades
- » Fibrogloss™ High-Gloss Sidewalls
- » 30" X 78" Oversized Entry Door
- » MORryde Telescoping Entry Door Rail
- » MORryde Strut Assist Flip Down Solid Steps
- » Insulated Baggage Doors
- » Split Baggage Doors on Off Door Side For Easier Access to Convenience Center (select floorplans)
- » Black Tank Flush
- » 3K LBS. Tow Hitch (3123RL, 3231CK, 3531RE, 3781RL, 3857BR)
- » 300 LBS. Accessory Hitch (3761FL, 3795FK, 3901RK, 3941FO)

EQUIPMENT

- » 7k Dexter® Gladiator™ Axles w/ Upgraded Springs & Nev-R-Adjust Brakes
- » Upgraded 8k Dexter® Gladiator™ Axles Standard on 3761FL, 3901RK, 3915TB, 3941FO
- » H-Rated Cooper® Tires Standard on all Models
- » Lippert® Titan Leveling Systems™ Hydraulic Auto-Leveling System w/ Digital Touchscreen & Under Frame LED Lighting
- » Lippert® Road Armor™ Suspension w/ 1/2" Shackle Plates, Wet Bolts & Bronze Bushing
- » 16-Gallon Gas/Electric Suburban Water Heater
- » Seaflo® Water Pump, 12 Db Quieter
- » Water Filtration System
- » 35K BTU Furnace & Up to 16.5K BTU Heat Pump
- » (2) Coleman®-Mach® PowerSaver A/C (<12AMP Draw Each)
- » Blade Pure™ High-Performance Air Flow System w/ Merv 9 Filtration
- » Maxxair Vent Fans in Kitchen and Bathroom W/ Rain Sensor

CONSTRUCTION

- » Drop-Frame Construction
- » One-Piece Alpha SuperFlex™ TPO Roof Membrane w/ Limited Lifetime Warranty
- » 5" Roof Truss with Built in Attic Vent
- » 5- Layer Automotive Painted Front Cap W/ HitchVision
- » 2" Exterior Wall Construction
- » 3" Interior Wall Construction
- » 5/8" Dyna Span Floor Decking with 25 Year Warranty
- » 6'6" Slide Room Height in Living Rooms
- » 12V Color-Coded Wiring
- » Tuf-Lok™ Thermoplastic A/C Duct Joiner
- » 70 Gallon Roto-Cast Fresh Water Tank
- » 3M™ Breathable Graphics

STANDARD FEATURES



DISCLAIMER: Product information is as accurate as possible as of the date of this publication. All features, floor plans, and specifications are subject to change without notice. Pre-production estimated weights & lengths may be listed; visit Keystonerv.com for the most current product information and specifications.

CAMP BETTER
KINDNESS · COMMUNITY · PLANET





KEYSTONE
RV COMPANY

MONTANA

HIGH COUNTRY

2025 | FIFTH WHEELS

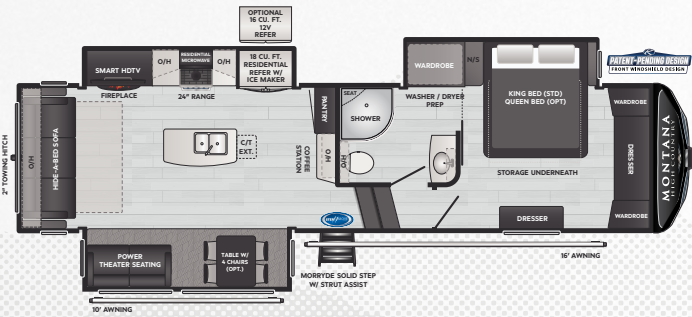

295RL | WEIGHT 11595 | LENGTH 34' 0"

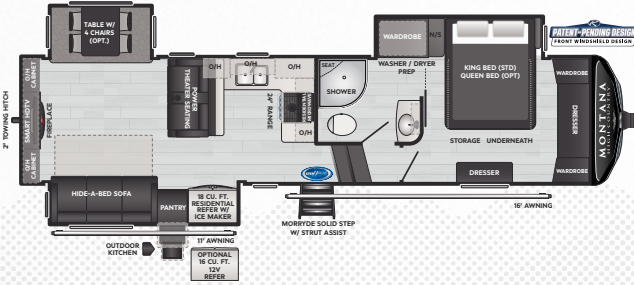

311RD | WEIGHT 11880 | LENGTH 35' 0"

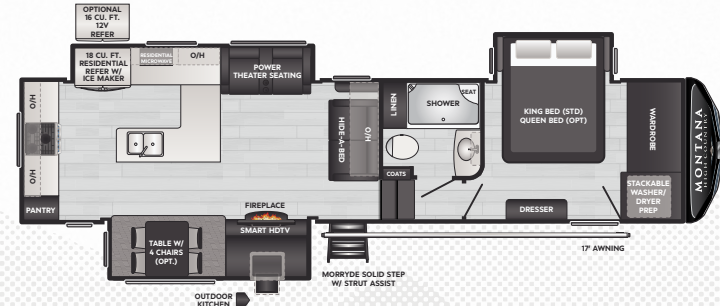

325RK | WEIGHT TBD | LENGTH 36' 7"

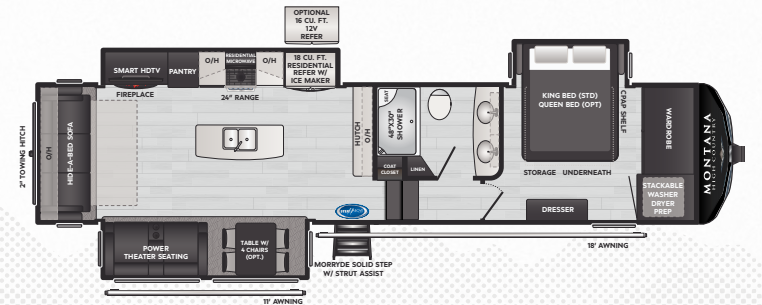

331RL | WEIGHT 12115 | LENGTH 37' 4"

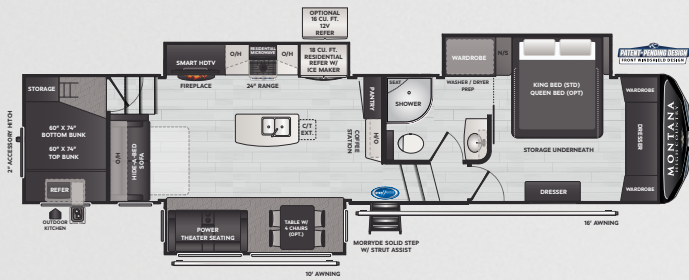

351BH | WEIGHT 13278 | LENGTH 39' 0"

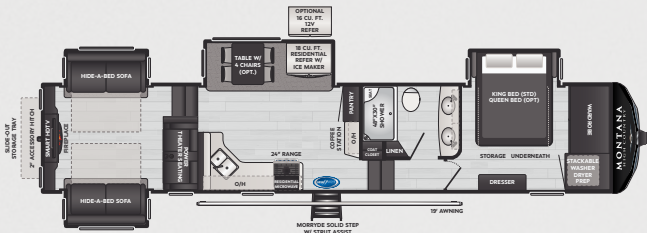

373RD | WEIGHT 13399 | LENGTH 41' 4"

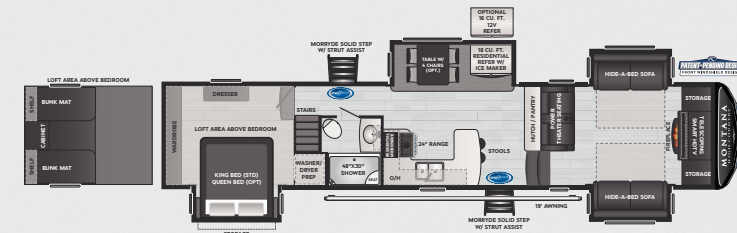

377FL | WEIGHT 13513 | LENGTH 41' 11"

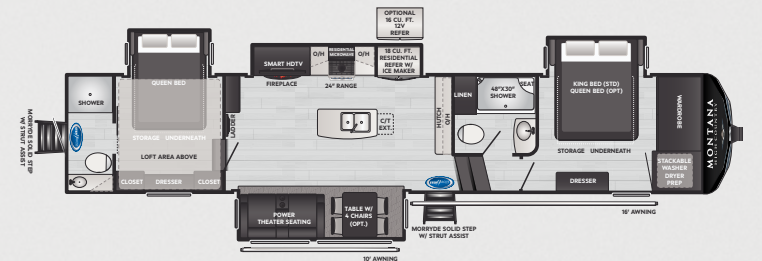

381TB | WEIGHT 14364 | LENGTH 42' 5"

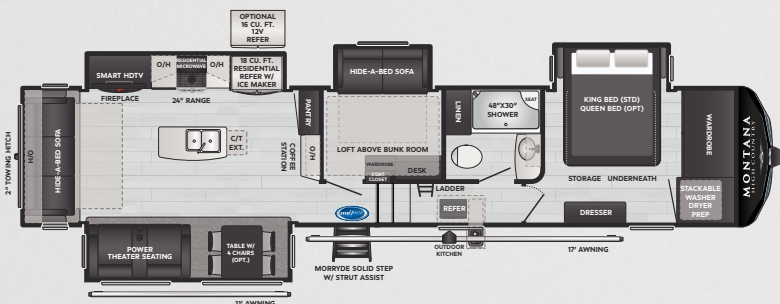

385BR | WEIGHT 13794 | LENGTH 40' 9"

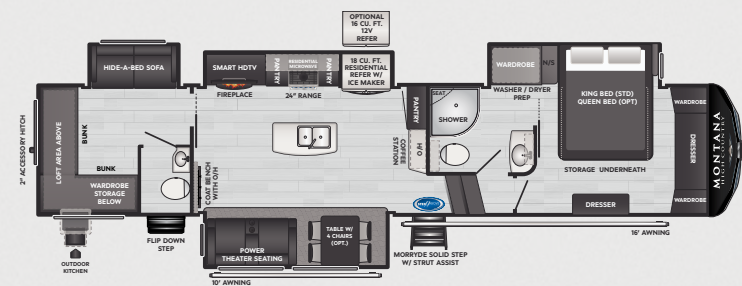

389BH | WEIGHT 13880 | LENGTH 40' 5"

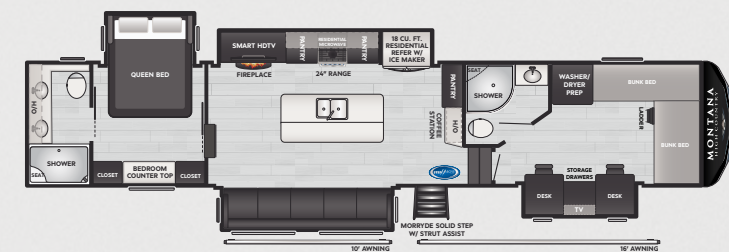

397FB | WEIGHT TBD | LENGTH 43' 0"

DISCLAIMER: Product information is as accurate as possible as of the date of this publication. All features, floor plans, and specifications are subject to change without notice. Pre-production estimated weights & lengths may be listed; visit Keystonerv.com for the most current product information and specifications.

CAMP BETTER
KINDNESS · COMMUNITY · PLANET





KEYSTONE
RV COMPANY

MONTANA

HIGH COUNTRY

2025 | FIFTH WHEELS

INTERIOR

- » Solid Surface Countertops
- » Belair Vinyl Flooring by Shaw® w/ 7-Year Cold Cracking Warranty
- » Larger, 24" Furrion Stove w/ Matching Stainless Steel Drawer
- » Stainless Steel Residential Microwave
- » 50" Smart TV in the Living Room
- » JBL® Cube Stereo with Mizone Control
- » Central Vacuum with Toe Kick
- » Adjustable Shelving in Pantry
- » 18 Cu. Ft. Residential Refrigerator with Ice Maker (opt 16 Cu. Ft. 12V Refrigerator)
- » Hardwood Cabinets Doors and Drawers
- » Sliding Storage Desk (Select Floorplans)

EXTERIOR

- » Fibrogloss™ High-Gloss Sidewalls
- » 30" X 78" Oversized Lippert® G-Class Black Glass Entry Door
- » MORryde Strut Assist Flip Down Solid Steps®
- » Insulated Baggage Doors
- » Black Tank Flush
- » 3K LBS.Tow Hitch (295RL, 311RD, 331RL, 385BR)
- » 300 LBS. Accessory Hitch (351BH, 373RD, 389BH)

CONSTRUCTION

- » Drop-Frame Construction
- » One-Piece Alpha SuperFlex™ TPO Roof Membrane w/ Limited Lifetime Warranty
- » 5" Roof Truss with Built in Attic Vent
- » 5- Layer Automotive Painted Front Cap W/ HitchVision
- » 2" Exterior Double Layer Luan Wall Construction
- » 3" Interior Wall Construction
- » 5/8" Dyna Span Floor Decking with 25 Year Warranty
- » 6'6" Slide Room Height in Living Rooms
- » 12V Color-Coded Wiring
- » Tuf-Lok™ Thermoplastic A/C Duct Joiner
- » 70 Gallon Roto-Cast Fresh Water Tank
- » 3M™ Breathable Graphics

EQUIPMENT

- » 7k Dexter® Gladiator™ Axles w/ Upgraded Springs & Nev-R-Adjust Brakes
- » G-Rated Rainer Tires on all Models
- » Lippert® Ground Control Leveling with Hitch Memory
- » Lippert® Road Armor™ Suspension w/ 1/2" Shackles, Wet Bolts & Bronze Bushing
- » Tankless Hot Water Heater
- » Seaflo® Water Pump, 12 Db Quieter
- » 35K BTU Furnace & Up to 16.5K BTU Heat Pump
- » (2) Coleman®-Mach® PowerSaver™ Air Conditioners (<12AMP Draw Each)
- » Blade Pure™ High-Performance Air Flow System w/ Merv 9 Filtration

STANDARD FEATURES



Colton RV & Marine
3122 Niagara Falls Blvd.
North Tonawanda, NY 14120
(716) 694-0188
www.ColtonRV.com

Colton RV
489 Bushkill Plaza LN #9665
Wind Gap, PA 18091
(610) 863-5239
www.ColtonRV.com

DISCLAIMER: Product information is as accurate as possible as of the date of this publication. All features, floor plans, and specifications are subject to change without notice. Pre-production estimated weights & lengths may be listed; visit Keystonerv.com for the most current product information and specifications.

CAMP BETTER
KINDNESS · COMMUNITY · PLANET

