

r.pod



Colton RV & Marine
3122 Niagara Falls Blvd
North Tonawanda, NY 14120
(716) 694-0188
www.ColtonRV.com

Colton RV & Marine
3443 Southwestern Blvd.
Orchard Park, NY 14127
(716) 957-3250
www.ColtonRV.com



FOREST RIVER

FORESTRIVERINC.COM

r.pod

FLOORPLANS

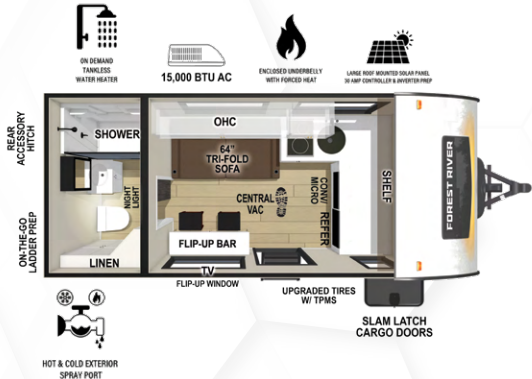

RP-150	UVW	HITCH	CCC	LENGTH	HEIGHT	WIDTH	CAPACITY (GAL)		
	2,809	305	1,500	19'	9' 10"	6' 5"	30	30	30

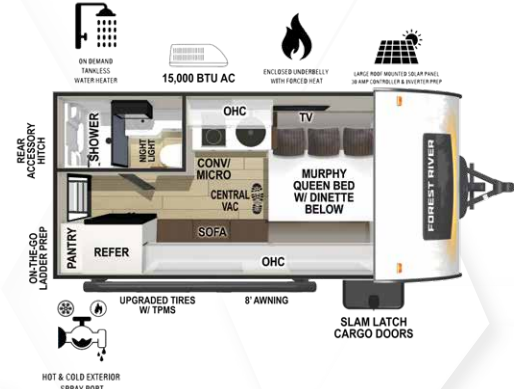

RP-153	UVW	HITCH	CCC	LENGTH	HEIGHT	WIDTH	CAPACITY (GAL)		
	3,024	290	1,500	17' 6"	9' 10"	7' 4"	30	30	30

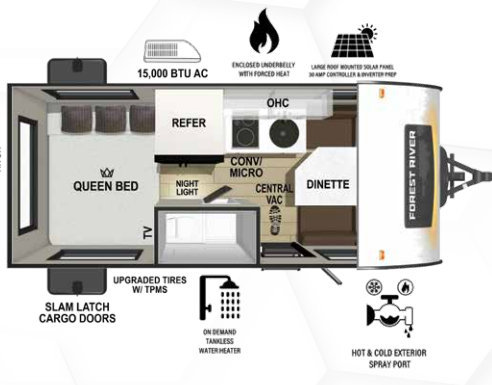

RP-171	UVW	HITCH	CCC	LENGTH	HEIGHT	WIDTH	CAPACITY (GAL)		
	2,529	360	1,500	19'	9' 10"	6' 5"	30	30	30

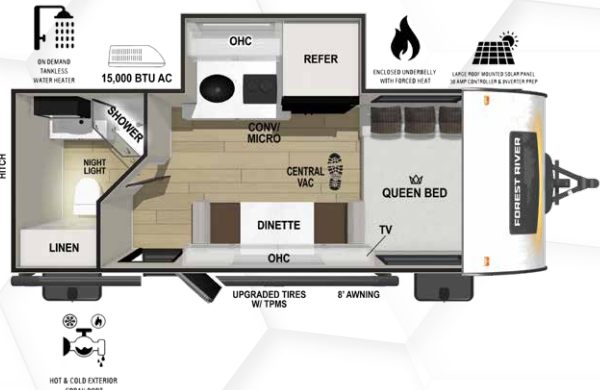

RP-180	UVW	HITCH	CCC	LENGTH	HEIGHT	WIDTH	CAPACITY (GAL)		
	2,974	385	1,811	20'	9' 10"	6' 5"	30	30	30



RP-190	UVW	HITCH	CCC	LENGTH	HEIGHT	WIDTH	CAPACITY (GAL)		
	3,049	370	1,721	20' 4"	9' 10"	6' 5"	30	30	30

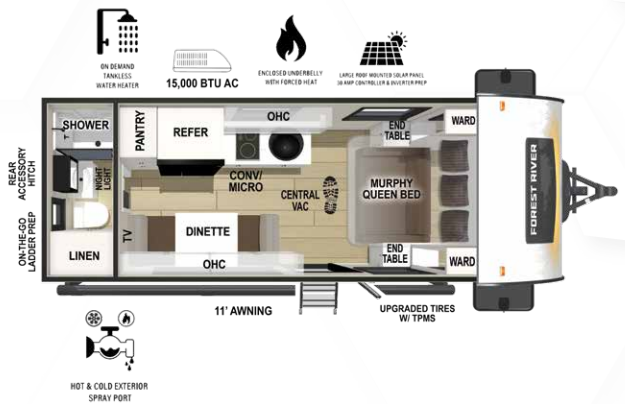

RP-192	UVW	HITCH	CCC	LENGTH	HEIGHT	WIDTH	CAPACITY (GAL)		
	3,649	385	1,136	22' 2"	10' 4"	7' 4"	30	30	30

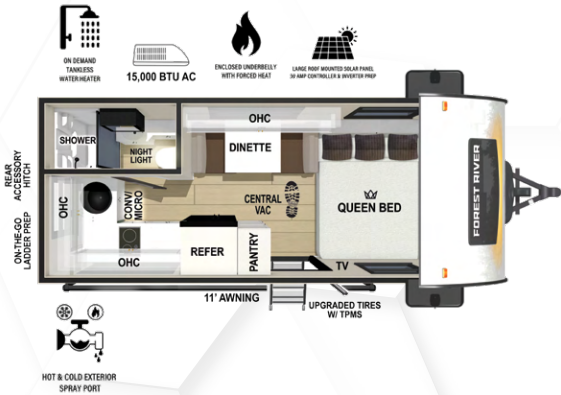

RP-194	UVW	HITCH	CCC	LENGTH	HEIGHT	WIDTH	CAPACITY (GAL)		
	3,404	360	1,356	20' 6"	10' 4"	7' 4"	30	30	30



RP-197	UVW	HITCH	CCC	LENGTH	HEIGHT	WIDTH	CAPACITY (GAL)		
	4,054	470	1,500	23'	10' 9"	8'	40	40	30



RP-198	UVW	HITCH	CCC	LENGTH	HEIGHT	WIDTH	CAPACITY (GAL)		
	4,594	475	1,500	25' 6"	10' 7"	7' 4"	30	30	30

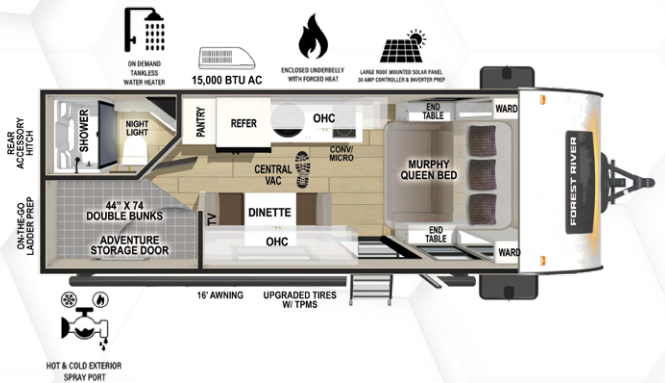

RP-200	UVW	HITCH	CCC	LENGTH	HEIGHT	WIDTH	CAPACITY (GAL)		
	4,544	585	1,500	25'	10' 6"	7' 4"	30	30	30



RP-202	UVW	HITCH	CCC	LENGTH	HEIGHT	WIDTH	CAPACITY (GAL)		
	4,574	340	1,510	25'	10' 10"	7' 4"	30	60	30

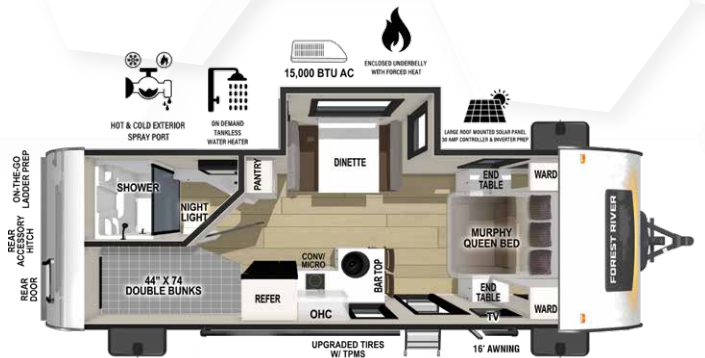

RP-203	UVW	HITCH	CCC	LENGTH	HEIGHT	WIDTH	CAPACITY (GAL)		
	4,584	635	1,500	25'	10' 6"	7' 4"	30	30	30

r.pod

FLOORPLANS

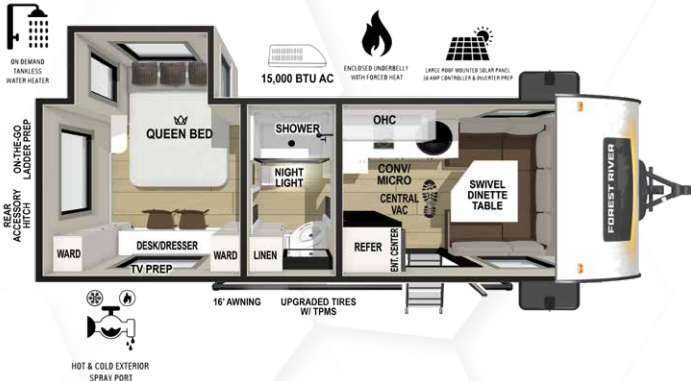

RP-204	UVW	HITCH	CCC	LENGTH	HEIGHT	WIDTH	CAPACITY (GAL)		
	4,507	575	1,500	25' 6"	10' 7"	7' 4"	30	60	30



RP-205	UVW	HITCH	CCC	LENGTH	HEIGHT	WIDTH	CAPACITY (GAL)		
	4,643	455	1,500	25'	10' 6"	8'	40	40	30

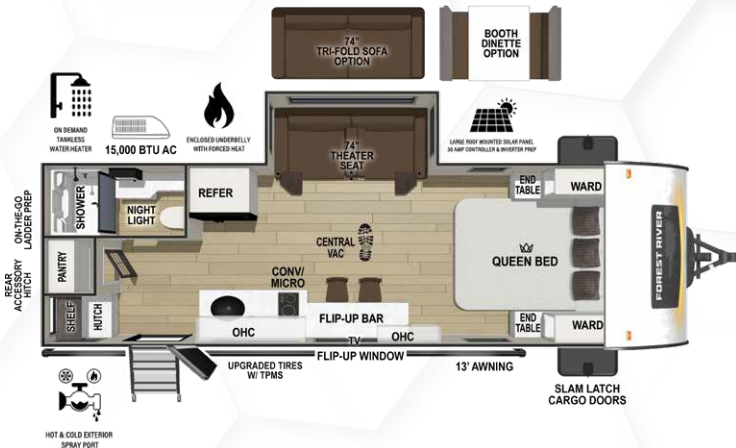

RP-206	UVW	HITCH	CCC	LENGTH	HEIGHT	WIDTH	CAPACITY (GAL)		
	TBD	TBD	1,500	25' 6"	10' 7"	7' 4"	30	30	30



TOP FEATURES



ACRYLIC FRONT WINDOW WITH NIGHT SHADE & BUG SHIELD



PLATFORM ENTRY STEPS SELECT MODELS



ENCLOSED UNDERBELLY WITH FORCED HEAT

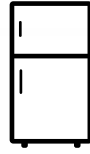

LARGE REFRIGERATORS

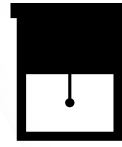

PREMIUM WINDOW TREATMENTS



TIRE PRESSURE MONITORING SYSTEM

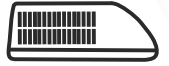

15,000 BTU A/C

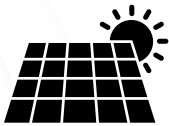

LARGE ROOF MOUNTED SOLAR PANEL 30 AMP CONTROLLER & INVERTER PREP



OUTSIDE KITCHEN (Excluding 150 & 171)



CENTRAL VACUUM SYSTEM



ON DEMAND TANKLESS WATER HEATER

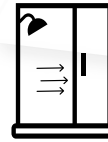

UPGRADED SHOWER ENCLOSURE SELECT MODELS



REAR ACCESSORY HITCH



USB-C PORTS INSIDE & OUT



CONVENIENT MOTION LIGHTING INSIDE & OUT



4 SPEED HIGH POWERED BATH FAN



HOT & COLD EXTERIOR SPRAY PORT



SLAM LATCH CARGO DOORS



LARGE HOLDING TANKS



CONVECTION MICROWAVE



12 VOLT TV



RP197



RP198



RP198



RP202



R•Pod is the #1 FASTEST GROWING RV OWNERS GROUP!

Growing and building the **R•Pod** Owners Facebook Group has been a passion project for more than twelve years. Having the opportunity to interact with so many amazing people who've all come together because of our love for camping and the **R•Pod** is priceless. I'm honored to be a part of it all and am always ready to support our Owners. It has been the longest, craziest, most rewarding camping experience I've ever had in my life and I'll never be able to express how much it all means to me.



Our **R•Pod** Rallies are phenomenal experiences not to be missed. Amazing food, demos and tours of our Pods, fun games and activities, and our fabulous hosts recommending the must-see sites in their area, are just the beginning. As night settles in you can find campfires and stories being told all over the campground. Rallies can be big or small—a few Pod Owners locally meeting to get to know each other or hundreds of Pods showing up from all over North America. We'd love to plan and organize even more events each year and I would love to travel to each and every one of them to support Forest River and our Owners.

Our community is about bringing all of our owners together in one place so we can share the knowledge, photos, and stories of all of our combined trips in a friendly and welcoming place. There is more to owning an **R•Pod** than just having an amazing camper, it welcomes you and your family into the friendliest and most helpful RV community anywhere. It's great seeing that we have 30,000 members and Owners supporting one another, but we want to reach even higher and find as many **R•Pod** Owners as we can and have them join us so they can share in the fellowship and help that we provide. We'll continue to expand our reach and presence in representing the Forest River **R•Pod** for years to come. I can't wait to see what the next twelve years bring.

Sincerely,

Travis Mattingly
R•Pod Owners Group Admin

JOIN US!



Safety and *Adventure* . . .

. . . . with AZDEL composite panels **"ONBOARD."**

Azdel's proven technology has been used in RVs since 2006.

AZDEL Composite Panels have been used in RV exterior and interior sidewall, ceilings, and roofs since 2006.

AZDEL Composite Panels are constructed using a blend of polypropylene and fiberglass to create a strong, lightweight, quiet, water resistant, temperature resistant, odorless and environmentally friendly wall that will increase the life of your RV.

RV Sidewall Cut-Away
(Exploded View)

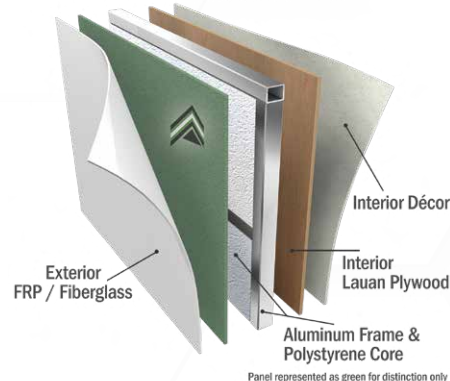

R-POD TOWING GUIDE

SUB 2,000 LB. - 3,500 LB. UVW R-POD FLOOR PLANS

3,500 LB. - 5,000 LB. UVW R-POD FLOOR PLANS



MAX - Approx. 3,500 lbs.
EXAMPLES:
SUBARU OUTBACK
TOYOTA RAV4



MAX - Approx. 3,500 lbs.
EXAMPLES:
JEEP WRANGLER 2 DOOR
JEEP WRANGLER 4 DOOR

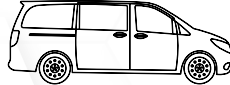

MAX - Approx. 3,500 lbs.
EXAMPLES:
CHRYSLER PACIFICA
HONDA ODYSSEY



MAX - Approx. 6,000 lbs.
EXAMPLES:
JEEP GRAND CHEROKEE
CHEVROLET TRAVERSE



MAX - Approx. 5,500 - 7,500 lbs.
EXAMPLES:
GMC CANYON
FORD RANGER



MAX - Approx. 6,000 lbs.
EXAMPLES:
JEEP GRAND CHEROKEE
CHEVROLET TRAVERSE



MAX - Approx. 5,500 - 7,500 lbs.
EXAMPLES:
GMC CANYON
FORD RANGER



MAX - Approx. 5,500 - 7,500 lbs.
EXAMPLES:
DODGE DURANGO
FORD EXPLORER

*Towing references listed above are only estimates and are subject to change. Please refer to and follow the specific guidelines and towing capabilities listed in your vehicle's owner's manual before towing any RV.



PRE-DELIVERY INSPECTION FACILITY

20,000 square feet of quality assurance. The bare essentials for a premium product. This state-of-the-art facility gives immediate daily feedback to production for quality assurance in every unit built.



Download our Forest River mobile app or visit our dynamic online manual to enhance your ownership experience. These interactive options provide incredible ease and insight into use, maintenance and enjoyment of your Forest River product.

Ranging from "How-To" videos, pictures and illustrations of various components, systems and features, to fully searchable content and downloadable PDFs for individual component owner's manuals, answers are always just a click away. View the online manual at www.forestriverinc.com/OnlineManual or download our FREE app from the App Store or Google Play!



FREE MEMBERSHIP
to Forest River Owners' Group

www.forestriverfrog.com



GVWR (Gross Vehicle Weight Rating) - is the maximum permissible weight of the unit when fully loaded. It includes all weights, inclusive of all fluids, cargo, optional equipment and accessories. For safety and product performance do NOT exceed the GVWR.

GAWR (Gross Axle Weight Rating) - is the maximum permissible weight, including cargo, fluids, optional equipment and accessories that can be safely supported by a combination of all axles.

UVW (Unloaded Vehicle Weight)* - is the typical weight of the unit as manufactured at the factory. It includes all weight at the unit's axle(s) and tongue or pin and LP Gas. The UVW does not include cargo, fresh potable water, additional optional equipment or dealer installed accessories.

CCC (Cargo Carrying Capacity)** - is the amount of weight available for fresh potable water, cargo, additional optional equipment and accessories. CCC is equal to GVWR minus UVW. Available CCC should accommodate fresh potable water (8.3 lbs per gallon). Before filling the fresh water tank, empty black and gray tanks for more cargo capacity.

*Estimated Average based on standard build optional equipment. ** Estimated average based on standard build optional equipment. Values estimated at time of printing.

Each Forest River RV is weighed at the manufacturing facility prior to shipping. A label identifying the unloaded vehicle weight of the actual unit and the cargo carrying capacity is applied to every Forest River RV prior to leaving our facilities. The load capacity of your unit is designated by weight, not by volume, so you cannot necessarily use all available space when loading your unit.

All information contained in this brochure is believed to be accurate at the time of publication. However, during the model year, it may be necessary to make revisions and Forest River, Inc., reserves the right to make all such changes without notice, including prices, colors, materials, equipment and specifications as well as the addition of new models and the discontinuance of models shown in this brochure. Therefore, please consult with your Forest River, Inc., dealer and confirm the existence of any materials, design or specifications that are material to your purchase decision.

©2024 R-pod, a division of Forest River Inc., a Berkshire Hathaway company.



Learn More
Scan this barcode using a QR Reader on your smart phone to learn more about Forest River.



**24/7 EMERGENCY **
ROADSIDE ASSISTANCE
WITH VEHICLE PURCHASE***

TOWING
JUMP-STARTS
TIRE CHANGES
FLUID DELIVERY
LOCKOUT
SERVICE

WINCH-OUT
MOBILE MECHANIC
TECHNICAL
SUPPORT
DEALER LOCATOR
SERVICES



*VALID FOR 1 YEAR FROM DATE OF PURCHASE