

# RAPTOR

LUXURY TOY HAULERS

Colton RV & Marine  
3122 Niagara Falls Blvd.  
North Tonawanda, NY 14120  
(716) 694-0188  
[www.ColtonRV.com](http://www.ColtonRV.com)

Colton RV & Marine  
3443 Southwestern Blvd.  
Orchard Park, NY 14127  
(716) 957-3250  
[www.ColtonRV.com](http://www.ColtonRV.com)

Colton RV  
489 Bushkill Plaza LN #9665  
Wind Gap, PA 18091  
(610) 863-5239  
[www.ColtonRV.com](http://www.ColtonRV.com)



KEYSTONE  
RV COMPANY

CAMPBETTER  
KINDNESS · COMMUNITY · PLANET



# LONGHAUL PACKAGE

## GO ALL-IN WITH PROFESSIONAL GRADE OPTIONS

- Furrion Side Cameras with a 7" Screen
- On-Board Air Compressor
- 50 Amp Electric Cord Reel
- Water Filtration System
- Kicker Sound System with 2 Amps, 8" Upgraded Speakers, & a Sub-Woofer
- TPMS Tire Monitoring System With In-Command® System Control



▲ LEARN MORE ▲



MAKE A STATEMENT WITH  
**FULL BODY PAINT**

Keystone's exclusive fade and peel-resistant automotive-grade paint is available as an optional package on all Raptor floorplans.

(AVAILABLE COLOR OPTIONS: CHARCOAL & ELECTRIC BLUE)



▲ LEARN MORE ▲

# H I G H A D R E N A L I N E

Unleash your inner thrill-seeker with Keystone RV's Raptor Luxury Toyhaulers – a haven crafted for the adventurous, the fearless, and those who are all-in on the exhilarating journey of life. A symphony of power and precision, Raptor embodies rugged performance through superior construction, an ode to your unquenchable thirst for adventure. But this is no compromise between brawn and luxury. Step inside and indulge in a world of opulence, where every detail is meticulously designed to cater to your appetite for the extraordinary. With comfort that cradles you after every heart-pounding escapade and innovative technology that elevates each moment, the Raptor promises a best-in-class owner experience that complements your audacious spirit.

**Whether you're a nomadic RVer yearning for flexible living spaces and sprawling open-air patios, or a power sports aficionado seeking a secure haven for your prized UTVs and dirt bikes, Raptor is your ultimate partner in conquering both the wild unknown and the lap of luxury.**

## RAPTOR EXCEPTIONAL FEATURES

- Maxturn™ Technology w/ Rota-Flex™ Pin Box
- Hitch Vision™ w/ Led Lighting
- One-Piece Alpha Super Flex TPO Roof Membrane w/ Limited Lifetime Warranty
- Furrion® Back-Up Camera
- 6-Point Hydraulic Auto Leveling System
- Upgraded MORryde® 3000 CRE Suspension w/ 1/2" Thick Shackles & Wet Bolts
- Tough Sailun G-Rated Tires
- DynaSpan® Seamless Floor Decking w/ Limited 25-Year Warranty
- MORryde® StepAbove® Strut Assisted Solid Entry Steps at Main Entry Door
- Extreme Weather Package
- Omni-Chill® Cooling, Operates Three A/Cs Simultaneously
- Blade™ High-Performance Air Distribution
- 35K BTU Furnace
- **NEW** Nautilus Exterior Convenience Center
- MORryde® Zero Gravity™ Ramp Door
- Industry-Leading 5,000 Lb. Frame-Welded Tie Downs
- Girard® On-Demand Tankless Water Heater
- iN-Command® w/ Global Connect® Smart RV Control System
- Winegard Air 360+ Omni-Directional Rooftop Antenna w/ Exclusive Satellite Pass-Through
- Expanded 6'5" Tall Upper Deck
- Soft-Close Cabinet Doors
- Solid Surface Countertops
- **NEW** Insignia® 24" Oven and Range
- Everchill® 12V Refrigerator
- Axis and Carbide Decor Options  
(SEE KEYSTONERV.COM FOR DETAILS)
- Thomas Payne® Furniture Equipped w/ Heat, Massage, & Led Lights
- Bedroom Washer & Dryer Prep
- Standard Wireless Phone Chargers
- Optional Long Haul Package, Designed For Extended Travel
- SolarFlex™ 220 Protect And 440i Discover Solar Power Packages w/ Optional Dragonfly Energy Lithium-Ion Batteries
- 1-Year Limited Base Warranty & 3-Year Limited Structural Warranty (SEE KEYSTONERV.COM FOR DETAILS)

VISIT OUR WEBSITE FOR PHOTOS,  
360° TOURS, AND FULL PRODUCT DETAILS



# RAPTOR TOY HAULERS

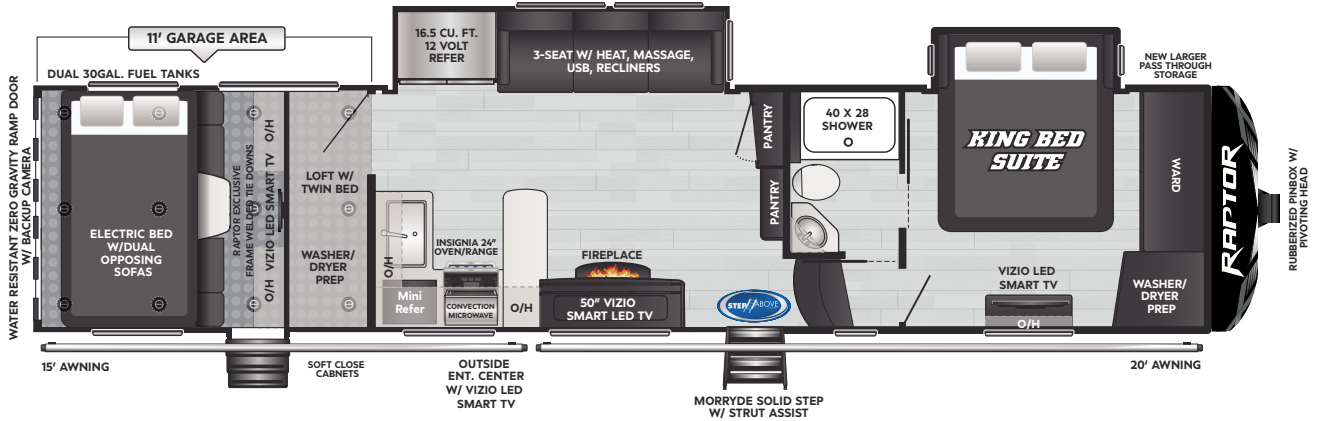

**351** | WEIGHT 13756 | LENGTH 39' 0"

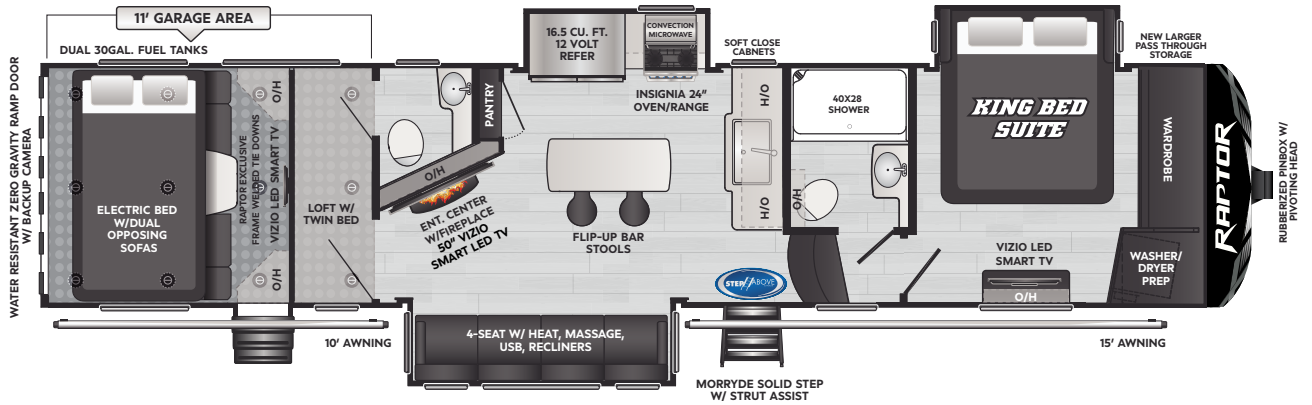

**352** | WEIGHT 14705 | LENGTH 39' 0"

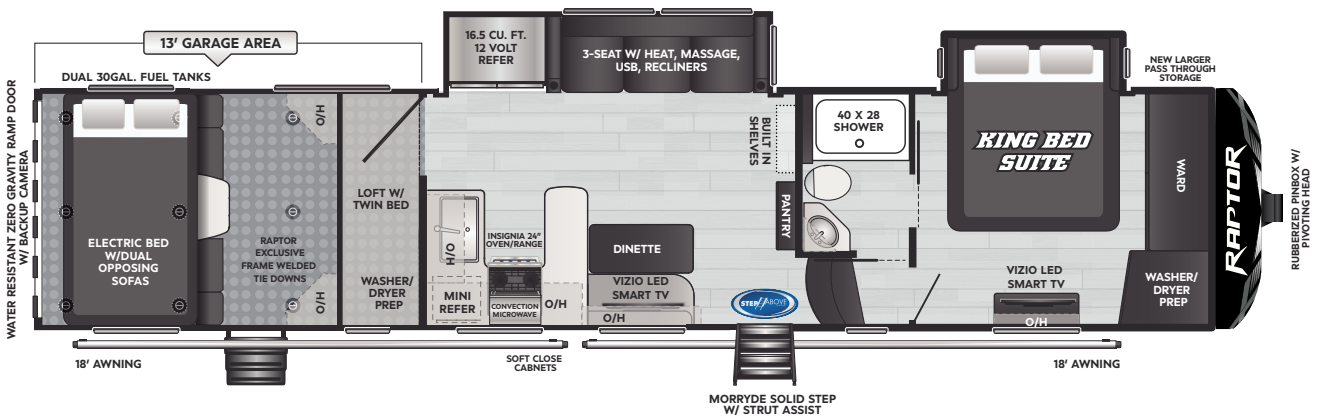

**362** | WEIGHT 13936 | LENGTH 40' 0"

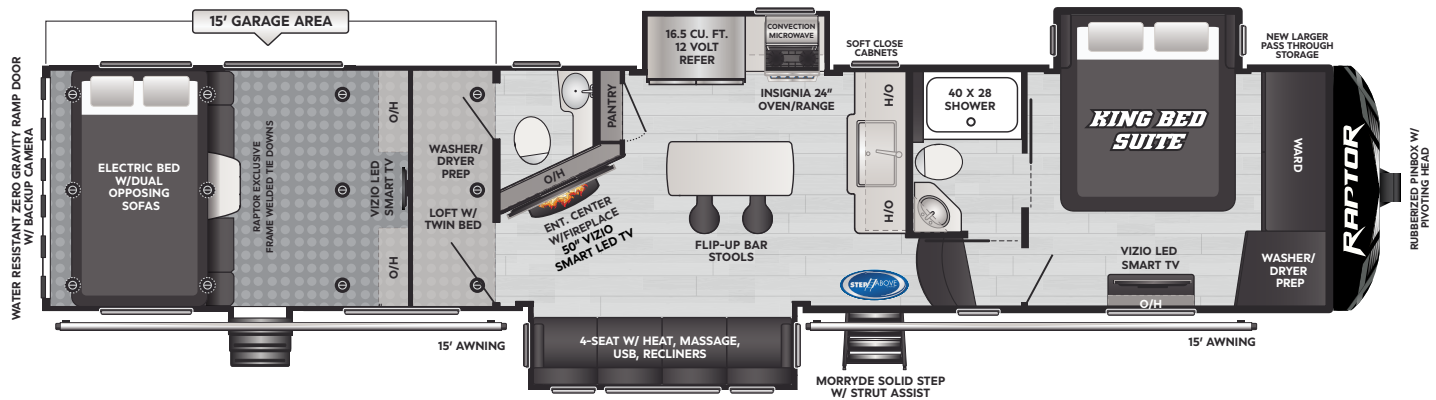

**415** | WEIGHT 16065 | LENGTH 44' 0"

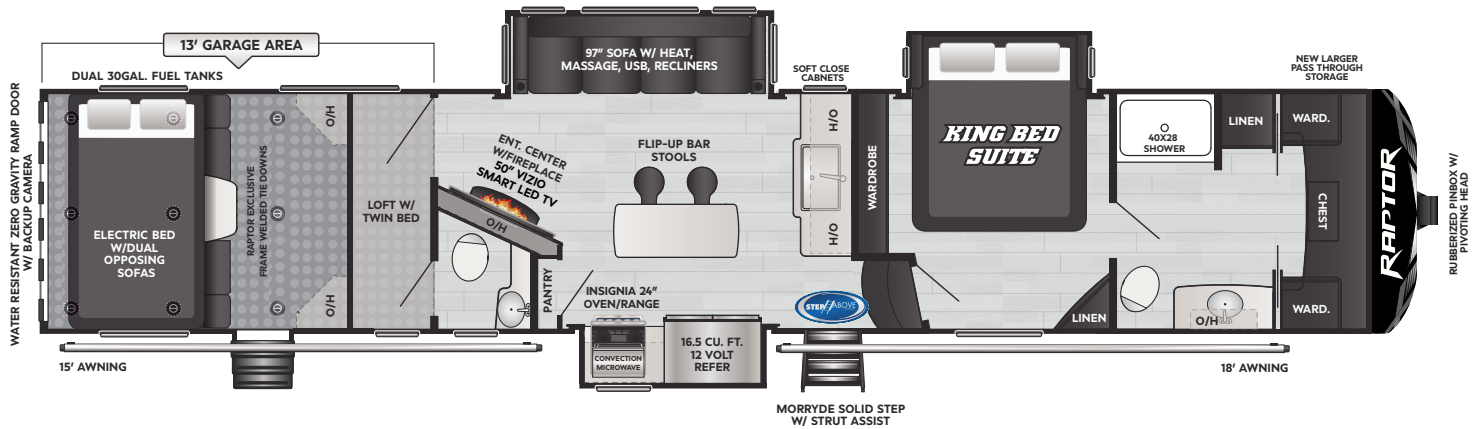

**420** | WEIGHT 15952 | LENGTH 44' 6"

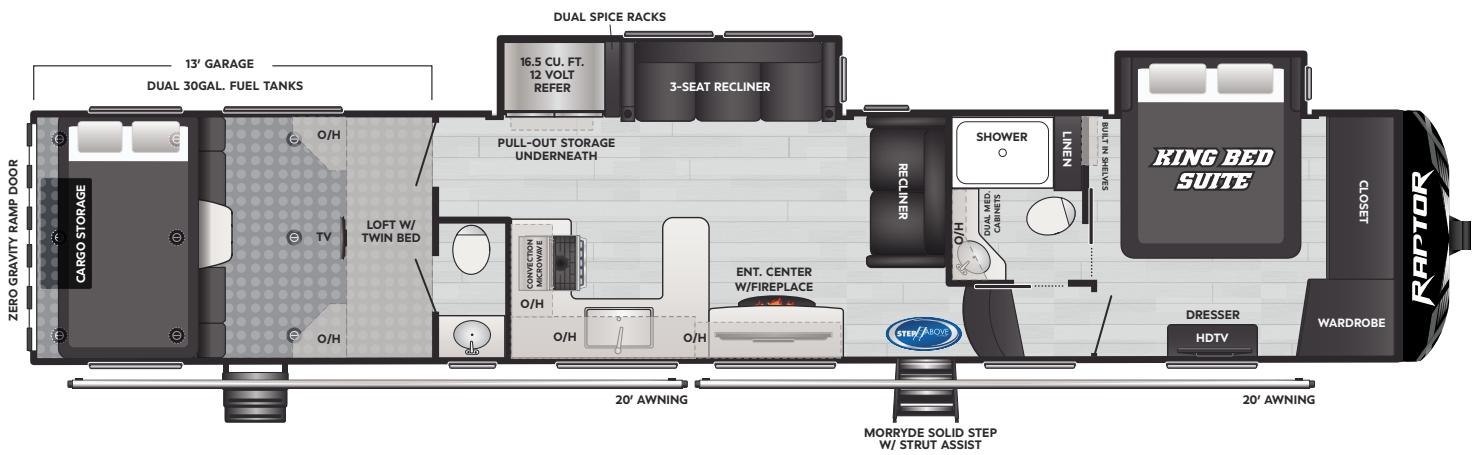

**424** | WEIGHT 15970 | LENGTH 44' 6"

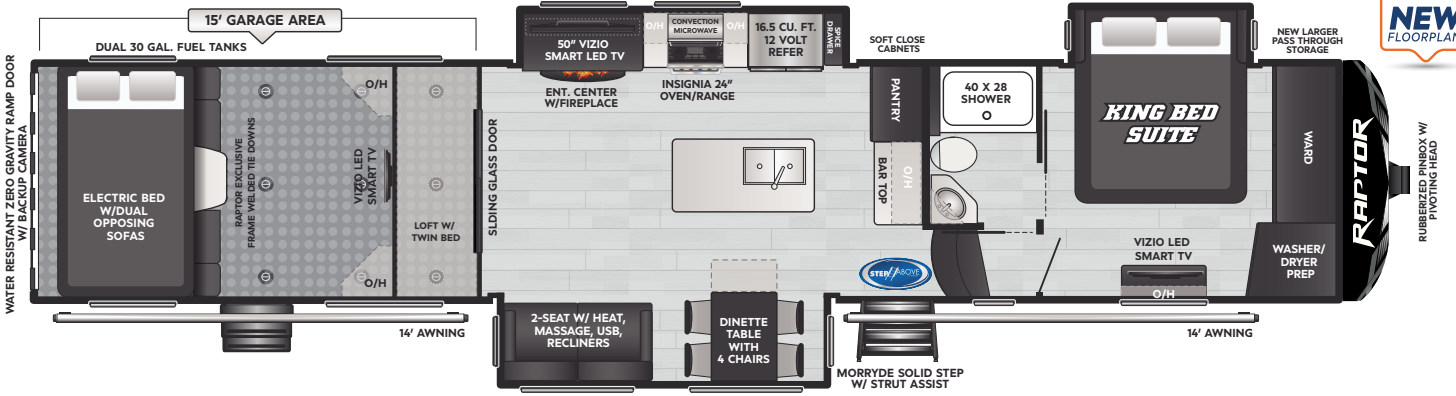

**428** | WEIGHT 16140 | LENGTH 44' 5"

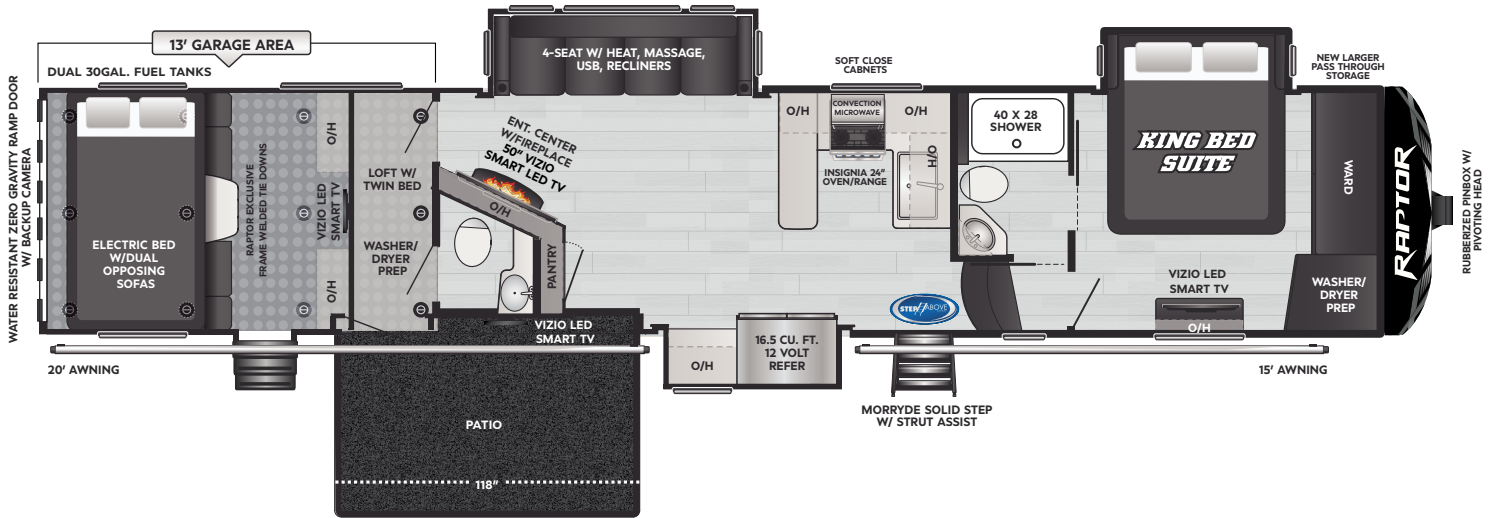

**429** | WEIGHT 16250 | LENGTH 44' 6"

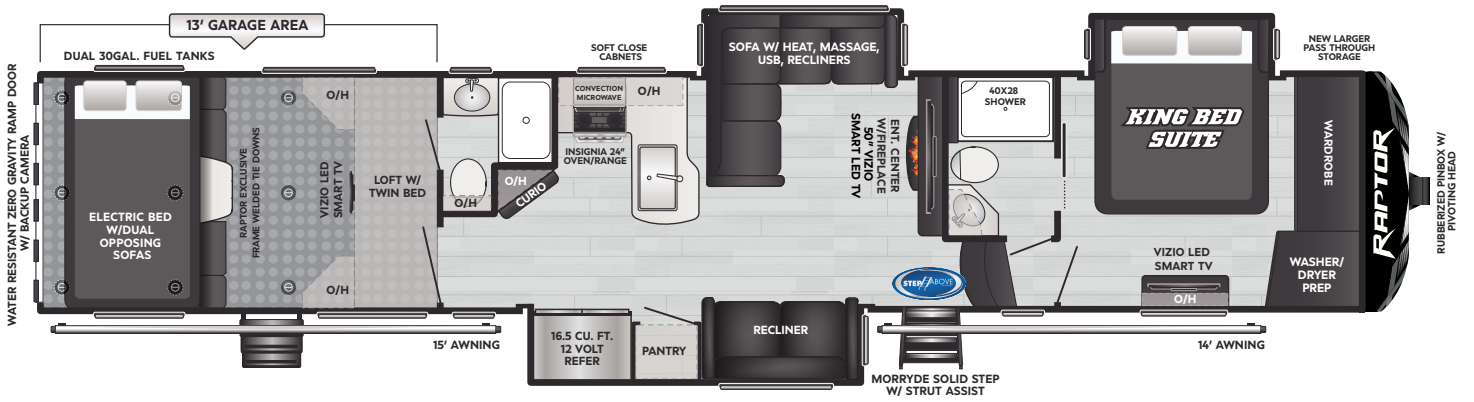

**431** | WEIGHT 16316 | LENGTH 44' 11"

# RAPTOR SPECIFICATIONS

MODEL	WEIGHT	CARRYING CAPACITY	HITCH WEIGHT	FRESH WATER**	WASTE WATER	GRAY WATER	LPG	LENGTH*	WIDTH	HEIGHT	AWNING
351	13756	3244	3020	94	44	82	60	39' 0"	8' 4"	13' 2"	20'/15'
352	14705	2815	3520	94	82	82	60	39' 0"	8' 4"	13' 2"	15'/10'
362	13936	3064	3375	94	44	82	60	40' 0"	8' 4"	13' 6"	18'/18'
415	16065	3935	3935	94	82	82	60	44' 0"	8' 4"	13' 6"	15'/15'
420	15952	4048	3460	94	82	82	60	44' 6"	8' 4"	13' 6"	15'/15'
424	15970	4030	3740	94	82	82	60	44' 6"	8' 4"	13' 6"	20'/20'
428	16140	3860	3665	94	44	82	60	44' 5"	8' 4"	13' 6"	14'/14'
429	16250	3750	3600	94	82	82	60	44' 6"	8' 4"	13' 6"	15'/20'
431	16316	3684	3775	94	82	82	60	44' 11"	8' 4"	13' 6"	14'/15'

## KEYSTONE OWNER'S SUPPORT

Keystone makes operating and maintaining your new RV easy with world-class resources and support. Owners have access to a wide variety of support tools and services via the MyKeystone mobile app and the Owner's section of KeystoneRV.com.

### FIRST TIME CAMPER'S VIDEO SERIES

A comprehensive guide to RV camping basics with Keystone's Matt & Bart.

### PRO TIPS DIY OPERATION & MAINTENANCE VIDEO LIBRARY

Visit our growing collection of step-by-step video and written guides to operating, maintaining, and repairing your Keystone RV.

### DIGITAL OWNER'S MANUAL

Our new online owner's manual is fully searchable and features helpful visual and video support.

### DIY REPAIR PROGRAM\*

Which includes free parts for small repairs within your first year of ownership

### 1-YEAR LIMITED BASE WARRANTY\*

### 3-YEAR LIMITED STRUCTURAL WARRANTY\*

\*See KeystoneRV.com for full details. PRO TIP: Owners should work with their dealers or other Keystone authorized service center or mobile tech to document all warranty claims within the warranty period.



We are the proud owners of a 2019 Keystone Raptor 421CK fifth wheel toy hauler. We chose the toy hauler for the "garage" area to haul our gear. Another name would be "multipurpose" room. We use it as our mudroom, dining room, office, guest bedroom, and garage. We have been traveling full-time in the Raptor for five years. We love the floor plan and it works perfectly for our lifestyle. We can easily accommodate family and friends when they join us on our adventures. This is our second Keystone due to the high quality of their products.



@FIFTYANDFIFTHWHEELING — RAPTOR 421CK OWNERS

# SOLAR<sup>TM</sup> FLEX



**NEW** 2024 PACKAGE UPDATES

For more information scan the QR code  
or visit [keystonerv.com](http://keystonerv.com).

## TAKE *CHARGE* OF HOW YOU CAMP

EXCEPTIONAL QUALITY, IMPOSSIBLY VERSATILE, SolarFlex<sup>TM</sup>  
IS SHATTERING CUSTOMER'S EXPECTATIONS OF FACTORY-INSTALLED SOLAR POWER.  
EXCLUSIVELY AVAILABLE ON ALL KEYSTONE RV MODELS.



Keystone RV is proud to partner with Dragonfly Energy to offer their legendary heated Lithium-ion batteries exclusively on all Keystone models.



FOLLOW US FOR THE LATEST!



DISCLAIMER: Product information is as accurate as possible as of the date of publication of this brochure. All features, floor plans, and specifications in this brochure are subject to change without notice. Please also consult Keystone's web site at [www.keystonerv.com](http://www.keystonerv.com) for more current product information and specifications. Tow Vehicle Disclaimer. CAUTION: Owners of Keystone recreational vehicles are solely responsible for the selection and proper use of tow vehicles. All customers should consult with a motor vehicle manufacturer or their dealer concerning the purchase and use of suitable tow vehicles for Keystone products. Keystone disclaims any liability or damages suffered as a result of the selection, operation, use or misuse of a tow vehicle. KEYSTONE'S LIMITED WARRANTY DOES NOT COVER DAMAGE TO THE RECREATIONAL VEHICLE OR THE TOW VEHICLE AS A RESULT OF THE SELECTION, OPERATION, USE OR MISUSE OF THE TOW VEHICLE. \*Length is defined as the distance from the centerline of hitch pin/coupler to rear bumper of trailer. \*\* Fresh water capacity includes water heater. Please review owner's manual prior to purchase for more information on service warranties, extended use, towing and maintenance. Owner's manuals can be found at [keystonerv.com](http://keystonerv.com).

PRINT 02.2024