

TOY HAULERS THAT GO THE DISTANCE

ENDURANCE

ENDURANCE



TOY HAULERS THAT GO THE DISTANCE



ENDURANCE

TOY HAULERS THAT GO THE DISTANCE

On your next adventure, bring along the extreme toys without sacrificing the living room. These sturdy, yet sensible toy haulers offer plenty of space for bikes, ATVs, or other vehicles—with comfort to spare. Featuring highly-durable fabrics, generous storage, and versatile garages, **Endurance** is perfect for those that take their fun seriously.

Standard in Every Endurance



Sleeps
up to 7



Prepped
WIFI W/ 4G LTE

Don't sell yourself short!
Dutchmen's exclusive Zero
Stack Up Patio System
folds in flat against the
garage wall and doesn't
take up any of your
precious cargo length!

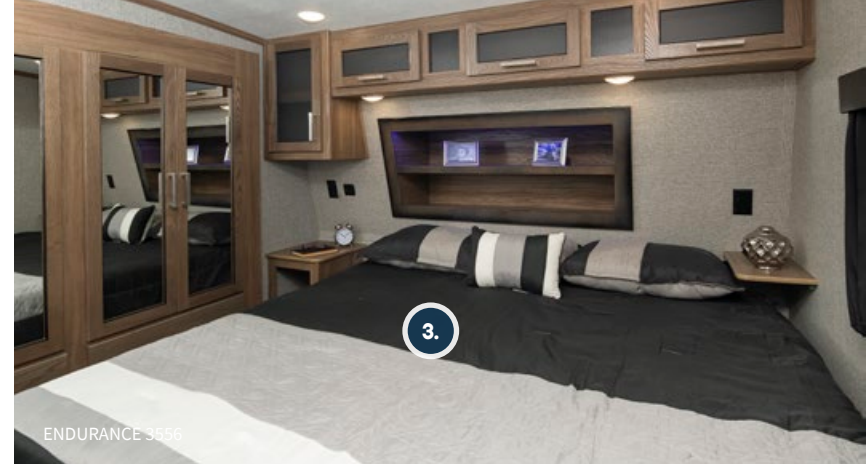

1. AVAILABLE 6-POINT HYDRAULIC AUTO LEVELING
2. 2,500-LB. RATED TIE DOWNS SECURED TO THE FRAME
3. KING-SIZE BED WITH DUAL NIGHTSTANDS
4. 50" TELEVISION
5. RECLINING SOFA WITH HEAT AND MASSAGE



Endurance Floorplans

FIFTH WHEELS

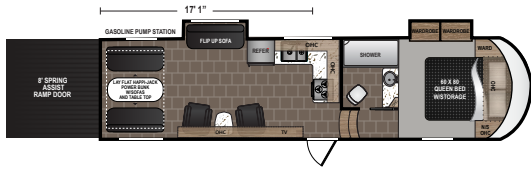

ENDURANCE | 3006 | Sleeps 4-6
Ext. Length: 33' 6" Ext. Height: 13' 4" Weight: 10,516 lbs.

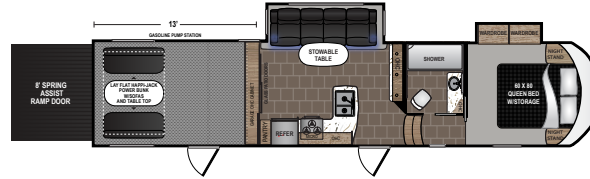

ENDURANCE | 3506 | Sleeps 4-6
Ext. Length: 38' 10" Ext. Height: 13' 4" Weight: 11,702 lbs.

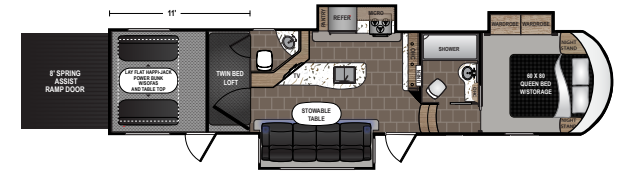

ENDURANCE | 3556 | Sleeps 5-7
Ext. Length: 39' 0" Ext. Height: 13' 4" Weight: 12,348 lbs.



ENDURANCE | 3586 | Sleeps 5-7
Ext. Length: 38' 11" Ext. Height: 13' 4" Weight: 12,316 lbs.



ENDURANCE | 3956 | Sleeps 5-7
Ext. Length: 42' 11" Ext. Height: 13' 4" Weight: 13,352 lbs.

TRAVEL TRAILERS

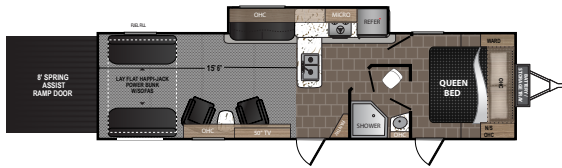

ENDURANCE | 3316 | Sleeps 4-6
Ext. Length: 36' 6" Ext. Height: 12' 4" Weight: 9,292 lbs.

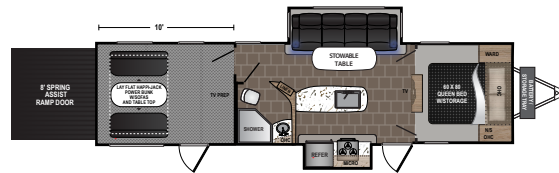

ENDURANCE | 3706 | Sleeps 4-6
Ext. Length: 36' 8" Ext. Height: 12' 4" Weight: 9,619 lbs.

Interior Décor

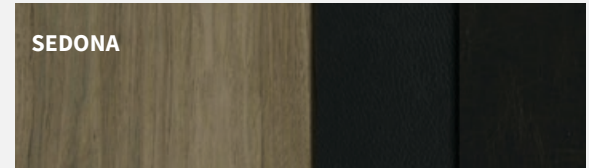

DISCLAIMER: Product information is as accurate as possible as of the brochure publication date. All features, floorplans and specifications in this brochure are subject to change without notice. Please consult Dutchmen's website at www.Dutchmen.com for current product information and specifications. Tow Vehicle Disclaimer. **CAUTION:** Owners of Dutchmen recreational vehicles are solely responsible for the selection and proper use of tow vehicles. All customers should consult with a motor vehicle manufacturer or their dealer concerning the purchase and use of suitable tow vehicles for Dutchmen products. Dutchmen disclaims any liability or damages suffered as a result of the selection, operation, use or misuse of a tow vehicle. DUTCHMEN'S LIMITED WARRANTY DOES NOT COVER DAMAGE TO THE RECREATIONAL VEHICLE OR THE TOW VEHICLE AS A RESULT OF THE SELECTION, OPERATION, USE OR MISUSE OF THE TOW VEHICLE. REFERENCE DUTCHMEN MANUFACTURING OWNERS MANUAL FOR LIMITED WARRANTY DETAILS.

Endurance Specifications

MODEL	FLOORPLAN	WEIGHTS (LBS.)			TANKS (GALS.)			DIMENSIONS	
		SHIPPING WEIGHT (AVERAGE)	DRY HITCH WEIGHT	CARRYING CAPACITY	FRESH WATER CAPACITY	WASTE WATER CAPACITY	GREY WATER CAPACITY	EXTERIOR LENGTH DOES NOT INCLUDE THE TIRE CARRIER OR LADDER	EXTERIOR HEIGHT TOP OF A/C
ENDURANCE	3316	9,292	1,294	3,708	92	48	96	36' 6"	12' 4"
ENDURANCE	3706	9,619	1,371	4,381	92	44	44	36' 8"	12' 4"
ENDURANCE	3006	10,516	2,331	4,484	92	40	40	33' 6"	13' 4"
ENDURANCE	3506	11,702	2,632	5,098	124	40	70	38' 10"	13' 4"
ENDURANCE	3556	12,348	2,731	4,452	92	84	84	39' 0"	13' 4"
ENDURANCE	3586	12,316	2,988	4,484	92	88	84	38' 11"	13' 4"
ENDURANCE	3956	13,352	3,314	4,648	124	84	84	42' 11"	13' 4"

*Length is defined as the distance from the centerline of hitch pin/coupler to rear bumper of trailer. **Our weights represent how most units are built, inclusive of many commonly-ordered options.

***Fresh water capacity includes water heater capacity.

Endurance Standards and Options

ENDURANCE PREMIUM PACKAGE

100-Watt Converter
3" Thick Fully Laminated Main Floor
30,000-BTU Furnace
50' Furrion Power Cord w/Indicator Lights
8.0 Cubic Foot Gas/Electric Refrigerator
Beauflor Linoleum
Charging Locker w/Two USB Outlets
Dark Tint Safety Glass Windows
Electric Front Landing Gear
Fiberglass Front Cap
HappiJac Bed Lift System
High Gloss Exterior Sidewall
Interior Speakers
LED Interior Lighting
Microwave
Pleated Pull Down Shades
Rubber/TPO Hybrid Roof Membrane
One Piece Countertops
Stainless-Steel Appliances

Stove Top w/Oven
Rota Flex Pin Box
Upgraded Graphics Package
Upgraded Stereo
15K Main A/C w/Race Track Air Duct
30 Gallon Fuel Station
50 Amp Service on FWs and 30 Amp Service on TTs
7,000-Pound Axles
8' Tall Spring Assisted Ramp Door
Aluminum Fender Skirts
Cable and Satellite Prep
Crown Molding
Electric Awning w/LED Lights
Exterior Shower
Heated and Enclosed Underbelly
LED Exterior Lighting
50" LED TV
Power Vent in Kitchen
King Bed In All Fifth Wheels
Remote Operating System

Spare Tire w/Carrier
Stainless-Steel Sink
Upgraded Exterior Speakers
Upgraded Residential Furniture

MANDATORY OPTIONS

2nd 15K-BTU Air Conditioner (Not Available on 3706)
Endurance Premium Package
HappiJac Bed Lift System w/Roll Over Sofa System and Table
RVIA Seal
Electric Rear Stabilizer Jacks
Generator Ready
Nitro Fill (Nitrogen Filled Tires) 12 Ply Radials

EXTERIOR OPTIONS

5,500-Watt Generator
Rear Ramp Patio System
Hydraulic Auto Leveling



100% PRE-DELIVERY INSPECTION

At Dutchmen, quality is our standard. Every single Dutchmen RV that comes off the line receives its own pre-delivery inspection. Typically, a competitor performs random inspections, meaning you won't find this commitment to quality anywhere else.



THE INDUSTRY'S BEST RV WARRANTY

With this industry-best warranty, we take the guessing game out of what is and isn't covered. So, that means you don't have to wrangle over the details, because we deliver value by clearly outlining the major components we back during the first three years.



THE LEADER IN PARTS AND SERVICE

Replacement parts. Routine checkups. Expert advice. You name it and we've got it covered. When only the best RV services will suffice, our industry-leading parts and service department is ready to help you get back on the road—and stay there longer than ever before.

YOUR LOCAL DEALER

Colton RV & Marine
3122 Niagara Falls Blvd
North Tonawanda, NY 14120
(716) 694-0188
www.ColtonRV.com

Colton RV & Marine
3443 Southwestern Blvd.
Orchard Park, NY 14127
(716) 957-3250
www.Coltonrv.com



To check for recent updates to floorplans and specifications. **Scan this QR CODE** with your favorite QR Reader application.

From giving advice to servicing products, we consider our loyal dealers the best resource for learning about Dutchmen products.

PO BOX 2000 • 2164 Caragana Court • Goshen, Indiana 46527 • Sales: 574.537.0600 • www.dutchmen.com

DISCLAIMER: Product information is as accurate as possible as of the brochure publication date. All features, floorplans and specifications in this brochure are subject to change without notice. Please consult Dutchmen's website at www.Dutchmen.com for current product information and specifications. **Tow Vehicle Disclaimer. CAUTION:** Owners of Dutchmen recreational vehicles are solely responsible for the selection and proper use of tow vehicles. All customers should consult with a motor vehicle manufacturer or their dealer concerning the purchase and use of suitable tow vehicles for Dutchmen products. Dutchmen disclaims any liability or damages suffered as a result of the selection, operation, use or misuse of a tow vehicle. **DUTCHMEN'S LIMITED WARRANTY DOES NOT COVER DAMAGE TO THE RECREATIONAL VEHICLE OR THE TOW VEHICLE AS A RESULT OF THE SELECTION, OPERATION, USE OR MISUSE OF THE TOW VEHICLE. REFERENCE DUTCHMEN MANUFACTURING OWNERS MANUAL FOR LIMITED WARRANTY DETAILS.** ©2019 Dutchmen. 1-19-VOLTAGE-TRITON- Printed in U.S.A.

www.dutchmen.com

Visit us online to see all of the Dutchmen brands, innovative models and spacious floorplans.