

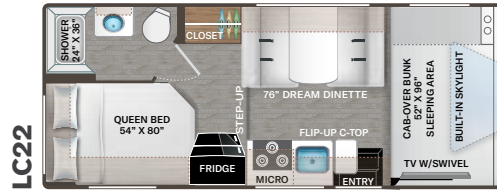

QUANTUM LC - STANDARD GRAPHICS

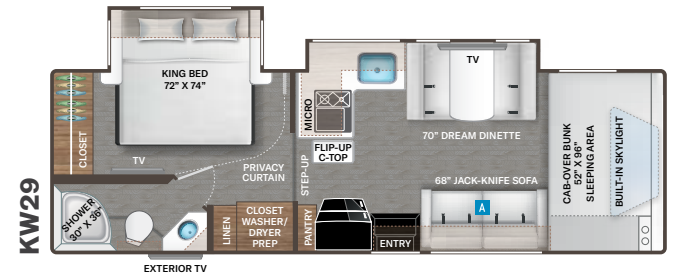

LC22



KW29



QUANTUM PARTIAL PAINT - BLUE OYSTER

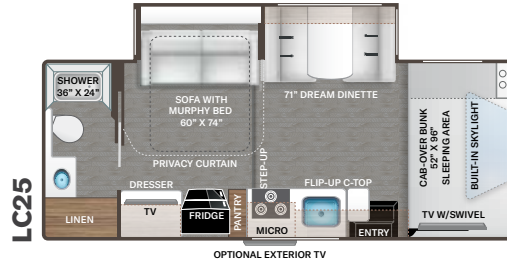

LC25

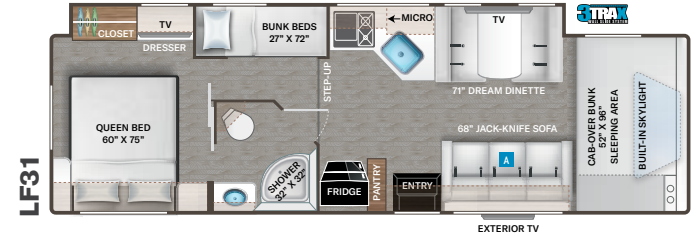

LF31



QUANTUM PARTIAL PAINT - PEARL WHITE

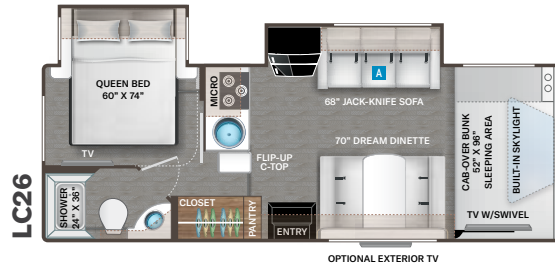

LC26

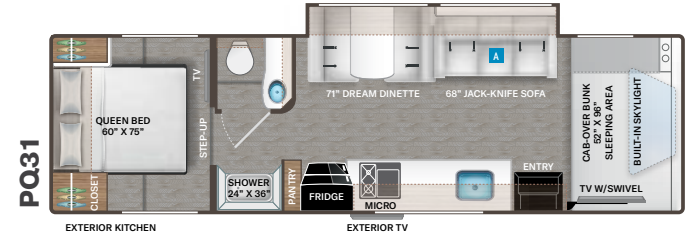

PQ31



QUANTUM FULL BODY PAINT - LAKE TAHOE

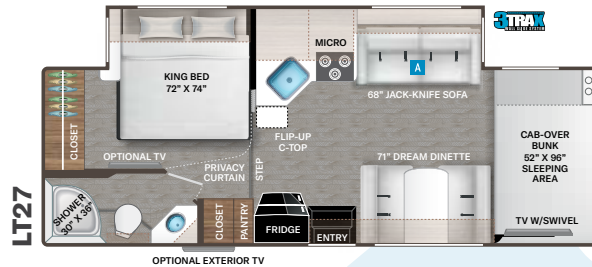

LT27

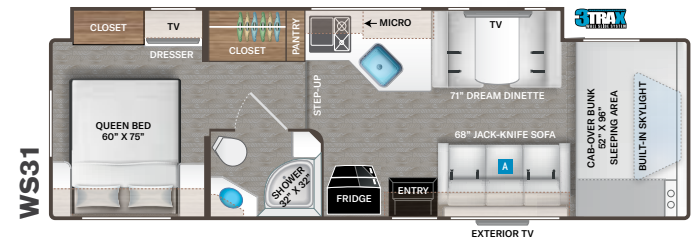

WS31

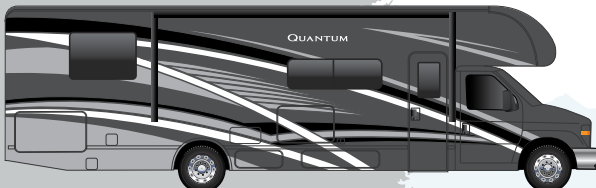

QUANTUM FULL BODY PAINT - SILVER CREEK

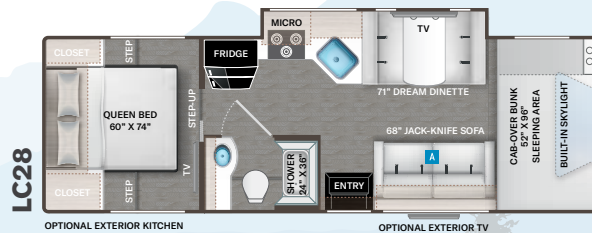

LC28

Option Available on  
Select Floor Plans:

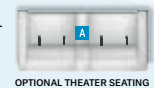

OPTIONAL THEATER SEATING

# QUANTUM® & QUANTUM<sup>LC</sup>

# Featured Highlights

## CONSTRUCTION & EXTERIOR

- Ford® E-Series Chassis - 7.3L V8, 325HP & 450 lb-ft Torque - w/TPM's
- Electric Stabilizing System (LC25, LC26 & LT27)
- Automatic Leveling Jacks with Touchpad Controls (KW29, LF31, PQ31 & WS31)
- SmoothTECH™ Ride Enhancement (KW29, LF31, PQ31 & WS31)
- Partial Paint on HD-MAX® with Graphics Package
- Front Cap with Skylight & Power Shade
- Lighted Rotocast Storage Compartments with Single ON/OFF Interior Switch
- MEGA-Storage™ Compartment (LC22, LT27, LC28, LF31, PQ31 & WS31)
- Portable Table in Mega Storage Compartment (LC28 & PQ31)
- Premium One-Piece Crossflex™ Roofing
- Framed Windows (LC22, LC25, LC26, LT27 & LC28)
- Frameless Windows (KW29, LF31, PQ31 & WS31)
- Power Patio Awning with Integrated LED lighting

## CONSTRUCTION & EXTERIOR OPTIONS

- Chevy® Chassis - 6.6L V8, 401HP & 464 lb-ft Torque (LC22, LC25 & LC26)
- Full-Body Paint Package with Protective Mask IPO Partial Paint (KW29, LF31, PQ31 & WS31)
- Exterior Pull-out Kitchen with Griddle and 12-volt Cooler (LC28 & PQ31)

## AUTOMOTIVE & COCKPIT

- 7" Touchscreen Dash Radio, Apple CarPlay™, Android Audio® with Back-Up Monitor
- SiriusXM® Tuner & Antenna
- Steering Wheel Audio & Camera Controls on Ford® E-Series Chassis Only
- Deluxe Exterior Mirrors (LC22, LC25, LC26, LT27 & LC28)
- Emergency Engine Start Switch
- Aluminum Running Boards
- Stainless Steel Wheel Liners
- Keyless Entry & Valve Stem Extenders
- Cruise Control
- Tilt Steering Wheel
- Windshield Privacy Curtain
- LED Taillights
- Dash Applique (KW29, LF31, PQ31 & WS31)

## AUTOMOTIVE & COCKPIT OPTIONS

- Heated/Remote Exterior Mirrors with Integrated Side View Cameras (STD - KW29, LF31, PQ31 & WS31)
- Leatherette Captain's Chairs (STD - KW29, LF31, PQ31 & WS31)
- Power Driver's Seat
- Cockpit Carpet Mat (KW29, LF31, PQ31 & WS31)

## INTERIOR

- Flat Panel Cabinet Doors with Nickle Finish Hardware (KW29, LF31, PQ31 & WS31)
- Luxury Collection: Flat Panel Cabinet Doors with Charcoal Diamond Décor (LC22, LC25, LC26, LT27 & LC28)
- Decorative Glass Inserts in Kitchen Overhead Cabinet Doors
- Pressed Laminate Countertops
- LED Lighting
- Leatherette Sofa with Queen Size Murphy Bed Conversion (LC25)
- Leatherette Jack-Knife Sofa (LC26, LT27, LC28, KW29, LF31, PQ31 & WS31)
- Leatherette Dream Dinette® Booth
- Wireless Phone Charging with USB Charging Port at Dinette
- Single Child Safety Tether in Dinette
- Cab-Over Sleeping Area with Cup Holders, and Telescoping Bunk Ladder
- Wall Cubby with Net & USB Charging Port
- Ceiling Ducted Air Conditioning System (N/A LC22)
- Window Privacy Shades (LC22, LC25, LC26, LT27 & LC28)
- Premium Window Privacy Roller Shades (KW29, LF31, PQ31 & WS31)
- Ceiling Vent in Cab-Over Bunk

## INTERIOR OPTIONS

- Luxury Collection: Flat Panel Cabinet Doors with Charcoal Diamond Décor (KW29, LF31, PQ31 & WS31)
- Leatherette Theater Seating IPO Jack-Knife Sofa (LC26, LT27, LC28, KW29, LF31, PQ31 & WS31)
- Cab-Over Child Safety Net (KW29, LF31, PQ31 & WS31)
- 12-volt Attic Fan with Cover in Cab-Over Bunk (KW29, LF31, PQ31 & WS31)

## KITCHEN

- 12-volt Refrigerator with Auto Generator Start
- Recessed 3-Burner Gas Cooktop/Oven with Glass Cover & Range Hood with Task Lighting (LC22, LC25, LC26, LT27 & LC28)
- 2-Burner Gas with Single Induction Cooktop (KW29, LF31, PQ31 & WS31)
- Microwave Oven (LC22, LC25, LC26, LT27 & LC28)
- 30" Over-the-Range Convection Microwave Oven (KW29, LF31, PQ31 & WS31)
- Flip-Up Countertop Extension (LC22, LC25, LC26, LT27 & KW29)
- Pop-Up Countertop Outlet & Charging Center (LT27, LC28, KW29, LF31, PQ31 & WS31)
- Pressed Laminate Kitchen Countertops with Sink Covers (LC22, LC25, LC26, LT27 & LC28)
- Solid Surface Kitchen Countertops with Sink Covers (KW 29, LF31, PQ31 & WS31)
- Large Single Bowl Stainless Steel Sink with Single Handle Faucet with Pull-Down Sprayer
- Kitchen Countertop Accent Lighting
- Manual Ceiling Vent (KW29, LF31, PQ31 & WS31)
- 12-volt Attic Fan with Switch (LC22, LC25, LC26, LT27 & LC28)

## BEDROOM & BATHROOM

- Queen Size Bed (LC22, LC26, LC28, LF31, PQ31 & WS31)
- Queen Size Murphy Bed (LC25)
- King Size Bed (LT27 & KW29)
- Hallway Bunk Beds with Telescoping Ladder (LF31)
- Bedroom USB Power Charging Center for Electronics
- Bedroom 12-volt Outlet for CPAP Machine
- 12-volt Attic Fan with Cover in Bedroom (N/A with Dual A/C Option - KW29, LF31, PQ31 & WS31)
- Power Bath Vent with Wall Switch
- Foot Flush Toilet
- Stainless Steel Bathroom Sink
- Robe Hook(s) Inside Bathroom
- Skylight in Shower
- Showermi\$er Hot Water Recycling System
- Upgraded Shower Curtain (LC22)
- Shower with Curved Anti-Microbial Shower Curtain (LC25, LC26 & LC28)

- Shower with Glass Door (LT27, KW29, LF31, PQ31 & WS31)

## ENTERTAINMENT

- 40" TV on Manual Swivel in Cab-Over (LC22, LC25, LC26, LT27 & PQ31)
- 40" TV in Living Area (LC28, KW29, LF31 & WS31)
- 32" TV in Bedroom (N/A LC22)
- Tablet Holders and USB Charge Ports in Bunk Beds (LF31)
- HDMI Video Distribution Box (N/A LC22)
- Cable TV Ready
- Satellite Mounting Backer in Roof

## ENTERTAINMENT OPTIONS

- Exterior 32" TV on Swivel Bracket with Bluetooth® Built-in Sound Bar and Radio (STD - KW29, LF31, PQ31 & WS31 / N/A - LC22)

## ELECTRICAL & PLUMBING

- 4.0 kw Gas Generator
- Automatic Generator Start
- Automatic Transfer Switch with Power Protection
- Automatic Shoreline-to-Generator Transfer Switch
- 30-amp Shoreline Power Cord
- Second Auxiliary House Battery (LC22, LC25, LC26, LT27 & LC28)
- Single Group 31 AGM House Battery (KW29, LF31, PQ31 & WS31)
- Battery Tray for Four (4) Batteries
- Solar Prep - Includes Solar Controller
- 100-watt Solar Charging System with Power Controller (KW29, LF31, PQ31 & WS31)
- Winegard® Connect™ 2.0 WiFi / 4G / TV Antenna
- 6-gallon DSI Gas/Electric Water Heater (LC22, LC25, LC26, LT27 & LC28)
- Tankless Water Heater (KW29, LF31, PQ31 & WS31)
- Single Roof Air Conditioner (LC22, LC25, LC26, LT27 & LC28)
- Single, High Output, Roof Air Conditioner (KW29, LF31, PQ31 & WS31)
- Exterior LP Connection (LC28, KW29, LF31, PQ31 & WS31)
- Whole Coach Water Filtration System (KW29, LF31, PQ31 & WS31)
- Water Heater By-Pass System (LC22, LC25, LC26, LT27 & LC28)

- Outside Shower (LC22, LC25, LC26, LT27, KW29, LF31 & WS31)
- Exterior Water Spray Port (LC28 & PQ31)
- 360° Siphon® RV Holding Tank Vent Cap
- 1" Fresh Water Tank Drain
- Black Tank Flush System
- Stackable Washer/Dryer Prep (KW29)
- Systems Control Center

## ELECTRICAL & PLUMBING OPTIONS

- Single, High Output, Front Air Conditioner IPO Standard Roof Air Conditioner (LC22, LC25, LC26, LT27 & LC28)
- Dual Roof Air Conditioners IPO Standard Roof Air Conditioner (KW29, LF31, PQ31 & WS31)
- 100-watt Solar Charging System with Power Controller (LC22, LC25, LC26, LT27 & LC28)
- Holding Tanks with Heat Pads (STD - KW29, LF31, PQ31 & WS31)

For a complete listing of available features visit [thormotorcoach.com/quantum](http://thormotorcoach.com/quantum).

Use your phone's camera to find out more information.

Just scan the code!



Colton RV & Marine  
3122 Niagara Falls Blvd  
North Tonawanda, NY 14120  
(716) 694-0188  
[www.ColtonRV.com](http://www.ColtonRV.com)

Colton RV  
3443 Southwestern Blvd.  
Orchard Park, NY 14127  
(716) 957-3250  
[www.Coltonrv.com](http://www.Coltonrv.com)

	LC22	LC25	LC26	LT27	LC28	KW29	LF31	PQ31	WS31
Chassis	Ford / Chevy	Ford / Chevy	Ford / Chevy	Ford	Ford	Ford	Ford	Ford	Ford
Gross Vehicle (GVWR)	12,500 / 12,300	12,500 / 14,200	14,500 / 14,200	14,500	14,500	14,500	14,500	14,500	14,500
Gross Combined (GCWR)	18,500 / 16,000	18,500 / 20,000	22,000 / 20,000	22,000	22,000	22,000	22,000	22,000	22,000
Wheel Base	158" / 159"	168" / 169"	190" / 191"	209"	212"	212"	223"	223"	223"
Exterior Length (w/o ladder)	24'-1" / 24'-7"	25'-2" / 25'-8"	27'-7" / 28'-1"	29'-1"	30'	31'	32'-8"	32'-7"	32'-4"
Exterior Height (w/AC)	11'-0"	11'-2"	11'-2"	11'-2"	11'	11'-2"	11'-2"	11'-2"	11'-2"
Exterior Width (w/o mirrors)	99"	99"	99"	99"	99"	99"	99"	99"	99"
Interior Height (living area)	84"	84"	84"	84"	84"	84"	84"	84"	84"
Awning Size	15'	16'	18'	20'	14'	18'	16'	16'	16'
Fuel (gal)	55 / 57	55 / 57	55 / 57	55	55	55	55	55	55
LPG (lbs)	40.9	40.9	40.9	40.9	40.9	40.9	40.9	40.9	40.9
Fresh/Waste/Gray Water (gal)	40 / 24.5 / 37	40 / 33 / 33	40 / 29 / 25	40 / 34.5 / 37	40 / 26 / 32	40 / 34.5 / 37	40 / 28 / 28	40 / 26 / 31	40 / 28 / 28
Water Heater (gal)	6	6	6	6	6	Tankless	Tankless	Tankless	Tankless
Furnace (BTUs)	19,000	30,000	30,000	30,000	30,000	30,000	30,000	30,000	30,000
Exterior Storage Capacity (cu. ft.)	50.3	40.3	27.3	55.5	99.9	50.4	55.7	107	55.7
Hitch Weight Rating (lbs)	8,000	8,000	8,000	8,000	8,000	8,000	8,000	8,000	8,000



IMPORTANT—PLEASE READ: This brochure reflects product design, fabrication, material, components and specifications at the date of printing, which date is disclosed below. Please visit us online at [ThorMotorCoach.com](http://ThorMotorCoach.com) or consult with your selling dealership for the latest in standards, options, specification and technical information. Photographs in the brochure may depict optional equipment or may only be available in certain floor plans. Components, appliances and the chassis may have been manufactured in a calendar year before the vehicle's designated model year. All capacities are approximate. The actual length of the vehicle may differ from that indicated in the brochure due to variances in the manufacturing processes and/or installed components. All dry weights are based on standard model features and do not include optional features or equipment. Component part and appliance manufacturers issue limited warranties covering portions of the vehicle not covered under the limited warranty we issue. Copyright Thor Motor Coach, Inc. © OH 10/01/2022

P.O. Box 1486, Elkhart, IN 46515 Sales Department: 800.860.5658

[thormotorcoach.com/quantum](http://thormotorcoach.com/quantum)

