

MID-SIZED LUXURY FIFTH WHEELS

# MODEL Z 3400

Colton RV & Marine  
3122 Niagara Falls Blvd  
North Tonawanda, NY 14120  
(716) 694-0188  
www.ColtonRV.com

Colton RV & Marine  
3443 Southwestern Blvd.  
Orchard Park, NY 14127  
(716) 957-3250  
www.Coltonrv.com Standard Run MSRP **\$124,312**

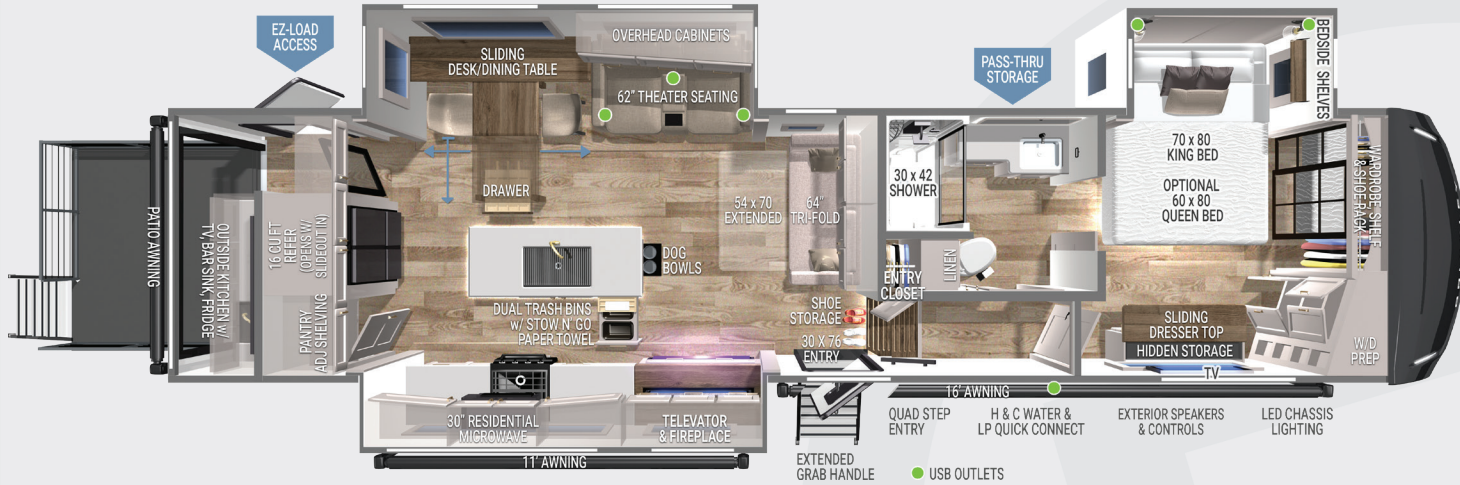

## SPECIFICATIONS:

- UVW – 13,698 lbs.
- GVWR – 16,996 lbs.
- Hitch Weight – 2,391 lbs.
- Exterior Length – 38' 11"
- Overall Height w/ AC – 13' 3"
- Width – 96"
- Bath & Bedroom Height - 79 ½"
- Slide Height - 76"
- Wheels & Tires – 17.5" H-Rated (16 ply)
- Fresh Water Capacity – 75 gal.
- Gray Water Capacity – True 90 + 45 gal.
- Black Water Capacity – 45 gal.
- Insulation – Floors R40, Walls R11, Ceiling R40

## FEATURES:

- Sliding Desk/Dining Table w/ Extending Leaves & Storage Drawer (Seats up to 4)
- Dual Pull-Out Trash Bins w/ Integrated Stow N' Go Paper Towel Holder
- 84" Pantry w/ Adjustable Shelves & Appliance Outlet
- Brinkley CraftSense™ Wood Trim Construction
- Premium Residential Cabinets & Drawers w/ Dovetail Joints
- Kitchen & Living/Dining Room Flush Floor Slides
- Bedside Shelves & Outlets w/ USB & USB-C
- Hidden Sliding Dresser Top Storage Compartment
- 24+ outlets and 6 outlets w/ USB & USB-C
- Pull-Out Storage for 'Stewy' w/ Removable Pet Bowls
- Automotive Grade Front Cap, Lights, & Lens
- Square Euro Frameless Windows w/ 6" Openings (Dual Pane Optional)
- Integrated Window Screens & Insulated Blackout Blinds (No Valances)
- 370W Solar Panel w/ 60AMP MPPT Controller (Inverter Prep & Lithium Ready)
- 2 - Hot/Cold Outdoor Showers (BOTH sides of coach)
- Brass Plumbing Connections (Industry First)
- Large Exterior Storage w/ Tough Ply Liner
- Built-in Wire Conduit from Roof to Basement
- Low Maintenance Roof (Industry First)
- Electric Waste Valves w/ Indicator Light & Manual-Override
- Wide Stance 6-Point Hydraulic Leveling Jacks & Oversized Front Storage
- Heavy-Duty 8k lbs. Axles with 8k lbs. Leaf Springs
- 13.5k Front AC + Furrion 18k Chill® Cube Rear AC

## Outdoor Kitchen & Patio Highlights:

- Cabinet Storage, Work Surface, & Bar Sink
- Large 4.5 Cu.Ft. Refrigerator
- 50" Smart TV on Swivel Mount
- Zero-Gravity Rear Patio w/ Electric Top Latches
- Residential Style Wire Patio Railing, Power Awning w/ LED Lighting, & Steps
- Two-Sided MOLLE Panel Rail w/ Prep Table & Cup Holders
- Patio Door w/ Tinted Glass
- EZ-Load Rear Cargo Access Door

## FACTORY OPTIONS:

- Queen Bed w/ Nightstands \$428
- Dual Pane Windows \$1,731
- Ottoman/Dining Bench w/ Lift Top & Storage \$428

051524

## PRE-PRODUCTION PREVIEW

Based on pre-production prototype. All preliminary info & content is subject to change without notice. Please consult with your dealer for current model details & information.



For More Information, MSRP, Photos, Videos & Why Brinkley go to [BrinkleyRV.com](http://BrinkleyRV.com)

