

Cougar

by Keystone

MID-PROFILE
FIFTH WHEELS



EASTERN EDITION

Cougar

by Keystone

At the heart of Cougars philosophy is the belief that if we listen to our customers, and execute accordingly, the crucial combination of quality, design, weight, luxury and price, is to offer an unparalleled product. A product that will provide the finest means for families, both young and old, to create memories year after year! From growing families, to full timers, Cougar vows to provide the top travel trailer and fifth wheel floor plans and features to suit each dynamic, and maximize their unique camping experience. Growing with Cougar from a mid-level travel trailer, to a 38 foot fifth wheel, is our forte! By avoiding fads and trends, we have been able to focus more on innovation, quality, style and affordability. These attributes are what our customers rely on, and appreciate, and are the hallmarks of America's #1 selling brand. Cougar is the choice of yesterday, today and tomorrow!

Cougar remains focused on the growing popularity of lightweight luxury vehicles, and the ease of tow ability. We have ongoing commitment to create a stress free journey for all who choose to explore with us. We make it our goal that our current customers choose us for each of their subsequent voyages. *Come grow with us and explore the country in a Cougar RV! Where you are always a step ahead, and luxury and lightweight meet!*



Since 1998,
*Cougar has been the pinnacle of excellence in the RV industry,
earning the DSI award for 9 consecutive years. Come find out why...*

THE DSI (DEALER SATISFACTION INDEX) AWARD RATES THE LEVEL OF SATISFACTION THE DEALERS HAVE IN A MANUFACTURER. IT RATES MANUFACTURERS IN MANY AREAS SUCH AS: PRODUCT DESIGN, PRODUCT RELIABILITY & QUALITY, WARRANTY SUPPORT, AND PARTS SUPPORT.



**EXPECT MORE AND
SACRIFICE NOTHING**

WWW.KEYSTONERV.COM/COUGAR





EXECUTIVE KITCHEN

- 1 Best in Class Kitchen Storage
- 2 8 Cubic Foot Refrigerator (12 cu. ft. in 337FLS)
- 3 Island with Storage - Select Models
- 4 Dedicated Trash Can Storage
- 5 22" Stainless Steel Oven
- 6 Crown Molding
- 7 Easy to Reach Stainless Steel Microwave Oven
- 8 Tile Backsplash
- 9 Rich Residential Villa Wood Cabinet Doors
- 10 Residential 5" Pulls
- 11 Solid Surface Countertops
- 12 Deep 50/50 Stainless Steel Sink
- 13 Convenient Pull-Out Faucet with Sprayer



336BHS BUNK ROOM



326RDS REAR DEN LIVING ROOM SHOWN IN VINEYARD DECOR



326RDS KITCHEN AND DINING AREA SHOWN IN VINEYARD DECOR



337FLS LIVING ROOM SHOWN IN VINEYARD DECOR

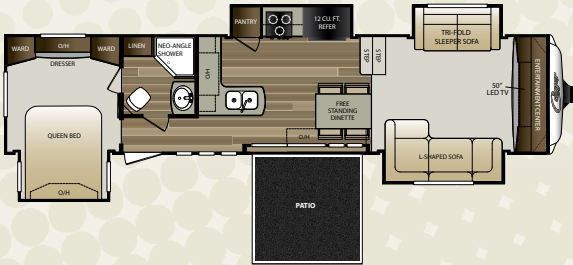

337 NOW AVAILABLE WITH SIDE PATIO!

Enjoy the side patio just off of the dining/kitchen area which is great for entertaining or just relaxing after the days adventure.



337PFL DINING AREA



337PFL KITCHEN

Quick Camp™ Set up & take down camp outside or inside

Slide Rooms
Press slide room button then press right arrow to bring slide out, press left arrow to bring slide in



Power Awning
Press awning button then press right arrow to awning out, press left arrow to bring awning in



Tight Spaces?
Set up camp quickly and easily with Quick Camp™



Rear Stabilizer Jacks
Press rear stabilizer button then press down arrow to bring jacks down, press up arrow to bring jacks up



Awning Light
Press light button to turn light on and off



Can't See?
Activate your lights with Quick Camp™



Cougar
by Keystone
Using Lippert Components™ linC TECHNOLOGY

TOUCH SCREEN REMOTE Standard in all Cougar fifth wheels



BLUETOOTH STEREO. Also includes: AM/FM, MP3, AUX INPUT, USB PORT, DVD/CD PLAYER



4 pt. Level Up System

COUGAR FIFTH WHEEL FEATURES



Another Cougar first: The rear storage rack provides a quick slide-away storage alternative. (N/A on 326SRX)



DOCKING STATION with battery disconnect for quick and easy set up.



ORTHOPEDIC SLEEP SYSTEM includes 7.5" foam mattress, orthopedic foam bunk mats and ortho tri-fold sleep surface.



Watch the big game or movie in the new OPTIONAL THEATER SEATING. (303RLS, 327RES, 333MKS, 336BHS,) Windows now have MCD roller shades to block out harsh sunlight.



OPTIONAL FIREPLACE (*Mandatory on 326SRX)



W/D PREP (288RLS, 313RLI, 326SRX, 327RES, 303RLS, 333MKS)



40" LED TVs in the main living area (50" in 337FLS, 337PFL, 339BHS in bunkroom)



LP gas hook up



Cougar slam baggage doors offer added security and convenience while providing better insulation.



Industry First PASS-THRU STORAGE PLUS



No need to worry about mobile devices dying. All Cougar fifth wheels come equipped with a USB CHARGING CENTER



Cougars command center features back lighted switches and places all of your controls in one convenient location.



LED Lighted awning

Cougar

by Keystone

(5-SIDED ALUMINUM SUPER STRUCTURE)

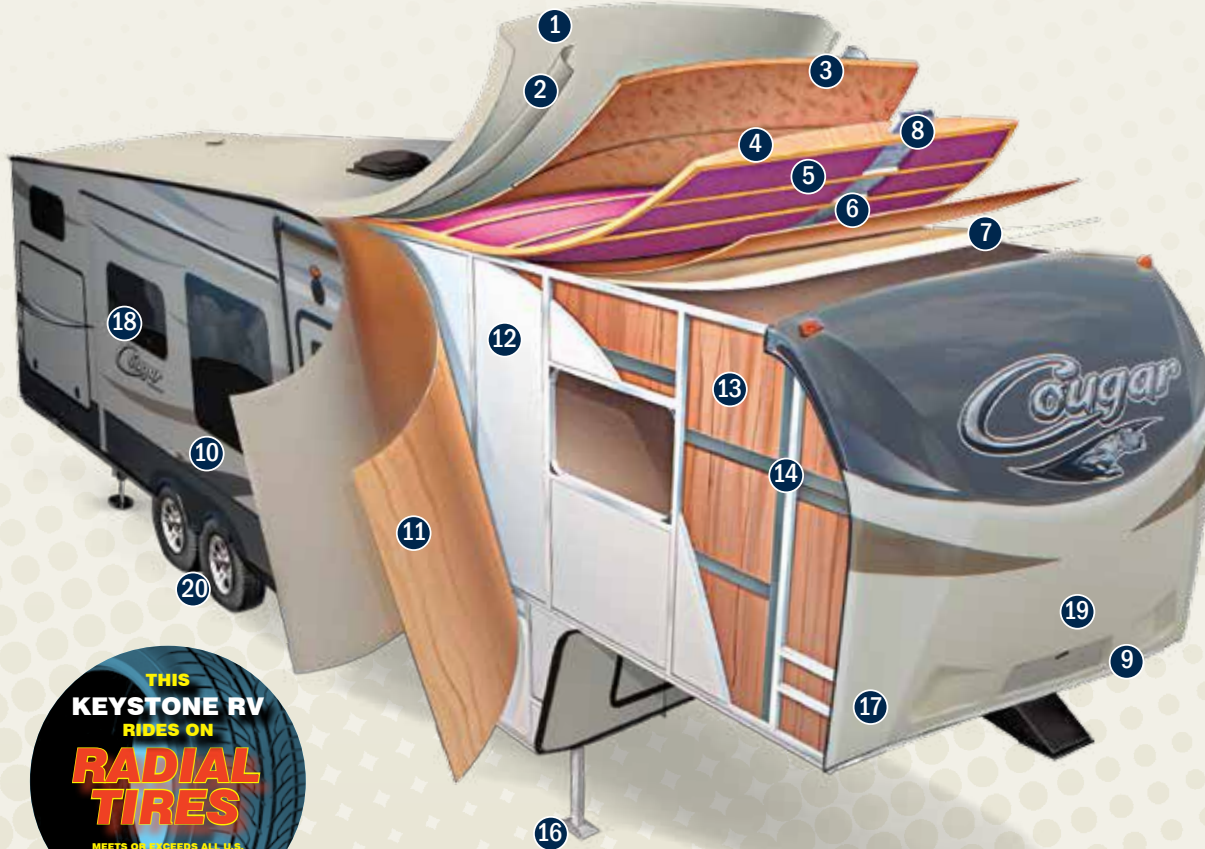

- 1 One-piece T.P.O. roof membrane with 12 year warranty
- 2 Radius roof transition molding
- 3 3/8" roof decking
- 4 5" fabricated rafters on 16" centers
- 5 Fiberglass insulation (R-14)
- 6 Ceiling decking Luan backer
- 7 Vinyl ceiling panel
- 8 Triple insulated, foam-core air conditioning duct
- 9 Hitch Vision (Patented)
- 10 High gloss clay medallion fiberglass sidewall
- 11 1/8" Luan board (2 layers)
- 12 Solid block foam insulation (R-9)
- 13 Interior decorator wall board
- 14 2" welded aluminum wall studs
- 15 Electro-galvanized sheet (EGS) metal backing strips
- 16 Easy access adjustable snap jack pins
- 17 Industry leading "Max Turn" turning radius
- 18 Tinted safety glass windows
- 19 LED Docking lights
- 20 E-Z lube axles with MOR/ryde CRE 3000 suspension



FLOOR (R-14) + (R-15)

- 1 10" steel i-beam (powder coated)
- 2 3" Welded aluminum floor joists
- 3 3" Large-capacity insulated heat duct
- 4 1/4" polypropylene enclosed underbelly
- 5 Welded steel cross members
- 6 Full radius wrap aluminum enclosure
- 7 Woven moisture and vapor barrier
- 8 Fiberglass insulation (R-14)
- 9 5/8" Dyna Span floor decking (one seamless piece)
- 10 Residential-grade carpeting with stain protectant
- 11 2" Heat duct from furnace into underbelly
- 12 Heated, enclosed water lines
- 13 Astro-Foil insulation barrier (R-15)





CRE/3000 RUBBER EQUALIZER

FOR SUSPENSIONS, IT LOOKS LIKE THIS:
 UPGRADED EQUALIZER = IMPROVED SUSPENSION TRAVEL OVER STOCK
 STANDARD, STOCK STEEL ROCKER ARM & LEAF SPRINGS

MOR/RYPDE SUSPENSION

What does "Best-In-Class" mean for a suspension system?

It means that all suspensions are not created equal. Like all other products, there are unique product segments relative to price and quality demands.

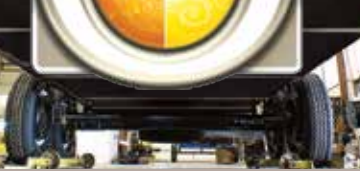

ZERO DEGREE TESTED

Cougar has been zero degree tested. The Polar Package Plus allows you to camp to zero degrees without worry of your tanks or water lines freezing up*.

We also add upgraded insulation to our slide-out floors to control the hot and cold exchange and unlike our competition we merge our skirt metal to the I-Beam for complete enclosure of your fifth wheel underbelly.

*Testing and certification achieved under a constant controlled environment.



**RAIN BAY TESTED.
ALL WEATHER APPROVED.**

**ASK THE OTHER GUYS IF
THEY HAVE BEEN TESTED!**



PATENTED COUGAR HITCH VISION

Hitch Vision moves the dial forward in what customers expect from an RV. There's no looking back!

Hitch Vision gives the fifth wheel user complete confidence to back up and align their truck to Cougar's extended hitch pin using only the built-in mirror for guidance. Automotive LED docking lights, which can be controlled by the E-Z Camp Cougar Remote, allow you to load or unload camping gear day or night. (Hitch Vision also comes in handy when using the E-Z Camp Cougar Remote to raise and lower landing gear.) Once you've used Hitch Vision, "there's no looking back" to the inconvenience of turning or straining to see your fifth wheel.

MAX TURN FRONT CAP

Combining focused design and unique product specifications, Max Turn Technology is the leader in optimum turn radius.

Unlike the competition, Cougar uses continuous contoured tubular steel for optimum strength and support behind the engineered tapered fiberglass front cap.

Also, Cougar is equipped with a heavy duty extended hitch. Combined - Max Turn Technology makes turning and maneuvering a breeze.



COUGAR FIFTH WHEEL FLOORPLANS



288RLS

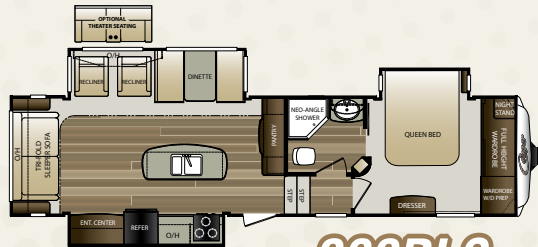

303RLS



325RPS NEW



326RDS NEW

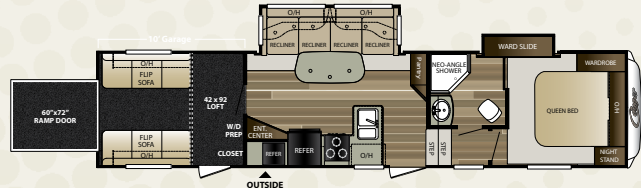

326SRX

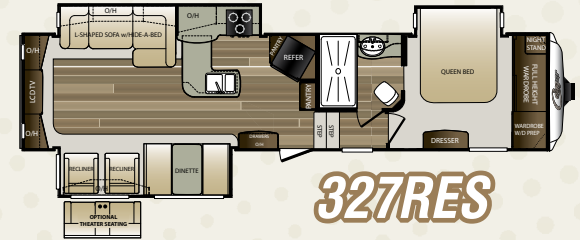

327RES

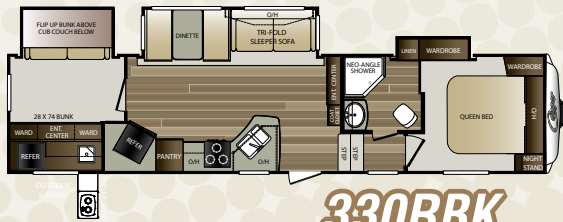

330RBK

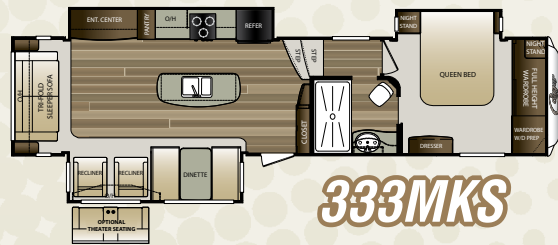

333MKS

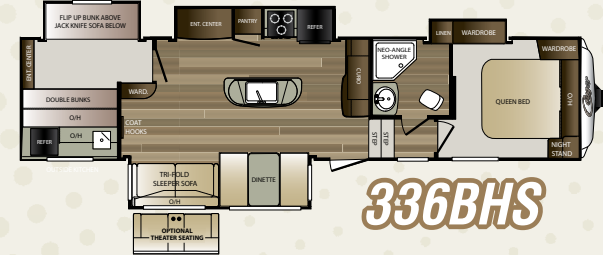

336BHS



337PFL NEW

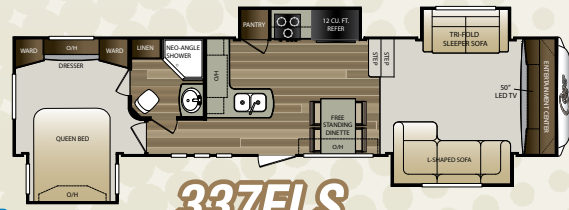

337FLS

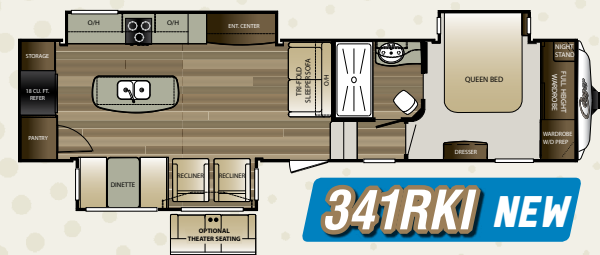

341RKI NEW

MODEL	SHIPPING WEIGHT	CARRYING CAPACITY	HITCH	LENGTH *	EXTERIOR WIDTH	HEIGHT	FRESH WATER	WASTE WATER	GRAY WATER	LPG	AWNING
288RLS	9385	2720	1705	34' 9"	8'	12' 3"	60	38	76	60	19'
303RLS	9884	2216	1705	34' 8"	8'	12' 3"	60	38	76	60	13'
325RPS	10330	2015	1945	36' 3"	8'	13' 2"	60	38	76	60	17'
326RDS	10295	1840	1735	37' 8"	8'	13' 2"	60	38	76	60	20'
326SRX	9930	2730	2260	37' 7"	8'	13' 2"	60	38	76	60	19'
327RES	10495	1730	1825	37' 4"	8'	12' 3"	60	38	76	60	15'
330RBK	9997	2448	2045	37' 4"	8'	12' 10"	60	38	76	60	19'
333MKS	10516	1834	1950	37' 8"	8'	12' 3"	60	38	76	60	14'
336BHS	10632	1658	1890	37' 8"	8'	12' 6"	60	38	76	60	12'
337PFL	9998	2567	2165	37' 8"	8'	13' 2"	60	38	76	60	16'
337FLS	10500	1955	2055	37' 8"	8'	13' 2"	60	38	76	60	17'
341RKI	10375	1845	1820	37' 8"	8'	13' 2"	60	38	76	60	14'

DISCLAIMER: Product information is as accurate as possible as of the date of publication of this brochure. Features, floor plans, and specifications are subject to change without notice. Please also consult Keystone's web site at keystonerv.com for more current product information and specifications. Tow Vehicle Disclaimer. CAUTION: Owners of Keystone recreational vehicles are solely responsible for the selection and proper use of tow vehicles. All customers should consult with a motor vehicle manufacturer or their dealer concerning the purchase and use of suitable tow vehicles for Keystone products. Keystone disclaims any liability or damages suffered as a result of the selection, operation, use or misuse of a tow vehicle. KEYSTONE'S LIMITED WARRANTY DOES NOT COVER DAMAGE TO THE RECREATIONAL VEHICLE OR THE TOW VEHICLE AS A RESULT OF THE SELECTION, OPERATION, USE OR MISUSE OF THE TOW VEHICLE. *Length is defined as the distance from the centerline to the hitch pin/coupler to rear bumper of the trailer.

CAMPING IN STYLE PACKAGE*

- MCD roller shades
- Frameless black trim safety glass windows (tinted to keep the sun out)
- Stainless steel microwave oven with turn style
- Aluminum framed sidewalls, floor, front and rear walls, slide rooms
- 13,500 BTU air conditioner
- Raised-panel upper & lower cabinet doors throughout
- Cougar Platinum Series Orthopedic Sleep System Mattress
- Orthopedic sleep system

VALUE PACKAGE*

- True home CD/DVD system with Bluetooth, speakers and separate zones (12V compatible), MP3 player hookup on stereo
- Gas/electric water heater with quick recovery
- Residential shower/tub surround
- TV antenna
- Satellite/Cable hook-up
- High gloss gel coated Filon® fiberglass
- Full walk-on roof & slideouts
- Fiberglass walls
- Rear stabilizer jacks
- Max Turn Technology front cap (fifth wheels only)
- MOR/ryde CRE 3000 Suspension
- 12V charging station

CONVENIENCE PACKAGE*

- Outside shower
- Residential refrigerator front
- Spare tire
- XL grab handle

COUGAR PACKAGE*

- Slam latch baggage doors
- 40" TV (50" in 337, 32" in 336 bunk room)
- Electric awning
- Radial tires
- Carbon monoxide detector
- Outside speakers
- Black tank flush
- XL Pass through storage with entertainment hook-up
- 16" wheels
- 8 cu ft refrigerator
- Outside LP quick connect
- Main entrance step light
- Battery disconnect
- Solid surface countertops

MANDATORY OPTIONS*

- Slide out bike/storage rack (N/A 326)
- Cougar Camp Remote Control
- Polar Package Plus
- Aluminum wheels
- Multi-Functional L-Shape sleeper sofa (327 only)

STANDARDS, OPTIONS AND DECORS

COUGAR OPTIONS

- "Smart Slide" Free standing dinette
- 15,000 BTU Ducted air conditioning
- Fireplace
- 4 point electric level up
- 2nd air conditioner
- Theater seating (select models)

NOTABLE STANDARD FEATURES

- 50 Amp Service
- E-Z lube hubs on axles (all models)
- Snap jack pins (all fifth wheels)
- 35,000 BTU furnace
- One-piece seamless T.P.O. roof
- Pre-Wire and Prepped for 2nd Air conditioner
- Patented Front Cap Hitch Vision
- Hand glazed hardwood upper and lower cabinet doors through out
- Solid hardwood slide fascia
- 19" LCD spare room TV (326 & 330 only)
- Residential porcelain toilet with foot pedal
- All windows in main slide out open
- Correct Track*

SAFETY MUST-HAVES

- Manual backup on all main slide outs
- T-Mold bulb seals on all slide outs to keep slider sweeps on your slide out (stays on in hot weather)
- LP sensor
- Smoke detector
- Fire extinguisher
- Carbon monoxide detector

DRY CAMPING FEATURES

- 12 Volt stereo/MP3 compatible
- Large fresh, gray & black tanks (all models)
- All slide-out lights are 12 Volt
- Space for dual batteries
- Entire underbelly enclosed to keep debris off tanks, water lines, etc.
- R-15 astro-foil in slideout floors and bottom of chassis
- All lights 12V compatible
- LED Pancake Lights Throughout

* *Mandatory option*

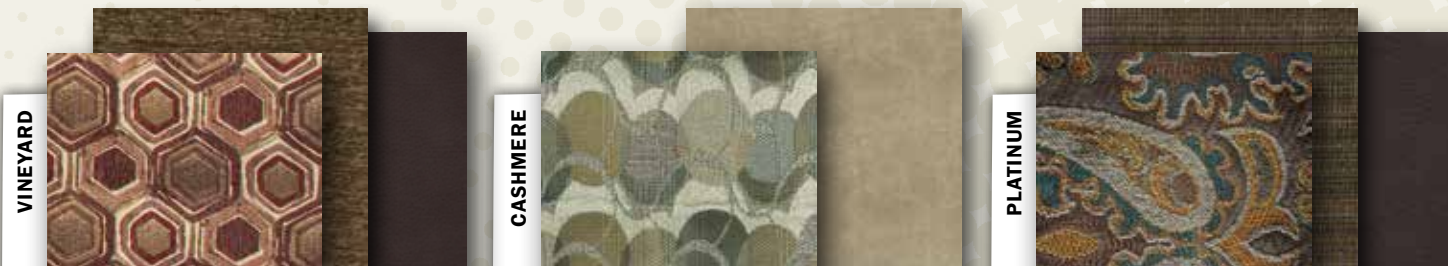

DARE TO COMPARE

- #1 selling fifth wheel in its class (14 years in a row)
- Highest trade-in and resale value in the industry on average
- Hitch Vision (patented) front cap with docking lights & Max Turn Technology (fifth wheels only)
- Exclusive factory installed bike/storage rack on most fifth wheels
- Fully enclosed, underbelly with heated and enclosed dump valves

- Sealed pin box
- 16.2 Gallons per hour – quick recovery water heater (great for bunkhouses)
- Oversized pass-thru storage doors with slam latches
- Slide out seal is mounted in a "T" track (no sticky tape to hold slide seals on)
- Solid surface countertops
- Extra large slide-out windows open for cross ventilation
- R-15 astro-foil in slideout floors and bottom of chassis

- Pass-thru storage plus
- Panoramic picture window at all dinettes
- MCD roller shades
- Porcelain foot flush toilets
- Five side welded aluminum super structure
- R-9 sidewall, R-14 roof, R14+R15 floor insulation and R-15 astro-foil in the slide out
- Fully ducted air conditioning featuring triple insulated, foil wrapped, light weight ducts
- 12 Volt compatible for dry camping

- Outside docking station (fifth wheels only)
- Back lit inside command center
- Stained Ash hardwood upper and lower cabinet doors
- Cougar remote
- Polar package plus
- Full extension drawer guides
- Black tank flush
- Battery disconnect



Cougar

by Keystone



WWW.KEYSTONERV.COM/COUGAR



CONNECT WITH KEYSTONE RV AND STAY UP TO DATE WITH PRODUCT NEWS AND INFORMATION



Go RVing
Life's A Trip

2642 Hackberry Drive
PO Box 2000
Goshen, IN 46527-2000
(574) 535-2100



Keystone RV Company

www.keystonerv.com

YOUR LOCAL DEALER:

Colton RV
3122 Niagara Falls Blvd
North Tonawanda, NY 14120
(716) 694-0188
www.ColtonRV.com

Colton RV
3443 Southwestern Blvd.
Orchard Park, NY 14127
(716) 957-3250
www.Coltonrv.com

BUY LOCALLY PURCHASING YOUR RV LOCALLY

JANUARY 2016

It's up to you where you purchase your new Cougar, but may we suggest your local dealer? Not only does it help your local economy and provide jobs, but it will also give you an opportunity to develop a service relationship with someone that will come to know you and your coach. Congratulations on finding the best built, best equipped, best value in the industry, and happy travels!