

2025 ESTEEM

Gas Class C Motorhome

27U

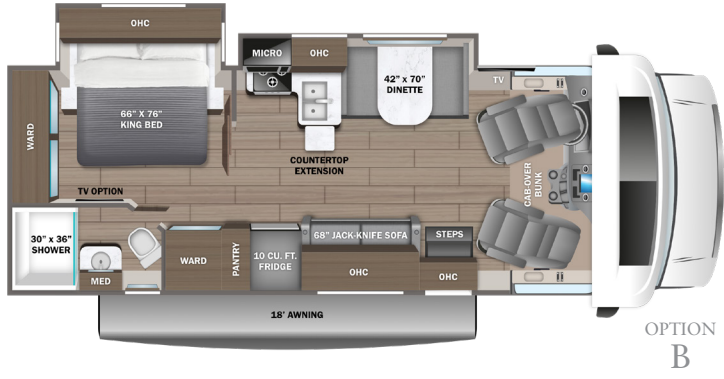

OPTION B

29V

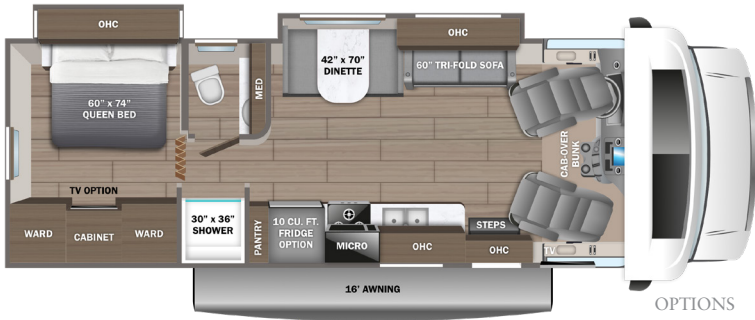

OPTIONS A AND C

31F

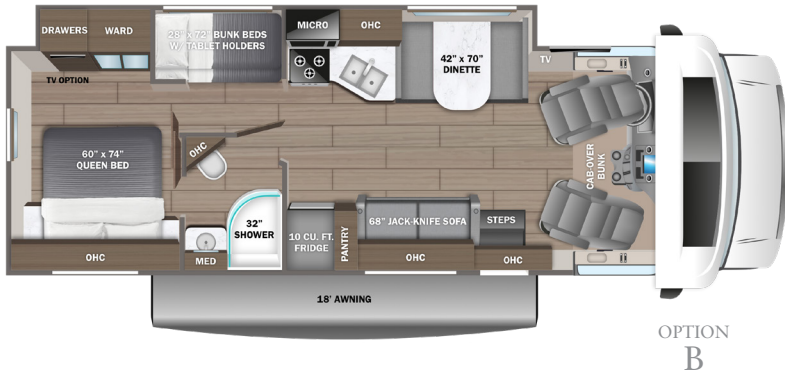

OPTION B

OPTIONS

A



60-inch Theater Sofa

B

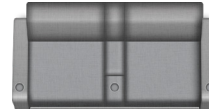

68-inch Theater Sofa

C



15 Cu. Ft. Fridge Option

PAINT SELECTIONS



Currant Full-Body Paint



Granite Full-Body Paint



Medallion Full-Body Paint



Oxford Full-Body Paint



Standard Partial Paint



ENTEGRACOACH

CUSTOMER VALUE PACKAGE

E-Z Drive™ Elite: Computer-balanced driveshaft, Koni® FSD shocks, heavy-duty rear stabilizer bar, standard front stabilizer bar, Helliwig® helper springs, rubber isolation mounts
 One-piece, seamless fiberglass front cap
 Automotive-bonded panoramic window in front cap with power shade
 Automatic hydraulic leveling jacks
 Frameless windows
 Electric patio awning with LED lights
 Exterior LED HD Smart TV with (2) high-output, marine-grade exterior speakers
 1,000W inverter
 Chrome, heated, remote-controlled, side-view mirrors
 Sony® infotainment center with tilt/swivel, Apple® CarPlay and Android Auto™
 Backup and side-view cameras
 LED-lit, solid-surface kitchen countertops

STANDARD CHASSIS EQUIPMENT

Ford® E-450 chassis
 GVWR - 14,500 lb.
 GCWR - 22,000 lb.
 7.3L V-8 325 HP engine with 450 ft.-lb. torque
 6-speed TorqShift® series transmission with overdrive
 210-amp alternator
 Catalytic converter theft deterrent
 E-rated highway tires- LT225/75R16
 Tire pressure monitoring system (TPMS)
 Power anti-lock brakes with power steering
 7,500 lb. hitch with 750 lb. tongue capacity and 7-pin plug
 12V chassis battery
 55 gal. fuel tank

STANDARD EXTERIOR EQUIPMENT

TuffShell™ vacuum-bond laminated roof, floor and sidewalls
 Bead-foam insulation (R-24 max roof, R-9 max floor, R-5 max walls)
 One-piece, seamless, fiberglass roof
 Fiberglass running boards
 Fiberglass side wings
 Fiberglass exterior walls with partial paint and vinyl graphics
 Remote keyless cab entry
 Entrance door with industry's largest travel-view window
 Electric-powered entrance step with integrated house battery compartment
 Slideout awning(s)
 Lockable storage compartments with slam latches
 Third brake light

Roof ladder
 4 in. bumper tube sewer hose storage
 Prep for satellite dish
 Cable TV hookup with RG-6 coax
 Winegard 2.0 Wi-Fi/4G antenna
 4,000W generator with auto-gen start
 200W solar panel with dual controller and second house battery
 12V house battery
 Transfer switch with reverse polarity protection
 30-amp electrical service
 16.5 gal. propane tank (56 lb.)
 LP quick-connect hookup
 Heated holding tanks (12V pads)
 Exterior utility center
 Winterization drain system
 Black tank flush
 Outside shower
 12V demand water pump
 Water filtration system

STANDARD COCKPIT EQUIPMENT

Swivel driver and passenger seats
 Tilt steering wheel
 Driver and passenger airbags
 Power windows and door locks
 Cruise control
 Hill start assist
 Electronic stability control
 Traction control
 Auxiliary start switch

STANDARD INTERIOR EQUIPMENT

Custom-molded ABS surround in cab-over area
 Overhead bunk with 750 lb. capacity and safety net
 Privacy curtain for cab area
 BMPRO total coach control system with wall-mounted touchscreen and mobile app
 84 in. interior ceiling height with padded vinyl ceiling
 High-intensity recessed LED ceiling lights
 LED-lit fascia
 Hardwood cabinet doors and drawer fronts
 Ball-bearing drawer guides
 Blackout night roller shades
 15,000 BTU A/C with heat pump
 30,000 BTU auto-ignition furnace
 6 gal. gas/electric DSI auto-ignition water heater
 Entegra-exclusive, easy-operation legless dinette table
 2-point lap safety belts in all designated seating locations
 Car seat tethers (select floorplans)

LED HD Smart TV in living area
 JBL® audio system
 Smoke alarm
 Carbon monoxide detector
 Fire extinguisher
 10 cu. ft. 12V refrigerator
 Furrion® all-in-one cooktop and oven
 Residential-size microwave
 Recessed stainless steel kitchen sink with solid-surface covers
 Flip-up countertop extension (select models)
 Decorative kitchen backsplash
 Pop-up charging station in kitchen with 120V outlets and USB ports
 Walk-around, queen-size bed with bedspread and nightstands (king size in 27U)
 USB port and wireless charging in nightstands
 Under-bed storage (select models)
 Large wardrobes
 Bunks with industry-exclusive 300 lb. capacity each (31F)
 Wall-mounted tablet holder in each bunk (31F)
 Shower with decorative surround, glass door, skylight and light
 Recessed stainless steel bathroom sink
 Porcelain toilet with foot flush
 Powered roof vent in bathroom with wall switch

OPTIONS

Power theater seating (27U, 29V, 31F)
 15 cu.ft. 12V refrigerator (29V)
 LED HD Smart TV in bedroom
 Dual 13,500 BTU A/C units with energy management system
 Aluminum rims
 Folding windshield sun shade



NO ONE OFFERS A BETTER WARRANTY

At Entegra Coach, we build our RVs to handle every adventure, then back them with our industry-leading 2+3 limited warranty. Our 2-year limited warranty has you covered for 2 camping seasons. That's 730 days. In addition, our 3-year structural limited warranty has you covered for 3 camping seasons or 1,095 days. You won't find a better limited warranty in the business, because the only strings we attach are those that deliver the ultimate in reliability. For a copy of our 2-year limited + 3-year structural limited warranty with complete terms and conditions, please contact your local Entegra Coach dealer.

It is important for your safety and enjoyment that you are aware of the weights and tow ratings of the RV you select. Consult a competent advisor for questions or advice. Whether you are new to RVing or a veteran, get a feel for the performance of your RV before heading out on the roadways. When you tow a vehicle with your RV, you must drive differently than when you drive a single vehicle. Practice hooking up, driving, backing up and braking in a safe environment or seek out professional instruction. Jayco affixes a weight label to each RV which lists weight information for that vehicle. Refer to that label to verify the vehicle will meet your requirements. Gross Vehicle Weight Rating (GVWR): The maximum permissible weight of the motorhome, including the Unloaded Vehicle Weight (UUV) plus passengers, personal items, all cargo, fluids, options and dealer-installed accessories. The GVWR is equal to or greater than the sum of the UUV and the Cargo Carrying Capacity. Gross Combined Weight Rating (GCWR): The maximum allowable combined weight of the motorhome used as a tow vehicle and the attached towed vehicle.

| Floorplan | GVWR (lbs.) | GCWR (lbs.) | Wheel Base | Overall Length | Exterior Height w/ A/C & Satellite | Exterior Width | Interior Height | Fresh Water Capacity (gal.) | Grey Waste Water Capacity (gal.) | Black Waste Water Capacity (gal.) |
|-----------|-------------|-------------|------------|----------------|------------------------------------|----------------|-----------------|-----------------------------|----------------------------------|-----------------------------------|
| 27U | 14,500 | 22,000 | 195 | 29' 11" | 11' 8" | 100 | 84 | 42.5 | 41 | 31 |
| 29V | 14,500 | 22,000 | 223 | 32' 6" | 11' 8" | 100 | 84 | 47 | 41 | 32 |
| 31F | 14,500 | 22,000 | 223 | 32' 6" | 11' 8" | 100 | 84 | 47 | 41 | 31 |



Part of Jayco Family of Companies

Entegra Coach, Inc., P.O. Box 460, Middlebury, IN 46540, www.entegracoach.com. See dealer for further information and prices. All information in this brochure is the latest available at the time of publication approval. Entegra Coach reserves the right to make changes and to discontinue models without notice or obligation. Photos in this brochure may show optional equipment and props for photography purposes. RVs built for sale in Canada may differ to conform to Canadian codes. ©2025 Entegra Coach, Inc. Printed in U.S.A. 2032938



entegracoach.com/esteem

LEGACY ISN'T LEFT,
IT'S LIVED.