

PALOMINO

BASECAMP TENT CAMPERS

OR/ORV TENT CAMPERS



PURE MICHIGAN®



10B

PALOMINO BASECAMP

TENT CAMPERS

Palomino tent campers have your comfort in mind. The standard indoor/outdoor cooktop gives you flexible cooking options while the 19 gallon fresh water tank gives you plenty of water for drinking or cleanup. And even if the temperature drops at night, the 20,000 BTU furnace will keep you comfortable and warm.



DESIGNED TO MOVE [YOU][®]

Construction matters. Each Palomino tent camper comes with a one-piece Filon fiberglass roof, which keeps the rain out, and is pre-framed for the optional roof air conditioner. The upgraded 5-piece sectionalized tenting makes repairing a section of the screen easier than replacing the entire camper's screens.



ADDITIONAL BUMPER STORAGE FOR EASY ACCESSIBILITY STANDARD ON ALL FLOORPLANS



CAMPING POSITION



TRAVELING POSITION



14ULC

PALOMINO BASECAMP

TENT CAMPERS

Practical and comfortable. Sleep should be peaceful, even on the colder nights. The Palomino bunks have large, comfortable Serta mattresses and thermo-foil bed ends to keep the heat in and the cold out. The dinette cushions are reversible so any food or drink spills can be easily cleaned off the reverse, vinyl side.



PALOMINO BASECAMP TENT CAMPER

FLOORPLANS & SPECIFICATIONS

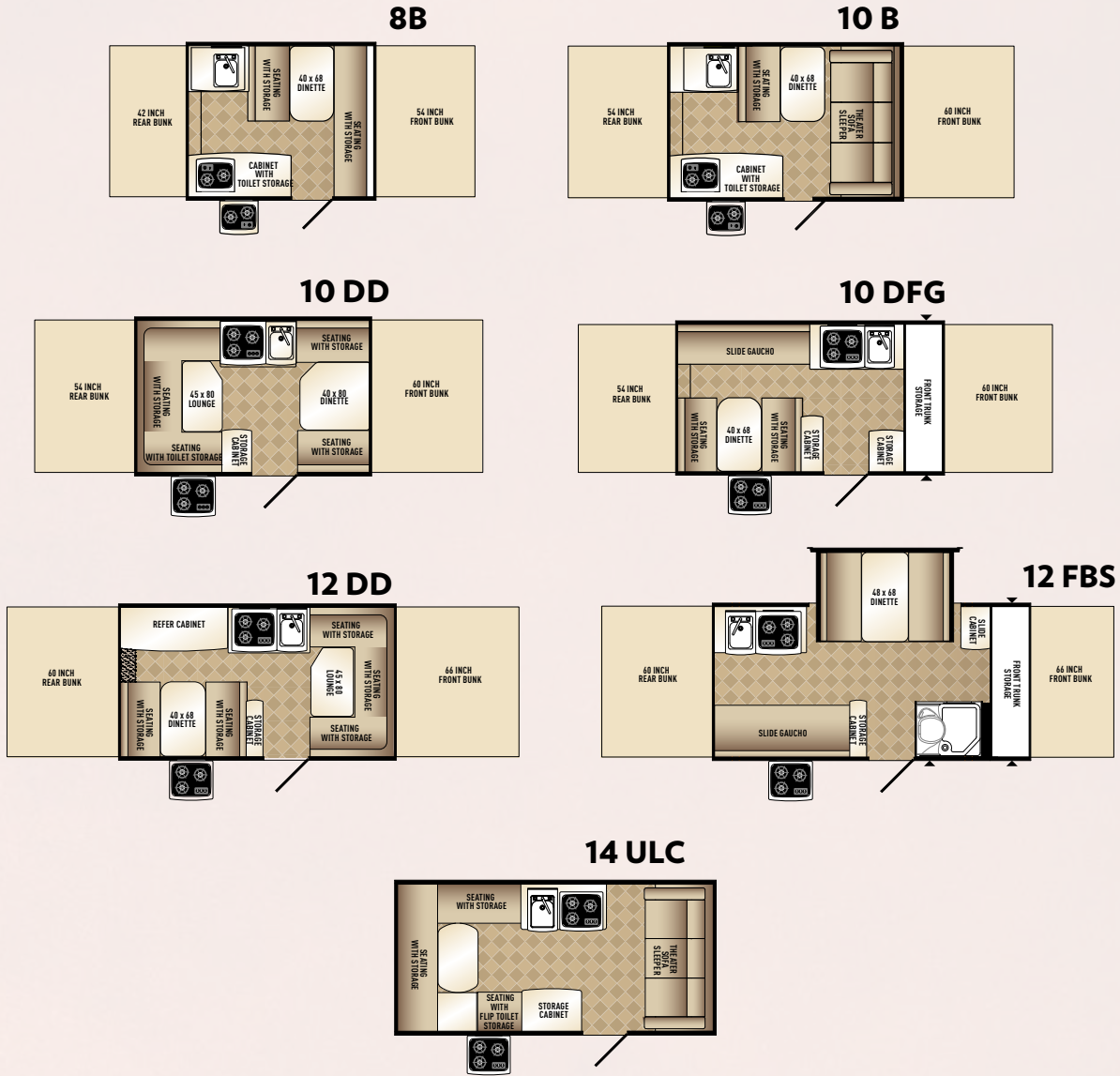

WEIGHTS & MEASURES	8 B	10 B	10 DD	10 DFG	12 DD	12 FBS	14 ULC
Travel Length	11'10"	13'10"	13'10"	15'10"	15'10"	17'10"	18'3"
Travel Width	85"	85"	85"	85"	85"	85"	85"
Travel Height	52"	52"	52"	56"	56"	56"	56"
Interior Open Length	16'8"	20'2"	20'2"	20'2"	23'10"	23'10"	14'6"
Interior Open Height	6'7"	6'7"	6'7"	6'7"	6'7"	6'7"	6'7"
Front Sleeping Area	54 X 80	60 X 80	60 X 80	60 X 80	66 X 80	66 X 80	NA
Rear Sleeping Area	42 X 80	54 X 80	54 X 80	54 X 80	60 X 80	60 X 80	NA
Tire Size	12"	12"	12"	13"	13"	13"	13"
Hitch Weight (Approx. Dry)	122 LBS.	210 LBS.	325 LBS.	152 LBS.	199 LBS.	257 LBS.	219 LBS.
Axle Weight (Approx. Dry)	1278 LBS.	1386 LBS.	1476 LBS.	1801 LBS.	1851 LBS.	2191 LBS.	1817 LBS.
Total Dry Weight	1400 LBS.	1596 LBS.	1801 LBS.	1953 LBS.	2050 LBS.	2448 LBS.	2036 LBS.
Cargo Capacity (Approx. Dry)	756 LBS.	649 LBS.	449 LBS.	1046 LBS.	949 LBS.	1104 LBS.	1386 LBS.
Fresh Water	19 GALS.	19 GALS.	19 GALS.	19 GALS.	19 GALS.	19 GALS.	19 GALS.
Black Water	NA	NA	NA	NA	NA	3 GALS.	NA

PALOMINO BASECAMP

ORV TENT CAMPERS

All our ORV campers come with a smooth pearl exterior and is finished off with the tough LineX® rock guard and powder-coated front deck with ramp / rail system. This keeps your camper clean and durable for years to come. Matched with 15" off road tires and scissor-style B.A.L. jacks, you can set up camp off the beaten path.



PALOMINO BASECAMP TENT CAMPER

ORV FLOORPLANS & SPECIFICATIONS

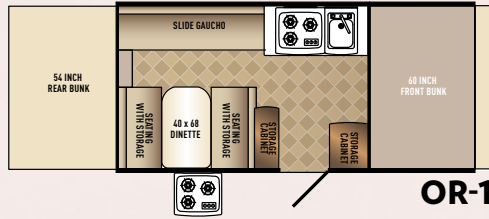

OR-1

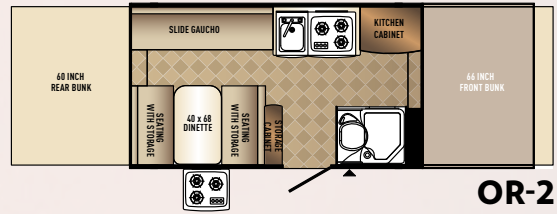

OR-2

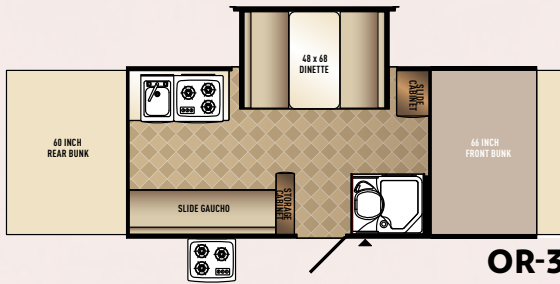

OR-3

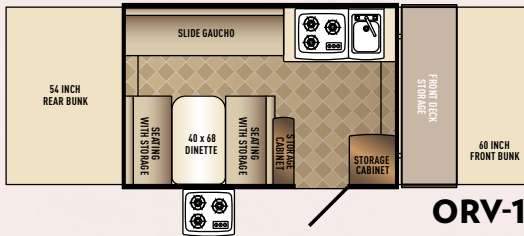

ORV-1

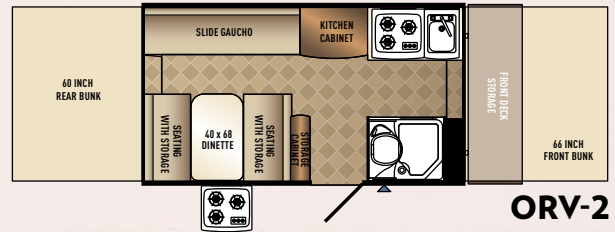

ORV-2



WEIGHTS & MEASURES

	OR-1	OR-2	OR-3	ORV-1	ORV-2
Travel Length	21'11"	24'0"	24'0"	17'2"	20'1"
Travel Width	85"	85"	85"	85"	85"
Travel Height	64"	64"	64"	64"	64"
Interior Open Height	6'7"	6'7"	6'7"	6'7"	6'7"
Front Sleeping Area	60 X 80	66 X 80	66 X 80	60 X 80	66 X 80
Rear Sleeping Area	54 X 80	60 X 80	60 X 80	54 X 80	60 X 80
Tire Size	15"	15"	15"	15"	15"
Hitch Weight (Appx. Dry)	299 LBS.	417 LBS.	353 LBS.	172 LBS.	302 LBS.
Axle Weight (Appx. Dry)	2313 LBS.	2422 LBS.	2644 LBS.	2151 LBS.	2246 LBS.
Total Dry Weight	2612 LBS.	2839 LBS.	2997 LBS.	2323 LBS.	2548 LBS.
Cargo Capacity (Appx. Dry)	1153 LBS.	1044 LBS.	822 LBS.	1315 LBS.	1220 LBS.
Front Deck Space (Ft.)	5' X 7'	5' X 7'	5' X 7'	2' X 7'	2' X 7'



PALOMINO BASECAMP TENT CAMPER STANDARDS & OPTIONS

STANDARD FEATURES

- GLAZED WALNUT CABINET DOORS
- LED INTERIOR LIGHTS
- 1200 LB. CAREFREE® ELECTRIC WINCH
- SPARE TIRE & CARRIER
- 20,000 BTU FURNACE
- SERTA® MATTRESS
- CREATE A BREEZE FAN
- ELECTRIC BRAKES
- KOOL A TRON 1.9 CU FT 2-WAY REFRIGERATOR
- 3 FLAP SAFETY SYSTEM TENT
- REVERSIBLE CUSHIONS
- PEARL EXTERIOR W/ LINE X® ROCK GUARD (N/A ON 8B & 10B)
- ELECTRIC ROOF LIFT
- THERMO FOIL BED ENDS
- 19 GALLON FRESH WATER TANKS ON ALL FLOORPLANS
- ROOF LED LIGHT STRIP

AVAILABLE OPTIONS

- AIR CONDITIONER (13,500 BTU)
- ALUMINUM WHEELS
- AM/FM BLUETOOTH STEREO
- DOMETIC® REFRIGERATOR
- DOUBLE LP GAS BOTTLES
- HANGING PANTRY
- HANGING WARDROBE
- HOT WATER AND OUTSIDE SHOWER (STD. ON BATHROOM MODELS)
- OUTSIDE GAS GRILL
- SCREEN ROOM



Forest River, Inc. encourages our customers to purchase their Forest River products from a local dealership whenever possible for the following reasons:

- 1) Forest River, Inc. dealers are independently owned and operated businesses so priority service and scheduling is at their discretion and is often provided to customers that purchased their unit at that dealership.
- 2) Purchasing locally allows customers to establish meaningful relationships with a dealer, enhancing the RV experience through assistance with product questions, user tips or RV regulations for your state or country, and much more!
- 3) Canadian customers must meet requirements to bring an RV purchased out of the country to their home. These requirements may involve additional inspections and certifications, taxes and fees. Your local Canadian Dealer is a professional at meeting these requirements.
- 4) Scheduling timely warranty repairs and adjustments through a local dealership provides far greater flexibility and convenience to you, the customer!

It is the goal of Forest River, Inc. that all of our RV owners fully enjoy the RV experience and that customer satisfaction meets or exceeds their expectations!



PRE-DELIVERY INSPECTION FACILITY

20,000 square feet of quality assurance. The bare essentials for a premium product. This state-of-the-art facility gives immediate daily feedback to production for quality assurance in every unit built.



FREE MEMBERSHIP
to Forest River Owners' Group

www.forestriverfrog.com



PALOMINO TENT CAMPER DEALER

Budget RV Outlet of Buffalo
4817 Lake Ave.
Blasdell, NY 14219
www.budgetrvoutlet.com



Learn More
Scan this barcode using a QR Reader on your smart phone to learn more about Forest River.



A Berkshire Hathaway company.

SINCE 1968
PALOMINO
Recreational Vehicles
a Division of Forest River

PALOMINO RV
1047 EAST M-86 | COLON, MI 49040
P: 269.432.3271 | F: 269.432.2516
www.palominoRV.com

All illustrations and specifications contained in this literature are based on the latest product information at time of publication. Forest River, Inc. reserves the right to make changes in prices, colors, materials, equipment and specifications at anytime without notice and assumes no responsibility for any error in this literature. All weights shown are approximate. All units are shipped F.O.B. point of manufacture. CONSULT YOUR LOCAL DEALER FOR WARRANTY INFORMATION. Litho U.S.A. 2014.12.22 FOR 1209