



DUTCHMEN® CONSTRUCTION ADVANTAGE

We put a great amount of thought into every RV we design and build. From strong frames, to sturdy walls and insulation, we build every RV to take you on many adventures to come.

Durable Roof Structure

- 1 TPO Roof
- 2 3/8" Decking
- 3 Fiberglass Insulation
- 4 Luan Interior Panel

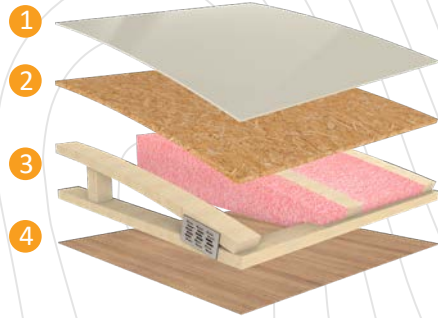

Blade Air Flow System

This design reduces air turbulence and noise accelerating airflow with duct elbows and wyes that feature enlarged inlets and narrow as they push cooled air from the AC through the length of the ducting.

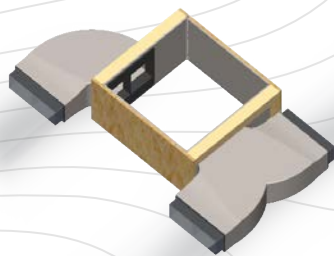

Insulated Structure

- 1 Metal Exterior Panel
- 2 Wood Frame with R7 Thermal Insulation
- 3 Luan Interior Panel

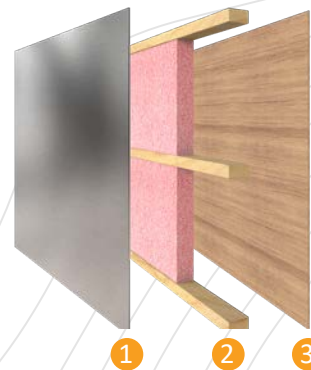

MORE STANDARD FEATURES MORE VALUE

Everything we put into our innovative floor plans are designed to maximize storage and comfort. We don't stop there, to ensure peace of mind after the purchase we have the industry's best RV warranty, 100% pre-delivery inspection, and the leader in parts and service. While other manufacturers offer features as options, we prefer to make those same features standard.

We've built a reputation for bringing RV owners more standard features for less money for over 25 years, and it's a reputation we plan to keep.



100% PRE-DELIVERY INSPECTION

At Dutchmen, quality is standard. Every single Dutchmen RV that comes off the line receives its own pre-delivery inspection. Every unit undergoes a thorough 253-point check to ensure accurate measurements, fully-functional electronics and components.



THE INDUSTRY'S BEST RV WARRANTY

With this industry-best warranty, we take the guessing game out of what is and isn't covered. So, that means you don't have to wrangle over the details, because we deliver value by clearly outlining the major components we back during the first three years.



THE LEADER IN PARTS AND SERVICE

Replacement parts. Routine checkups. Expert advice. You name it and we've got it covered. When only the best RV services will suffice, our industry-leading parts and service department is ready to help you get back on the road - and stay there longer than ever before.

Length is defined as the distance from the centerline of hitch pin/coupler to rear bumper of trailer. **Our weights represent how most units are built, inclusive of many commonly-ordered options. ***Fresh water capacity includes water heater capacity.

DISCLAIMER: Product information is as accurate as possible as of the date of brochure publication. All features, floor plans and specifications in this brochure are subject to change without notice. Please consult Dutchmen's website at www.Dutchmen.com for current product information and specifications. Tow Vehicle Disclaimer. CAUTION: Owners of Dutchmen recreational vehicles are solely responsible for the selection and proper use of tow vehicles. All customers should consult with a motor vehicle manufacturer or their dealer concerning the purchase and use of suitable tow vehicles for Dutchmen products. Dutchmen disclaims any liability or damages suffered as a result of the selection, operation, use or misuse of a tow vehicle. DUTCHMEN'S LIMITED WARRANTY DOES NOT COVER DAMAGE TO THE RECREATIONAL VEHICLE OR THE TOW VEHICLE AS A RESULT OF THE SELECTION, OPERATION, USE OR MISUSE OF THE TOW VEHICLE. REFERENCE DUTCHMEN MANUFACTURING OWNERS MANUAL FOR LIMITED WARRANTY DETAILS. © 2021Dutchmen 10-13-2021-Coleman-Lantern-Printed in U.S.A

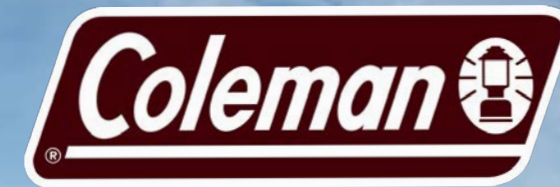

Lantern



Travel Trailers Illuminating Adventure

Your Dealer Colton RV & Marine
3122 Niagara Falls Blvd
North Tonawanda, NY 14120
(716) 694-0188
www.ColtonRV.com

Colton RV & Marine
3443 Southwestern Blvd.
Orchard Park, NY 14127
(716) 957-3250
www.Coltonrv.com

PO BOX 2000 | 2164 CARAGANA COURT | GOSHEN, IN 46527 | SALES 574.537.0600

www.dutchmen.com

Visit us online to see all the Dutchmen brands, innovative models and spacious floor plans.



Dutchmen®



Lantern

Soul of the RV

Whether a weekend getaway or an extended season, the Coleman will renew your spirit. With more standard features and a focus on quality, value, and design, find your soul of the RV.

Features in Coleman

- **Power Plus Package** - an all around easy-to-use system that makes setting up and tearing down a breeze with a Power Awning w/LED lights, Power Stabilizer Jacks and a Power Tongue Jack.
- **Upgraded Kitchen Package** - residential appliances, high rise faucet, farm style sink (Lantern only), pull out kitchen trash can (select models).
- **Solid Entry Step** - stability you need when coming and going from your Coleman. Easy to expand and store away, these aluminum steps deliver a sound platform.

EXTERIOR FEATURES:

- Power Awning w/ LED Lights
- Power Tongue Jack
- Power Stabilizer Jacks
- Diamond Plate Rock Guard
- Mega Pass Thru Storage Compartment w/ Magnetic Catches
- Backup Camera Prep
- Solar Panel Prep
- Friction Hinge Entry Door
- Exterior Spray Port
- 30 Amp Power Cord
- 50 Amp Power Cord (Select Models)
- 13,500 BTU Air Conditioner
- Black Tank Flush
- Solid Entry Step
- Exterior Command Center
- Enclosed Underbelly (Select Models)

INTERIOR FEATURES:

- 60"x 74" Queen Bed
- Upgraded Beauflor Lino
- Dual Row LED Interior Lighting
- Foot Flush Toilet
- Seamless Countertops (Lantern Only)
- 3 Burner Range w/ Glass Cover & 17" Oven
- Large Single Bowl Farm Sink w/ High Rise Faucet
- Range Hood w/ Light & Exhaust Fan
- Fireplace w/ 5K BTU Heater (Lantern Only)
- Bedroom Pocket Doors (Floor plan Specific)
- Pleated Night Shades in Living Area & Bedroom
- AM/FM/CD/AUX Stereo 2 Zone Stereo w/ USB
- 6 Gallon Gas Water Heater w/ DSI
- High Output Furnace
- Upgraded Kitchen Window

Standard Features In Every Floor Plan

*N/A Single Axles

POWER PLUS PACKAGE



LANTERN SERIES



LANTERN 242BH
Length: 28' 11" Weight: 5,987 lbs. Sleeps: 4-6
Hitch: 698 lbs. Height: 11' 3"



LANTERN 263BH
Length: 30' 7" Weight: 6,168 lbs. Sleeps: 4-6
Hitch: 822 lbs. Height: 11' 1"



LANTERN 264RL
Length: 30' 11" Weight: 6,152 lbs. Sleeps: 2-4
Hitch: 753 lbs. Height: 11' 3"



LANTERN 285BH
Length: 32' 9" Weight: 6,611 lbs. Sleeps: 4-8
Hitch: 869 lbs. Height: 11' 2"



LANTERN 286RK
Length: 32' 11" Weight: 6,726 lbs. Sleeps: 2-4
Hitch: 745 lbs. Height: 11' 3"



LANTERN 295QB
Length: 32' 8" Weight: 6,601 lbs. Sleeps: 4-8
Hitch: 863 lbs. Height: 11' 4"



LANTERN 334BH
Length: 37' 3" Weight: 8,548 lbs. Sleeps: 4-8
Hitch: 1,098 lbs. Height: 11' 4"



LANTERN 337BH
Length: 37' 11" Weight: 8,436 lbs. Sleeps: 4-8
Hitch: 1,084 lbs. Height: 11' 4"

INTERIOR DECORS

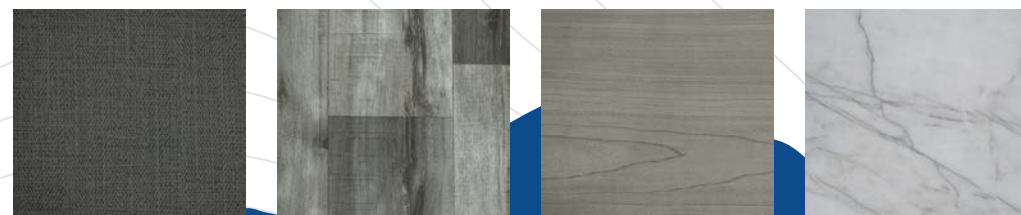

Boulder

Flooring

Woodgrain

Countertops

LANTERN LT SERIES



LANTERN LT 18BH
Length: 22' 10" Weight: 3,672 lbs. Sleeps: 2-3
Hitch: 510 lbs. Height: 9' 9"



LANTERN LT 18FQ
Length: 22' 9" Weight: 3,980 lbs. Sleeps: 2-4
Hitch: 457 lbs. Height: 10' 1"



LANTERN LT 202RD
Length: 24' 11" Weight: 4,521 lbs. Sleeps: 2-4
Hitch: 604 lbs. Height: 10' 10"



LANTERN LT 214BH
Length: 25' 11" Weight: 4,546 lbs. Sleeps: 4-6
Hitch: 455 lbs. Height: 10' 8"



LANTERN LT 262BH
Length: 30' 7" Weight: 5,909 lbs. Sleeps: 4-8
Hitch: 754 lbs. Height: 11' 4"



LANTERN LT 274BH
Length: 28' 6" Weight: 4,824 lbs. Sleeps: 4-8
Hitch: 586 lbs. Height: 10' 4"

LANTERN TOY HAULERS



LANTERN TOY HAULER 251TQ
Length: 29' 11" Weight: 5,728 lbs. Sleeps: 4-8
Hitch: 853 lbs. Height: 11' 5"



LANTERN TOY HAULER 270TQ
Length: 31' 6" Weight: 6,241 lbs. Sleeps: 4-8
Hitch: 945 lbs. Height: 11' 4"



LANTERN TOY HAULER 300TQ
Length: 34' 11" Weight: 6,781 lbs. Sleeps: 4-8
Hitch: 998 lbs. Height: 12' 4"

Garage Features

- 1,600-lb. Rated Rear Ramp Door
- Maximized Storage Flat Floors
- 2,500-lb. Rated Recessed D-Rings

To learn more visit our website dutchmen.com