

*HIGH COUNTRY*  
**MONTANA**

LUXURY FIFTH WHEELS



**KEYSTONE**  
RV COMPANY

**CAMPBETTER**  
KINDNESS · COMMUNITY · PLANET

# A WIDE WORLD A WAITS

Welcome to a new era of elevated travel experiences with the 2024 Keystone Montana High Country. Step into a realm where every detail is meticulously crafted to enhance your journey, from the breathtaking panoramas framed by expansive windows to the innovative features like SolarFlex™ solar power systems and our exclusive Winegard Air 360+ antenna with satellite pass through that make life on the road seamless. With slightly shorter models, floorplan options designed for families, and warranty coverage for full-time travelers, High Country is a favorite for RV enthusiasts throughout North America.

## MONTANA HIGH COUNTRY EXCEPTIONAL FEATURES

- **NEW** Exciting Exterior Graphics
- **NEW** Fibrogloss™ High-Gloss Sidewalls
- Lippert Ground Control™ Leveling w/ Hitch Memory
- Road Armor™ Suspension w/ 1/2" Shackle Plates, Wet Bolts & Bronze Bushings
- Nitrogen Filled G-Rated Rainier Tires
- Dexter® Gladiator™ Axles w/ Upgraded Springs & Nev-R-Adjust Brakes
- Oversized Lippert G-Class Black Glass Entry Door
- 12V Heating Pads & Furnace Heat Protection for Holding Tanks
- 16 Gallon Gas/Electric Suburban Water Heater
- 70 Gallon Fresh Water Tank
- Seaflo® Water Pump, 12 Db Quieter
- 35K BTU Dometic Furnace & Up to 16.5K BTU Heat Pump
- Two Coleman-Mach Power-Saver Air Conditioners (<12 AMP DRAW EACH)
- Blade Pure™ High-Performance Airflow System w/ Merv 9 Air Filtration
- **NEW** Sandstone Maple Interiors w/ Woodland Maple Accents
- Hardwood Cabinet Drawers & Doors
- **NEW** Bel-Air Vinyl Flooring by Shaw w/ 7-Year Cold Cracking Warranty
- **NEW** Arlington & Kingston Decor Options (SEE WEBSITE FOR DETAILS)
- Solid Surface Kitchen Countertops
- 18 Cu. Ft. Residential Refrigerator w/ Ice Maker (Opt. 16 Cu. Ft 12V Refrigerator)
- 24" Furrion Stove w/ Matching Stainless Steel Drawer
- **NEW** Adjustable 23" Dual-Burner Suburban Griddle in Outside Kitchens
- Central Vacuum w/ Attachments
- 50" Smart TV in the Living Room
- JBL Cube Stereo w/ Mizone Control
- JBL Exterior Speakers
- SolarFlex™ Protect 220i, Discover 440i, Package Options w/ Optional Dragonfly Lithium-Ion Batteries
- 1-Year Limited Base Warranty & 3-Year Limited Structural Warranty (SEE KEYSTONERV.COM FOR DETAILS)



With five kids and a penchant for cross-country adventure, Lanes Less Traveled met their match in the Montana High Country 381TB. Follow their journey on Instagram.



@LANESLESSTRAVELED —MONTANA HIGH COUNTRY 381TB OWNERS

# MONTANA HIGH COUNTRY FIFTH WHEELS

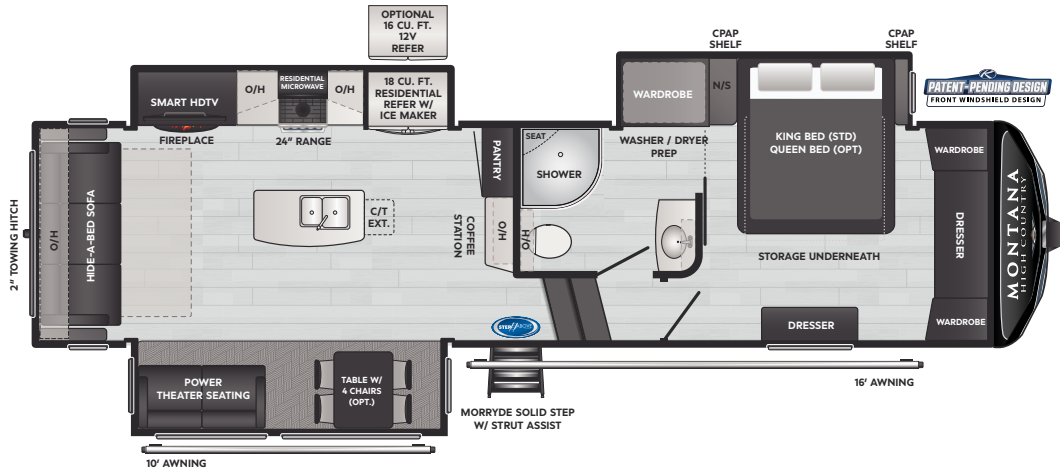

**295RL** | WEIGHT 11697 | LENGTH 34' 0"

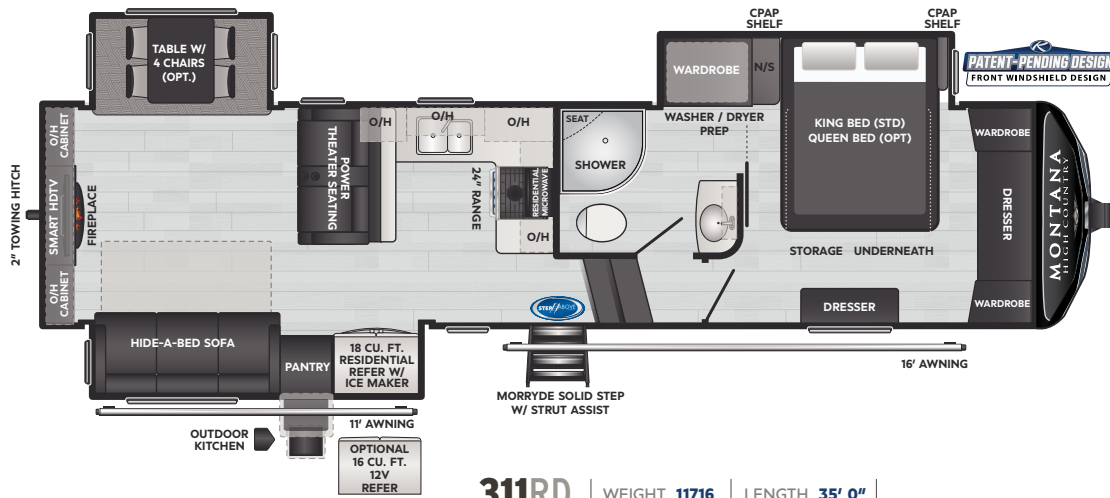

**311RD** | WEIGHT 11716 | LENGTH 35' 0"

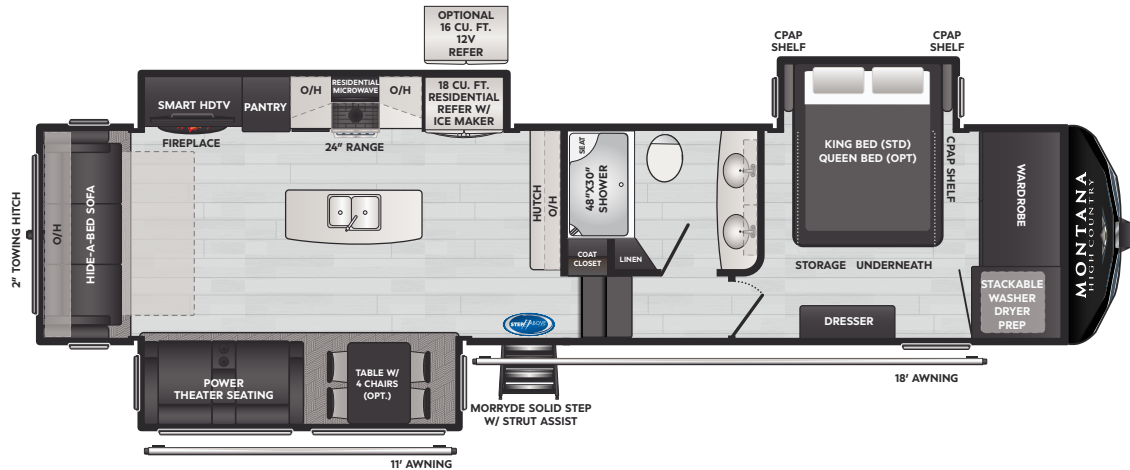

**331RL** | WEIGHT 12077 | LENGTH 37' 4"

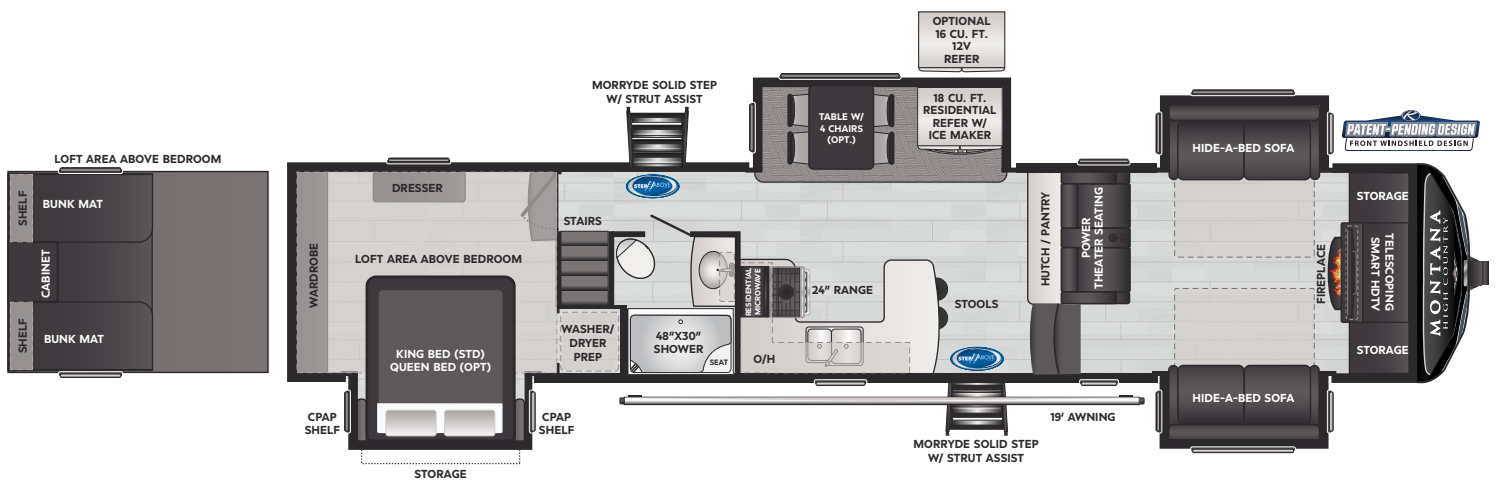
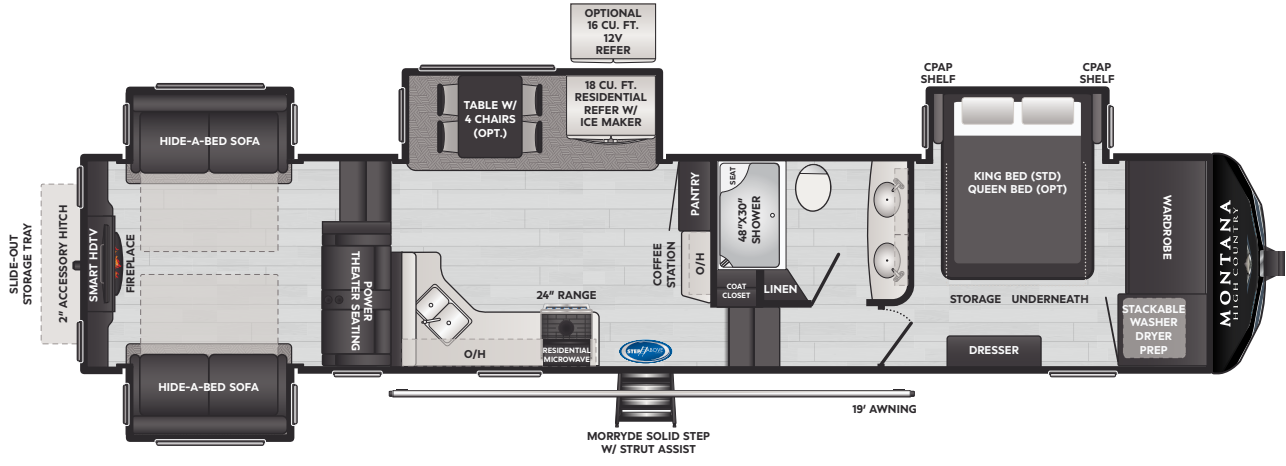
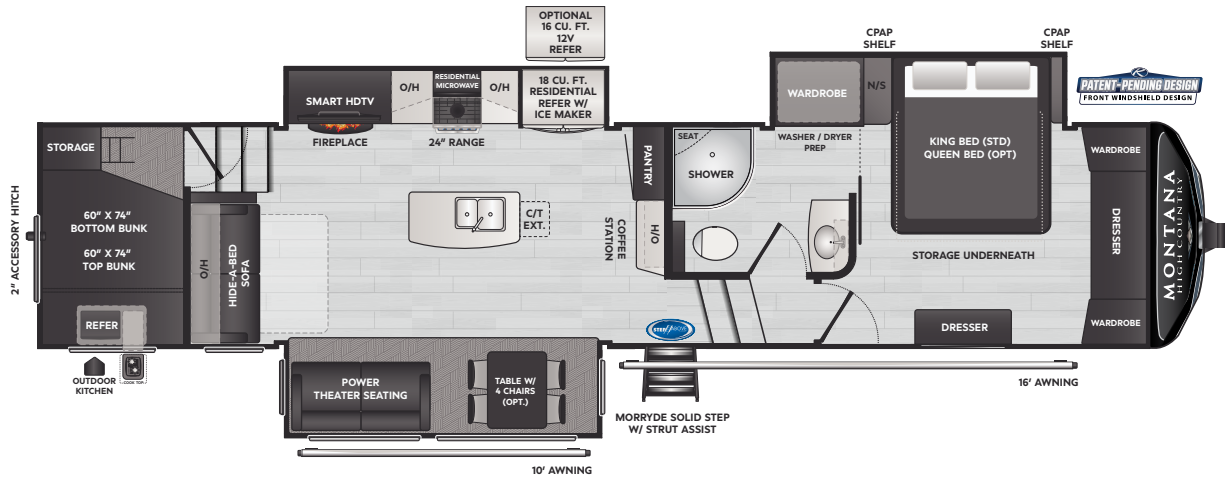



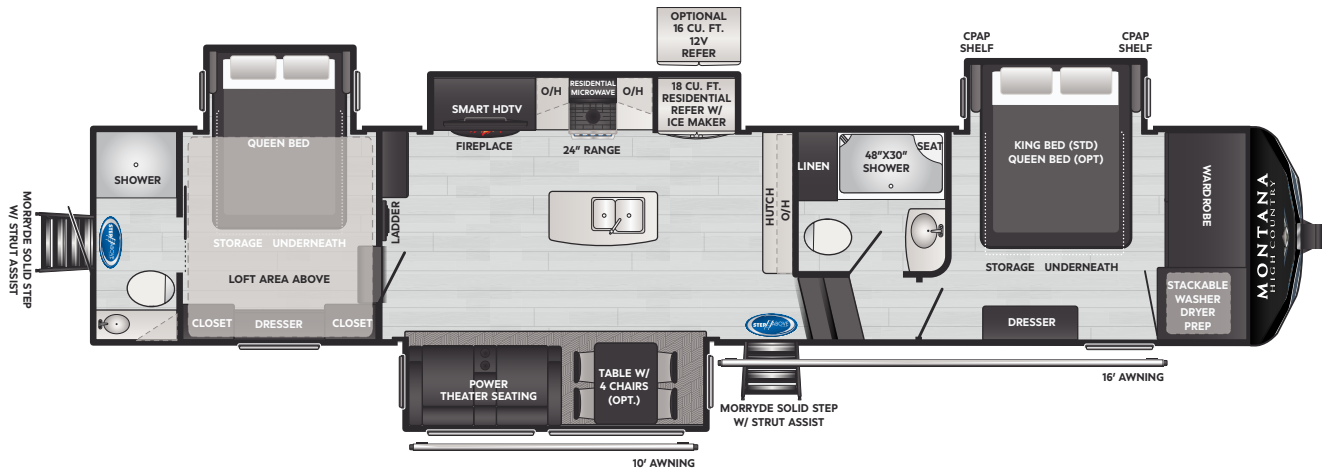

**381TB** | WEIGHT 14364 | LENGTH 42' 5"

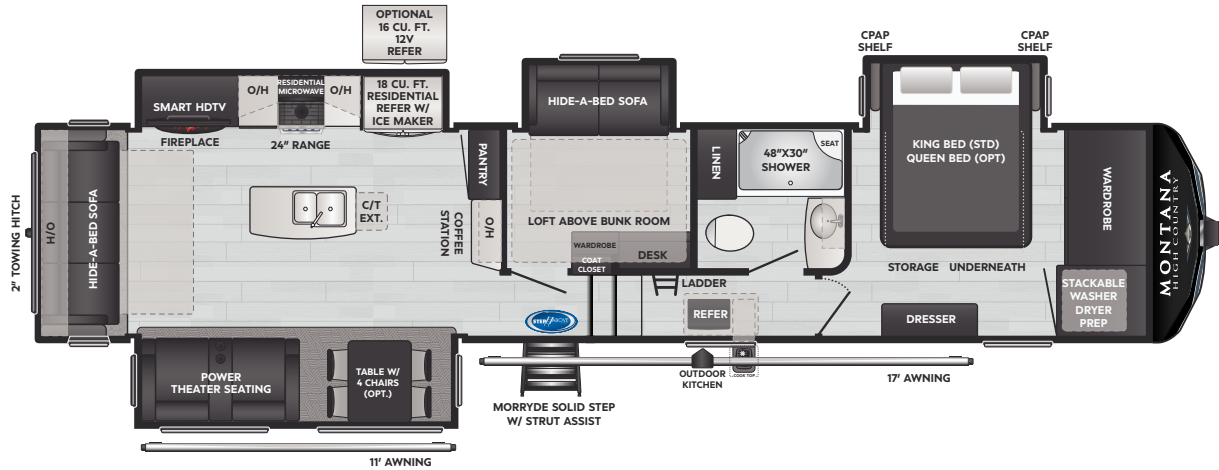

**385BR** | WEIGHT 13794 | LENGTH 40' 9"

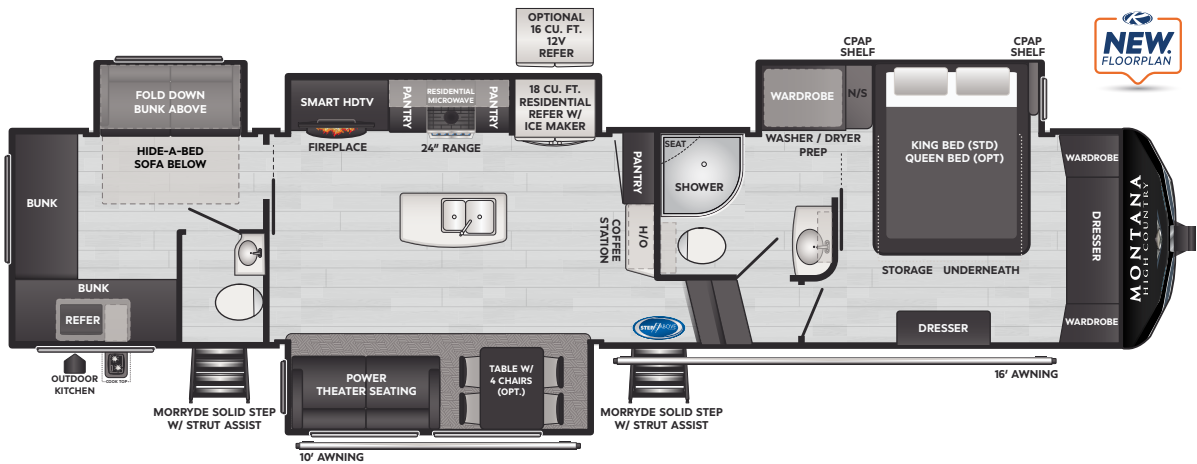

**389BH** | WEIGHT 13500 | LENGTH 40' 5"

## KEYSTONE OWNER'S SUPPORT

Keystone makes operating and maintaining your new RV easy with world-class resources and support. Owners have access to a wide variety of support tools and services via the MyKeystone mobile app and the Owner's section of [KeystoneRV.com](http://KeystoneRV.com).

### FIRST TIME CAMPER'S VIDEO SERIES

A comprehensive guide to RV camping basics with Keystone's Matt & Bart.

### PRO TIPS DIY OPERATION & MAINTENANCE VIDEO LIBRARY

Visit our growing collection of step-by-step video and written guides to operating, maintaining, and repairing your Keystone RV.

### DIGITAL OWNER'S MANUAL

Our new online owner's manual is fully searchable and features helpful visual and video support.

### DIY REPAIR PROGRAM\*

Which includes free parts for small repairs within your first year of ownership

### 1-YEAR LIMITED BASE WARRANTY\*

### 3-YEAR LIMITED STRUCTURAL WARRANTY\*

\*See [KeystoneRV.com](http://KeystoneRV.com) for full details. PRO TIP: Owners should work with their dealers or other Keystone authorized service center or mobile tech to document all warranty claims within the warranty period.

VISIT OUR WEBSITE FOR PHOTOS,  
360° TOURS, AND FULL PRODUCT DETAILS



## MONTANA HIGH COUNTRY SPECIFICATIONS

MODEL	WEIGHT	CARRYING CAPACITY	HITCH WEIGHT	FRESH WATER**	WASTE WATER	GRAY WATER	LPG	LENGTH*	WIDTH	HEIGHT	AWNING
295RL	11697	2603	2400	91	49	88	60	34' 0"	8'	13' 4"	10'/16'
311RD	11716	2554	2270	91	49	88	60	35' 0"	8'	13' 4"	11'/16'
331RL	12077	2133	2210	91	49	88	60	37' 4"	8'	13' 4"	18'/11'
351BH	13278	3377	2655	91	49	88	60	39' 0"	8'	13' 4"	10'/16'
373RD	13399	3381	2780	91	49	88	60	41' 4"	8'	13' 4"	19'
377FL	13513	3107	2620	91	39	78	60	41' 11"	8'	13' 4"	19'
381TB	14364	2341	2705	91	98	137	60	42' 5"	8'	13' 4"	10'/16'
385BR	13794	2891	2685	91	49	88	60	40' 9"	8'	13' 4"	11'/17'
389BH	13500	2500	2535	91	88	88	60	40' 5"	8'	13' 4"	10'/16'





### MONTANA OWNER'S CLUB

Welcome to the Montana Family! As an owner, you have the opportunity to get involved with the Montana Owner's Club, an independently run group built around this legendary brand. Through the MOC forum, you will be privy to insider tips, technical advice, and the incredible fellowship this community offers. Join fellow members at regional and national rallies, including the club's annual camp out near Keystone headquarters in Goshen, Indiana.

TO CHECK OUT MORE AND JOIN THE COMMUNITY,  
GO TO [WWW.MONTANAOWNERS.COM/FORUMS](http://WWW.MONTANAOWNERS.COM/FORUMS)



**RV LIFESTYLE**  
Your Adventure Awaits

RV Lifestyle's Mike & Jennifer Wendland share their vast knowledge of the lifestyle with millions of devoted fans. Find out what they love about their new Montana High Country 311RD.



**WATCH  
HERE**



# SOLAR<sup>TM</sup> FLEX



**NEW** 2024 PACKAGE UPDATES

For more information scan the QR code  
or visit [keystonerv.com](http://keystonerv.com).

## TAKE CHARGE OF HOW YOU CAMP

Colton RV & Marine  
3122 Niagara Falls Blvd.  
North Tonawanda, NY 14120  
(716) 694-0188  
[www.ColtonRV.com](http://www.ColtonRV.com)

Colton RV  
489 Bushkill Plaza LN #9665  
Wind Gap, PA 18091  
(610) 863-5239  
[www.ColtonRV.com](http://www.ColtonRV.com)

**EXCEPTIONAL QUALITY, IMPOSSIBLY VERSATILE, SolarFlex<sup>TM</sup>  
IS SHATTERING CUSTOMER'S EXPECTATIONS OF FACTORY-INSTALLED SOLAR POWER.  
EXCLUSIVELY AVAILABLE ON ALL KEYSTONE RV MODELS.**



Keystone RV is proud to partner with Dragonfly Energy to offer their legendary heated Lithium-ion batteries exclusively on all Keystone models.



**FOLLOW US FOR THE LATEST!**



DISCLAIMER: Product information is as accurate as possible as of the date of publication of this brochure. All features, floor plans, and specifications in this brochure are subject to change without notice. Please also consult Keystone's web site at [www.keystonerv.com](http://www.keystonerv.com) for more current product information and specifications. Tow Vehicle Disclaimer. CAUTION: Owners of Keystone recreational vehicles are solely responsible for the selection and proper use of tow vehicles. All customers should consult with a motor vehicle manufacturer or their dealer concerning the purchase and use of suitable tow vehicles for Keystone products. Keystone disclaims any liability or damages suffered as a result of the selection, operation, use or misuse of a tow vehicle. KEYSTONE'S LIMITED WARRANTY DOES NOT COVER DAMAGE TO THE RECREATIONAL VEHICLE OR THE TOW VEHICLE AS A RESULT OF THE SELECTION, OPERATION, USE OR MISUSE OF THE TOW VEHICLE. \*Length is defined as the distance from the centerline of hitch pin/coupler to rear bumper of trailer. \*\* Fresh water capacity includes water heater. Please review owner's manual prior to purchase for more information on service warranties, extended use, towing and maintenance. Owner's manuals can be found at [keystonerv.com](http://keystonerv.com).

PRINT 10.2023