

# Excursion



## EXPERIENCE THE FREEDOM YOU DESERVE

Engage in the luxurious craftsmanship of the Excursion, bath in the beauty of the contemporary decor and embrace the freedom of the open road. Your Excursion awaits you.





## WHY BUY EXCURSION?

**State-of-the-art Components** The Hide-Away 40" LCD HDTV in the 33A galley provides extra counter top space when it's hidden in the "up" position. The 33A Conver-Table transitions from dinette to coffee table in 3 simple steps and the optional Hide-A-Loft adds a drop-down queen bed to any Excursion Floorplan.

**Lavish Living Space** The wide body interior and 84" ceiling height are designed to maximize your available living space.

**Luxurious Gallery** The spacious galley shows off polished volcanic series solid-surface countertops, residential refrigerator and glass-tile backsplash.

**Low Profile Design** With a lower profile design, the Excursion comfortably fits under a 12 ft. garage door but still maintains the interior height and space you've come to expect.

**Cummins® 300 HP Diesel Engine** The compact Excursion diesel pusher is equipped with 300 HP Cummins ISB 6.7L engine with exhaust brake, providing exceptional performance.



2013 GRAPHICS AND DÉCOR



COCOA PEARL



COPPER JAVA



GOLD STARFIRE



PLATINUM FROST

Both inside and out, there is a wide selection of colors, styles and finishes. From the moment you lay your eyes on an Excursion, the high-style graphics and décor collection welcome you with gracious beauty and contemporary design. We've paid attention to every detail. So wherever you are, you'll feel right at home.

|           |                 |          |        |                 |
|-----------|-----------------|----------|--------|-----------------|
|           | TUSCANY TOFFEE  |          |        |                 |
| BEDSPREAD | SOFA            | ACCENT   |        | CLASSIC CONGNAC |
|           |                 |          |        |                 |
|           |                 |          |        |                 |
|           |                 |          |        |                 |
|           | COUNTERTOP      | FLOORING | CARPET |                 |
|           | MANHATTAN EBONY |          |        |                 |
| BEDSPREAD | SOFA            | ACCENT   |        | PEARL WHITE     |
|           |                 |          |        |                 |
|           |                 |          |        |                 |
|           |                 |          |        |                 |
|           | COUNTERTOP      | FLOORING | CARPET |                 |

# STANDARD FEATURES AND OPTIONS

## STANDARD FEATURES

### INTERIOR THROUGHOUT

- 120V/12V AC/DC Converter
- 34,000 BTU Furnace
- 6 Gallon Quick Recovery Water Heater
- Dual 6V Deep-Cycle House Batteries
- Dual Lo-Pro A/C High Efficiency, Chill Grills & Bedroom Heat Pump
- Energy Management System
- Halogen Lighting
- HDMI Video System
- Centralized Control Monitoring
- Soft-Touch Vinyl Ceiling
- 1200-Watt Inverter (33A)
- 84" Interior Ceiling Height
- PEX Plumbing System
- Crown Molding
- Fabric Lined Storage
- Spacious Wide Body Design
- Day/Night Pleated Shades
- Deluxe Roller Bearing, Full-Extension Drawer Guides & Transit-Ship Locks
- Demand Water Pump w/Filter
- Waterpump Switches in Multiple Locations
- Raised-Panel Hardwood Cabinet Doors & Hardwood Cabinet Drawers
- Wall-to-Wall Vinyl Tile Flooring
- Wall Sconce Lighting
- Wall Switch Convenience
- Water Heater Bypass
- Whole Coach Water Filtration System
- Wood Finish Return Air Intake for Furnace

### DRIVER CONVENIENCE

- Automotive Style Wrap Around Dash
- 3-Point Seatbelts at Driver & Front Passenger Seats (w/Adjustable Shoulder Straps)
- Auxiliary Start Circuit Switch
- Battery Disconnect System
- Cruise Control
- Power Driver/Front Passenger Shade/Sun Visor
- Driver/Front Passenger Soft-Touch Captain's Chairs w/Manual Reclining Back/Slide Controls
- Denso High-Output Auto A/C Heater Combo
- Passenger Cup Holder Console w/Integrated Magazine Rack
- Radio Switch Main/Auxiliary Power
- Air Suspension Dump Switch
- Power & Remote Heated Mirrors
- Driver Console Cup Holders
- Tilt/Telescoping Steering Wheel
- 110-Volt Power Outlet at Dash
- 2 12-Volt Power Outlets at Dash
- Pre-wired for Automatic Generator Start
- Radio with AM, FM, CD and DVD
- Color Back-up Monitor
- Mirror-Mounted Side Cameras
- Intermittent Wiper Control
- Soft-Touch Automotive Dash

### GALLEY

- Stainless Steel Microwave Convection Oven w/Built-in Range Hood & Light

- Adjustable Cabinet Shelves (Select Cabinets)
- Fan-Tastic® Power Roof Vent
- Dometic® 8 cu.ft. 2-Door Refrigerator (33A)
- Residential Refrigerator w/2000 Watt Inverter & 2 additional House Batteries (Standard on 35B/35C)
- Single-Handle Galley Faucet w/Pullout Sprayer
- Hardwood Overhead Face Frames
- Designer Volcanic Series - Polished Solid-Surface Countertop w/Deco Edge
- Solid-Surface Sink & Range Covers
- Full Mosaic Glass Tile Backsplash
- Under-Galley Shelving & Wastebasket
- Window Over Sink
- Hi-Def Laminate Dinette Tabletop
- Cabinet Toe Kicks
- Large, 50/50 Dual Stainless-Steel Sink
- Halogen Task Lighting
- Galley Window w/Mini Blinds
- Pull Out Pantry
- 3-Burner High-Output Cooktop

### LIVING ROOM

- Sony® 40" LCD HDTV Blu-ray® Ready
- Sony® 5.1 Home Theater System w/Built-in AM/FM/DVD & Surround Sound Speakers
- Flexsteel® Soft Touch Residential Style Seating
- TV Antenna w/Signal Booster
- Entry Assist Handle
- Hardwood Overhead Face Frames

### BEDROOM

- Overhead Cabinets
- Designer Reversible Comforter
- Décor Pillows
- Deluxe Pillow-Top Innerspring Mattress
- Day/Night Shades
- Rear Speakers
- Dual 110V Outlets
- Chair Rail Molding
- Dual-Tone Wall Accents
- Full Length Hanging Wardrobe w/Adjustable Shelves
- Under Bed Storage
- Hydro-Lift Bed Top
- Night Stands

### BATHROOM

- A/C Venting
- Fan-Tastic® Power Roof Vent w/Wall Switch
- Glass Shower Enclosure w/Skylight
- Brushed Nickel Single-Handle Faucet
- One Piece Fiberglass Shower w/Convenience Shelf
- Adjustable Shelving
- Stainless Steel Sink
- Brushed Nickel Towel Bars & Rings
- Hardwood Bath Door/Trims
- Porcelain Toilet w/Water Saver
- Halogen Task Lighting

### SAFETY/CONVENIENCE (INTERIOR)

- Carbon Monoxide Detector/Alarm

- Energy Management System (EMS) w/Soft-Start
- Multiple Seatbelt Locations
- Propane Detector/Alarm
- Smoke Detector/Alarm
- Fire Extinguisher
- 30" Wide Entry Door

### EXTERIOR THROUGHOUT

- 120V/12V AC/DC Converter
- Hydraulic 4-Point Automatic Levelers
- 50-Amp Service w/LED Power Cord Indicators
- 6.0 kW Onan® Quiet Diesel Generator
- Awning Rail/Drip Molding
- LED Clearance Lights
- Door-side 110v Patio Receptacle
- Pre-Wired For Easy DSS Antenna Installation
- Single-Pane Tinted Windows w/Screens
- Fiberglass Wheel-Well Trims
- Full-Body Paint w/Color & Graphics
- Power Patio Awning w/Wind Sensor Retract
- Fiberglass Front Cap
- Fiberglass Rear Cap w/High-Mounted Center Brake Light
- Water Pump Switch (located in service compartment)
- Pre-Wired for Exterior Entertainment System (located in Basement)
- Park Cable Receptacle
- Utility Compartment w/Exterior Shower

### AUTOMOTIVE

- Fog Lamps
- Mud Flaps
- Single-Motor Windshield Wipers w/Wet Arm
- Under-hood Utility Light
- Large One-Piece Bonded Windshield
- Heated Power Exterior Mirrors w/Turn Signals
- 22.5" Aluminum Wheels

### SAFETY/CONVENIENCE (EXTERIOR)

- 20' Sewer Hose
- 4-Wheel ABS Brakes
- Automotive Safety Glass
- Daytime Running Lights
- Easy-Sweep Flooring at Entry Step
- Entry Door w/Screen Door & Deadbolt Lock
- Two 6V/Deep-Cycle House Batteries
- Entry Assist Handle
- Power Entry Step
- Toilet Tank San-T-Flush™ System
- Touch Sensor Tank Monitoring System
- Rear, Front and Side Marker Lights (Select LED)
- Porch Light (Door-side)
- Large Egress Window in Bedroom (2 in 33A)

### STORAGE

- Continuous One-Piece Compartment Seals
- Pass-Through Storage
- Large Side Swinging Luggage Doors
- Insulated Aluminum Luggage Doors w/Single Paddle Metal Latches & Corrosion-Resistant Steel Hinges
- Lighted Roto-Molded Polyethylene Luggage Compartments

### BODY STRUCTURE

- Aluminum Interlocking Floor/Wall/Ceiling Framing
- Heated Water & Holding Tank Compartments
- Radius Roof with Ducted A/C
- Basement Storage
- Vacu-Bond® Upper/Lower Floors, Walls & Ceilings

### OPTIONS

#### INTERIOR

- CSA Package (Canadian Specs)\*\*
- Central Vacuum System
- Manual Footrest - Passenger
- Power Passenger Seat w/Power Foot Rest
- Power Driver Seat
- Washer/Dryer Combo
- Hide-A-Loft Drop Down Queen Bed w/Driver & Passenger Curtains
- Driver/Passenger Pedestal Table

#### GALLEY

- Ice Maker for 8 cu. ft. Standard Refrigerator (33A)
- Residential Refrigerator w/2000 Watt Inverter & 2 additional House Batteries (33A)

#### BEDROOM

- Queen Bed with Memory Foam Mattress
- Sony® 32" LCD HDTV

#### EXTERIOR

- Clear Front Protective Mask
- Electrical System w/ Neutral Loss Protection
- Dual Glazed Windows

### FLEETWOOD ADVANTAGES

- Sony® LCD HDTVs
- Sony® 5.1 Home Theatre System w/Surround Sound
- HDMI A/V Components/Cables Throughout Coach
- TV & Home Theater Remote Control Operation Pre-Wired
- Built-In HDMI, Satellite AV Input Jack
- 50-Amp Energy Management System
- 110AC Outlet in Dash Area
- 300HP Cummins® ISB 6.7L Engine
- Vacu-Bond® Walls w/Smooth High-Gloss Exterior Fiberglass
- Large One-Piece Bonded Windshield
- Pass-Through Storage
- Large Side Swinging Luggage Doors
- Deluxe Roller Bearing, Full-Extension Drawer Guides
- 84" Interior Ceiling Height
- Power Bridge® Construction (Fleetwood RV Exclusive)
- 11Ft. 7 In. Exterior Height (Suspension Deflated)

\*\*CSA Standards may require substitution or deletion of features to achieve conformance.

FLOOR PLANS

33A

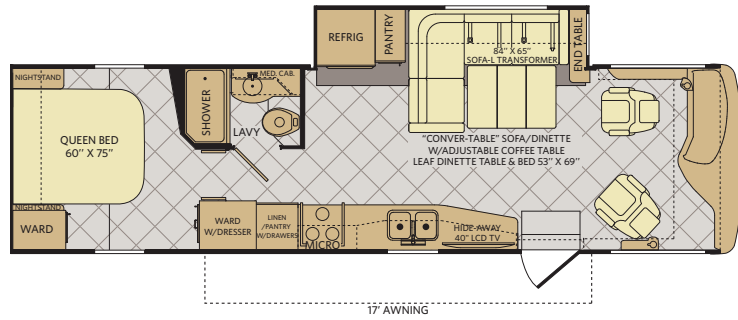

INTERIOR STORAGE CAPACITY: 166 CU. FT.  
EXTERIOR STORAGE CAPACITY: 140 CU. FT.

Available options: 084, 126, 144, 146, 186, 217, 853

35B

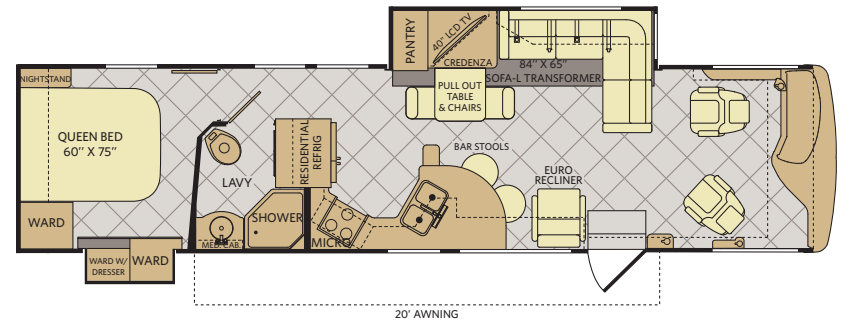

INTERIOR STORAGE CAPACITY: 170 CU. FT.  
EXTERIOR STORAGE CAPACITY: 161 CU. FT.

Available options: 084, 126, 186, 217, 853

35C

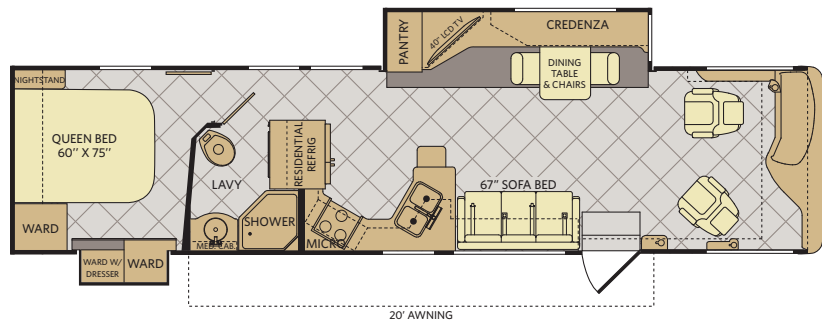

INTERIOR STORAGE CAPACITY: 170 CU. FT.  
EXTERIOR STORAGE CAPACITY: 161 CU. FT.

Available options: 084, 126, 186, 217, 853

FLOOR PLAN OPTIONS

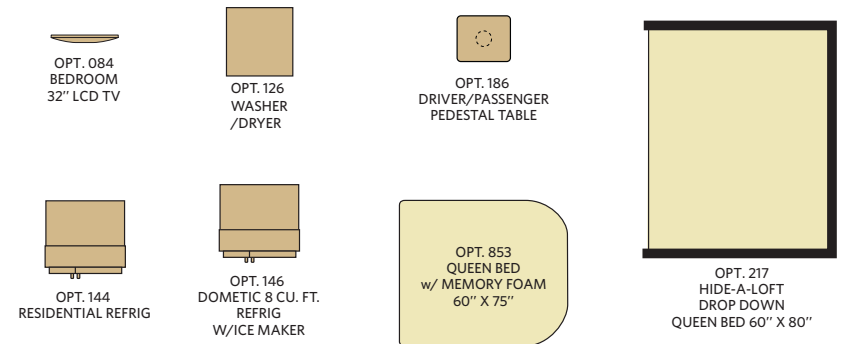

# WEIGHTS & MEASUREMENTS

| CHASSIS                                | POWER BRIDGE® |        |        |
|----------------------------------------|---------------|--------|--------|
|                                        | 33A           | 35B    | 35C    |
| <b>MODELS</b>                          |               |        |        |
| Wheelbase (inches)                     | 208"          | 242"   | 242"   |
| GVWR (lbs) <sup>1</sup>                | 26,000        | 26,000 | 26,000 |
| Front GAWR (lbs) <sup>2</sup>          | 10,500        | 10,500 | 10,500 |
| Rear GAWR (lbs) <sup>2</sup>           | 17,500        | 17,500 | 17,500 |
| GCWR (lbs) <sup>3</sup>                | 30,000        | 30,000 | 30,000 |
| Hitch Rating Weight (lbs) <sup>†</sup> | 10,000        | 10,000 | 10,000 |
| Fuel Capacity (gal)                    | 90            | 90     | 90     |

## POWER BRIDGE® CHASSIS

**Model:** Freightliner® XCS Series  
**Engine:** Cummins® ISB 6.7L w/Exhaust Brake  
**Transmission:** Allison® 2100 MH 6-Speed  
 w/Electronic Shifter

**Alternator:** Delco Remy 160 Amp  
**Torque:** 660 lb-ft @ 1,600 RPM  
**Horsepower:** 300HP

## DIMENSIONS & CAPACITIES

| MODELS                                         | 33A     | 35B     | 35C     |
|------------------------------------------------|---------|---------|---------|
| Overall Length (inches) <sup>4</sup>           | 33' 11" | 36' 9"  | 36' 9"  |
| Overall Height (suspension inflated)           | 11' 10" | 11' 10" | 11' 10" |
| Overall Height (suspension deflated)           | 11' 7"  | 11' 7"  | 11' 7"  |
| Overall Width (maximum) <sup>5,6</sup>         | 102"    | 102"    | 102"    |
| Interior Height (maximum)                      | 84"     | 84"     | 84"     |
| Interior Width (maximum)                       | 96"     | 96"     | 96"     |
| Fresh Water Holding Tank (gal)                 | 88      | 88      | 88      |
| Grey Water Holding Tank (gal)                  | 60      | 60      | 60      |
| Black Water Holding Tank (gal)                 | 32      | 32      | 32      |
| Appliance Propane Tank (gal) (WC) <sup>7</sup> | 28.2    | 28.2    | 28.2    |
| Water Heater Tank (gal)                        | 6       | 6       | 6       |

### Liquid Weight Reference:

Water (gal) = (8.3 lbs/3.8 kgs) Fuel (gal) = (7.1 lbs/3.2 kgs) Propane (gal) = (4.2 lbs/1.9 kgs)

### Metric Conversion:

Multiply pounds x 0.453 to obtain kilograms. Multiply gallons x 3.785 to obtain liters.  
 Multiply liters x 61 to obtain cubic inches.

## ADDENDUMS

- GVWR (Gross Vehicle Weight Rating) is the maximum permissible weight of this fully loaded motor home. The GVWR is equal to or greater than the sum of the (UVW) unloaded vehicle weight plus the (OCCC) occupant cargo-carrying capacity.\*
  - GAWR (Gross Axle Weight Rating) is the maximum permissible loaded weight a specific axle is designed to carry.
  - GCWR (Gross Combined Weight Rating) is the value specified by the motor home manufacturer as the maximum allowable loaded weight of this motor home with its towed vehicle. Towing and braking capacities may be different. Refer to Fleetwood and chassis manufacturer's manuals for complete information.
  - Length measured from front bumper to rear bumper (excludes accessories).
  - Excludes safety equipment and awnings.
  - Motor homes feature a body width over 96" which will restrict your access to certain roads. Before purchasing, you should research any state and/or province road laws which may affect your usage.
  - Tank manufacturer's listed water capacity (WC). Actual propane capacity is 80% of water listing as required by the safety code.
- † The chassis manufacturer recommends the installation of a supplemental brake control system to activate the brakes on the vehicle or trailer you are towing. Hitch receiver ratings expressed are maximum for the hitch receiver installed and may require the purchase of additional equipment that is dependent on the weight of the towed load. Consult with hitch receiver manufacturer for further information.
- †† Minimum Towable Load is the available weight, up to GCWR, when the coach is fully loaded to maximum GVWR. However, if the coach is loaded to something less than maximum GVWR, that extra available weight can be added to your Towable Load. For example, if your coach is loaded to 1000lbs less than maximum GVWR, your Towable Load increases accordingly.
- \* UVW and OCCC are found on the label containing the federal certification tag in each RV.

**IMPORTANT—PLEASE READ:** Product information, photography and illustrations included in this publication were as accurate as possible at the time of printing. For further product information and changes, please visit our website at [www.fleetwoodrv.com](http://www.fleetwoodrv.com) or contact your local Fleetwood RV dealer. Prices, materials, design and specifications are subject to change without notice. All weights, fuel, liquid capacities and dimensions are approximate. Fleetwood RV has designed its recreational vehicles to provide a variety of uses for its customers. Each vehicle features optimal seating, sleeping, storage and fluid capacities. The user is responsible for selecting the proper combination of loads (i.e., occupants, equipment, fluids, cargo, etc.) to ensure that the vehicle's capacities are not exceeded.

## WHY FLEETWOOD RV?



### Quality

There's no cutting corners. Skilled craftsmen build every Fleetwood RV for maximum durability and longevity.



### Trust

More people trust Fleetwood RV. After all, we've spent over 60 years perfecting RVs, earning the loyalty of generations of RVers.



### Passion

We're truly passionate about the RV lifestyle. Fleetwood RV was founded by RV enthusiasts, and that tradition continues today.



### Safety

You've got precious cargo. So we've engineered dozens of innovative safety features into our motor homes to give you more peace of mind.



### Service

Help is nearby with 24/7 emergency Fleetwood RV Trusted Roadside Assistance.\* And when you need an upgrade or repair, you'll find Fleetwood RV dealers all across North America ready to assist you.



### Warranty

Exclusive RV OwnerCare warranty. See your Fleetwood RV dealer for details.

\* All 2013 Fleetwood RV motorhomes include a 1-year emergency Fleetwood RV Trusted Roadside Assistance membership. For complete info, see your Fleetwood RV dealer.

\*\*For complete info, see your Fleetwood RV dealer.

# Excursion

### RV OWNERCARE\*\*

Limited one-year/15,000-mile coach warranty and three-year/45,000-mile structural warranty, whichever occurs first, and it is fully transferable for the first 12 months. RV OWNERCARE is one of the RV industry's most comprehensive programs and includes systems, appliances, components and construction, with no deductible and no service charge. RV OWNERCARE coverage is provided by a company that will be around in the future to service your needs. See your nearest Fleetwood RV dealer for a full explanation of benefits and restrictions.

### CONTACT US

To locate a dealer near you, visit our website at [www.fleetwoodrv.com](http://www.fleetwoodrv.com) or call 1-800-322-8216. We can also be contacted at Fleetwood RV Customer Relations, P.O. Box 1007, Decatur, IN 46733.

### IMPORTANT—PLEASE READ

Product information, photography and illustrations included in this publication were as accurate as possible at the time of printing. For further product information and changes, please visit our website at [www.fleetwoodrv.com](http://www.fleetwoodrv.com) or contact your local Fleetwood RV dealer. Prices, materials, design and specifications are subject to change without notice. All weights, fuel, liquid capacities and dimensions are approximate. Fleetwood RV has designed its recreational vehicles to provide a variety of uses for customers. Each vehicle features optimal seating, sleeping, storage and fluid capacities. The user is responsible for selecting the proper combination of loads (i.e., occupants, equipment, fluids, cargo, etc.) to ensure that the vehicle's capacities are not exceeded.



ALLIED SPECIALTY VEHICLES

FLEETWOOD RV IS AN  
ALLIED SPECIALTY VEHICLE COMPANY.

## FLEETWOOD RV

### YOUR LOCAL FLEETWOOD RV DEALER IS:

Colton RV & Marine  
3122 Niagara Falls Blvd  
North Tonawanda, NY 14120  
(716) 694-0188  
[www.ColtonRV.com](http://www.ColtonRV.com)

Colton RV  
3443 Southwestern Blvd.  
Orchard Park, NY 14127  
(716) 957-3250  
[www.Coltonrv.com](http://www.Coltonrv.com)

©2012. Fleetwood RV, Inc.  
Printed in the USA. Inventory Control Number EXC13B3, 11/12.  
Model Year 2013, Third Edition.