

# WORK HARD, PLAY HARDER

Keystone Fuzion Impact Edition fifth wheel and travel trailer toy haulers offer the same robust construction as the brand's big brother with shorter, more towable models.

## TOUGHER WHEN YOU NEED IT

- Frame-welded 5k interlock tie-down system
- 7,000 lb flipped Dexter® axles w/ electric self-adjusting brakes
- Fully enclosed, 30 gallon fuel pump station w/ touch pad controls
- G-rated tires
- Tighter door, window and slide seals with CNC, precision-routed sidewalls

## TECHNOLOGY THAT TRANSFORMS

- NEW SolarFlex 200, 400i & 600i-L solar power packages
- Equalizer Systems' EQ Smart Level

## UNEXPECTED CONVENIENCES

- NEW on-demand hot water (fifth wheel models only)
- Easy-access, exterior convenience center
- Space saving, swing-out bar stools (select models)

Colton RV & Marine  
3122 Niagara Falls Blvd  
North Tonawanda, NY 14120  
(716) 694-0188  
www.ColtonRV.com

Colton RV & Marine  
3443 Southwestern Blvd.  
Orchard Park, NY 14127  
(716) 957-3250  
www.Coltonrv.com

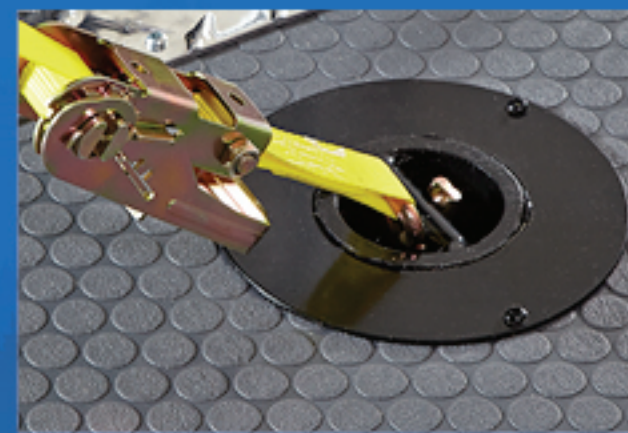

### 5k Interlock Tie Downs

Travel securely with Impact's industry-leading interlock tie downs, rated up to 5,000 lb each.



### CNC Routed Sidewalls

Precision-routed sidewalls ensure the best possible seal around windows, doors and slide boxes.



### Blade™

Designed to accelerate air flow, eliminate leakage and failure points, Keystone's Blade™ high-performance handling system delivers an average of 20% more cooling power.

SCAN HERE TO LEARN MORE



VISIT [KEYSTONERV.COM/IMPACT](http://KEYSTONERV.COM/IMPACT) FOR IN-DEPTH PRODUCT INFORMATION, VIDEOS, MODEL 360'S AND MORE.



PRINT 10.2021

Learn more about the SolarFlex difference and packages now available.

LAUNCHING AS STANDARD EQUIPMENT ON ALL KEYSTONE TRAVEL TRAILERS AND FIFTH WHEELS, FALL 2021

# SOLAR FLEX

# TAKE CHARGE OF HOW YOU CAMP

## The Solar Energy System You've Been Waiting For

Impossibly versatile, exceptionally designed, SolarFlex is shattering customers' expectations of factory-installed solar power. SolarFlex eliminates the guesswork to deliver affordable, high quality solar energy systems.

Impact offers SolarFlex 200 as standard, with the option to upgrade to SolarFlex 400i or SolarFlex 600i-L (N/A TT's).

 **KEYSTONE**  
RV COMPANY | **CAMP BETTER**



# IMPACT

FIFTH WHEEL & TRAVEL TRAILER TOY HAULERS



 **KEYSTONE**  
RV COMPANY | **CAMP BETTER**

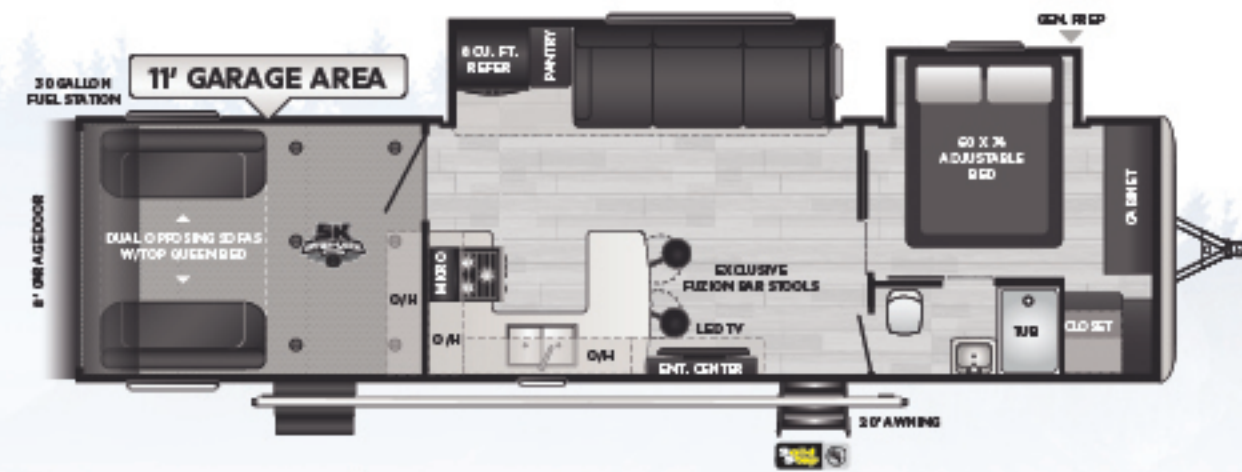

**317** U-shaped kitchen, swing out stools, two slides, 11' garage  
WEIGHT 9700 LENGTH 37' 6"

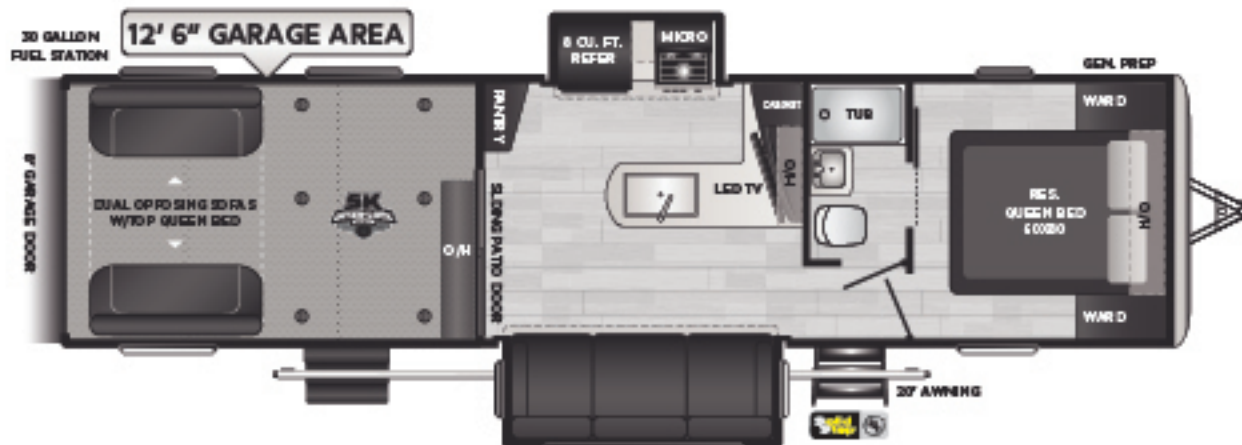

**330** Angled entertainment center, two slides, 12' 6" garage  
WEIGHT 9768 LENGTH 37' 6"

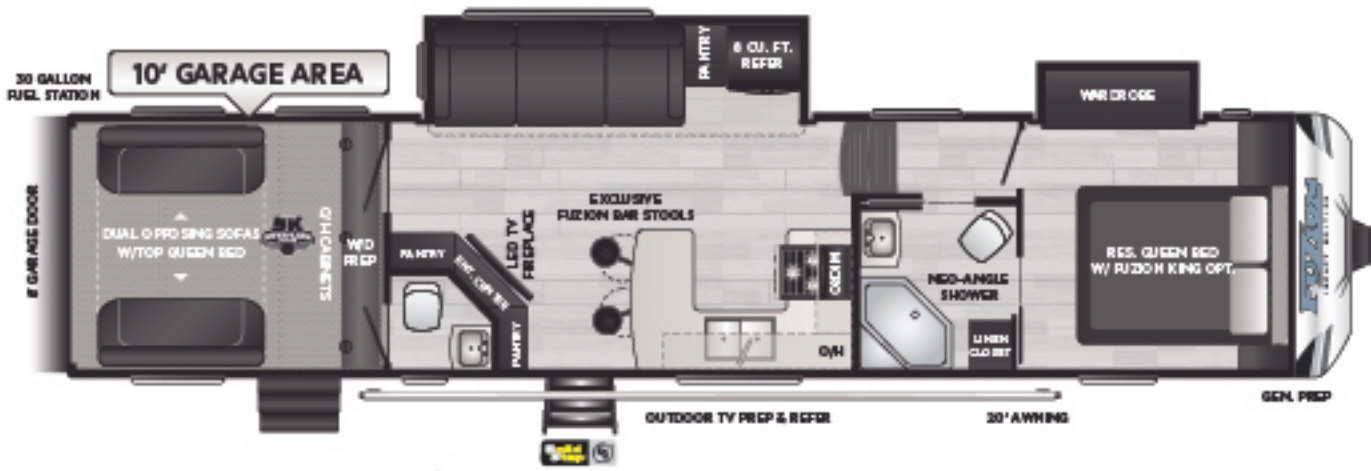

**359** U-shaped kitchen, tandem axle, 1 1/2 baths, 10' garage  
WEIGHT 12715 LENGTH 39' 0"

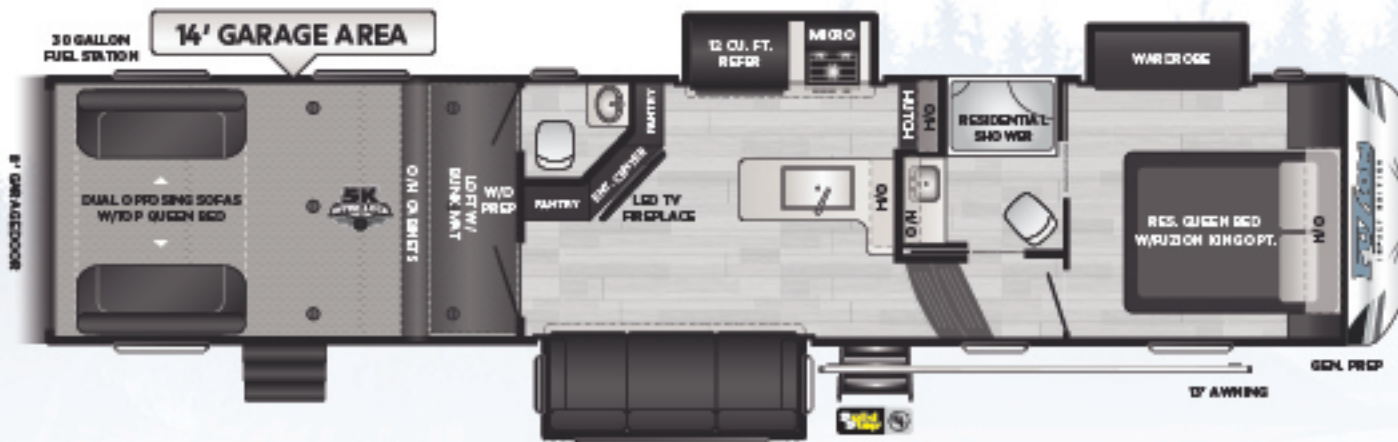

**367** Tandem-axle, 1 1/2 baths, 12 cu.ft. refer, 14' garage  
WEIGHT 13010 LENGTH 40' 2"

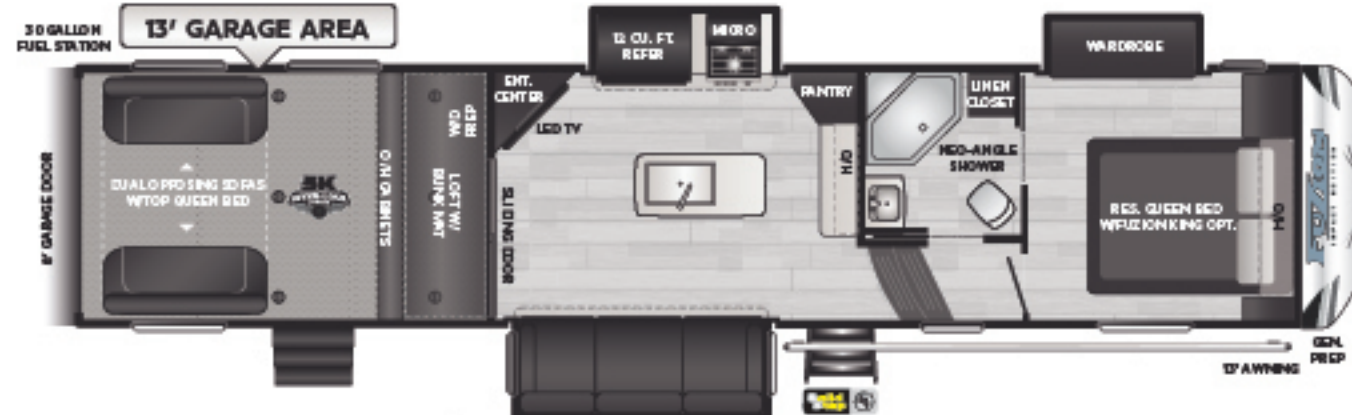

**343** Tandem-axle, kitchen island, three slides, 13' garage  
WEIGHT 12635 LENGTH 39' 0"

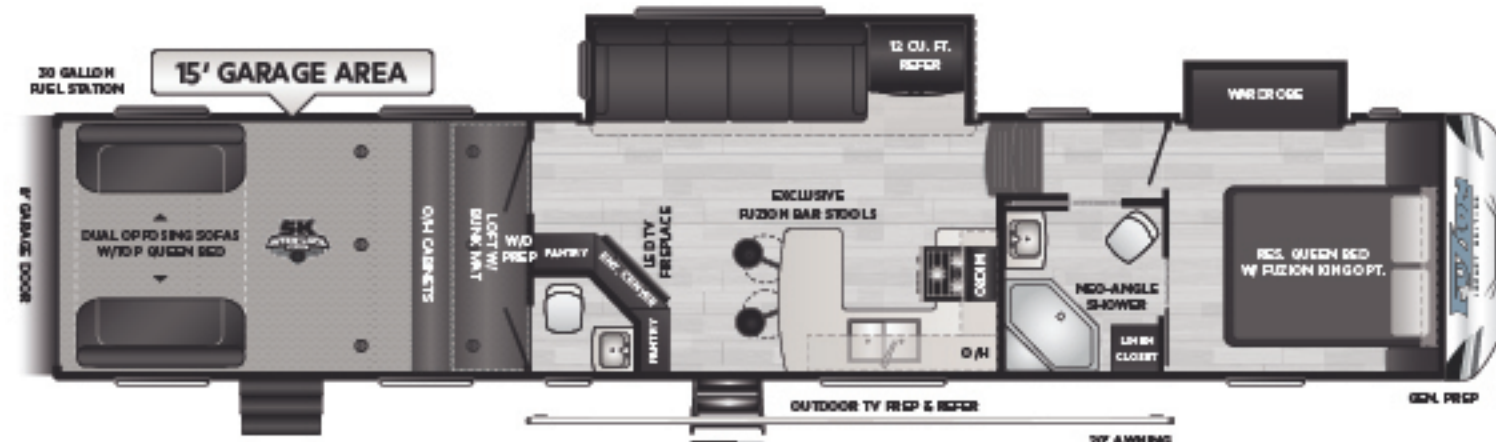

**415** U-shaped kitchen, triple axle, 1 1/2 baths, 15' garage  
WEIGHT 14135 LENGTH 44' 0"

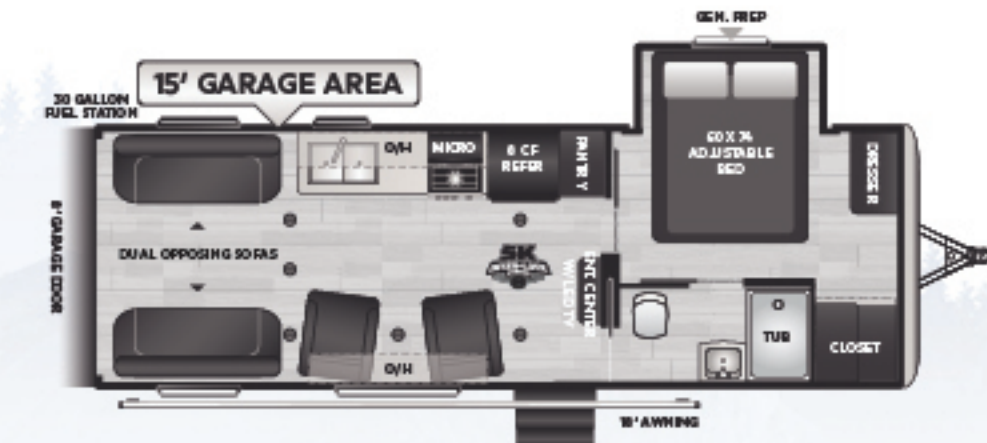

**25V** Lightweight, one slide, 15' garage  
WEIGHT 6965 LENGTH 28' 10"

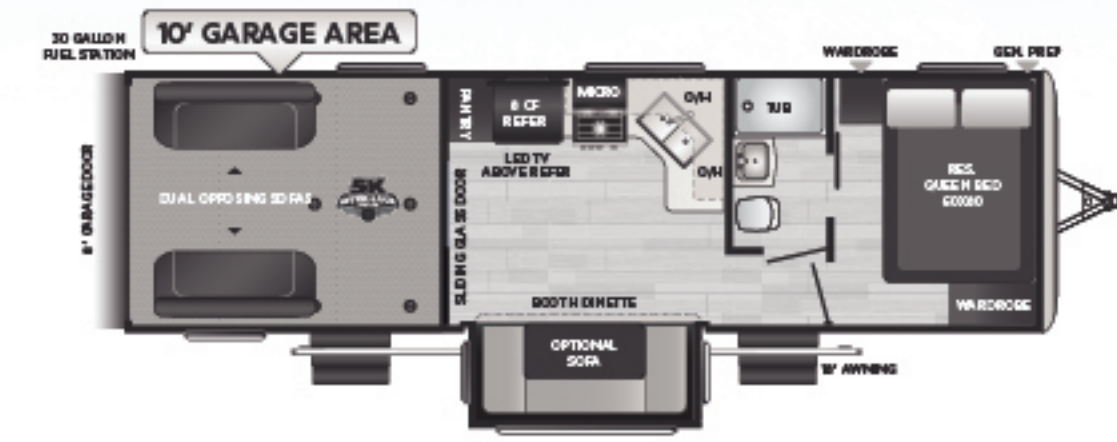

**28V** Lightweight, one slide, 10' garage  
WEIGHT 7440 LENGTH 32' 8"

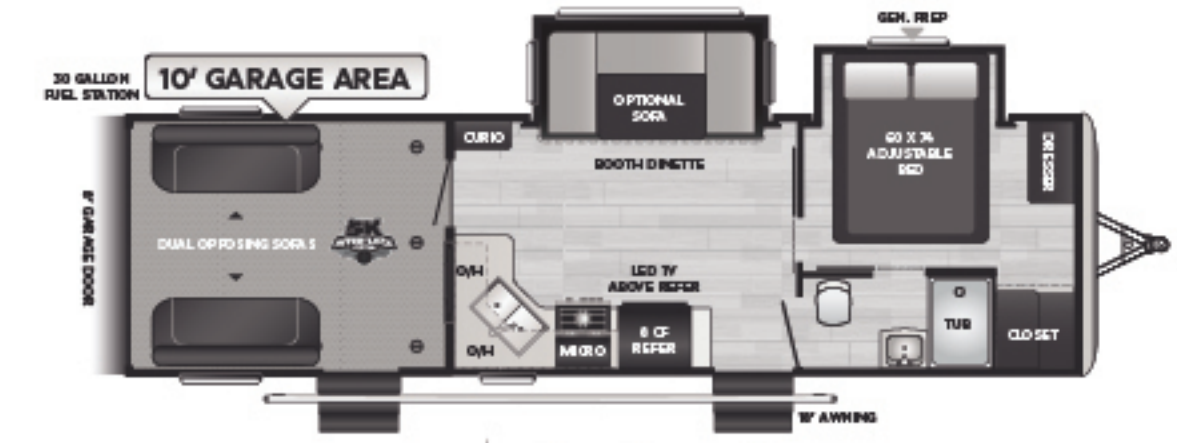

**29V** Lightweight, two slides, 10' garage  
WEIGHT 8013 LENGTH 33' 10"

MODEL	WEIGHT	CARRYING CAPACITY	HITCH WEIGHT	FRESH WATER**	WASTE WATER	GRAY WATER	LPG	LENGTH*	WIDTH	HEIGHT	AWNING
317	9700	3300	1680	100	30	60	60	37' 6"	8' 4"	12' 4"	20'
330	9768	3232	1415	100	30	60	60	37' 6"	8' 4"	12' 4"	20'
359	12715	4165	2880	94	88	88	60	39' 0"	8' 4"	13' 1"	20'
367	13010	3940	2950	94	88	88	60	40' 2"	8' 4"	13' 3"	13'
343	12635	4265	2905	94	44	86	60	39' 0"	8' 4"	13' 1"	13'
415	14135	4865	3155	94	88	88	60	44' 0"	8' 4"	13' 3"	20'
25V	6965	2835	1015	60	30	30	60	28' 10"	8' 4"	12' 2"	18'
28V	7440	2560	1225	60	30	30	60	32' 8"	8' 4"	12' 2"	18'
29V	8013	1987	1225	60	30	60	60	33' 10"	8' 4"	12' 2"	18'

DISCLAIMER: Product information is as accurate as possible as of the date of publication of this brochure. All features, floor plans, and specifications in this brochure are subject to change without notice. Please also consult Keystone's web site at [www.keystonerv.com](http://www.keystonerv.com) for more current product information and specifications. **Tow Vehicle Disclaimer.** CAUTION: Owners of Keystone recreational vehicles are solely responsible for the selection and proper use of tow vehicles. All customers should consult with a motor vehicle manufacturer or their dealer concerning the purchase and use of suitable tow vehicles for Keystone products. Keystone disclaims any liability or damages suffered as a result of the selection, operation, use or misuse of a tow vehicle. KEYSTONE'S LIMITED WARRANTY DOES NOT COVER DAMAGE TO THE RECREATIONAL VEHICLE OR THE TOW VEHICLE AS A RESULT OF THE SELECTION, OPERATION, USE OR MISUSE OF THE TOW VEHICLE. \*Length is defined as the distance from the centerline of hitch pin/coupler to rear bumper of trailer. \*\* Fresh water capacity includes water heater. Please review owner's manual prior to purchase for more information on service warranties, extended use, towing and maintenance. Owner's manuals can be found at [keystonerv.com](http://keystonerv.com).