

PREMIER
ULTRA LITE BY BULLET

PREMIER

www.keystone-premier.com *ULTRA LITE BY BULLET*



THE PREMIER... LUXURY LIGHTWEIGHT
A NEW ERA IN ULTRA LITES

www.keystone-premier.com





PREMIER

ULTRA LITE BY BULLET

Premier by Bullet is the New Gold Standard in Ultra Lite RVs.

With vaulted ceilings almost 7 feet tall, huge frameless picture windows, and comfortable seating in the extra deep slideout rooms, Premier surrounds you with “at home” comfort.

www.keystone-premier.com



31BHPR | KITCHEN



- 1 Deep, full extension cabinet drawers
- 2 Laminated counter top with wrapped edges
- 3 Deep single-basin sink
- 4 Easy-access storage under the sink
- 5 21" conventional oven
- 6 Double-door refrigerator
- 7 Residential pantry with removable shelves
- 8 Full-function microwave oven
- 9 Large, unobstructed overhead cabinet

What's the big thing about Premier?

From floorplan layout to interior and exterior styling, Premier is in a class by itself. Take, for example, Premier's interior features. These include craftsman-style real hardwood cabinetry, Beauflor extra durable cushioned floors, plus an ingenious use of space that makes more efficient use of every square foot of interior area. With Premier, you'll enjoy a luxury RV that's functional, beautiful and can be towed by today's fuel-efficient SUVs and trucks.

What's the big thing about Premier? In a word, **EVERYTHING!**



PREMIER

ULTRA LITE BY BULLET

EXTERIOR FEATURES



Largest Pass-Thru Storage in its class. 40.3 cubic ft. of pass-thru storage for all of your camping gear.



Frameless Tinted Windows allow you to keep the windows open for air flow, even when it's raining.



Electric Awning makes it easy to extend/retract the awning. Awning is also equipped with adjustable arms.



Rolled Roof Edge promotes increased water runoff from crowned roof while also providing another layer of protection where the roof meets the sidewall.



Wide Stance Axles dramatically increases how the unit tows by reducing bouncing and swaying during travel.



Exterior Shower equipped with a fixed shower head and access to both hot and cold water.



1. Power Tongue Jack
2. Quick Access LP Cover
3. Integrated Dual Battery Tray
4. LED Docking Lights
5. Dual Radius Fiberglass Front Cap
6. 5" Radius Galvanized Roof Trusses
7. Hurricane Straps
8. Fully Insulated Roof
9. Durable Roof Decking
10. One Piece EPDM Rubber Roof
11. 13.5 Quick Cool Air Conditioning
12. Full Length Rain Gutter and Spouts
13. Rolled Roof Edge
14. Smooth Fiberglass Exterior

15. 1/8" Luan Wall Backing
16. Hi-Density Block Foam Insulation
17. 1 1/2" Box Welded Aluminum Frame Structure
18. Decorative Interior Wall Board
19. Residential Stain Resistant Linoleum
20. 1st Layer Floor Decking

21. 2nd Layer Floor Decking
22. Hi-Density In Floor Block Foam Insulation
23. Welded Aluminum Floor Joists
24. 3rd Layer Floor Decking
25. Paco/I - Beam Frame
26. Darco Vapor Barrier Wrap



LOOK FOR
PREMIER VIDEOS
ON OUR WEBSITE!



LIGHTWEIGHT SOLID CONSTRUCTION

- 27. Enclosed Underbelly
- 28. Radial Tires with Electric Breaks (4)
- 29. Load Equalization Axle System
- 30. Easy Lube Axles
- 31. Radius Entry Steps
- 32. Frameless Tinted Windows

INTERIOR FEATURES



Laundry Chute provides a convenient place to dispose of dirty clothes until you get home.



9" Deep Single Basin Kitchen Sink allows enough size and depth for washing pots and pans.



Flush Mounted Puck Lighting in the living room offers a more luxurious look compared to traditional RV interior lights



Progressive Interior Lighting located above the queen size bed in the master bedroom.



Max Depth Slideout Room is 36" deep allowing for larger dinette and sofa.



CD/DVD/AM/FM Stereo w/ MP3 Hookup gives you multiple option for entertainment on those rainy days at the campground.



Sofa easily converts into a comfortable **Full Size Air Bed**.



Mullion doors give customers the eye appeal found in high end 5th wheels



29RTPR | Kitchen



29RTPR | Refrigerator and pantry



31BHPR | Outdoor Camp Kitchen



31BHPR | Bunk room shown with Garden View Decor

You'll find a Premier floorplan to fit your lifestyle perfectly.

The kitchen of the 29RTPR & 30RLPR (shown upper left) offers a tremendous amount of countertop space, complimented by a ton of storage, including a residential style pantry. Perfect for a chef.

The Outdoor Camp Kitchen on the 31BHPR (photo directly above) offers refrigerator, cooktop, sink with hot and cold running water, storage and LCD TV. It's a great way to add to your tailgating experience or those lazy days hanging out beneath the patio awning.



Full Body Paint Options

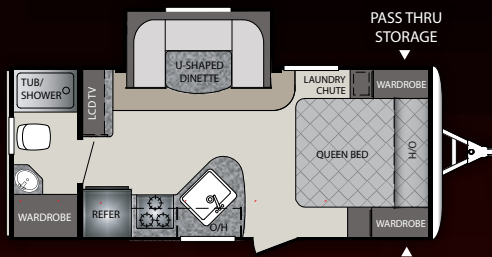

19FBPR

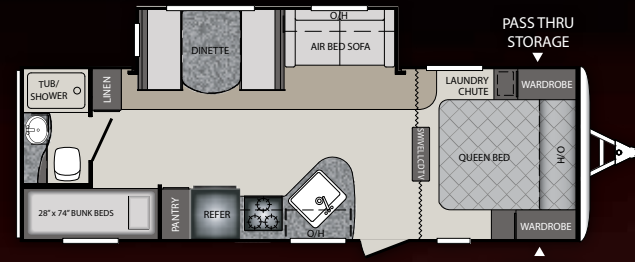

26BHPR



27RBPR



29RTPR

WEIGHTS AND MEASUREMENTS

| TRAVEL TRAILERS | 19FBPR | 26BHPR | 27RBPR | 29RTPR | 30RLPR | 31BHPR |
|-----------------------|---------|---------|---------|---------|---------|---------|
| SHIPPING WEIGHT | 4168 | 5048 | 5364 | 6047 | 5750 | 6305 |
| CARRYING CAPACITY | 2332 | 1852 | 1736 | 1553 | 1850 | 1295 |
| HITCH WEIGHT | 410 | 645 | 655 | 735 | 705 | 780 |
| EXTERIOR LENGTH | 23' 2" | 29' 2" | 30' 6" | 33' 9" | 33' 9" | 35' 4" |
| EXTERIOR WIDTH | 8' | 8' | 8' | 8' | 8' | 8' |
| EXT. HEIGHT - A/C TOP | 10' 11" | 10' 11" | 10' 11" | 10' 11" | 10' 11" | 10' 11" |
| FRESH WATER (GAL.) | 41 | 41 | 41 | 41 | 41 | 41 |
| WASTE WATER (GAL.) | 30 | 30 | 30 | 30 | 30 | 30 |
| GRAY WATER (GAL.) | 30 | 30 | 30 | 30 | 30 | 30 |
| LP CAPACITY (LBS.) | 40 | 40 | 40 | 40 | 40 | 40 |

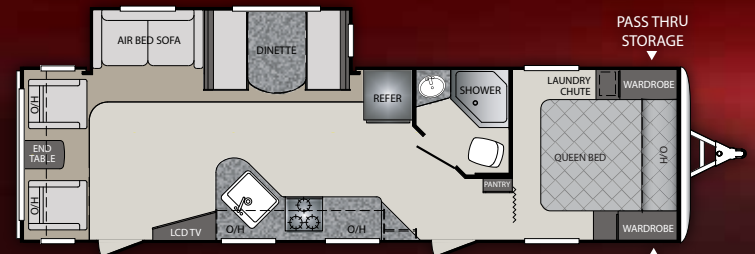

30RLPR

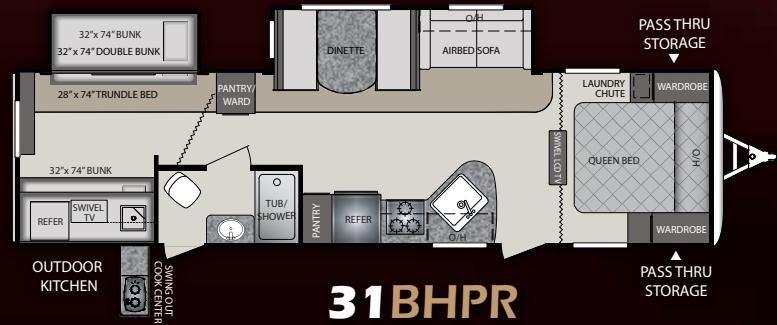

31BHPR



GODIVA
DECORSADDLE
DECORGARDEN VIEW
DECOR**CONSTRUCTION
STANDARDS**

- Aggressive Front Profile for Increased Towability
- Aluminum Framed Front, End and Side Walls
- Laminated Fiberglass Exterior Side Walls
- 2" Thick Laminated Aluminum Floor
- In Frame Fresh, Grey, and Black Water Tanks
- 6" and 8" I-Beam with Full-Length Welded Outrigger
- ¼" ABS Enclosed Underbelly
- Darco Moisture Barrier
- One Piece Seamless Rubber Roof
- E-Z Lube Axles
- Electric Brake System (4 wheels)
- R-11 Insulation in Floor
- R-7 Insulation in Sidewalls
- R-11 Insulation in Roof

**EXTERIOR CAMPING
PACKAGE**

- Wide Stance E-Z Lube Axles
- 6 Gallon Gas/Electric DSI Water Heater
- Radius Entry Door with Gas Strut
- Outside Speakers
- Outside Shower (Hot and Cold Water)
- 4 Stabilizer Jacks
- TV Antenna and Cable Hook-Up
- Electric Awning with Adjustable Arms
- Radial Tires

EXTERIOR FEATURES

- Outdoor Kitchen (27RB, 31BH)
- Aluminum Wheels
- Dual Propane Tanks with Cover
- In Frame Dual Battery Rack
- Oversized Exterior Pass Thru Storage with Lighting
- LP Quick Connect
- Amber Patio Light
- Spare Tire
- Triple Entry Steps

**INTERIOR CAMPING
PACKAGE**

- 13.5 BTU Ducted A/C
- Night Shades
- CD/DVD/AM/FM Stereo with Aux and I-Pod Hookup
- 26" LCD TV
- Microwave
- 6 cu./ft. Double Door Refrigerator
- 3 Burner High Output Range
- 9" Deep Oversized Single Basin Sink with High Rise Faucet
- Chestnut Glazed Hardwood Cabinet Doors
- Foot Flush Toilet
- Tub Surround with Shelves
- Full Extension Drawer Glides
- Air Bed Sofa (select models)

INTERIOR FEATURES

- 6' 11" Vaulted Ceiling
- Beauflor Linoleum
- Swivel Rockers
- Pillow Back Furniture
- Swivel TV with Mirror and Convenience Center
- Night Shades in Living Area
- 17" Oven
- Decorative Wall Border

BATHROOM

- Deluxe Curved Shower Curtain
- Power Vent Fan
- Solid Wood Medicine Cabinet
- Linen Storage

MASTER BEDROOM

- Upgraded Innerspring Mattress
- Mirrored Wardrobes
- Laundry Chute
- Under Bed Storage
- Individual Reading Lights
- Dual 110V Outlets
- Full Blackout Window Treatments

SAFETY EQUIPMENT

- Carbon Monoxide Detector
- Smoke Alarm
- Fire Extinguisher
- Electric Brakes
- Safety Chains
- Frameless Tinted Safety Glass Windows, Egress Windows (Fire Escape)
- GFI Receipts

OPTIONS

- Full Body Paint (Blue or Burgundy)
- RVQ Grill (Mandatory All Models, N/A 27RB & 31BH)
- 15K A/C

THERMAL PACKAGE

- Heated and Enclosed Underbelly
- 2" Pipe off of Furnace to Underbelly
- 30K BTU Furnace and Residential Heat Ducts

**PREMIER
PACKAGE**

- Aerodynamic Fiberglass Front Cap
- Vaulted Ceiling System
- Frameless Tinted Windows
- Power Tongue Jack
- Air Bed Sofa Sleeper
- Max Depth Slides
- Flush Mounted Puck Lighting
- Upgraded Exterior Graphics Package
- Black Tank Flush



Get the free app at
<http://gettag.mobi>
and scan this tag.

YOUR LOCAL DEALER

Colton RV & Marine
3122 Niagara Falls Blvd
North Tonawanda, NY 14120
(716) 694-0188
www.ColtonRV.com

Colton RV & Marine
3443 Southwestern Blvd.
Orchard Park, NY 14127
(716) 957-3250
www.Coltonrv.com

www.keystone-premier.com

PREMIER
ULTRA LITE BY BULLET



www.keystonerv.com

2642 Hackberry Drive | PO Box 2000
Goshen, IN 46527-2000
(574) 535-2100

Product information is as accurate as possible at the date of publication of this brochure. Features, floor plans, and specifications are subject to change without notice. Please also consult Keystone's web site at keystonerv.com for more current product information and specifications. Tow Vehicle Disclaimer. CAUTION: Owners of Keystone recreational vehicles are solely responsible for the selection and proper use of tow vehicles. All customers should consult with a motor vehicle manufacturer or their dealer concerning the purchase and use of suitable tow vehicles for Keystone products. Keystone disclaims any liability or damages suffered as a result of the selection, operation, use or misuse of a tow vehicle. KEYSTONE'S LIMITED WARRANTY DOES NOT COVER DAMAGE TO THE RECREATIONAL VEHICLE OR THE TOW VEHICLE AS A RESULT OF THE SELECTION, OPERATION, USE OR MISUSE OF THE TOW VEHICLE. 1/2012

Member
Go RVing
Life's A Trip
RVIA
RECREATIONAL VEHICLE
INDUSTRY ASSOCIATION