



Dutchmen[®]

Legendary Innovation. Trailblazing Value.

TRAVEL TRAILERS AND EXPANDABLES

AEROLITE

ZERO GRAVITY SERIES



LIKE NO OTHER ULTRA LITE ON EARTH



AEROLITE

ZERO GRAVITY SERIES

**LIKE NO OTHER
ULTRA LITE ON
EARTH**



Set your sights high and reach for the stars. Aerolite, a campground legend, has been setting the bar in ultra lite innovation for more than 20 years. Cutting-edge construction coupled with industry-leading features both inside and out keeps Aerolite years ahead of the competition. There's a reason we call it our Zero Gravity Series.

STUNNING KITCHEN

Solid-wood cabinet doors and drawer fronts add durability and beauty to your storage space. Optional solid-surface countertops with LED backlighting, stainless-steel appliances and sink, as well as a high-rise pull out faucet, provide all the luxuries you could want in your on-the-road kitchen.

AEROLITE 292DBHS



TRI-FOLD SOFA

Whether it's extra sleeping space or just a place to enjoy the show, this optional tri-fold deluxe sofa is both comfortable and convenient.



REMOTE CONTROL

Our new remote control, available on all travel trailers, lets you operate your slide room, front and rear stabilizer jacks, electric awning and patio lights from the palm of your hand.



POWDER ROOM

Enjoy the conveniences of a handy detachable shower head, the durability of the decorative tub surround and the illumination of the extra-large skylight.

LED LIGHTING THROUGHOUT

Upgraded LED lights are brighter, use less energy and help keep your travel trailer cooler than traditional lighting.

SPACIOUS BARRELED CEILING

The curved ceilings in Aerolite provide even greater headroom — 6' 10" to be exact — while maintaining its ultra light weight.

ENTERTAINMENT

All of your entertainment needs are taken care of with an AM/FM/CD/DVD Player with Bluetooth.

UPGRADED LINOLEUM

Aerolite's resilient flooring surface, which comes with a multi-year warranty, features a unique backing resistant to curling and tearing in extreme temperatures.

AEROLITE 298RESL | GRANITE

THE MASTER

All Aerolite travel trailers feature king-sized beds in the master bedroom. You'll find it's the perfect retreat after a long day of exploring.

EXPANDED SPACE

Aerolite Expandable offers floorplans that make the best use of space with multiple fold-down tent beds for ultimate living and sleeping convenience.

AEROLITE 298RESL | GRANITE

AEROLITE 224ES | MARBLE

BUNK BEDS IN UP-POSITION



BUNK BEDS IN DOWN-POSITION

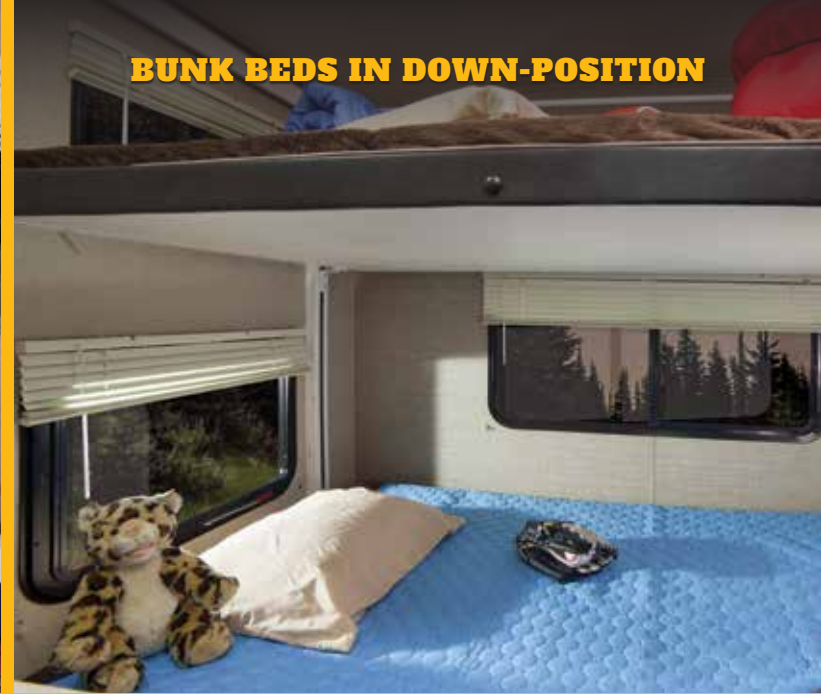

INNOVATION IN SPACE

MULTI-PURPOSE REVOLUTION With a reputation founded on innovation, Aerolite continues to build on this rich heritage. Our unique multi-purpose area serves as a sleeping room with two retractable and height-adjustable bunks, a play space for the kids and the “four-legged” members of the family, or a storage spot with outside access when you’re loading up and heading out.

AEROLITE STANDARDS AND OPTIONS

EXTERIOR PREMIUM PACKAGE

- 13,500-BTU ducted A/C
- Dark-tinted, safety-glass windows
- Double/triple entry step
- Entry assist handle
- E-Z Lube axles
- Exterior shower
- Front and rear stabilizer jacks
- Outside speakers
- Patio and hitch lights
- Propane-gas quick disconnect
- Spare tire and carrier
- Stabilitrack suspension system
- TV antenna

INTERIOR PREMIUM PACKAGE

- 3-burner range top with oven
- 6 cu. ft. double-door refrigerator
- 6-gal. gas/electric DSI water heater
- 12V bath exhaust fan
- Bath skylight

- Bedroom TV hookup
- Black refrigerator insert
- Cable/satellite TV hookup with booster
- Centralized utility panel
- Flip sofa
- Microwave
- Night shades throughout living area
- Range hood with 12V fan/light
- Skylight with shade in kitchen/living room (n/a 174,204,24)
- Swivel rockers (281, 294, 298)

MANDATORY OPTIONS

- Aerolite Package
- Aerolite Premium Package
- Emerald Package (n/a 174,204,224)
- 21st Platinum Package
- Heated and enclosed underbelly
- Radial tires
- Tri-fold deluxe sofa in place of flip sofa (272, 282,282,

- 292, 298, 315 only)
- Aero Tech package (n/a 174, 204, 224)

EXTERIOR OPTIONS

- 15,000-BTU A/C (in place of 13,500-BTU)
- 13,500-BTU non ducted bedroom A/C (front) (272,281,282, 294,298,319) (Req. 2nd A/C prep with 50-amp service)
- 13,500-BTU non-ducted bedroom A/C (rear) (292, 315) (Req. 2nd A/C prep with 50-amp service)
- Power tongue jack (n/a 174, 204, 224)

INTERIOR OPTIONS

- Free Standing Dinette & Chairs (272,281,294, Required on 298)
- Solid Surface Countertops (n/a 174, 204, 224)
- 32" LED Flat Screen TV (n/a 174, 204, 224, 298)
- 39" LED Flat Screen TV (298 required)
- 2nd A/C Prep w/ 50 Amp service (272 and larger/Req. on 298, 319)

AEROLITE PACKAGE (MANDATORY)

- Aluminum wheels
- Black tank flush (n/a 174, 204, 224)
- Champagne gel-coat exterior
- Crowned interior roof (n/a 174, 204, 224)
- King bed (n/a 174, 204, 224)

EMERALD PACKAGE (MANDATORY)

- 30-lb. propane-gas bottles
- Battery disconnect
- Bluetooth stereo
- Painted fiberglass front cap with LED lights
- Porcelain toilet
- Power awning with LED lights

AERO TECH PACKAGE

- 5-Function Remote system
- Electric Stabilizer Jacks
- Solar Prep
- Back Up Camera Prep

CODES & SEALS

- CSA construction and seal
- State seal
- Winterization (mandatory Oct.-April)

21st PLATINUM PLUS PACKAGE

- EXTERIOR:**
- Slam latch baggage door (where applicable)
- Two-tone colored gel coat fiberglass sidewalls
- Two-tone gel coat and painted fiberglass front cap (on all TTs)
- INTERIOR:**
- LED lighting throughout
- High-spout, pull-out kitchen faucet
- Stainless-steel appliances

DISCLAIMER: Product information is as accurate as possible, as of the date of brochure publication. All features, floorplans and specifications in this brochure are subject to change without notice. Please consult Dutchmen’s website at www.Dutchmen.com for current product information and specifications. Tow Vehicle Disclaimer. **CAUTION:** Owners of Dutchmen recreational vehicles are solely responsible for the selection and proper use of tow vehicles. All customers should consult with a motor vehicle manufacturer or their dealer concerning the purchase and use of suitable tow vehicles for Dutchmen products. Dutchmen disclaims any liability or damages suffered as a result of the selection, operation, use or misuse of a tow vehicle. **DUTCHMEN’S LIMITED WARRANTY DOES NOT COVER DAMAGE TO THE RECREATIONAL VEHICLE OR THE TOW VEHICLE AS A RESULT OF THE SELECTION, OPERATION, USE OR MISUSE OF THE TOW VEHICLE. REFERENCE DUTCHMEN MANUFACTURING OWNERS MANUAL FOR LIMITED WARRANTY DETAILS.**

SET YOUR SIGHTS ON THESE HIGH-END FEATURES

Smart design and upgraded amenities make the Aerolite a travel trailer favorite



POWER AWNING WITH LED LIGHT STRIP

Seek shelter from rain or sun at the touch of a button with Aerolite's electric awning, and enjoy nights outside with the attached ultra-bright LED light strip.



PAINTED LED-LIT FRONT CAP

Aerolite features a front cap that combines style and function thanks to LED lighting, dual 30-lb. propane tanks, complete with cover, and an optional power tongue jack.



BATTERY DISCONNECT

Until your next journey, conserve your Aerolite's 12-volt battery life with this convenient single-point, shut-off switch.



ENCLOSED & HEATED UNDERBELLY

Aerolite's enclosed and heated underbelly prevents water tanks from freezing and protects the tanks and floor from road damage.

NEW AERO TECH PACKAGE

- 5-Function Remote
- Electric Stabilizer Jacks
- Solar Prep Ready
- Back-up Camera Ready

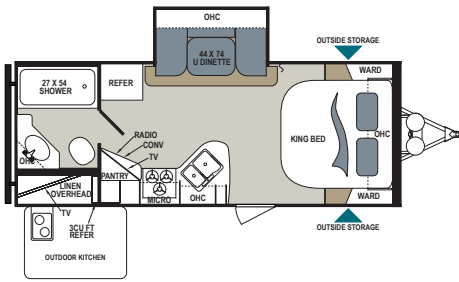

AEROLITE | 213RBSL

Ext. Length: 25' 8" Ext. Height: 11' 1" Average Shipping Weight: 4,973 Sleeps up to: 4

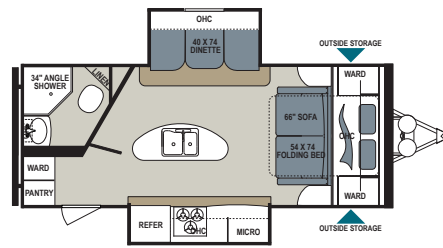

AEROLITE | 218RBSL

Ext. Length: 25' 2" Ext. Height: 10' 10" Average Shipping Weight: 5,204 Sleeps up to: 4

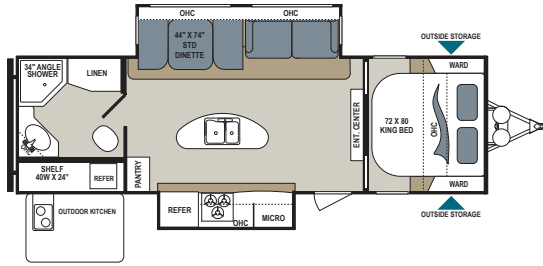

AEROLITE | 272RBSS

Ext. Length: 31' 6" Ext. Height: 11' 1" Average Shipping Weight: 6,600 Sleeps up to: 6

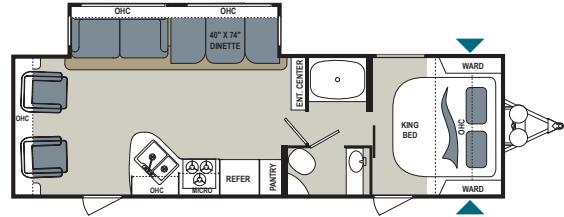

AEROLITE | 281RLSS

Ext. Length: 32' 2" Ext. Height: 11' 2" Average Shipping Weight: 6,246 Sleeps up to: 6

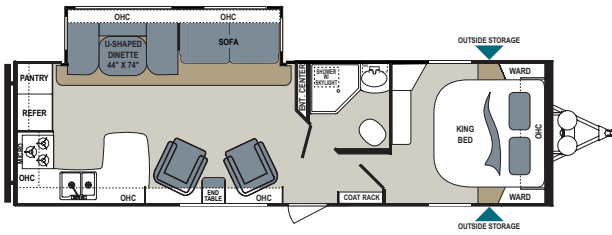

AEROLITE | 294RKSS

Ext. Length: 34' 2" Ext. Height: 11' Average Shipping Weight: 6,426 Sleeps up to: 6

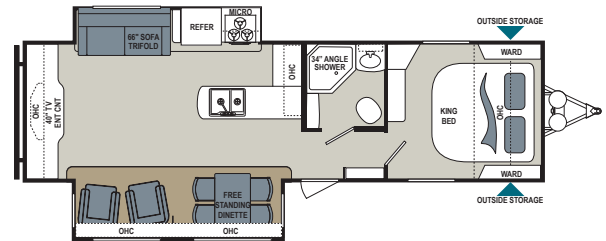

AEROLITE | 298RESL

Ext. Length: 33' 11" Ext. Height: 11' 2" Average Shipping Weight: 7,204 Sleeps up to: 4

AEROLITE SPECIFICATIONS

MODEL	DIMENSIONS	WEIGHTS (LBS.)		TANKS (GALS.)						
MODEL	FLOORPLAN	*EXTERIOR TRAVEL LENGTH	EXTERIOR WIDTH	EXTERIOR HEIGHT (WITH A/C)	**AVERAGE SHIPPING WEIGHT	DRY HITCH WEIGHT	CARGO CARRYING CAPACITY	***FRESH WATER CAPACITY	GREY WATER CAPACITY	BLACK WATER CAPACITY
Travel Trailer	213RBSL	25' 8"	96"	11' 1"	4,973	547	1,627	52	39	28
	218RBSL	25' 2"	96"	10' 10"	5,204	520	2,396	52	39	28
	221BHSL	26' 7"	96"	10' 10"	5,230	764	1,452	52	39	28
	242BHSL	28' 6"	96"	11' 1"	5,510	720	1,090	52	39	28
	272RBSS	31' 6"	96"	11' 1"	6,600	890	3,080	52	67	28
	281RLSS	32' 2"	96"	11' 2"	6,246	810	3,080	52	67	28
	282DBHS	33'	96"	11' 1"	6,210	869	1,390	52	39	28
	292DBHS	34' 0"	96"	11' 1"	6,452	888	1,461	52	39	28
	294RKSS	34' 2"	96"	11'	6,426	764	1,174	52	78	28
	298RESL	33' 11"	96"	11' 2"	7,204	790	1,140	52	39	28
	315BHSS	34'	96"	11'	6,460	840	1,140	52	39	28
	319BHSS	37' 7"	96"	11' 5"	8,339	1,168	1,341	52	84	56
Expandable	174E	18' 6"	96"	10'	3,191	287	659	52	39	28
	204ES	24' 6"	96"	10' 1"	4,281	567	2,319	52	39	28
	224ES	25' 11"	96"	9' 11"	4,536	608	2,064	52	39	28

*Length is defined as the distance from the centerline of hitch pin/coupler to rear bumper of trailer. **Our weights represent how most units are built, inclusive of many commonly-ordered options. ***Fresh water capacity includes water heater capacity.

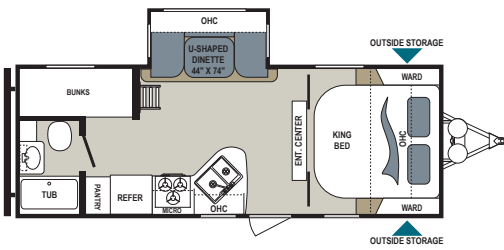

AEROLITE | 221BHSL

Ext. Length: 26' 7" Ext. Height: 10' 10" Average Shipping Weight: 5,230 Sleeps up to: 6

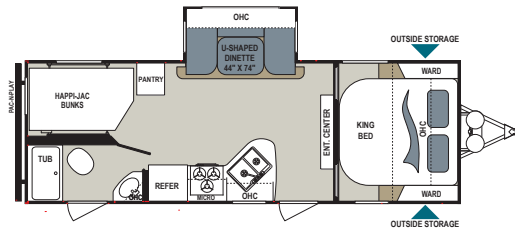

AEROLITE | 242BHSL

Ext. Length: 28' 6" Ext. Height: 11' 1" Average Shipping Weight: 5,510 Sleeps up to: 10

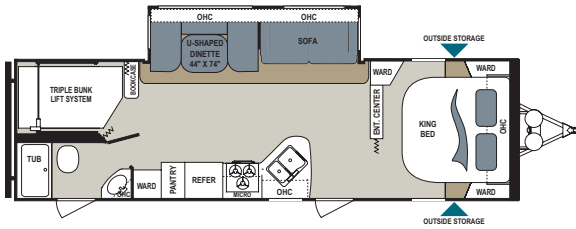

AEROLITE | 282DBHS

Ext. Length: 33' Ext. Height: 11' 1" Average Shipping Weight: 6,210 Sleeps up to: 12

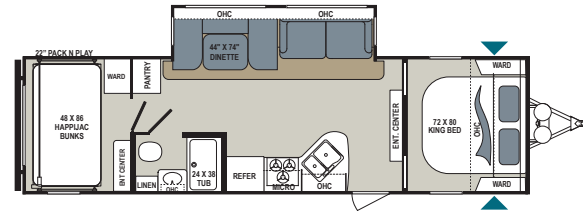

AEROLITE | 292DBHS

Ext. Length: 34' 0" Ext. Height: 11' 1" Average Shipping Weight: 6,452 Sleeps up to: 10

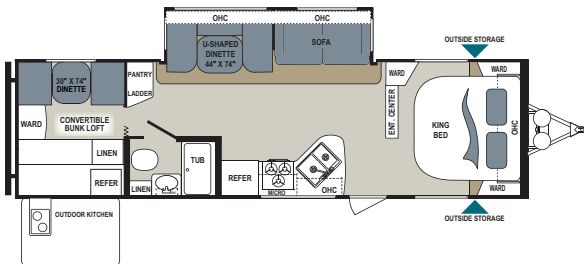

AEROLITE | 315BHSS

Ext. Length: 34' Ext. Height: 11' Average Shipping Weight: 6,460 Sleeps up to: 10

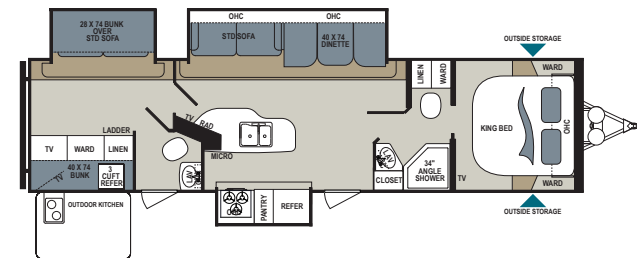

AEROLITE | 319BHSS

Ext. Length: 37' 7" Ext. Height: 11' 5" Average Shipping Weight: 8,339 Sleeps up to: 9

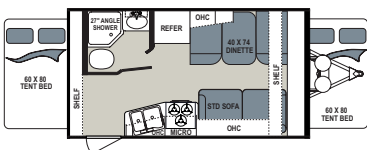

AEROLITE EXPANDABLE | 174E

Ext. Length: 18' 6" Ext. Height: 10' Average Shipping Weight: 3,191 Sleeps up to: 8

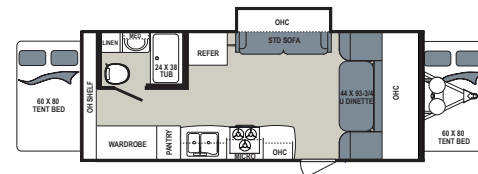

AEROLITE EXPANDABLE | 204ES

Ext. Length: 24' 6" Ext. Height: 10' 1" Average Shipping Weight: 4,281 Sleeps up to: 8

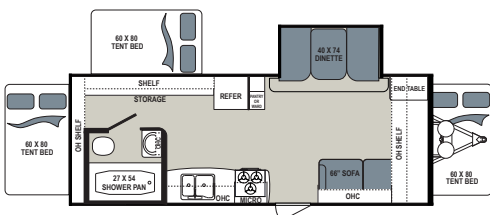

AEROLITE EXPANDABLE | 224ES

Ext. Length: 25' 11" Ext. Height: 9' 11" Average Shipping Weight: 4,536 Sleeps up to: 10

AEROLITE DÉCOR

ONYX



GRANITE



MARBLE

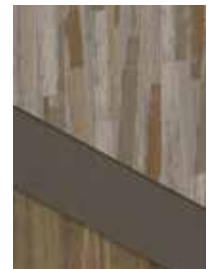

LIKE NO OTHER ULTRA LITE ON EARTH



Dutchmen—A North American Campground Classic

Few manufacturers have built RVs for 25+ years, and only one has set the standard for innovation AND value. Dutchmen **IS** “A North American Campground Classic.”



Dutchmen®

Legendary Innovation. Trailblazing Value.

MORE STANDARD FEATURES MORE VALUE

Dutchmen RVs turn more heads on the lot and in the campground than any other. Why? While other manufacturers offer features as options, Dutchmen tends to make those same features standard. Call it “bang for the buck,” “more for your money,” or simply “more value.” **We’ve built a reputation for bringing RV owners more standard features for less money** for more than 25 years . . . and it’s a reputation we plan to keep.

300 STRONG

NATION WIDE DEALER NETWORK

More than 300 Dutchmen dealers across North America and our industry-leading service center in Goshen, Indiana, combine for your peace of mind before, during and after the sale. Rest assured no matter where your travels take you, **the best-resourced RV manufacturing company in the world is behind you all the way.**

PO BOX 2000 • 2164 Caragana Court
Goshen, Indiana 46527 Sales: 574.537.0600
www.dutchmen.com

At Dutchmen, quality is our standard. **Every single Dutchmen RV that comes off the line receives its own pre-delivery inspection.** Typically, a competitor performs random inspections, meaning you won’t find this commitment to quality anywhere else.



Scan this QR Code for a **360° view** of the Aerolite interior.



www.dutchmen.com

Visit us online to see all of the Dutchmen brands, innovative models and spacious floorplans.

Your local dealer

Colton RV & Marine
3122 Niagara Falls Blvd
North Tonawanda, NY 14120
(716) 694-0188
www.ColtonRV.com

Colton RV & Marine
3443 Southwestern Blvd.
Orchard Park, NY 14127
(716) 957-3250
www.Coltonrv.com

From giving advice to servicing products, we consider our loyal dealers the best resource for learning about Dutchmen products.

AERO-HM0216-30K