



**THE FIRST NAME IN CAMPING.
THE TRUSTED NAME IN RVs.**





The Outdoor Company®



THE FIRST NAME IN CAMPING

For more than 100 years, millions of people have trusted the Coleman name to help them thrive in the great outdoors. These all-new Coleman RVs deliver on that same reputation, packing more camping conveniences into one value-packed product! With multiple floorplans to choose from and a number of residential-style features throughout, the campground awaits you and your Coleman RV.





GREAT INDOORS

With an expansive interior height of 82 inches, Coleman RVs offer taller sliderooms, roomier cabinets and larger windows for an even better camping experience. Combine that with hardwood cabinet doors, a 60-gal. fresh water capacity and a 6-gal. gas DSI water heater, and you're certain to feel at home wherever your travels take you.



SWEET DREAMS

The comfortable master bedroom features handy nightstands, mirrored cabinets, a bonus storage shelf and a queen-sized mattress.



ROOM TO RELAX

Coleman's oversized slideout creates a roomy living area with plenty of seating and sleeping space for family and guests.

NORTH AMERICA'S **TRUSTED** NAME IN RVs



OUTDOOR KITCHEN

Select models feature an exterior kitchen, perfect for Coleman outdoor enthusiasts.



LED AWNING AND OUTDOOR SPEAKERS

Enjoy more outside your RV with the LED power awning and outdoor speakers.



INTERIOR POWER COMMAND CENTER

Control your lights, sliderooms, power awning and more all from one smart location.

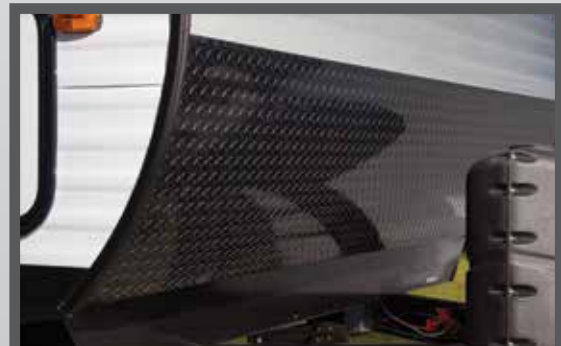

BLACK DIAMOND PLATE ROCK GUARD

The black diamond-plate rock guard protects your RV from the rigors of the road.

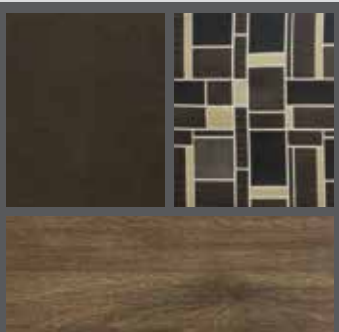

MACKINAC DECOR

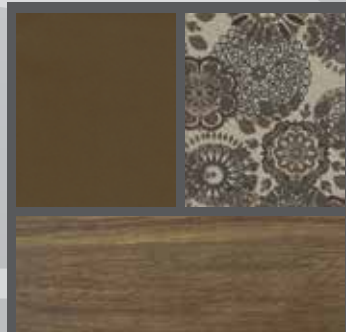

SHORELINE DECOR





Lantern LT 17FQ

LANTERN LT

Whether you're a couple wanting to enjoy the great outdoors or a young family looking to create your own camping traditions, Lantern LT is a series that will appeal to you. With the wide array of features and upgraded interior amenities, you are sure to see why Coleman is one of the fastest-growing brands in the market.



LANTERN

Coleman's Lantern Series features spacious floorplans and one of the longest lists of amenities in its class. Combining old-world craftsmanship with over-the-top conveniences, like a power awning with LED lights, standard front and rear jacks and a solid-state converter with built-in battery charger, your family will love everything the Coleman Lantern offers to help you get away from it all.





The Outdoor Company®



THE FIRST NAME IN **CAMPING**

Every day is an adventure with Coleman, especially when you ramp up the fun with an outing in the Lantern SUT. Part toy hauler, part travel trailer, this model packs garage space for the toys, a HappiJac power bed for the guests and a private bedroom for the two leaders in the pack. Plus, the flush-floor cargo area doesn't sacrifice space to bulky wheel wells. Coleman, we believe in practical design.



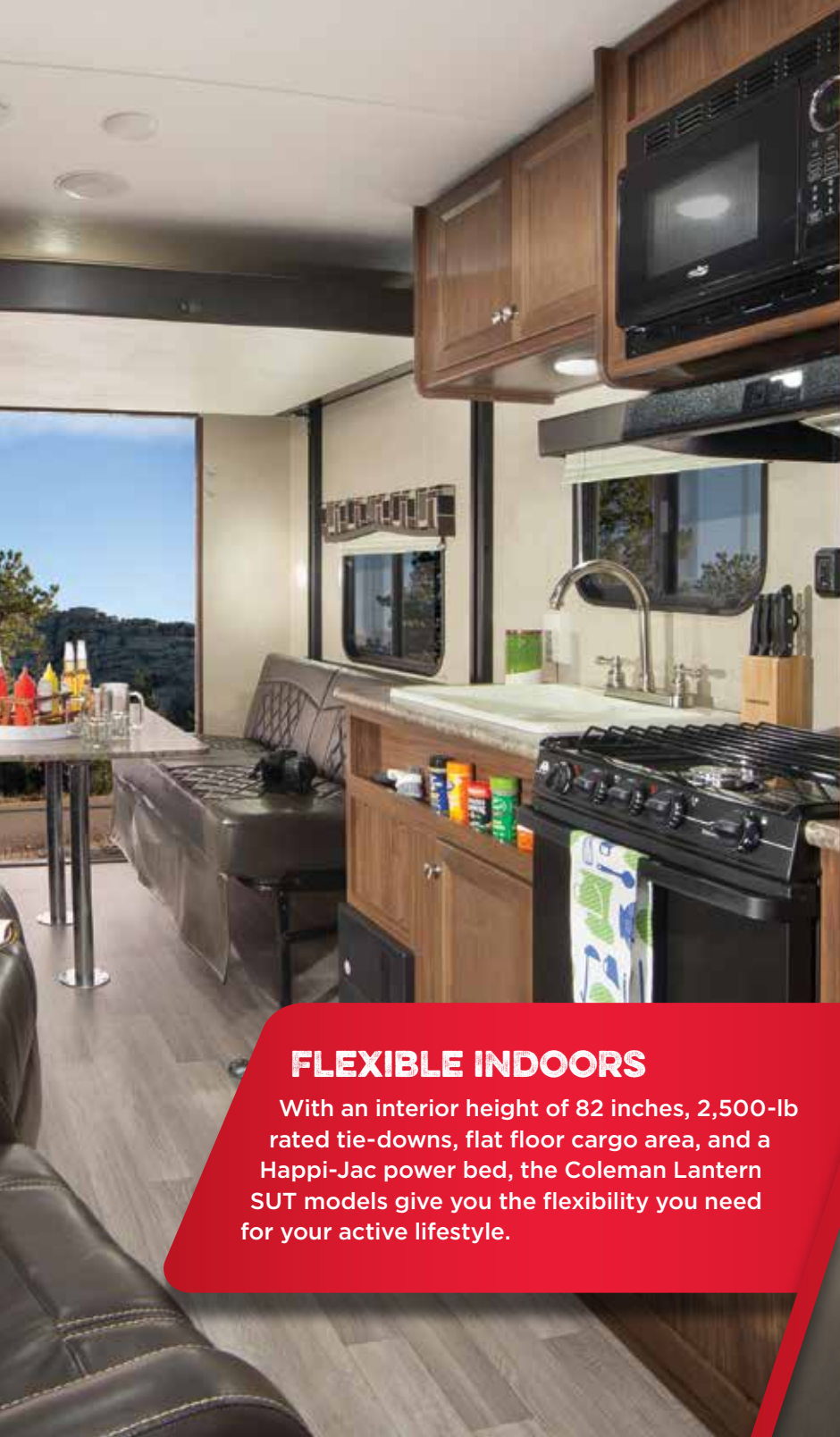

FLEXIBLE INDOORS

With an interior height of 82 inches, 2,500-lb rated tie-downs, flat floor cargo area, and a Happi-Jac power bed, the Coleman Lantern SUT models give you the flexibility you need for your active lifestyle.



BUNKS UP

Take your gear and your toys with you.



BUNKS DOWN

Convert the cargo area into a plush bedroom.

THE FIRST NAME IN CAMPING. THE TRUSTED NAME IN RVS.

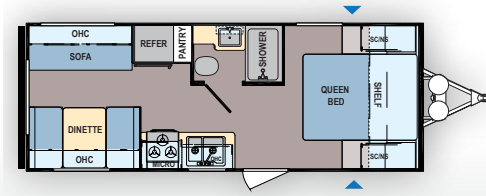

Lantern | 202RD

Ext. Length: **24' 11"** Ext. Height: **10' 10"**
Average Shipping Weight: **4,242** Sleeps **4-6**

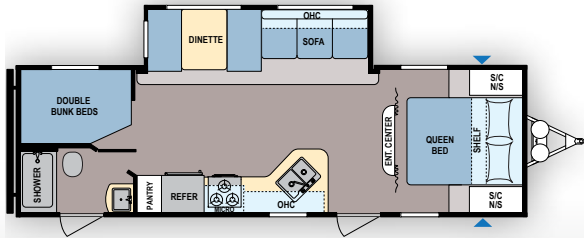

Lantern | 263BH

Ext. Length: **30' 7"** Ext. Height: **11' 4"**
Average Shipping Weight: **5,820** Sleeps **8**

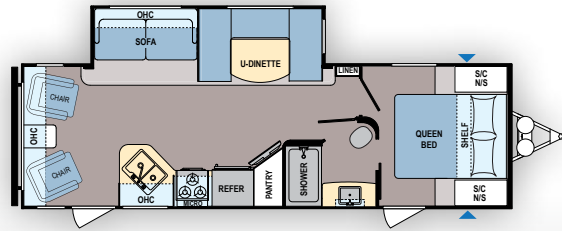

Lantern | 270RL

Ext. Length: **30' 8"** Ext. Height: **11' 2"**
Average Shipping Weight: **6,030** Sleeps **4-5**

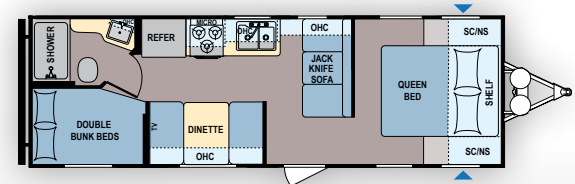

Lantern | 274BH

Ext. Length: **28' 7"** Ext. Height: **10' 4"**
Average Shipping Weight: **4,630** Sleeps **7-8**

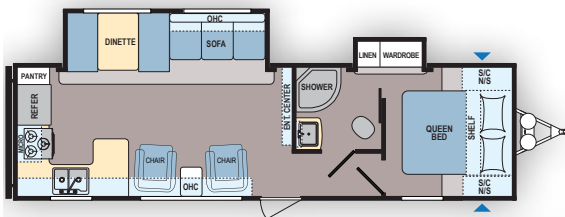

Lantern | 296RK

Ext. Length: **32' 11"** Ext. Height: **11' 6"**
Average Shipping Weight: **6,801** Sleeps **6**

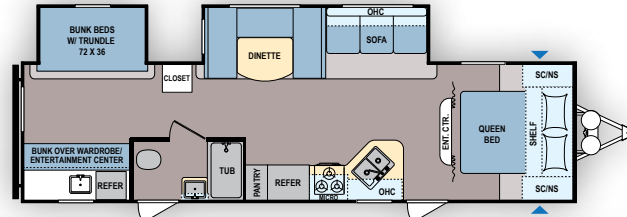

Lantern | 314BH

Ext. Length: **34' 9"** Ext. Height: **11' 6"**
Average Shipping Weight: **7,400** Sleeps **7-10**

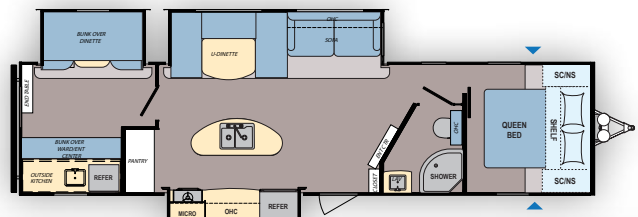

Lantern | 337BH

Ext. Length: **37' 11"** Ext. Height: **11' 3"**
Average Shipping Weight: **8,437** Sleeps **7-10**

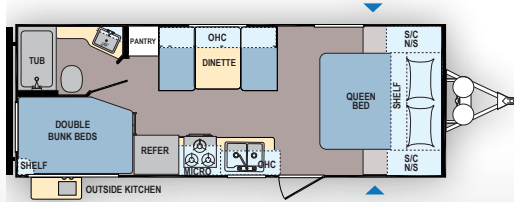

Lantern | 215BH

Ext. Length: **25' 11"** Ext. Height: **TBD**
 Average Shipping Weight: **TBD** Sleeps **5-7**

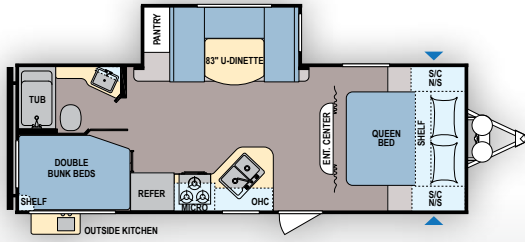

Lantern | 244BH

Ext. Length: **27' 7"** Ext. Height: **11' 4"**
 Average Shipping Weight: **5,500** Sleeps **6-8**

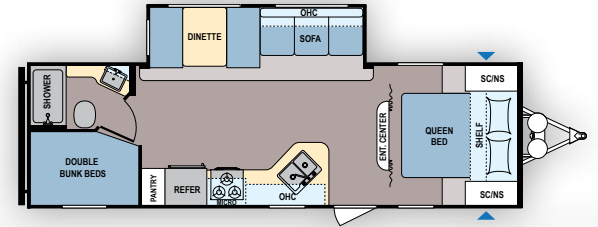

Lantern | 262BH

Ext. Length: **30' 7"** Ext. Height: **11' 4"**
 Average Shipping Weight: **5,789** Sleeps **8-10**

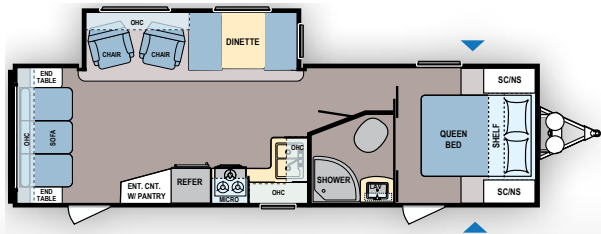

Lantern | 280RL

Ext. Length: **32' 6"** Ext. Height: **11' 3"**
 Average Shipping Weight: **6,090** Sleeps **4-6**

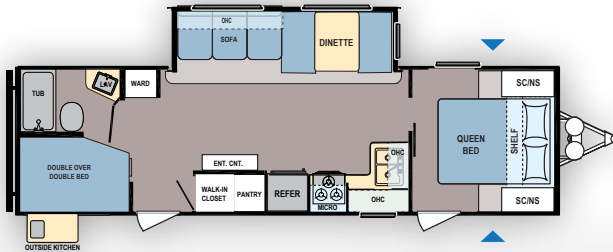

Lantern | 285BH

Ext. Length: **32' 9"** Ext. Height: **11' 3"**
 Average Shipping Weight: **6,443** Sleeps **8-10**

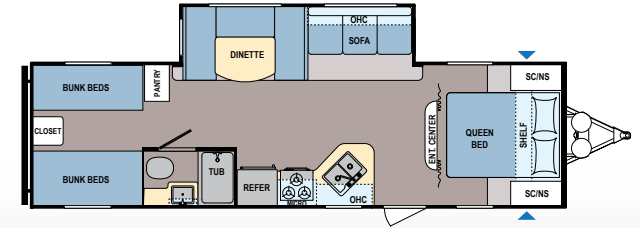

Lantern | 295QB

Ext. Length: **32' 8"** Ext. Height: **11' 3"**
 Average Shipping Weight: **6,260** Sleeps **8-9**

COLEMAN LANTERN SUT MODELS

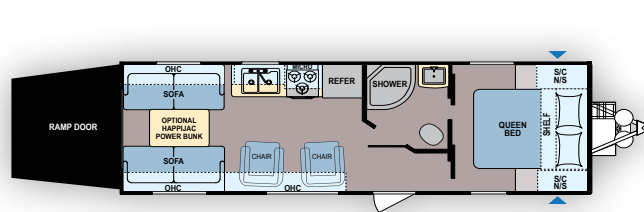

Lantern SUT | 250TQ

Ext. Length: **29' 7"** Ext. Height: **11' 4"**
 Average Shipping Weight: **5,514** Sleeps **6**

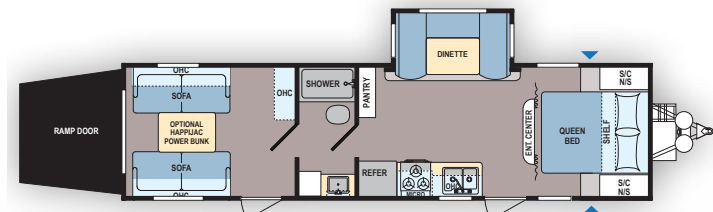

Lantern SUT | 300TQ

Ext. Length: **34' 10"** Ext. Height: **12' 4"**
 Average Shipping Weight: **6,838** Sleeps **8**

COLEMAN LANTERN LT MODELS

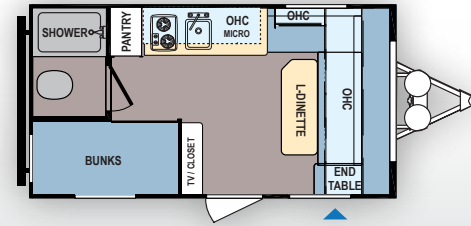

Lantern LT | 14BH

Ext. Length: 18' 9" Ext. Height: 9' 0"

Average Shipping Weight: 2,782 Sleeps 3-4

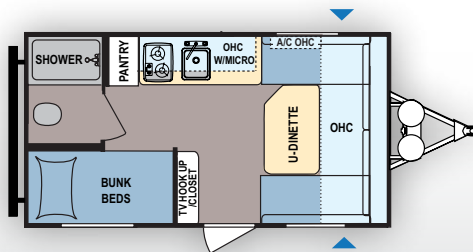

Lantern LT | 15BH

Ext. Length: 18' 9" Ext. Height: 8' 8"

Average Shipping Weight: 2,883 Sleeps 3-4

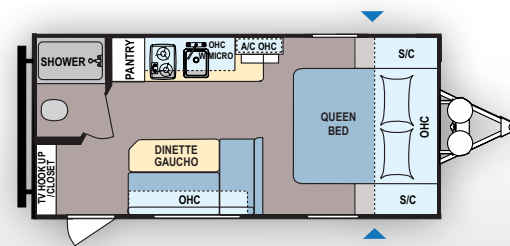

Lantern LT | 16FB

Ext. Length: 21' 5" Ext. Height: 8' 8"

Average Shipping Weight: 3,141 Sleeps 2-3

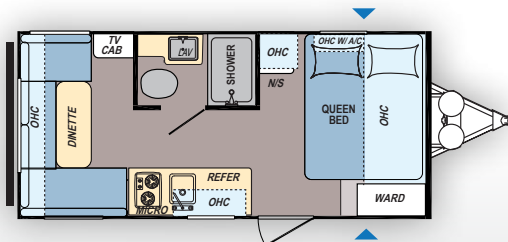

Lantern LT | 17RD

Ext. Length: 21' 2" Ext. Height: 8' 10"

Average Shipping Weight: 3,169 Sleeps 2-4

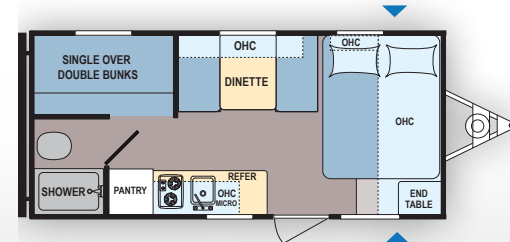

Lantern | 17FQ

Ext. Length: 21' 5" Ext. Height: 8' 8"

Average Shipping Weight: 3,205 Sleeps 6

COLEMAN LANTERN LT MODELS

Awning
Diamond plate
Tinted safety-glass windows
28" entrance door
Entry handle
Single-entry step
Porch light
Rear stabilizer jacks
E-Z Lube axles
Radial tires with steel spoke rims
Spare tire
20-lb. propane bottle
30-amp power cord
Exterior outlet
Solid-state converter with built-in battery charger
6-gal. gas water heater
Water heater bypass kit
18,000-BTU furnace
Acrylic kitchen sink with faucet
3.3 cu. ft. refrigerator
2-burner cooktop
Range hood with 12V light and exhaust fan
Microwave
Full-extension drawer guides throughout
Mini blinds throughout
Residential-grade vinyl flooring

Stereo AM/FM/MP3/SC/AUX
Interior speakers
Bath/galley fan
Shower curtain
Foot pedal flush toilet

OPTIONAL EQUIPMENT

8,000-BTU air conditioner (mandatory)
CSA upfit and seal

COLEMAN LANTERN MODELS

Awning
Diamond plate
Tinted safety-glass windows
28" entrance door(s)
Entry handle(s)
Folding entry steps (double or triple on select models)
Smooth-finish entry and baggage doors
Large storage compartment
Exterior TV connection on entry-door side
Backers for rear ladder
Front and rear jacks
E-Z Lube axles
Radial tires with nitro fill and silver spoke rims
Dual 20-lb. propane bottles with ABS cover
30-amp power cord
120V exterior outlet

Solid-state converter with built-in battery charger
13,500-BTU A/C
6-gal. gas DSI water heater with bypass kit
Residential galley sink with high-rise faucet
6 cu. ft. double-door refrigerator
3-burner cooktop
Range hood with 12V light and exhaust fan
Microwave
Interior power command center
Full-extension drawer guides throughout
Mini blinds throughout
Residential-grade vinyl flooring
Dinette storage compartment with side access (select models)
Under-bed storage
Upgraded Rest Easy mattress
Bedroom TV hookup
Backers for bedroom TV mount
Luxury furniture
2 swivel rockers (select models)
Cable/satellite TV hookup
Stereo AM/FM/CD/AUX/Bluetooth
Glass shower door (select models)
Shower curtain rod (select models)
Power bath fan
Foot pedal flush toilet
Medicine cabinet with mirror

COLEMAN LANTERN SUT MODELS

1,600-lb. rated rear ramp door
2,500-lb. rates recessed D-Rings
Maximized storage flat floors
Opposing rear fold-away sofas

OPTIONAL EQUIPMENT

Yukon Package (mandatory)
Spare tire and carrier
50 Amp Power with 2nd A/C prep (select models)
15,000-BTU A/C in place of 13,500 (select models)
Happi-Jac power bed (250TQ, 300TQ only) (mandatory)
CSA upfit and seal

YUKON PACKAGE (Mandatory)

Power awning with LED patio light
Exterior speakers
Enclosed and insulated fresh water tank
Oven with 3-burner range



To check for recent updates to floorplans and specifications. Scan this QR CODE with your favorite QR Reader application.

SPECIFICATIONS

FLOORPLAN	14BH	15BH	16FB	17RD	17FQ	202RD	215BH	244BH	262BH	263BH	270RL	274BH	280RL	285BH	295QB	296RK	314BH	337BH	250TQ	300TQ
*AVG SHIPPING WEIGHT (LBS)	2,782	2,883	3,141	3,169	3,205	4,242	TBD	5,500	5,789	5,820	6,030	4,630	6,090	6,443	6,260	6,801	7,400	8,437	5,514	6,838
CARGO CAPACITY (LBS)	1,068	967	709	678	645	3,358	TBD	2,100	1,811	1,780	1,570	2,970	3,590	3,237	3,420	2,879	2,280	2,739	4,166	2,842
DRY HITCH WEIGHT (LBS)	362	346	345	450	453	477	TBD	676	739	775	705	562	806	619	832	837	773	1,085	826	1,031
EXTERIOR HEIGHT (WITH A/C)	9'	8' 8"	8' 11"	8' 10"	8' 8"	10' 10"	TBD	11' 4'	11' 4"	11' 4"	11' 2"	10' 4"	11' 3"	11' 3"	11' 3"	11' 6"	11' 6"	11' 3"	11' 4"	12' 4"
**EXTERIOR TRAVEL LENGTH	18' 9"	18' 9"	21' 5"	21' 2"	21' 5"	24' 11"	25' 11"	27' 7"	30' 7"	30' 7"	30' 8"	28' 7"	32' 6"	32' 9"	32' 8"	32' 11"	34' 9"	37' 11"	29' 7"	34' 10"
EXTERIOR WIDTH	8'	8'	8'	8'	8'	8'	8'	8'	8'	8'	8'	8'	8'	8'	8'	8'	8'	8'	8'	8'
***FRESH WATER CAPACITY	27	27	27	27	27	60	60	60	60	60	60	60	60	60	60	60	60	60	60	60
BLACK WATER CAPACITY	28	28	28	28	28	42	42	42	42	42	42	42	42	42	42	42	42	42	42	42
GREY WATER CAPACITY	28	28	28	28	28	42	42	42	42	42	42	42	42	42	42	84	42	84	42	42
FURNACE BTU OUTPUT	19,000	19,000	19,000	19,000	19,000	25,000	25,000	25,000	30,000	25,000	30,000	25,000	30,000	25,000	25,000	30,000	30,000	25,000	20,000	30,000

*Our weights represent how most units are built, inclusive of many commonly-ordered options. **Length is defined as the distance from the centerline of hitch pin/coupler to rear bumper of trailer. ***Fresh water capacity includes water heater capacity.

NORTH AMERICA'S TRUSTED NAME IN RVs





Since 1900, the Coleman Company, Inc. has led the world in the manufacture of camping gear and outdoor equipment. From the renowned Coleman lantern to stoves, tents, sleeping bags and coolers, Coleman's reputation for high-quality camping products is legendary.

Coleman's floorplans are not only loaded with added value and innovative features, they're designed to help your family get the most out of every camping experience.

After all, Coleman is Camping!

Whether your outdoor activities involve hiking, camping, fishing, hunting, boating, swimming, tailgating or simply relaxing, Coleman offers everything you need to satisfy your family's dreams.

We invite you to visit your nearest Coleman RV dealer today, and find out for yourself why Coleman is the most respected name in outdoor recreation.

Disclaimer: Product information is as accurate as possible as of the date of publication of this brochure. Features, floorplans and specifications are subject to change without notice. Please consult our website for more current product information and specifications. Coleman,  and  are trademarks of The Coleman Company, Inc., and are used under license.



Manufactured under license by:
Dutchmen Manufacturing, Inc.
PO Box 2000 • 2164 Caragana Court
Goshen, Indiana 46527
(574) 537-0600
www.dutchmen.com

YOUR LOCAL DEALER

Colton RV & Marine
3122 Niagara Falls Blvd
North Tonawanda, NY 14120
(716) 694-0188
www.ColtonRV.com

Colton RV & Marine
3443 Southwestern Blvd.
Orchard Park, NY 14127
(716) 957-3250
www.Coltonrv.com