



**THE FIRST NAME IN CAMPING.
THE TRUSTED NAME IN RVs.**



Dutchmen
Legendary Innovation. Trailblazing Value.



The Outdoor Company®



THE FIRST NAME IN CAMPING

For more than 100 years, millions of people have trusted the Coleman name to help them thrive in the great outdoors. These all-new Coleman RVs deliver on that same reputation, packing more camping conveniences into one value-packed product! With multiple floorplans to choose from and a number of residential-style features throughout, the campground awaits you and your Coleman RV.





GREAT INDOORS

With an expansive interior height of 82 inches, Coleman RVs offer taller sliderooms, roomier cabinets and larger windows for an even better camping experience. Combine that with hardwood cabinet doors, a 60-gal. fresh water capacity and a 6-gal. gas DSI water heater, and you're certain to feel at home wherever your travels take you.



SWEET DREAMS

The comfortable master bedroom features handy nightstands, mirrored cabinets, a bonus storage shelf and a queen-sized mattress.

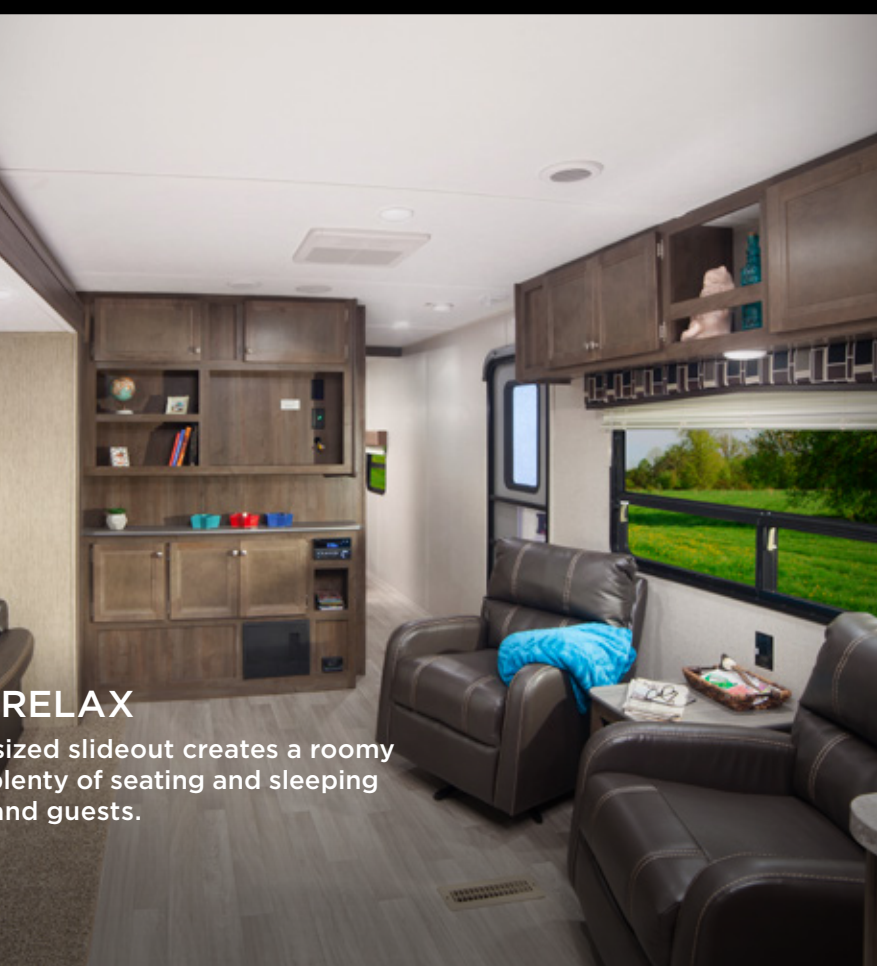

ROOM TO RELAX

Coleman's oversized slideout creates a roomy living area with plenty of seating and sleeping space for family and guests.

NORTH AMERICA'S **TRUSTED** NAME IN RVs



OUTDOOR KITCHEN

Select models feature an exterior kitchen, perfect for Coleman outdoor enthusiasts.



LED AWNING AND OUTDOOR SPEAKERS

Enjoy more outside your RV with the LED power awning and outdoor speakers.



INTERIOR POWER COMMAND CENTER

Control your lights, sliderooms, power awning and more all from one smart location.

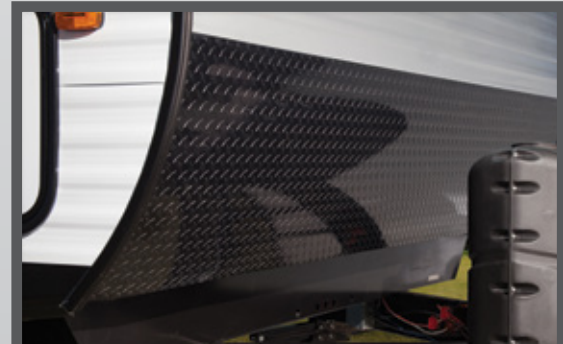

BLACK DIAMOND PLATE ROCK GUARD

The black diamond-plate rock guard protects your RV from the rigors of the road.

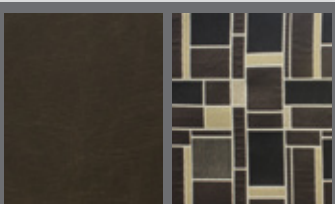

MACKINAC DECOR

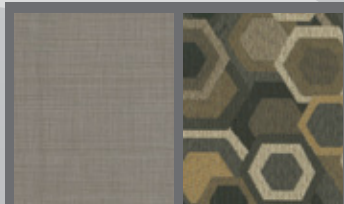

BAYSIDE DECOR





Lantern LT 17FQ

LANTERN LT

Whether you're a couple wanting to enjoy the great outdoors or a young family looking to create your own camping traditions, Lantern LT is a series that will appeal to you. With the wide array of features and upgraded interior amenities, you are sure to see why Coleman is one of the fastest-growing brands in the market.



LANTERN

Coleman's Lantern Series features spacious floorplans and one of the longest lists of amenities in its class. Combining old-world craftsmanship with over-the-top conveniences, like a power awning with LED lights, standard front and rear jacks, and upgraded seamless kitchen counter tops, your family will love everything the Coleman Lantern offers to help you get away from it all.





The Outdoor Company®



THE FIRST NAME IN **CAMPING**

Every day is an adventure with Coleman, especially when you ramp up the fun with an outing in the Lantern SUT. Part toy hauler, part travel trailer, this model packs garage space for the toys, a HappiJac power bed for the guests and a private bedroom for the two leaders in the pack. Plus, the flush-floor cargo area doesn't sacrifice space to bulky wheel wells. At Coleman, we believe in practical design.





FLEXIBLE INDOORS

With an interior height of 82 inches, 2,500-lb rated tie-downs, flat floor cargo area, and a Happi-Jac power bed, the Coleman Lantern SUT models give you the flexibility you need for your active lifestyle.



BUNKS UP

Take your gear and your toys with you.



BUNKS DOWN

Convert the cargo area into a plush bedroom.

THE FIRST NAME IN CAMPING. THE TRUSTED NAME IN RVS.

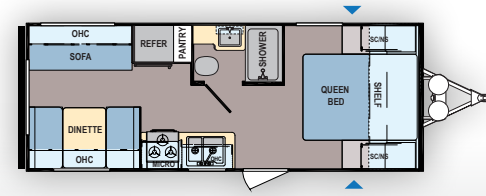

Lantern | 202RD

Ext. Length: **24' 11"** Ext. Height: **10' 10"**
Average Shipping Weight: **4,225** Sleeps **4-6**

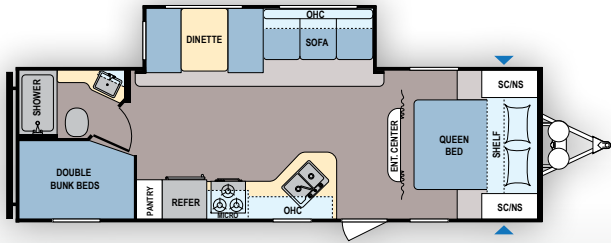

Lantern | 262BH

Ext. Length: **30' 7"** Ext. Height: **11' 4"**
Average Shipping Weight: **5,789** Sleeps **8-10**

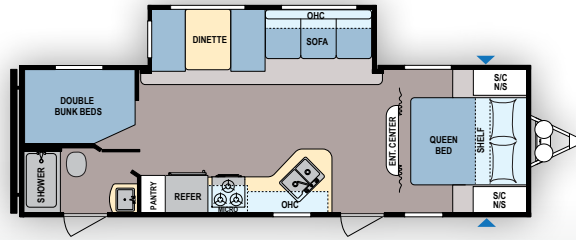

Lantern | 263BH

Ext. Length: **30' 7"** Ext. Height: **11' 1"**
Average Shipping Weight: **5,871** Sleeps **8**

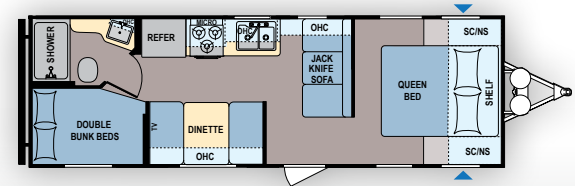

Lantern | 274BH

Ext. Length: **28' 7"** Ext. Height: **10' 4"**
Average Shipping Weight: **4,676** Sleeps **7-8**

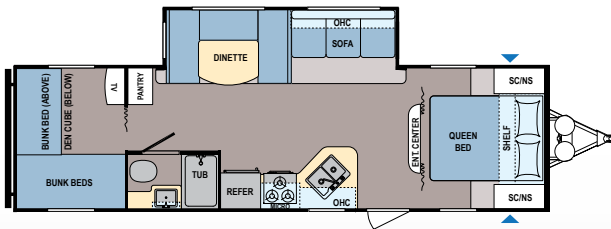

Lantern | 295QB

Ext. Length: **32' 8"** Ext. Height: **11' 3"**
Average Shipping Weight: **6,231** Sleeps **8-9**

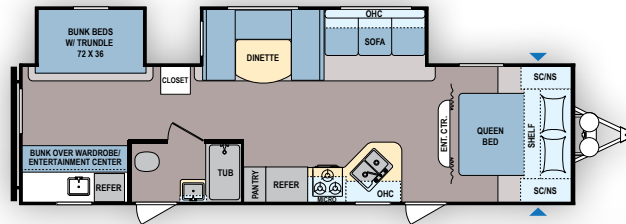

Lantern | 314BH

Ext. Length: **34' 9"** Ext. Height: **11' 6"**
Average Shipping Weight: **7,400** Sleeps **7-10**

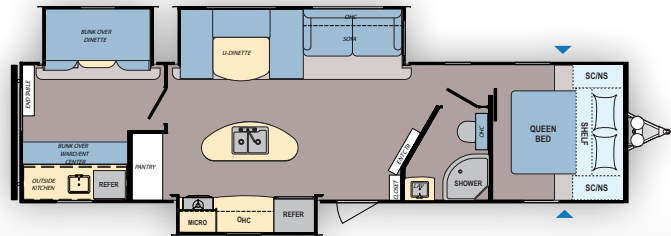

Lantern | 337BH

Ext. Length: **37' 11"** Ext. Height: **11' 3"**
Average Shipping Weight: **8,352** Sleeps **7-10**

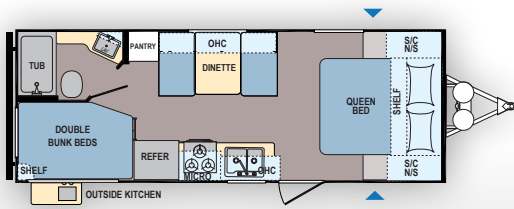

Lantern | 215BH

Ext. Length: **25' 11"** Ext. Height: **10' 7"**
 Average Shipping Weight: **4,448** Sleeps **5-7**

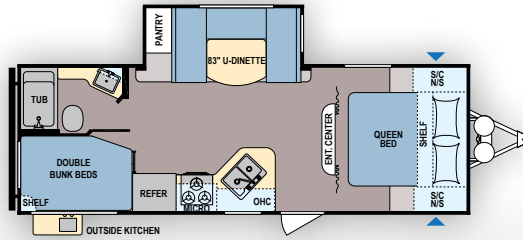

Lantern | 244BH

Ext. Length: **27' 7"** Ext. Height: **11' 4"**
 Average Shipping Weight: **5,421** Sleeps **6-8**

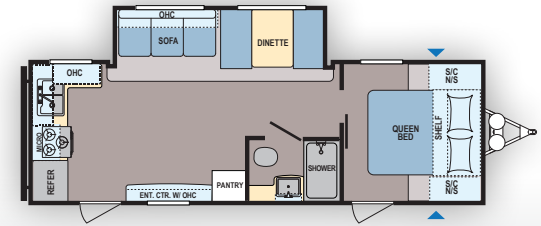

Lantern | 245RK

Ext. Length: **28' 11"** Ext. Height: **11' 4"**
 Average Shipping Weight: **5,674** Sleeps **4-6**

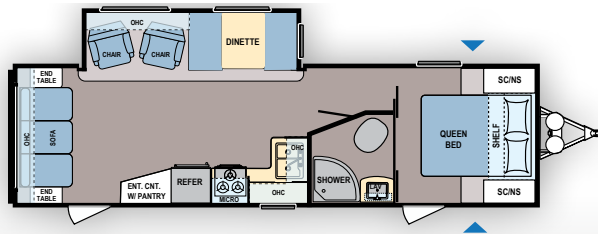

Lantern | 280RL

Ext. Length: **32' 6"** Ext. Height: **11' 3"**
 Average Shipping Weight: **6,169** Sleeps **4-6**

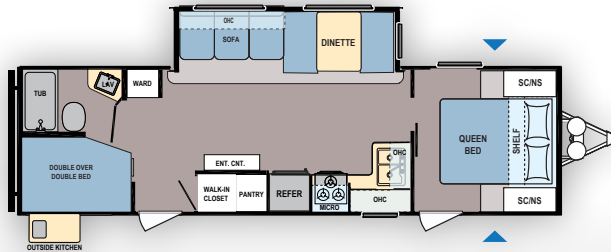

Lantern | 285BH

Ext. Length: **32' 9"** Ext. Height: **11' 3"**
 Average Shipping Weight: **6,515** Sleeps **8-10**

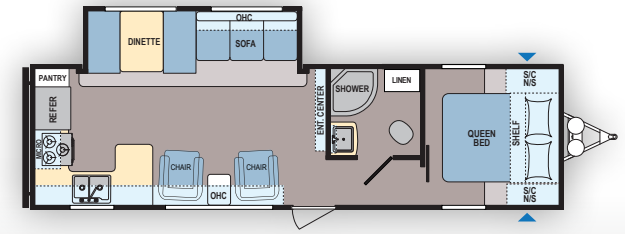

Lantern | 286RK

Ext. Length: **32' 11"** Ext. Height: **11' 6"**
 Average Shipping Weight: **6,339** Sleeps **6**

COLEMAN LANTERN SUT MODELS

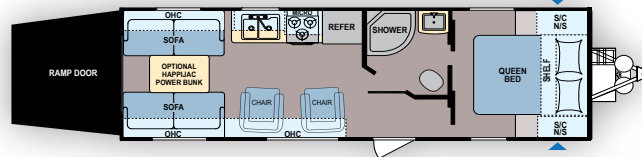

Lantern SUT | 250TQ

Ext. Length: **29' 7"** Ext. Height: **11' 4"**
 Average Shipping Weight: **5,514** Sleeps **6**

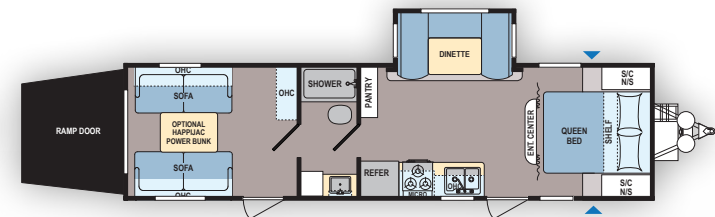

Lantern SUT | 300TQ

Ext. Length: **34' 10"** Ext. Height: **12' 4"**
 Average Shipping Weight: **6,838** Sleeps **8**

COLEMAN LANTERN LT MODELS

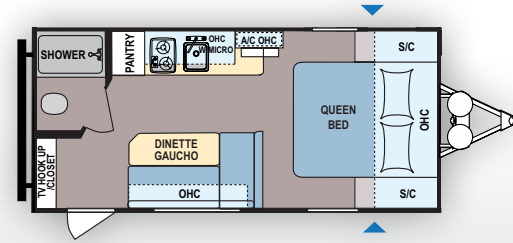

Lantern LT | 16FB

Ext. Length: **21' 5"** Ext. Height: **8' 8"**
Average Shipping Weight: **3,141** Sleeps **2-3**

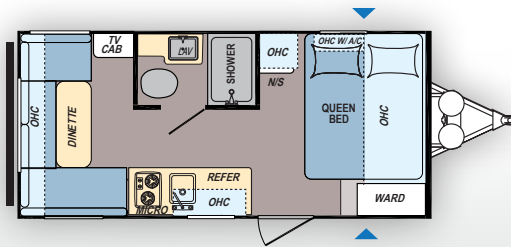

Lantern LT | 17RD

Ext. Length: **21' 2"** Ext. Height: **8' 10"**
Average Shipping Weight: **3,136** Sleeps **2-4**

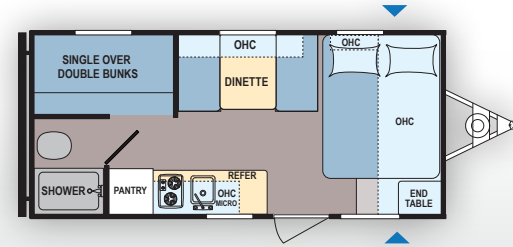

Lantern | 17FQ

Ext. Length: **21' 5"** Ext. Height: **8' 8"**
Average Shipping Weight: **3,205** Sleeps **6**

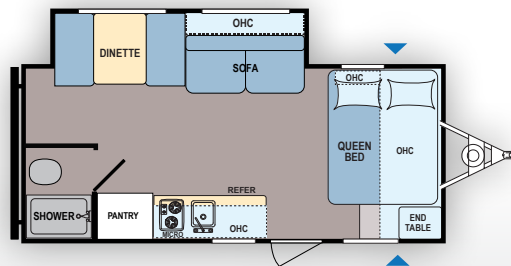

Lantern LT | 18FQ

Ext. Length: **22' 9"** Ext. Height: **10'**
Average Shipping Weight: **3,992** Sleeps **4-6**

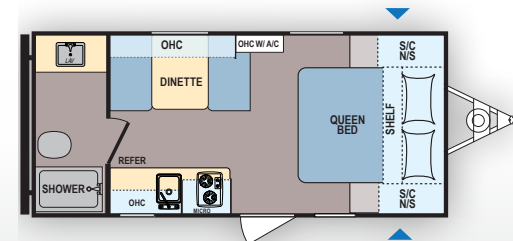

Lantern | 18RB

Ext. Length: **21' 5"** Ext. Height: **8' 11"**
Average Shipping Weight: **3,044** Sleeps **2-4**

COLEMAN LANTERN LT PACKAGE

Tinted Safety Glass Windows
Front Rockguard Plate
28" Entrance Door Without Window Entry Handle
Entry Step
Porch Light w/Switch on Light
Rear Jacks
Easy Lube Axles
Silver Spoke Rims
Radial Tires
Spare Tire
20# LP Bottle
Exterior Outlet
30 AMP Power Cord
Solid State Converter w/Built in Battery Charger
6 Gallon Gas Water Heater
Water Heater By-Pass Kit
18,000 BTU Furnace
3.3 Cubic Foot Refer
Microwave
2 Burner Cooktop
Range Hood w/12V Light & Exhaust Fan
Full Extension Drawer Guides Throughout
Non-Power Bath/Galley Fan
Skylight in Bath
Shower Curtain
Foot Pedal Flush Toilet
Hard Valance Living Area
Mini-Blinds Throughout
Residential Grade Vinyl Flooring
Stereo AM/FM/MP3/SC/AUX
Interior Speakers

LANTERN LT TECHNOLOGY PACKAGE

Power Awning w/ LED Patio Light
Multi-Color Selectable Patio Light w/ Remote
Bluetooth Enhanced Stereo
Solar Charge Connection

OPTIONAL EQUIPMENT

CSA Upfit & Seal

MANDATORY OPTIONS

Coleman Lantern LT Package
Lantern LT Tech Package
8,000 BTU Air Conditioner

COLEMAN LANTERN PACKAGE

Awning
Front Rockguard Plate
Tinted Safety Glass Windows
Front and Rear Jacks
Easy Lube Axles
Radial Tires w/Silver Spoke Rims
13,500 BTU Air Conditioner
30 AMP Power Cord
120V Exterior Outlet
Dual 20# LP Bottles with ABS Cover
28" Entrance Door(s)
6 Gallon Gas DSI Water Heater w/By-Pass Kit
Entry Handle(s)
Porch Light with Interior Switch
Folding Entry Steps (Double/Triple - FP Specific)
Backers for Rear Ladder
Smooth Finish Entry/Baggage Doors

Large Storage Compartment
Solid State Converter w/Built in Battery Charger
Interior Power Command Center
Full Extension Drawer Guides Throughout
Solid Valances in Living Room and Master Bedroom
Mini Blind Shades Throughout
Residential Grade Vinyl Flooring
Dinette Storage Compartment with Side Access (FP Specific)
Under Bed Storage
Upgraded Rest Easy Mattress
Bedroom TV Hook-Up
Bedroom USB Connections
Bedroom TV Location - Backers for TV Mount
Everwear Luxury Furniture
Bunk Bed USB Connections (model specific)
Upgraded Residential Styled Sofa with Center Arm Rest
2 Swivel Rockers (Model Specific)
Cable/Satellite TV Hook-Up
Stereo AM/FM/CD/AUX/Bluetooth
Glass Shower Door (FP Specific)
Shower Curtain Rod (Tub Models)
Power Bath Fan
Foot Pedal Flush Toilet
Medicine Cabinet w/Mirror
Residential Galley Sink w/High Rise Faucet
6 Cubic Foot Double Door Refer w/Black Insert
3 Burner Cooktop
Microwave
Range Hood w/12V Light & Exhaust Fan

Solar Charge Connection
Backup Camera Prep

LANTERN SUT MODELS

1,600-lb. rated rear ramp door
2,500-lb. rates recessed D-Rings
Maximized storage flat floors
Opposing rear fold-away sofas

YUKON PACKAGE

Power Awning with LED Patio Light
Exterior Speakers
Enclosed and Insulated Fresh Water Tank
Oven with 3 Burner Range

OPTIONAL EQUIPMENT

Spare Tire & Carrier
15,000 BTU A/C IPO 13.5 (N/A 192)
CSA Upfit & Seal

MANDATORY OPTIONS

Coleman Lantern Package
Yukon Package
Outside Shower
LED HD TV (285BH, 285BHWE only)



To check for recent updates to floorplans and specifications. Scan this QR CODE with your favorite QR Reader application.

SPECIFICATIONS

Floorplan	16FB	17FQ	17RD	18FQ	18RB	202RD	215BH	244BH	245RK	262BH	263BH	274BH	280RL	285BH	286RK	295QB	314BH	337BH	250TQ	300TQ
*AVG Shipping Weight (LBS)	3,141	3,205	3,136	3,992	3,044	4,225	4,448	5,421	5,674	5,789	5,871	4,676	6,169	6,515	6,339	6,231	7,400	8,352	5,514	6,838
Cargo Capacity (LBS)	2,340	2,340	2,340	2,340	806	2,340	2,340	2,340	2,340	2,340	2,340	2,340	2,340	2,340	2,340	2,340	2,340	2,340	2,340	2,340
Dry Hitch Weight (LBS)	345	453	445	676	358	471	450	640	784	739	782	568	816	857	702	814	773	1,074	900	1,031
**Exterior Length	21' 5"	21' 5"	21' 2"	22' 9"	21' 5"	24' 11"	25' 11"	27' 7"	28' 11"	30' 7"	30' 7"	28' 7"	32' 6"	32' 9"	32' 11"	32' 8"	34' 9"	37' 11"	29' 7"	34' 10"
Exterior Width	96"	96"	96"	96"	96"	96"	96"	96"	96"	96"	96"	96"	96"	96"	96"	96"	96"	96"	96"	96"
Exterior Height (with A/C)	107"	103.5"	107"	121"	107"	130"	127"	133"	133"	136"	133"	124"	135"	134"	135"	136"	138"	136"	137"	148"
***Fresh Water Capacity	27	27	27	27	27	60	60	60	60	60	60	60	60	60	60	60	60	60	60	60
Black Water Capacity	28	28	28	28	28	42	42	42	42	42	42	42	42	42	42	42	42	42	42	42
Grey Water Capacity	28	28	28	28	28	42	42	42	84	42	42	42	42	42	42	42	42	84	42	42

*Our weights represent how most units are built, inclusive of many commonly-ordered options. **Length is defined as the distance from the centerline of hitch pin/coupler to rear bumper of trailer. ***Fresh water capacity includes water heater capacity.

NORTH AMERICA'S TRUSTED NAME IN RVs



Since 1900, the Coleman Company, Inc. has led the world in the manufacture of camping gear and outdoor equipment. From the renowned Coleman lantern to stoves, tents, sleeping bags and coolers, Coleman's reputation for high-quality camping products is legendary.

Coleman's floorplans are not only loaded with added value and innovative features, they're designed to help your family get the most out of every camping experience.

After all, Coleman is Camping!

Whether your outdoor activities involve hiking, camping, fishing, hunting, boating, swimming, tailgating or simply relaxing, Coleman offers everything you need to satisfy your family's dreams.

We invite you to visit your nearest Coleman RV dealer today, and find out for yourself why Coleman is the most respected name in outdoor recreation.



Manufactured under license by:
Dutchmen Manufacturing, Inc.
PO Box 2000 • 2164 Caragana Court
Goshen, Indiana 46527
(574) 537-0600
www.dutchmen.com

Disclaimer: Product information is as accurate as possible as of the date of publication of this brochure. Features, floorplans and specifications are subject to change without notice. Please consult our website for more current product information and specifications. Coleman, Dutchmen and the lantern icon are trademarks of The Coleman Company, Inc., and are used under license.

YOUR LOCAL DEALER

Colton RV
North Tonawanda, NY 14120
(716) 694-0188
(800) 628-4889
www.ColtonRV.com

Colton RV
Orchard Park, NY 14127
(716) 957-3250
(800) 628-4889
www.Coltonrv.com