

FIFTH WHEELS



A HIGHER STANDARD

CRUSADER



"NORTH AMERICA'S
FAVORITE RV COMPANY!"



www.primetimerv.com

CRUSADER



CRUSADER

Within us all, there's a calling to achieve ever-greater things; a search for a higher standard. In creating Crusader, we asked our engineers and design team to throw caution to the wind and engage in serious "outside the box" thinking.

We challenged them to think beyond the status quo and reach for product innovations not currently offered. We said, "Make Crusader a new icon for the 21st century." Needless to say, they took the challenge to heart.

The result of their efforts represents a new standard in fifth wheels – A HIGHER STANDARD – Crusader.



• Crusader 295RST

A HIGHER STANDARD



• *Crusader 295RST Bedroom*

• *Crusader 295RST Closet*

Crusader is unlike any fifth wheel in its class. On the outside, our fifth wheel experts have combined advanced engineering and design with best-in-class features to create a fifth wheel that looks great, tows easily, and maximizes convenience. On the inside, Cherry hardwood cabinetry and solid surface kitchen countertops carefully work together to make a lasting

impression. Your comfort and relaxation will be guaranteed with an abundance of upgrades such as high gloss champagne exterior, residential furniture and Ground Control Automatic Leveling System. Finally your long-term peace of mind is assured with Crusader's durable ETENABOND® Construction, 50 AMP service and our custom 65 point pre-delivery inspection on 100 percent of our units.

A HIGHER STANDARD



• Crusader 322RES Living Room

A HIGHER STANDARD



• Crusader 322RES Kitchen

**A HIGHER
STANDARD
THAT WILL
IMPRESS AT
EVERY TURN**

Within seconds of entering, experienced RV'ers will recognize Crusader's subtle details of excellence, best-in-class features, and residential appointments.

Crusader's kitchens are by far the best in its class! We have designed our kitchens with large countertop preparation areas, enormous amounts of storage and large pantries. Crusader kitchens

are appointed with many modern amenities such as LG Solid Surface countertops, stainless steel sinks, sprayer faucet and large storage drawers. Crusader kitchens are definitely built to a *Higher Standard!*



• Crusader 322RES Bedroom



• Crusader 322RES Bedroom

All Crusader bedrooms are built for comfort and convenience. Every Crusader model features large 60" x 80" Ever Rest® select foam beds while several models come standard with a king bed. Crusader bedrooms feel spacious and roomy due to our tall ceilings, they have large storage closets, and our bedroom slide-out models come with the added convenience of washer and dryer preparation. Everywhere you look; there are numerous upgrades that will make your Crusader the envy of the campground.



TOP FEATURES

CRUSADER

A HIGHER STANDARD



PRIME TIME PROUDLY USES DEXTER AXLES

2 Year Warranty
DEXTER AXLE COMPANY

» Your safety and peace-of-mind while traveling are assured with high quality, heavy duty Dexter Axles.



EZ FLEX SUSPENSION

2 Year Warranty
DEXTER AXLE COMPANY

» The E-Z Flex technology virtually eliminates damage caused by vibration from rough road conditions. This will help protect your valuable investment.



LED LIGHTED AWNING

» Every Crusader is equipped with a LED awning light. Our customers like how the light brightens your campsite with the awning opened or closed.



LED INTERIOR LIGHTING

» All Crusaders have LED interior lighting. Customers appreciate that Crusader's lights operate cooler and draw less electricity.



HIGH GLOSS FIBERGLASS

» All Crusaders are High Gloss Gel Coated Fiberglass exteriors. The exteriors are uniquely designed to be easy on the eyes while sharp traveling down the road.



STAINLESS STEEL SINK AND SPRAYER FAUCET

» Crusader customers love the durability of the Stainless Steel Sink and the convenience of the pull down Sprayer Faucet.



ETERNABOND® CONSTRUCTION

» Every wall, floor, and slide-out roof is made up of welded aluminum framework that is laminated together in order to build a stronger, longer lasting RV.

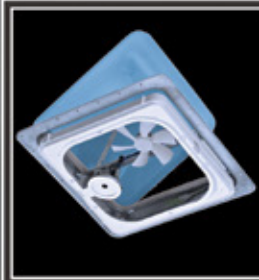

KITCHEN POWER FAN

» The power vent fan operates with a touch of a button. Powers up, down, on and off. This will insure proper air flow throughout your RV.



* R-52 EXTREME THERMAL PACKAGE

» R-52 Extreme Thermal Package provides superior protection from the outside elements, while keeping you cool in the summer and warm in the winter.

** R-Values calculated at 80° Ambient Temperature*



UNIVERSAL DOCKING CENTER

» Crusader provides Best In Class convenience of having all your water connections, cable connections and outside shower in a lockable all-in-one, easy to use compartment.



GROUND CONTROL AUTO LEVELING SYSTEM

» This one touch Auto Leveling System makes setting up your Crusader quick and easy!



"QUIET COOL" AIR CONDITIONER

» Every Crusader is equipped with Dometic's premium "Quiet Cool" air conditioner. This air conditioner is 25% more efficient and 75% quieter than the competition.

260 RLD



315 RST



335 BHS



294 RLT



321 RES

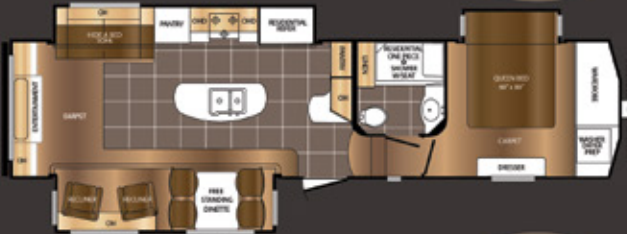

350 REQ

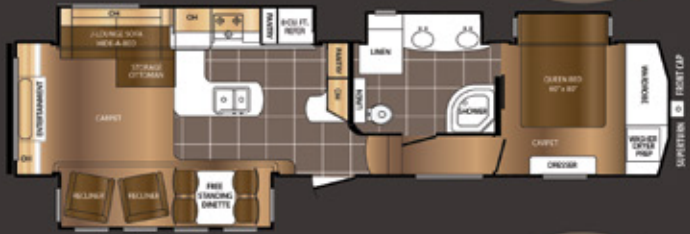

295 RST



322 RES



351 REQ



296 BHS



334 CKT



360 BHS



370 BHQ



CRUSADER

A HIGHER STANDARD

PRIME TIME
Manufacturing

www.primetimerv.com



CONSTRUCTION

- Gel Coated Fiberglass Exterior
- 5" Truss Rafters On 16" Centers with 3/8" WALK ON Decking
- Fiberglass Roof Insulation (R-14)
- One Piece Rubber Roof With 12 Year Warranty
- Upgraded Water Line Fittings With 25 Year Warranty
- Easy Access Low Point Drain Switches
- Easy Access Fresh Water Drain Switches
- **Fresh Water Capacity - 60 Gallons**
- **Waste Water Capacity - 35 Gallons** (360BHS, 370BHQ only - 70 Gallons)
- **Gray Water Capacity - 70 Gallons**

EXTERIOR STANDARDS

- SUPER TURN® Aerodynamic Front Cap
- "E-Z LUBE" Greasable Axle Hubs
- Oversized Pass Thru Baggage Doors
- Extended Drip Spouts
- Black, Dark Tinted, Radius Safety Glass Windows
- 30# LP Bottles - Weight Distribution Design
- Quick Connect® Exterior LP Connection
- Outside Speakers
- Folding Grab Handle
- 30" Radius Entry Door
- Outside Shower With Detachable Hose
- Digital Compatible Roof Mounted Antenna
- Hi-Rise Triple Entry Step
- Outside Television Hook-Up
- ABS Hitch Cover
- 15" Aluminum Wheels And Tires (260,285,294,295,296)
- 16" Aluminum Wheels And Tires (315,321,322,334,335,350,351,360,370)

APPLIANCES/EQUIPMENT

- 15,000 BTU "Quiet Cool" Air Conditioner
- 35,000 BTU Hi Capacity Gas Furnace
- 3-Burner Range With Large Oven
- Range Hood With Light And Exhaust
- 8 Cubic Foot Double Door Refrigerator
- 6 Gal. Gas/Electric W/H With DSI
- 18 Gal./Hr. Quick Recovery Mode For Water Heater
- Simple Water Heater Bypass
- Hi Capacity Water Pump
- 12V Electrical System
- EZ Winterization Hook-Up
- Washer/Dryer Prep (bed slide models)

INTERIOR STANDARDS

- Solid Cherry Hardwood Cabinet Doors
- Solid Cherry Hardwood Drawer Fronts
- Solid Wood Core Cabinets
- Predrilled and Screwed Cabinetry
- Ball Bearing Extended Drawer Glides
- "Video Pro" Separate Cable/Satellite Prep
- Upgraded Residential Carpet
- Deep Overhead Cabinets in Slide Out (where applicable)
- Swivel Chairs (260 only)
- Large Panoramic Slide Room Windows
- Premium Vinyl Flooring
- Pleated Shades

KITCHEN

- LG Solid Surface Countertops
- Polished Nickel Fixtures & Hardware
- Deep, Double Bowl Stainless Steel Sink
- Sprayer Kitchen Faucet
- Residential Style Microwave
- Large Size Trash Can In Dedicated Area (most models)
- Oversized Pots N Pans Drawer (most models)
- Slide Out Pantry (most models)

BATHROOM

- King Size Shower (most models)
- Glass Shower Enclosure (most models)
- ABS Tub Surround
- Deluxe Skyview® Skylight Over Tub
- Power Vent Fan
- Porcelain Toilet With Foot Flush
- STOR MOR® Shower Caddy
- Large Bathroom Sink
- Medicine Cabinet With Mirror

BEDROOM

- Dual Wardrobes (most models)
- Underbed Storage With Struts
- Residential Bedspread
- Bedroom Heat And A/C Vents
- Wired & Framed for 2nd Air Conditioner

SAFETY EQUIPMENT

- CO Detector
- LP Detector
- Fire Extinguisher
- Propane Alarm
- Smoke Alarm

"ADVANTAGE PACKAGE"

- ** (MANDATORY)
- ETERNABOND CONSTRUCTION Featuring:
 - Laminated Aluminum Framed Side Walls (R-11)
 - Laminated Aluminum Framed End Walls (R-11)
 - Laminated Aluminum Framed Main Floor (R-14)
 - Laminated Aluminum Framed Slide Out Walls And Roof
- Golden Cherry Cabinetry
- LG Solid Surface Countertops
- LG Solid Surface Sink Covers
- Universal Docking Center (UDC)
 - Cable & Satellite Hook-ups
 - Black Tank Flush

- Battery Disconnect Switch
- Spray Port With Hot & Cold Water
- Coil Hose
- Simple Water Heater By-Pass Switch
- Simple Winterization Switch
- Simple Winterization Draw Line
- City Water Connection And Fresh Tank Gravity Fill
- Thermal Package Plus Featuring:
 - Enclosed And Heated Underbelly
 - Heated Holding Tanks
 - Enclosed Dump Valves
 - Heated Dump Valves
 - Zero Degree Extended Season Enjoyment

- Roof Ladder
- Spare Tire
- Residential Hide-A-Bed Sofa
- Residential Recliners (294,321,322,334,350,351 only)
- Detachable Power Cord
- Ever Rest Select Foam Mattress
- Dexter "E-Z Flex" Rubberized Suspension
- 1 Year Emergency Roadside Assistance Plan
- Leak Guard Assurance Process
- DVD And Surround Sound System
- Exterior Speakers
- Large LED TV
- One Touch Electric Awning
- 15K BTU "Quiet Cool" Premium Air Conditioning System
- 50 AMP Electrical System
- Prepped For Bedroom Air Conditioner

TOURING EDITION PACKAGE (MANDATORY)

- Extreme Thermal Package R-52 (roof, floor and behind cap)
- High Gloss Gel Coat Exterior
- Stainless Steel Sink & Sprayer Faucet
- Kitchen Power Vent
- Electric Fireplace
- Ground Control 4 Point Auto Leveling
- LED Interior Lighting
- LED Lighted Awning

OPTIONS

- 16" Aluminum Wheels And "E" Rated Tires IPO 15"
- Free Standing Table With 4 Chairs (322,334,350,370 only)
- Champagne High Gloss Gel Coat Exterior (mandatory)
- Dual Pane Windows
- Theater Seating IPO Recliners (334 only)
- 2nd 13.5K "Quiet Cool" Air Conditioner With Dual Zone Control (315,321,322,334,350,351,360,370 only)

**Mandatory Effective 1/1/15



CRUSADER

A HIGHER STANDARD



PRIME TIME
Manufacturing

www.primetimerv.com

SPECIFICATIONS	260RLD	294RLT	295RST	296BHS	315RST	321RES	322RES	334CKT	335BHS	350REQ	351REQ	360BHS	370BHQ
Length	29' 11"	32' 11"	31' 11"	35' 3"	33' 11"	36' 3"	36' 3"	37' 9"	37' 9"	39' 6"	39' 6"	40' 5"	40' 5"
Height	11' 8"	11' 8"	11' 8"	11' 8"	12' 7"	12' 7"	12' 7"	12' 7"	12' 7"	12' 7"	12' 7"	13' 2"	13' 2"
Hitch	1,321	1,290	1,278	1,350	1,953	1,715	1,752	1,741	1,657	2,270	2,270	1,852	2,110
Ship Weight	7,669	9,061	8,777	8,934	9,926	10,632	10,618	10,606	9,751	11,875	11,875	12,120	13,331
Carrying Capacity	2,393	2,351	3,117	2,538	2,389	3,045	3,096	3,097	2,268	2,357	2,357	1,694	2,741

Base Weight - The weight of the unit with no fluids, cargo, optional equipment or accessories. **Carrying Capacity** - The amount of weight available for all fluids, cargo, optional equipment and accessories.

A HIGHER STANDARD



• 29RS Living Area



• 29RS Dinette



• 29RS Kitchen

CRUSADER

HALF-TON SERIES

LITE

PRIME TIME
Manufacturing



A HIGHER STANDARD

Within seconds of entering, experienced RV'ers will recognize Crusader Lite's subtle details of excellence, best-in-class features, and residential appointments.



• 29RS Bedroom

CONSTRUCTION

- Champagne High Gloss Gel Coated Fiberglass Exterior
- 5" Truss Rafters On 16" Centers With 3/8" WALK ON Decking
- Fiberglass Roof Insulation (R-14)
- One Piece Rubber Roof With 12 Year Warranty
- Upgraded Water Line Fittings With 25 Year Warranty
- Easy Access Low Point Drains
- Easy Access Fresh Water Drain
- **Fresh Water Capacity - 60 Gallons**
- **Waste Water Capacity - 35 Gallons** (30BH only - 70 Gallons)
- **Gray Water Capacity - 35 Gallons** (29RKS only - 70 Gallons)

EXTERIOR STANDARDS

- SUPER TURN® Aerodynamic Front Cap
- "E-Z LUBE" Axle Hubs
- Oversized Pass Thru Baggage Doors
- Extended Drip Spouts
- Black, Dark Tinted, Radius Safety Glass Windows
- 30lb. LP Bottles - Weight Distribution Design
- Outside Speakers
- Folding Grab Handle
- 30" Radius Entry Door
- Outside Shower with Detachable Hose
- Digital Compatible Roof

- Mounted Antenna
- Electric Awning
- Hi-Rise Triple Entry Step
- Outside Television Hook-Up
- LED Awning Light
- 15" Wheels And Tires

INTERIOR STANDARDS

- Solid Cherry Hardwood Cabinet Door Frames
- Solid Wood Core Cabinets
- Predrilled And Screwed Cabinetry
- Ball Bearing Extended Drawer Glides
- "Video Pro" Separate Cable / Satellite Prep
- Upgraded Residential Carpet
- Deep Overhead Cabinets In Slide Out (where applicable)
- Recliners (where applicable)
- Large Panoramic Slide Room Windows
- Premium Vinyl Flooring
- Pleated Shades

APPLIANCES/EQUIPMENT

- 15,000 BTU Air Conditioner
- Hi Capacity Gas Furnace
- 3-Burner Range With Large Oven
- Range Hood With Light And Exhaust
- Double Door Refrigerator
- 6 gal Gas/Electric W/H With DSI
- 18 gal/hr Quick Recovery Mode For Water Heater

- Hi Capacity Water Pump
- 12V Electrical System
- Simple Winterization Switches
- Simple Water Heater By-Pass Switch

KITCHEN

- Polished Nickel Fixtures And Hardware
- Deep, Double Bowl Kitchen Sink
- Hi Rise Metal Kitchen Faucet
- Residential Style Microwave
- Large Pots N Pans Drawer
- Sink Cover

BATHROOM

- Residential Size Shower With Glass Doors
- ABS Tub Surround
- Deluxe Skyview® Skylight Over Tub
- Power Vent Fan
- Large Bathroom Sink
- Medicine Cabinet With Mirror

BEDROOM

- Large Wardrobe Closet And Drawers
- Underbed Storage With Struts
- Residential Bedspread
- Bedroom Heat And A/C Vents
- Two Nightstands

SAFETY EQUIPMENT

- CO Detector
- LP Detector
- Fire Extinguisher

- Propane Alarm
- Smoke Alarm

** ADVANTAGE PACKAGE

- ETERNABOND CONSTRUCTION Featuring:

- Laminated Aluminum Framed Side Walls (R-11)
- Laminated Aluminum Framed End Walls (R-11)
- Laminated Aluminum Framed Main Floor (R-14)
- Laminated Aluminum Framed Slideout Walls And Roof
- Universal Docking Center (UDC) Featuring:
 - Cable And Satellite Hook-ups
 - Black Tank Flush
 - Battery Disconnect Switch
 - Spray Port With Hot And Cold water Coil Hose
- Simple Water Heater By-Pass Switch
- Simple Winterization Switch
- Simple Winterization Draw Line
- City Water Connection And Fresh Tank Gravity Fill
- Thermal Package Plus Featuring:
 - Enclosed And Heated Underbelly
 - Heated Holding Tanks
 - Enclosed Dump Valves
 - Heated Dump Valves
- Extended Season Enjoyment
- Roof Ladder

- Spare Tire
- Residential Hide-A-Bed Sofa
- Residential Recliners (28RL 27RK only)
- Detachable 30 Amp Power Cord
- Evergreen Mattress
- 1-Year Emergency Roadside Assistance Plan
- Leak Guard Assurance Process
- Home Theater Soundbar And DVD Player
- 32" LED TV
- One Touch Electric Awning With LED Lights
- 15K BTU Standard Air Conditioning System
- 30 Amp Electrical Service

OPTIONS

- Free-Standing Dinette Table And 4 Chairs

** Mandatory Effective 1/1/2015



CRUSADER

HALF-TON SERIES

LITE



Base Weight - The weight of the unit with no fluids, cargo, optional equipment or accessories.

Carrying Capacity - The amount of weight available for all fluids, cargo, optional equipment and accessories.



SPECIFICATIONS	27RK	28RL	29RS	30BH
Ship Weight	7,602	8,103	8,104	8,519
Carrying Capacity	2,418	1,960	1,874	1,365
Hitch Weight	1,279	1,322	1,237	1,143
Length	31' 11"	31' 10"	31' 11"	33' 7"
Height	11' 6"	11' 6"	11' 6"	11' 6"

DSI QUALITY CIRCLE AWARD WINNER - 2010, 2011, 2012, 2013, 2014

Prime Time Manufacturing is proud to be recognized as an industry leader in value, reliability, and overall quality by the Recreational Vehicle Dealers Association. This was accomplished by committing ourselves to "A Higher Standard" in design, construction, testing, and customer service. Check us out - we know you'll be impressed!



Seal Tech Air Pressure Test



ETERNABOND Construction



Rain Bay



Seek-A-Leak Pressure Test



65 Point Secondary PDI



Web Based
Customer Service



Executive Quality Audits



Advanced Engineering



**FROG™ the Forest
River Owners' Group!**

FREE MEMBERSHIP
to Forest River Owners' Group



Forest River, Inc. encourages our customers to purchase their Forest River products from a local dealership whenever possible for the following reasons:

- 1) Forest River, Inc. dealers are independently owned and operated businesses so priority service and scheduling is at their discretion and is often provided to customers that purchased their unit at that dealership.
- 2) Purchasing locally allows customers to establish meaningful relationships with a dealer, enhancing the RV experience through assistance with product questions, user tips or RV regulations for your state or country, and much more!
- 3) Canadian customers must meet requirements to bring an RV purchased out of the country to their home. These requirements may involve additional inspections and certifications, taxes and fees. Your local Canadian Dealer is a professional at meeting these requirements.
- 4) Scheduling timely warranty repairs and adjustments through a local dealership provides far greater flexibility and convenience to you, the customer!

It is the goal of Forest River, Inc. that all of our RV owners fully enjoy the RV experience and that customer satisfaction meets or exceeds their expectations!

All information contained in this brochure is believed to be accurate at the time of publication. However, during the model year, it may be necessary to make revisions and Forest River, Inc. reserves the right to make all such changes without notice, including prices, colors, materials, equipment and specifications as well as the addition of new models and the discontinuance of models shown in this brochure. Therefore, please consult with your Forest River, Inc. dealer and confirm the existence of any materials, design or specifications that are material to your purchase decision.

©2014 Prime Time Manufacturing

A Division Of Forest River, Inc.,
A Berkshire Hathaway Company.
All Rights Reserved

www.primetimerv.com
PO Box 330 • 55470 CR 1 • Elkhart, IN 46515



HERE'S JUST A SAMPLE OF THE BENEFITS*

- ✓ Mobile Mechanic
- ✓ Free Jump Starts
- ✓ Tire Changes
- ✓ \$2000 Trip Interruption
- ✓ Appointment Assistance
- ✓ Lock Out Service
- ✓ Fuel Delivery
- ✓ Service Assistance
- ✓ Custom Trip Routing and Maps
- ✓ 24 Hour Emergency Messaging

*Exclusions and restrictions apply. See member guide for details.



Learn More
Scan this barcode using a QR Reader on your smart phone to learn more about Forest River.



A Berkshire Hathaway company.

Colton RV
North Tonawanda, NY 14120
(716) 694-0188
(800) 628-4889
www.ColtonRV.com

Colton RV
Orchard Park, NY 14127
(716) 957-3250
(800) 628-4889
www.Coltonrv.com

DEALER