

IMPRESSION



Colton RV & Marine
3122 Niagara Falls Blvd.
North Tonawanda, NY 14120
(716) 694-0188
www.ColtonRV.com

Colton RV
489 Bushkill Plaza LN #9665
Wind Gap, PA 18091
(610) 863-5239
www.ColtonRV.com



IMPRESSIONRV.COM

FLOORPLANS

235RW

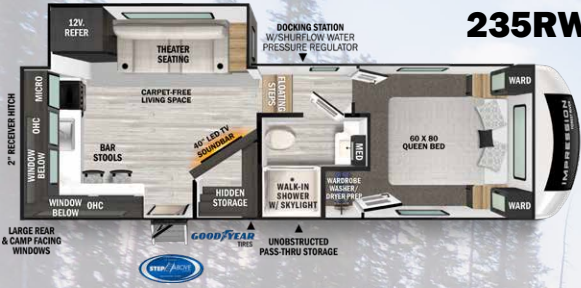

240RE

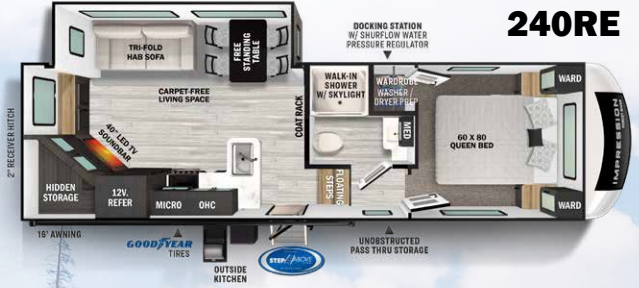

270RK

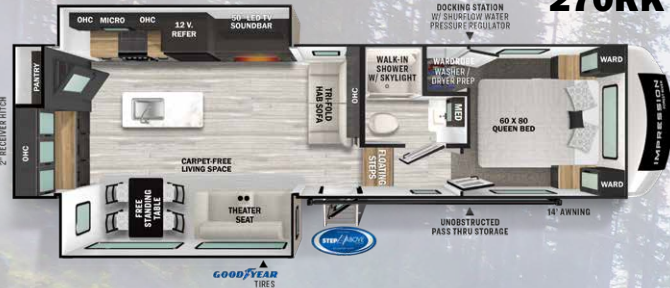

280RL

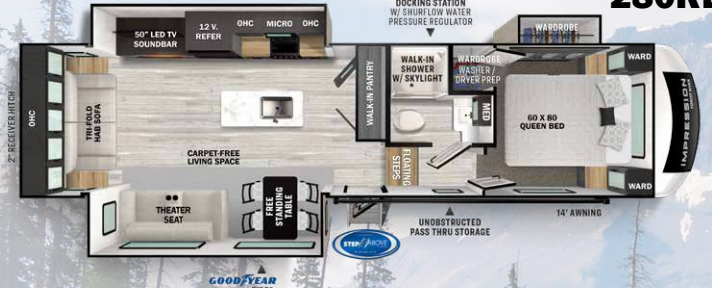

290VB

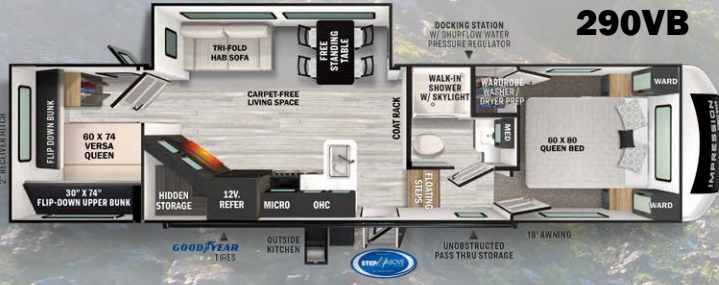

315MB



320FL



315MB



330BH

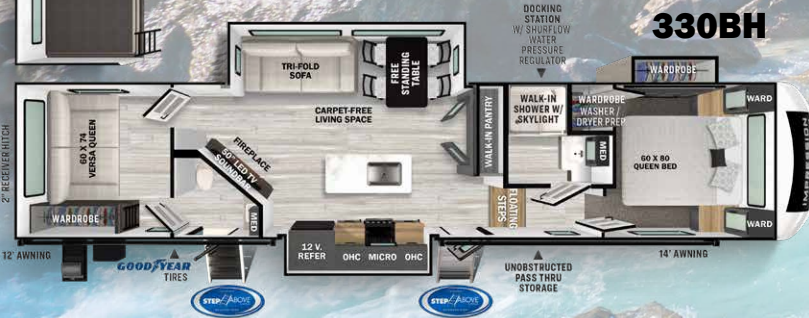

315MB



STANDARDS AND OPTIONS

EXTERIOR FEATURES

- Upgraded E-Rated Goodyear Endurance Tires (Made In the U.S.A.)
- One Touch Automatic Leveling System
- Gel Coat Fiberglass Front Cap with Automotive Windshield & LED Lights
- Shurflo Water Pressure Regulator
- Enclosed Docking Station
- Black Tank Flush, Winterization & Sanitation
- Outside Shower
- Easy Access Water Heater Bypass
- Off Grid Package: 100W Roof Panel, 30AMP Charge Control, Battery
- Step Above Entry Step
- 2" Receiver Hitch with 300 lb. Capacity
- Enclosed Spare Tire & Carrier (Full Size)
- Insulated Exterior Slam Latch Baggage Door
- Battery Disconnect in Pass-Through
- Custom Aluminum Rims
- Marine Grade Outdoor Speakers
- Factory Installed Roof Ladder
- Observation Back Up Camera Prep
- Adjustable Power Awning with LED Lights
- Slide Topper/Awning Prep
- Gas/Electric DSI Water Heater
- 30" Friction Hinge Entry Door
- Detachable Power Cord
- LED Exterior Lighting
- Custom Exterior Graphics Package

INTERIOR FEATURES

- Blackout Curtains & Roller Shades with Reflective Back
- Lumbercore Cabinetry
- Ductless Flooring Throughout for Easy Sweeping
- Centralized Command Center with Built-In Tank Monitoring System
- USB Charging Stations
- WiFi Prep, Digital TV Antenna
- Full Extension Drawer Glides
- Residential Carpet with Stain Guard Protection
- Residential Linoleum
- Flex Pex Plumbing
- Carbon Monoxide/LP Detector
- LED Interior Lighting Throughout

KITCHEN FEATURES

- 10 CU FT 12V Refrigerator
- Glass Recessed Range with Glass Cover
- Glass Microwave with Exhaust Vent
- Residential Backsplash
- Stainless Steel Single Bowl Sink

- High Rise Faucet with Pull-Down Sprayer
- Floor To Ceiling Pantry
- Natural Lighting From Skylight

LIVING ROOM FEATURES

- Carpet-Free Living Space
- Living Room LED TV (50" or 40")
- Electric Fireplace/Space Heater (5,500 Watt Heats up to 400 sq. ft.)
- Soundbar
- Oversized Opening Windows
- Trifold Hide A Bed with Residential Sleep Surface
- Theater Seating with USB Charge Ports (Select Models)
- Free Standing Table w/ 4 Chairs Standard (N/A 235RW, 320FL)
- 2 Barstools (235RW, 320FL)

BATHROOM FEATURES

- Porcelain Foot Flush Toilet
- Walk-In Shower with Skylight
- Anti-Bacterial Shower Door
- Large Medicine Cabinet with Mirror

BEDROOM FEATURES

- Residential Carpet with Stain Guard Protection
- 6'3" Bedroom Height
- 60" x 80" Mattress with Residential Bedspread & Pillows
- Gas Strut Assisted Bed Lift with Storage
- Full Size Stackable Washer/Dryer Prep
- Directional & Closable A/C Vents
- 110 Outlet & 12V Charging Ports Beside Bed
- CPAP Machine Ready
- Cable/Sat Prep

HEATING & COOLING

- Industry Leading 15K A/C Standard
- 35K BTU Furnace
- Maximized A/C Ducting For Best Cooling Efficiency
- 12V Heat Pads For Holding Tanks
- Fully Heated & Enclosed AccessiBelly (Removable Underbelly Panels)

CONSTRUCTION

- "Aluma-Frame" Structure
- Laminated Aluminum Front Wall
- Laminated Aluminum Sidewalls
- Laminated Aluminum Slide Boxes
- Laminated Aluminum Floor
- 5" Truss Rafters 16" OC

- One-Piece Tufflex™ PVC Roofing
- LCI Space Saver Upper Deck™ & LCI Rhino Box™ Frame
- Construction Additional Steel in Upper Deck (Vertical Tubular Frame for Strength, Additional Gussets increase Headroom in Bedroom)
- 100% PDI: Quality Inspection Check Points Throughout the Production Process. Before Any Unit Is Shipped from the Assembly Line to Our Dealer Partners, it Goes Through a Separate Stand-Alone Inspection

PREMIER PACKAGE

- One Touch Automatic Leveling System
- Upgraded E-Rated Goodyear Tires
- Shurflo Water Pressure Regulator
- Floor To Ceiling Pantry
- Oversized Opening Windows
- 10 CU FT 12V Refrigerator
- 2" Receiver Hitch For Storage Rack
- Enclosed Convenient Docking Station
- Gel Coat Fiberglass Front Cap with Automotive Windshield
- "Aluma-Frame" Structure
- LED TV with Soundbar
- Electric Fireplace/Space Heater (5500 Watt Heats up to 400 sq. ft.)

COMFORT PACKAGE

- Superior Insulation with Astrofoil & 12V Tank Heat Pads
- Forced Heat AccessiBelly
- 35K BTU Furnace
- Industry Leading 15K A/C
- 50AMP with 2nd A/C Prep & W/D Prep

OFF GRID PACKAGE

- 30A Charge Controller
- 100W Roof Panel
- Solar on Side Prep
- Battery

OPTIONS

- 2nd 13.5K Ducted A/C
- 8 CU FT Gas/Elec Refrigerator IPO 12V 10 CU FT Refrigerator
- Booth Dinette (N/A 235RW, 320FL)

	235RW	240RE	270RK	280RL	290VB	315MB	320FL	330BH
LENGTH	28' 11"	31' 0"	34' 6"	35' 3"	36' 8"	38' 0"	40' 2"	41' 0"
HEIGHT	13' 2"	13' 2"	13' 2"	13' 2"	13' 2"	13' 2"	13' 4"	13' 4"
HITCH WEIGHT	1,320 LB.	1,350 LB.	1,515 LB.	1,825 LB.	1,730 LB.	1,935 LB.	2,535 LB.	2,165 LB.
UVW	7,110 LB.	8,243 LB.	8,948 LB.	9,549 LB.	8,868 LB.	10,338 LB.	10,303 LB.	10,433 LB.
CCC	4,372 LB.	3,307 LB.	2,767 LB.	2,476 LB.	3,267 LB.	3,597 LB.	4,232 LB.	3,732 LB.
FRESH WATER	57 GAL.	57 GAL.	57 GAL.	57 GAL.	57 GAL.	57 GAL.	57 GAL.	57 GAL.
GREY WATER	60 GAL.	60 GAL.	62 GAL.	60 GAL.	62 GAL.	62 GAL.	60 GAL.	60 GAL.
BLACK WATER	30 GAL.	30 GAL.	30 GAL.	30 GAL.	30 GAL.	30 GAL.	32 GAL.	62 GAL.
AWNING	17'	16'	14'	14'	18'	18'	17'	12' & 14'



Check out the innovative hidden storage behind the entertainment center!



240RE

240RE



PRE-DELIVERY INSPECTION FACILITY

20,000 square feet of quality assurance. The bare essentials for a premium product. This state-of-the-art facility gives immediate daily feedback to production for quality assurance in every unit built.

CUSTOMER SATISFACTION



www.ForestRiverBuyLocal.com

Download our Forest River mobile app or visit our dynamic online manual to enhance your ownership experience. These interactive options provide incredible ease and insight into use, maintenance and enjoyment of your Forest River product.

Ranging from "How-To" videos, pictures and illustrations of various components, systems and features, to fully searchable content and downloadable PDFs for individual component owner's manuals, answers are always just a click away. View the online manual at www.forestriverinc.com/OnlineManual or download our FREE app from the App Store or Google Play!



GVWR (Gross Vehicle Weight Rating) - is the maximum permissible weight of the unit when fully loaded. It includes all weights, inclusive of all fluids, cargo, optional equipment and accessories. For safety and product performance do NOT exceed the GVWR.

GAWR (Gross Axle Weight Rating) - is the maximum permissible weight, including cargo, fluids, optional equipment and accessories that can be safely supported by a combination of all axles.

UVW (Unloaded Vehicle Weight)* - is the typical weight of the unit as manufactured at the factory. It includes all weight at the unit's axle(s) and tongue or pin and LP Gas. The UVW does not include cargo, fresh potable water, additional optional equipment or dealer installed accessories.

CCC (Cargo Carrying Capacity)** - is the amount of weight available for fresh potable water, cargo, additional optional equipment and accessories. CCC is equal to GVWR minus UVW. Available CCC should accommodate fresh potable water (8.3 lbs per gallon). Before filling the fresh water tank, empty black and gray tanks for more cargo capacity.

*Estimated Average based on standard build optional equipment. ** Estimated average based on standard build optional equipment. Values estimated at time of printing.

Each Forest River RV is weighed at the manufacturing facility prior to shipping. A label identifying the unloaded vehicle weight of the actual unit and the cargo carrying capacity is applied to every Forest River RV prior to leaving our facilities. The load capacity of your unit is designated by weight, not by volume, so you cannot necessarily use all available space when loading your unit.

All information contained in this brochure is believed to be accurate at the time of publication. However, during the model year, it may be necessary to make revisions and Forest River, Inc., reserves the right to make all such changes without notice, including prices, colors, materials, equipment and specifications as well as the addition of new models and the discontinuance of models shown in this brochure. Therefore, please consult with your Forest River, Inc., dealer and confirm the existence of any materials, design or specifications that are material to your purchase decision.

©2022 Impression, a division of Forest River Inc., a Berkshire Hathaway company.

FREE MEMBERSHIP
to Forest River Owners' Group

www.forestriverfrog.com



Learn More
Scan this barcode using a QR Reader on your smart phone to learn more about Forest River.



**24/7 EMERGENCY
ROADSIDE ASSISTANCE
WITH VEHICLE PURCHASE***

TOWING
JUMP-STARTS
TIRE CHANGES
FLUID DELIVERY
LOCKOUT
SERVICE

WINCH-OUT
MOBILE MECHANIC
TECHNICAL
SUPPORT
DEALER LOCATOR
SERVICES



*VALID FOR 1 YEAR FROM DATE OF PURCHASE

