

SOLAIRE

BY PALOMINO



SOLAIRE
ULTRA LITE

PASSION + PERFORMANCE + INNOVATION

190 X IN HEATHER



SOLAIRE EXPANDABLES

All new Solaire Expandables represent true quality in the industry with a complete aluminum framed superstructure all floorplans come standard with true queen beds, efficient ride of the torsion axle and a barreled full walk on laminated roof, Palomino has truly hit the target with these 5 remarkable floorplans.

SOLAIRE SEVENS

This sleek yet strong and graceful design allows for easy towability and exceptional rear visibility. Our laminated, crowned roof that's fully walkable and allows for increased interior head room. With interiors designed to make your camping experience a relaxing adventure.

28 QBSS IN TOFFEE



317 BHSK IN HEATHER



SOLAIRE ULTRA LITES

The Ultra Lites are the results of superior design and modernization. Striving to meet all the customer's demand this trailer provides a smooth ride with independent suspension axles, aluminum superstructure frame for light weight towing and barreled ceilings for a more spacious interior.

SOLAIRE WITH ECLIPSE PACKAGE

Our Eclipse package brings additional luxury into our Ultra Lite floorplans. From a fiberglass front cap with LED lighting and Line X® rock guard, frameless windows, aluminum wheels and upgraded Serta Trump® Mattress and several other features we have all the amenities encompassed.

** This package will increase trailer weight by approximately 250 lbs.

267 BHSK IN TOFFEE



190 X IN HEATHER



SOLAIRE EXPANDABLES

Expandables are available in 5 spacious floorplans to meet all the needs of the consumer with both mocha and white fiberglass exterior available.



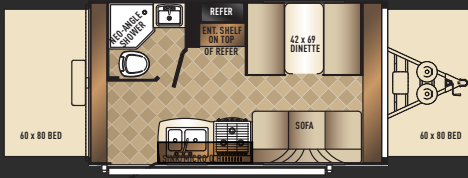

147 X*

WEIGHTS & MEASURES

Hitch Dry Weight	315 lbs.	Exterior Width	8'
Dry Axle Weight	2720 lbs.	Travel Length	18'6"
Total Dry Weight	3011 lbs.	Fresh Water Capacity	32 gals.
GVWR	3815 lbs.	Gray Water Capacity	30 gals.
Interior Height	6'8"	Black Water Capacity	30 gals.
Exterior Height	9'3"	Cargo Carrying Capacity	746 lbs.
Open Length	23' 1"		

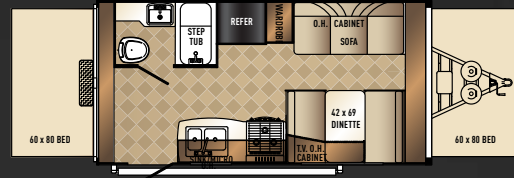

163 X

WEIGHTS & MEASURES

Hitch Dry Weight	400 lbs.	Exterior Width	8'
Dry Axle Weight	3060 lbs.	Travel Length	20'2"
Total Dry Weight	3392 lbs.	Fresh Water Capacity	32 gals.
GVWR	7400 lbs.	Gray Water Capacity	30 gals.
Interior Height	6'8"	Black Water Capacity	30 gals.
Exterior Height	9'3"	Cargo Carrying Capacity	3906 lbs.
Open Length	24' 9"		

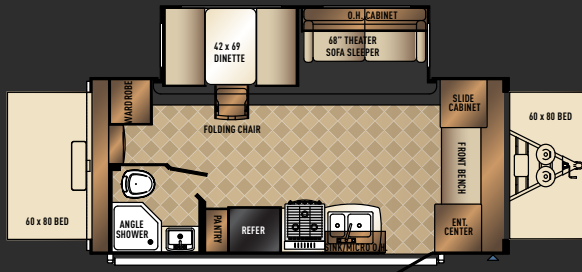

190 X

WEIGHTS & MEASURES

Hitch Dry Weight	620 lbs.	Exterior Width	8'
Dry Axle Weight	3990 lbs.	Travel Length	22'10"
Total Dry Weight	4622 lbs.	Fresh Water Capacity	32 gals.
GVWR	7620 lbs.	Gray Water Capacity	30 gals.
Interior Height	6'8"	Black Water Capacity	30 gals.
Exterior Height	9'3"	Cargo Carrying Capacity	2976 lbs.
Open Length	27' 6"		

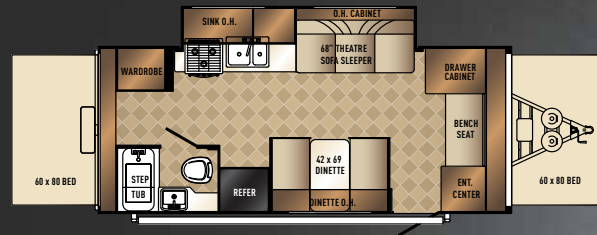

199 X

WEIGHTS & MEASURES

Hitch Dry Weight	485 lbs.	Exterior Width	8'
Dry Axle Weight	3880 lbs.	Travel Length	23'8"
Total Dry Weight	4297 lbs.	Fresh Water Capacity	32 gals.
GVWR	7485 lbs.	Gray Water Capacity	60 gals.
Interior Height	6'8"	Black Water Capacity	30 gals.
Exterior Height	9'3"	Cargo Carrying Capacity	3086 lbs.
Open Length	28' 3"		

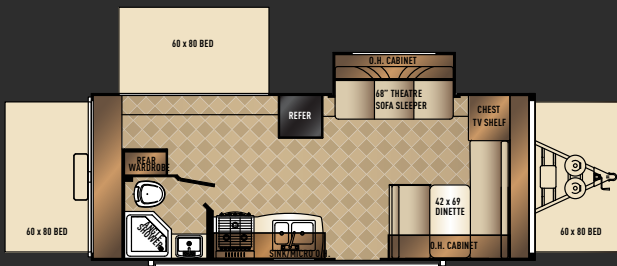

213 X

WEIGHTS & MEASURES

Hitch Dry Weight	605 lbs.	Exterior Width	8'
Dry Axle Weight	3675 lbs.	Travel Length	25'2"
Total Dry Weight	4280 lbs.	Fresh Water Capacity	32 gals.
GVWR	7605 lbs.	Gray Water Capacity	30 gals.
Interior Height	6'8"	Black Water Capacity	30 gals.
Exterior Height	9'3"	Cargo Carrying Capacity	3291 lbs.
Open Length	29' 9"		



190 X IN HEATHER

* 147 X SINGLE AXLE WITH 5 CU. FT. REFRIGERATOR AND NO DUCTED A/C.

ALL EXPANDABLES HAVE A 19" TV OPTION.

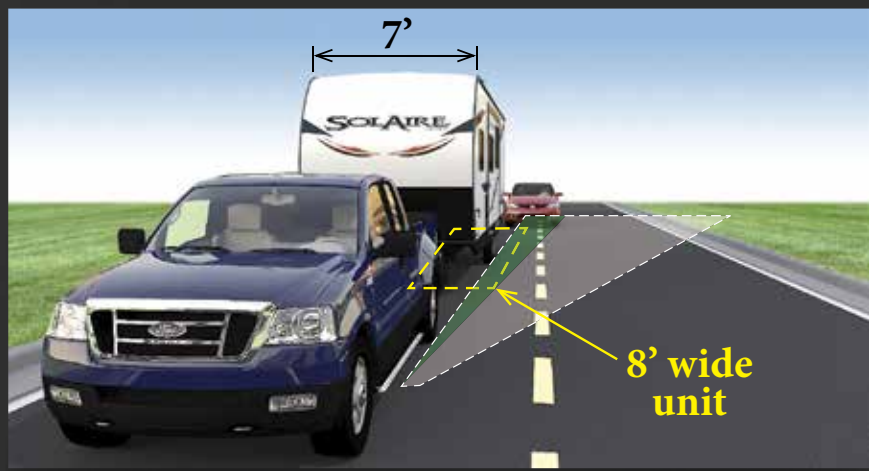
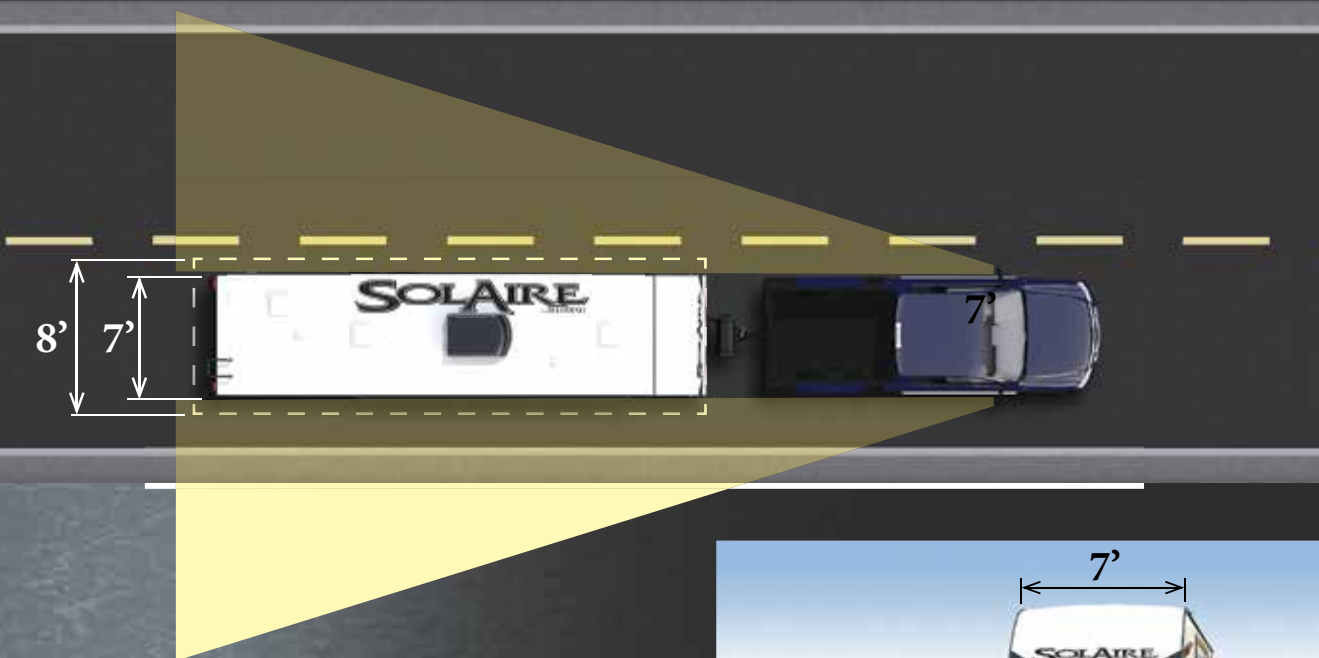

SOLAIRE SEVENS

These innovative 7' wide travel trailers allow for a more aerodynamic towing experience. Suited for all your camping needs and creatively designed to be your home away from home.



28 QBSS IN TOFFEE



Show in toffee interior. Three available floor plans all standard with hard wood cherry cabinetry and LED interior lighting and optional 32" LED TV.

28 QBSS



Show in toffee interior. Three available floor plans all standard with hard wood cherry cabinetry and LED interior lighting and optional 32" LED TV.

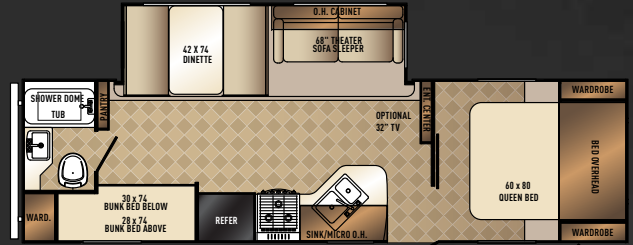

25 BHSS

WEIGHTS & MEASURES

Hitch Dry Weight	545 lbs.	Exterior Width	7'
Dry Axle Weight	4220 lbs.	Travel Length	29'5"
Total Dry Weight	4690 lbs.	Fresh Water Capacity	32 gals.
GVWR	7545 lbs.	Gray Water Capacity	60 gals.
Interior Height	6'6"	Black Water Capacity	30 gals.
Exterior Height	9'3"	Cargo Carrying Capacity	2746 lbs.

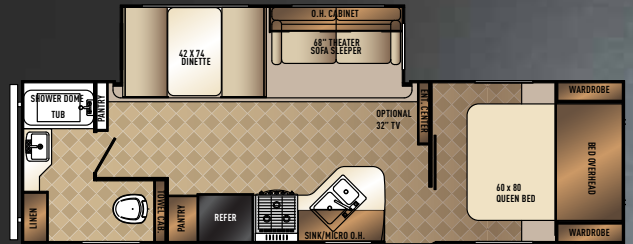

26 RBSS

WEIGHTS & MEASURES

Hitch Dry Weight	570 lbs.	Exterior Width	7'
Dry Axle Weight	4190 lbs.	Travel Length	29'5"
Total Dry Weight	4695 lbs.	Fresh Water Capacity	32 gals.
GVWR	7570 lbs.	Gray Water Capacity	60 gals.
Interior Height	6'6"	Black Water Capacity	30 gals.
Exterior Height	9'3"	Cargo Carrying Capacity	2776 lbs.

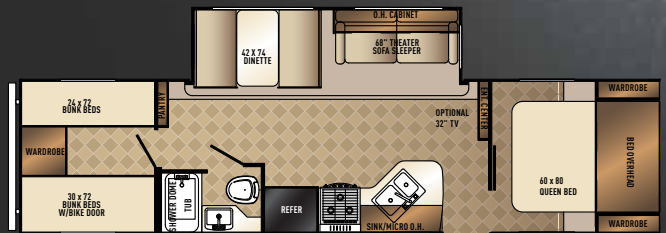

28 QBSS

WEIGHTS & MEASURES

Hitch Dry Weight	610 lbs.	Exterior Width	7'
Dry Axle Weight	4390 lbs.	Travel Length	33'5"
Total Dry Weight	4990 lbs.	Fresh Water Capacity	32 gals.
GVWR	7610 lbs.	Gray Water Capacity	30 gals.
Interior Height	6'6"	Black Water Capacity	30 gals.
Exterior Height	9'3"	Cargo Carrying Capacity	2576 lbs.

317 BHSK IN HEATHER



SOLAIRE ULTRA LITE

Exceptional elegance with all the residential features you could desire. These Ultra Lite travel trailers are light weight with plenty of comforts to make your family camping trips a dream come true.



SOLAIRE ULTRA LITE FLOORPLANS & SPECIFICATIONS

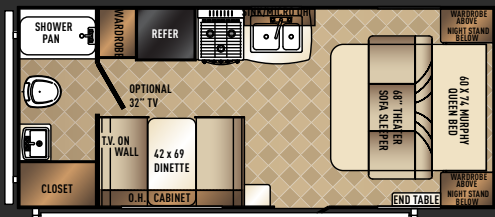

192 RB *

WEIGHTS & MEASURES

Hitch Dry Weight	400 lbs.	Exterior Width	8'
Dry Axle Weight	3390 lbs.	Travel Length	22'7"
Total Dry Weight	3742 lbs.	Fresh Water Capacity	32 gals.
GVWR	7400 lbs.	Gray Water Capacity	30 gals.
Interior Height	6'8"	Black Water Capacity	30 gals.
Exterior Height	9'3"	Cargo Carrying Capacity	3576 lbs.

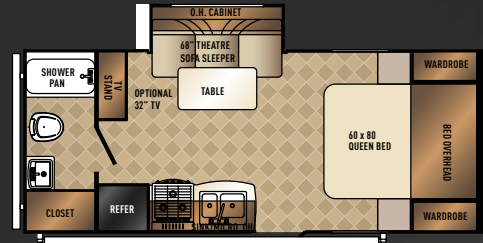

201 SS

WEIGHTS & MEASURES

Hitch Dry Weight	460 lbs.	Exterior Width	8'
Dry Axle Weight	3390 lbs.	Travel Length	23'4"
Total Dry Weight	3826 lbs.	Fresh Water Capacity	32 gals.
GVWR	7460 lbs.	Gray Water Capacity	38 gals.
Interior Height	6'8"	Black Water Capacity	30 gals.
Exterior Height	9'3"	Cargo Carrying Capacity	3576 lbs.

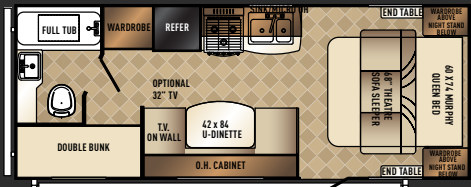

209 BH *

WEIGHTS & MEASURES

Hitch Dry Weight	550 lbs.	Exterior Width	8'
Dry Axle Weight	3325 lbs.	Travel Length	24'5"
Total Dry Weight	3851 lbs.	Fresh Water Capacity	32 gals.
GVWR	7550 lbs.	Gray Water Capacity	30 gals.
Interior Height	6'8"	Black Water Capacity	30 gals.
Exterior Height	9'3"	Cargo Carrying Capacity	3641 lbs.

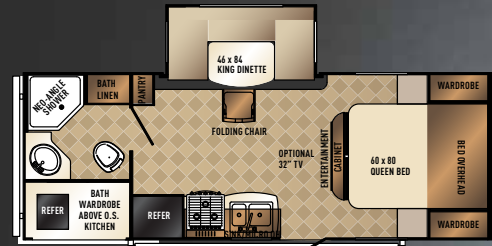

226 RBK

WEIGHTS & MEASURES

Hitch Dry Weight	710 lbs.	Exterior Width	8'
Dry Axle Weight	4305 lbs.	Travel Length	25'10"
Total Dry Weight	4991 lbs.	Fresh Water Capacity	32 gals.
GVWR	7710 lbs.	Gray Water Capacity	76 gals.
Interior Height	6'8"	Black Water Capacity	30 gals.
Exterior Height	9'3"	Cargo Carrying Capacity	2661 lbs.

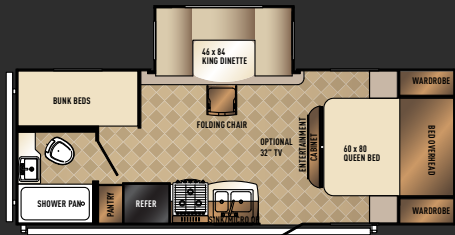

229 BHS

WEIGHTS & MEASURES

Hitch Dry Weight	730 lbs.	Exterior Width	8'
Dry Axle Weight	3985 lbs.	Travel Length	26'1"
Total Dry Weight	4691 lbs.	Fresh Water Capacity	32 gals.
GVWR	7730 lbs.	Gray Water Capacity	76 gals.
Interior Height	6'8"	Black Water Capacity	30 gals.
Exterior Height	9'3"	Cargo Carrying Capacity	2981 lbs.



OUTSIDE KITCHEN

267 BHSK

WEIGHTS & MEASURES

Hitch Dry Weight	885 lbs.	Exterior Width	8'
Dry Axle Weight	4475 lbs.	Travel Length	30'11"
Total Dry Weight	5290 lbs.	Fresh Water Capacity	32 gals.
GVWR	7885 lbs.	Gray Water Capacity	76 gals.
Interior Height	6'8"	Black Water Capacity	38 gals.
Exterior Height	9'3"	Cargo Carrying Capacity	2491 lbs.

* 192 RB & 209 BH HAVE MURPHY BEDS

SOLAIRE ULTRA LITE

FLOORPLANS & SPECIFICATIONS

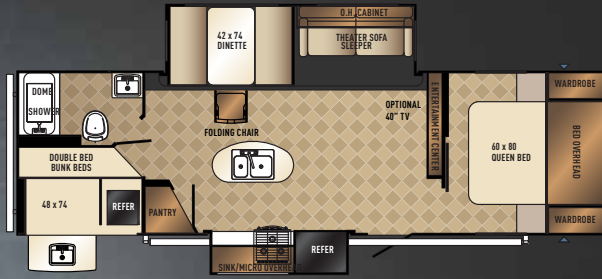

OUTSIDE KITCHEN

269 BHDSK

WEIGHTS & MEASURES

Hitch Dry Weight	955 lbs.	Exterior Width	8'
Dry Axle Weight	4655 lbs.	Travel Length	32'3"
Total Dry Weight	5590 lbs.	Fresh Water Capacity	32 gals.
GVWR	8955 lbs.	Gray Water Capacity	76 gals.
Interior Height	6'8"	Black Water Capacity	38 gals.
Exterior Height	9'3"	Cargo Carrying Capacity	3311 lbs.



OUTSIDE KITCHEN

278 RBK

WEIGHTS & MEASURES

Hitch Dry Weight	645 lbs.	Exterior Width	8'
Dry Axle Weight	4700 lbs.	Travel Length	30'11"
Total Dry Weight	5357 lbs.	Fresh Water Capacity	32 gals.
GVWR	7645 lbs.	Gray Water Capacity	76 gals.
Interior Height	6'8"	Black Water Capacity	30 gals.
Exterior Height	9'3"	Cargo Carrying Capacity	2266 lbs.

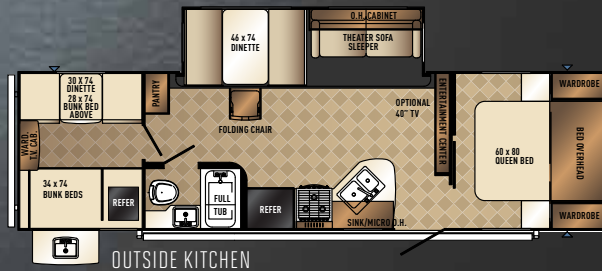

OUTSIDE KITCHEN

292 QBSK

WEIGHTS & MEASURES

Hitch Dry Weight	780 lbs.	Exterior Width	8'
Dry Axle Weight	4955 lbs.	Travel Length	33'3"
Total Dry Weight	5683 lbs.	Fresh Water Capacity	32 gals.
GVWR	7780 lbs.	Gray Water Capacity	38 gals.
Interior Height	6'8"	Black Water Capacity	38 gals.
Exterior Height	9'3"	Cargo Carrying Capacity	2011 lbs.

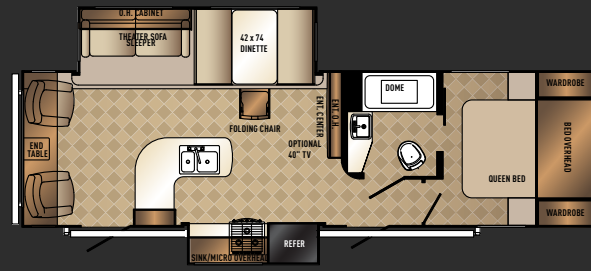

OUTSIDE KITCHEN

297 RLDS

WEIGHTS & MEASURES

Hitch Dry Weight	615 lbs.	Exterior Width	8'
Dry Axle Weight	5275 lbs.	Travel Length	32'9"
Total Dry Weight	5773 lbs.	Fresh Water Capacity	32 gals.
GVWR	8615 lbs.	Gray Water Capacity	76 gals.
Interior Height	6'8"	Black Water Capacity	30 gals.
Exterior Height	9'3"	Cargo Carrying Capacity	2691 lbs.

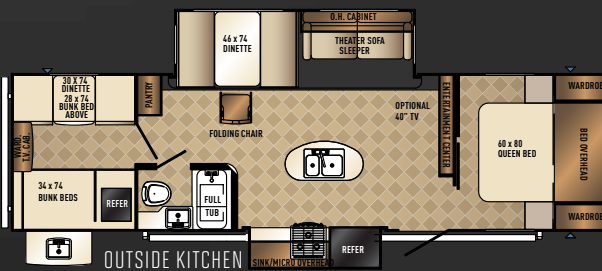

OUTSIDE KITCHEN

307 QBDSK

WEIGHTS & MEASURES

Hitch Dry Weight	835 lbs.	Exterior Width	8'
Dry Axle Weight	5290 lbs.	Travel Length	33'11"
Total Dry Weight	5960 lbs.	Fresh Water Capacity	32 gals.
GVWR	8835 lbs.	Gray Water Capacity	38 gals.
Interior Height	6'8"	Black Water Capacity	38 gals.
Exterior Height	9'3"	Cargo Carrying Capacity	2676 lbs.



OUTSIDE KITCHEN

317 BHSK

WEIGHTS & MEASURES

Hitch Dry Weight	625 lbs.	Exterior Width	8'
Dry Axle Weight	6200 lbs.	Travel Length	35'1"
Total Dry Weight	6726 lbs.	Fresh Water Capacity	32 gals.
GVWR	8625 lbs.	Gray Water Capacity	76 gals.
Interior Height	6'8"	Black Water Capacity	30 gals.
Exterior Height	9'3"	Cargo Carrying Capacity	1766 lbs.

317 BHSK IN TOFFEE



SOLAIRE WITH THE ECLIPSE PACKAGE

Upgrade your Ultra Lite trailer with the quality and durability of our Eclipse package which offers the elements of a fiberglass front cap with LED lights and Line X® rock guard, solid surface counter tops and much more.



SOLAIRE WITH THE ECLIPSE PACKAGE

FLOORPLANS & SPECIFICATIONS

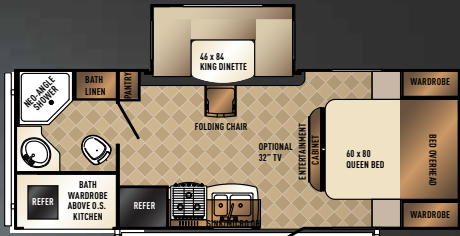

226 RBK

WEIGHTS & MEASURES

Hitch Dry Weight	710 lbs.	Exterior Width	8'
Dry Axle Weight	4305 lbs.	Travel Length	25'10"
Total Dry Weight	4991 lbs.	Fresh Water Capacity	32 gals.
GVWR	7710 lbs.	Gray Water Capacity	76 gals.
Interior Height	6'8"	Black Water Capacity	30 gals.
Exterior Height	9'3"	Cargo Carrying Capacity	2661 lbs.



269 BHDSK

WEIGHTS & MEASURES

Hitch Dry Weight	955 lbs.	Exterior Width	8'
Dry Axle Weight	4655 lbs.	Travel Length	32'3"
Total Dry Weight	5590 lbs.	Fresh Water Capacity	32 gals.
GVWR	8955 lbs.	Gray Water Capacity	76 gals.
Interior Height	6'8"	Black Water Capacity	38 gals.
Exterior Height	9'3"	Cargo Carrying Capacity	3311 lbs.

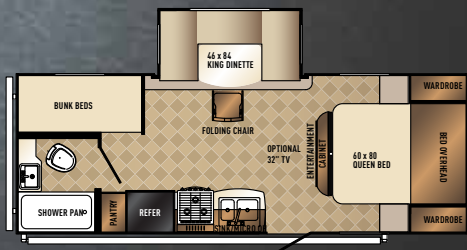

229 BHS

WEIGHTS & MEASURES

Hitch Dry Weight	730 lbs.	Exterior Width	8'
Dry Axle Weight	3985 lbs.	Travel Length	26'1"
Total Dry Weight	4691 lbs.	Fresh Water Capacity	32 gals.
GVWR	7730 lbs.	Gray Water Capacity	76 gals.
Interior Height	6'8"	Black Water Capacity	30 gals.
Exterior Height	9'3"	Cargo Carrying Capacity	2981 lbs.

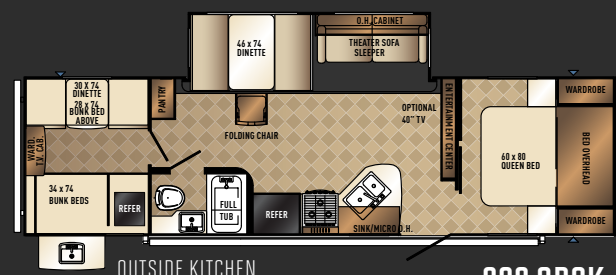

292 QBSK

WEIGHTS & MEASURES

Hitch Dry Weight	780 lbs.	Exterior Width	8'
Dry Axle Weight	4955 lbs.	Travel Length	33'3"
Total Dry Weight	5683 lbs.	Fresh Water Capacity	32 gals.
GVWR	7780 lbs.	Gray Water Capacity	38 gals.
Interior Height	6'8"	Black Water Capacity	38 gals.
Exterior Height	9'3"	Cargo Carrying Capacity	2011 lbs.

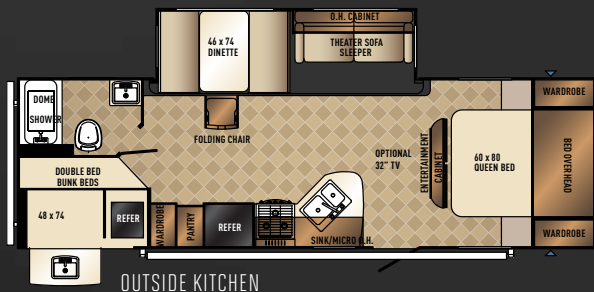

267 BHSK

WEIGHTS & MEASURES

Hitch Dry Weight	885 lbs.	Exterior Width	8'
Dry Axle Weight	4475 lbs.	Travel Length	30'11"
Total Dry Weight	5290 lbs.	Fresh Water Capacity	32 gals.
GVWR	7885 lbs.	Gray Water Capacity	76 gals.
Interior Height	6'8"	Black Water Capacity	38 gals.
Exterior Height	9'3"	Cargo Carrying Capacity	2491 lbs.

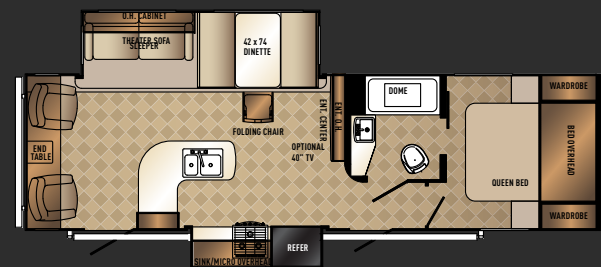

297 RLDS

WEIGHTS & MEASURES

Hitch Dry Weight	615 lbs.	Exterior Width	8'
Dry Axle Weight	5275 lbs.	Travel Length	32'9"
Total Dry Weight	5773 lbs.	Fresh Water Capacity	32 gals.
GVWR	8615 lbs.	Gray Water Capacity	76 gals.
Interior Height	6'8"	Black Water Capacity	30 gals.
Exterior Height	9'3"	Cargo Carrying Capacity	2691 lbs.

ECLIPSE PACKAGE AVAILABLE

1. Residential Style Wood Valances
2. Fiberglass Front Cap w/ LED Lights and Line X® Rock Guard
3. Power Stabilizer Jack Pack [Includes Hitch]
4. Frameless Windows
5. Serta® Trump Metropolitan Mattress
6. Solid Surface Countertops
7. Aluminum Wheels

Note: The Eclipse package will add approximately 250 lbs.



MORTISE AND TENON CHERRY
HARD WOOD CABINET DOORS



CHESTNUT



HEATHER



TOFFEE



INDIGO

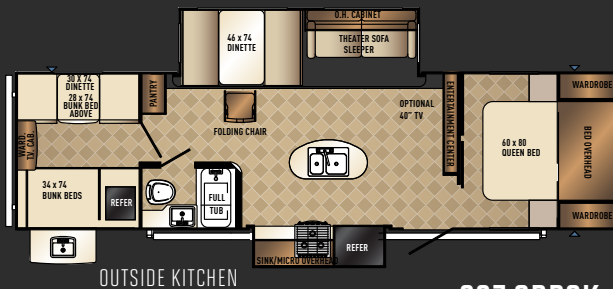

OUTSIDE KITCHEN

307 QBDSK

WEIGHTS & MEASURES

Hitch Dry Weight	835 lbs.	Exterior Width	8'
Dry Axle Weight	5290 lbs.	Travel Length	33'11"
Total Dry Weight	5960 lbs.	Fresh Water Capacity	32 gals.
GVWR	8835 lbs.	Gray Water Capacity	38 gals.
Interior Height	6'8"	Black Water Capacity	38 gals.
Exterior Height	9'3"	Cargo Carrying Capacity	2676 lbs.

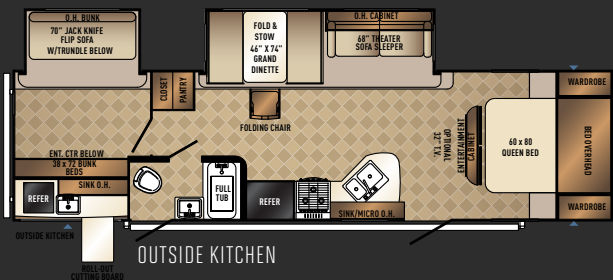

OUTSIDE KITCHEN

317 BHSK

WEIGHTS & MEASURES

Hitch Dry Weight	625 lbs.	Exterior Width	8'
Dry Axle Weight	6200 lbs.	Travel Length	35'1"
Total Dry Weight	6726 lbs.	Fresh Water Capacity	32 gals.
GVWR	8625 lbs.	Gray Water Capacity	76 gals.
Interior Height	6'8"	Black Water Capacity	30 gals.
Exterior Height	9'3"	Cargo Carrying Capacity	1766 lbs.

SOLAIRE ROCK-SOLID CONSTRUCTION



A. Alphasuperflex Membrane

B. Luan Substrate

C. Fiberglass Exterior

D. Luan substrate

E. High density block foam insulation

F. Fiberglass exterior

G. High density block foam insulation

H. Luan substrate

I. Fiberglass front cap w/LED lights and Line X® Rock Guard (Eclipse Package only)

J. Residential Style Carpeting

K. Fully welded aluminum super structure

L. High density block foam insulation

M. Luan substrate – top

N. Luan substrate – bottom

O. Beau Flor® -vinyl flooring

P. Under floor holding tanks

Q. Upgraded aluminum wheels (Eclipse package only)

SOLAIRE POPULAR FEATURES



Swivel TV allows for viewing in both the bedroom and kitchen area of the trailer. Optional TV, sizes vary, see floorplans for available sizes.



Solaires include a standard torsion axle with independent wheel suspension (N/A on Sevens) and includes rubber cushioning to eliminate the metal on metal contact.



Optional Serta Trump® Mattress upgrade – provides a restful sleep with the most advanced 900 coil support system. The superior quality of the Serta Trump® helps provide the luxuries of home in your R.V.



The electric awning with self-contained LED light strip provides quick and easy set-up.

OUR SIDE WALLS HAVE MASSIVE STRENGTH

Vacuum bonded radius roof with vaulted ceiling providing superior insulation and more interior height.



VACUUM-BONDED LAMINATED CONSTRUCTION

Solaire provides a fully 6 sided vacuum-bonded trailer. Our walls, floors, roof, fronts and backs are all built vacuum-bonded to ensure a light weight strong structural trailer.



VOLTED RADIUS ROOF

Structurally engineered materials makes our vacuum-bonded walls some of the strongest in the industry.

SOLAIRE

STANDARDS & OPTIONS

STANDARD FEATURES

- 6 Sided vacuum bonded construction
- Dexter or AL-KO torsion axle (N/A Sevens)
- Laminated full walk on barreled roof
- Full welded aluminum super structure
- Storage tube bumper
- Filon Fiberglass Exterior
- Tinted Safety glass windows
- Outside shower w/hot and cold water
- Beau Flor® - vinyl flooring
- Mortise and Tenon Cherry hard wood cabinet
- Pocket screw lumber core cabinets
- Laminated roof w/ducted A/C (Except 147 X)
- Pleated fabric window shades
- Box valances
- Pantries w/removable shelves and clothes rods

COMMONLY ORDERED OPTIONS

- Aluminum wheels
- Counter top extension (N/A on all floorplans)
- High gloss white fiberglass exterior
- RVQ grill w/ bumper mount (bumper mount N/A on X's)
- Roof Ladder (N/A on X's and 297 RLDS)
- Spare tire, carrier and cover
- LED TV (sizes vary depending on floorplan)
- Solid surface counter tops
- Serta Trump® Mattress Upgrade
- Power front jack
- Power Stabilizer Jacks
- Water Tank Heaters
- Tri-Fold Hide A Bed

• See our website for a complete list of available options



Forest River, Inc. encourages our customers to purchase their Forest River products from a local dealership whenever possible for the following reasons:

- 1) Forest River, Inc. dealers are independently owned and operated businesses so priority service and scheduling is at their discretion and is often provided to customers that purchased their unit at that dealership.
- 2) Purchasing locally allows customers to establish meaningful relationships with a dealer, enhancing the RV experience through assistance with product questions, user tips or RV regulations for your state or country, and much more!
- 3) Canadian customers must meet requirements to bring an RV purchased out of the country to their home. These requirements may involve additional inspections and certifications, taxes and fees. Your local Canadian Dealer is a professional at meeting these requirements.
- 4) Scheduling timely warranty repairs and adjustments through a local dealership provides far greater flexibility and convenience to you, the customer!

It is the goal of Forest River, Inc. that all of our RV owners fully enjoy the RV experience and that customer satisfaction meets or exceeds their expectations!



PRE-DELIVERY INSPECTION FACILITY

20,000 square feet of quality assurance. The bare essentials for a premium product. This state-of-the-art facility gives immediate daily feedback to production for quality assurance in every unit built.



FREE MEMBERSHIP
to Forest River Owners' Group

www.forestriverfrog.com



Colton RV
North Tonawanda, NY 14120
(716) 694-0188
(800) 628-4889
www.ColtonRV.com

SOLAIRE DEALER
Colton RV
Orchard Park, NY 14127
(716) 957-3250
(800) 628-4889
www.Coltonrv.com



Learn More
Scan this barcode using a QR Reader on your smart phone to learn more about Forest River.



A Berkshire Hathaway company.



PALOMINO RV
1047 East M-86 | Colon, MI 49040
P: 269.432.3271 | F: 269.32.2516
www.palominorv.com