

SPORTSMEN®



Fifth Wheels & Travel Trailers



Sportsmen features all the amenities of home including glazed hardwood cabinet doors, residential furniture, island kitchen floor plans and 82" interior height.

S3301K

Harvest Décor with Prestige Walnut
(optional table and chairs shown)



S330IK



S330IK



Designed for extended camping, the Sportsmen S330IK has the following amenities: residential 48" shower with sliding glass door, wardrobe slide and designer padded headboard.



S330IK



S302BH
 Brindle Décor with
 Prestige Walnut

Sportsmen floor plans are developed for today's camping family. These family friendly floor plans like the S302BH boast double wood doors to the master bedroom, panoramic view windows in the slide out and large kitchen featuring a high rise faucet and deep double sink.



S302BH Sportsmen 302BH includes two double Teddy Bear bunk mats.



S302BH Designer padded headboard is handcrafted by our in-house sewing department.

The large U-Shaped dinette easy converts into additional double bed for additional sleeping.



The bathroom features a multi-shelved tub/shower and a second entry door conveniently located to accommodate outdoor access.

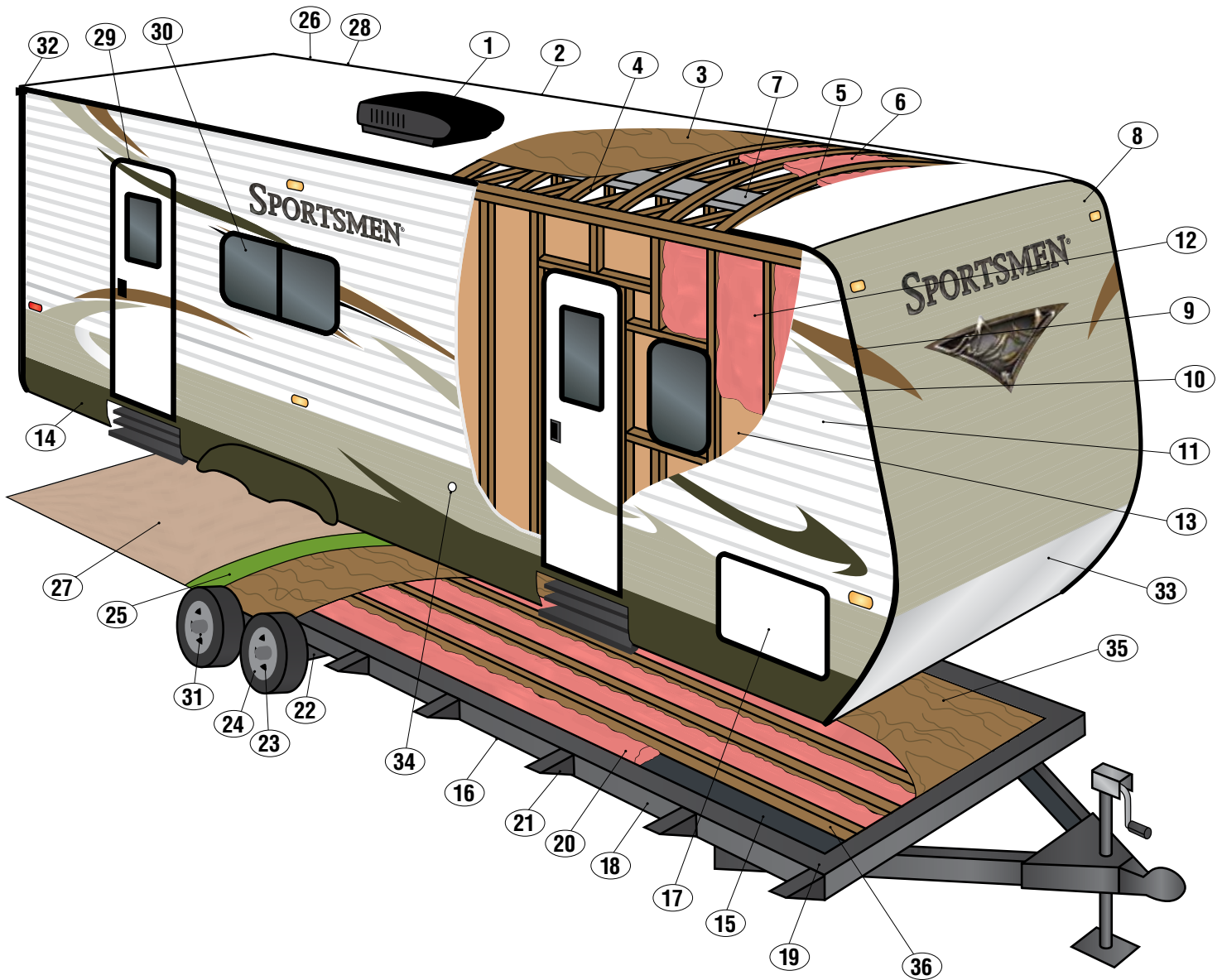

- | | | |
|--|--|---|
| 1 13,500 BTU A/C | 13 Decorative Luan Wall Board | 25 Residential Style Carpet Pad |
| 2 Seamless 1-Piece Roof with SuperFlex Roofing Material | 14 Exterior Brake Lights | 26 Rack and Pinion Electric Slide with Manual Override |
| 3 3/8" Decking | 15 Darco® Moisture Barrier Underbelly | 27 Residential Carpet or Linoleum |
| 4 Vinyl Interior Ceiling Panel | 16 Enclosed Underbelly with Heated Freshwater Tank | 28 Triple Sealed Slide Outs |
| 5 4 1/2" Wood Truss Rafters, 16" O.C. | 17 Extra-Large Radius Exterior Baggage Doors | 29 Radius Entrance Door |
| 6 R-7 Batten Insulation | 18 Heavy Duty I-beam Frame Construction | 30 Tinted Windows |
| 7 Insulated Ductwork | 19 Norco/BAL Huck Bolted Frame (E-Coated) and A-Frame (Epoxy Painted) | 31 Easy-Lube Axles |
| 8 Exterior Clearance Lights | 20 R-7 Batten Insulation | 32 Extra Long Drip Spouts |
| 9 2x2 Wood Frame Front and End Walls | 21 Fully Welded Out Riggers | 33 Diamond Plate Front Plate Rock Guard |
| 10 2x2 Wood Studs, 16" O.C. | 22 Heavy Duty Leaf Spring Axles | 34 Cable Hook Up |
| 11 Extra-Thick .024 Metal Siding | 23 Self-Adjust Electric Brakes | 35 Plywood Floors |
| 12 R-7 Batten Insulation | 24 Heavy Duty Steel Wheels | 36 Floor Joists, 16" O.C. |

Travel Trailers

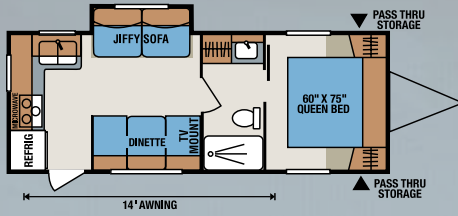

S241RKS

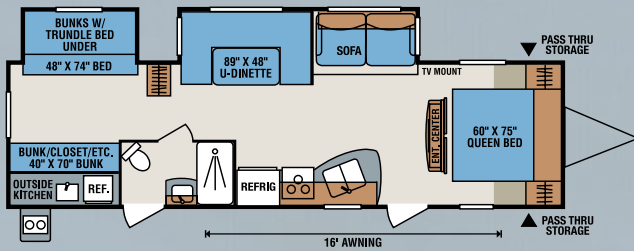

S322BHK

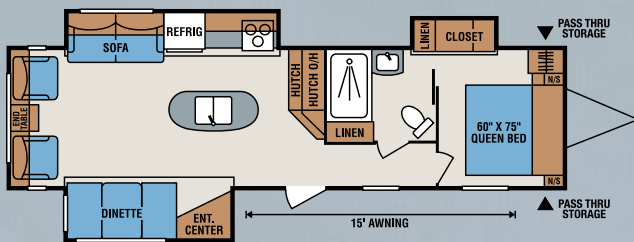

S330IK

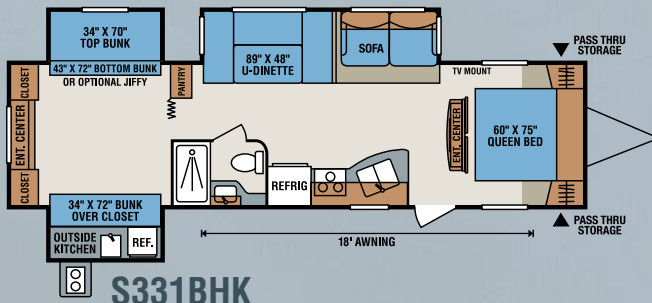

S331BHK

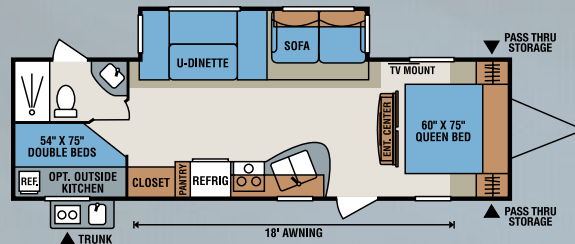

S302BH

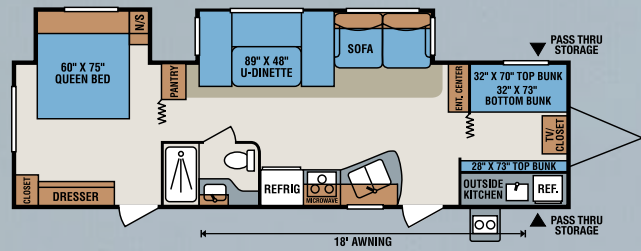

S330BHK

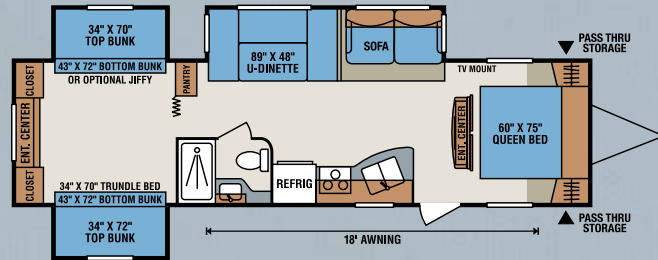

S331BH

Travel Trailers	S241RKS	S302BH	S322BHK	S330BHK	S330IK	S331BH	S331BHK
UVW (Unloaded Vehicle Weight) *	4,575	6,280	7,060	7,210	7,690	7,550	7,680
Dry Hitch Weight*	502	760	600	950	890	760	700
Dry Axle Weight*	4,073	5,520	6,460	6,260	6,800	6,790	6,980
NCC (Net Carrying Capacity)	1,425	1,720	1,740	1,590	1,110	1,250	1,120
GVWR	6,000	8,000	8,800	8,800	8,800	8,800	8,800
Interior Height	78"	82"	82"	82"	82"	82"	82"
Exterior Height w/ A/C	10' 1"	11' 4"	11' 2"	11' 1"	10' 11"	11' 4"	11' 4"
Exterior Width	96"	96"	96"	96"	96"	96"	96"
Exterior Length	26'	32' 6"	34' 5"	35' 2"	35' 6"	35' 6"	35' 6"
Refrigerator (cu. feet)	5	5	5	5	5	5	5
Water Heater Cap. (gal. G/E w/DSI)	6	6	6	6	6	6	6
Fresh Water Cap. (gal.)	38	38	40	38	40	38	38
Waste Water Cap. (gal.)	32	32	32	32	32	32	32
Gray Water Cap. (gal.)	32	32	32	47	32	32	32
LP Gas Cap. (lbs.)	40	40	40	40	40	40	40
Furnace BTUs (1,000s)	20	30	30	30	30	30	30
Tire Size	14"	15"	15"	15"	15"	15"	15"
Awning	14'	18'	16'	18'	15'	16'	16'

*This weight reflects the rolling average unit weight for each model. Your trailer weight will vary according to optional equipment.

Fifth Wheels

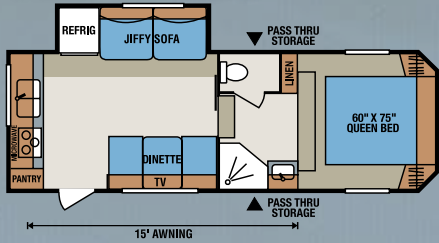

S235RK

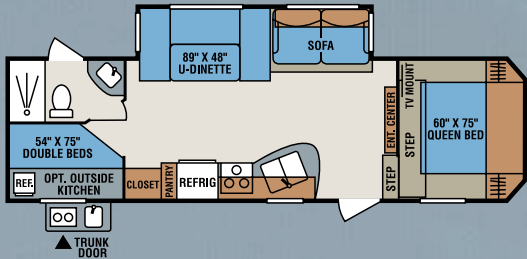

S266BH

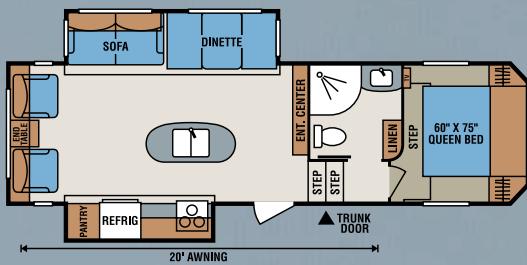

S285IK

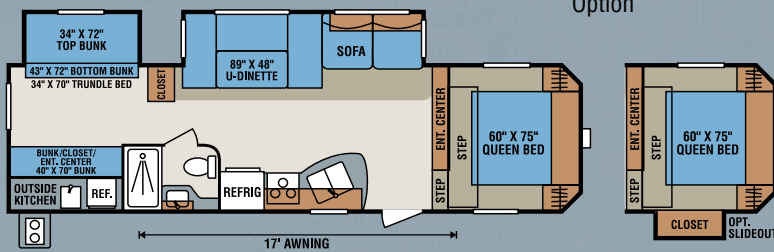

S315BHK

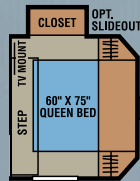

S266BH
Closet Slideout Option



S285IK
Closet Slideout Option

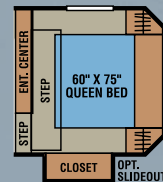

S315BHK
Closet Slideout Opt.

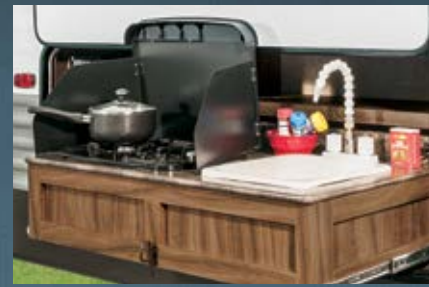

Optional pull-out kitchen drawer features 2-burner cooktop, refrigerator and faucet with sink.



2-30#LP tanks with auto-change over and easy view propane tank cover.



The exterior features gutters along each side and an extended downspout.



Optional power lighted tongue jack has a leveling bubble on top.



Optional Multi-directional LED power lighted awning.

Fifth Wheels	S235RK	S266BH	S285IK	S315BHK
UVW (Unloaded Vehicle Weight) *	5,925	7,130	7,540	7,830
Dry Hitch Weight*	860	1,440	1,210	1,420
Dry Axle Weight*	5,065	5,690	6,330	6,410
NCC (Net Carrying Capacity)	1,075	1,670	1,260	970
GVWR	7,000	8,800	8,800	8,800
Interior Height	90"	92"	92"	91"
Exterior Height w/ A/C	11' 8"	12' 4"	12' 7"	11' 11"
Exterior Width	96"	96"	96"	96"
Exterior Length	25' 3"	30'	30' 9"	33' 1"
Refrigerator (cu. feet)	5	5	5	5
Water Heater Cap. (gal. G/E w/DSI)	6	6	6	6
Fresh Water Cap. (gal.)	38	40	38	38
Waste Water Cap. (gal.)	57	32	32	32
Gray Water Cap. (gal.)	89	32	32	32
LP Gas Cap. (lbs.)	40	40	40	40
Furnace BTUs (1,000s)	25	25	30	30
Tire Size	14"	15"	15"	15"
Awning	15'	14'	20'	17'

*This weight reflects the rolling average unit weight for each model. Your trailer weight will vary according to optional equipment.



Brindle Décor



Cocoa Décor



Harvest Décor



PrestigeWalnut

Standards

- 3/8" Fully Walk On Roof Decking
- 1 Piece Seamless Roof with SuperFlex Roofing Material
- 3 Burner Cook Top
- 5 Cubic Foot Refrigerator
- 6 Gallon Gas DSI Water Heater
- 20 lb. Gas Bottles
- 30 Amp Service
- 13,500 BTU A/C
- Acrylic Sink
- AM/FM CD Player
- Awning with Drip Rail and Spouts
- Built-In Medicine Cabinet with Mirror in Bath
- Cable Hook Up
- Cotton Cloud Deep Quilt Mattress
- Custom Wall Border
- Decorative Kitchen Backsplash
- Decorative Light Above Dinette in Slide-Out
- Decorative Pillows on Jiffy Sofa (Where Available)
- Diamond Plate Rock Guard on Front of Travel Trailers
- Enclosed Pin Box on Fifth Wheels
- Enclosed Underbelly
- Heated Fresh Water Tank

- Large Overhead Cabinets
- Linoleum From Front to Rear
- Microwave with Turntable
- Mini Blinds
- Monitor Panel
- New Aerodynamic Front Profile
- Norco/BAL Huck Bolted Frame (E-Coated) and A-Frame (Epoxy Painted)
- Padded Headboard
- Patio Door Light
- Power Vent in Bath
- Radius Entry Door
- Range Hood with 12V Light and Exhaust Fan
- Rear Bumper with Sewer Hose Storage
- Reversible Quilted Comforter
- Roller Ball Bearing Drawer Guides
- Roof Vent in Main Bedroom
- Self-Adjust Electric Brakes
- Sink Cover
- Smooth Screwless Baggage Doors
- Solid Wood Framed Mortise and Tenon Glazed Cabinet Doors
- Tinted Windows
- Tub Surround
- TV Antenna with Booster

Options

- 8 Cubic Foot Refrigerator
- 32" LCD TV (Floorplan Dependent)
- 39" LCD TV (Floorplan Dependent)
- 15,000 BTU A/C Upgrade
- Bunk Ladder and Railing (Where Available)
- Closet Slide (S266BH, S285IK and S315BHK Only)
- Cotton Cloud Gel Foam Mattress Upgrade
- Deluxe Sleeper Sofa
- Fiberglass on Fifth Wheels (Forced Option)
- Flip Up Bike Rack/Tray (Adds 8')
- Jiffy in Bunk Slide (S331BH ODS)
- Ladder
- Maxxair® Vent Fan (Bedroom or Living Room)
- Night Shades
- Outside Grill
- Outside Kitchen (S266BH and S302BH Only)
- Recliner – 1 or 2
- Table and Chairs with Leaf
- Wired for 2nd A/C with 50 Amp Service

Standard Run Package

- 2 Exterior Speakers
- 2/4 Stabilizer Jacks
- 6 Cubic Foot Refrigerator
- 30# Gas Bottle with Cover
- AM/FM/CD Player
- Assist Grab Handle
- Gas/Electric DSI Water Heater
- Outside Shower (N/A with Outside Kitchen)
- Oven
- Skylight Over Tub
- Windows at End of Slideout (Where Available)
- Winter Bypass Kit

Touring Package

- Black Tank Flush
- Multi-Directional Lighted Power Awning
- Power Tongue Jack
- Spare Tire/Carrier/Cover
- Stereo with DVD Player



Dealer Satisfaction Index: Ratings of manufacturers, by dealers, have consistently awarded KZ top honors for excellence of design, reliability, overall quality and value, communications and dealer support.



Dealer:
Colton RV & Marine
3122 Niagara Falls Blvd.
North Tonawanda, NY 14120
(716) 694-0188
www.ColtonRV.com

Colton RV
489 Bushkill Plaza LN #9665
Wind Gap, PA 18091
(610) 863-5239
www.ColtonRV.com

ASK ABOUT OUR 2-YEAR LIMITED WARRANTY!



Join our Family Forum at
www.kzfamilyforum.com

For more product details and in-depth information, visit us at www.kz-rv.com |



985 N 900 W • Shipshewana, IN 46565
E-mail kz@kz-rv.com • www.kz-rv.com



Due to continual research and advances, manufacturer reserves the right to change specifications, design, price and equipment without notice, and assumes no responsibility for any error in this literature. Some items shown are not included as standard or optional equipment. ©2014KZ | 9/8/14 | 1.5M