

# Salem

Welcome to the Original Social Networking Site



Salem





Salem 100%

# 27DBUD

Family Friendly Towable Unit

SHOWN IN CAMEL

Family Friendly Towable Unit. Your family will love exploring new places in this premium and spacious model. Enjoy the comfort and convenience at an unmatched price!

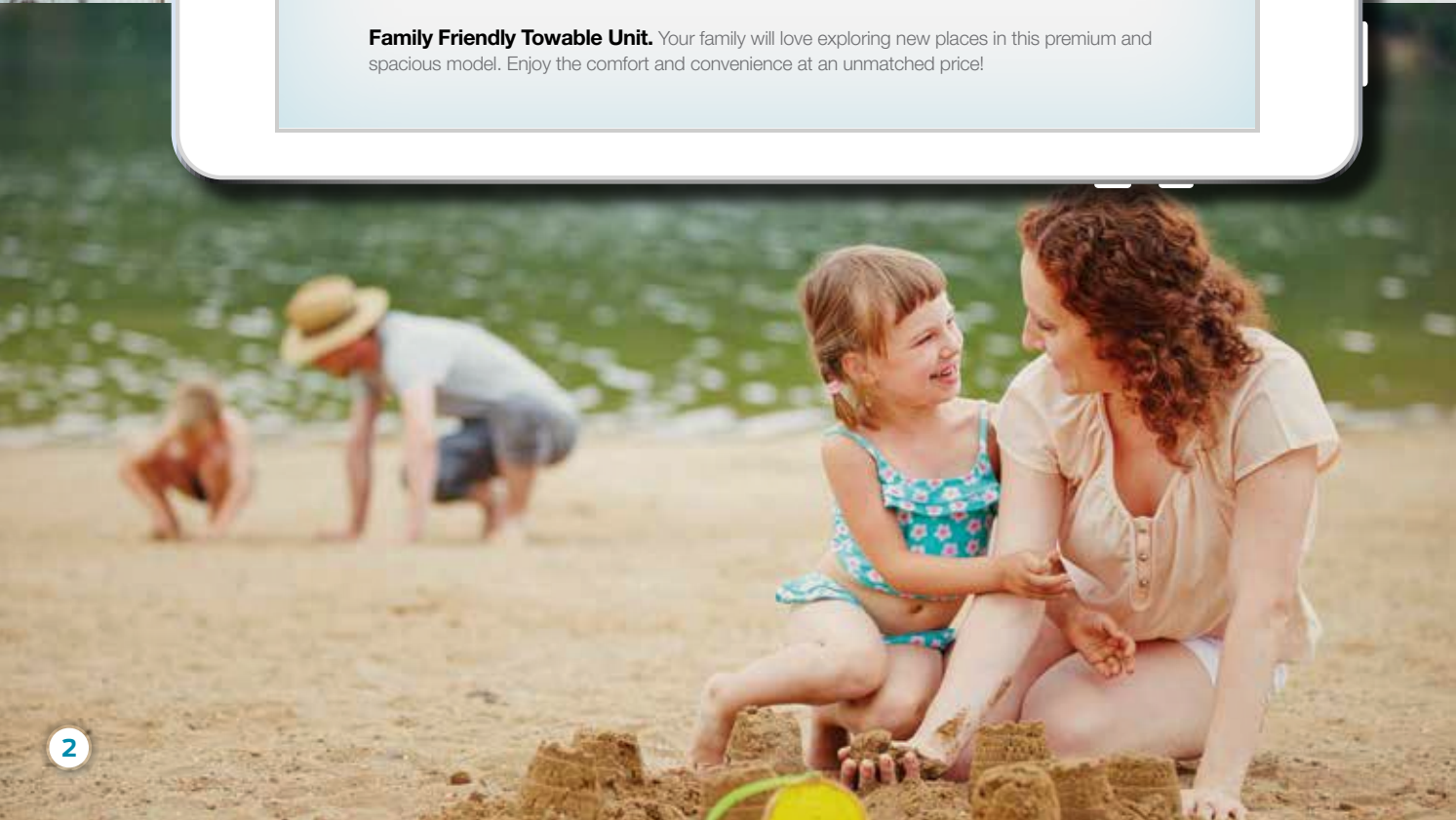











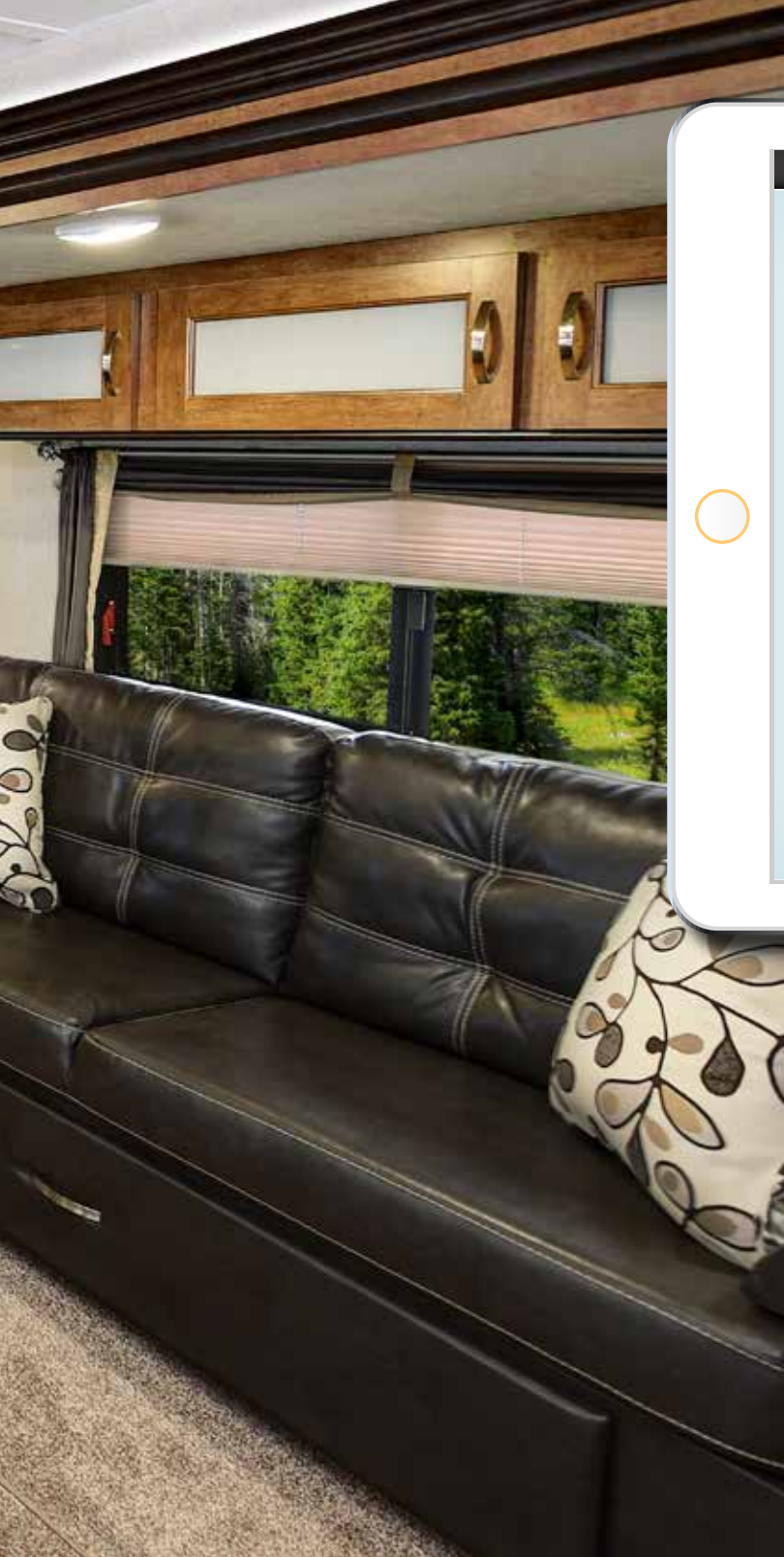

Salem 100%

# 27RKSS

Our Most Popular Single Bedroom Unit

SHOWN IN MINERAL

The floor plan diagram for the 27RKSS RV model shows a layout with a front dinette (DINETTE) and sofa (SOFA) area with overhead cabinets (OHC) and carpeting. A central living area features a linoleum floor with two chairs (CHAIR) and an end table (END TABLE). The kitchen area includes a pantry (PANTRY), refrigerator (REF), and optional camp kitchen (OPT CAMP KITCHEN). The bathroom (BATH) has a radius shower (RADIUS SHOWER) and a medicine cabinet (MED CAB). The sleeping quarters (WARD) feature a queen bed (QUEEN BED) and wardrobes (WARD) with pass-thru storage (PASS THRU STORAGE) on both ends. An entry (ENTRY) is located at the front of the bedroom area.

**Years Ahead Of The Competition.** This model combines the versatility of both travelling and the seasonal destination RV lifestyle. It offers some of the most comfortable standard recliners available in this price range, along with optional Solid Surface Countertops, LED lighting, Power Awnings and more.





Salem 100%

# 30KQBSS

Spacious Family Unit

SHOWN IN MINERAL

**Large Scale Towable Convenience.** What amenities would you like for your family? This has it all, such as a massive room for children or guests with tremendous storage, TV hookups, and tons of sleeping room. With your choice of an outside kitchen, or an additional bunk (T30QBSS – it's sister model), the versatility and convenience of this beautiful trailer is unparalleled.







SHOWN WITH CUSTOMER-SUPPLIED TV





Night Shades

Decorative  
Curtain Rods  
and Curtains

LED Lights

Dhalia Cherry Mouldings and  
Accents Throughout

**80"**  
CEILING  
HEIGHT

16 x 24 Residential Style Cabinets  
with Glass Inserts and Base  
Shelves (Where applicable)

LG® Solid Surface Countertops

Stainless Steel  
Appliance Package

Standard Plush Recliners

Beauflor® Linoleum  
Scratch, Tear, and Cold,  
Crack Resistant Flooring

Full Extension, Extra-Deep  
Pot and Pan Drawer

# Interior Features

SOME FEATURES SHOWN HAVE LIMITED AVAILABILITY.



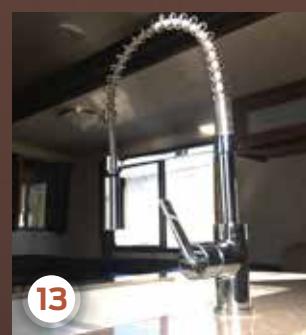

# Salem Popular Features

## MORE REASONS WHY PEOPLE CHOOSE SALEM

1. Over Slide LED Accent Lighting (Limited Time Options\*)
2. Full Extension Ball Bearing Drawer Guides
3. Shoe Nook (Most Models)
4. Colored LED Awning Lights w/ Remote (Limited Time Options\*)
5. Blue LED undercarriage lighting (Limited Time Options\*)
6. Extra Large Pass-Through Storage
7. Bluetooth Stereo with DVD, FM, & CD (Limited Time Options\*)
8. New Deluxe Entertainment Center With Residential Entry Into Master Bedroom. Where applicable (Shown with customer supplied TV)
9. Beauflor® One Piece Plank Wood Linoleum Flooring
10. Copper Vein Weatherproof Countertop on Outside Kitchen (Outside Kitchen Models Only)
11. Solid Surface Countertops (Limited Time Options\*)
12. Hinged 1/2 Barrel Storage (Most Models)
13. High Rise Spring Faucet
14. Optional 10.7 cu. ft. Whirlpool® Refrigerator with Power Inverter

\* See your dealer for more details about our Limited Time Options



# Construction Build to Last.

- 1 Radius entry Steps
- 2 2" x 3" floor joists 12" on center
- 3 2" wall studs 16" or less on center
- 4 30" fiberglass radius entry door
- 5 .024 aluminum siding
- 6 5" bowed truss roof rafters
- 7 One piece seamless roof (12 yr. warranty)
- 8 R-7 fiberglass insulation throughout
- 9 Extra large full pass-thru storage
- 10 Smooth rolled skirting
- 11 In floor ducted heat
- 12 Diamond plate rockguard
- 13 3/8" roof decking (full walk-on roof)
- 14 LP bottle cover w/ easy access
- 15 13.5K ducted roof, high output AC w/ quick cool
- 16 Stain resistant carpet
- 17 One piece plank wood look linoleum flooring
- 18 Safety glass windows
- 19 Hitch Light
- 20 Aluminum radius front corners



- 21 A/C ducts
- 22 "Darco" anti-puncture underbelly wrap
- 23 5/8" Tongue and Groove Plywood Floor Decking

## FUNCTIONAL, QUALITY STANDARDS

At Salem your satisfaction is serious business and it shows. Our commitment to your satisfaction includes:

- A: 5/8" Tongue and Groove Plywood Flooring System
- B: Heated and enclosed fresh water tank
- C: 6 gallon GE DSI water heater with Quick Recovery
- D: Central Switch Command Center (Most Floorplans)





# Salem Standards & Options



## CONSTRUCTION & EXTERIOR

- Full walk on one-piece Superflex® roof w/ 12 year warranty
- Extra large full pass through storage (per floorplan)
- Cold crack and mildew resistant vinyl patio awning
- Safety glass windows
- Steel framed 30" smooth radius fiberglass main entry door
- Cambered chassis
- Enclosed fresh water tank in a heated compartment
- 16-gal. per hour GE quick recovery DSI water heater
- Water heater by-pass
- 2" wall construction 16" (or less) on center
- R-7 fiberglass insulation throughout
- 13 ply cross micro-laminated beam header above slide outs
- Triple seal slide outs
- Electric slide out systems (flush floor)
- Swing arm entry assist handle
- Two marine grade exterior speakers
- Radial tires

## KITCHEN

- Dometic® double door refrigerator (2 yr. warranty)
- High rise faucet
- **NEW Deep basin** residential style sink
- Microwave w/ carousel
- 3-Burner, high output range with oven (2 yr. warranty)
- Range hood w/ 12-volt exhaust fan and light (Exhausted through to the exterior)

- 5/8" exterior grade tongue and groove plywood floor decking (Not OSB)
- Beauflor® One piece plank wood linoleum flooring
- Solid wood drawers
- Knife rack (behind cook top)
- Large overhead cabinets w/ glass inserts
- Central switch command center
- Nickel finished hardware
- Full extension ball bearing drawer guides
- Abundant cabinet storage
- Hinged 1/2 barrel storage (Some models)

## LIVING ROOM

- 80" interior height travel trailers
- Ducted 13,500 BTU high output roof air conditioner w/ quick cool
- Huge storage drawer at sofa base
- Extra large booth dinette w/ large drawer (most models)
- Large dinette picture window
- Digital TV antenna and booster
- Cable TV/ satellite hook-up
- **NEW Blue tooth stereo** with DVD/CD, and 4 cube speakers (limited time option)
- 25K BTU Suburban® forced air DSI furnace w/ digital thermostat (2 yr. warranty)
- In-floor ducted heat

## BEDROOM

- Residential bed mattress
- Plush designer comforter
- Strut lifted storage area under bed
- Bedside 110-volt power outlets (2)
- Residential swing bedroom privacy doors (some models)
- Storage shelf above bed

## BATHROOM

- 12-volt power bath roof exhaust vent
- Wooden medicine cabinet w/ mirrored door
- Foot flush toilet
- Tooth brush holder and towel ring
- Vinyl tub surround
- Frosted glass barrel shower with tub surround (27REI, 27RLSS, 27RKSS, 28RLDS, 29FKBS, 29RLW, 29RKSS, 31BKIS, 36BHBS, 37BHSS2Q)

## SECURITY AND SAFETY

- LP leak detector
- Smoke detector
- Carbon monoxide detector
- Fire extinguisher
- Hitch light
- Welded heavy duty safety chains
- Electric brakes (all wheels)
- GFI receptacles
- ANSI 119.2 certified
- Meets all national highway administration specifications

## SALEM OPTIONS

- 4 Stabilizer jacks
- Spare tire and carrier
- 15K Ducted A/C with Quick Cool Feature
- Skylight over tub
- 30-lb LP bottles w/ cover and auto change over
- Optional 10.7 cu. ft. Whirlpool® Refrigerator with Power Inverter

Contact your Salem dealer for a complete list of options.



# Salem Travel Trailers

FLOORPLANS, WEIGHTS & MEASURES

## 26TBUD

UNLOADED  
VEHICLE WEIGHT:  
**5730**

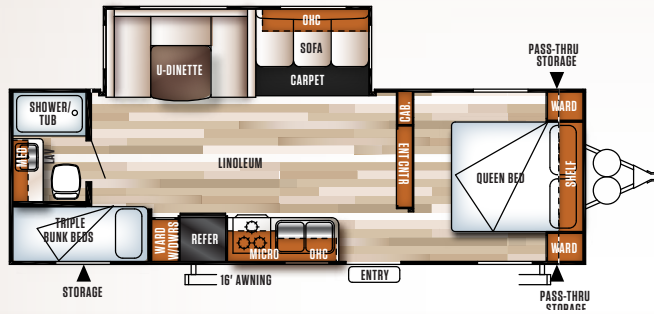

## 27DBK

UNLOADED  
VEHICLE WEIGHT:  
**6380**

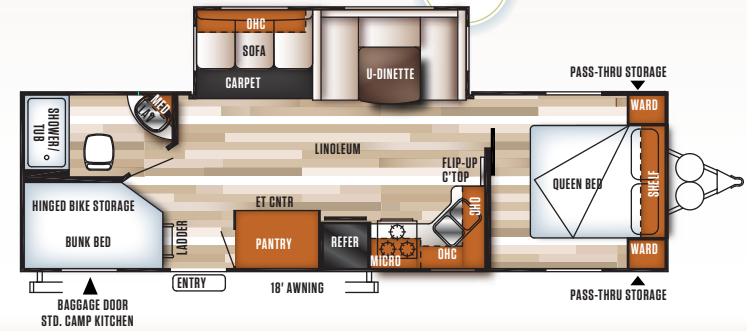

NEW

## 27DBUD

UNLOADED  
VEHICLE WEIGHT:  
**6140**

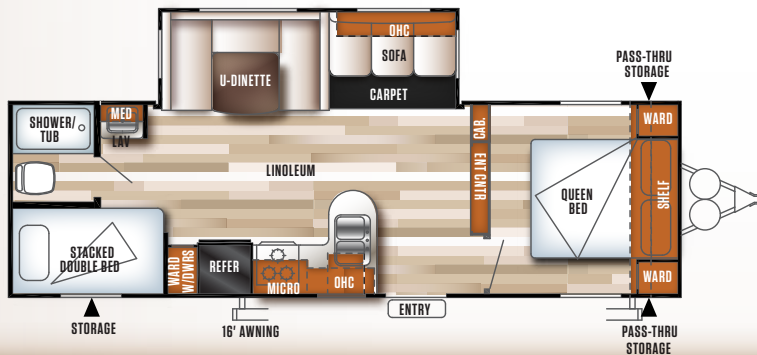

## 27REI

UNLOADED  
VEHICLE WEIGHT:  
**7558**



NEW

## 27RKSS

UNLOADED  
VEHICLE WEIGHT:  
**6355**

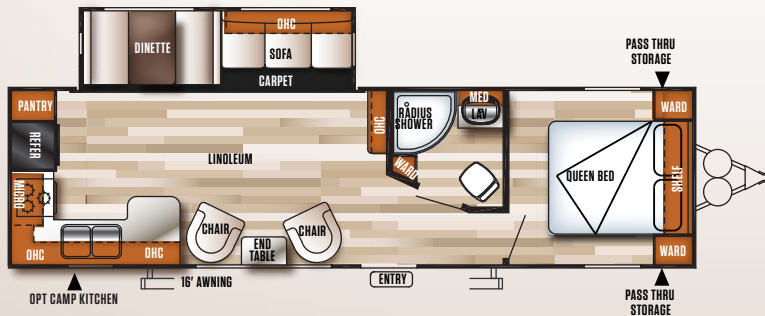

## 27RLSS

UNLOADED  
VEHICLE WEIGHT:  
**6372**

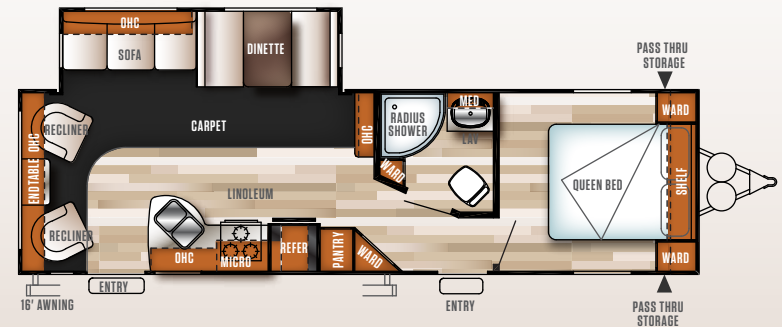



## 28CKDS

UNLOADED  
VEHICLE WEIGHT:  
**7622**

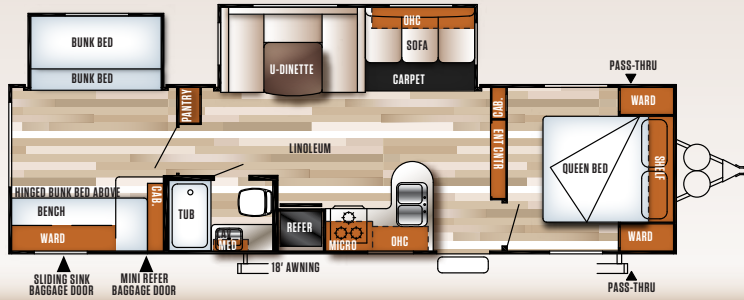

## 28RLDS

UNLOADED  
VEHICLE WEIGHT:  
**6782**

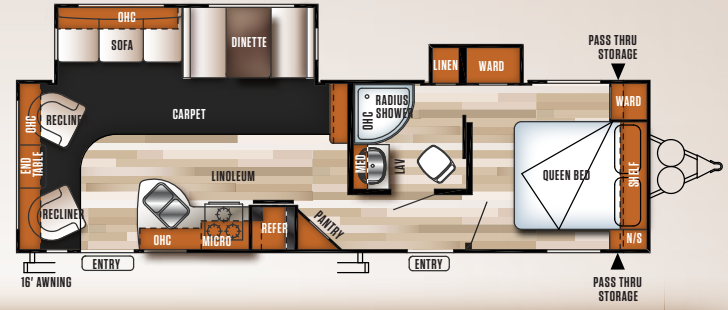

## 29FKBS

UNLOADED  
VEHICLE WEIGHT:  
**7513**

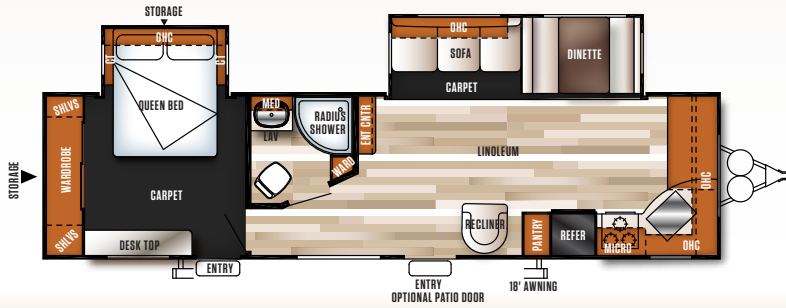

## 30KQBSS

UNLOADED  
VEHICLE WEIGHT:  
**6884**

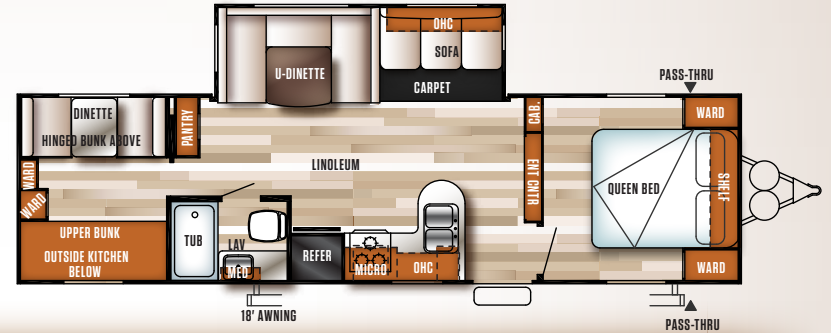

## 30QBSS

UNLOADED  
VEHICLE WEIGHT:  
**6575**

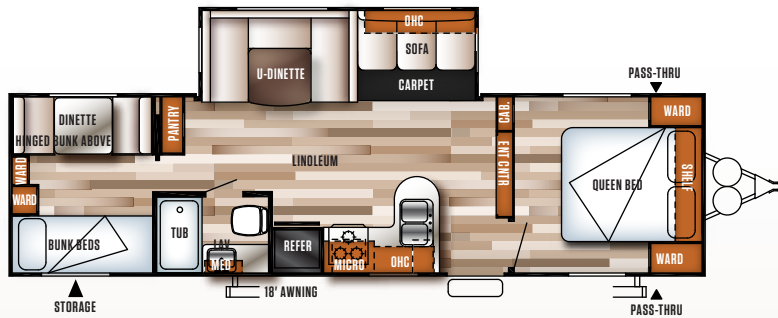

## 31BKIS

UNLOADED  
VEHICLE WEIGHT:  
**8350**

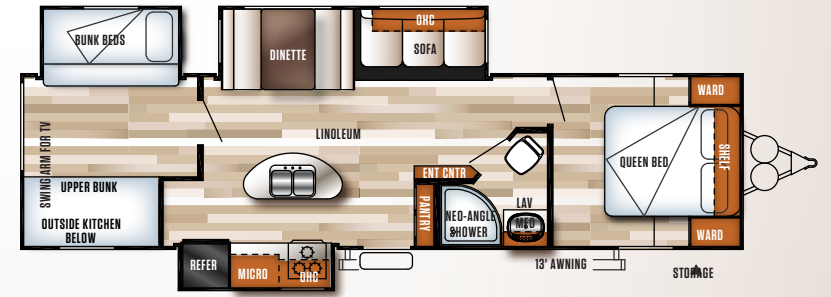

	26TBUD	27DBK	27DBUD	27REI	27RKSS	27RLSS	28CKDS	28RLDS	29FKBS	30KQBSS	30QBSS	31BKIS
HITCH WEIGHT (LBS.)	815	701	772	831	720	650	838	882	826	899	980	970
UNLOADED VEHICLE WEIGHT (LBS.)	5730	6380	6140	7558	6355	6372	7622	6782	7513	6884	6575	8350
CARGO CARRYING CAPACITY (LBS.)	2047	1283	1549	3374	1327	1240	1978	1062	3414	2777	3167	2742
EXTERIOR LENGTH	28' 8"	32' 0"	29' 6"	33' 1"	33' 3"	32' 2"	34' 6"	32' 3"	35' 3"	33' 0"	33'	35' 8"
EXTERIOR HEIGHT	11' 2"	11' 4"	11' 2"	11' 5"	11' 2"	11' 2"	11' 5"	11' 2"	11' 2"	11' 2"	11' 2"	11' 3"
FRESH WATER CAPACITY (GAL.)	40	40	40	40	40	40	40	40	40	40	40	40
BLACK WATER CAPACITY (GAL.)	30	41	30	27	27	27	30	27	30	27	27	30
GREY WATER CAPACITY (GAL.)	27	60	27	42	60	60	30	60	57	57	30	60
AWNING (FT.)	16'	18'	16'	11' / 9'	16'	16'	18'	16'	18'	18'	18'	13'



# Salem Travel Trailers

FLOORPLANS, WEIGHTS & MEASURES

## 31KQBTS

UNLOADED  
VEHICLE WEIGHT:  
**7902**

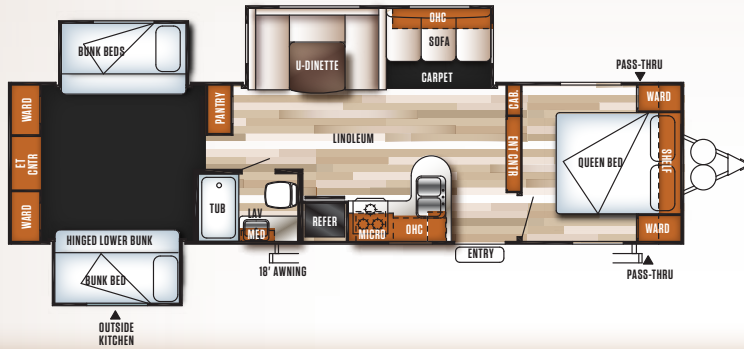

## 31QBTS

UNLOADED  
VEHICLE WEIGHT:  
**8104**

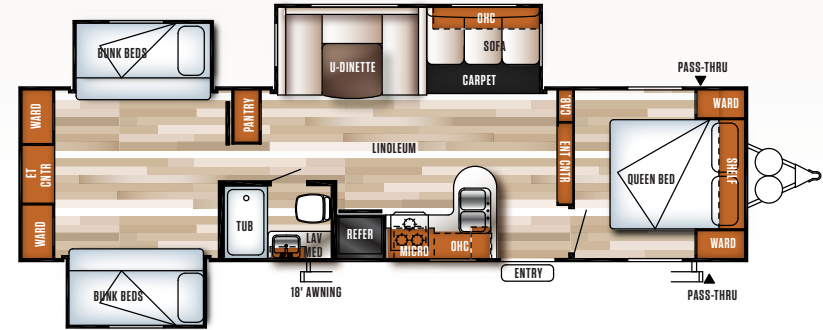

## 32BHDS

UNLOADED  
VEHICLE WEIGHT:  
**7955**

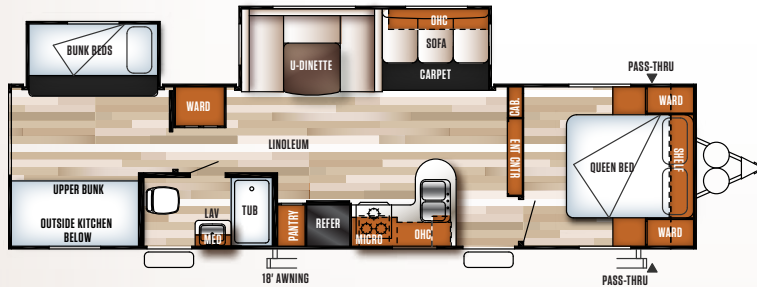

## 36BHBS

UNLOADED  
VEHICLE WEIGHT:  
**7891**

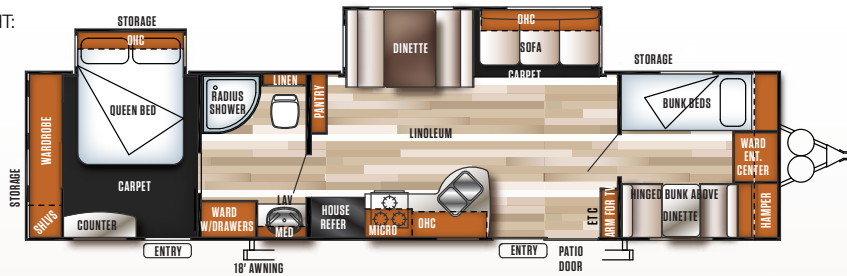

## 37BHSS2Q

UNLOADED  
VEHICLE WEIGHT:  
**7600**

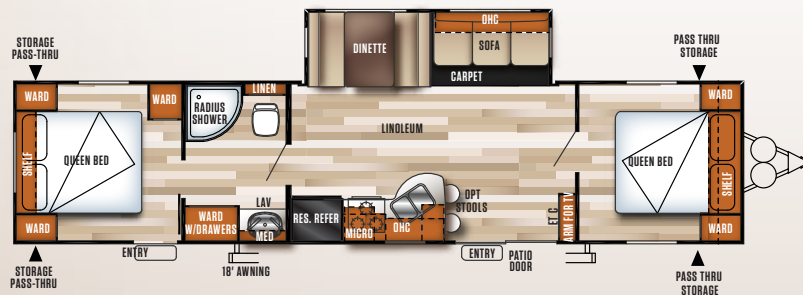

	31KQBTS	31QBTS	32BHDS	36BHBS	37BHSS2Q
HITCH WEIGHT (LBS.)	793	885	859	720	970
UNLOADED VEHICLE WEIGHT (LBS.)	8140	7902	7955	7891	7600
CARGO CARRYING CAPACITY (LBS.)	3013	2867	3026	2951	3492
EXTERIOR LENGTH	36'1"	35' 6"	35' 8"	36' 7"	39' 0"
EXTERIOR HEIGHT	11'3"	11'2"	11'2"	11'2"	11'2"
FRESH WATER CAPACITY (GAL.)	40	40	40	40	40
BLACK WATER CAPACITY (GAL.)	27	27	30	27	27
GREY WATER CAPACITY (GAL.)	54	27	57	30	30
AWNING (FT.)	18'	18'	18'	18'	18'



# Salem Fifth Wheels

FLOORPLANS, WEIGHTS & MEASURES

## 26DDSS

UNLOADED  
VEHICLE WEIGHT:  
**7103**

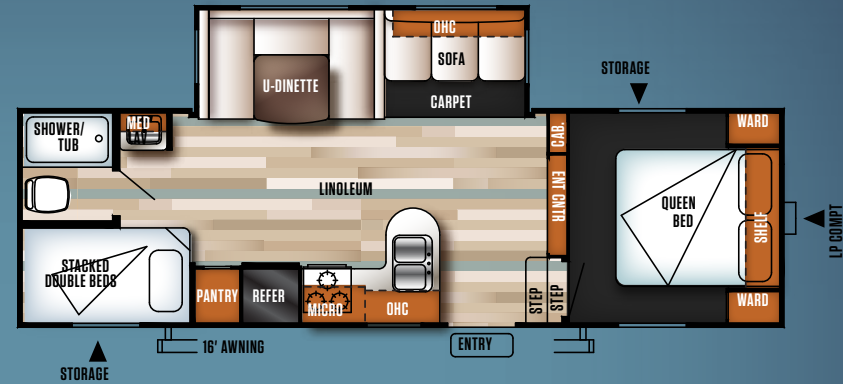

## 29RKSS

UNLOADED  
VEHICLE WEIGHT:  
**7832**

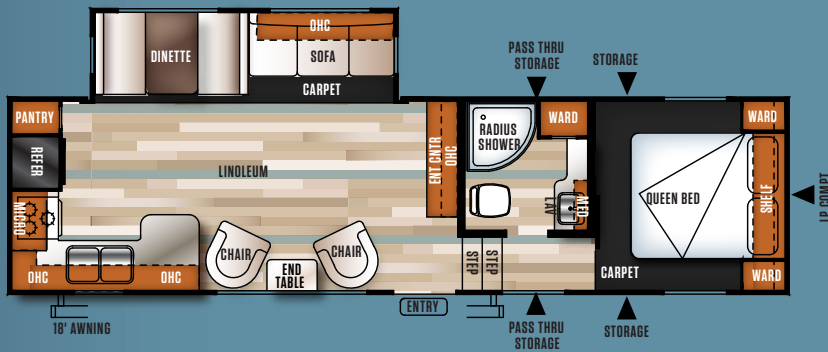

## 29RLW

UNLOADED  
VEHICLE WEIGHT:  
**7394**

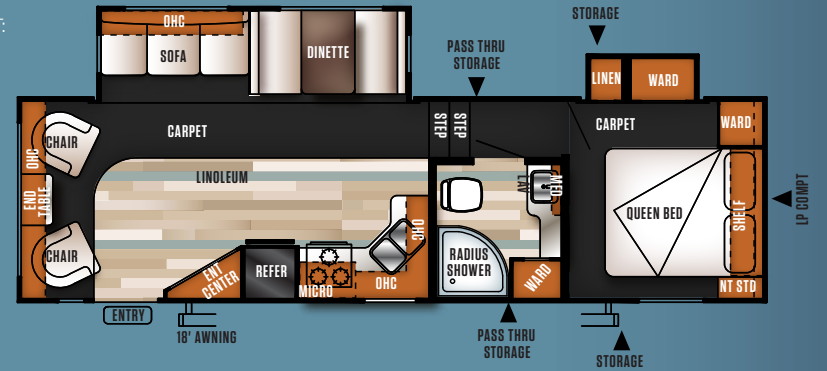

## 33BHOK

UNLOADED  
VEHICLE WEIGHT:  
**9107**



	26DDSS	29RKSS	29RLW	33BHOK
HITCH WEIGHT (LBS.)	1272	1418	1441	1704
UNLOADED VEHICLE WEIGHT (LBS.)	7103	7832	7394	9107
CARGO CARRYING CAPACITY (LBS.)	4291	3708	4169	2719
EXTERIOR LENGTH	30'9"	34'1"	31'8"	37'9"
EXTERIOR HEIGHT	12'3"	12'6"	12'6"	12'9"
FRESH WATER CAPACITY (GAL.)	40	40	40	40
BLACK WATER CAPACITY (GAL.)	30	30	27	30
GREY WATER CAPACITY (GAL.)	27	54	27	57
AWNING (FT.)	16'	18'	18'	16'

### Floorplan Key

- OHC** Overhead Cabinet
- WARD** Wardrobe
- MICRO** Microwave
- LAV** Bathroom Sink
- MED** Medicine Cabinet



**FREE MEMBERSHIP**  
to Forest River Owners' Group

www.forestriverfrog.com



**Learn More**  
Scan this barcode using a QR Reader on your smart phone to learn more about Forest River.



A Berkshire Hathaway company.

Forest River, Inc. 55470 C.R. 1 Elkhart, IN 46515 | (574) 533-5934  
www.forestriverinc.com/Salem | www.forestriveraccessories.com

# The Salem Line-Up



SALEM



SALEM CRUISE LITE



SALEM VILLA | VILLA ESTATE



SALEM HEMISPHERE

## 24/7 EMERGENCY ROADSIDE ASSISTANCE

For a worry-free ownership experience Forest River includes one year of Coach-Net RV Technical & Roadside Assistance with each RV purchase. Whether new to the RV lifestyle or an experienced RV enthusiast, Forest River owners have 24/7 access to technical, operational and emergency road service coverage throughout the US & Canada. Coach-Net's fast, dependable service is just a phone call away.

## Coach-Net®

RV Technical & Roadside Assistance



Forest River, Inc. encourages our customers to purchase their Forest River products from a local dealership whenever possible for the following reasons:

- 1) Forest River, Inc. dealers are independently owned and operated businesses so priority service and scheduling is at their discretion and is often provided to customers that purchased their unit at that dealership.
- 2) Purchasing locally allows customers to establish meaningful relationships with a dealer, enhancing the RV experience through assistance with product questions, user tips or RV regulations for your state or country, and much more!
- 3) Canadian customers must meet requirements to bring an RV purchased out of the country to their home. These requirements may involve additional inspections and certifications, taxes and fees. Your local Canadian Dealer is a professional at meeting these requirements.
- 4) Scheduling timely warranty repairs and adjustments through a local dealership provides far greater flexibility and convenience to you, the customer!

It is the goal of Forest River, Inc. that all of our RV owners fully enjoy the RV experience and that customer satisfaction meets or exceeds their expectations!



### PRE-DELIVERY INSPECTION FACILITY

20,000 square feet of quality assurance. The bare essentials for a premium product. This state-of-the-art facility gives immediate daily feedback to production for quality assurance in every unit built.

2017

### YOUR SALEM DEALER

Colton RV  
North Tonawanda, NY 14120  
(716) 694-0188  
(800) 628-4889  
www.ColtonRV.com

Colton RV  
Orchard Park, NY 14127  
(716) 957-3250  
(800) 628-4889  
www.Coltonrv.com

### Specification Definitions

**GVWR (Gross Vehicle Weight Rating)** - is the maximum permissible weight of the unit when fully loaded. It includes all weights, inclusive of all fluids, cargo, optional equipment and accessories. For safety and product performance do NOT exceed the GVWR.

**GAWR (Gross Axle Weight Rating)** - is the maximum permissible weight, including cargo, fluids, optional equipment and accessories that can be safely supported by a combination of all axles.

**UVW (Unloaded Vehicle Weight)\*** - is the typical weight of the unit as manufactured at the factory. It includes all weight at the unit's axle(s) and tongue or pin and LP Gas. The UVW does not include cargo, fresh potable water, additional optional equipment or dealer installed accessories.

\*Estimated average based on standard build optional equipment.

**CCC (Cargo Carrying Capacity)\*\*** - is the amount of weight available for fresh potable water, cargo, additional optional equipment and accessories. CCC is equal to GVWR minus UVW. Available CCC should accommodate fresh potable water (8.3 lbs per gallon). Before filling the fresh water tank, empty the black and gray tanks to provide for more cargo capacity.

\*\* Estimated average based on standard build optional equipment

Each Forest River RV is weighed at the manufacturing facility prior to shipping. A label identifying the unloaded vehicle weight of the actual unit and the cargo carrying capacity is applied to every Forest River RV prior to leaving our facilities.

The load capacity of your unit is designated by weight, not by volume, so you cannot necessarily use all available space when loading your unit.

All information contained in this brochure is believed to be accurate at the time of publication. However, during the model year, it may be necessary to make revisions and Forest River, Inc. reserves the right to make all such changes without notice, including prices, colors, materials, equipment and specifications as well as the addition of new models and the discontinuance of models shown in this brochure. Therefore, please consult with your Forest River dealer and confirm the existence of any materials, design or specifications that are material to your purchase decision. Litho. U.S.A. FOR 1336 P/W: 2016.11.10