

# CHATEAU®

## Class C Floorplans

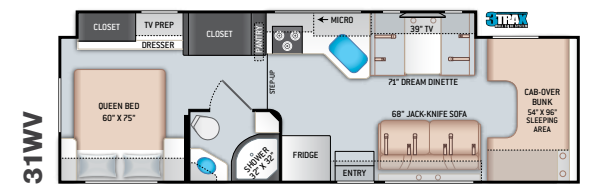

Option Available on  
Select Floor Plans:

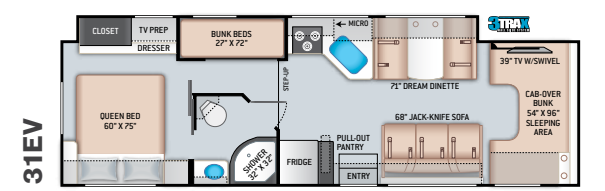
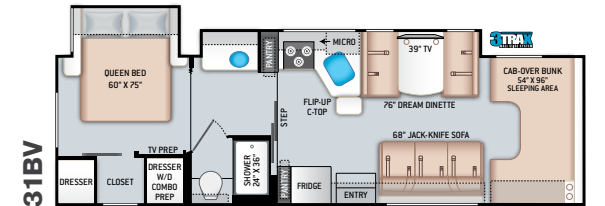
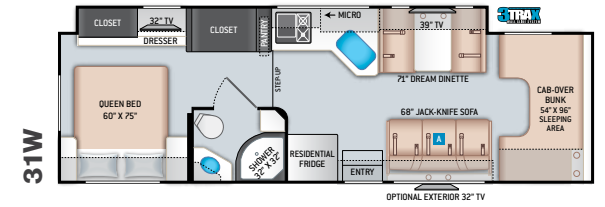
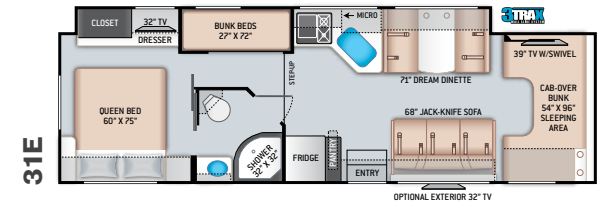
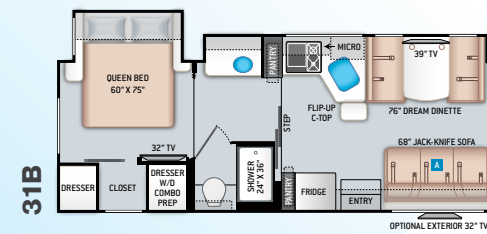
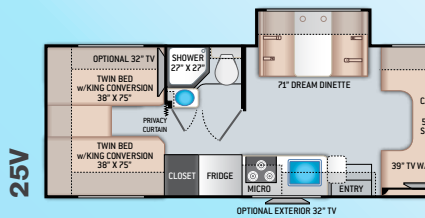
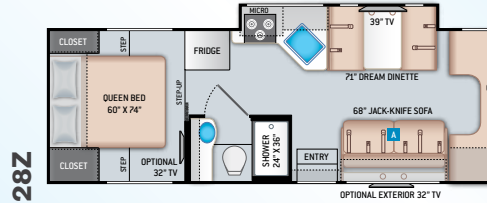
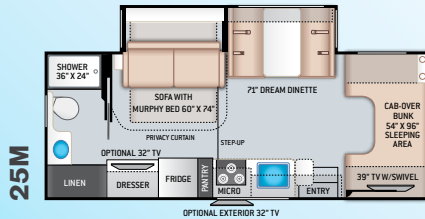
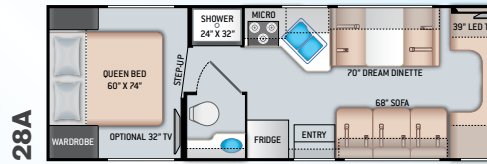
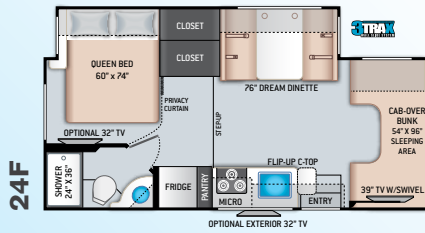
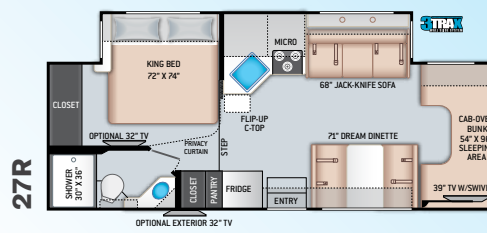
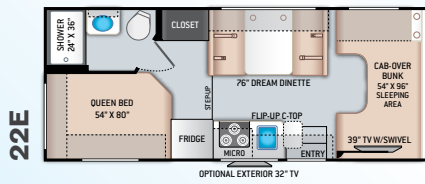
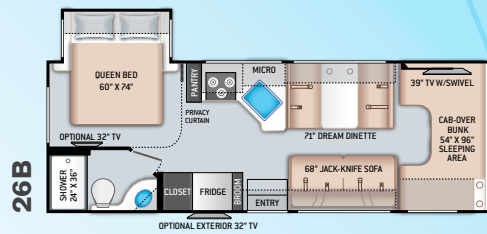
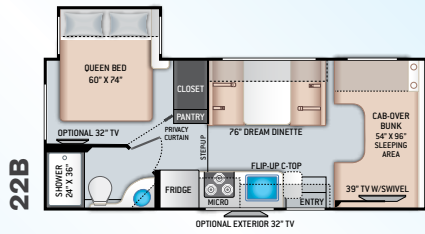
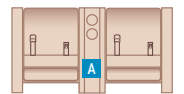

OPTIONAL THEATER SEATING

# Exterior Graphics & Interior Decor

## CLASS C

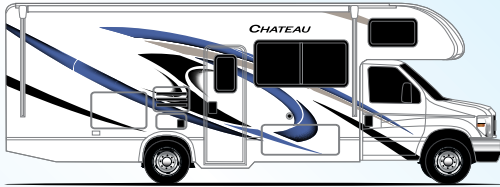

DENIM BLUE

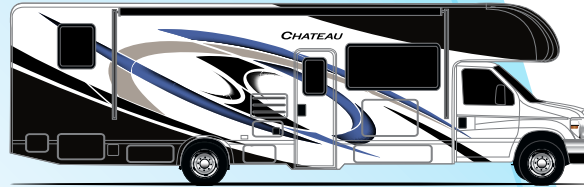

MIDNIGHT BLUE PARTIAL PAINT  
(31B, 31E, & 31W ONLY)

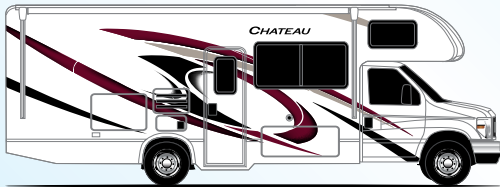

RODEO RED

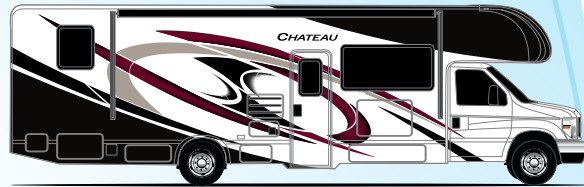

RED SADDLE PARTIAL PAINT  
(31B, 31E, & 31W ONLY)

## SPRINTERS

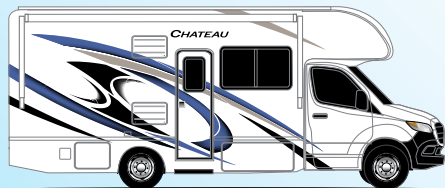

DENIM BLUE

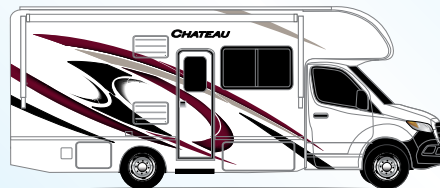

RODEO RED



BONITA BAY  
FULL-BODY PAINT (SPRINTERS)



DAYTONA BEACH  
FULL-BODY PAINT (SPRINTERS)



FLOORING



CAROLINA  
CHERRY



IRISH  
MAPLE

## OPTIONAL HOME COLLECTION



IVORY COAST





# CHATEAU<sup>®</sup>

## Sprinter Featured Highlights

### CONSTRUCTION & EXTERIOR

- Mercedes-Benz Sprinter - 3.0L V6 188HP 325 lb-ft Torque
- Slick Fiberglass Exterior with Graphics Package
- Electric Stabilizing System
- Welded Tubular Aluminum Roof & Sidewall Cage Construction
- Lighted Rotocast Storage Compartments
- Flush Mount Radius Compartment Doors
- Electric Entry Step with Accent Light Under Step on Separate Switch
- Entry Door with Deadbolt Lock
- Premium One-piece Crossflex<sup>®</sup> Roof
- Power Patio Awning with Integrated LED Lighting
- Slide out Room Topper Awnings

### CONSTRUCTION & EXTERIOR OPTIONS

- Full-Body Paint Package with Protective Mask

### AUTOMOTIVE & COCKPIT

- Touchscreen Dash Stereo
- SiriusXM<sup>®</sup> Ready
- Back-up Monitor with Integrated Camera
- Cruise Control
- LED Taillights
- Deluxe Heated/Remote Exterior Mirrors
- Leatherette Swivel Captain's Chairs
- Keyless Entry System

- Stainless Steel Wheel Liners
- Valve Stem Extensions on All Wheels
- Dash Applique
- Windshield Privacy Curtain

### AUTOMOTIVE & COCKPIT OPTIONS

- Cockpit Carpet Mat

### INTERIOR

- Wall Cubby with Net & USB Charging Port
- Leatherette Dinette Booth
- High-Sheen Cabinetry with Flat Panel Upper Cabinet Doors and Nickel Finish Hardware
- Decorative Glass Inserts in Kitchen Overhead Cabinet Doors (N/A with Home Collection)
- LED Lighting
- Cab-Over Sleeping Area with Cup Holders, and Bunk Ladder
- Premium Window Privacy Roller Shades
- Leatherette Theater Seating with Footrests (24DS)
- Leatherette Dream Dinette<sup>®</sup> Booth (N/A 24DS)
- Full Extension Metal Ball-Bearing Drawer Guides
- Wireless Phone Charger with USB Plug
- Rubber Tread Entry Steps with Step Well Light
- Ceiling Ducted Air Conditioning System

### INTERIOR OPTIONS

- Home Collection Interior Décor and Cabinet Package with Black Hardware and Faucets (Glass Inserts in Kitchen Overhead N/A with Option)
- Single Child Safety Tether in Dinette (24BL)
- Cab-Over Bunk Safety Child Net
- 12-volt Attic Fan with Cover in Cab-Over
- 12-volt Attic Fan with Cover in Bedroom

### KITCHEN

- Double Door Refrigerator
- Recessed 3-Burner Gas Cooktop with Glass Cover (24BL)
- 2-Burner Gas Cooktop with Glass Cover & Electric Start (24DS)
- Convection Microwave Oven
- Protective Cover & Task Lighting Above Cooktop
- Kitchen Countertop LED Accent Lighting
- Pop-Up Countertop Outlet & Charging Center for Electronics (24BL)
- Large Single Bowl Stainless Steel Sink with Single Handle Faucet
- Flip-Up Countertop Extension
- 12-volt Ceiling Vent in Kitchen with Under Cabinet Switch

### BEDROOM & BATHROOM

- Queen Size Bed (24BL)
- Full Size Bed (24DS)

Colton RV & Marine  
3122 Niagara Falls Blvd  
North Tonawanda, NY 14120  
(716) 694-0188  
[www.ColtonRV.com](http://www.ColtonRV.com)

Colton RV  
3443 Southwestern Blvd.  
Orchard Park, NY 14127  
(716) 957-3250  
[www.Coltonrv.com](http://www.Coltonrv.com)

- Bedroom 12V Outlet for CPAP Machine
- Bedroom USB Power Charging Center for Electronics
- Shower with Curved Anti-Microbial Shower Curtain
- Skylight in Shower
- Power Bath Vent with Wall Switch
- Foot Flush Toilet
- Stainless Steel Bathroom Sink

### ENTERTAINMENT

- 32" TV on Manual Swivel Over Entry Door (24BL)
- 39" TV in Living Area (24DS)
- HDMI Video Distribution Box
- Cable TV Ready
- HD/DSS Satellite Ready
- Satellite Mounting Backer in Roof

### ENTERTAINMENT OPTIONS

- 32" TV in Bedroom

### ELECTRICAL & PLUMBING

- Onan<sup>®</sup> RV QG 3600 LP Generator
- Winegard<sup>®</sup> Connect<sup>™</sup> 2.0 WiFi / 4G / TV Antenna
- 30-amp Shoreline Power Cord
- Automatic Transfer Switch with Power Protection
- Auxiliary House Battery (Group 31)

- 100-watt Solar Charging System with Solar Controller
- Battery Disconnect Switch
- Single Roof Air Conditioner
- Exterior LP Connection
- Tankless Water Heater
- Black Tank Flush System
- Sewer Hose Storage Area
- 360 Siphon RV Holding Tank Vent Cap
- 1" Fresh Water Tank Drain
- Outside Shower
- Systems Control Center

### ELECTRICAL & PLUMBING OPTIONS

- Holding Tanks with Heat Pads

For a complete listing of available features, visit [thormotorcoach.com/chateau-sprinter](http://thormotorcoach.com/chateau-sprinter).



## Sprinter Floorplans

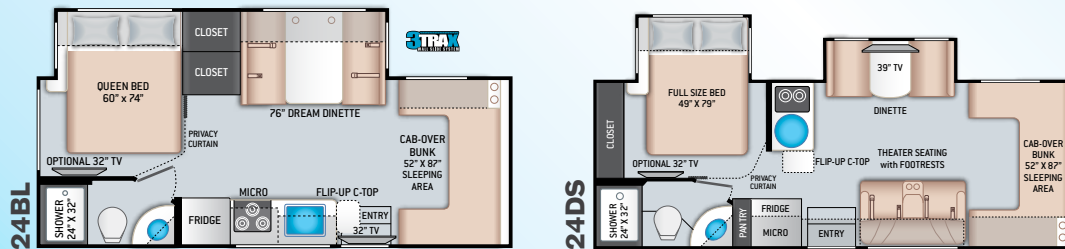

	24BL	24DS
Chassis	Mercedes-Benz <sup>®</sup> Sprinter	Mercedes-Benz <sup>®</sup> Sprinter
Gross Vehicle (GVWR)	11,030	11,030
Gross Combined (GCWR)	15,250	15,250
Wheel Base	170.3"	170.3"
Exterior Length (w/o ladder)	24'-10"	25'-9"
Exterior Height (w/AC)	11'-8"	11'-6"
Exterior Width (w/o mirrors)	90"	90"
Interior Height (living area)	84"	84"
Awning Size	15'	16'
Fuel (gal)	26.4	26.4
LPG (lbs)	68.2	68.2
Fresh/Waste/Gray Water (gal)	30 / 24.5 / 38	30 / 34.5 / 37
Water Heater (gal)	Tankless	Tankless
Furnace (BTUs)	30,000	30,000
Exterior Storage Capacity (cu. ft.)	48.5	47
Hitch Weight Rating (lbs)	5,000	5,000



Made to fit.

P.O. Box 1486, Elkhart, IN 46515 Sales Department: 800.860.5658

[thormotorcoach.com/chateau](http://thormotorcoach.com/chateau)



**IMPORTANT—PLEASE READ:** This brochure reflects product design, fabrication, material, components and specifications at the date of printing, which date is disclosed below. Please visit us online at [ThorMotorCoach.com](http://ThorMotorCoach.com) or consult with your selling dealership for the latest in standards, options, specification and technical information. Photographs in the brochure may depict optional equipment or may only be available in certain floor plans. Components, appliances and the chassis may have been manufactured in a calendar year before the vehicle's designated model year. All capacities are approximate. The actual length of the vehicle may differ from that indicated in the brochure due to variances in the manufacturing processes and/or installed components. All dry weights are based on standard model features and do not include optional features or equipment. Component part and appliance manufacturers issue limited warranties covering portions of the vehicle not covered under the limited warranty we issue. Copyright Thor Motor Coach, Inc. © MY 03/12/2021