

Pursuit



Pursuit
BY COACHMEN

THERE ARE NO SMALL THINGS WHEN IT COMES TO PURSUIT.

IN DESIGNING PURSUIT, WE TOOK CARE OF EVERY DETAIL. THE RESULT? AN EXPERIENCE THAT WILL SURPRISE AND DELIGHT YOU AT EVERY TURN.



Cooking in the Pursuit is a breeze, thanks to generous cabinet and countertop space. The backsplash, solid surface and fixtures add a touch of style.



The outdoor entertainment system (N/A 27XPS) is perfect for watching the game outside while the dash includes a computer workstation with 12V, 110V, and USB outlets, perfect for when you want to stay connected.



Spacious exterior storage compartments make it easy to haul extra gear without taking up space inside.

15,000 BTU A/Cs with heat pumps keep you cool in the summer. Dual A/Cs standard on 29SS, 31BH, 31TS.

INTERIOR DÉCOR COLOR SELECTIONS



Champagne



Mocha

INTERIOR WOOD COLOR SELECTIONS



Cloud



Shadow



Photography features the Pursuit 31ES floorplan with Champagne interior and Shadow cabinetry.



Pursuit's spacious dinette provides a comfortable place to enjoy meals. The dinette converts into a bed for extra sleeping.

Pursuit's drop-down bunk is designed to provide an additional sleeping quarter while maximizing space when not in use.

New square windows provide more airflow and a refined look. Integrated day/night shades create less road noise than traditional blinds.

Power shade for front windshield allows for easy and quick privacy.



With porcelain touches, the bathroom is both tastefully designed and easy to clean.

A designer headboard adds a touch of style to the comfortable bedroom, which includes a king mattress (select floorplans). Storage space has been optimized, giving you more options for long distance trips.

Pursuit includes four floorplan options, so you'll have no trouble choosing the one that suits you perfectly.



27XPS



29SS

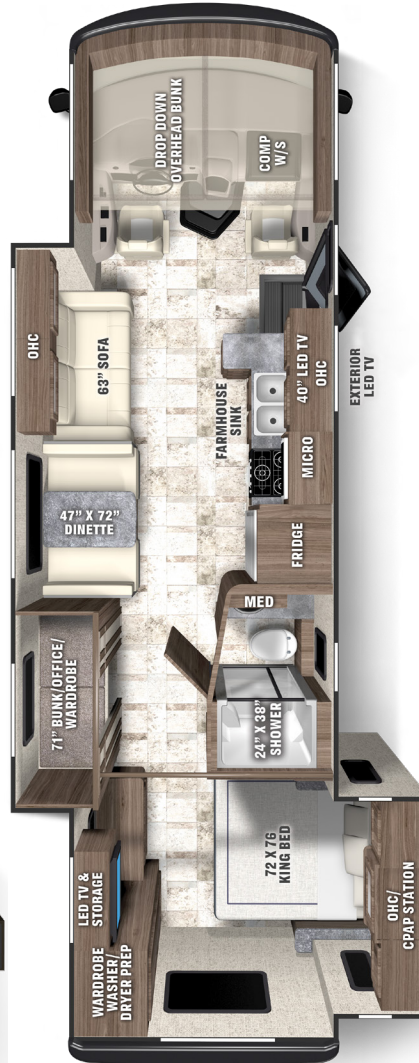

31ES



31TS

FLOORPLANS

PURSUIT SPECIFICATIONS

CLASS A GAS	27XPS	29SS	31ES	31TS
FORD ENGINE V-8 7.3L 3-VALVE	335 HP/468 TRQ	335 HP/468 TRQ	335 HP/468 TRQ	335 HP/468 TRQ
WHEEL BASE	178"	190"	208"	208"
GVWR	16,000 lbs	18,000 lbs	18,000 lbs	18,000 lbs
GCWR	23,000 lbs	23,000 lbs	23,000 lbs	23,000 lbs
GAWR FRONT	6,500 lbs	7,000 lbs	7,000 lbs	7,000 lbs
GAWR REAR	11,000 lbs	12,000 lbs	12,000 lbs	12,000 lbs
FUEL CAPACITY	80 gal	80 gal	80 gal	80 gal
LP GAS CAPACITY	20 gal	20 gal	20 gal	20 gal
FURNACE (BTUs)	30,000	30,000	30,000	30,000
EXTERIOR LENGTH (w/o Ladder)	29' 0"	30' 3"	33' 0"	33' 0"
EXTERIOR HEIGHT (w/A/C)	12'	12'	12'	12'
EXTERIOR WIDTH	102"	102"	102"	102"
FRESH WATER	50 gal	50 gal	50 gal	50 gal
GREY WATER	31 gal	35 gal	38 gal	38 gal
BLACK WATER	31 gal	35 gal	38 gal	38 gal
WATER HEATER	6 gal	6 gal	6 gal	6 gal
AWNING SIZE	16'	20'	17'	17'

GVWR (Gross Vehicle Weight Rating) is the maximum permissible weight of the unit when fully loaded. It includes all weights, inclusive of all fluids, occupants, cargo, optional equipment and accessories. For safety and product performance do NOT exceed the GVWR.

GCWR (Gross Combined Weight Rating) is the maximum permissible loaded weight of your motor home and any towed trailer or towed vehicle. Actual GCWR of this vehicle may be limited by the sum of the GVWR and the installed hitch receiver maximum capacity rating; see hitch rating label for detail.

GAWR (Gross Axle Weight Rating) is the maximum permissible weight, including cargo, fluids, optional equipment and accessories that can be safely supported by each axle.

UVW (Unloaded Vehicle Weight)* is the typical weight of the unit as manufactured at the factory. It includes all weight at the unit's axle(s), including full fuel, all fluids and LP Gas. The UVW does not include cargo, fresh potable water, additional optional equipment or dealer installed accessories.

*Estimated Average based on standard build optional equipment.

CCC (Cargo Carrying Capacity)** is the amount of weight available for fresh potable water, cargo, passengers, additional optional equipment and accessories. CCC is equal to GVWR minus UVW. Available CCC should accommodate fresh potable water (8.3 lbs per gallon). Before filling the fresh water tank, empty the black and gray tanks to provide for more cargo capacity.

** Estimated average based on standard build optional equipment

Each Coachmen motorhome is weighed at the manufacturing facility prior to shipping. A label identifying the unloaded vehicle weight of the actual unit and the cargo carrying capacity is applied to every Coachmen motorhome prior to leaving our facilities.

The load capacity of your unit is designated by weight, not by volume, so you cannot necessarily use all available space when loading your unit.

Actual towing capacity is dependent upon your particular loading and towing circumstances, which includes the GVWR, GAWR and GCWR as well as adequate trailer brakes. Please refer to the Operator's Manual of your vehicle for further towing information.

All information contained in this brochure is believed to be accurate at the time of publication. However, during the model year, it may be necessary to make revisions and Coachmen reserves the right to make all such changes without notice, including prices, colors, materials, equipment and specifications as well as the addition of new models and the discontinuance of models shown in this brochure. Therefore, please consult with your Coachmen dealer and confirm the existence of any materials, design or specifications that are material to your purchase decision.

STANDARD FEATURES

INTERIOR APPOINTMENTS

Manual Drop-Down Front Bunk
Self-Closing Ball Bearing Drawer Guides Throughout
Premium Linoleum Throughout
Square Windows with Safety Glass
Reclining/Swivel Pilot Seats
Sofa (27XPS, 29SS, 31ES)
Theater Seating (31TS)
Day/Night Shades Coach
Dream Booth Dinette
Easy Clean Cockpit floor

INTERIOR EQUIPMENT

10" Touch Screen Radio AM/FM Radio
with Bluetooth Apple CarPlay and
Android Auto Link Enabled
LP Leak Alarm and Smoke Detector
Carbon Monoxide Detector
Fire Extinguisher
King Jack TV and Radio Antenna
Smart TV Coach
Pre-Wired for Satellite Dish
Charging Station for Electronic Devices
Power Shade for Front Windshield

GALLEY

Stainless Steel Range Hood with Light
Stainless Steel Double Door Refrigerator
12V 10 Cu. Ft.
High Rise Kitchen Faucet
Stainless Steel Sink
Stainless Steel 3-Burner Range with Glass Cover
Stainless Steel Microwave Oven
Solid Surface Kitchen Counter Top

BATH AND WATER

Porcelain Toilet with Foot Flush
One Piece ABS Shower Surround
Retractable Shower Door
Power Bath Vent
6-Gallon Gas/Electric D.S.I. Water Heater
Demand Water Pump
Skylight Over Shower
Stainless Lavatory Sink
Black Tank Flush

SLEEPING

Bedroom TV (N/A 27XPS)
CPAP Cabinet
Power Outlets Both Sides of Bed
Bunk/Office/Wardrobe (31ES)

ELECTRICAL/HEATING/AC

50-Amp Power Cord (29SS, 31TS, 31ES)
30-Amp Power Cord (27XPS)
100W Solar Panel with Controller
Automatic Transfer Switch
55-Amp Converter with Distribution Panel
GFI Circuit
Outside Receptacle
Emergency Start Switch
30,000 BTU E.I. Furnace
Dual 15,000 BTU A/C with Heat Pump
(29SS, 31TS, 31ES)
Single 15,000 BTU A/C with Heat Pump
(27XPS)
Coach Command Center
LED Interior Lights
5.5 kW Gas Generator (29SS, 31TS, 31ES)
4.0 kW Gas Generator (27XPS)

AUTOMOTIVE/EXTERIOR

Ford F53 7.3L V8 Chassis
Tilt and Telescoping Steering Wheel
Cruise Control
Traction Control
Sunload Sensor with Auto Dimming
Dash Lighting
Intermittent Wipers
Dash Air Conditioning
Computer Work Station with USB, 12V, 120V
Automatic Leveling Jacks
(29SS, 31TS, 31ES)
Back Up Monitor with Side View Cameras
(29SS, 31TS, 31ES)
Back Up Monitor (27XPS)
Radial Tires
Rear Mud Flaps Only
Power Entrance Step-Single
Crowned, Laminated TPO Roof
Radius Trunk Doors
Fiberglass Front Cap
High Gloss Dove Grey Sidewalls
(with Azdel™ Superlite Composite)
Dead Bolt Lock-Entrance Door
26" Radius Entry Door
Power Patio Awning
8,000 Towing Hitch with 7-Way Plug
(27XPS)
5,000 Towing Hitch with 7-Way Plug
(29SS, 31TS, 31ES)
Power Heated Mirrors
Rear Bumper
Stainless Steel Wheel Liners
Slide-out room awning(s)(Where Applicable)
20-Gallon LP Tank
Valve Stem Extenders
Outside Entertainment Center
with TV (29SS, 31TS, 31ES)
Exterior Propane Hook-Up

OPTIONAL FEATURES

INTERIOR COLOR SELECTIONS

Champagne
Mocha

INTERIOR WOOD COLOR SELECTIONS

Cloud
Shadow

OPTIONAL FEATURES

Power Driver Seat (N/A 27XPS)
CSA Up-fit
CD-MVSA (Canadian Motor Vehicle Safety Act)¹
Diamond Shield

Notes:

¹ Mandatory For All Canadian Provinces

Colton RV & Marine
3122 Niagara Falls Blvd
North Tonawanda, NY 14120
(716) 694-0188
www.ColtonRV.com

Colton RV
3443 Southwestern Blvd.
Orchard Park, NY 14127
(716) 957-3250
www.Coltonrv.com

THE COACHMEN ADVANTAGE

What is the Coachmen advantage? It's the collection of unique features offered in a Coachmen motorhome to ensure a smoother ride, a better camping experience, and a motorhome that will last for years.

1. AZDEL™ COMPOSITE

Most manufacturers use wood sidewalls that can expand, swell, and eventually mold. We use Azdel. It's impervious to water, won't rot or mold, and with less than a 1% chance of delaminating, it ensures the long-term integrity of the sidewalls.

2. REINFORCED LAMINATION

We vacuum bond and pinch roll every sidewall, floor, and roof, then perform a pull adhesion test. Most manufacturers just do one process or the other, but by doing both we improve the strength and longevity of the sidewalls.

3. FOREFRONT OF TECHNOLOGY

We offer the latest in technology by pairing electronics with smart phones. A safer and larger viewing area is achieved when dual-mirroring your smart phone GPS to the 10" dash radio and backup system. Play your favorite songs from your favorite apps through our 4-channel 500 watt bluetooth amplifier.

4. SIGHT RITE DASH™

Our dashes are angled 20 degrees forward. This increases the line of sight for the driver, and offers the best road visibility on the market.

5. COOL STREAM DUCT™

Our patented duct system evenly disperses air through the whole coach. We use residential ducting instead of Styrofoam because it's antimicrobial, preventing the growth of bacteria and ensuring a cool, clean coach in even scorching heat.

6. DIGITAL OWNER'S MANUAL

Our owner's manuals are easy to access through the Coachmen website or our free app. Supplemented with videos, PowerPoints, and more, it's got all you need to know about your coach.

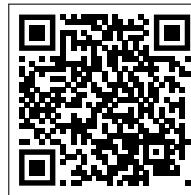

SCAN HERE

To see available
Standards, Options
and Features!



Coachmen RV, a Division of Forest River, Inc.,
A Berkshire Hathaway Company

423 N. Main St., P.O. Box 30, Middlebury, IN 46540

To learn more about Coachmen RV and our products and see how Coachmen is making the easy life easier, visit www.coachmenrv.com

©Copyright 2023 Coachmen RV a Division of Forest River Inc. - All Rights Reserved.

10/23

CUSTOMER SATISFACTION



www.ForestRiverBuyLocal.com



**24/7 EMERGENCY
ROADSIDE ASSISTANCE
WITH VEHICLE PURCHASE***

<p>TOWING JUMP-STARTS TIRE CHANGES FLUID DELIVERY LOCKOUT SERVICE</p>	<p>WINCH-OUT MOBILE MECHANIC TECHNICAL SUPPORT DEALER LOCATOR SERVICES</p>
---	--

*VALID FOR 1 YEAR FROM DATE OF PURCHASE



Learn More
Scan this barcode using
a QR Reader on your
smart phone to learn
more about Forest River.



A Berkshire Hathaway company.