

We put a great amount of thought into every RV we design and build. From strong frames, to sturdy walls and insulation, we build every RV to take you on many adventures to come.

Floor Structure

- 1 Linoleum Flooring
- 2 Luan Interior Panel
- 3 Aluminum Frame with Block Foam Insulation
- 4 Luan Panel
- 5 Darco Moisture Barrier
- 6 Steel powder coated Main Frame
- 7 Fully Enclosed Underbelly



Laminated Walls

- 1 Fiberglass Exterior Panel
- 2 Luan Wall Backing
- 3 Aluminum Frame with Block Foam Insulation
- 4 Luan Interior Wall Panel

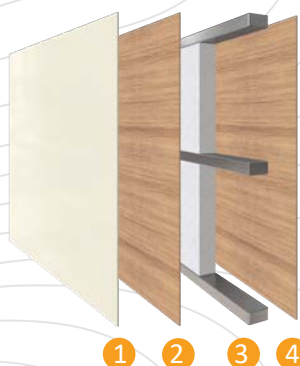

Durable Roof Structure

- 1 TPO Roof
- 2 3/8" Decking
- 3 Fiberglass Insulation
- 4 Luan Interior Panel



MORE STANDARD FEATURES MORE VALUE

Everything we put into our innovative floor plans are designed to maximize storage and comfort. We don't stop there, to ensure peace of mind after the purchase we have the industry's best RV warranty, 100% pre-delivery inspection, and the leader in parts and service. While other manufacturers offer features as options, we prefer to make those same features standard.

We've built a reputation for bringing RV owners more standard features for less money for over 25 years, and it's a reputation we plan to keep.



**100%
PRE-DELIVERY
INSPECTION**

At Dutchmen, quality is standard. Every single Dutchmen RV that comes off the line receives its own pre-delivery inspection. Every unit undergoes a thorough 253-point check to ensure accurate measurements, fully-functional electronics and components.



**THE INDUSTRY'S
BEST
RV WARRANTY**

With this industry-best warranty, we take the guessing game out of what is and isn't covered. So, that means you don't have to wrangle over the details, because we deliver value by clearly outlining the major components we back during the first three years.



**THE LEADER IN
PARTS AND SERVICE**

Replacement parts. Routine checkups. Expert advice. You name it and we've got it covered. When only the best RV services will suffice, our industry-leading parts and service department is ready to help you get back on the road - and stay there longer than ever before.



**Light
SERIES**



Travel Trailers

Your Dealer Colton RV
3122 Niagara Falls Blvd
North Tonawanda, NY 14120
(716) 694-0188
www.ColtonRV.com

Colton RV
3443 Southwestern Blvd.
Orchard Park, NY 14127
(716) 957-3250
www.Coltonrv.com

PO BOX 2000 | 2164 CARAGANA COURT | GOSHEN, IN 46527 | SALES 574.537.0600

www.dutchmen.com

Visit us online to see all the Dutchmen brands, innovative models and spacious floor plans.



Length is defined as the distance from the centerline of hitch pin/coupler to rear bumper of trailer. **Our weights represent how most units are built, inclusive of many commonly-ordered options. ***Fresh water capacity includes water heater capacity.

DISCLAIMER: Product information is as accurate as possible as of the date of brochure publication. All features, floor plans and specifications in this brochure are subject to change without notice. Please consult Dutchmen's website at www.Dutchmen.com for current product information and specifications. Tow Vehicle Disclaimer. CAUTION: Owners of Dutchmen recreational vehicles are solely responsible for the selection and proper use of tow vehicles. All customers should consult with a motor vehicle manufacturer or their dealer concerning the purchase and use of suitable tow vehicles for Dutchmen products. Dutchmen disclaims any liability or damages suffered as a result of the selection, operation, use or misuse of a tow vehicle. DUTCHMEN'S LIMITED WARRANTY DOES NOT COVER DAMAGE TO THE RECREATIONAL VEHICLE OR THE TOW VEHICLE AS A RESULT OF THE SELECTION, OPERATION, USE OR MISUSE OF THE TOW VEHICLE. REFERENCE DUTCHMEN MANUFACTURING OWNERS MANUAL FOR LIMITED WARRANTY DETAILS. © 2021 Dutchmen 12-13-2021-Coleman-Light-Printed in U.S.A MY2022



Dutchmen



Light
SERIES

Soul of the RV

Whether a weekend getaway or an extended season, the Coleman will renew your spirit. With more standard features and a focus on quality, value, and design, find your soul of the RV.

Features in Coleman

- **Upgraded Kitchen Package** - residential appliances, high rise faucet, farm style sink, pull out kitchen trash can, hidden pantry behind entertainment center (select Light models only).
- **Fully Enclosed Underbelly** - all of your RVs vital functions are kept out of the elements. Plus, this extra layer of protection means you can travel further into the year.
- **Solid Entry Steps** - stability you need when coming and going from your Coleman Light. Easy to expand and store away, these aluminum steps deliver a sound platform.

EXTERIOR FEATURES:

- Power Awning w/ LED Lights
- Power Tongue Jack
- Front & Rear Electric Jacks
- Diamond Plate Rock Guard
- Mega Pass Thru Storage Compartment w/ Magnetic Catches & Slam Latch Doors
- Backup Camera Prep
- Solar Panel Prep
- Friction Hinge Entry Door
- Exterior Grab Handle
- 30 Amp Power Cord
- Aluminum Rims
- LP Quick Connect
- Outside Shower
- Black Tank Flush
- Fiberglass Front Cap

INTERIOR FEATURES:

- 60"x 80" Residential Queen Bed
- Upgraded Beauflor Lino
- Dual Row LED Interior Lighting
- Foot Flush Toilet
- Seamless Kitchen Countertops
- 3 Burner Range w/ Glass Cover & 17" Oven
- Large Single Bowl Farm Sink w/ High Rise Faucet
- Range Hood w/ Light & Exhaust Fan
- Glass Fireplace w/ 5K BTU Heater (N/A 1855, 1905)
- Pleated Night Shades in Living Area & Bedroom
- 32" LED TV (N/A 1855, 1905)
- 6 Gallon Gas Water Heater w/ DSI
- High Output Furnace
- WiFi Prep
- Upgraded Kitchen Window

Standard Features In Every Floor Plan

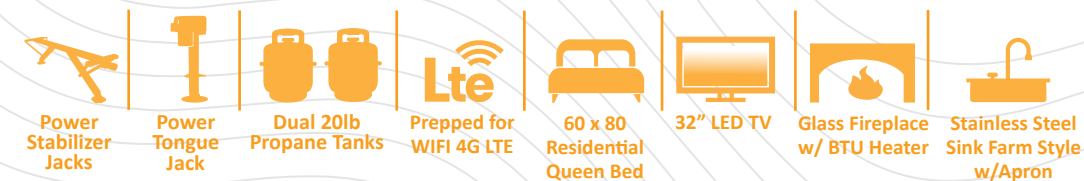

LIGHT 1805RB
Length: 22' 9" Weight: 4,503 lbs. Sleeps: 2-4
Hitch: 536 lbs. Height: 10' 10"



LIGHT 1855RB
Length: 22' 11" Weight: 4,308 lbs. Sleeps: 2-3
Hitch: 584 lbs. Height: 10' 7"



LIGHT 2715RL
Length: 31' 11" Weight: 6,354 lbs. Sleeps: 4-6
Hitch: 727 lbs. Height: 11' 4"



LIGHT 2755BH
Length: 36' 10" Weight: 6,528 lbs. Sleeps: 6-8
Hitch: 790 lbs. Height: 11' 0"



LIGHT 1905BH
Length: 23' 11" Weight: 4,537 lbs. Sleeps: 2-3
Hitch: 609 lbs. Height: 11' 1"



LIGHT 2835BH
Length: 32' 11" Weight: 6,574 lbs. Sleeps: 6-8
Hitch: 795 lbs. Height: 10' 11"



LIGHT 2455BH
Length: 28' 11" Weight: 5,570 lbs. Sleeps: 6-8
Hitch: 662 lbs. Height: 10' 11"



LIGHT 2955RL
Length: 33' 11" Weight: 7,370 lbs. Sleeps: 4-6
Hitch: 1,053 lbs. Height: 11' 3"

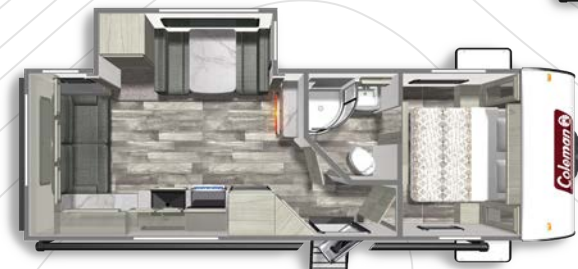

LIGHT 2515RL
Length: 29' 5" Weight: 5,685 lbs. Sleeps: 2-4
Hitch: 611 lbs. Height: 10' 11"



LIGHT 3055BS
Length: 34' 11" Weight: 7,346 lbs. Sleeps: 2-4
Hitch: 870 lbs. Height: 11' 5"



LIGHT 2625RB
Length: 31' 11" Weight: 6,493 lbs. Sleeps: 4-6
Hitch: 828 lbs. Height: 11' 4"



LIGHT 3215BH
Length: 33' 10" Weight: 7,583 lbs. Sleeps: 6-8
Hitch: 1,053 lbs. Height: 11' 3"

INTERIOR DECORS



*All information & specifications are for units manufactured after 12/15/2021

To learn more visit our website dutchmen.com