

MONTANA
LEGACY
PACKAGE

ELEVATING EXCELLENCE TO NEW HEIGHTS

THE MONTANA LEGACY PACKAGE UPGRADES YOUR COACH WITH FEATURES THAT DELIVER SUPERIOR PERFORMANCE, CUTTING-EDGE TECHNOLOGY, AND UNPARALLELED STYLE.

PAINTED REAR FIBERGLASS CAP

iN-COMMAND® W/ GLOBAL CONNECT® SMART RV CONTROL SYSTEM

HYDRASTAR ELECTRIC OVER HYDRAULIC DISC BRAKES

FURRION® VISION S™ OBSERVATION SYSTEM

FULL COACH SURGE PROTECTION

WINEGARD 4G LTE WiFi ROUTER

ELECTRIC POWER CORD REEL

FULL BODY AUTOMOTIVE PAINT IN SHADOW, STERLING, COBALT,
AND ALL NEW VOLCANO DESIGN



**EXPLORE
FULL-BODY
PAINT
OPTIONS**



WHERE ADVENTURE MEETS UNSURPASSED COMFORT

Embark on a journey of a lifetime with the pinnacle of recreational vehicles that seamlessly blends luxury, innovation, and rugged capability. Designed to cater to the desires of modern travelers and outdoor enthusiasts, the 2024 Montana RVs set the standard for mobile living, with exciting new options like factory-installed MORryde® independent suspension and Splendide stackable washer/dryer. Fully refreshed exterior and interior styling redefines the meaning of your home on the road.

Welcome to the family. Welcome to Montana.

MONTANA EXCEPTIONAL FEATURES

- **NEW** Dynamic Exterior Graphics
- Legacy Package Option w/ Disc Brakes & Full Body Paint
- Drop-Frame Construction
- **NEW** Fibrogloss™ High-Gloss Sidewalls
- One-Piece Alpha Super Flex TPO Roof Membrane w/ Limited Lifetime Warranty
- **NEW** Lippert Basecamp™ Hydraulic Auto-Leveling System w/ Digital Touchscreen & Under Frame LED Lighting
- Road Armor™ Suspension w/ 1/2" Shackle Plates, Wet Bolts & Bronze Bushings
- Sailun 16" G-Rated Tires
- TST Tire Pressure Monitoring System
- **NEW** MORryde® Independent Suspension Option
- Dexter® Gladiator™ Axles w/ Upgraded Springs & Nev-R-Adjust Brakes
- 30" X 78" Oversized Entry Door
- **NEW** MORryde® Telescoping Entry Door Rail
- Four-Season Weather Protection
- 16-Gallon Gas/Electric Suburban Water Heater
- 70-Gallon Fresh Water Tanks
- Seaflo® Water Pump, 12 Db Quieter
- 35K BTU Dometic Furnace & Up to 16.5K BTU Heat Pump
- Two Coleman-Mach Power-Saver Air Conditioners (<12 AMP DRAW EACH)
- Blade Pure™ High-Performance Air Flow System w/ Merv 9 Filtration
- **NEW** Manhattan Maple Interiors w/ Birch & Glazed White Accents
- **NEW** Woodcliff and Oakmont Decor Options (SEE KEYSTONERV.COM FOR DETAILS)
- Hardwood Cabinet Drawers, Doors & Stiles
- Solid Surface Countertops
- **NEW** Bel-Air Vinyl Flooring by Shaw w/ 7-Year Cold Cracking Warranty
- Island Design w/ Curved Bookshelf and Front Accent Frames
- Larger, 24" Furrion Stove w/ Matching Stainless Steel Drawer
- Stainless Steel Convection Microwave
- Adjustable 23" Dual-Burner Suburban Griddle in Outdoor Kitchens
- 18 Cu. Ft. Residential Refrigerator w/ Ice Maker (OPT. 20 CU. FT. 12V REFRIGERATOR)
- 50" Smart TV in the Living Room
- JBL Cube Stereo with Mizone Control & Subwoofer
- 32" Smart TV in the Bedroom
- **NEW** Stackable Washer and Dryer Option
- SolarFlex™ Protect 220, Discover 440i, & Outlast Extreme 1320i-L Package Options w/ Optional Dragonfly Lithium-Ion Batteries
- 1-Year Limited Base Warranty & 3-Year Limited Structural Warranty (SEE KEYSTONERV.COM FOR DETAILS)

MONTANA OWNER'S CLUB

Welcome to the Montana Family! As an owner, you have the opportunity to get involved with the Montana Owner's Club, an independently run group built around this legendary brand. Through the MOC forum, you will be privy to insider tips, technical advice, and the incredible fellowship this community offers. Join fellow members at regional and national rallies, including the club's annual camp out near Keystone headquarters in Goshen, Indiana.

TO CHECK OUT MORE AND JOIN THE COMMUNITY,
GO TO WWW.MONTANAOWNERS.COM/FORUMS



SOLARTM FLEX



NEW 2024 PACKAGE UPDATES

For more information scan the QR code
or visit keystonerv.com.

TAKE CHARGE OF HOW YOU CAMP

EXCEPTIONAL QUALITY, IMPOSSIBLY VERSATILE, SolarFlexTM
IS SHATTERING CUSTOMER'S EXPECTATIONS OF FACTORY-INSTALLED SOLAR POWER.
EXCLUSIVELY AVAILABLE ON ALL KEYSTONE RV MODELS.



Keystone RV is proud to partner with Dragonfly Energy to offer their legendary heated Lithium-ion batteries exclusively on all Keystone models.



FOLLOW US FOR THE LATEST!



DISCLAIMER: Product information is as accurate as possible as of the date of publication of this brochure. All features, floor plans, and specifications in this brochure are subject to change without notice. Please also consult Keystone's web site at www.keystonerv.com for more current product information and specifications. Tow Vehicle Disclaimer. CAUTION: Owners of Keystone recreational vehicles are solely responsible for the selection and proper use of tow vehicles. All customers should consult with a motor vehicle manufacturer or their dealer concerning the purchase and use of suitable tow vehicles for Keystone products. Keystone disclaims any liability or damages suffered as a result of the selection, operation, use or misuse of a tow vehicle. KEYSTONE'S LIMITED WARRANTY DOES NOT COVER DAMAGE TO THE RECREATIONAL VEHICLE OR THE TOW VEHICLE AS A RESULT OF THE SELECTION, OPERATION, USE OR MISUSE OF THE TOW VEHICLE. *Length is defined as the distance from the centerline of hitch pin/coupler to rear bumper of trailer. ** Fresh water capacity includes water heater. Please review owner's manual prior to purchase for more information on service warranties, extended use, towing and maintenance. Owner's manuals can be found at keystonerv.com.

PRINT 09.2023

MONTANA

LUXURY FIFTH WHEELS



Colton RV & Marine
3122 Niagara Falls Blvd.
North Tonawanda, NY 14120
(716) 694-0188
www.ColtonRV.com

Colton RV
3443 Southwestern Blvd.
Orchard Park, NY 14127
(716) 957-3250
www.ColtonRV.com

Colton RV
489 Bushkill Plaza LN #9665
Wind Gap, PA 18091
(610) 863-5239
www.ColtonRV.com



KEYSTONE
RV COMPANY

CAMPBETTER
KINDNESS · COMMUNITY · PLANET

MONTANA FIFTH WHEELS

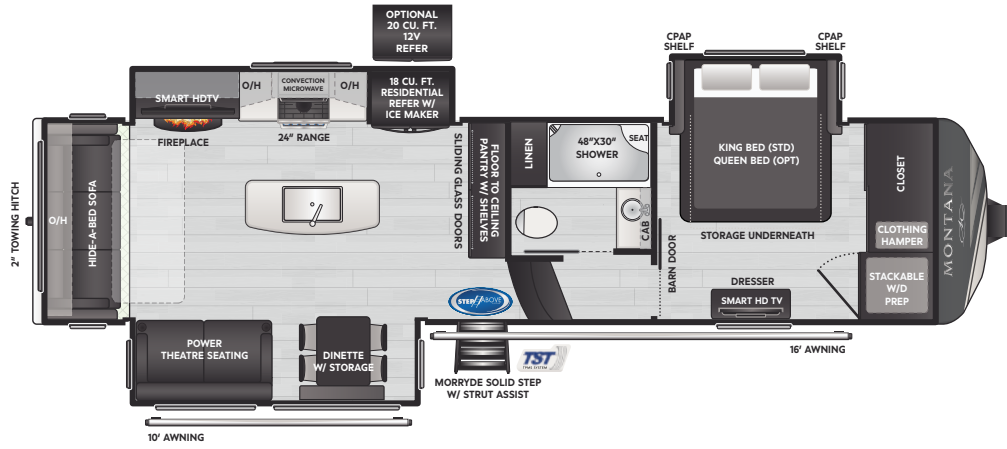

3123RL | WEIGHT 12482 | LENGTH 35' 1"

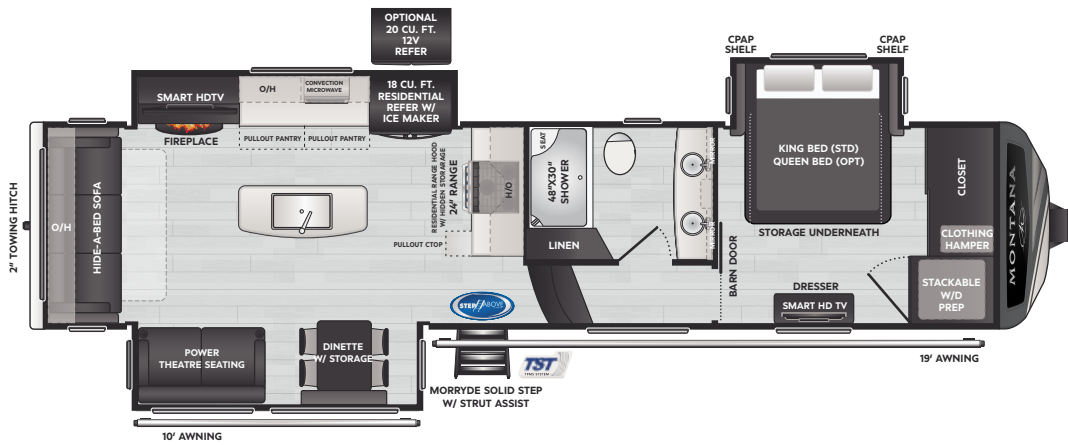

3231CK | WEIGHT 12903 | LENGTH 37' 5"

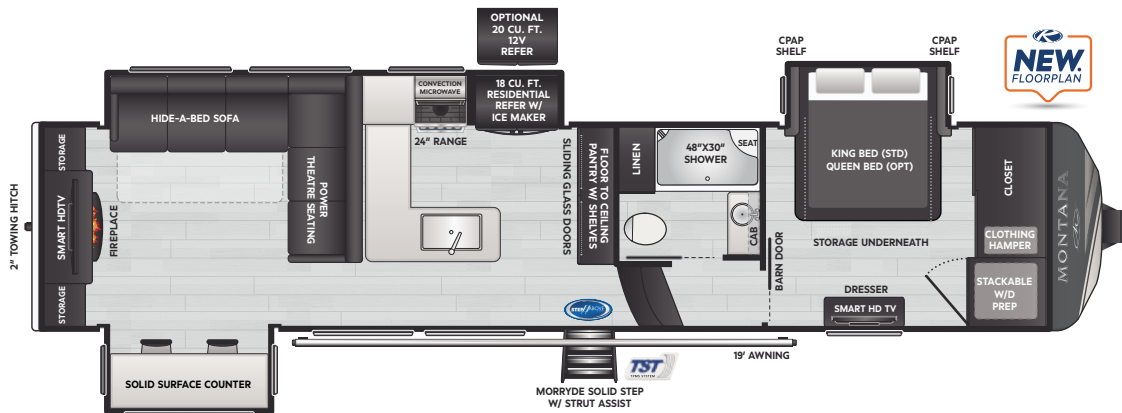

3531RE | WEIGHT TBD | LENGTH 38' 7"

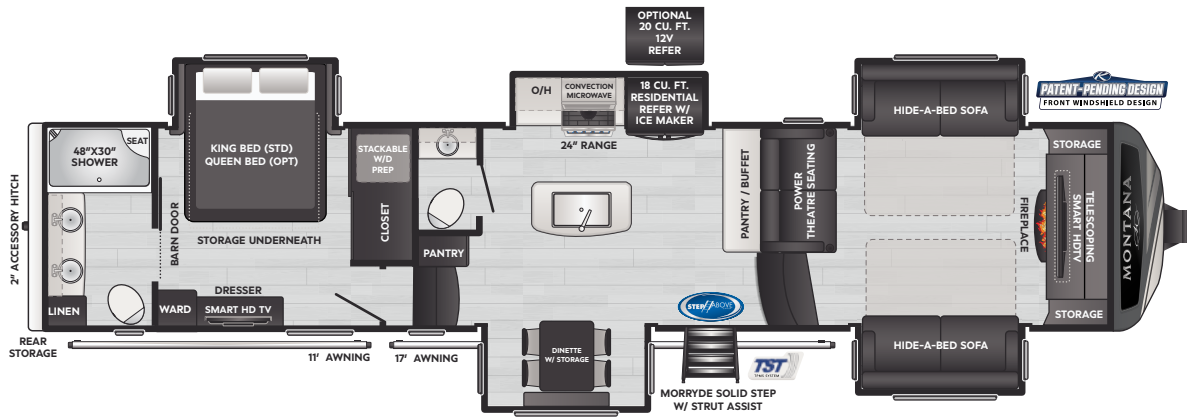

3761FL | WEIGHT 14518 | LENGTH 41' 0"

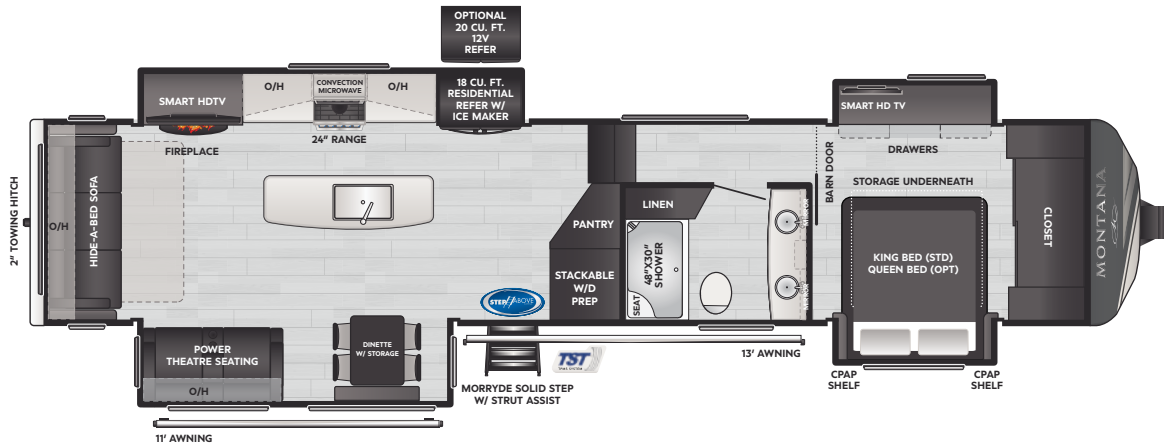

3781RL | WEIGHT 13790 | LENGTH 41' 0"

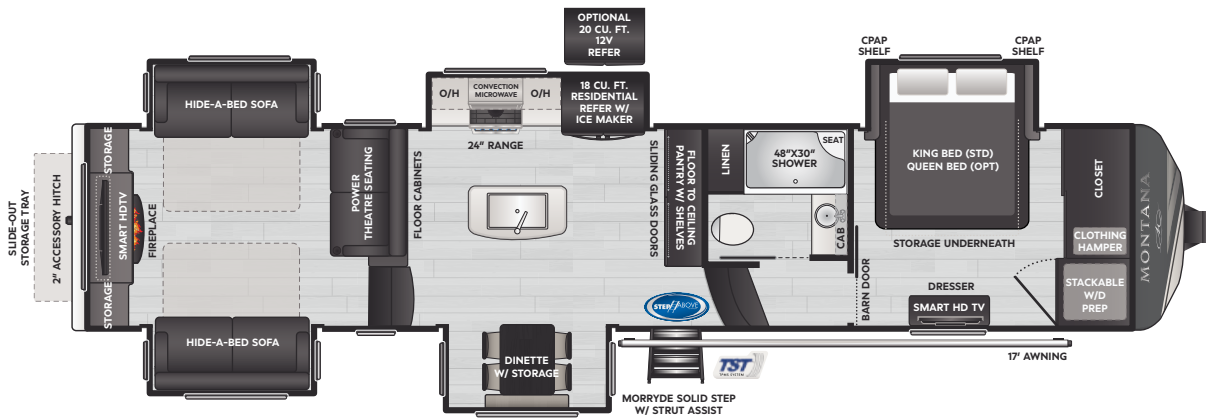

3793RD | WEIGHT 14373 | LENGTH 40' 5"

VISIT OUR WEBSITE FOR PHOTOS, 360° TOURS, AND FULL PRODUCT DETAILS



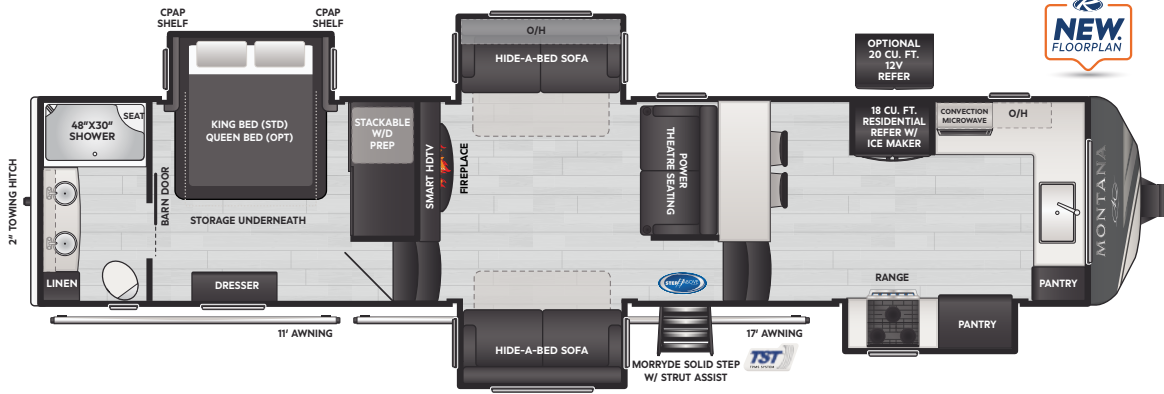

3795FK | WEIGHT TBD | LENGTH 39' 11"

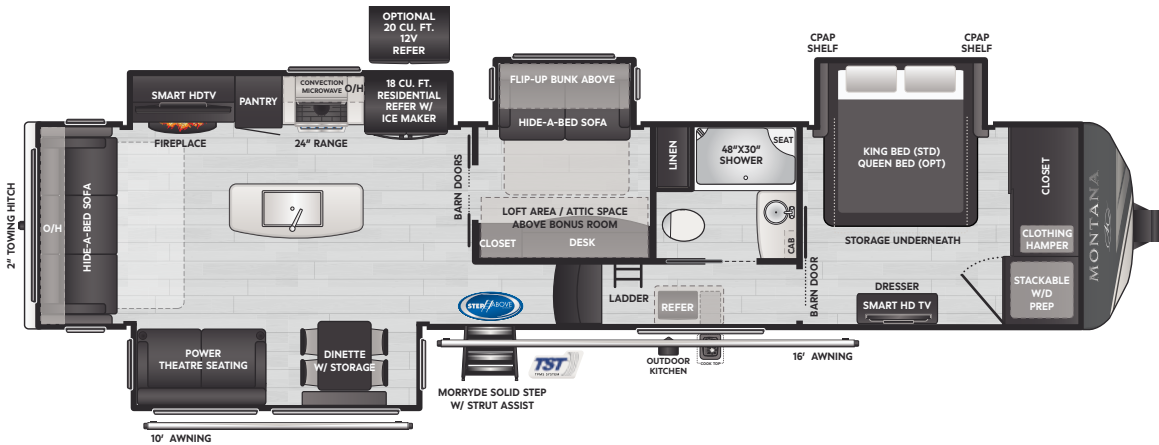

3857BR | WEIGHT 14143 | LENGTH 40' 11"

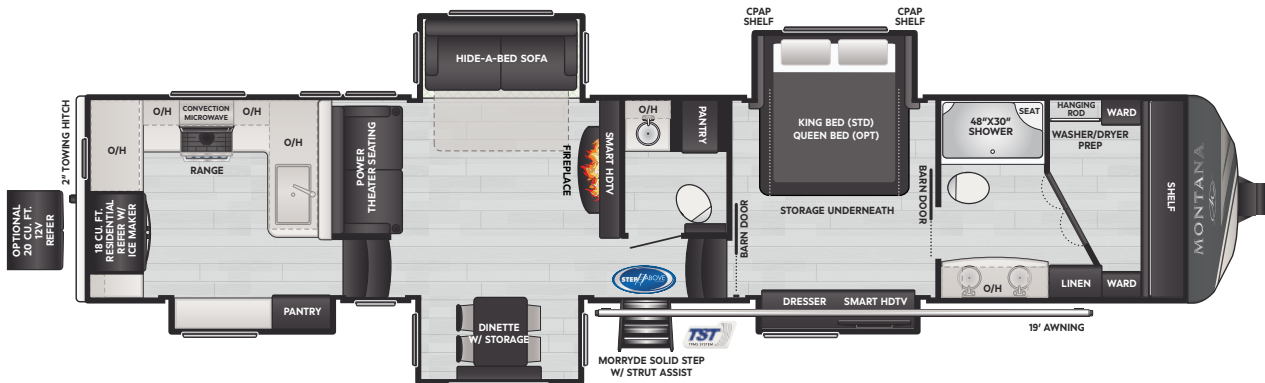

3901RK | WEIGHT 14541 | LENGTH 42' 4"

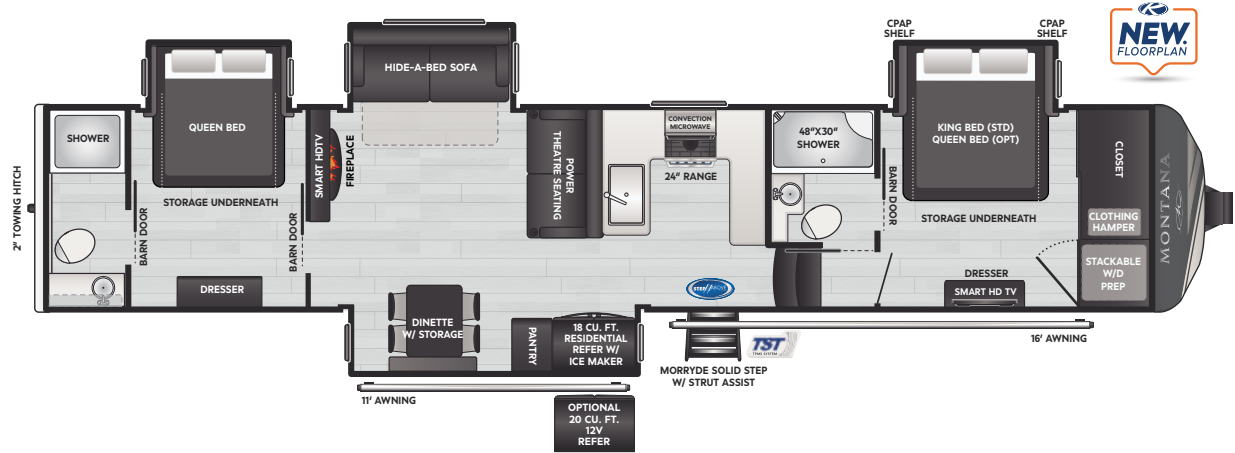

3915TB | WEIGHT TBD | LENGTH 42' 7"

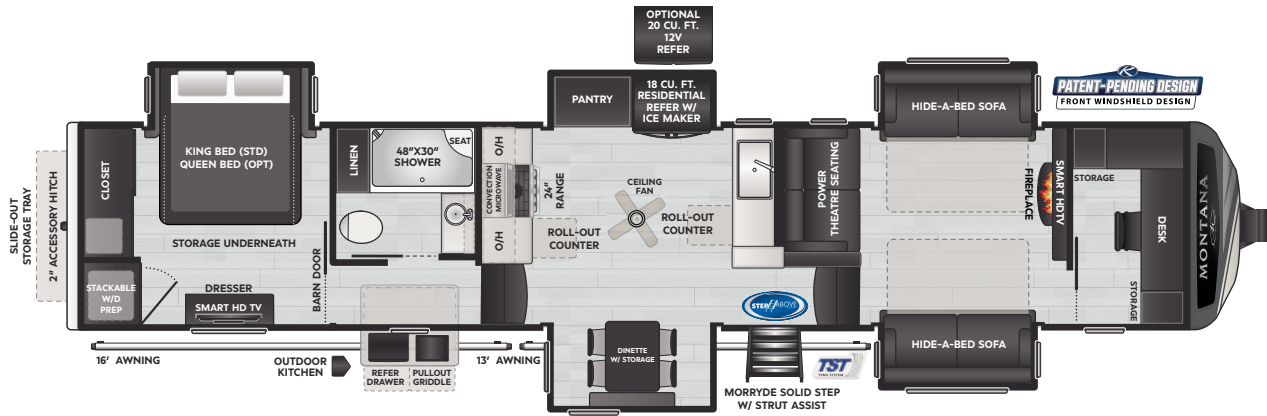

3941FO | WEIGHT 15285 | LENGTH 42' 7"

CRAFTSMANSHIP | A Living Legend

GENERATIONS OF EXPERIENCED CRAFTSPEOPLE HAVE WALKED THROUGH THE DOORS AT KEYSTONE'S PLANT 4 TO BUILD THIS LEGENDARY BRAND. TEAM MONTANA'S PASSION FOR SUPERIOR ENGINEERING, PROFOUND ATTENTION TO DETAIL, AND QUALITY CONSTRUCTION HAS DELIGHTED MORE THAN 100,000 OWNERS THROUGHOUT THE UNITED STATES AND CANADA.

MODEL	WEIGHT	CARRYING CAPACITY	HITCH WEIGHT	FRESH WATER**	WASTE WATER	GRAY WATER	LPG	LENGTH*	WIDTH	HEIGHT	AWNING
3123RL	12482	3868	2580	70	49	88	60	35' 1"	8'	13' 4"	16'/10'
3231CK	12903	3777	2680	70	49	88	60	37' 5"	8'	13' 4"	19'/10'
3531RE	TBD	TBD	TBD	70	49	88	60	38' 7"	8'	13' 4"	19'
3761FL	14518	2282	2880	70	88	88	60	41' 0"	8'	13' 4"	17'/11'
3781RL	13790	2810	2970	70	49	88	60	41' 0"	8'	13' 4"	13'/11'
3793RD	14373	2227	3130	70	49	88	60	40' 5"	8'	13' 4"	17'
3795FK	TBD	TBD	TBD	70	98	98	60	39' 11"	8'	13' 4"	17'/11'
3857BR	14143	2757	3050	70	49	88	60	40' 11"	8'	13' 5"	16'/10'
3901RK	14541	2259	2975	70	88	88	60	42' 4"	8'	13' 5"	19'
3915TB	TBD	TBD	TBD	70	98	137	60	42' 7"	8'	13' 4"	16'/10'
3941FO	15285	1525	2810	70	39	78	60	42' 7"	8'	13' 4"	16'/11'