

COACHMEN

| CLIPPER Hybrid Camping Trailers

Time to
Relax.



Coachmen
Leader to the Great Outdoors.



Coachmen Clipper

Presenting the all new 2013 Coachmen Clipper Hybrid Camping Trailer. Rebuilt from the ground up in ways you can see – new aerodynamic styling for ease of towing, full width stone guard to protect your investment, and radial tires for the safety you need and desire. These are but a few of the new features you will enjoy with your new Clipper!



Features you can't live without



Sliding Storage Trunk (SST)



New E-Z One-Hand Swing Level Galley
(Classics and V1)



Optional AM/FM/CD/DVD/MP3
Player with Int./Ext. Speakers
(Std. on Classics and V-Trec)



Exterior Utility Shelf

◀ **NEW One-Piece Entry Door**

The one-piece door features door panels that allows finite adjustment for air and sunlight. (N/A LS Series)



E-Z Swing Stepper Door



Optional Dometic® 3-Way Refrigerator



Dual Drive Dual Purpose Winch by Canimex

Scissor Style Stabilizer Jack



Optional Modular Cassette Potti with Electric Flush

Retractable Clothes Bar (Classics and V-Trec)

The Clipper Difference.

Construction & Features Competitors Can't Match

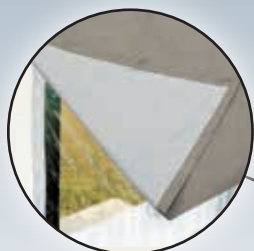

Lined drapes
for improved
privacy



Standard heated mattress
features a Sunbeam®
heating element.
(Opt. on 106 & 106ST)
(N/A on LS Series)



"Glide-N-Lock" bed system is
the only cable-supported bed
system in the industry. Simply
pull out the beds until they lock
into place. No more awkward
poles to contend with!



Largest heating capacity of any folding camper.

- Optional 20M BTU Suburban® Furnace with forced air, electronic ignition and thermostat control.

VRX-14
Supreme Tent with storm
cuff and tinted windows
(No Stormcuff on LS Series)



Polyflex woven moisture
barrier laminated to all
Clipper floors and bunks.

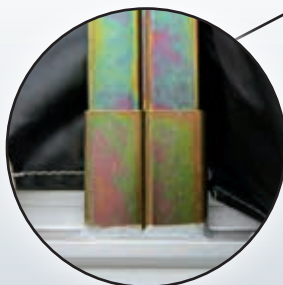

Goshen Stamping double-
wide lifter post with limited
lifetime warranty
(N/A 806 LS)

Portable in/out
dINETTE table

Wide Trac Suspension

**Better safety and stability
on the road.**

- Widest stance of any folding camper
- Improves towing safety and stability
- Stronger axle beams than most competitors
- Steel frame with powdercoat protection

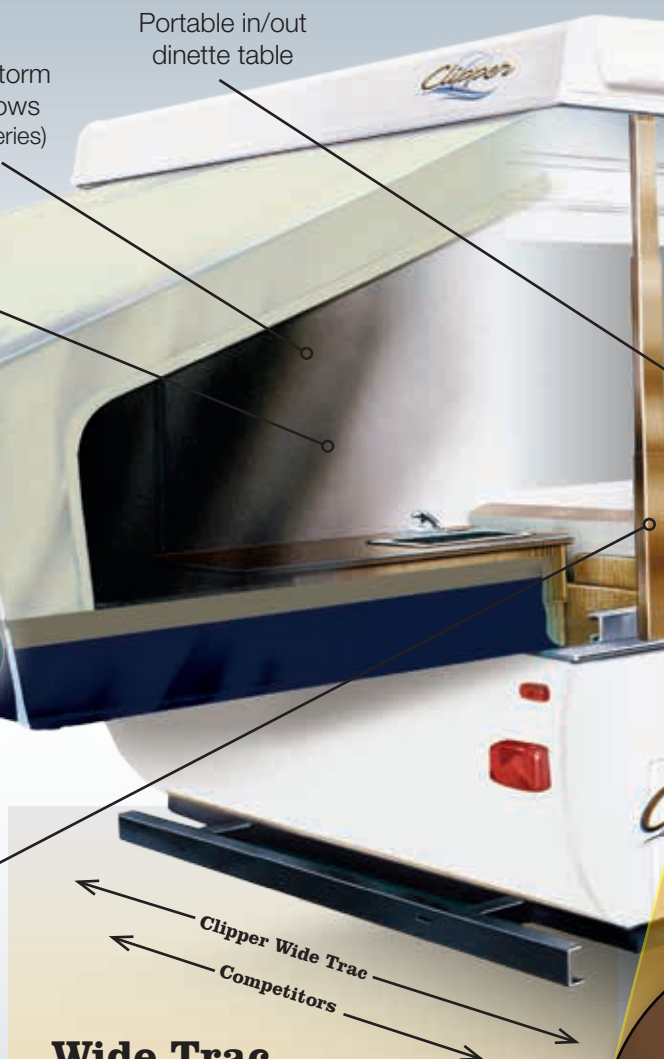

Dura Tuff Roof

A. One Piece Seamless Skin

B. Dura Tuff Wood Protective Layer

No one else includes the extra wood layer between the top skin and internal foam that provides stiffness and reduces the probability of damage due to hail, road debris, etc.

C. Foam Roof Structure

D. Steel Reinforced Wood Frame

The roof is framed with steel supports to accept A/C on all models without extra reinforcement.

- Roof vent is placed off to the side so the A/C can be center-mounted without having to remove the vent. This design allows you to have both the vent and A/C.



Roof Side Z-Rail Channels water away.

1. Roof's Outside Skin
2. Body's Outside Skin
3. Water tight Seal
4. Z-Rail channels water away from wood

- Z-Rails on roof perimeter and sidewalls keep wood above water level collection points.
- Others use U channel where wood and water can come in contact at the bottom of the channel.
- Channels are kept open to allow water to run out like a gutter.
- Others attempt to seal channels to keep water out; when the seal is compromised, water will collect and cannot escape.

1-1/4" Laminated Insulated Bunkend

(N/A 806 LS)

- Double the industry standard thickness
- Solid wood, steel reinforced frame filled with 1" thick high density foam and laminated with wood panel on top and bottom
- Yields a more stable bedend vs. chipboard or spliced plywood used by other brands
- Insulation improves comfort and warmth

Clipper Standard



Competition



Clipper
LS

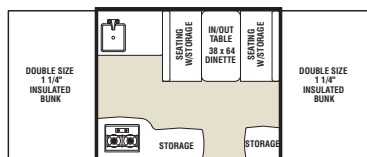

806 LS

Limited Warranty

- Lift System - Lifetime
- Vinyl Tent - 5 years
- Roll Out System - 5 years
- Frame - 5 years
- Roof Assembly - 5 years
- AL-KO® Ultralube Spring Axle - 1 year
- AL-KO® Ultralube Rubber Suspension Axle - 5 years
- Refrigerator - 3 years
- Plumbing System - 10/25 years
- Electronic Converter- 2 years
- Roof Exterior - 2 years

Clipper
Sport

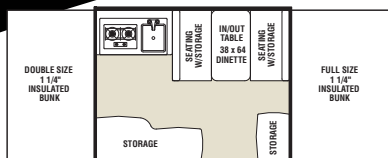

106

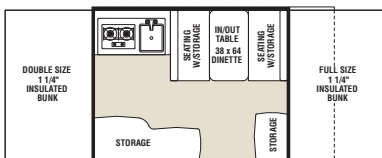

106 ST

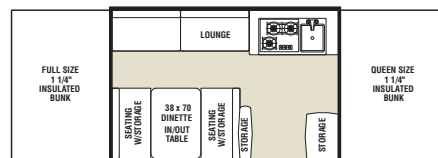

107

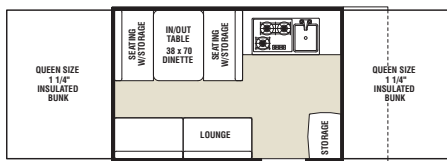

108 ST

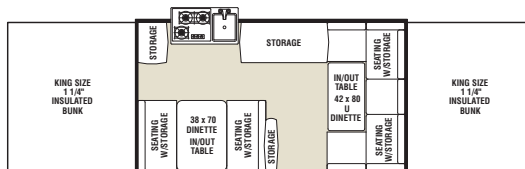

126

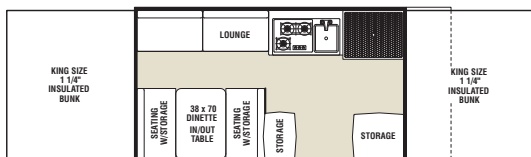

127 ST

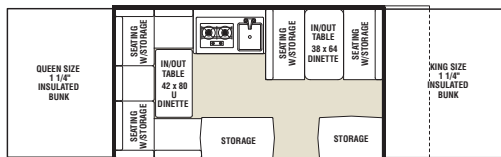

128 ST

Clipper
Classic

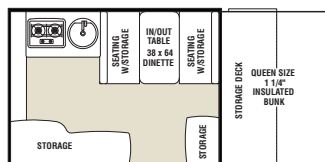

904 GS

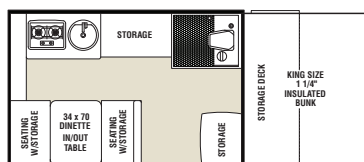

104 GS

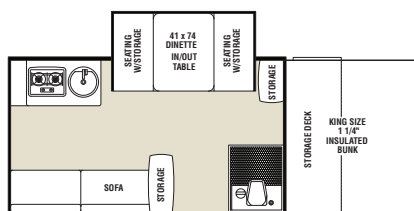

124 GS

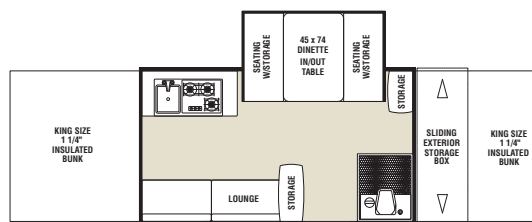

1285 SST

Standard Features

| Standard Features | | | | LSISICIV | | | | LSISICIV | | | | LSISICIV | | | | | | | | | | | |
|--|--|--|--|----------|--|--|--|---|--|--|--|----------|--|--|--|---|--|--|--|--|--|--|--|
| CHASSIS | | | | | | | | One Piece Screen Door | | | | | | | | Mortise and Tenon Residential Cabinet Doors | | | | | | | |
| Tubular Steel Frame | | | | | | | | 4 Layer Laminated Seamless Fiberglass Roof Prebraced for A/C (3 Layer on LS) | | | | | | | | Residential Laminted Countertops | | | | | | | |
| Dual Drive Winch by Canimex | | | | | | | | Exterior High Pressure LP Tank Hook-up | | | | | | | | Ultra Comfor 4" Heated Mattresses with Sunbeam Element (N/A LS) (Optional 106, 106ST) | | | | | | | |
| Heavy Duty Dolly Jack with Wheel | | | | | | | | VRX Sectionalized Tent with Storm Cuff (Storm Cuff N/A LS Series) | | | | | | | | Ultra Comfort 4" High Density Cushions | | | | | | | |
| Wide Trac UltraLube Spring Suspension | | | | | | | | Laminated/Insulated Bed Platforms (N/A LS) | | | | | | | | Lined Privacy Drapes (Vented on Bed Ends) | | | | | | | |
| Wide Trac UltraLube Torsion Suspension | | | | | | | | Glide-n-Lock Cable Supported Bed System | | | | | | | | E-Z Swing Galley with Drawer | | | | | | | |
| Electric Brakes (Optional on LS) | | | | | | | | Exterior Utility Shelf | | | | | | | | Euro Style Fixed Galley (Classic GS Models) | | | | | | | |
| Radial Tires | | | | | | | | Above Floor 16 Gallon Fresh Water Tank (106, 106ST, and LS Only) | | | | | | | | Deep Bowl Acrylic Sink | | | | | | | |
| Aluminum Rims | | | | | | | | 23 Gallon Below Floor Fresh Water Tank (N/A on 106, 106ST, and 106 ST Models) | | | | | | | | 3 Burner Range (2 Burner on 806LS, 106, 106ST And GS Models) | | | | | | | |
| Scissor Jacks w/Pads (4) | | | | | | | | 25 AMP Converter with Battery Charger (12 AMP on LS) | | | | | | | | 12 Volt On Demand Water Pump | | | | | | | |
| Scissor Jacks w/Pads (2) | | | | | | | | 120 Volt GFI Exterior Recept | | | | | | | | Built in Shower (127ST, 1285SST, 104GS, 124GS, and V3) | | | | | | | |
| Goshen Lift System w/Double Arms (Single arm on 806 LS) | | | | | | | | Amber Patio Light | | | | | | | | Thetford Cassette Potti (1285SST, 104GS, 124GS, and V3) | | | | | | | |
| EXTERIOR | | | | | | | | "SST" Super Sliding Storage Compartment 1285SST (Optional on 904GS, 104GS, 124GS, and V1) | | | | | | | | DSI 6 Gallon Water Heater 127ST 1285SST, 904GS, 104GS, 124GS, V1, and V3 | | | | | | | |
| "Zero Exposure" Floor and Bunk Technology | | | | | | | | Exterior Storage Access Door(s) (N/A on LS, 106, 107, 126, and V1) | | | | | | | | Indoor/Outdoor Dinette Table | | | | | | | |
| Laminated Aluminum Skin Walls | | | | | | | | Create a Breeze Power Roof Vent | | | | | | | | 12 Volt Interior Lights | | | | | | | |
| Laminated Hi-Gloss Fiberglass Walls | | | | | | | | INTERIOR | | | | | | | | 120 Volt Interior Outlets | | | | | | | |
| Laminated Hi-Gloss Tan Fiberglass Walls (GS Models) | | | | | | | | 100% Adhesion Residential Grade Linoleum | | | | | | | | Retractable Clothes Bar | | | | | | | |
| Laminated Hi-Gloss Gray Fiberglass Walls (V-Trec Models) | | | | | | | | Deep Maple Cabinetry | | | | | | | | HD Park Cable Hookup | | | | | | | |
| Diamond Plate Front Wall Protector (N/A 1285SST) | | | | | | | | | | | | | | | | Powdercoated Interior Tent Support Poles | | | | | | | |
| E-Z Swing Stepper Door | | | | | | | | | | | | | | | | | | | | | | | |

Popular Options

| Popular Options | | | | LSISICIV | | | | LSISICIV | | | | LSISICIV | | | |
|--|--|--|--|--|--|--|--|--|--|--|--|--|--|--|--|
| Essentials Package | | | | <div>DSI Hot Water System with Hot/Cold Exterior Shower (106 ST, 107, 108ST, 126 and 128ST ONLY)</div> <div>Electric Brakes (806LS Only)</div> <div>Screenroom with Privacy Flaps</div> <div>Single LP Bottle Cover (N/A V1 & V3)</div> <div>Double LP Bottles Rings and Cover (Std. on V1, and V3)</div> <div>Hanging Storage Cabinet</div> <div>Bed End Fan Light (1 Std. on Classic and V Trec)</div> | | | | <div>Second Bed End Fan Light (N/A LS, GS Models)</div> | | | | <div>Ultra Comfort 4" Heated Mattresses with Sunbeam Element (106, 106ST Only)</div> | | | |
| ✓ 3-Way Dometic® Refrigerator 1.9 Cu. Ft. (2.5 Cu. Ft. on Classic and V3) | | | | | | | | <div>A/C Wiring Kit</div> | | | | <div>AM/FM/CD/DVD Player w/Exterior Speakers (Std. on Classic and V-Trec)</div> | | | |
| ✓ 20,000 BTU Furnace | | | | | | | | <div>Coleman Outdoor Grill and Stand</div> | | | | <div>SSTSuper Sliding Storage Trunk (GS and V1)</div> | | | |
| ✓ A & E Awning | | | | | | | | <div>Laminated High Gloss Tan Fiberglass Walls (Std. on GS Models)</div> | | | | | | | |
| ✓ Spare Tire, Carrier and Cover | | | | | | | | | | | | | | | |
| ✓ 72" High Pressure LP Accessory Hose (N/A LS) | | | | | | | | | | | | | | | |
| Thetford Modular Cassette Potti with Electric Flush (107, 108ST, 127ST, 904GS, and V1) | | | | | | | | | | | | | | | |

LS = LS Series S = Classic Sport C = Classic V = V-Trec ■ = Available ■ = New Feature ■ = Standard Run Option

Specifications

| Specifications | 806 LS | 106 | 106ST | 107 | 108 ST | 126 | 128 ST | 127ST | 904GS | 104GS | 124GS | 1285SST | V1 | V3 |
|---------------------------|------------|------------|------------|-------------|-------------|-------------|-------------|-------------|-------------|-------------|-------------|-------------|-------------|-------------|
| | LS Models | Sport | | | | | | | Classic | | | | V-Trec | |
| Interior Box Size | 8' | 8.5' | 8.5' | 10' | 10' | 12' | 12' | 12' | 9' | 10' | 12' | 12' | 10' | 12' |
| Travel Length | 12' 2" | 12' 8" | 14' 10" | 14' 2" | 16' 4" | 16' 2" | 18' 3" | 18' 3" | 15' 9" | 16' 9" | 18' 5" | 18' 5" | 16' 9" | 21' 4" |
| Travel Width | 85" | 85" | 85" | 85" | 85" | 85" | 85" | 85" | 85" | 85" | 85" | 85" | 85" | 85" |
| Travel Height | 54" | 56" | 56" | 58" | 58" | 58" | 58" | 58" | 55" | 55" | 55" | 55" | 65" | 65" |
| Interior Open Length | 16' 11" | 17' 11" | 17' 11" | 20' 5" | 20' 9" | 24' 5" | 23' 5" | 24' 5" | 14' | 16' | 18' | 24' 5" | 20' 5" | 24' 5" |
| Interior Open Height | 6' 10" | 6' 10" | 6' 10" | 6' 10" | 6' 10" | 6' 10" | 6' 10" | 6' 10" | 6' 10" | 6' 10" | 6' 10" | 6' 10" | 6' 10" | 6' 10" |
| Sleeping Capacity | 6 | 6 | 6 | 7 | 7 | 7 | 8 | 7 | 4 | 4 | 6 | 6 | 6 | 6 |
| Front Sleeping Area | 48 X 80 | 54 X 80 | 54 X 80 | 58 X 80 | 58 X 80 | 70 X 80 | 70 X 80 | 70 X 80 | 58 X 80 | 70 X 80 | 70 X 80 | 70 X 80 | 58 X 80 | 70 X 80 |
| Rear Sleeping Area | 48 X 80 | 48 X 80 | 48 X 80 | 54 X 80 | 58 X 80 | 70 X 80 | 58 X 80 | 70 X 80 | N/A | N/A | N/A | 70 X 80 | 58 X 80 | 70 X 80 |
| Dinette Area | 38 X 64 | 38 X 64 | 38 X 64 | 38 X 70 | 38 X 70 | 38 X 70 | 38 X 64 | 38 X 70 | 38 X 64 | 34 X 70 | 41 X 74 | 41 X 74 | 38 X 70 | 41 X 74 |
| "U" Dinette | N/A | N/A | N/A | N/A | N/A | N/A | 42 X 80 | N/A | N/A | N/A | N/A | N/A | N/A | N/A |
| Lounge Area | N/A | N/A | N/A | 80" | N/A | 80" | N/A | N/A | N/A | N/A | N/A | N/A | N/A | N/A |
| Sofa Bed | N/A | N/A | N/A | N/A | 34 X 76 | N/A | N/A | 34 X 70 | N/A | N/A | 40 X 72 | N/A | N/A | N/A |
| Radial Tire Size | 4.80 X 12 | ST145R12 | ST145R12 | ST145R12 | ST175/80R13 | ST175/80R13 | ST175/80R13 | ST175/80D13 | ST175/80R13 | ST175/80R13 | ST175/80R13 | ST175/80R13 | LT235/75R15 | LT235/75R15 |
| Tire Load Range | 4 Bolt C | 4 Bolt C | 4 Bolt C | 4 Bolt C | 5 Bolt D | 5 Bolt D | 5 Bolt D | 5 Bolt D | 5 Bolt D | 5 Bolt D | 5 Bolt D | 5 Bolt D | 5 Bolt C | 5 Bolt C |
| Hitch Weight (lbs./Kg)* | 120/55 | 116 / 53 | 184 / 83 | 171 / 78 | 187 / 85 | 243 / 110 | 191 / 87 | 245 / 111 | 241 / 109 | 271 / 123 | 260 / 118 | 282 / 128 | 252 / 114 | 420 / 191 |
| Axle Weight (lbs./Kg)* | 1138 / 517 | 1338 / 607 | 1381 / 627 | 1448 / 657 | 1667 / 756 | 1722 / 781 | 1859 / 843 | 1913 / 868 | 1777 / 806 | 1874 / 850 | 2256 / 1023 | 2403 / 1090 | TBD | 2700 / 1225 |
| Dry Weight (lbs./Kg) ** | 1305 / 591 | 1503 / 682 | 1651 / 749 | 1740 / 789 | 1863 / 845 | 1982 / 899 | 2154 / 977 | 2199 / 997 | 2018 / 915 | 2162 / 981 | 2516 / 1141 | 2702 / 1226 | 2233 / 1013 | 3065 / 1390 |
| Cargo Capacity (lbs./Kg)* | 778 / 353 | 813 / 369 | 733 / 332 | 631 / 286 | 824 / 374 | 761 / 345 | 1257 / 570 | 1266 / 574 | 1426 / 647 | 1329 / 603 | 947 / 430 | 800 / 363 | 1519 / 689 | 1325 / 601 |
| GVWR (lbs./Kg)* | 2098 / 952 | 2096 / 951 | 2200 / 999 | 2400 / 1089 | 2702 / 1227 | 2743 / 1244 | 3464 / 1571 | 3481 / 1579 | 3461 / 1570 | 3491 / 1584 | 3480 / 1579 | 3502 / 1588 | TBD | 4380 / 1987 |
| Coupler Ball Size | 2" | 2" | 2" | 2" | 2" | 2" | 2" | 2" | 2" | 2" | 2" | 2" | 2-5/16" | 2-5/16" |

*Weights shown are approximate.
** Dry Weight shown is the total weight of the standard unit (hitch + axle) without optional equipment and empty tanks.

V-Trec

Specs | V1 V3

| | | |
|---------------------------------------|-------------|-------------|
| Interior Box Size | 10' | 12' |
| Travel Length | 16'9" | 21' 4" |
| Travel Width | 85" | 85" |
| Travel Height | 65" | 65" |
| Interior Open Length | 20'5" | 24' 5" |
| Interior Open Height | 6' 10" | 6' 10" |
| Sleeping Capacity | 6 | 6 |
| Front Sleeping Area | 58 X 80 | 70 X 80 |
| Rear Sleeping Area | 58 X 80 | 70 X 80 |
| Dinette Area | 38 X 70 | 45 X 73 |
| "U" Dinette | N/A | N/A |
| Lounge Area | N/A | N/A |
| Sofa Bed | N/A | N/A |
| Radial Tire Size | LT235/75R15 | LT235/75R15 |
| Tire Load Range | 5 Bolt C | 5 Bolt C |
| Hitch Weight # (approx.), (lbs./Kg) | 252/114 | 420/191 |
| Axle Weight # (approx.), (lbs./Kg) | 1981/899 | 2700/1225 |
| Dry Weight # (approx.), (lbs./Kg) ** | 2233/1013 | 3065/1390 |
| Cargo Capacity # (approx.), (lbs./Kg) | 1519/689 | 1325/601 |
| GVWR (lbs./Kg) | 3752/1702 | 4380/1987 |
| Coupler Ball Size | 2-5/16" | 2-5/16" |



V1

AT COACHMEN,
we're all about easy.
Our motorhomes, fifth
wheels, travel trailers
and folding campers
are designed to be easy
to use, easy to enjoy,
easy to own. And our
no hassle warranty
keeps them that way.

**Heavier Duty
Than Other
Folding
Campers!**

V-Trec Series

- 5" Tube Frame • 4000 Lb. Torsion Axle for Heavy Cargo Capacity
- Reinforced Diamond Plate Front Deck

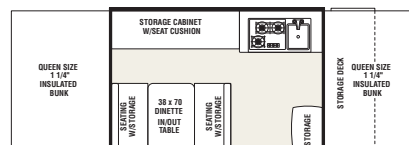

V1

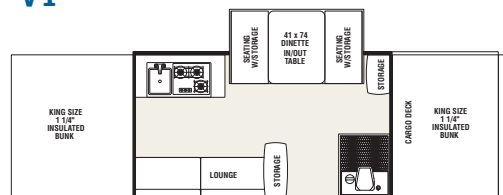

V3



Coachmen

Leader to the Great Outdoors.



**Coachmen
Recreational Vehicles**
A Forest River Company
580 West Burr Oak Street
P.O. Box 549
Centreville, MI 49032
269.467.6321

To learn more about
Coachmen RV and our
products and see how
Coachmen is making
the easy life easier, visit
www.coachmenrv.com.



Free Roadside Assistance

Coachmen provides one
year of free Travel Easy™

emergency roadside assistance for those who buy
a new Coachmen RV. Administered by Coach-Net®,
this service gives Coachmen owners 24/7 access to
operational, technical and emergency road services,
including towing, fuel delivery, jump starts, lockout
service, tire changes, mobile mechanic and unlimited
technical advice. So no matter where you go, we're
ready to help!



Big Benefits For New Owners

Owners club discounts and
more — A free one-year membership in the Coachmen
Owners Association comes with the purchase of any
Coachmen product. This add-on value not only provides
a host of travel services and campground discounts, but
also a 24/7 online service that locates needed services
while offering member savings at more than 180,000
merchants across the country. And, of course, the COA
is an excellent way to share experiences with other
Coachmen owners through rallies and caravans.



**Forest River, Inc. encourages
our customers to purchase
their Forest River products
from a local dealership
whenever possible for the
following reasons:**

- 1) Forest River, Inc. dealers are independently owned and operated businesses so priority service and scheduling is at their discretion and is often provided to customers that purchased their unit at that dealership.
- 2) Purchasing locally allows customers to establish meaningful relationships with a dealer, enhancing the RV experience through assistance with product questions, user tips or RV regulations for your state or country, and much more!
- 3) Canadian customers must meet requirements to bring an RV purchased out of the country to their home. These requirements may involve additional inspections and certifications, taxes and fees. Your local Canadian Dealer is a professional at meeting these requirements.
- 4) Scheduling timely warranty repairs and adjustments through a local dealership provides far greater flexibility and convenience to you, the customer!

It is the goal of Forest River, Inc. that all of our RV owners fully enjoy the RV experience and that customer satisfaction meets or exceeds their expectations!



Learn More
Scan this barcode using a QR Reader
on your smart phone to learn more
about Forest River.



A Berkshire Hathaway company.

Contact your Clipper Dealer for a complete list of parts and accessories:

Colton RV
North Tonawanda, NY 14120
(716) 694-0188
(800) 628-4889
www.ColtonRV.com

Colton RV
Orchard Park, NY 14127
(716) 957-3250
(800) 628-4889
www.Coltonrv.com

All information contained in this brochure is believed to be accurate at the time of publication. However, during the model year, it may be necessary to make revisions and Coachmen reserves the right to make all such changes without notice, including changes in prices, colors, materials, equipment and specifications, as well as the addition of new models and the discontinuance of models shown in this brochure. Therefore, please consult with your Coachmen dealer and confirm the existence of any materials, design or specifications that are material to your purchase decision.