

MONTANA

LUXURY FIFTH WHEEL

Colton RV & Marine
3122 Niagara Falls Blvd.
North Tonawanda, NY 14120
(716) 694-0188
www.ColtonRV.com

Colton RV
3443 Southwestern Blvd.
Orchard Park, NY 14127
(716) 957-3250
www.ColtonRV.com

Colton RV
489 Bushkill Plaza LN #9665
Wind Gap, PA 18091
(610) 863-5239
www.ColtonRV.com



KEYSTONE
RV COMPANY

CAMP BETTER

WARRANTY FOR
FULL TIME RVING*

*RESIDENCE REQUIRED. RV COMPANY FINANCIAL PARTIAL FOR LIMITED WARRANTY DETAILS.



MONTANA 3781RL



MONTANA 3781RL

2023 MONTANA | EXCEPTIONAL FEATURES

- **NEW** 50" SMART TV IN THE LIVING ROOM
- JBL CUBE STEREO WITH MIZONE CONTROL & SUBWOOFER
- HARDWOOD CABINET DRAWERS, DOORS & STILES
- SOLID SURFACE COUNTERTOPS
- **NEW** ISLAND DESIGN W/ CURVED BOOKSHELF AND FRONT ACCENT FRAMES
- LARGER, 24" FURRION STOVE W/ MATCHING STAINLESS STEEL DRAWER
- STAINLESS STEEL CONVECTION MICROWAVE
- 18 CU. FT. RESIDENTIAL REFRIGERATOR W/ ICE MAKER (OPT. 18 CU. FT. GAS/ELECTRIC)
- **NEW** 32" SMART TV IN THE BEDROOM
- STRATEGICALLY PLACED INVERTED OUTLETS
- **NEW** BEL-AIR VINYL FLOORING BY SHAW WITH 7-YEAR COLD CRACKING WARRANTY
- **NEW** ADJUSTABLE 23" DUAL-BURNER SUBURBAN GRIDDLE IN OUTDOOR KITCHENS
- 30" X 78" OVERSIZED ENTRY DOOR
- FOUR-SEASON WEATHER PROTECTION, TESTED & APPROVED FOR 0° USAGE
- **NEW** 16-GALLON GAS/ELECTRIC SUBURBAN WATER HEATER
- SEAFLO® WATER PUMP, 12 DB QUIETER
- **NEW** 35,000 BTU DOMETIC FURNACE & UP TO 16,500 BTU HEAT PUMP
- DUAL, POWER-SAVER ACS (EACH <12 AMP DRAW)
- BLADE PURE™ HIGH PERFORMANCE AIR FLOW SYSTEM W/ MERV 9 FILTRATION
- WASHER/DRYER PREP
- ROAD ARMOR™ SUSPENSION W/ 1/2" SHACKLE PLATES, WET BOLTS & BRONZE BUSHINGS
- SAILUN 16" G-RATED TIRES
- TST TIRE PRESSURE MONITORING SYSTEM
- DEXTER® GLADIATOR™ AXLES
- SOLARFLEX™ 400i & STATE-OF-THE-ART 1200i-L PACKAGE UPGRADES W/ OPTIONAL DRAGONFLY ENERGY® LITHIUM-ION BATTERIES
- OPTIONAL LEGACY PACKAGE W/ DISC BRAKES & FULL-BODY PAINT



MONTANA OWNER'S CLUB

Welcome to the Montana Family! As an owner, you have the opportunity to get involved with the Montana Owner's Club, an independently run group built around this legendary brand. Through the MOC forum, you will be privy to insider tips, technical advice, and the incredible fellowship this community offers. Join fellow members at regional and national rallies, including the club's annual campout near Keystone headquarters in Goshen, Indiana.

TO CHECK OUT MORE AND JOIN THE COMMUNITY, GO TO WWW.MONTANAOWNERS.COM/FORUMS



VISIT OUR WEBSITE FOR PHOTOS, 360° TOURS, AND FULL PRODUCT DETAILS



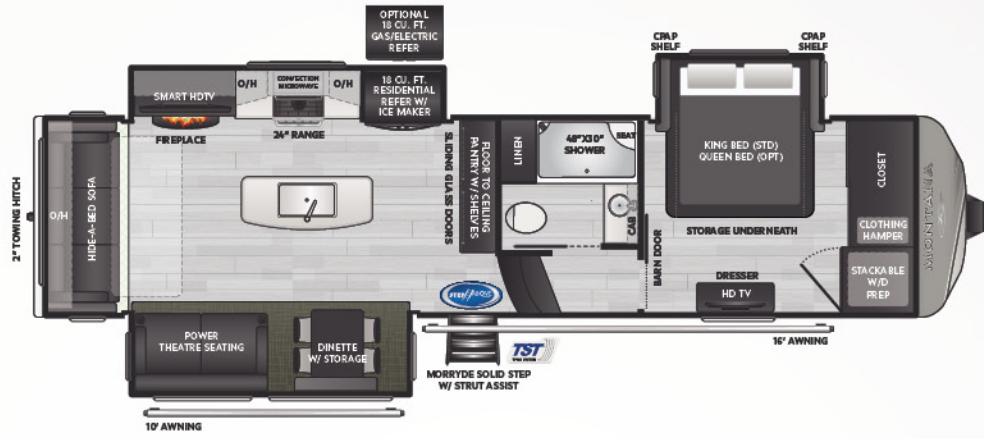

NEW! **3123RL** | WEIGHT 12315 | LENGTH 35' 1"

▪ REAR LIVING, MID-KITCHEN, MASTER CLOSET

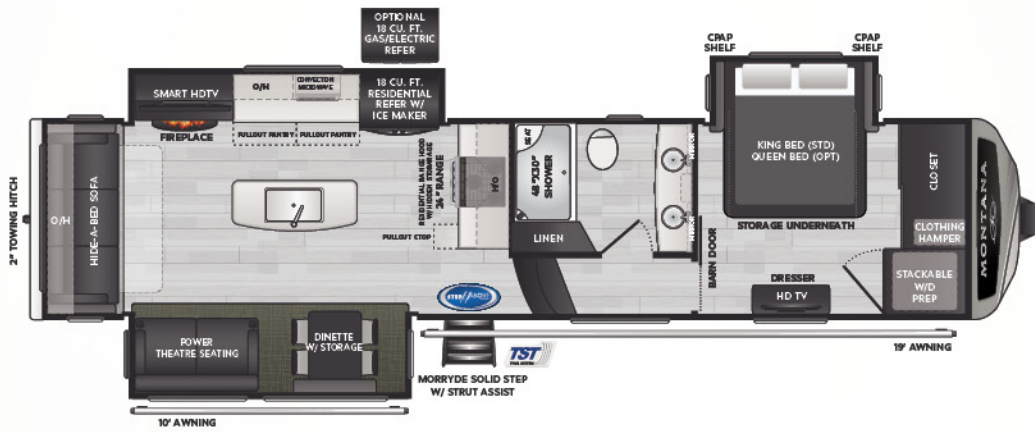

3231CK | WEIGHT 12770 | LENGTH 37' 5"

▪ CENTER KITCHEN, THREE SLIDES, DUAL VANITY BATH

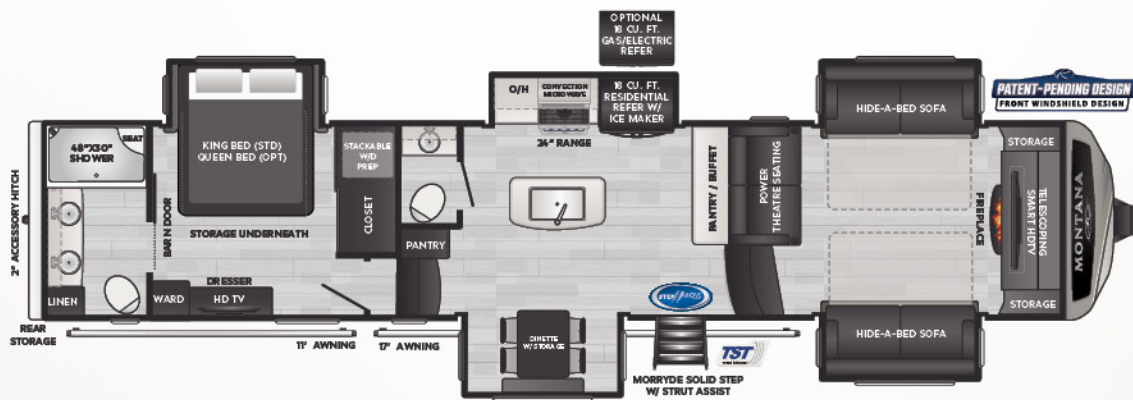

3761FL | WEIGHT 14345 | LENGTH 41' 0"

▪ FRONT LIVING, FIVE SLIDES, 1-1/2 BATHS

SLIDE-OUT FLOOR PLANS

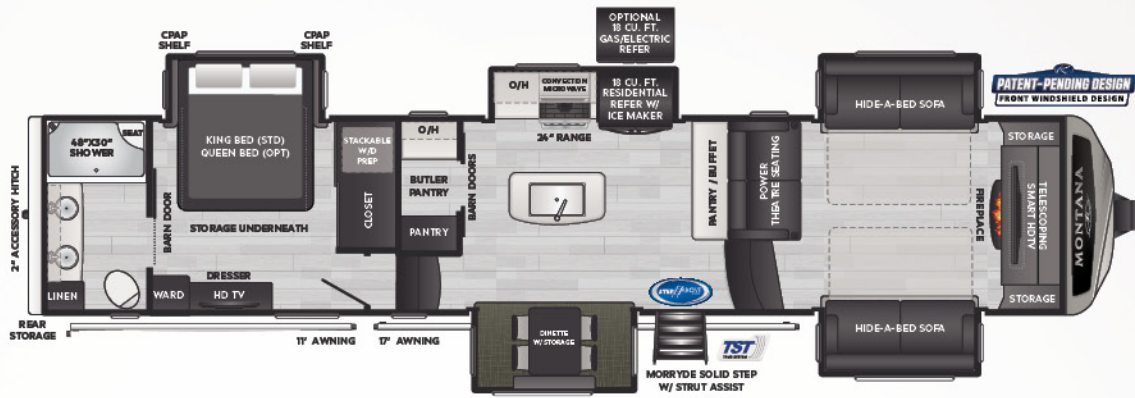

3763BP | WEIGHT 14261 | LENGTH 41' 0"

▪ FRONT LIVING W/ BUTLER'S PANTRY, FIVE SLIDES

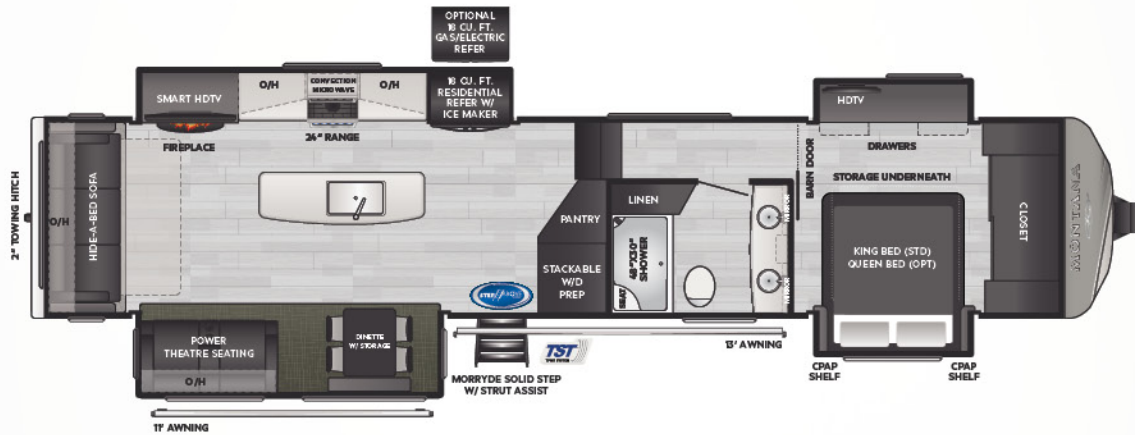

3781RL | WEIGHT 13588 | LENGTH 41' 0"

▪ REAR LIVING W/ DOUBLE VANITY BATHROOM & DOUBLE SLIDE BEDROOM

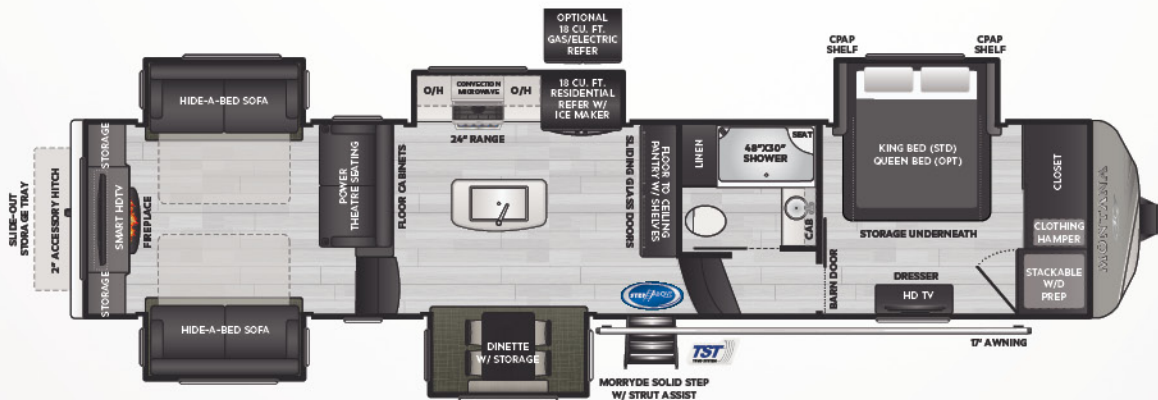

NEW! 3793RD | WEIGHT 14550 | LENGTH 40' 5"

▪ ELEVATED REAR DEN, MID-KITCHEN, REAR PULLOUT TRAY

FLOOR PLANS

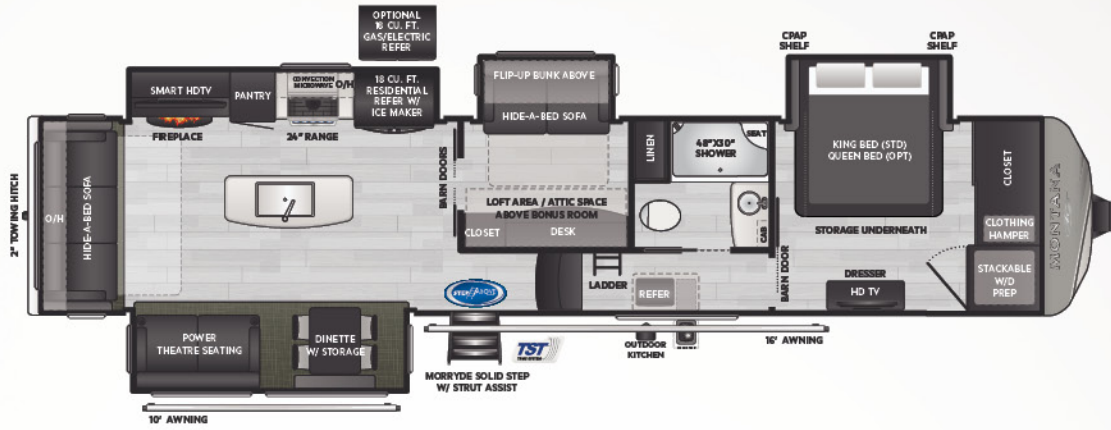

NEW! 3857BR | WEIGHT TBD | LENGTH 40' 11"

- BONUS ROOM, FLIP-UP BUNK, LOFT, OUTDOOR KITCHEN

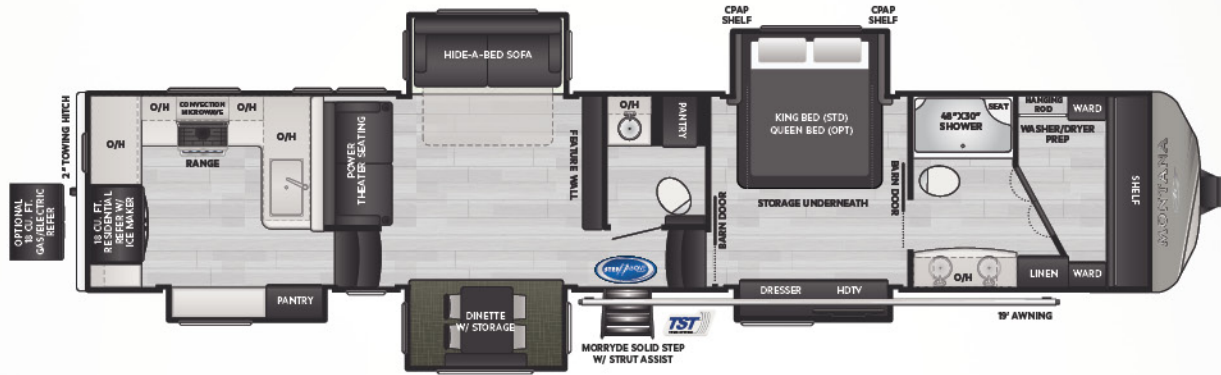

NEW! 3901RK | WEIGHT 14610 | LENGTH 42' 4"

- REAR KITCHEN, FRONT BATH AND WALK-IN WARDROBE

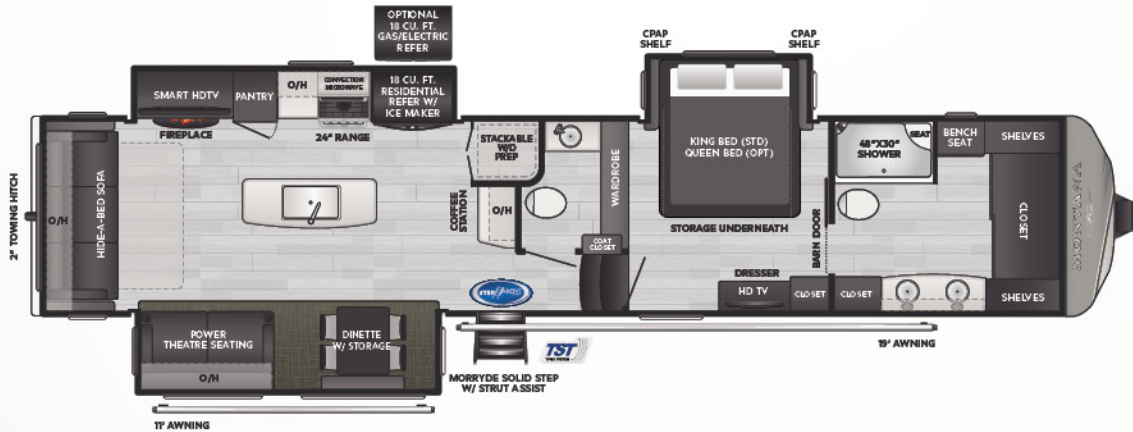

3931FB | WEIGHT 13595 | LENGTH 41' 4"

- FRONT BATH AND WALK-IN WARDROBE, 1/2 BATH

MODEL	WEIGHT	CARRYING CAPACITY	HITCH WEIGHT	FRESH WATER**	WASTE WATER	GRAY WATER	LPG	LENGTH*	WIDTH	HEIGHT	AWNING
3123RL	12315	4035	2580	70	49	88	60	35' 1"	8'	13' 4"	16'/10'
3231CK	12770	3910	2680	70	49	88	60	37' 5"	8'	13' 4"	19'/10'
3761FL	14345	2455	2880	70	88	88	60	41' 0"	8'	13' 4"	17'/11'
3763BP	14261	2719	2980	70	49	88	60	41' 0"	8'	13' 4"	17'/11'
3781RL	13588	3012	2695	70	49	88	60	41' 0"	8'	13' 4"	13'/11'
3793RD	14550	2050	3130	70	49	88	60	40' 5"	8'	13' 4"	7'
3857BR	TBD	TBD	TBD	70	49	88	60	40' 11"	8'	13' 5"	16'/10'
3901RK	14610	2190	3300	70	88	88	60	42' 4"	8'	13' 5"	19'
3931FB	13595	2905	2530	70	88	88	60	41' 4"	8'	13' 5"	19'/11'



TAKE CHARGE OF HOW YOU CAMP

EXCEPTIONAL QUALITY, IMPOSSIBLY VERSATILE, SolarFlex™ IS SHATTERING CUSTOMER'S EXPECTATIONS OF FACTORY-INSTALLED SOLAR POWER. EXCLUSIVELY AVAILABLE ON ALL KEYSTONE RV MODELS.



Relieve battery anxiety with legendary Lithium-ion deep cycle batteries – the ultimate replacement for lead acid. Lightweight, reliable, and longer-lasting, Dragonfly Energy batteries are made in the USA and available exclusively from Keystone RV and authorized dealers.

MY KEYSTONE OWNER'S APP

THE ONLY APP YOU'LL NEED...

» MANUALS & QUICK START GUIDES

» HOW-TO VIDEOS



» FIRST-TIME CAMPER'S ADVICE

» ACCESS TO YOUR RV'S MOBILE APPS

Available for iOS and Android devices.



FOLLOW US FOR THE LATEST!



DISCLAIMER: Product Information is as accurate as possible as of the date of publication of this brochure. All features, floor plans, and specifications in this brochure are subject to change without notice. Please also consult Keystone's web site at www.keystonerv.com for more current product information and specifications. Tow Vehicle Disclaimer. CAUTION: Owners of Keystone recreational vehicles are solely responsible for the selection and proper use of tow vehicles. All customers should consult with a motor vehicle manufacturer or their dealer concerning the purchase and use of suitable tow vehicles for Keystone products. Keystone disclaims any liability or damages suffered as a result of the selection, operation, use or misuse of a tow vehicle. KEYSTONE'S LIMITED WARRANTY DOES NOT COVER DAMAGE TO THE RECREATIONAL VEHICLE OR THE TOW VEHICLE AS A RESULT OF THE SELECTION, OPERATION, USE OR MISUSE OF THE TOW VEHICLE. *Length is defined as the distance from the centerline of hitch pin/coupler to rear bumper of trailer. ** Fresh water capacity includes water heater. Please review owner's manual prior to purchase for more information on service warranties, extended use, towing and maintenance. Owner's manuals can be found at keystonerv.com.

PRINT 09.2022