



NAVI. GO PLACES.

The all-new Navi travel trailer has been engineered to maximize comfort and convenience while minimizing weight. Designed to be towed by most of today's minivans and crossover SUV's, the impressively versatile Navi is a thoughtfully appointed, dependable trailer for today's adventure seeker. And by utilizing cutting-edge, high-quality manufacturing processes, Navi ensures that even the most discriminating campers will feel right at home. Make fires. Make friends. Make memories. **GO PLACES.**



16BH



16FQ



17BHS

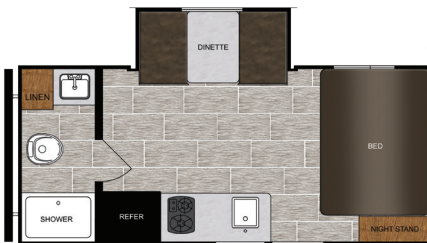

17FQS

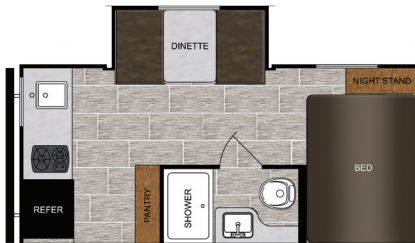

17RKS



22BH

SPECIFICATIONS	16BH	16FQ	17BHS	17FQS	17RKS	22BH
LENGTH	20' 7"	TBD	TBD	TBD	TBD	TBD
HEIGHT	9' 11"	TBD	TBD	TBD	TBD	TBD
HITCH WEIGHT	334 lb.	TBD	TBD	TBD	TBD	TBD
UNLOADED VEHICLE WEIGHT (UVW)	2,855 lb.	TBD	TBD	TBD	TBD	TBD
CARGO CARRYING CAPACITY (CCC)	979 lb.	TBD	TBD	TBD	TBD	TBD



NAVI



by PRIME TIME Mfg.

STANDARDS AND OPTIONS

PRO PACKAGE	EXTERIOR FEATURES	INTERIOR FEATURES
6 CU. FT. Refer	Two Rear Stabilizer Jacks	Two Large Galley Drawers in Kitchen
13,500 BTU A/C	Front Diamond Plate	Extended Ball Bearing Drawer Guides
Kitchen Skylight	Radial Tires	Two Burner Cooktop
LED Lit Power Awning	Single #20 LP Tank	Brushed Nickel Kitchen Faucet
Solar Prep and Back-Up Camera Prep	Aerodynamic Front Profile	Microwave
Exterior Shower	Extended Drip Spouts	Range Hood
Residential Sound Bar	E-Z Open Entry Step	16K BTU Furnace
LED Lit Outside Speakers	Oversized Pass-Thru Storage	78" Interior Height
Doggy D-Ring	Cable/Satellite Prep	LED Interior Lights
CONSTRUCTION	6 Gallon DSI Hot Water Heater	Seamless Carefree Congoleum Flooring
2" Laminated Walkable Roof	Oversized Holding Tanks: Fresh: 37 Gal / Gray: 30 Gal / Black: 30 Gal.	Overhead Storage Above Dinette
2" Laminated Floor	Tinted Safety Glass Windows	Skylight Above Top Bunk*
R-7 Insulation Throughout	Digital TV Antenna	Oversized Shelf Above Bed*
Powder Coated C-Channel Frame	12V Electrical System w/ 40 AMP Converter	Mini Blinds Throughout
Dexter E-Z Lube Axles	Safety Glass Windows	OPTIONS
One-Piece TPO Roof	Bottle Opener	MVSA
2" Wall Construction on 16" Centers	26" Fiberglass Entry Door with Window	QAI

*Most Models

UVW (Unloaded Vehicle Weight)* is the typical weight of the unit as manufactured at the factory. It includes all weight at the unit's axle(s) and tongue or pin and LP Gas. The UVW does not include cargo, fresh potable water, additional optional equipment or dealer installed accessories. *Estimated Average based on standard build optional equipment.

CCC (Cargo Carrying Capacity)** is the amount of weight available for fresh potable water, cargo, additional optional equipment and accessories. CCC is equal to GVWR minus UVW. Available CCC should accommodate fresh potable water (8.3 lbs per gallon). Before filling the fresh water tank, empty the black and gray tanks to provide for more cargo capacity. ** Estimated average based on standard build optional equipment.

GAWR (Gross Axle Weight Rating) is the maximum permissible weight, including cargo, fluids, optional equipment and accessories that can be safely supported by a combination of all axles.

Each Forest River RV is weighed at the manufacturing facility prior to shipping. A label identifying the unloaded vehicle weight of the actual unit and the cargo carrying capacity is applied to every Forest River RV prior to leaving our facilities. The load capacity of your unit is designated by weight, not by volume, so you cannot necessarily use all available space when loading your unit.

All information contained in this brochure is believed to be accurate at the time of publication. However, during the model year, it may be necessary to make revisions and Forest River, Inc., reserves the right to make all such changes without notice, including prices, colors, materials, equipment and specifications as well as the addition of new models and the discontinuance of models shown in this brochure. Therefore, please consult with your Forest River, Inc., dealer and confirm the existence of any materials, design or specifications that are material to your purchase decision.

© 2018 Prime Time Manufacturing. A Division Of Forest River, Inc., A Berkshire Hathaway Company. All Rights Reserved

Colton RV
3122 Niagara Falls Blvd.
North Tonawanda, NY 14120
(716) 694-0188
www.ColtonRV.com



www.ForestRiverBuyLocal.com



Learn More
Scan this barcode using a QR Reader on your smart phone to learn more about Forest River.



North America's Favorite RV Company!