

FLAGSTAFF
SHAMROCK, MICRO LITE, SUPER LITE
& CLASSIC TRAVEL TRAILERS

Flagstaff

SHAMROCK, MICRO LITE,
SUPER LITE & CLASSIC TRAVEL TRAILERS

PROVIDING OUTDOOR FUN SINCE 1974.







A Reputation of Excellence

FROM HUMBLE BEGINNINGS, FLAGSTAFF HAS EMERGED AS AN INDUSTRY LEADER IN THE MANUFACTURING OF LIGHT WEIGHT TRAVEL TRAILERS, FIFTH WHEELS AND CAMPING TRAILERS.

Located in Millersburg, IN since 1974, Flagstaff has been supported by this community and the local families residing there. These families have helped provide the hundreds of workers that have brought their dedication to quality workmanship, respect for their fellow workers and a commitment to an uncompromising work ethic to make a major contribution to this company's success. Founded on the principle of providing superior value and service while remaining in tune with customer's preferences, Flagstaff has become the ultimate luxury product in the light-weight travel trailer market, proudly showcasing more innovative floor plans, appealing features and refined interior appointments than any others in it's class.

TODAY, FLAGSTAFF REMAINS COMMITTED TO INSURING THAT OUR CUSTOMERS ENJOY THEIR CAMPING EXPERIENCES. *Through the utilization of our experienced work force, "state of the art" lamination facility, modern production plants and detailed assembly processes our aim is to continue to provide our customers with the best built product possible at an unmatched value.*

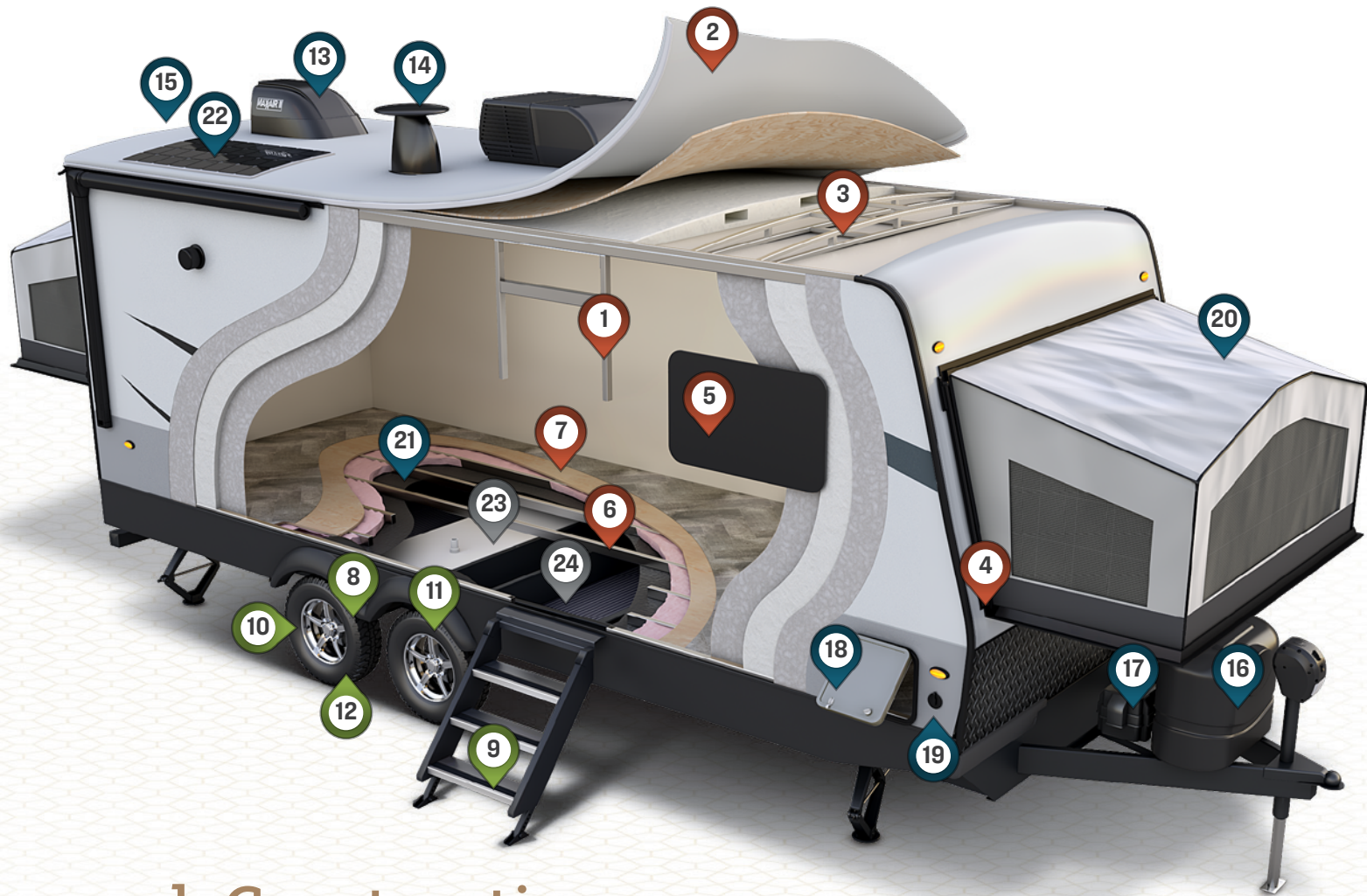

Shamrock Construction

SUPERIOR CONSTRUCTION

- 1 6 Sided Full Aluminum Frame
- 2 Fully Laminated One-Piece Walkable Roof
- 3 Aluminum Truss AC Bracing
- 4 Easy Reach Latch System
- 5 Frameless Windows
- 6 Aluminum Floor Joists
- 7 5/8" Tongue & Groove Plywood Floor

SAFETY STANDARDS

- 8 Dexter Torsion Axles
- 9 MORryde Strut Assist Steps (N/A 19/183)
- 10 TST Tire Pressure Monitor System
- 11 Goodyear Endurance Tires
- 12 Nitrogen Filled Tires

STANDARD FEATURES

- 13 2 Maxxair Fans w/ Covers
- 14 Teton All In One WiFi Booster w/ LTE Prep & Antenna
- 15 Back Up Camera Prep
- 16 Double 20# LP Bottles
- 17 Double Battery Boxes
- 18 Key-Alike Locks
- 19 Solar Prep On Side
- 20 5 Year Tent Warranty

- 21 12v Thermostatically Controlled Heated Tanks
- 22 190w Solar Panel w/ 1000w Inverter

CLIMATE PROTECTION PACKAGE

- 23 4" Block Foam Insulated Roof
- 24 Radiant Foil Insulated Underbelly



235S



235S

Shamrock

A VALUE THAT'LL MAKE YOU FEEL LUCKY! We have a trailer just for you. Whether you are interested in the expanded interior space provided by the spacious drop down bunks, heated mattresses and the feel of a traditional trailer, the Flagstaff Shamrock will deliver the quality and amenities you expect. Flagstaff brings the necessities of residential living on the campsite

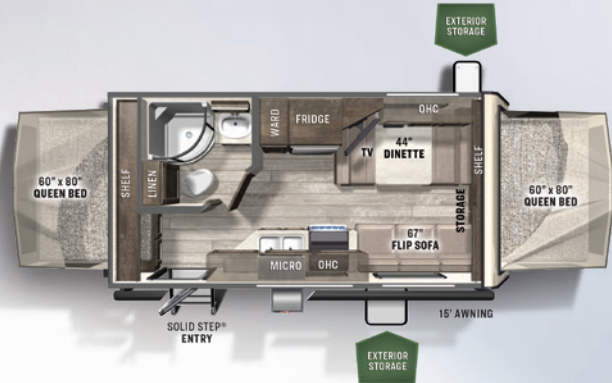

19

EXPANDABLE

UVW: 4298 HITCH: 434 AXLE: 3826 LENGTH: 22' OPEN LENGTH: 26' 5"
 CCC: 1416 WIDTH: 8' HEIGHT: 10' 6" FRESH: 54 gal GRAY: 30 gal BLACK: 30 gal



183

EXPANDABLE

UVW: 4259 HITCH: 450 AXLE: 3771 LENGTH: 21' 2" OPEN LENGTH: 25' 7"
 CCC: 1471 WIDTH: 8' HEIGHT: 10' 6" FRESH: 54 gal GRAY: 30 gal BLACK: 30 gal

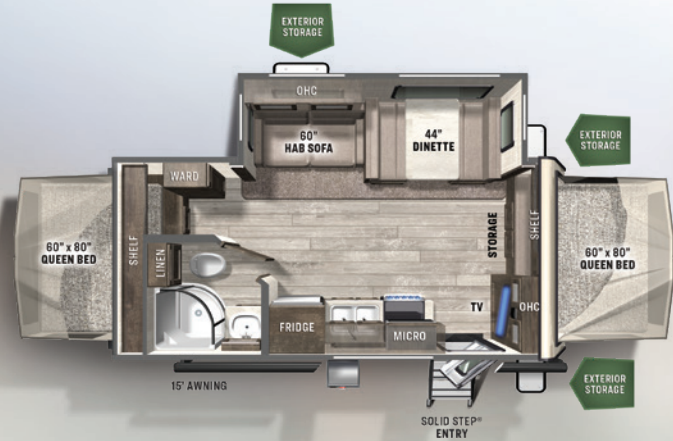

21SS

EXPANDABLE

UVW: 5095 HITCH: 556 AXLE: 4501 LENGTH: 22' 10" OPEN LENGTH: 27' 2"
 CCC: 1461 WIDTH: 8' HEIGHT: 10' 11" FRESH: 54 gal GRAY: 30 gal BLACK: 30 gal

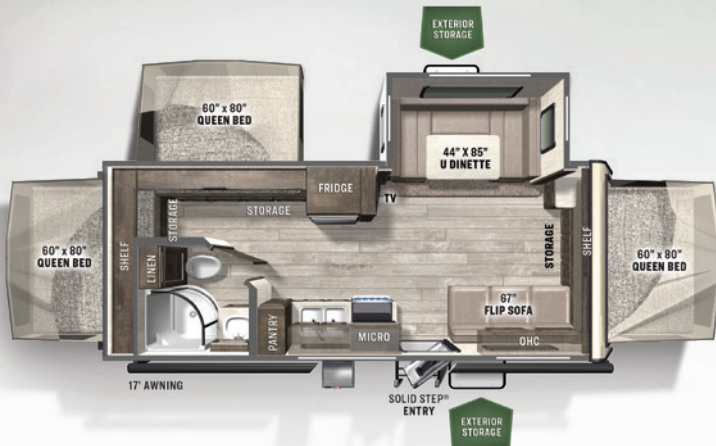

233S

EXPANDABLE

UVW: 5111 HITCH: 652 AXLE: 4421 LENGTH: 24' 10" OPEN LENGTH: 29' 7"
 CCC: 1541 WIDTH: 8' HEIGHT: 10' 6" FRESH: 54 gal GRAY: 30 gal BLACK: 30 gal



235S

EXPANDABLE

UVW: 5639 HITCH: 738 AXLE: 4863 LENGTH: 24' 10" OPEN LENGTH: 29' 7"
 CCC: 1259 WIDTH: 8' HEIGHT: 10' 11" FRESH: 54 gal GRAY: 30 gal BLACK: 30 gal

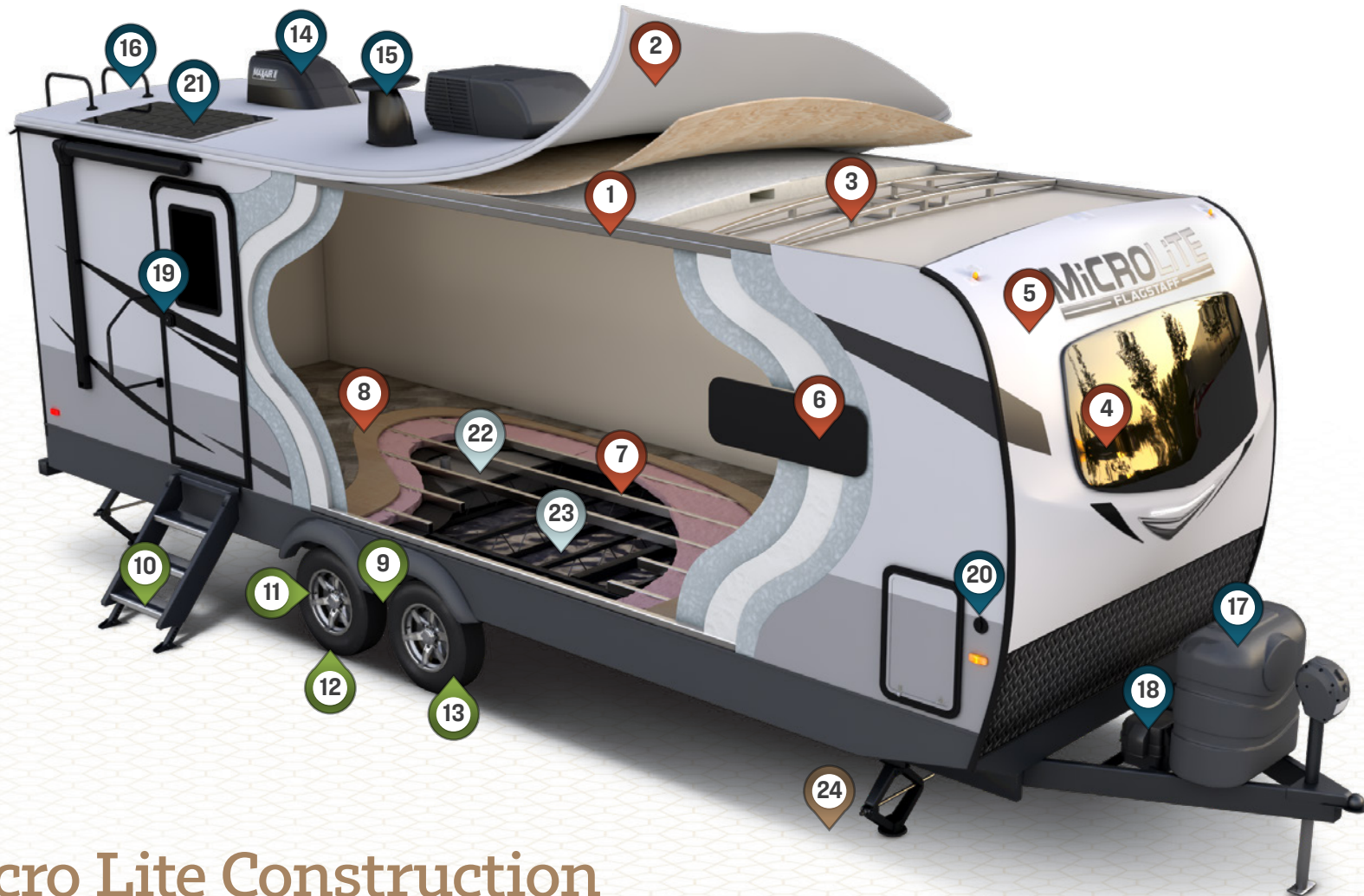

Micro Lite Construction

▲ SUPERIOR CONSTRUCTION

- 1 6 Sided Full Aluminum Frame
- 2 Fully Laminated One-Piece Walkable Roof
- 3 Aluminum Truss Roof Bracing
- 4 Automotive Glass Windshield
- 5 Painted Fiberglass Front Cap w/ Clear Coat
- 6 Frameless Windows
- 7 Aluminum Floor Joists
- 8 5/8" Tongue & Groove Plywood Floor

▲ SAFETY STANDARDS

- 9 Dexter Torsion Axles
- 10 MORryde Strut Assist Steps (NA 21FBR5)
- 11 TST Tire Pressure Monitor System
- 12 Goodyear Endurance Tires
- 13 Nitrogen Filled Tires

▲ STANDARD FEATURES

- 14 Maxxair Fan w/ Cover
- 15 Teton All In One Wifi Booster w/ LTE Prep & Antenna
- 16 Back Up Camera Prep
- 17 Double 30# LP Bottles
- 18 Double Battery Boxes
- 19 Key-Alike Locks
- 20 Solar Prep On Side
- 21 190w Solar Panel w/ 1000w Inverter

▲ CLIMATE PROTECTION PACKAGE

- 22 12v Thermostatically Controlled Heated Tanks
- 23 Radiant Foil In Underbelly, Front Caps & Slide Out Floors

▲ OPTIONAL FEATURES

- 24 Power Stabilizers (Not Pictured)

Micro Lite

TOWING A TRAILER DOESN'T REQUIRE A TRUCK ANYMORE. When towing size and weight are your focus, you will find that these specially designed Micro Lite models offer flexible floor plans that provide you with more comfort and amenities than you would expect — all within the towing capacity of many SUV's.

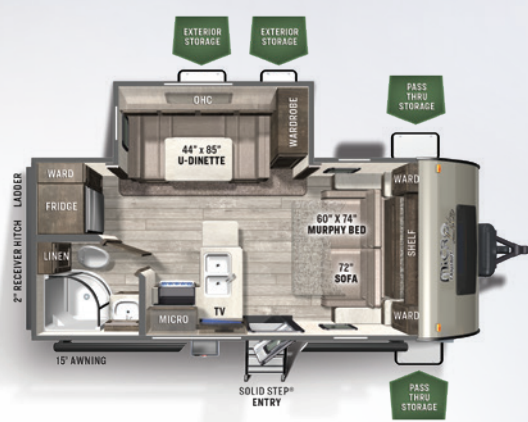

21DS

MURPHY BED

UVW: 4977 HITCH: 681 AXLE: 4237 CCC: 1864 LENGTH: 22' 4"
 HEIGHT: 10' 11" WIDTH: 8' FRESH: 54 gal GRAY: 30 gal BLACK: 30 gal



21FBRs

FRONT BED

UVW: 4493 HITCH: 557 AXLE: 3877 CCC: 1344 LENGTH: 22' 4"
 HEIGHT: 10' 3" WIDTH: 8' FRESH: 54 gal GRAY: 30 gal BLACK: 30 gal



22TBS

TWIN BED

UVW: 4975 HITCH: 720 AXLE: 4196 CCC: 1905 LENGTH: 23' 11"
 HEIGHT: 10' 11" WIDTH: 8' FRESH: 54 gal GRAY: 30 gal BLACK: 30 gal

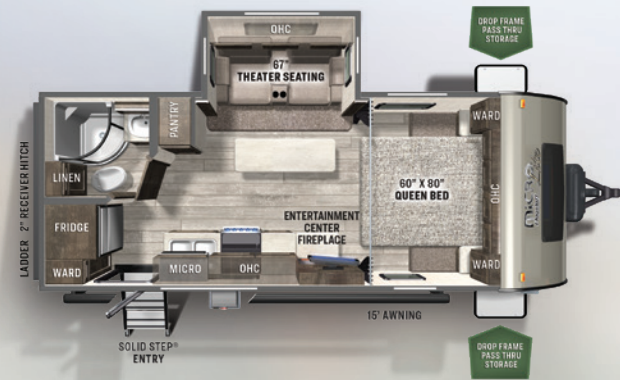

22FBS

FRONT BED

UVW: 5132 HITCH: 634 AXLE: 4439 CCC: 1662 LENGTH: 23' 10"
 HEIGHT: 10' 11" WIDTH: 8' FRESH: 54 gal GRAY: 30 gal BLACK: 30 gal



25BDS

MURPHY BED

UVW: 5754 HITCH: 590 AXLE: 5105 CCC: 1836 LENGTH: 25' 10"
 HEIGHT: 10' 11" WIDTH: 8' FRESH: 54 gal GRAY: 30 gal BLACK: 30 gal

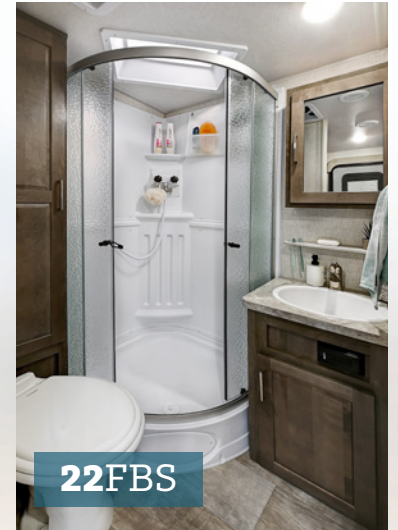

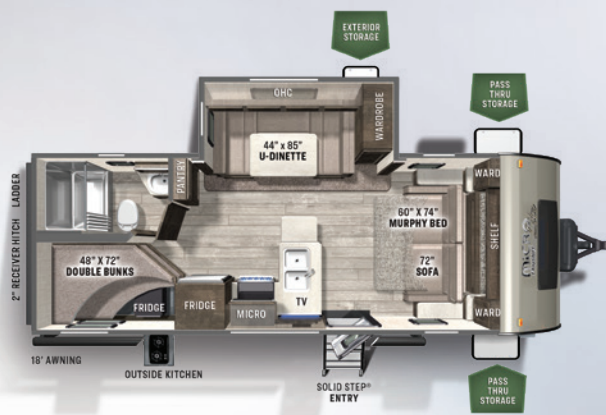

25BRDS

BUNK HOUSE

UVW: 5440 HITCH: 773 AXLE: 4667 CCC: 1493 LENGTH: 25' 11"
 HEIGHT: 10' 11" WIDTH: 8' FRESH: 54 gal GRAY: 30 gal BLACK: 30 gal



25BSDS

FRONT BEDROOM

UVW: 5971 HITCH: 660 AXLE: 5252 CCC: 1689 LENGTH: 25' 10"
 HEIGHT: 10' 11" WIDTH: 8' FRESH: 54 gal GRAY: 30 gal BLACK: 30 gal



25FBLs

FRONT BEDROOM

UVW: 5748 HITCH: 824 AXLE: 4865 CCC: 1236 LENGTH: 25' 10"
 HEIGHT: 10' 11" WIDTH: 8' FRESH: 54 gal GRAY: 60 gal BLACK: 30 gal

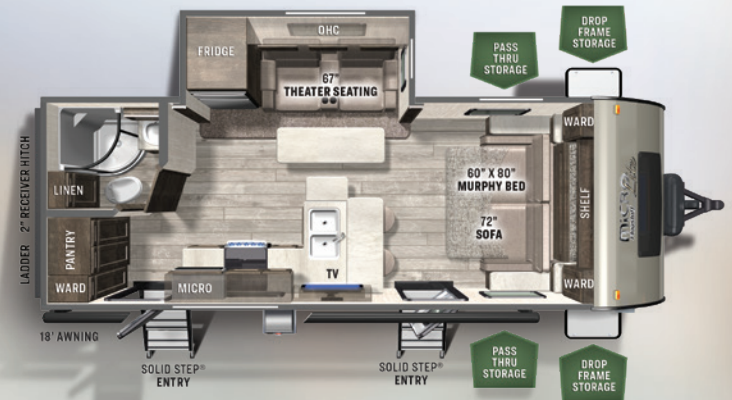

25FBS

MURPHY BED

UVW: 5675 HITCH: 646 AXLE: 4970 CCC: 1971 LENGTH: 25' 10"
 HEIGHT: 10' 11" WIDTH: 8' FRESH: 54 gal GRAY: 30 gal BLACK: 30 gal



25FKBS

FRONT KITCHEN

UVW: 6049 HITCH: 772 AXLE: 5218 CCC: 1723 LENGTH: 25' 11"
 HEIGHT: 10' 11" WIDTH: 8' FRESH: 54 gal GRAY: 60 gal BLACK: 30 gal



25FKS

FRONT KITCHEN

UVW: 5528 HITCH: 814 AXLE: 4655 CCC: 1446 LENGTH: 25' 11"
 HEIGHT: 10' 11" WIDTH: 8' FRESH: 54 gal GRAY: 60 gal BLACK: 30 gal

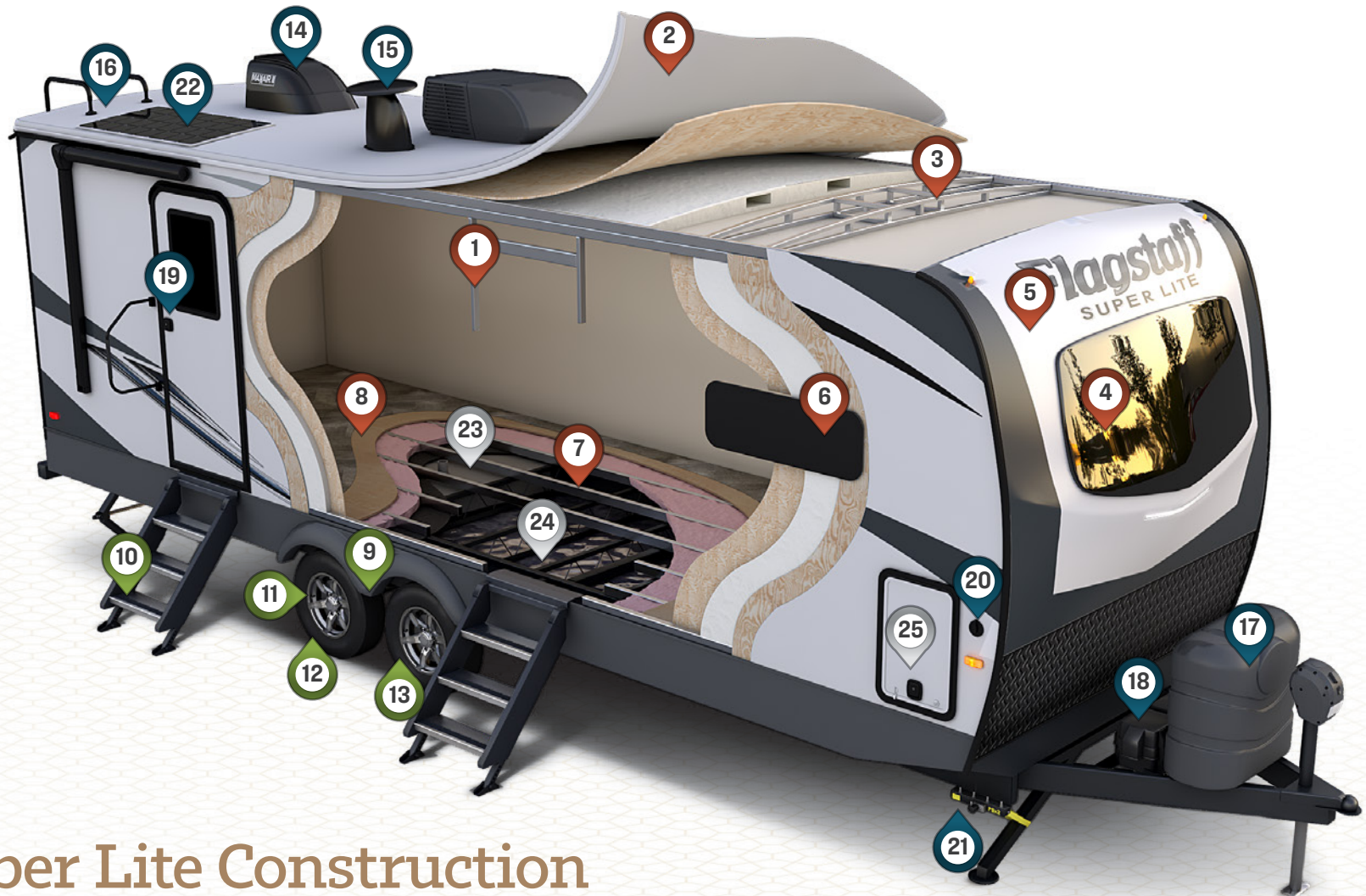

Super Lite Construction

▲ SUPERIOR CONSTRUCTION

- 1 6 Sided Full Aluminum Frame
- 2 Fully Laminated One-Piece Walkable Roof
- 3 Aluminum Truss Roof Bracing
- 4 Automotive Glass Windshield
- 5 Painted Fiberglass Front Cap w/ Clear Coat
- 6 Frameless Windows
- 7 Aluminum Floor Joists
- 8 5/8" Tongue & Groove Plywood Floor

▲ SAFETY STANDARDS

- 9 Dexter Torsion Axles
- 10 MORryde Strut Assist Steps
- 11 TST Tire Pressure Monitor System
- 12 Goodyear Endurance Tires
- 13 Nitrogen Filled Tires

▲ STANDARD FEATURES

- 14 Maxxair Fan w/ Cover
- 15 Teton All In One Wifi Booster w/ LTE Prep & Antenna
- 16 Back Up Camera Prep
- 17 Double 30# LP Bottles
- 18 Double Battery Boxes
- 19 Key-Alike Locks
- 20 Solar Prep On Side

- 21 Power Stabilizers
- 22 190w Solar Panel w/ 1000w Inverter

▲ CLIMATE PROTECTION PACKAGE

- 23 12v Thermostatically Controlled Heated Tanks
- 24 Radiant Foil In Underbelly, Front Caps & Slide Floors
- 25 Insulated Slam Latch Baggage Doors



29BHS

AUTUMN WOOD & MOJAVE



29BHS



29BHS



Super Lite

YOU'LL LOVE WHAT YOU FIND IN OUR FLOOR PLANS. Our trailers are packed full of quality features in order to bring to you one of the best values in the light weight market. There are spacious flush floor slides, comfortable stylish sofas and wide dinettes with easily adjustable legs. Our Super Lite series offers lots of room and amenities while still being a 1/2 ton towable Travel Trailer.

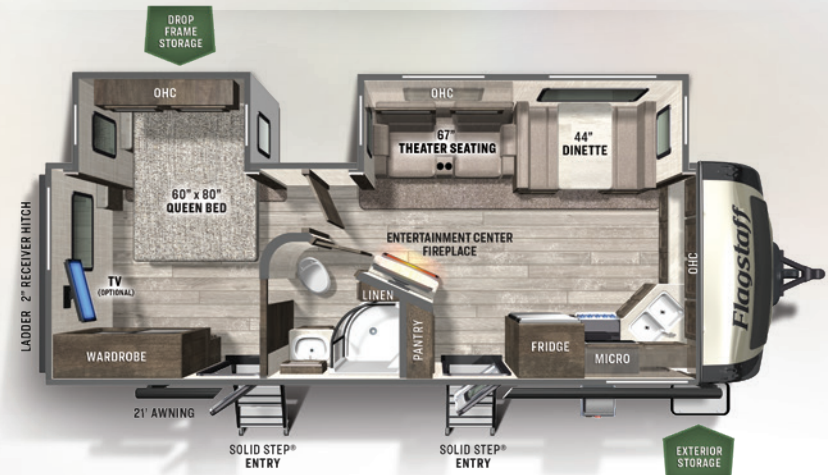

26FKBS

FRONT KITCHEN

UVW: 6836 HITCH: 946 AXLE: 5831 CCC: 1910 LENGTH: 29' 8"
 HEIGHT: 11' 2" WIDTH: 8' FRESH: 54 gal GRAY: 90 gal BLACK: 45 gal

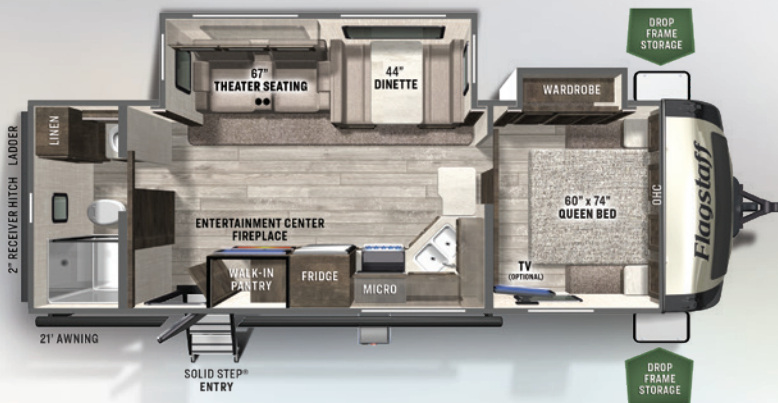

26RBWS

FRONT BEDROOM

UVW: 6158 HITCH: 908 AXLE: 5191 CCC: 2550 LENGTH: 29' 9"
 HEIGHT: 11' 2" WIDTH: 8' FRESH: 54 gal GRAY: 90 gal BLACK: 45 gal



26RKBS

REAR KITCHEN

UVW: 6988 HITCH: 796 AXLE: 6133 CCC: 1608 LENGTH: 29' 9"
 HEIGHT: 11' 2" WIDTH: 8' FRESH: 54 gal GRAY: 90 gal BLACK: 45 gal



26RLBS

REAR LIVING

UVW: 6614 HITCH: 915 AXLE: 5640 CCC: 2101 LENGTH: 29' 9"
 HEIGHT: 11' 2" WIDTH: 8' FRESH: 54 gal GRAY: 90 gal BLACK: 45 gal



27BHWS

BUNK HOUSE

UVW: 7310 HITCH: 921 AXLE: 6330 CCC: 1411 LENGTH: 32' 10"
 HEIGHT: 11' 2" WIDTH: 8' FRESH: 54 gal GRAY: 90 gal BLACK: 45 gal



27FBIK

REAR KITCHEN

UVW: 8324 HITCH: 1035 AXLE: 7230 CCC: 1511 LENGTH: 33' 1"
 HEIGHT: 11' 3" WIDTH: 8' FRESH: 54 gal GRAY: 90 gal BLACK: 45 gal



29BHS

BUNK HOUSE

UVW: 7605 HITCH: 1038 AXLE: 6508 CCC: 2233 LENGTH: 35' 5"
 HEIGHT: 11' 2" WIDTH: 8' FRESH: 54 gal GRAY: 45 gal BLACK: 45 gal



29RBS

FRONT BEDROOM

UVW: 7854 HITCH: 952 AXLE: 6843 CCC: 1898 LENGTH: 35' 2"
 HEIGHT: 11' 2" WIDTH: 8' FRESH: 54 gal GRAY: 90 gal BLACK: 45 gal



29RLBS

REAR LIVING

UVW: 8559 HITCH: 1100 AXLE: 7400 CCC: 1341 LENGTH: 35' 5"
 HEIGHT: 11' 3" WIDTH: 8' FRESH: 54 gal GRAY: 45 gal BLACK: 45 gal

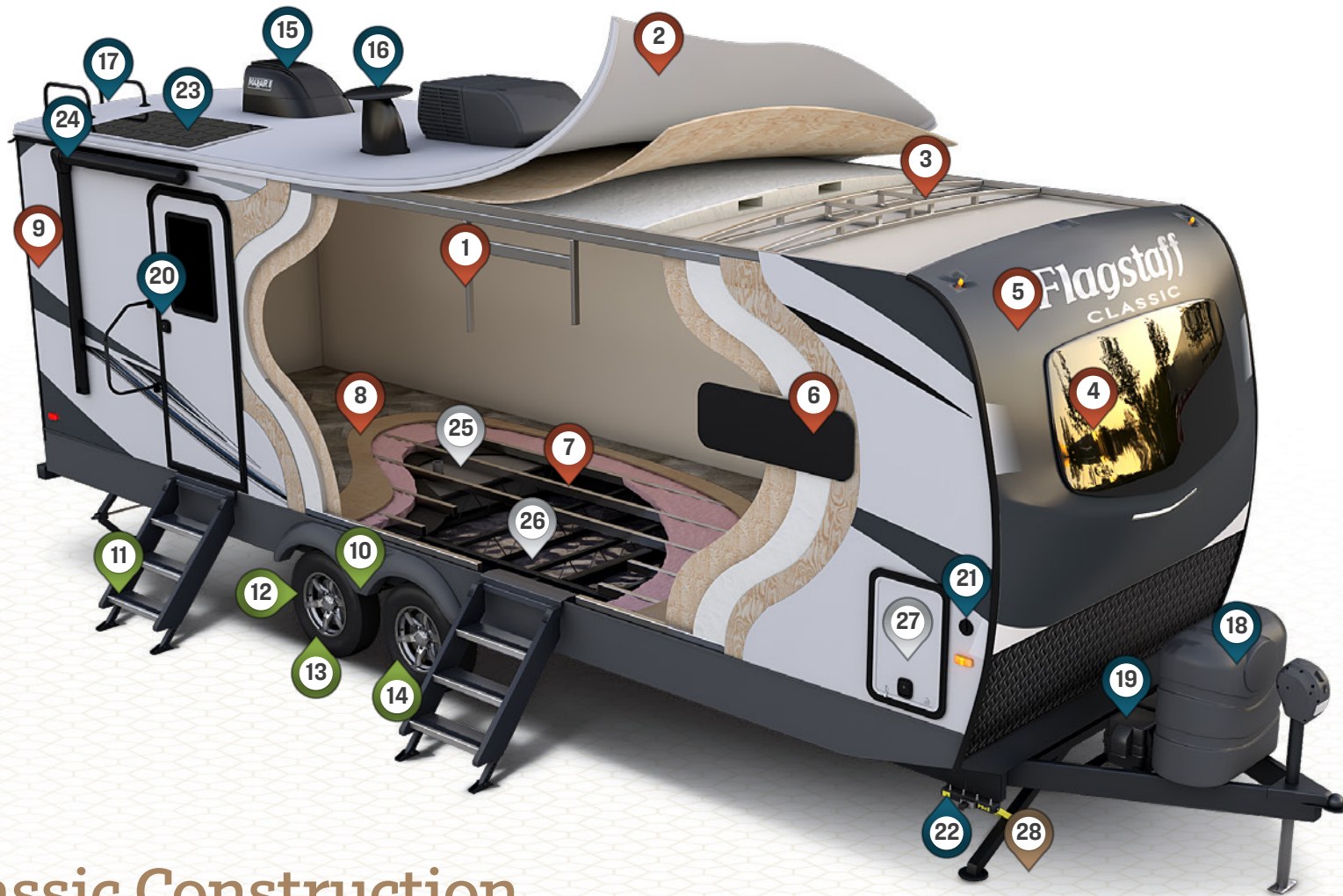

Classic Construction

SUPERIOR CONSTRUCTION

- 1 6 Sided Full Aluminum Frame
- 2 Fully Laminated One-Piece Walkable Roof
- 3 Aluminum Truss Roof Bracing
- 4 Automotive Glass Windshield
- 5 Painted Fiberglass Front Cap w/ Clear Coat
- 6 Frameless Windows
- 7 Aluminum Floor Joists
- 8 5/8" Tongue & Groove Plywood Floor
- 9 High Gloss Fiberglass

SAFETY STANDARDS

- 10 Dexter Torsion Axles
- 11 MORryde Strut Assist Steps
- 12 TST Tire Pressure Monitor System
- 13 Goodyear Endurance Tires
- 14 Nitrogen Filled Tires

STANDARD FEATURES

- 15 Maxxair Fan w/ Cover
- 16 Teton All In One Wifi Booster w/ LTE Prep & Antenna

- 17 Back Up Camera Prep
- 18 Double 30# LP Bottles
- 19 Double Battery Boxes
- 20 Key-Alike Locks
- 21 Solar Prep On Side
- 22 PSX2 Power Stabilizers
- 23 190w Solar Panel w/ 1000w Inverter (Opt 832RKSB)
- 24 Shielded Awning Covers

CLIMATE PROTECTION PACKAGE

- 25 12v Thermostatically Controlled Heated Tanks
- 26 Radiant Foil In Underbelly, Front Caps & Slide Out Floors
- 27 Insulated Slam Latch Baggage Doors

OPTIONAL FEATURES

- 28 Electric Auto-leveling



832BWS

NEWPORT ASH & ACADIA



832BWS



Classic

BEAUTIFUL SPACIOUS INTERIORS COME STANDARD. *The Classic series has many outstanding features to enhance your camping experience. The open floorplans and generous storage space allows extra room for those extra things you want to bring along. Sleeping in a comfortable bedroom, you'll forget you were in the great outdoors. The spacious interior and picturesque view through the many windows enable you to experience your surroundings in the comfort of your Classic travel trailer.*



826MBR
SUITE SERIES

UVW: 7809 HITCH: 1065 AXLE: 6685 CCC: 2056 LENGTH: 29' 11"
HEIGHT: 11' 7" WIDTH: 8' FRESH: 54 gal GRAY: 80 gal BLACK: 40 gal



832BWS

NEWPORT ASH & ACADIA



832BWS

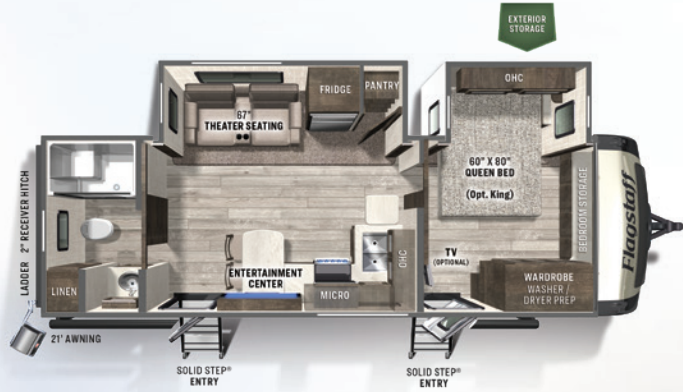

826RBS

SUITE SERIES

UVW: 7709 HITCH: 1070 AXLE: 6580 CCC: 2161 LENGTH: 29' 11"
 HEIGHT: 11' 7" WIDTH: 8' FRESH: 54 gal GRAY: 80 gal BLACK: 40 gal



832BWS

BUNK HOUSE

UVW: 9669 HITCH: 1320 AXLE: 8290 CCC: 1651 LENGTH: 36' 8"
 HEIGHT: 11' 7" WIDTH: 8' FRESH: 54 gal GRAY: 130 gal BLACK: 50 gal

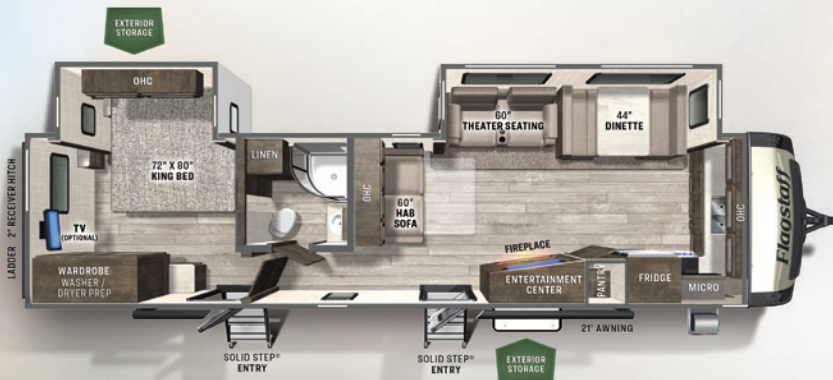

832CLSB

FRONT KITCHEN

UVW: 8327 HITCH: 1057 AXLE: 7211 CCC: 2730 LENGTH: 36' 8"
 HEIGHT: 11' 7" WIDTH: 8' FRESH: 54 gal GRAY: 130 gal BLACK: 50 gal

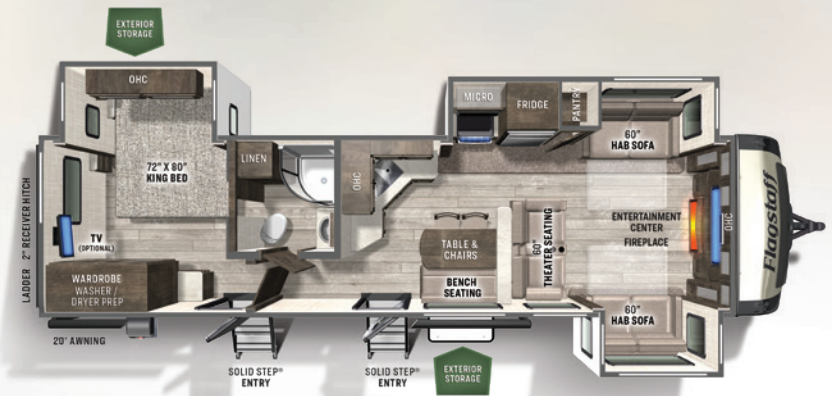

832FLSB

FRONT LIVING

UVW: 9254 HITCH: 1115 AXLE: 8080 CCC: 1861 LENGTH: 36' 8"
 HEIGHT: 11' 7" WIDTH: 8' FRESH: 54 gal GRAY: 120 gal BLACK: 50 gal



832IKRL

REAR LIVING

UVW: 9209 HITCH: 1315 AXLE: 7835 CCC: 2106 LENGTH: 36' 8"
 HEIGHT: 11' 7" WIDTH: 8' FRESH: 54 gal GRAY: 120 gal BLACK: 50 gal

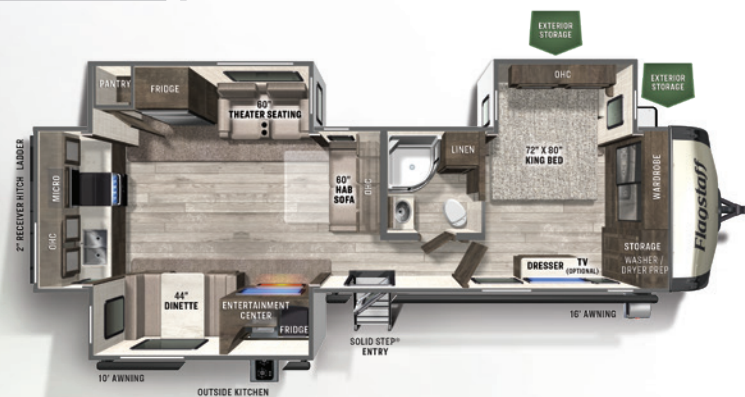

832RKSB

REAR KITCHEN

UVW: 9444 HITCH: 1130 AXLE: 8255 CCC: 1686 LENGTH: 36' 8"
 HEIGHT: 11' 7" WIDTH: 8' FRESH: 54 gal GRAY: 110 gal BLACK: 50 gal

Acadia

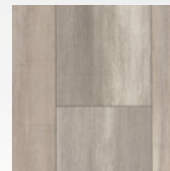
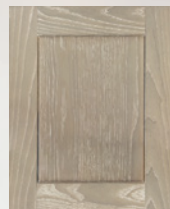
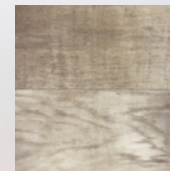

Mojave

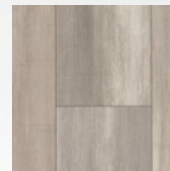
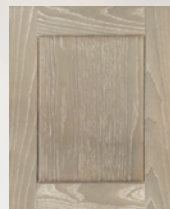

MONITOR YOUR RV FROM YOUR DEVICES

Your RV is equipped with OneControl. This WiFi app-based interface provides comfort and convenience to control and monitor your RV's functions. With the WeRV app you can control your lights, slides and awning from your fingertips.

For a complete list of control capabilities, please visit lippert.com/onecontrol

**Whenever, wherever
we make your
experience better.**

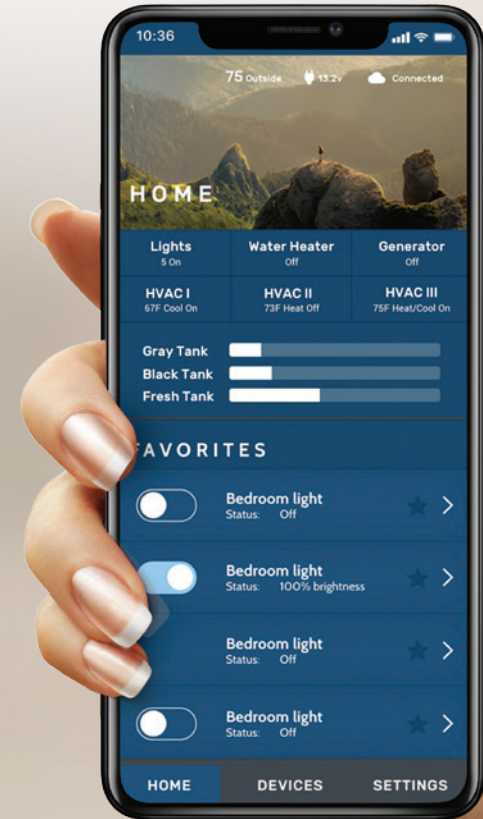

Scan
for more
information



Flagstaff Warranty. Our Promise.

FOR DETAILS ON FLAGSTAFF'S COMPLETE WARRANTY PROGRAM, SEE YOUR FLAGSTAFF DEALER. When it comes to backing products with the same quality and commitment it does when it begins the manufacturing process, the only name you have to remember when you're looking for a recreational vehicle is Flagstaff. Flagstaff offers the following additional limited warranties to the original purchasers. Consult written warranty for details.

1. Twelve-year vinyl roof warranty.
2. Two-year fiberglass warranty.
3. Five-year tent warranty.
4. Ten-year Torflex® axle warranty.
5. One-year bumper to bumper warranty.

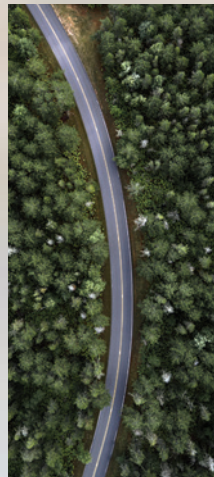

24/7 EMERGENCY ROADSIDE ASSISTANCE WITH VEHICLE PURCHASE*

TOWING	WINCH-OUT
JUMP-STARTS	MOBILE MECHANIC
TIRE CHANGES	TECHNICAL
FLUID DELIVERY	SUPPORT
LOCKOUT	DEALER LOCATOR
SERVICE	SERVICES



*VALID FOR 1 YEAR FROM DATE OF PURCHASE



PRE-DELIVERY INSPECTION FACILITY

20,000 square feet of quality assurance. The bare essentials for a premium product. This state-of-the-art facility gives immediate daily feedback to production for quality assurance in every unit built.

CUSTOMER SATISFACTION



www.ForestRiverBuyLocal.com

FREE MEMBERSHIP
to Forest River Owners' Group

www.forestriverfrog.com



Specification Definitions :: GVWR (Gross Vehicle Weight Rating) - is the maximum permissible weight of the unit when fully loaded. It includes all weights, inclusive of all fluids, cargo, optional equipment and accessories. For safety and product performance do NOT exceed the GVWR. // **GAWR (Gross Axle Weight Rating)** - is the maximum permissible weight, including cargo, fluids, optional equipment and accessories that can be safely supported by a combination of all axles. // **UVW (Unloaded Vehicle Weight)** - is the typical weight of the unit as manufactured at the factory. It includes all weight at the unit's axle(s) and tongue or pin and LP Gas. The UVW does not include cargo, fresh potable water, additional optional equipment or dealer installed accessories. *Estimated average based on standard build optional equipment. // **CCC (Cargo Carrying Capacity)**** - is the amount of weight available for fresh potable water, cargo, additional optional equipment and accessories. CCC is equal to GVWR minus UVW. Available CCC should accommodate fresh potable water (8.3 lbs per gallon). Before filling the fresh water tank, empty the black and gray tanks to provide for more cargo capacity. **Estimated average based on standard build optional equipment. // Each Forest River RV is weighed at the manufacturing facility prior to shipping. A label identifying the unloaded vehicle weight of the actual unit and the cargo carrying capacity is applied to every Forest River RV prior to leaving our facilities. The load capacity of your unit is designated by weight, not by volume, so you cannot necessarily use all available space when loading your unit. // All information contained in this brochure is believed to be accurate at the time of publication. However, during the model year, it may be necessary to make revisions and Forest River, Inc., reserves the right to make all such changes without notice, including prices, colors, materials, equipment and specifications as well as the addition of new models and the discontinuance of models shown in this brochure. Therefore, please consult with your Forest River dealer and confirm the existence of any materials, design or specifications that are material to your purchase decision. Litho. U.S.A. FOR 1766 P&W: 2021.02.11

Look for our other popular lines of Flagstaff trailers.



FLAGSTAFF E-PRO



FLAGSTAFF FIFTH WHEELS



FLAGSTAFF CAMPING TRAILERS

YOUR **FLAGSTAFF** DEALER

Colton RV & Marine
3122 Niagara Falls Blvd.
North Tonawanda, NY 14120
(716) 694-0188
www.ColtonRV.com

Colton RV
3443 Southwestern Blvd.
Orchard Park, NY 14127
(716) 957-3250
www.ColtonRV.com

Colton RV
489 Bushkill Plaza LN #9665
Wind Gap, PA 18091
(610) 863-5239
www.ColtonRV.com

FOLLOW THE JOURNEY



Learn More
Scan this barcode using a QR Reader on your smart phone to learn more about Forest River.



A Berkshire Hathaway company.



Follow us on these media platforms @FlagstaffRvs

201 WEST ELM MILLERSBURG, IN 46543
WWW.FORESTRIVERINC.COM/FLAGSTAFF 574.642.2640