

Ultra Lite Weight Travel Trailers by Jayco



Jayco

AMERICA'S MOST **LIVEABLE** RVs.

2010 JAY FEATHER

Travel Light



Explore your



ACCOMMODATING

Thanks to a variety of expandable sleeping quarters and hard-wall slideout rooms, the Jay Feather can comfortably sleep up to nine people (select models). It's big when you need it to be, and small when you don't.

JAY FEATHER®
Ultra Lite Weight Travel Trailers by Jayco®

LIVEABILITY MEETS TOWABILITY

possibilities.

Spending less and saving more is the reality facing many people today. And yet, the desire for deeper, more meaningful connections with friends and family is stronger than ever. Fortunately, spending less doesn't mean settling for less, thanks to the new Jay Feather. Light enough to be towed by most SUVs, minivans and crossovers*, yet expandable enough to fit most families, the Jay Feather makes it possible to reconnect — and stay connected — with the important things in life.



TOWABLE

Aluminum frame construction makes the Jay Feather durable, yet incredibly light weight—while the TorFlex® independent suspension makes towing easy and smooth.

DURABLE

Just because you're giving up weight doesn't mean you're giving up durability. Our industry-leading construction techniques developed over the past 40 years ensure the Jay Feather is built for the long haul.

A TRADITION OF LIVEABILITY

Starting with our first lifter system for fold-down campers in 1968, which made for an easier, more enjoyable camping experience, Jayco has always been about liveability. Today, we're the world's largest family-owned RV manufacturer, yet our priorities remain the same: making RVs more liveable and family time more memorable.

* Consult with your authorized automobile manufacturer and vehicle owner manual.



JAY FEATHER 24T | SPICE



SPACE TO LIVE, ROOM TO GROW.

There's no need to give up space or amenities with the Jay Feather. Expandable sleeping areas mean there's plenty of room to stretch out at night, while full-featured kitchens and bathrooms make getaways comfortable, memorable and stress-free.



EXP 26P | SAND



EXP 26P | SAND



EX-PORT 17C | SPICE

CONTEMPORARY

The Jay Feather's full bath delivers all the comforts of home in a compact, well-designed space.

SPACIOUS

Mealtime is quick and easy in the Jay Feather's efficient, fully equipped kitchen. Cleanup's a snap as well.

COMFORTABLE

After a long day of outdoor fun, you'll appreciate the Jay Feather's restful queen-sized mattress and quilted bed pad.

JAY FEATHER

Ultra Lite Weight Travel Trailers by Jayco

Live large. Tow small.

The Jay Feather can be towed by most SUVs, minivans and crossovers*, so getting away from the stress of your everyday life has never been easier—or more enjoyable. With four series and 17 different floorplans to choose from, the Jay Feather comes with everything you need to get away whenever you want and to stay away for as long as you need.



SPORT

The Jay Feather SPORT packs a mighty big punch in a mighty small package. Easily towable, with sleeping for up to five people, the SPORT is our most light weight, compact model, perfect for quick trips and weekend getaways.

SLEEPING CAPACITY
UP TO 5

EXTERIOR LENGTH
18'–24' 1"

UNLOADED WEIGHT
2,910–3,900

FLOORPLANS
3

EX-PORT

Combining the compact style of the SPORT with the expandability of the EXP, the Jay Feather EX-PORT features two queen-sized hard-and soft-wall expansions, and sleeps up to six people; yet it's still light enough to be towed by most SUVs and minivans*.

SLEEPING CAPACITY
UP TO 6

EXTERIOR LENGTH
17' 11"–18' 6"

UNLOADED WEIGHT
2,935

FLOORPLANS
2

EXP

Maximize your living space while minimizing towing weight with the Jay Feather EXP. Hard-wall slideout rooms or expandable beds provide sleeping for up to eight people, while greatly increasing your interior living areas.

SLEEPING CAPACITY
UP TO 8

EXTERIOR LENGTH
20' 4"–28' 9"

UNLOADED WEIGHT
3,650–5,700

FLOORPLANS
6

JAY FEATHER

Not only is the Jay Feather light and compact, it's also very affordable, making it perfect for families who want the ease of a smaller trailer but need the amenities and interior space of a much larger model.

SLEEPING CAPACITY
UP TO 9

EXTERIOR LENGTH
26' 1"–30' 10"

UNLOADED WEIGHT
4,370–5,210

FLOORPLANS
6

* Consult your tow vehicle owner's manual for towing capacity.

Jayco construction

At Jayco, we've built a reputation for superior construction and craftsmanship. We always use top-quality materials and production techniques, giving our products **reliable resale value** and our owners peace of mind.

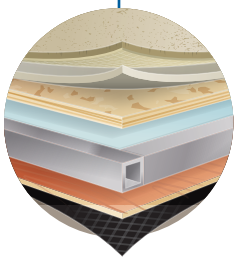

FLOOR

Vacuum bonding joins our aluminum frame with bead-foam insulation and decking to create one of the strongest foundations in the industry. (EXP, EX-PORT and Jay Feather).

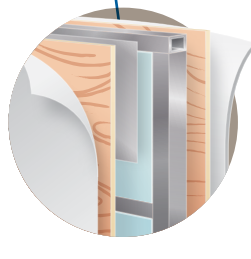

WALLS

TuffShell™ vacuum bonding combined with welded aluminum frames and metal backers create a durable structure designed to withstand use and travel.

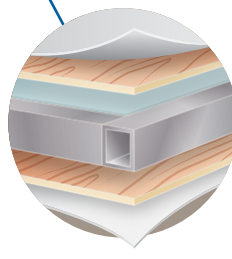

ROOF

Our roof structure provides 2 inches of R-9 bead-foam insulation and is finished with a seamless rubber layer that protects against moisture and resists aging.

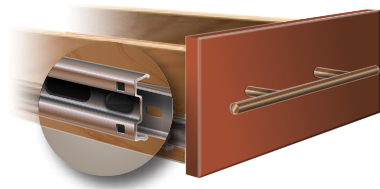

BALL BEARING DRAWER GUIDES

Our new residential-style ball bearing drawer guides provide smooth operation and full-drawer extension, for a stronger, more substantial drawer and a true home-like feel.

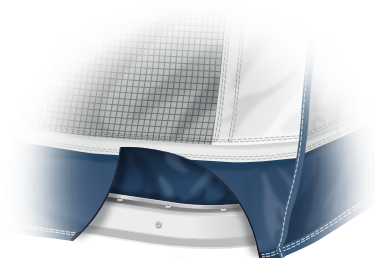

DURABLE TENT CONSTRUCTION

Setup is quick and easy with sectionalized tents, featuring a unique permanent tent-to-bunk attachment system. Bunk-end bows have also been raised for an additional 6" of headroom. (EXP and EX-PORT only.)

Jayco craftsmanship

Jayco's dedicated production team includes Amish craftsmen who build with well-honed woodworking techniques passed down for generations and skilled seamstresses who produce our upholstery, bedding and draperies with great attention to detail.



Jayco liveability

At Jayco, it's always been about liveability.

CENTRAL A/C

The Customer Value Package includes 13,500-BTU air conditioning in the SPORT, EX-PORT and EXP models, and central air with louvered, directional ceiling vents in the Jay Feather models.

AUDIO SYSTEM

The Jay Feather's home audio system with AM/FM/CD/DVD stereo and MP3 input jack bring the sounds of enjoyment to everyone.

OUTSIDE SHOWER

The standard outside shower is perfect after a fun day at the beach. (EXP and Jay Feather.)

INDEPENDENT SUSPENSION

TorFlex® independent suspension gives more ground clearance, provides a smooth ride, easier towing and offers greater durability.

ULTRA LIGHT STEEL FRAME

Our ultra light steel frame is 10-15% lighter, yet significantly more rigid than the frame of conventional travel trailers. Tapered rails, "huck" bolt assembly and an E-Coat™ finish give the frame durability and strength. (Select EXP models only.)

Floorplans

- = trailer hitch
- ◀ = outside storage
- LAV. = bathroom sink
- MICRO. = microwave
- OHC. = overhead cabinets
- REFRIG. = refrigerator
- WARD. = wardrobe

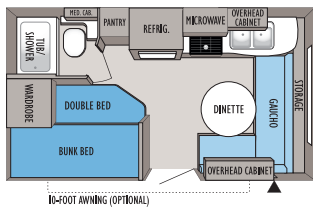

SPORT | 165

Ext. Length: 18' Ext. Height: 115" Unloaded Weight (lbs.): 2,910

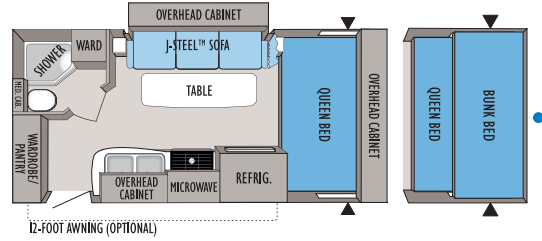

SPORT | 199

Ext. Length: 20' 7" Ext. Height: 118" Unloaded Weight (lbs.): 3,650

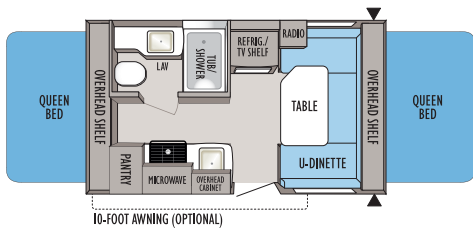

EX-PORT | 17C

Ext. Length: 17' 11" Ext. Height: 115" Unloaded Weight (lbs.): 2,935

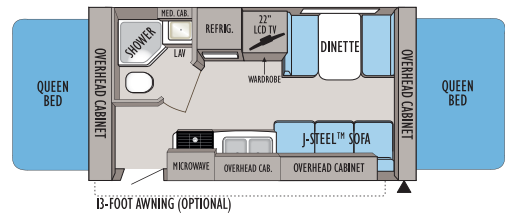

EXP | 19H

Ext. Length: 20' 4" Ext. Height: 115" Unloaded Weight (lbs.): 3,650

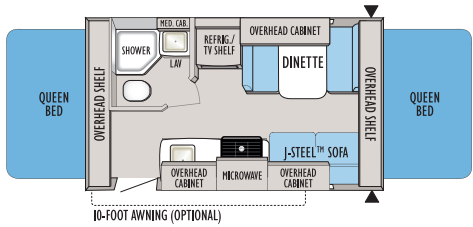

EX-PORT | 17Z

Ext. Length: 18' 6" Ext. Height: 115" Unloaded Weight (lbs.): TBD

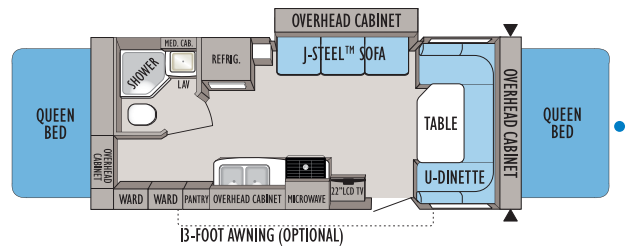

EXP | 23B

Ext. Length: 24' Ext. Height: 115" Unloaded Weight (lbs.): 4,165

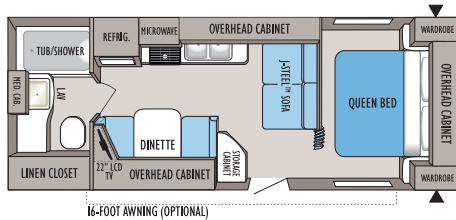

JAY FEATHER | 22Y

Ext. Length: 26' 1" Ext. Height: 120" Unloaded Weight (lbs.): 4,370

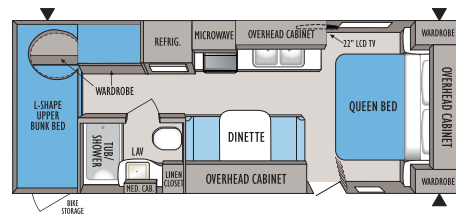

JAY FEATHER | 23K

Ext. Length: 26' 11" Ext. Height: 119" Unloaded Weight (lbs.): 4,620

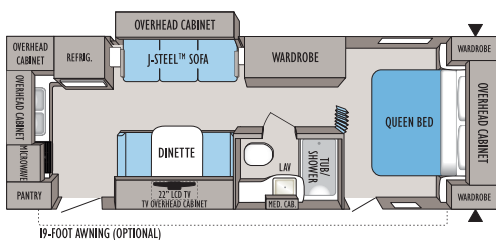

JAY FEATHER | 24Z

Ext. Length: 27' 9" Ext. Height: 119" Unloaded Weight (lbs.): 4,945

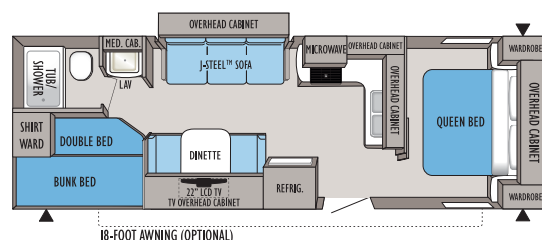

JAY FEATHER | 28R

Ext. Length: 30' 10" Ext. Height: 119" Unloaded Weight (lbs.): 5,210

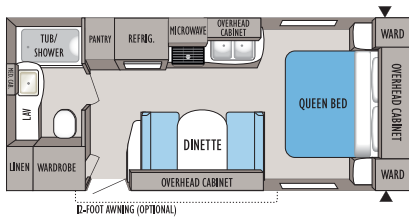

SPORT | 226

Ext. Length: 24' 1" Ext. Height: 116" Unloaded Weight (lbs.): 3,900

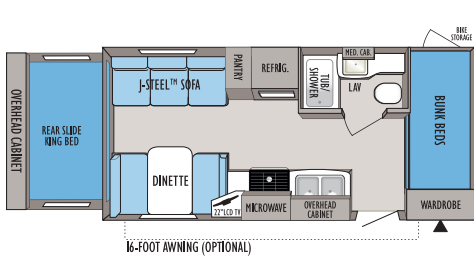

EXP | 213

Ext. Length: 23' 10" Ext. Height: 116" Unloaded Weight (lbs.): 4,285

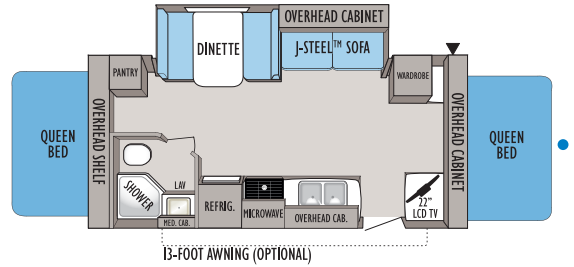

EXP | 21M

Ext. Length: 22' 4" Ext. Height: 125" Unloaded Weight (lbs.): 4,780

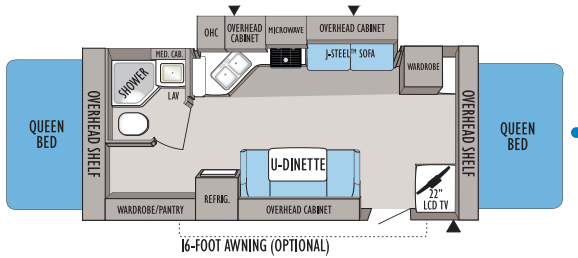

EXP | 23J

Ext. Length: 24' 11" Ext. Height: 125" Unloaded Weight (lbs.): 5,050

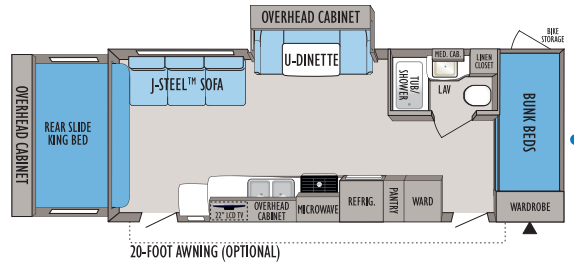

EXP | 26P

Ext. Length: 28' 9" Ext. Height: 126" Unloaded Weight (lbs.): 5,700

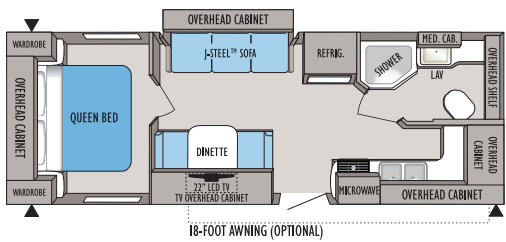

JAY FEATHER | 24S

Ext. Length: 27' 8" Ext. Height: 120" Unloaded Weight (lbs.): 4,765

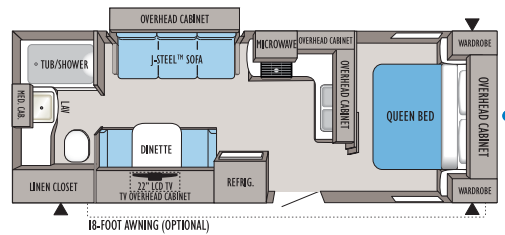

JAY FEATHER | 24T

Ext. Length: 27' 8" Ext. Height: 120" Unloaded Weight (lbs.): 4,845

Standards and options

	JAY FEATHER	EXP	EX-PORT	SPORT
STANDARD BATHROOM EQUIPMENT				
ABS tub surround	•			
Bathroom exhaust vent	•	•		
Marine toilet with foot flush	•	•	•	•
Medicine cabinet with mirror	•	•	•	
Residential 3-panel passage door	•			
Residential 6-panel passage door			•	•
Shower curtain with curved shower track	•	•	•	•
Towel holder	•	•	•	•
Tub/shower skylight (select models)			•	•
Vanity mirror	•			
STANDARD BEDROOM EQUIPMENT				
Decorative headboard				•
Decorative reading lights				•
Large pass-through storage (select models)				•
Privacy door				•
Quilted bed mat	•			
Quilted bedspread				•
Roof vent				•
Shirt wardrobe (select models)	•	•		
STANDARD KITCHEN EQUIPMENT				
3-burner range with 9,000-BTU SuperBurner™ and piezo igniter	•	•	•	•
5 cu. ft. flush-mount refrigerator	•	•		
6 cu. ft. flush-mount refrigerator			•	•
Cover for sink/cutting board (1)	•	•	•	
High-rise mixing faucet	•	•	•	•
Large kitchen window			•	•
Microwave oven with carousel	•			
Oversized drawer in U-dinette (select models)				•
Oversized oven	•			
Range hood with light and exhaust fan	•	•	•	•
Wallpaper border			•	•
White residential-style double-bowl kitchen sink			•	•
STANDARD CONSTRUCTION FEATURES				
5/8" seamless Structurwood® main floor decking with Poly Flex™ wrap on the underside of the floor	•			
78" ceiling height	•	•	•	•
Bead-foam insulation (R-17 in roof, R-9 in floor and R-7 in walls)				•
Bead-foam insulation (R-7 in sidewalls, R-9 in roof)	•			
Bead-foam insulation (R-9 in roof, R-9 in floor and R-7 in walls)			•	•
Cabinetry crafted with screwed-stile construction	•	•	•	•
Cable support system for bunk ends (interior mount)	•	•		
E-Coat™ protected frame	•	•		
Electric-powered slideout (select models)	•	•	•	•
FRP smooth fiberglass sidewall exteriors	•	•	•	•
One-piece, seamless rubber roof material	•	•	•	•
TuffShell™ vacuum-bonded laminated roof and sidewalls	•	•	•	•
Unitized 1-1/2" laminated construction of floor			•	•
Welded tubular aluminum sidewall and roof framework	•	•	•	•
STANDARD EXTERIOR EQUIPMENT				
2" hitch coupler	•	•		
2-5/16" hitch coupler			•	•
13" D-range tires	•	•		
13" radial tires				•
14" radial tires				•
110V G.F.C.I. protected exterior receptacle				•
120V G.F.C.I. protected exterior receptacle	•	•	•	•
ABS fender skirts	•	•	•	•
Aerodynamic front profile	•	•	•	•
Amber patio lights with inside switch	•	•	•	•

	JAY FEATHER	EXP	EX-PORT	SPORT
Automotive styling rear caps				•
Baggage doors—lockable, insulated and radius-cornered with heavy-duty grab handle			•	•
Bunk end tents permanently attached to bed base			•	•
Composite bumper extensions				•
DuraTek™ water-repellent vinyl tent			•	•
Exterior speakers, high-output marine grade (2)			•	•
E-Z Lube® axles	•	•	•	•
Fiberglass radius-cornered entrance door and screen door	•	•	•	•
Front window with flush-mounted stone guard (select models)				•
Heavy-duty, retractable entrance step	•	•	•	•
Impact-resilient composite wheel wells	•	•	•	•
MaxiStor™ (select models)				•
Molded rain guttering with extended drip spouts	•	•	•	•
Painted bottom radius skirting	•	•	•	•
Pass-through storage compartment	•	•	•	•
Prep for outside grill	•	•	•	•
Self-supporting lockable end-bunks (no poles required)	•	•	•	•
Sewer hose storage compartment	•	•	•	•
Stabilizer jacks (1 pair, rear) with sand pads				•
Stabilizer jacks (2 pair) with sand pads	•			
TorFlex® independent torsion-axle rubber ride suspension system	•	•	•	•
White spoked wheels	•	•	•	•
STANDARD INTERIOR EQUIPMENT				
22" LCD HDTV in living area				•
Ball bearing drawer guides, 50-lb. capacity with full-drawer extension				•
Cable and satellite TV prepped				•
Cable TV hookup with RG6 coax	•	•	•	•
Crank-up HDTV antenna with signal booster	•	•	•	•
Deep-quilted cushions for bunk(s)				•
Fan lights in bunk (2)				•
Manchester Oak doors and drawers	•	•	•	•
Mini-blinds throughout				•
Pleated night shades	•	•	•	•
Privacy curtains for bunks				•
Queen bed-size bunk mats (2)				•
Residential furniture, designed and made by Jayco®	•	•	•	•
Vinyl flooring wall-to-wall	•	•	•	•
STANDARD HEAT, POWER & WATER EQUIPMENT				
6-gal. gas water heater	•	•	•	•
12V demand water pump	•	•	•	•
12V electrical system with deluxe 120V 45-amp power converter	•	•	•	•
20-lb. propane gas bottle	•			
30-amp power cord	•	•	•	•
18,000-BTU furnace with auto-ignition	•	•		
Auto-ignition furnace with wall thermostat	•	•	•	•
Double 20-lb. propane gas bottles				•
Double 30-lb. propane gas bottles				•
Gravity fill for water	•	•	•	•
Hookup for city water	•	•	•	•
Outside shower	•			
Rotocast fresh water holding tanks	•	•	•	•
Single 30-lb. propane gas bottle, with regulator				•
Systems monitor panel	•	•	•	•
Water heater bypass system	•	•	•	•
Winterization kit	•	•	•	•

	JAY FEATHER	EXP	EX-PORT	SPORT
STANDARD SAFETY EQUIPMENT				
Breakaway switch				•
Clear safety-glass windows				•
Dual hitch safety chains	•	•	•	•
Egress window	•	•	•	•
Fire extinguisher	•	•	•	•
Lock and deadbolt on entrance door	•	•	•	•
Multiple egress windows	•	•	•	•
Propane/carbon monoxide alarm	•	•	•	•
Smoke alarm	•	•	•	•
Tinted safety-glass windows	•	•	•	•
OPTIONS				
Aluminum rims				•
Canadian standards	•	•	•	•
Customer Value Package	•	•	•	•
Customer Value Package with 15,000-BTU central A/C				•
Heated bed mats (select models)				•
Hydraulic surge brakes	•	•		
Oven				•
Portable outside gas grill	•	•	•	•
Queen bed with bunk (199)	•			
Satellite kit				•
Spare tire with carrier				•
Suspension lift kit (2") (select models)				•
Water purification system	•	•	•	•
CUSTOMER VALUE PACKAGE				
6-gal. gas/electric DSI auto-ignition water heater				•
13,500-BTU A/C				•
13,500-BTU A/C with wall thermostat				•
13,500-BTU A/C with wall thermostat and louvered directional ceiling vents				•
ABS gas bottle cover with access hatch to propane valves				•
ABS tub surround				•
Bathroom power vent				•
Bi-fold range cover				•
Carefree® patio awning	•	•		
Carefree® Travel™ 12V electric patio awning				•
Microwave oven with carousel	•	•	•	•
Multi-Media Premium Sound System™				•
AM/FM/CD/DVD stereo with MP3 input jack				•
Multi-Media Sound System™ AM/FM/CD stereo with MP3 input jack and 2 speakers	•	•	•	•
Multi-Media Sound System™ AM/FM/CD/DVD stereo with MP3 input jack				•
Outside shower				•
Oversized oven				•
Spare tire and tire carrier	•	•	•	•
Stabilizer jacks (2 pairs) with sand pads	•	•	•	•
Water heater bypass system	•	•	•	•

Interior color options

SAND

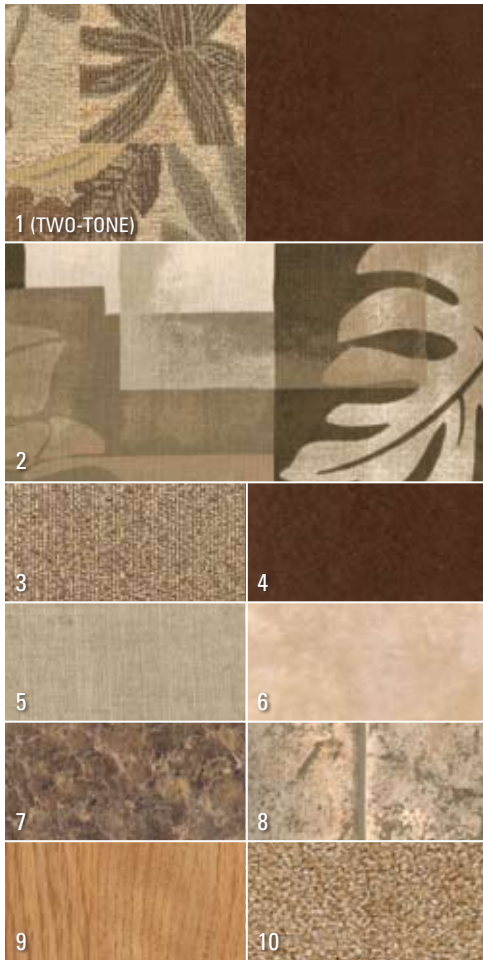

SPICE

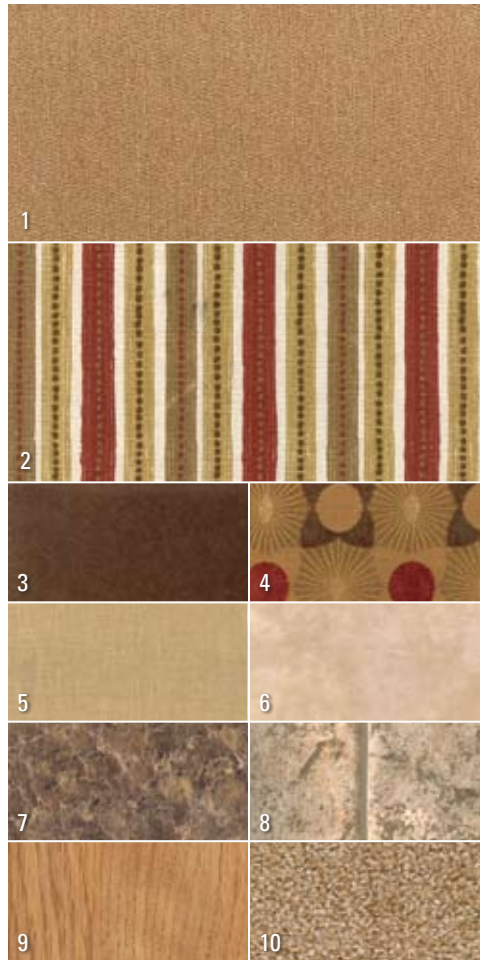

- 1 Sofa
- 2 Bedspread
- 3 Chair
- 4 Accent fabric
- 5 Drapery
- 6 Wall panel
- 7 Countertop
- 8 Flooring
- 9 Wood
- 10 Carpet

Specifications

	FLOORPLAN	EXTERIOR LENGTH	EXTERIOR HEIGHT (WITH A/C)	INTERIOR HEIGHT	UNLOADED VEHICLE WEIGHT (LBS.)	DRY HITCH WEIGHT (LBS.)	GROSS VEHICLE WEIGHT RATING (LBS.)	CARGO CARRYING CAPACITY (LBS.)	FRESH WATER CAPACITY (WITH WATER HEATER)	GRAY WASTEWATER CAPACITY (GAL.)	TOILET/BLACK WASTEWATER CAPACITY (GAL.)
SPORT	165	18'	115"	78"	2,910	440	3,500	590	30	30.5	11
	199	20' 7"	118"	78"	3,650	265	4,750	1,100	30	30.5	11
	226	24' 1"	116"	78"	3,900	380	4,750	850	30	30.5	11
EX-PORT	17C	17' 11"	115"	78"	2,935	480	3,500	565	28.5	30.5	22.5
	17Z	18' 6"	115"	78"	TBD	TBD	TBD	TBD	28.5	30.5	22.5
EXP	19H	20' 4"	115"	78"	3,650	440	4,950	1,300	28.5	30.5	22.5
	213	23' 10"	116"	78"	4,285	450	5,500	1,215	28.5	30.5	22.5
	21M	22' 4"	125"	78"	4,780	610	6,000	1,220	28.5	30.5	22.5
	23B	24'	115"	78"	4,165	370	4,950	785	28.5	29.5	22.5
	23J	24' 11"	125"	78"	5,050	765	6,500	1,450	28.5	30.5	22.5
	26P	28' 9"	126"	78"	5,700	760	6,750	1,050	28.5	30.5	30.5
JAY FEATHER	22Y	26' 1"	120"	78"	4,370	515	5,800	1,430	28.5	30.5	30.5
	23K	26' 11"	119"	78"	4,620	630	5,900	1,280	28.5	30.5	30.5
	24S	27' 8"	120"	78"	4,765	635	6,250	1,485	28.5	30.5	30.5
	24T	27' 8"	120"	78"	4,845	645	6,250	1,405	28.5	45	30.5
	242	27' 9"	119"	78"	4,945	535	6,500	1,555	28.5	45	30.5
	28R	30' 10"	119"	78"	5,210	765	6,500	1,290	28.5	45	30.5

Unloaded Vehicle Weight (UWV): Sometimes referred to as "Dry Weight," UWV means the typical weight of this trailer as built at the factory. The UWV, as used in product literature and other promotional materials, does not include cargo, fresh water, propane, options or dealer-installed accessories.

Gross Vehicle Weight Rating (GVWR): GVWR means the maximum permissible weight of the trailer, including the UWV plus passengers, personal items, all cargo, fluids, options, and dealer-installed accessories. The GVWR is equal to or greater than the sum of the UWV and the CCC.

Cargo Carrying Capacity (CCC): CCC means the maximum weight of all passengers, personal items, food, fresh water, propane, tools, other cargo and dealer-installed accessories that can be carried by the trailer. CCC is equal to or less than GVWR minus UWV. The addition of options will decrease the CCC.

Hitch Weight (HW): The hitch weight, as used in product literature and other promotional materials, does not include cargo, fresh water, propane gas, options or dealer-installed accessories. The addition of these types of items will either add to or subtract from the stated hitch weight.

It is important for your safety and enjoyment that your tow vehicle be adequately sized and equipped to tow and handle the GVWR of the RV you select. Review weights and rating of your tow vehicle and consult a competent advisor for questions or advice. Whether you are new to RVing or a veteran, get a feel for the performance of your tow vehicle and the RV together before heading out on the roadways. When you tow an RV, you must drive differently than you do when driving a single vehicle. Practice hooking up, driving, backing up and braking in a safe environment or seek out professional instruction. Jayco affixes a weight label to each RV which lists weight information for that vehicle. See specification chart above.



AMERICA'S MOST **LIVEABLE** RVs.

2 YEAR WARRANTY

The Jayco Co-Pilot Warranty is a manufacturer's limited warranty. It comes from the people who build Jayco recreation vehicles to the people who buy them. Each Jayco is warranted to the original purchaser for twenty-four (24) months or twenty-four thousand (24,000) miles (mileage limitation applies to motorized products only), whichever occurs first, from the original date of purchase against defects in materials and workmanship. Jayco's limited warranty is not transferable. **Go ahead and compare the Jayco warranty with other manufacturers' warranties. You'll find it's the best in the business!**

For a copy of the limited warranty with full terms and conditions, ask your local Jayco dealer.

300 JAYCO DEALERS

Establishing a solid relationship with your local Jayco dealer is a key component in the enjoyment of your new Jayco. By purchasing from a local dealer, you will have a convenient location for sales, parts and service support.

Jayco dealers are required to deliver all products at the site of the sale to provide a full product orientation and walkthrough at the time of delivery. It's a good way to become familiar with your Jayco and to meet the service, parts and warranty staff members who will be assisting you. If you live in Canada, there are regulations that must be met when buying a Jayco RV. Your local Canadian dealer is a professional at meeting these requirements and regulations. There simply is no substitute for a good relationship with your local Jayco dealer.

1 YEAR ROADSIDE ASSISTANCE

Travel worry-free with Jayco's Customer First Roadside Assistance program, yours at no cost during your first year of ownership. This program is offered through Coach-Net®, the largest RV emergency road service in the country, and gives you immediate access to dependable roadside assistance and support services with a simple phone call.

- Free jump starts
- Free tire changes
- Free fuel delivery
- Free lockout service
- Free travelers checks
- Toll-free nationwide service appointment assistance
- 24-hour toll-free emergency message service
- Free custom trip routing and full-color map service
- Free dispatch of on-site mechanical service
- \$2,000 trip-interruption reimbursement
- RV technical assistance hotline
- Free towing to nearest qualified service

Your Jayco Dealer

Colton RV
North Tonawanda, NY
14120 (716) 694-0188
(800) 628-4889
www.ColtonRV.com

Colton RV
Orchard Park, NY 14127
(716) 957-3250
(800) 628-4889
www.ColtonRV.com



Jayco proudly sponsors Tread Lightly!®, a nonprofit organization whose mission is to empower generations to enjoy the outdoors responsibly through education and restoration.



From RV insurance to extended warranties, JayPlus has it covered. Ask your Jayco dealer about our exclusive JayPlus program today.



As a Jayco owner, you can be part of the Jayco Jafari International Travel Club. Ask your dealer about the Jafari "flight" in your area, write Jayco or visit our website.

Jayco, Inc., P.O. Box 460, Middlebury, IN 46540, www.jayco.com 

See dealer for further information and prices. All information in this brochure is the latest available at the time of publication approval. Jayco reserves the right to make changes and to discontinue models without notice or obligation. Photos in this brochure may show optional equipment and props for photography purposes. RVs built for sale in Canada may differ to conform to Canadian codes. ©2010 Jayco, Inc. 10-JFTR-PL 0809-100K Printed in U.S.A.