

# MODEL Z FLOORPLAN

SPECS & FEATURES

# 2900

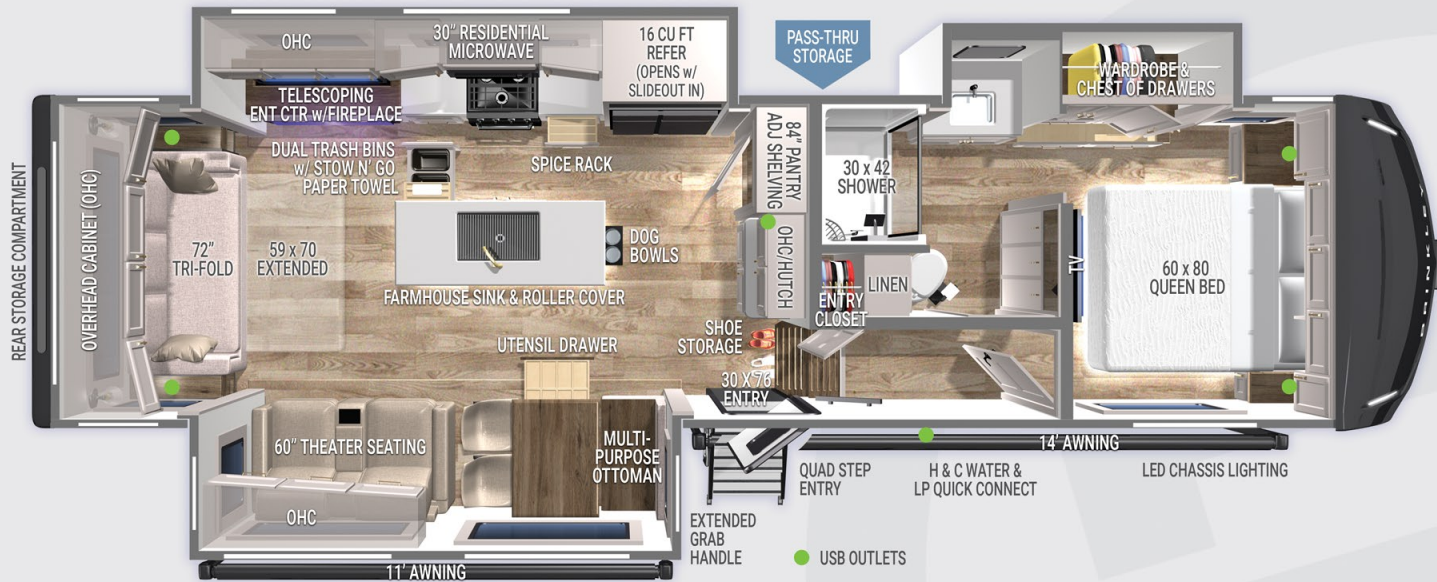

## SPECIFICATIONS:

- UVW – 11,674 lbs.
- GVWR – 14,495 lbs.
- Hitch Weight – 2,081 lbs.
- Exterior Length – 32' 11"
- Overall Height – 12' 9"
- Overall Height with 2nd AC – 13' 2"
- Width – 96"
- Bath & Bedroom Height - 79 ½"
- Slide Height - 76"
- Wheels & Tires – 17.5" H-Rated (16 ply)
- Fresh Water Capacity – 75 gal
- Grey Water Capacity – True 90 gal
- Black Water Capacity – 45 gal
- Insulation – Floors R40, Walls R11, Ceiling R40

## FEATURES:

- Dual Pull-Out Trash Bins w/ Integrated Stow N' Go Paper Towel Holder
- Wide Stance Leveling Jacks & Oversized Front Storage
- Residential Frameless Windows w/ 6" Opening
- Electric Dump Valves
- Kitchen & Living Room/Dining Room Flush Floor Slides
- Automotive Grade Front Cap, Lights, & Lens
- 84" Pantry w/ Adjustable Shelves & Appliance Outlet
- 18 Outlets & 6 Outlets w/ USB & USB-C
- Basement Utility Access w/ Sliding Doors & Motion Lights
- Pull-Out Storage for 'Stewy' w/ Removable Dog Bowls
- 370W Solar Panel w/ 50AMP MPPT Controller (Inverter Prep & Lithium Ready)

- Over 100 Cubic Feet of Exterior Storage
- Rear Storage Compartment (48"x40"x15")
- Tough Ply Storage Area Liner
- Brinkley CraftSense™ Wood Trim Construction
- Premium Residential Cabinets & Drawers w/ Dovetail Joints
- Residential End Tables w/ Flip-Up Charging Station & Storage
- Bedside End Tables & Outlets w/ USB & USB-C
- 2 - Hot/Cold Outdoor Shower (BOTH sides of coach)
- Built-in Wire Conduit from Roof to Basement
- Quad Tip-To-Clean Entry Steps w/ Motion Lights
- Industry First Brass Plumbing Connections
- Industry First Low Maintenance Roof
- Heavy-Duty 7k lbs. Axles w/ 8k lbs. Leaf Springs

## FACTORY OPTIONS:

- Dual Pane Windows
- Low-Profile 2nd Air Conditioner
- Queen Bed (Mandatory)

Colton RV & Marine  
3122 Niagara Falls Blvd  
North Tonawanda, NY 14120  
(716) 694-0188  
www.ColtonRV.com

Colton RV  
3443 Southwestern Blvd.  
Orchard Park, NY 14127  
(716) 957-3250  
www.Coltonrv.com

032323

## PRE-PRODUCTION INFO

Based on pre-production prototype. All preliminary info & content is subject to change without notice. Please consult with your dealer for current production model details & information.



For More Information, Photos, & Videos,  
& Why Brinkley go to [BrinkleyRV.com](http://BrinkleyRV.com)

