

# Sun Valley

by EVERGREEN

Find Your Place  
in the Sun.

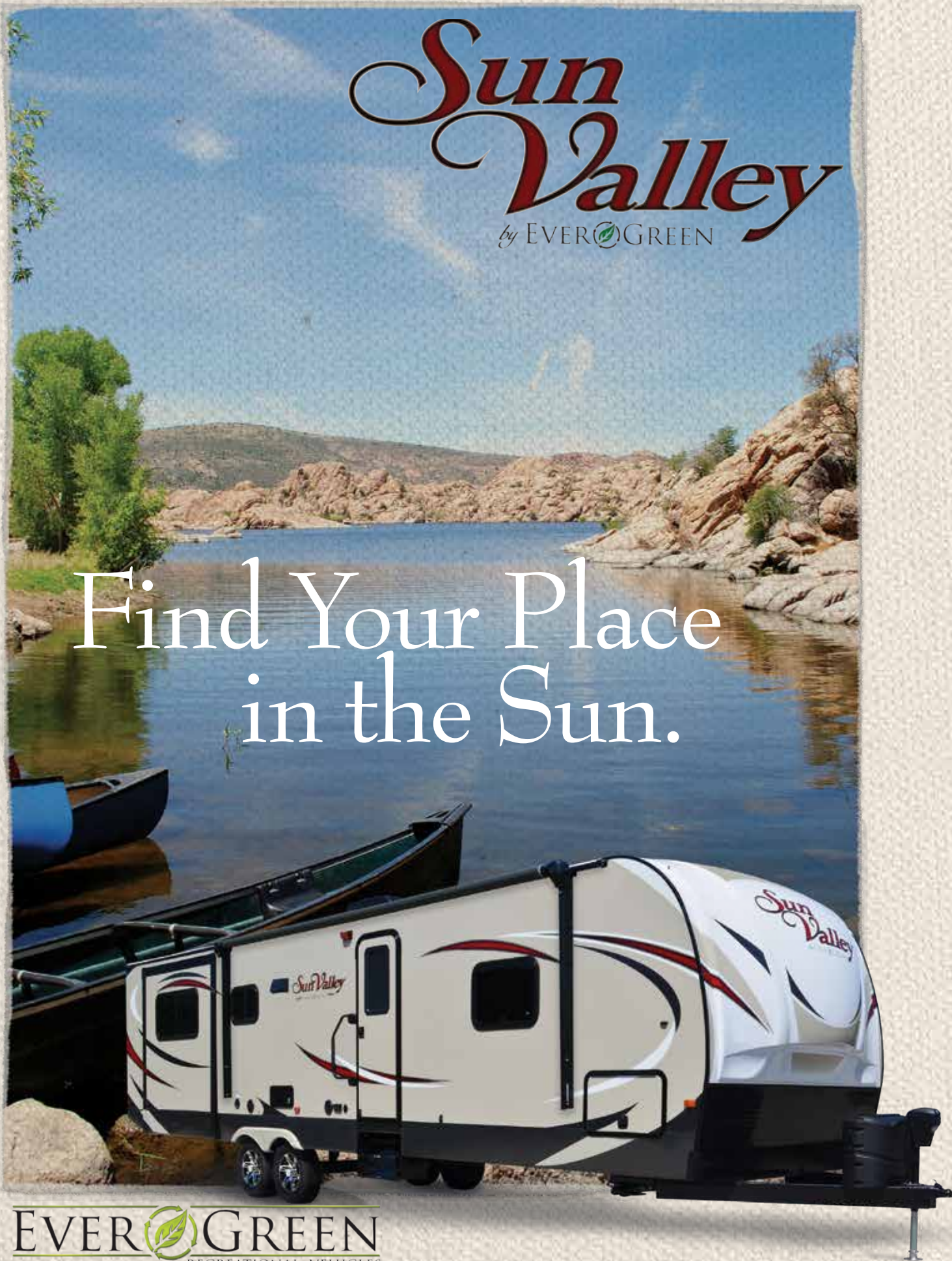



# Welcome to Sun Valley. More Choices and Value for Your Family.

Our Sun Valley travel trailers have more floorplans and variety than any other brand in the EverGreen family of products. Better yet, Sun Valley has all the quality you'd expect from an EverGreen, at a surprisingly affordable price.

With many floorplans to choose from, sleeping anywhere from two empty nesters to a family of ten, there's a Sun Valley for you. And if your family owns a medium to full sized SUV or half-ton pickup, you can head on down the road pulling a Sun Valley.

Welcome to our Sun Valley, the most versatile travel trailer in our family.



Curved shower doors increase the shower size while a skylight makes the entire bathroom feel even more spacious.

S32RE



This master bedroom features a wardrobe slide providing extra storage space wide enough to hang shirts and slacks.

S32RE



# We pulled out all the stops to make your Sun Valley a home away from home.



## All the Comforts of Home.

No need to leave all the comforts of home behind because you're 500 miles down the road. We've included luxury features in the Sun Valley line up. Well-appointed, interiors with easy to clean surfaces are both attractive and practical. Dinettes and sofas double as comfortable sleeping quarters with quality mattresses. Functional kitchens with name brand appliances make for easy home cooking. There's plenty of food storage to feed your entire family—large or small. Ample entertainment centers with flat screen TVs have optional larger screen upgrades.

## Built Tough for Decades of Family Fun.

Sun Valley may be one of our most affordable travel trailers, and it's still built

with "The EverGreen Difference."

Features such as laminated construction built on top of a DuraLite™ Double Welded Aluminum Structure are all part of the Sun Valley package. And our legendary lightweight, easy-to-tow construction makes Sun Valley ready for the full sized family or today's full-sized SUV or half-ton pickup.

## A Place in the Sun for Any Family.

With the largest selection of floor plans of any EverGreen brand, you're sure to find the coach that's perfect for your family. Check out the Sun Valley floor plans on pages 8 and 9!

Tasteful fabric valences, window shades, and rich wood trim accents all add to the touch of home. Choose from a variety of island kitchen floor plans with built in sinks.



S32RE

Under dinette storage bins are perfect for keeping your storage space neat and organized.





S29DB





### Sun Valley Interior Color Selections

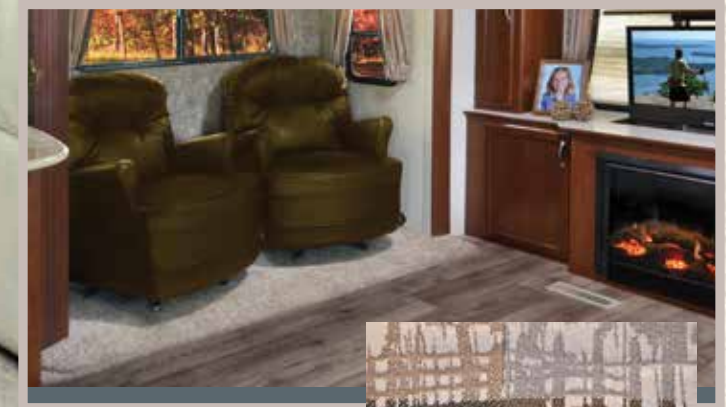
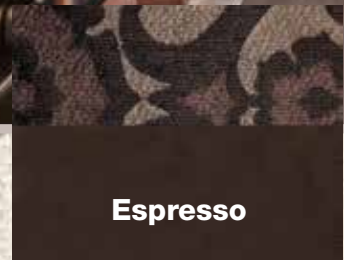



# No one builds travel trailers like EverGreen.

Take the time to compare because there is an "EverGreen Difference." Since we first revolutionized the RV industry with the Ever-Lite travel trailer, we've been busy focusing on the innovation front with new manufacturing and material specifications to build a better trailer for your family.

## Construction Features

### Walls

- 1** Fully double welded aluminum frame
- 2** High-density, block foam insulation
- 3** Plywood substrate
- 4** High-Gloss fiberglass-reinforced exterior

### Roof

- 5** Fully double welded, crowned aluminum frame
- 6** High-density, block foam insulation
- 7** Plywood substrate
- 8** Reflective, white TPO roofing

### Floor

- 9** Enclosed, heated seamless underbelly
- 10** Fully double welded aluminum frame
- 11** Woven plastic floor brace
- 12** High-density, block foam insulation
- 13** Plywood substrate
- 14** Padded "No-Crack" vinyl floor with 7-year warranty
- 15** Steel I-beam frame

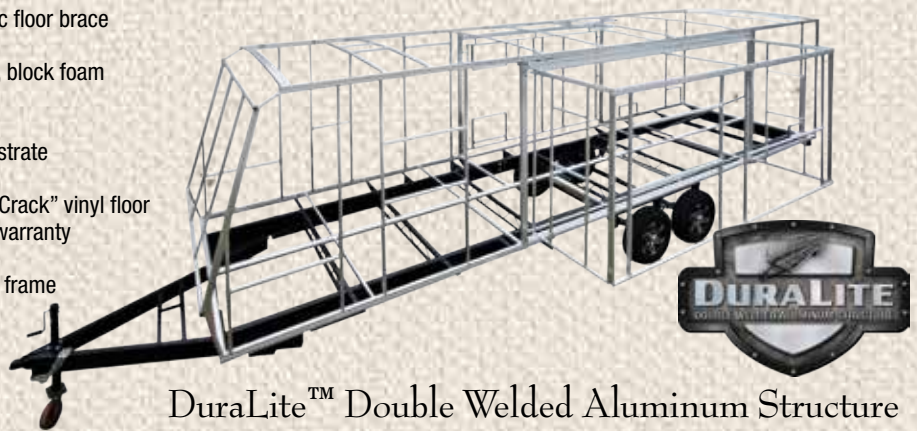

## DuraLite™ Double Welded Aluminum Structure

Sun Valley is built on the DuraLite™ Double Welded Aluminum Structure. It includes six-sided double-welded aluminum frame construction in the walls, roof and floors, with header framing around all doors, windows and baggage door openings. Our strong, durable frame eliminates flexing and DuraLite™ is superior to wood frame construction used in other travel trailers, which can rot when exposed to water.

## Vacuum Lamination



Sun Valley is built with vacuum lamination in the roof. Dense, block foam insulation is coated with a water-based urethane adhesive which becomes super bonded under the heat and high pressure of EverGreen's vacuum lamination process. The result is a stronger, yet lighter and more durable coach that's better insulated for all seasons.

## TPO Roofing



Bright white, mechanically applied, vacuum laminated TPO roof membrane is superior to rubber roof membranes that can bubble, loosen, mold, mildew or chalk. The TPO glue is spread evenly to create a surface that is cooler and won't mold or mildew. It also requires less maintenance than conventional roofs.





# Standard Features and Optional Packages

## Construction

- Steel I-beam frame
- Laminated sidewalls, roof and floors
- Tough fiberglass-reinforced exterior
- Crowned roof with fully laminated white, reflective TPO material
- Four frame-mounted stabilizer jacks
- Diamond plate front stone guard

## Exterior

- Large, dark-tinted automotive style windows
- Porch light
- Exterior speakers
- Power Awning
- Radius entry door
- Large pass-through storage
- Designer graphics
- Large baggage doors with slam latches

## Utilities

- Detachable power cord with LED indicator light
- Exterior LCD TV hookup with bracket, cable hookup
- Furnace
- Electronic tank readouts
- Water pump with winterizing inlet
- Fire extinguisher, carbon monoxide detector, smoke alarm
- LP quick disconnect (gas grill ready)
- LP harness and machine-crimped fittings
- Gear-driven 4-point slide system

## Living

- Entertainment center with Optional 32-inch TV
- Ceiling speakers

## Kitchen

- Padded "No Crack" vinyl flooring
- Large kitchen window with blind
- Full-size composite sink with cover and gooseneck faucet
- Screwed and glued solid wood cabinetry
- Microwave
- Three-burner range with oven
- Double-door refrigerator/freezer
- Plywood drawers with full-extension ball bearing guides

## Bath

- Full tub or neo-angled shower
- Skylight over shower/tub
- Large medicine cabinet and mirror
- Power exhaust fan
- Residential fixtures

## Bedroom

- True residential 60x80 innerspring mattress
- Large under-bed storage with lift struts
- Decorative bedspread
- Dual wardrobes

## **PREMIUM RESERVE PACKAGE**

### Exterior

- High-gloss fiberglass front cap
- Fully enclosed heated underbelly
- Six sided Duralite Double Welded Aluminum Structure
- 20# LP tanks w/hard shell cover
- 6 gallon gas/electric water heater w/ DSI
- Outside shower
- Spare tire and carrier
- Swing-out grab bar

- Exterior speakers
- 13,500 BTU ducted AC with quick chill function
- Radial tires with nitrogen fill
- TV/Radio antenna
- Power awning
- Black tank flush
- Automotive trim-seal windows
- Barreled ducted laminated roof system
- Aluminum wheels
- Power tongue jack

### Interior

- 60"x80" residential queen bed
- AM/FM/CD/DVD with Bluetooth
- Interior speakers
- Toilet w/foot flush pedal
- Pleated shades
- Solid surface countertops
- 8 cubic foot refrigerator
- Tri-fold sleeper sofa

### Optional Equipment

- 15,000 BTU AC
- Additional 13,500 BTU AC (requires 50 Amp package)
- 50 Amp service with 2<sup>nd</sup> AC prep
- 32" flat screen TV
- Outside grill
- Power stab jacks front and rear
- Fireplace with remote control
- Freestanding table with four chairs
- Shower enclosure
- CSA/QAI



# Choose your floor plan from a wide range

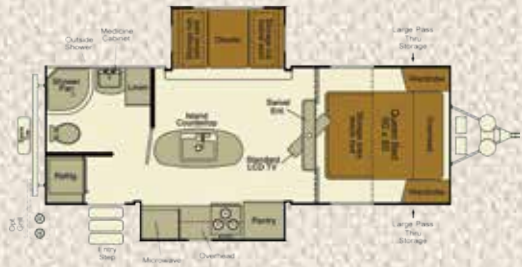

**S23RB**



**S29DB**



**S27KS**



**S29RL**

	<b>SPECIFICATIONS</b>	<b>S23RB</b>	<b>S27KS</b>	<b>S29DB</b>	<b>S29RL</b>
Furniture	Total Dry Weight	5,600	6,155	6,625	6,300
	Dry Hitch Weight	880	750	875	650
	GVWR (LBS)	8,715	8,795	8,795	8,795
Features	Fresh Water Capacity (GAL)	56	56	56	56
	Gray Water Tank Capacity (GAL)	29	58	58	29
	Black Water Tank Capacity (GAL)	29	29	29	29
	LP Capacity (LBS)	40	40	40	40
	Cargo Carrying Capacity (LBS)	2,000*	1,930	1,480	1,500*
Linoleum	Overall Length	27'-6"	32'-0"	34'-0"	33' 11"
	Overall Height (including AC)	10'-8"	10'-8"	10'-8"	10' 8"
	Width	8'-1"	8'-1"	8'-1"	8' 1"
	Bed Size (inches)	60 x 80	60 x 80	60 x 80	60 x 80
	Power Awning Length	18'	20'	20'	16'
	Tire Size	ST225/75R15-D	ST225/75R15-D	ST225/75R15-D	ST225/75R15-D

\*EverGreen RV reserves the right to change or discontinue at any time, without notice, prices, colors, materials, equipment, accessories, specifications, models, and packages, without incurring any obligations to make the same or similar changes to trailers previously sold. Colors shown may vary due to reproduction and printing processes.



of popular choices.



**S32RE**



**S33BH**



**S32RL**

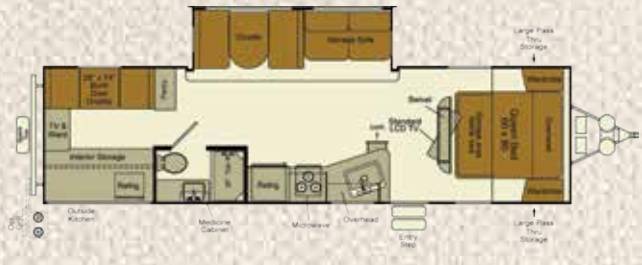

**S283BHLTD**

SPECIFICATIONS	S32RE	S32RL	S33BH	S283BHLTD
Total Dry Weight	7,400	TBD	TBD	TBD
Dry Hitch Weight	805	TBD	785	TBD
GVWR (LBS)	9,995	9,995	9,995	TBD
Fresh Water Capacity (GAL)	56	56	56	36
Gray Water Tank Capacity (GAL)	58	58	29	29
Black Water Tank Capacity (GAL)	29	29	29	29
LP Capacity (LBS)	40	40	40	40
Cargo Carrying Capacity (LBS)	2,120	TBD	TBD	TBD
Overall Length	36'-8"	37' 4"	37'-6"	32' 11"
Overall Height (including AC)	10'-8"	10' 8"	10'-8"	10' 8"
Width	8'-1"	8' 1"	8'-1"	8' 1"
Bed Size (inches)	60 x 80	60 x 80	60 x 80	60 x 80
Power Awning Length	18'	14'	16'	15'
Tire Size	ST225/75R15-D	ST225/75R15-D	ST225/75R15-D	ST205/75R14-C

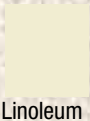



## Check out Sun Valley's Features and Benefits

- ✓ DuraLite six-sided double welded cage construction provides a secure structure
- ✓ Skylight over shower/tub for natural light to give the space a residential feel
- ✓ 42-inch deep slide outs give you more space for your family to enjoy
- ✓ Raised panel cabinet doors with screwed and glued cabinetry will stand up to the kids
- ✓ Padded "No-Crack" vinyl flooring is comfortable on little feet and durable, too
- ✓ 60x80 residential queen bed with under-bed storage and lift struts
- ✓ Ducted, heated enclosed underbelly for year round family camping trips
- ✓ Outdoor kitchens that allow you to truly enjoy the great outdoors
- ✓ Lightweight, half-ton towable construction makes towing with your family sedan possible
- ✓ Large variety of floor plans, because no two families are the same

### Compliments of:

Colton RV  
North Tonawanda, NY 14120  
(716) 694-0188  
(800) 628-4889  
[www.ColtonRV.com](http://www.ColtonRV.com)

See the above dealer for further information and prices.



## The EverGreen Peace of Mind Warranty.

We're so confident in our quality that we're willing to stand behind our travel trailers and fifth-wheels with one of the best warranties in the industry.

- 1-Year Limited Warranty
- 3-Year Limited Structural Warranty\*
- 12-Year Roofing Materials Warranty (except the Ascend)
- 1-Year Free Roadside Assistance Program

\*Contact your EverGreen dealer for an applicable copy of all limited warranties

## Learn more about our full-line of quality EverGreen Travel Trailers, Fifth Wheels, Toy Haulers and Motorhomes.



10758 County Road 2 • Middlebury, IN 46540  
Phone: (574) 825-4298 • Fax: (574) 825-4299



[www.GoEverGreenRV.com](http://www.GoEverGreenRV.com)  
[www.LifestyleLRV.com](http://www.LifestyleLRV.com)

