

FOUR WINDS &
FOUR WINDS SUPER C

MADE TO FIT
YOUR PURSUITS



Four Winds

 BY THOR MOTOR COACH

WHEN WE SAY *MADE TO FIT*, WE MEAN IT.

Wherever your pursuits may take you, let our Four Winds be the catalyst that makes the journey a memorable one. Four Winds offers an impressive line-up of floor plans, standard equipment and unique options to help make the motorhome that is ***Made to Fit*** your pursuits.



26A | BRONZE COIN | OLYMPIC CHERRY



23U | ROLLING STONE | SYDNEY MAPLE



22B | BRONZE COIN | SYDNEY MAPLE



31L | ROLLING STONE | OLYMPIC CHERRY



CLASS C



THOR
MOTOR COACH

Made to fit.

BEAUTY INSIDE & OUT

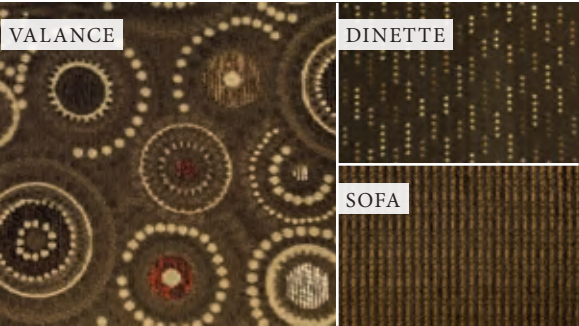

BRONZE COIN



RESIDENTIAL VINYL FLOORING

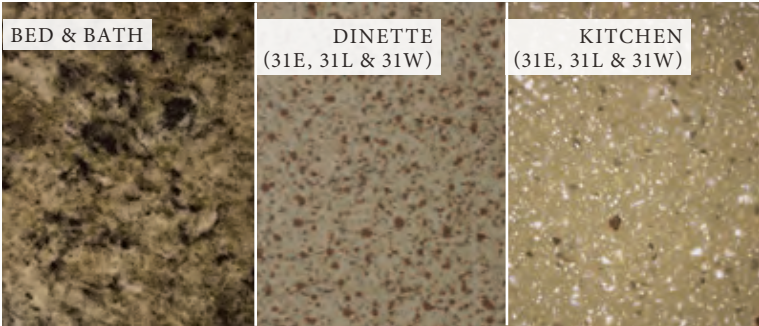

COUNTERTOPS



ROLLING STONE



OLYMPIC CHERRY



SYDNEY MAPLE

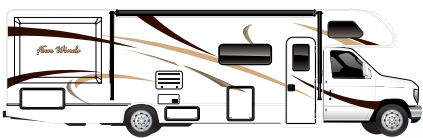

STANDARD GRAPHICS



GOLDEN NUGGET-CHAMPAGNE 

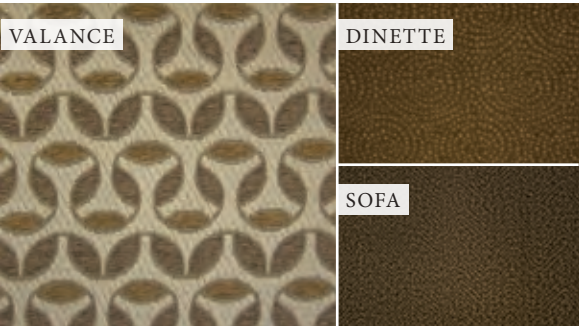

TOASTED ALMOND



RAISED PANEL
OLYMPIC CHERRY
(31E, 31L & 31W)



RAISED PANEL
SYDNEY MAPLE
(31E, 31L & 31W)



GOLDEN NUGGET-TAUPE 



RIO RED-CHAMPAGNE 

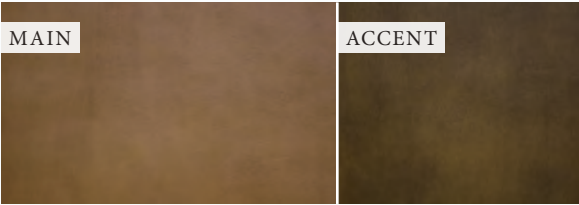

OPTIONAL LEATHERETTE FURNITURE



RIO RED-TAUPE 

CHEVROLET® C4500 DUALY

OPT 22B, 22E, 23U, 24C, 26A & 26B



VORTEC® 6.0L V8 ENGINE

The Vortec is powerful with its 323-horsepower and 373 lb.-ft. of torque. It delivers exceptional refinement to go with its great strength. Quiet features built into the engine help reduce vibrations throughout the chassis.

POWER 4-WHEEL ANTI-LOCK DISC BRAKE SYSTEM

The 13-inch front and 13.5-inch rear discs help stop your motorhome quickly.

INDEPENDENT FRONT SUSPENSION

The combination of long and short control arms help ensure maximum wheel contact with the road providing a smooth and comfortable ride.

HYDRA-MATIC® 6-SPEED AUTOMATIC TRANSMISSION

Includes Tap-Up/Tap-Down Driver Shift Control and auto grade braking to automatically slow the vehicle using the engine.

LIMITED WARRANTY

The Chevrolet® Motorhome Chassis comes standard with a Bumper-to-Bumper Limited Warranty for 3 years or 36,000 miles and a Powertrain Limited Warranty for 5 years or 100,000 miles, whichever comes first.

FORD® E-SERIES

OPT 22B, 22E, 23U, 24C, 26A & 26B.

STD 28Z, 29G, 31E, 31L & 31W.



TRITON® V10 ENGINE

The 6.8L V10 engine has a proven track record of durability and low-hassle maintenance. Extremely smooth running with a commanding 305-horsepower and 420 lb.-ft. of torque.

POWER 4-WHEEL DISC ANTI-LOCK BRAKE SYSTEM

Maintains brake balance in heavy use and varying road conditions. Reduces wheel lock up and helps maintain superior steering control.

TWIN I-BEAM FRONT SUSPENSION

Provides a comfortable ride by allowing the front wheels to work independently of each other, reducing driver stress.

TORQSHIFT® 6-SPEED AUTOMATIC TRANSMISSION

Provides crisp, firm and quick shifting without sacrificing driver comfort.

LIMITED WARRANTY

The Ford® Motorhome Chassis has a Bumper-to-Bumper Limited Warranty for 3 years or 36,000 miles and a Powertrain Limited Warranty for 5 years or 60,000 miles, whichever comes first.

CLASS C FLOOR PLANS

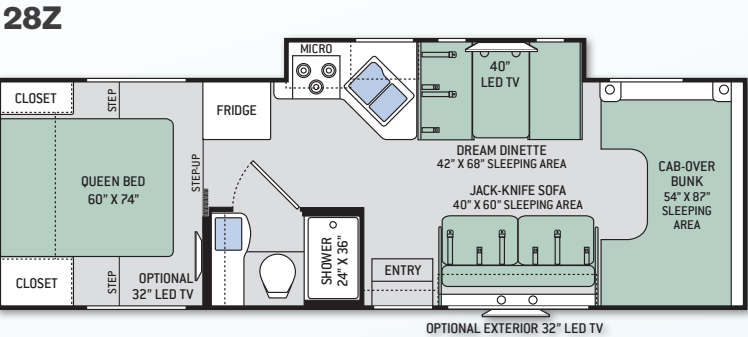
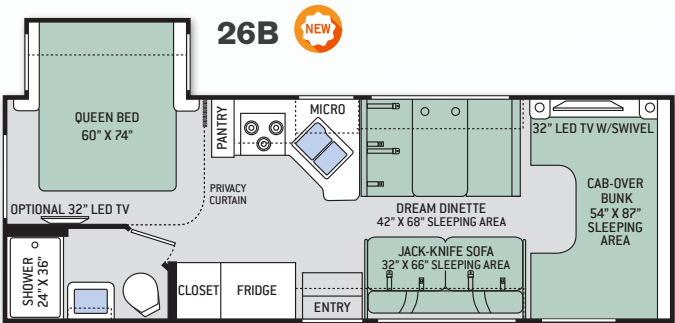
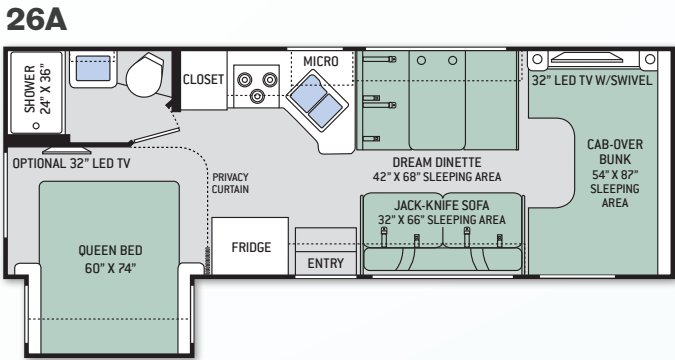
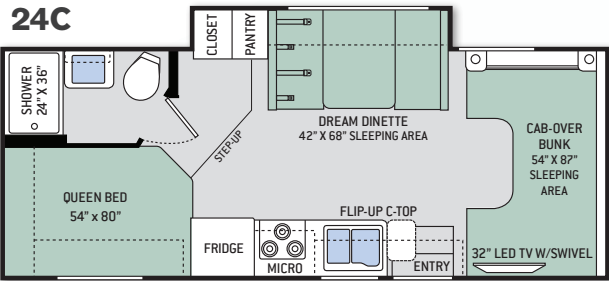
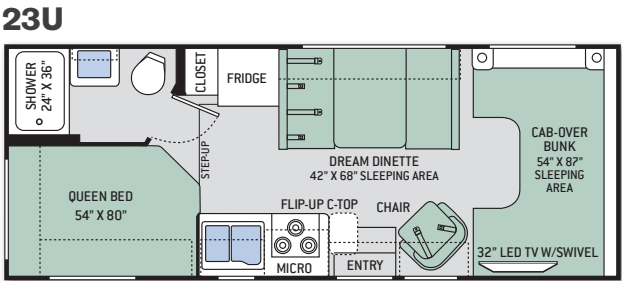
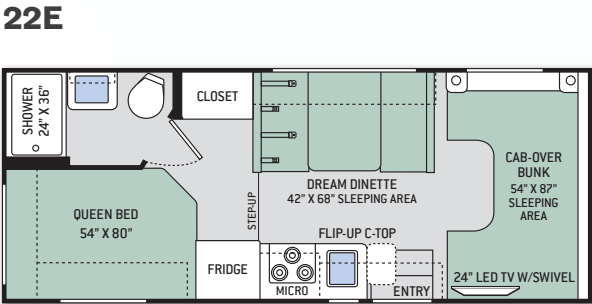
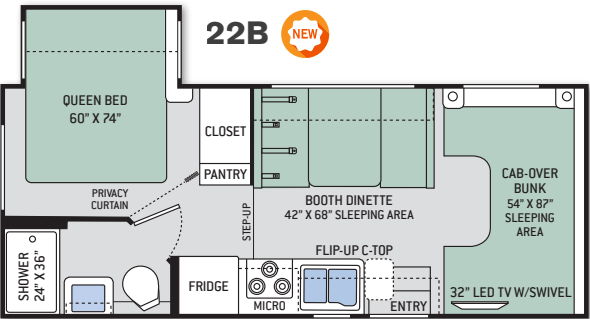

29G

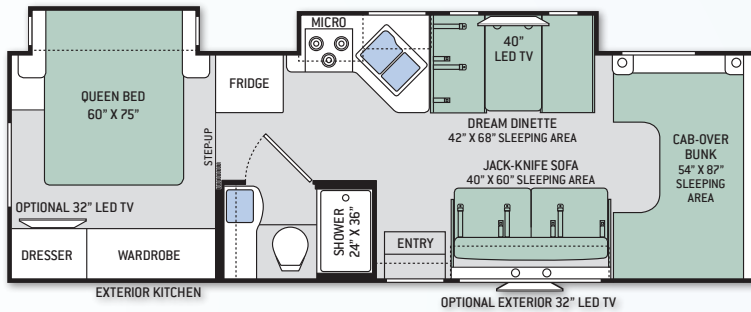

31E

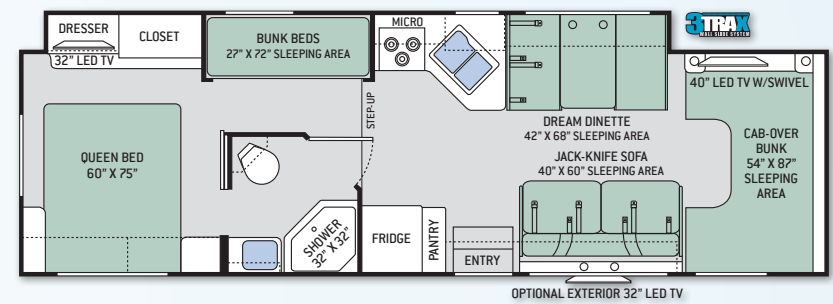

31L

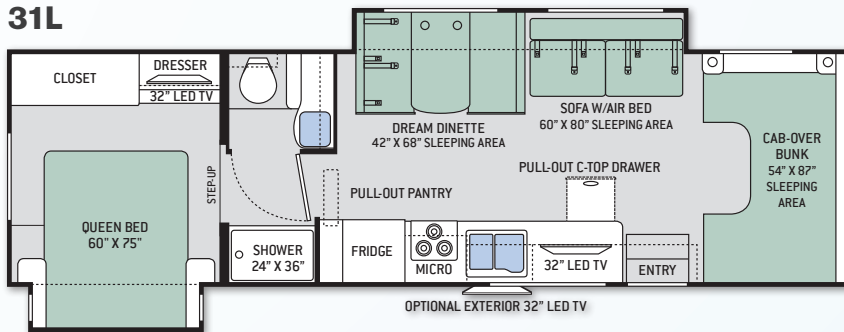

31W

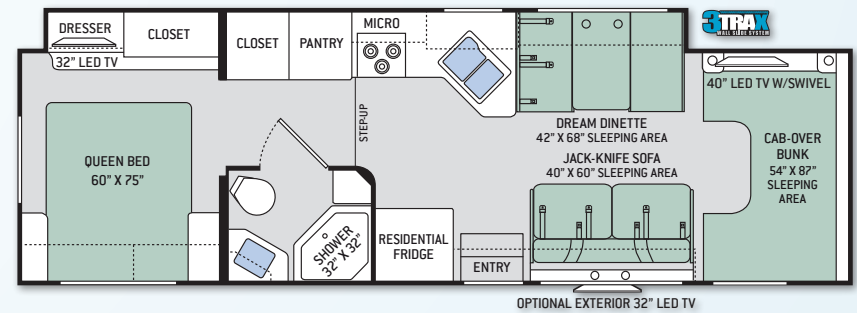

FLOOR PLAN

	22B	22E	23U	24C	26A	26B	28Z	29G	31E	31L	31W
Chassis	Ford / Chevy	Ford / Chevy	Ford / Chevy	Ford / Chevy	Ford / Chevy	Ford / Chevy	Ford	Ford	Ford	Ford	Ford
Gross Vehicle (GVWR)	14,500 / 12,300	14,500 / 12,300	14,500 / 12,300	14,500 / 12,300	14,500 / 12,300	14,500 / 12,300	14,500	14,500	14,500	14,500	14,500
Gross Combined (GCWR)	22,000 / 16,000	22,000 / 16,000	22,000 / 16,000	22,000 / 16,000	22,000 / 16,000	22,000 / 16,000	22,000	22,000	22,000	22,000	22,000
Wheel Base	158" / 159"	158" / 159"	158" / 159"	168" / 169"	183" / 184"	183" / 184"	212"	212"	223"	223"	223"
Exterior Length (w/o ladder)	24' / 24'-6"	24' / 24'-6"	24'-10" / 25'-4"	24'-11" / 25'-5"	27' / 27'-6"	27'-6" / 28'	29'-11"	29'-11"	32'-7"	32'-7"	32'-2"
Exterior Height (w/AC)	10'-10"	10'-10"	10'-10"	10'-10"	10'-10"	10'-10"	10'-10"	10'-10"	11'-1"	11'-1"	11'-1"
Exterior Width (w/o mirrors)	99"	99"	99"	99"	99"	99"	99"	99"	99"	99"	99"
Interior Height (living area)	82"	82"	82"	82"	82"	82"	82"	82"	84"	84"	84"
Awning Size	15'	15'	15'	16'	11'	18'	14'	14'	16'	16'	16'
Fuel (gal)	55 / 57	55 / 57	55 / 57	55 / 57	55 / 57	55 / 57	55	55	55	55	55
LPG (lbs)	40.9	40.9	40.9	40.9	40.9	40.9	40.9	40.9	40.9	40.9	40.9
Fresh/Waste/Gray Water (gal)	40 / 24.5 / 37	40 / 24.5 / 37	40 / 24.5 / 38.5	40 / 24.5 / 37	40 / 26 / 26	40 / 26 / 26	40 / 26 / 32	39 / 26 / 32	40 / 28 / 28	40 / 31 / 29	40 / 28 / 28
Water Heater (gal)	6	6	6	6	6	6	6	6	6	6	6
Furnace (BTUs)	20,000	20,000	20,000	20,000	30,000	30,000	30,000	30,000	30,000	30,000	30,000
Exterior Storage Capacity (cu. ft.)	30.9	50.3	69.5	49.2	40	40	98.3	46.7 / 71.9'	56.2	65.9	62.9



This triple track design supports large rooms, like those found in full-wall slideouts, ensuring simple, reliable, maintenance-free operation. What sets 3TRAX™ apart is the patented rail system, in-floor roller guides and electric motor design. For more information, visit thormotorcoach.com/3TRAX.



Made to fit.



Taking the extra time to ensure the best possible structure is exactly what you deserve, and this is why Thor Motor Coach insists on vacuum-bond laminating not only the sidewalls of the motorhome, but also the floor and roof. Vacuum-bonding is the optimum manufacturing process to ensure maximum strength.

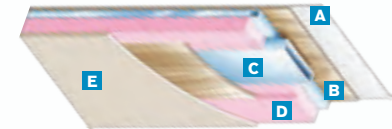

ROOF

- A** One-piece exterior TPO membrane
- B** Lauan panels
- C** Aluminum structure with bowed framing
- D** Block foam insulation
- E** Interior panel with hard vinyl covering

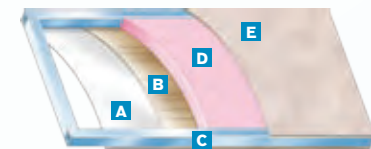

SIDEWALLS

- A** High-gloss fiberglass
- B** Lauan panels
- C** Aluminum structure with framing at all openings
- D** Block foam insulation
- E** Interior panel with designer wall covering

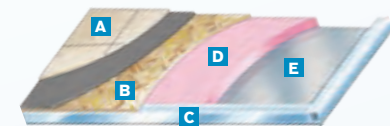



FLOOR

- A** Residential vinyl flooring
- B** OSB structure wood base
- C** Structural steel framing
- D** Block foam insulation
- E** Lauan with woven plastic exterior finish

CLASS C STANDARDS & OPTIONS

CONSTRUCTION & EXTERIOR

- Ford® E-Series or Chevrolet® C4500 Dually Chassis (22B, 22E, 23U, 24C, 26A & 26B)
- Ford® E-Series Chassis (STD 28Z, 29G, 31E, 31L & 31W)
- Premium One-Piece TPO Roof 
- Slick Fiberglass Exterior with Standard Graphics Package
- MEGA-Storage™ Compartment (22B, 22E, 23U, 24C, 28Z & 29G)
- Flush Mount Radius Compartment Doors
- Power Patio Awning with Integrated LED Lighting
- 3TRAX™ Wall Slide System (31E & 31W) 
- Framed Radius Windows (22B, 22E, 23U, 24C, 26A, 26B, 28Z & 29G)
- Frameless Windows (31E, 31L & 31W)

CONSTRUCTION & EXTERIOR OPTIONS

- HD-MAX® Exterior with Graphics Package
- Automatic Leveling Jacks (OPT 29G & 31L / STD 31E & 31W)
- Outside Shower (STD 31E, 31L & 31W)

AUTOMOTIVE & COCKPIT

- AM/FM Dash Radio with CD Player & Bluetooth® (22B, 22E, 23U, 24C, 26A & 26B)
- Deluxe Exterior Mirrors
- Power Windows & Door Locks
- Cruise Control
- Windshield Privacy Curtain
- Aluminum Running Boards
- 8,000-lb. Trailer Hitch with 7-pin Round Connector

AUTOMOTIVE & COCKPIT OPTIONS

- Heated/Remote Exterior Mirrors with Integrated Side View Cameras (Requires Back-up Monitor)
- Touchscreen AM/FM Dash Radio with CD/DVD Player, Bluetooth® & Back-Up Monitor (STD 28Z, 29G, 31E, 31L & 31W)
- Wood Dash Applique
- Leatherette Captain's Chairs
- Power Driver's Seat (28Z, 29G, 31E, 31L & 31W)
- Cockpit Carpet Mat
- Keyless Entry & Valve Stem Extenders (STD 28Z, 29G, 31E, 31L & 31W)
- Wheel Liners (STD 28Z, 29G, 31E, 31L & 31W)
- Spare Tire

INTERIOR

- Residential Vinyl Flooring Throughout
- Ceiling Ducted Air Conditioning System (26A, 26B, 28Z, 29G, 31E, 31L & 31W)
- LED Ceiling Lights
- Window Privacy Shades
- Cab-Over Bunk Ladder (N/A 22E)

- Fabric Barrel Chair (23U)
- Fabric Jack-Knife Sofa (26A, 26B, 28Z, 29G, 31E & 31W)
- Leatherette Sofa with Air Bed (31L)
- Fabric Booth Dinette* (22B)
- Fabric Dream Dinette® Booth* (22E, 23U, 24C, 26A, 26B, 28Z, 29G, 31E, 31L & 31W)

INTERIOR OPTIONS

- Leatherette Jack-Knife Sofa (26A, 26B, 28Z, 29G, 31E & 31W)
- Leatherette Booth Dinette (22B)
- Leatherette Dream Dinette® Booth (22E, 23U, 24C, 26A, 26B, 28Z, 29G, 31E, 31L & 31W)
- Single Child Safety Tether in Dinette
- Dual Child Safety Tethers in Dinette*
- 12-volt Attic Fan in Cab-Over Bunk

KITCHEN

- Double Door Refrigerator (N/A 31W)
- 16 cu. ft. Residential Refrigerator w/Ice Maker (31W)
- 3-Burner Gas Cooktop
- Microwave Oven
- Pop-Up Countertop Outlet* (31E, 31L, 31W)
- Laminate Countertops
- Pantry (22B, 26B, 24C, 31E, 31L & 31W)

KITCHEN OPTIONS

- 3-Burner Gas Cooktop with Oven (STD 28Z, 29G, 31E, 31L & 31W)
- Convection Microwave Oven (N/A 31E, 31L & 31W)

BEDROOM & BATHROOM

- Denver Mattress® Queen Size Bed
- Bunk Beds in Hallway Slideout (31E)
- Shower with Curtain (22B, 22E & 24C)
- Shower with Retractable Door (23U, 26A, 26B, 28Z & 29G)

BEDROOM & BATHROOM OPTION

- 12-volt Attic Fan in Bedroom

ENTERTAINMENT

- 24" LED TV & DVD Player on Manual Swivel in Cab-Over (22E)
- 32" LED TV & DVD Player on Manual Swivel in Cab-Over (22B, 23U, 24C, 26A & 26B)
- 40" LED TV & DVD Player in Living Area (28Z & 29G)
- 40" LED TV & DVD Player on Manual Swivel in Cab-Over (31E & 31W)
- 32" LED TV & DVD Player in Living Area (31L)
- Two (2) 13" LED TVs & DVD Player in Bunk Bed Area (31E)

- Bluetooth® Coach Radio with Exterior Speakers (28Z, 29G, 31E, 31L & 31W)
- Power Charging Center for Electronics (28Z, 29G, 31E, 31L & 31W)
- Cable TV Ready
- Digital TV Antenna*
- Exterior Kitchen with 2.6 cu. ft. Refrigerator, Sink, Portable Gas Grill & 1000-watt Inverter (29G)

ENTERTAINMENT OPTIONS

- Cab-Over Entertainment Center with 39" LED TV, DVD Player & Sound Bar IPO STD Living Area TV (22B, 22E, 23U, 24C, 26A, 26B, 31E, 31L & 31W)
- 32" LED TV in Bedroom (OPT 26A, 26B, 28Z, 29G / STD 31E, 31L & 31W)
- Exterior 32" LED TV (28Z, 29G, 31E, 31L & 31W)
- Storage Area with Shelf IPO Exterior Kitchen (29G)

ELECTRICAL & PLUMBING

- Cummins Onan® RV QG 4000 Gas Generator
- Automatic Generator Start (31W)
- 30-amp Shoreline Power Cord
- 1800-watt Inverter (31W)
- 13,500 BTU Roof Front Air Conditioner
- 6-gallon DSI Gas/Electric Water Heater
- Water Heater Bypass System
- Rapid Camp® Wireless Control System (31E, 31L & 31W)

ELECTRICAL & PLUMBING OPTIONS

- 15,000 BTU Roof Front Air Conditioner IPO 13,000 BTU Standard Air Conditioner
- Holding Tanks with Heat Pads (STD 28Z, 29G, 31E, 31L & 31W)
- Second Auxiliary House Battery (STD 31W)

PREMIER PACKAGE - STANDARD ON 31E, 31L & 31W

- 30" Over-the-Range Microwave Oven
- Solid Surface Kitchen Countertops & Sink Covers
- Shower with Glass Door
- Premium Roller Shades
- Whole Coach Water Filtration System*
- Enclosed Sewer Area for Sewer Tank Valves
- Black Tank Flush System

*INCLUDED ON UNITS BUILT AFTER 10/01/15



Made to fit.

DO YOU NEED A LITTLE MORE?

A little more power? A little more towing capacity? A little more leg room? The Four Winds Super C answers all those questions with a resounding yes, and compliments our diverse Four Winds Class C line-up, creating the perfect palette for you to choose the motorhome that is ***Made to Fit.***



33SW | KEY LARGO | MONTEREY MAPLE



35SK | ARUBA | MONTEREY MAPLE



35SK | ARUBA | MONTEREY MAPLE



33SW | KEY LARGO | MONTEREY MAPLE



SUPER C



 **THOR**
MOTOR COACH

Made to fit.

35SK | ARUBA | HIGH-GLOSS GLAZED MONTEREY MAPLE

BEAUTY INSIDE & OUT



ARUBA



RESIDENTIAL VINYL FLOORING



KEY LARGO



COUNTERTOPS



MANHATTAN



HIGH-GLOSS
GLAZED MILAN
CHERRY



HIGH-GLOSS
GLAZED
MONTEREY MAPLE

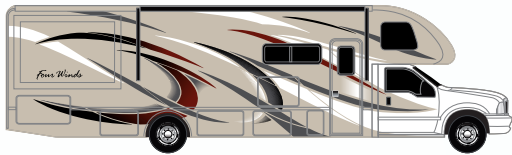

CINNABAR-CHAMPAGNE 

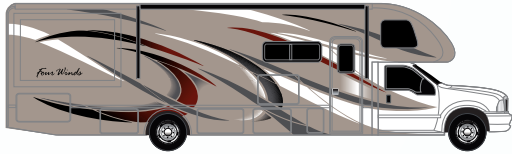

CINNABAR-TAUPE 

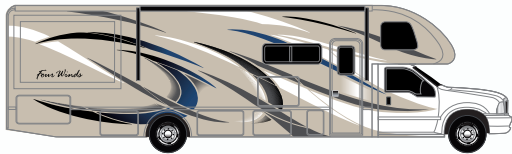

WATERFALL-CHAMPAGNE 

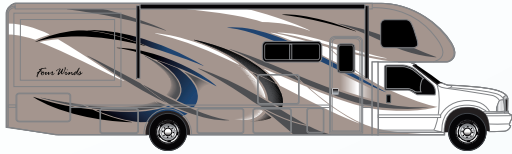

WATERFALL-TAUPE 



MAPLE LEAF FULL-BODY PAINT



PACIFICA FULL-BODY PAINT

SUPER C – FORD® F-550



A | 6.7L POWER STROKE® V8 TURBO DIESEL ENGINE

The 6.7L V8 engine has a proven track record of durability and low-hassle maintenance. Extremely smooth running with a commanding 300-horsepower and 660 lb.-ft. of torque.

B | POWER 4-WHEEL DISC ANTI-LOCK BRAKE SYSTEM

Maintains brake balance in heavy use and varying road conditions. Reduces wheel lock up and helps maintain superior steering control.

C | TWIN I-BEAM FRONT SUSPENSION

Provides a comfortable ride by allowing the front wheels to work independently of each other, reducing driver stress.

D | TORQSHIFT™ 6-SPEED SELECT SHIFT® AUTOMATIC TRANSMISSION

Provides crisp, firm and quick shifting without sacrificing driver comfort.

E | LIMITED WARRANTY

The Ford® Motorhome Chassis has a Bumper-to-Bumper Limited Warranty for 3 years or 36,000 miles and a Powertrain Limited Warranty for 5 years or 60,000 miles, whichever comes first.

Taking the extra time to ensure the best possible structure is exactly what you deserve, and this is why Thor Motor Coach insists on vacuum-bond laminating not only the sidewalls of the motorhome, but also the floor and roof. Vacuum-bonding is the optimum manufacturing process to ensure maximum strength.

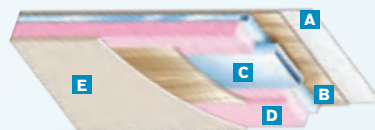

ROOF

- A** One-piece exterior TPO membrane
- B** Luan panels
- C** Aluminum structure with bowed framing
- D** Block foam insulation
- E** Interior panel with soft touch vinyl covering

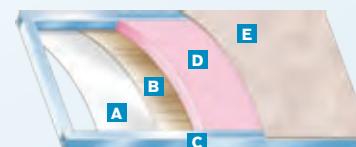

SIDEWALLS

- A** High-gloss fiberglass
- B** Luan panels
- C** Aluminum structure with framing at all openings
- D** Block foam insulation
- E** Interior panel with designer wall covering

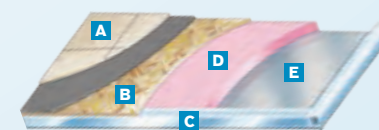

FLOOR

- A** Residential vinyl flooring
- B** OSB structure wood base
- C** Structural steel framing
- D** Block foam insulation
- E** Luan with woven plastic exterior finish

SUPER C FLOOR PLANS

33SW

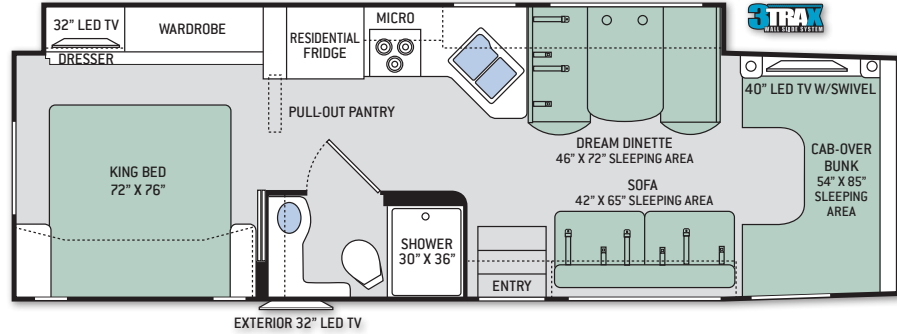

35SB

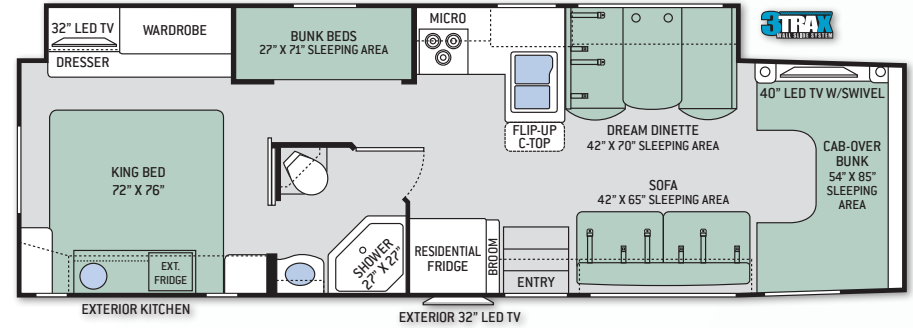

35SD NEW

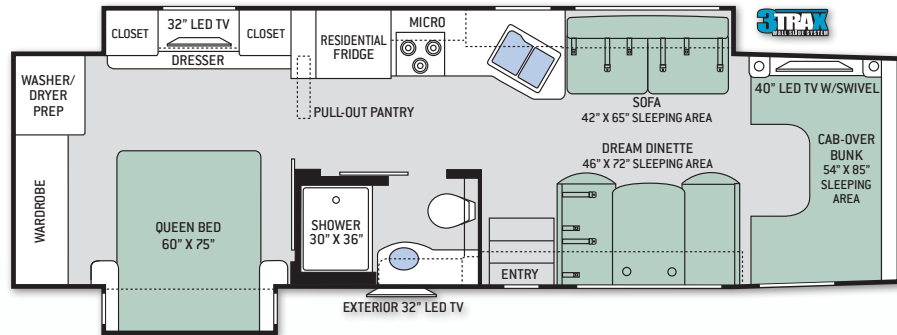

35SF

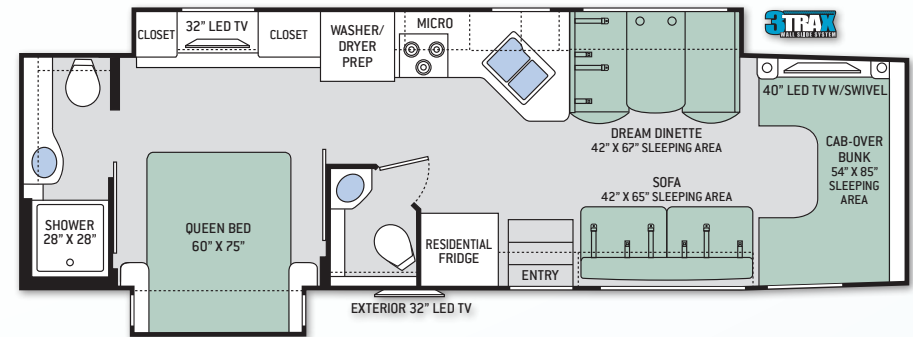

35SK

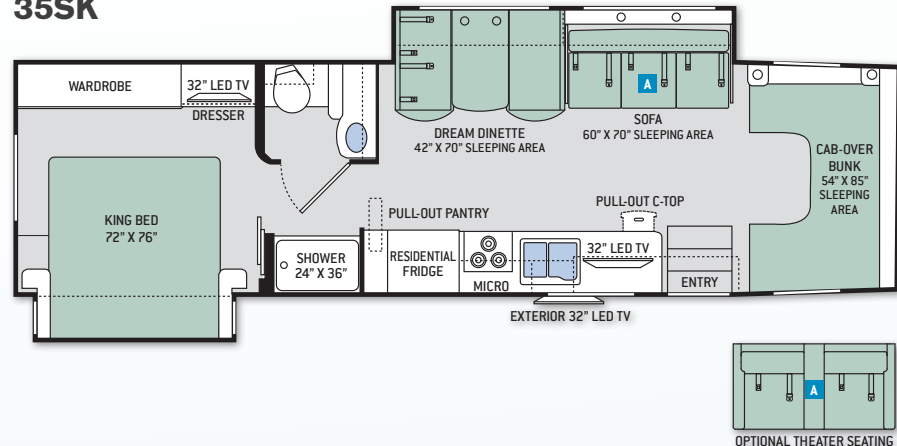



FLOOR PLAN

	33SW	35SB	35SD	35SF	35SK
Chassis	Ford	Ford	Ford	Ford	Ford
Gross Vehicle (GVWR)	19,500	19,500	19,500	19,500	19,500
Gross Combined (GCWR)	35,000	35,000	35,000	35,000	35,000
Wheel Base	255"	245"	255"	255"	255"
Exterior Length (w/o ladder)	34'-6"	35'-11"	36'-2"	36'-2"	36'-2"
Exterior Height (w/ AC)	12'-6"	12'-6"	12'-6"	12'-6"	12'-6"
Exterior Width (w/o mirrors)	99"	99"	99"	99"	99"
Interior Height (living area)	84"	84"	84"	84"	84"
Awning Size	20'	19'	14'	14'	16'
Front/Rear Fuel (gal)	40 / 28	40 / 28	40 / 28	40 / 28	40 / 28
LPG (lbs)	68.2	68.2	68.2	68.2	68.2
Fresh/Waste/Gray Water (gal)	75 / 40 / 47	75 / 40 / 40	75 / 40 / 40	75 / 40F- 31R / 40	75 / 40 / 40
Water Heater (gal)	6	6	6	6	6
Furnace (BTUs)	30,000	30,000	30,000	30,000	30,000
Exterior Storage Capacity (cu. ft.)	133	128.7 / 92.6'	100	117	164

*Without Exterior Kitchen

SUPER C STANDARDS & OPTIONS

CONSTRUCTION & EXTERIOR

- Ford® F-550 Chassis – 6.7L Power Stroke® V8 Turbo Diesel, 300HP & 660 lb.-ft. Torque – TorqShift® 6-Speed SelectShift® Automatic Transmission
- Fully Welded Tubular Steel Floor System
- Fully Welded Tubular Aluminum Roof & Sidewall Cage Construction
- Premium One-Piece TPO Roof 
- HD-MAX® Exterior with Graphics Package
- Automatic Leveling Jacks with Touchpad Controls
- Seamless Rotocast Storage Compartments
- Flush Mount Radius Storage Doors
- Power Patio Awning with Integrated LED Lighting
- Slideout Room Awning
- 3TRAX™ Wall Slide System (33SW, 35SB, 35SD & 35SF) 
- Roof Ladder
- Patio Light
- Single Electric Automatic Entry Step
- Outside Shower
- Black Frameless Slider Windows

CONSTRUCTION & EXTERIOR OPTION

- Full-Body Paint Package with Gel-Coat Sidewalls

AUTOMOTIVE & COCKPIT

- Touchscreen AM/FM Dash Radio with CD/DVD Player, Bluetooth® & Back-Up Monitor
- Chrome, Heated/Remote Exterior Mirrors with Side View Camera System
- Luxury Cloth Captain's Chairs with Center Seat & Fold-Down Console in Between
- 6-Way Power Adjustment Driver's Seat
- Adjustable Accelerator & Brake Pedals
- Power Windows & Door Locks
- Keyless Entry System
- Fiberglass Running Boards
- Valve Stem Extenders
- Wheel Liners
- 10,000-lb. Trailer Hitch with 7-pin Round Connector

INTERIOR

- Residential Vinyl Flooring Throughout
- Ceiling Ducted Air Conditioning System
- 84" LED Ceiling Height
- Soft Touch Vinyl Ceiling
- LED Ceiling Lights
- High-Gloss Glazed Cabinetry with Nickel Finish Hardware
- Window Solar & Privacy Roller Shades in Living Room
- Leatherette Sleeper Sofa*
- Leatherette Dream Dinette® Booth*
- Solid Surface Dinette Countertop

INTERIOR OPTIONS

- Theater Seating with Incliners & Footrests (35SK)
- Single Child Safety Tether in Dinette
- Dual Child Safety Tethers in Dinette*
- 12-volt Attic Fan in Cab-Over

KITCHEN

- 16 cu. ft. Stainless Steel Residential Refrigerator w/Ice Maker
- 3-Burner Gas Cooktop with Oven
- 30" Over-the-Range Microwave Oven
- Solid Surface Countertops & Sink Covers
- Large Double Bowl Kitchen Sink with Single Handle Faucet & Pull-Down Sprayer
- Pop-Up Countertop Outlet*
- Pantry (33SW & 35SK)

KITCHEN OPTION

- 12-volt Attic Fan (33SW, 35SB, 35SD & 35SF)

BEDROOM & BATHROOM

- Denver Mattress® King Size Bed (33SW, 35SB & 35SK)
- Denver Mattress® Queen Size Bed (35SD & 35SF)
- Bedspread & Pillow Shams
- Bunk Beds in Hallway Slideout (35SB)
- Shower with Glass Door
- Stainless Steel Bathroom Sink
- Vanity Soffit Lighting
- Porcelain Toilet
- Power Vent in Bathroom

ENTERTAINMENT

- 40" LED TV & DVD Player on Manual Swivel in Cab-Over (33SW, 35SB, 35SD & 35SF)
- Mid-Ship Entertainment Center with 32" LED TV & DVD Player in Living Area (35SK)
- 32" LED TV in Bedroom
- Two (2) 13" LED TVs & DVD Player in Bunk Bed Area (35SB)
- Exterior 32" LED TV
- Bluetooth® Coach Radio System with Exterior Speakers
- Cable TV Ready
- Digital TV Antenna*
- Power Charging Center for Electronics
- Exterior Kitchen with 2.6 cu. ft. Refrigerator, Sink & Portable Gas Grill (35SB)

ENTERTAINMENT OPTIONS

- Cab-Over Entertainment Center with 50" LED TV & Sound Bar (IPO 40" LED TV)
- Storage Area with Shelf IPO Exterior Kitchen (35SB)

ELECTRICAL & PLUMBING

- Cummins Onan® RV QG 6000 Diesel Generator*
- Automatic Generator Start
- 50-amp Detachable Shoreline Power Cord
- Automatic Shoreline-to-Generator Transfer Switch
- 1800-watt Inverter
- Dual 13,500 BTU Roof Air Conditioners
- Emergency Start Switch
- Dual Auxiliary House Batteries
- Battery Disconnect Switch
- Whole Coach Water Filtration System*
- 6-gallon DSI Gas/Electric Water Heater
- Water Heater Bypass System
- Enclosed & Heated Holding Tanks
- Black Tank Flush System*
- Systems Control Center
- Rapid Camp® Wireless Control System

*INCLUDED ON UNITS BUILT AFTER 10/01/15



This triple track design supports large rooms, like those found in full-wall slideouts, ensuring simple, reliable, maintenance-free operation. What sets 3TRAX™ apart is the patented rail system, in-floor roller guides and electric motor design. For more information, visit thormotorcoach.com/3TRAX.



Made to fit.



SHIELD of PROTECTION



CONCIERGE CONNECTION

New owners receive a personalized contact right from the factory to answer questions about their new motorhome purchase.



24/7 FACTORY SUPPORT

Day or night, highly-trained Thor Motor Coach technicians can diagnose and offer solutions to operational and service needs, providing owners with peace of mind.



RAPID RESPONSE

It is Thor Motor Coach's commitment to have essential parts stocked for quick shipment to get units back on the road.



ONE SOURCE WARRANTY

Owners and dealers have the strength of Thor Motor Coach to help facilitate warranty service.

Thor Motor Coach is the industry leader in innovative design and builds a variety of unique styles, sizes and floor plans that feel custom-made – at a truly competitive price.

IMPORTANT–PLEASE READ: This brochure reflects product design, fabrication, material, components and specifications at the date of printing, which date is disclosed below. **Please visit us online at ThorMotorCoach.com or consult with your selling dealership for the latest in standards, options, specification and technical information.** Photographs in the brochure may depict optional equipment or may only be available in certain floor plans. Components, appliances and the chassis may have been manufactured in a calendar year before the vehicle's designated model year. All capacities are approximate. The actual length of the vehicle may differ from that indicated in the brochure due to variances in the manufacturing processes and/or installed components. All dry weights are based on standard model features and do not include optional features or equipment. Component part and appliance manufacturers issue limited warranties covering portions of the vehicle not covered under the limited warranty we issue. Copyright Thor Motor Coach, Inc. © 12/15/15 V2

Colton RV
North Tonawanda, NY 14127
(716) 694-0188
(800) 628-4889
www.ColtonRV.com

YOUR LOCAL THOR MOTOR COACH DEALER



Colton RV
Orchard Park, NY 14127
(716) 957-3250
(800) 628-4889
www.ColtonRV.com



Made to fit.

P.O. Box 1486, Elkhart, IN 46515
Sales Department: 800.860.5658
Customer Service: 877.855.2867

thormotorcoach.com/fourwinds
thormotorcoach.com/fourwinds-super-c

