

MIRADA

BY COACHMEN



DON'T SETTLE FOR MIDDLE-OF-THE-ROAD.

MIRADA IS FOR MOTORHOME ENTHUSIASTS WHO APPRECIATE THE FINER ASPECTS OF HIGHWAY LIFE — AT A SURPRISINGLY AFFORDABLE PRICE.



Entertaining is a breeze with a beautifully appointed kitchen. The exterior kitchen (available in select floor plans) and outdoor entertainment system are perfect for taking the party outside.

There's even room for the kids to sleep over with the drop-down cabover bunk.



INTERIOR DÉCOR COLOR SELECTIONS



Carnegie



Heron

INTERIOR WOOD COLOR SELECTIONS



White Velvet



Chocolate Cherry



Photography features the Mirada 350S floorplan with Heron interior and Chocolate Cherry cabinetry.



Equipped with a comfortable king mattress and designer headboard with coordinating bedspread and shams, Mirada's bedroom is the perfect place to sleep after a day in the woods or on the town.

The bedroom features an LED TV, spacious wardrobe and side tables to keep clutter at bay.

The Coach-Pap™ Station allows for storage of CPAP machines and other electronics, located in the cabinet above the bed.

Built from stainless steel and porcelain, the bathroom is both appealingly designed and super-easy to clean.



You'll find hardwood cabinet doors in the galley and living areas, providing an elegant feel in the Mirada.

The Mirada is equipped with optional power theater seating that has heat, massage, light and recline functions.

Convert the sofa into a bed to provide even more sleeping capacity.

FLOORPLANS

Mirada includes five floorplan options, so you'll have no trouble choosing the one that suits you perfectly.

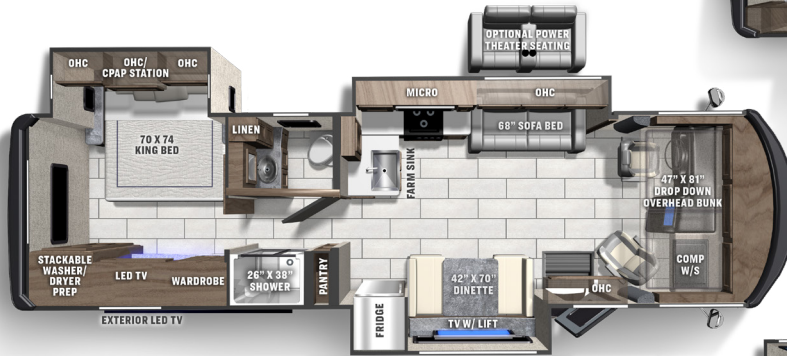

315KS



29FW

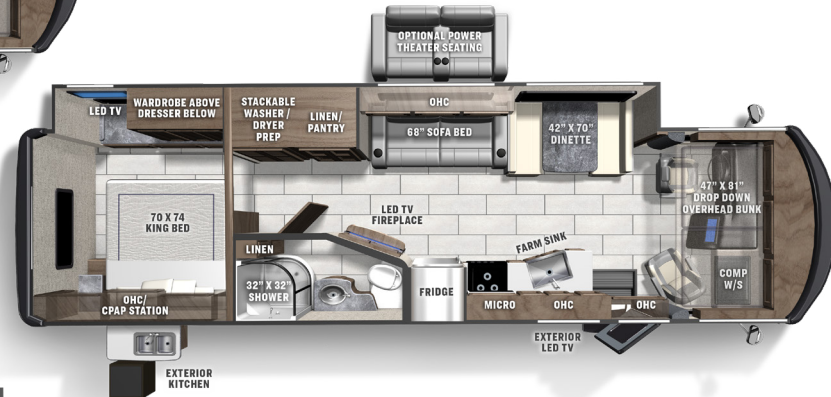

32LS

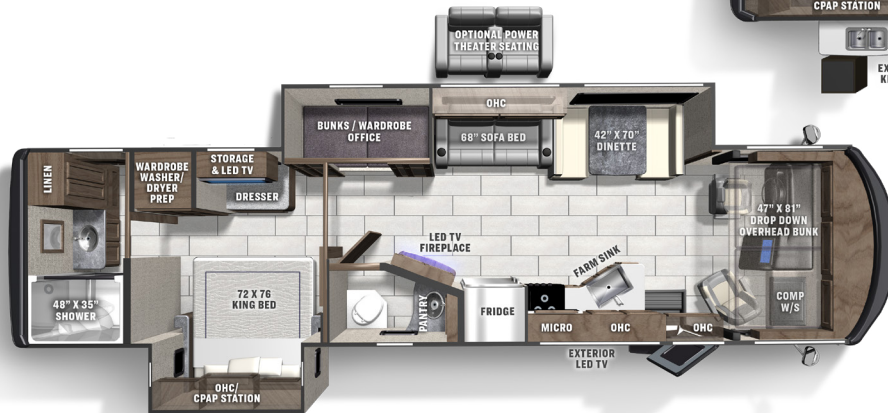

35ES

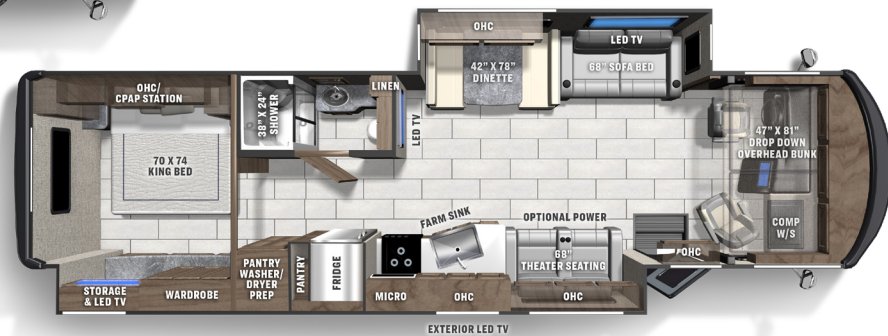

35OS

MIRADA SPECIFICATIONS

CLASS A GAS	29FW	315KS	32LS	35ES	35OS
FORD ENGINE V-8 7.3L 3-VALVE	350 HP/468 TRQ	350 HP/468 TRQ	350 HP/468 TRQ	350 HP/468 TRQ	350 HP/468 TRQ
WHEEL BASE	190"	228"	228"	242"	242"
GVWR	18,000 lbs	22,000 lbs	20,500 lbs	22,000 lbs	22,000 lbs
GCWR	23,000 lbs	26,000 lbs	26,000 lbs	26,000 lbs	26,000 lbs
GAWR FRONT	7,000 lbs	8,000 lbs	7,500 lbs	8,000 lbs	8,000 lbs
GAWR REAR	12,000 lbs	15,000 lbs	13,500 lbs	15,000 lbs	15,000 lbs
FUEL CAPACITY	80 gal	80 gal	80 gal	80 gal	80 gal
LP GAS CAPACITY	20 gal	20 gal	20 gal	20 gal	20 gal
FURNACE (BTUs)	30,000	30,000	30,000	30,000	30,000
EXTERIOR LENGTH	30' 7"	33' 1"	34' 10"	36' 10"	36' 10"
EXTERIOR HEIGHT (w/A/C)	12' 5"	12' 7"	12' 5"	12' 5"	12' 5"
EXTERIOR WIDTH	102"	102"	102"	102"	102"
FRESH WATER	50 gal	70 gal	70 gal	70 gal	70 gal
GREY WATER	46 gal	46 gal	45 gal	45/45 gal	45 gal
BLACK WATER	46 gal	46 gal	45 gal	45/46 gal	45 gal
WATER HEATER	6 gal	10 gal	6 gal	6 gal	6 gal
AWNING SIZE	20'	8' & 12'	15' & 10'	17'	20'

GVWR (Gross Vehicle Weight Rating) is the maximum permissible weight of the unit when fully loaded. It includes all weights, inclusive of all fluids, occupants, cargo, optional equipment and accessories. For safety and product performance do NOT exceed the GVWR.

GCWR (Gross Combined Weight Rating) is the maximum permissible loaded weight of your motor home and any towed trailer or towed vehicle. Actual GCWR of this vehicle may be limited by the sum of the GVWR and the installed hitch receiver maximum capacity rating; see hitch rating label for detail.

GAWR (Gross Axle Weight Rating) is the maximum permissible weight, including cargo, fluids, optional equipment and accessories that can be safely supported by each axle.

UVW (Unloaded Vehicle Weight) * is the typical weight of the unit as manufactured at the factory. It includes all weight at the unit's axle(s), including full fuel, all fluids and LP Gas. The UVW does not include cargo, fresh potable water, additional optional equipment or dealer installed accessories.

*Estimated Average based on standard build optional equipment.

CCC (Cargo Carrying Capacity) ** is the amount of weight available for fresh potable water, cargo, passengers, additional optional equipment and accessories. CCC is equal to GVWR minus UVW. Available CCC should accommodate fresh potable water (8.3 lbs per gallon). Before filling the fresh water tank, empty the black and gray tanks to provide for more cargo capacity.

** Estimated average based on standard build optional equipment

Each Coachmen motorhome is weighed at the manufacturing facility prior to shipping. A label identifying the unloaded vehicle weight of the actual unit and the cargo carrying capacity is applied to every Coachmen motorhome prior to leaving our facilities.

The load capacity of your unit is designated by weight, not by volume, so you cannot necessarily use all available space when loading your unit.

Actual towing capacity is dependent upon your particular loading and towing circumstances, which includes the GVWR, GAWR and GCWR as well as adequate trailer brakes. Please refer to the Operator's Manual of your vehicle for further towing information.

All information contained in this brochure is believed to be accurate at the time of publication. However, during the model year, it may be necessary to make revisions and Coachmen reserves the right to make all such changes without notice, including prices, colors, materials, equipment and specifications as well as the addition of new models and the discontinuance of models shown in this brochure. Therefore, please consult with your Coachmen dealer and confirm the existence of any materials, design or specifications that are material to your purchase decision. 11/21

©Copyright 2021 Coachmen RV a Division of Forest River Inc. – All Rights Reserved.

STANDARD FEATURES

INTERIOR APPOINTMENTS

Solid Surface Kitchen Countertop
Premium Linoleum Throughout
Brushed Nickel Hardware
Hardwood Cabinet Doors/Flat Panel
Self-Closing Ball Bearing Drawer Guides
Throughout
Frameless Tinted Windows with Safety Glass
Reclining/Swivel Pilot Seats
Sofa with Hide-A-Bed (Where Applicable)
Solar Privacy Shades Throughout
Easy Clean Cockpit Floor
Power Windshield Shade with Manual Side Shade

INTERIOR EQUIPMENT

10" Touch Screen Radio AM/FM Radio
with Bluetooth Apple CarPlay and Android
Auto Link Enabled
Pre-Wired for Satellite Dish
Exterior Cable TV Jack and Tailgater Satellite Jack
LP Leak Alarm and Smoke Detector
Carbon Monoxide Detector
Fire Extinguisher
King Jack TV - Radio Antenna
40" LCD TV Main Coach (29FW, 32LS, 35ES)
50" LCD TV Main Coach (35OS, 315KS)
Fireplace Electric (32LS, 35ES)
Charging Station for Electronic Devices

GALLEY

High Rise Kitchen Faucet
Stainless Steel Farmhouse Sink
Solid Surface Sink Covers
Stainless Steel Large Double Door Refrigerator
Stainless Steel 3-Burner Range with Glass Cover
Stainless OTR Microwave
Tile Backsplash

BATH AND WATER

Stainless Lavatory Sink
Porcelain Toilet with Foot Flush
One Piece ABS Shower Surround
Glass Shower Door
Power Bath Vent
6-Gallon Gas/Electric D.S.I. Water Heater
Demand Water Pump
Skylight Over Shower
Stackable Washer/Dryer Prep
(32LS, 35OS, 35ES, 315KS)
Whole Coach Water Filter (Exc. CSA)

SLEEPING

King Bed
CPAP Cabinet
Designer Headboard
32" LCD TV Bedroom
Drop-Down Front Bunk Bed
Bunk-Office-Wardrobe Room (35ES Only)

ELECTRICAL/HEATING/AC

LED Interior Lighting
30'-50-Amp Power Cord
55-Amp, 110/12-Volt Power Converter
GFI Circuit
Outside Receptacle (DS)
Emergency Start Switch
Lighted Trunk Boxes
Exterior LED Strip Light
30,000 BTU E.I. Furnace
Dual 15,000 BTU A/C with Heat Pump
Dual Coach Batteries
5.5 KW Gas Generator
Coach Command Center
Automatic Transfer Switch
Auto Generator Start (32LS, 315KS, 35ES, 35OS)
100W Solar Panel with Controller
(Aftermarket Upgradeable to 300W)

AUTOMOTIVE/EXTERIOR

Ford F53 Chassis 7.3L V8
Tilt and Telescoping Steering Wheel
Cruise Control
Traction Control
Sunload Sensor with Auto Dimming
Dash Lighting
Intermittent Wipers
Dash Air Conditioning
19.5 Radial Tires (N/A 315KS)
22.5 Radial Tires with Aluminum Rims
(315KS Only)
Rear Mud Flaps Only
Power Entrance Step-Double
Full Basement with Pass Thru Storage
Radius Trunk Doors with Slam Latch
Fiberglass Front Cap and Rear Cap
Dead Bolt Lock-Entrance Door
26" Radius Entry Door
Power Patio Awning with Speakers
5,000 Towing Hitch with 7-Way Plug (29FW)
8,000 Towing Hitch with 7-Way Plug
(32LS, 35OS, 35ES, 315KS)
High Definition Back Up and Side Cameras
Power Heated Mirrors
Automatic Leveling Jacks
Slide-Out Room Awning(s)
20-Gallon LP Tank
Valve Stem Extenders
Exterior Kitchen (29FW, 32LS)
Computer Work Station at Passenger Seat
High Gloss "Oyster" Gelcoat Sidewalls
(with Azdel™ Superlite Composite)
Crowned, Laminated Fiberglass Roof
(with Azdel™ Superlite Composite)
Exterior Propane Hook-Up
Outside Entertainment Center with TV
Auxiliary Dash Fans
Auxiliary Driving Lights

OPTIONAL FEATURES

INTERIOR COLOR SELECTIONS

Carnegie
Heron

INTERIOR WOOD COLOR SELECTIONS

White Velvet
Chocolate Cherry

EXTERIOR COLOR SELECTIONS

Full Body Paint

- Phantom
- Shadow
- Ghost
- Cullinan

OPTIONAL FEATURES

Power Theater Seating (N/A 29FW)
Washer/Dryer Stackable
(32LS, 35OS, 35ES, 315KS)
Diamond Shield Paint Protection -
(Required with Full Paint)
CSA Up-Fit
CD-MVSA (Canadian Motor Vehicle Safety Act)¹

Notes:

¹ Mandatory For All Canadian Provinces

EXTERIOR COLOR OPTIONS



Partial Paint



Full Body Paint - Phantom



Full Body Paint - Shadow



Full Body Paint - Ghost



Full Body Paint - Cullinan

THE COACHMEN ADVANTAGE

What is the Coachmen advantage? It's the collection of unique features offered in a Coachmen motorhome to ensure a smoother ride, a better camping experience, and a motorhome that will last for years.

1. NOBLE SELECT™

Protected by a three-year warranty, these sidewalls have a high-gloss gelcoat finish to prevent fading. They are also 20% lighter than wood substrate sidewalls, provide more occupant cargo carrying capacity, and offer three times the insulation against extreme climates.

2. AZDEL™ COMPOSITE

Most manufacturers use wood sidewalls that can expand, swell, and eventually mold. We use Azdel. It's impervious to water, won't rot or mold, and with less than a 1% chance of delaminating, it ensures the long-term integrity of the sidewalls.

3. REINFORCED LAMINATION

We vacuum bond and pinch roll every sidewall, floor, and roof, then perform a pull adhesion test. Most manufacturers just do one process or the other, but by doing both we improve the strength and longevity of the sidewalls.

4. FOREFRONT OF TECHNOLOGY

We offer the latest in technology by pairing electronics with smart phones. A safer and larger viewing area is achieved when dual-mirroring your smart phone GPS to the 10" radio and backup system. Play your favorite songs from your favorite apps through our 4-channel 500 watt bluetooth amplifier.

5. SIGHT RITE DASH™

Our dashes are angled 20 degrees forward. This increases the line of sight for the driver, and offers the best road visibility on the market.

6. COOL STREAM DUCT™

Our patented duct system evenly disperses air through the whole coach. We use residential ducting instead of Styrofoam because it's antimicrobial, preventing the growth of bacteria and ensuring a cool, clean coach in even scorching heat.

7. DIGITAL OWNER'S MANUAL

Our owner's manuals are easy to access through the Coachmen website or our free app. Supplemented with videos, PowerPoints, and more, it's got all you need to know about your coach.

Colton RV
3122 Niagara Falls Blvd.
North Tonawanda, NY 14120
(716) 694-0188
www.ColtonRV.com



SCAN HERE

To see available
Standards, Options
and Features!



Coachmen RV, a Division of Forest River, Inc.,
A Berkshire Hathaway Company

423 N. Main St., P.O. Box 30, Middlebury, IN 46540

To learn more about Coachmen RV and our products and see how Coachmen is making the easy life easier, visit www.coachmenrv.com

CUSTOMER SATISFACTION



www.ForestRiverBuyLocal.com



**24/7 EMERGENCY
ROADSIDE ASSISTANCE
WITH VEHICLE PURCHASE***

TOWING	WINCH-OUT
JUMP-STARTS	MOBILE MECHANIC
TIRE CHANGES	TECHNICAL
FLUID DELIVERY	SUPPORT
LOCKOUT	DEALER LOCATOR
SERVICE	SERVICES



*VALID FOR 1 YEAR FROM DATE OF PURCHASE



Learn More
Scan this barcode using
a QR Reader on your
smart phone to learn
more about Forest River.



A Berkshire Hathaway company.